

(4-6754)

# Township N. 1 South Range N. 1 East of the Fairbanks Meridian, Alaska

G F E D C B A

Fairbanks Base

EAST

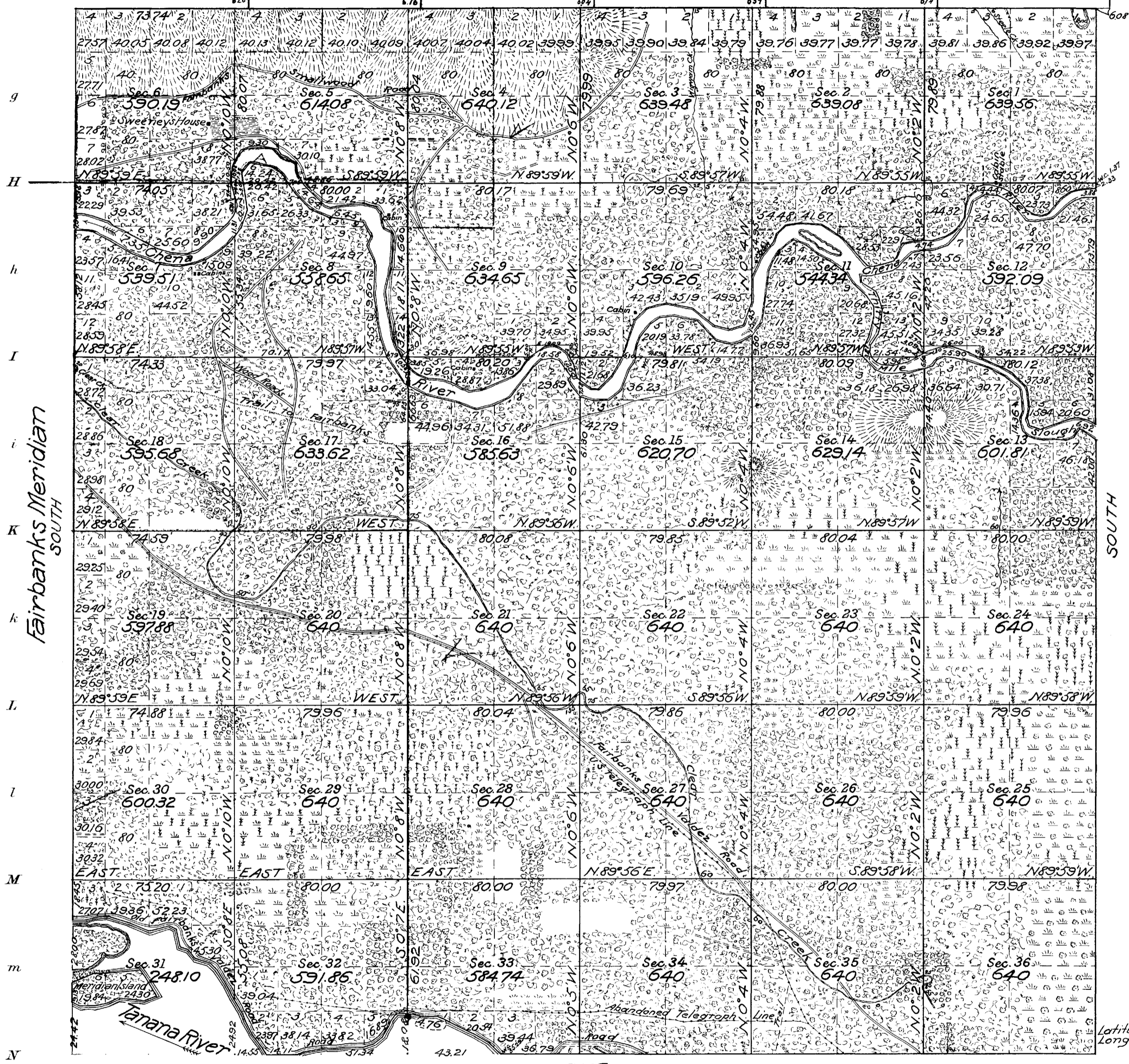

Areas in Acres	
Public Land	2 1837.49
Indian Reservation	
Indian Allotments	
Mineral Claims	
Water Surface	942.65
<b>Total Area</b>	<b>22780.14</b>

Latitude 64° 46' 35" N.  
Longitude 147° 26' 21" W.  
Scale 40 Chains to an inch.  
Mean Magnetic Declination \_\_\_\_\_

Surveys Designated	By Whom Surveyed	Contract		Amount of Surveys			When Surveyed	
		No.	Date	Mls.	chs.	lks.	Begun	Completed
E.W.N. and S. B'dys.	S.G. Lunde			18	59	22	Aug. 9, 1910	Sept. 29, 1910
N. Bdy.	W. N. Vance			1	51	19	Aug. 21, 1910	Aug. 22, 1910
W. and S. B'dys	W. H. Thorn			1	28	26	June 26, 1911	Sept. 28, 1911
Subdivisions	S.G. Lunde			5	75	20	Sept. 29, 1910	Oct. 3, 1910
Subdivisions	R. K. Crawford			15	74	65	Aug. 21, 1911	Oct. 13, 1911
Subdivisions	George S. Lewis			28	74	46	Aug. 21, 1911	Oct. 13, 1911
Subdivisions	W. H. Thorn			8	68	63	Aug. 21, 1911	Oct. 13, 1910
Meanders	S.G. Lunde			1	28	14	Oct. 5, 1910	Oct. 6, 1910
Meanders	W. H. Thorn			24	48	35	Aug. 21, 1911	Oct. 13, 1911

The above map of Township No. 1 South Range No. 1 East of the Fairbanks Meridian Alaska is strictly conformable to the field notes of the survey thereof on file in this office, which have been examined and approved

U. S. Surveyor General's Office.  
Juneau, Alaska, October 9, 1913.

*M. L. Austin*  
Surveyor General.

Topography and Calculations, M.G.