

FOUND A 1-1/2" BRASS CAP WITH OBLISCURED MARKINGS, UNABLE TO READ, 0.1' BELOW PAVEMENT, LEANING EAST WITH A CONCRETE NAIL DRIVEN IN NEXT TO IT AS APPARENT CENTER, USED NAIL.

NOTE:
FOUND A 2-1/2" BRASS CAP MONUMENT 3.9' SOUTH OF SECTION CORNER, DID NOT USE FOR THIS SURVEY SEE DOT&PF RIGHT OF WAY MAPS STP-F-M-06101 (1) / 65412, SHEET 22, NOTE 11.

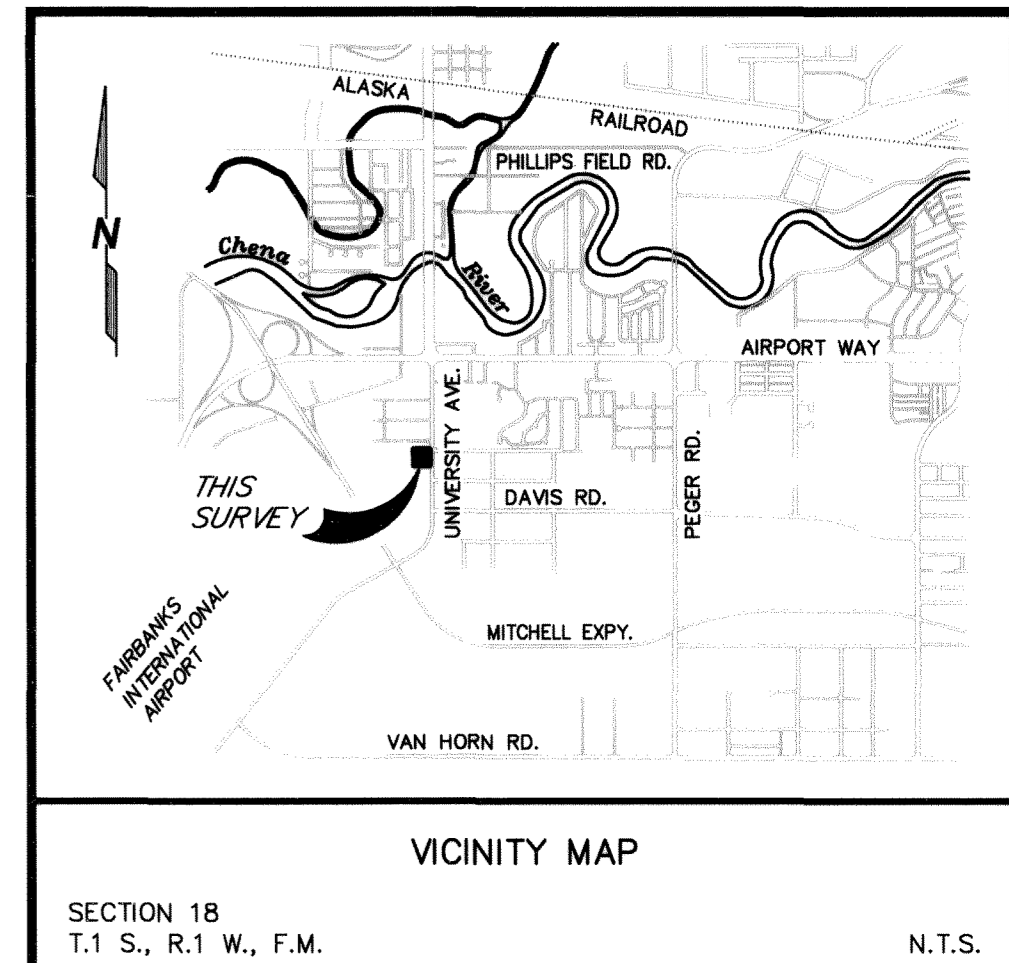

- LEGEND**
- ⊕ FOUND BRASS CAP MONUMENT IN CASE
 - FOUND 1" IRON PIPE
 - SET 2" ALCAP ON 5/8" x 30" REBAR
 - × COMPUTED POINT, NOTHING SET
 - (R) RECORD INFORMATION PER PLAT #64-486, FRD, Recorded 1/24/1964.
 - (BLM) RECORD INFORMATION PER BLM DEPENDENT RESURVEY AND SUBDIVISION OF SECTION 18, APPROVED JANUARY 14, 1972
 - (M) MEASURED INFORMATION
 - (C) COMPUTED INFORMATION

NAD83 STATE PLANE COORDINATES (ZONE 3)		
PROPERTY CORNER OR WITNESS CORNER	NORTHING (ft.)	EASTING (ft.)
CORNER#1	3,962,249.2	1,357,649.7
CORNER#2	3,961,782.6	1,357,651.4
CORNER#3	3,961,783.2	1,358,118.1
WITNESS CORNER#1	3,962,249.9	1,358,086.4
WITNESS CORNER#2	3,962,219.9	1,358,116.5

2002-4

RECORDED - FILED
Fairbanks Recording District

Date 2-4-2002

Time 1:10 PM

Requested By FMSB

Address

- NOTES:**
- This survey does not constitute a subdivision as determined by A.S. 40.15.900(5)
 - Recorded and unrecorded utility easements may exist and do not appear on this record of survey.
 - Rebar not set due to utility pole at NE corner of lease parcel. Set two witness corners to reference the corner.
 - Basis of bearing is recovered monuments of West Addition, Fairwest Subdivision, Plat #64-486, FRD, Recorded 1/24/1964.

SURVEYOR'S CERTIFICATE

I, Michael L. Jokela, professional land surveyor do hereby certify that the record of survey of Lease Tract is a true and correct representation of lands actually surveyed and that the distances and bearings are shown correctly and that all permanent exterior control monuments, all other monuments, and lot corners have been set.



RECORD OF SURVEY

LEASE TRACT - 5 ACRES

LEGAL DESCRIPTION: A 5 acre tract within the NE1/4, Section 18, T. 1S., R. 1W., F.M., Alaska, Fairbanks Recording District

PREPARED FOR: Federal Aviation Administration, Alaska Region
Logistics Division, AAL-59RE
222 West 7th Avenue, #14
Anchorage, Alaska 99513-7587

Fairbanks North Star Borough
PO Box 71267
Fairbanks, Alaska 99707-1267

USKH Architecture • Engineering • Land Surveying • Planning
Anchorage Wasilla Juneau Fairbanks

SCALE: 1"=100'	DRAWN: RCH	DATE: 1/10/02	SHEET OF
FB: 340	CHECKED: MLJ	W.O. 608004	
SURVEYED: 11/2001		DWG. FILE: 6080ROS	

Fairbanks 2002-4