

TOWNSHIPS 9 TO 12 NORTH, RANGES 1 TO 4 WEST, SEWARD MERIDIAN, ALASKA  
PROTRACTED (UNSURVEYED)

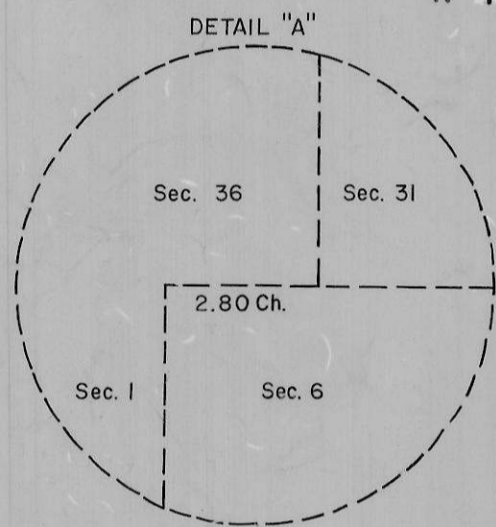

Surveyed See official plats for areas. Unless otherwise shown each Section contains 640 acres. Water area based upon U.S.G.S. quadrangle sheets. Water area computed to nearest five acres. Topography based on USGS quadrangles Tyonek A-1, Kenai D-1, Anchorage A-7, A-8, Seward D-7, D-8

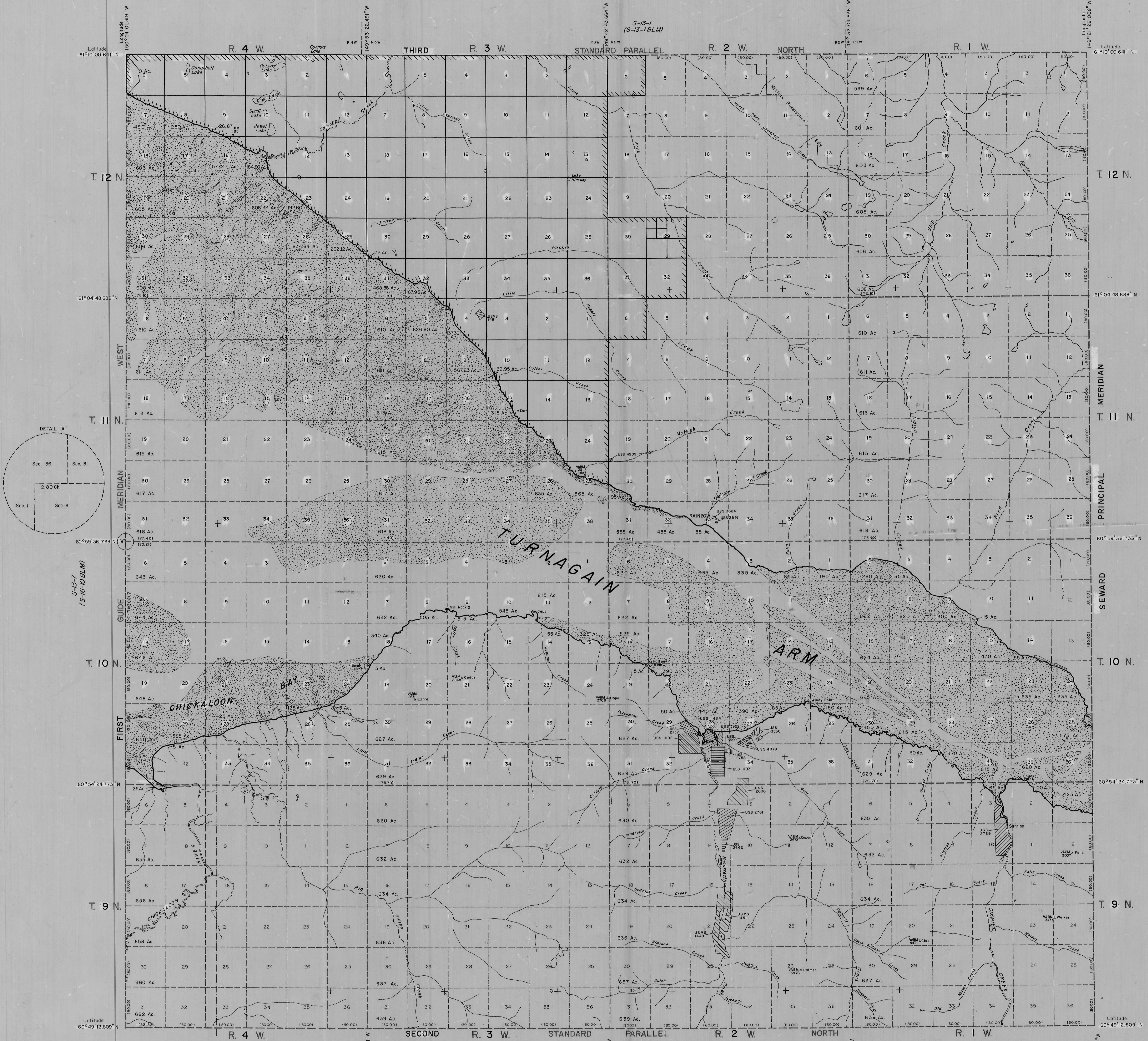
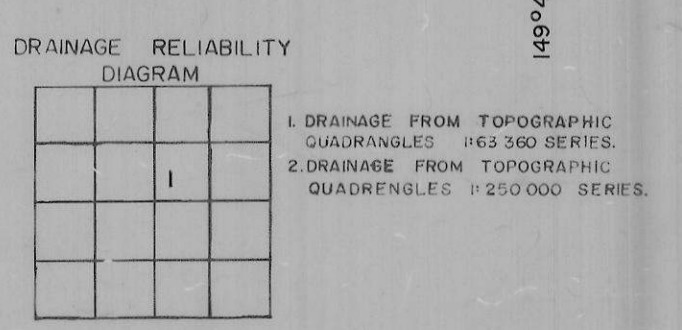

Scale in Chains  
0 40 80 160 240 320

Scale in Kilometers  
0 1 2 3 4 5

1 meter = 32808333 US survey ft.  
1 meter = 0497096 US chain  
1 US acre = 404687 Hectare

STATE OF ALASKA DEPARTMENT OF NATURAL RESOURCES DIVISION OF LANDS ANCHORAGE, ALASKA	
<b>GRID No. S-13-8</b>	
1/22/79 Added sec 29 line for sec 29 of T.12N, R.2W	RLG OS
5/9/72 Protraction Sheet redrawn	DLT <i>RLG</i>
11/0/71 Changed acreage of coastline sections in Twps. 11 & 12 N, Rgs. 3 & 4 W, SM	DLT NI
8/5/69 Added USS 4909 at T.11N, R.2W	FL NI
6/6/69 Added USS 3390 and 4979 at T.10N, R.2W, S.M.	LRE NI
DATE	DRN CK'D APPR
DRWN. BY <b>P.S.C.</b>	APPROVAL RECOMMENDED <b>Edward Yormak</b> Office Engineer
DATE APPROVED: <b>8/30/63</b>	APPROVED: <b>Roscoe E. Bell</b> Director of Lands
SCALE:	CHECKED: <b>Wright</b>
	FILE NO.