

STATE OF ALASKA
DEPARTMENT OF TRANSPORTATION
&
PUBLIC FACILITIES

RECORD OF SURVEY

FERRY ROAD
RIGHT OF WAY

PRELIMINARY

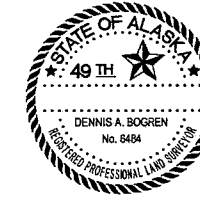

SURVEYOR'S CERTIFICATE

I HEREBY CERTIFY THAT I AM PROPERLY REGISTERED AND LICENSED TO PRACTICE LAND SURVEYING IN THE STATE OF ALASKA, THAT THIS PLAT REPRESENTS A SURVEY MADE BY ME OR UNDER MY DIRECT SUPERVISION, AND THE MONUMENTS SHOWN HEREON ACTUALLY EXIST AS DESCRIBED, AND THAT ALL DIMENSIONS AND OTHER DETAILS ARE CORRECT.

DATE _____ REGISTRATION NO. _____

REGISTERED LAND SURVEYOR

LEGEND

- FOUND PRIMARY MONUMENT
- SET PRIMARY MONUMENT
- FOUND U.S. COAST AND GEODETIC SURVEY MONUMENT
- FOUND BUREAU OF LAND MANAGEMENT MONUMENT
- FOUND GENERAL LAND OFFICE MONUMENT
- SET REBAR AND CAP
- CENTERLINE
- RIGHT-OF-WAY
- SECTION LINE
- SLOPE LIMIT
- 1/4 SECTION LINE

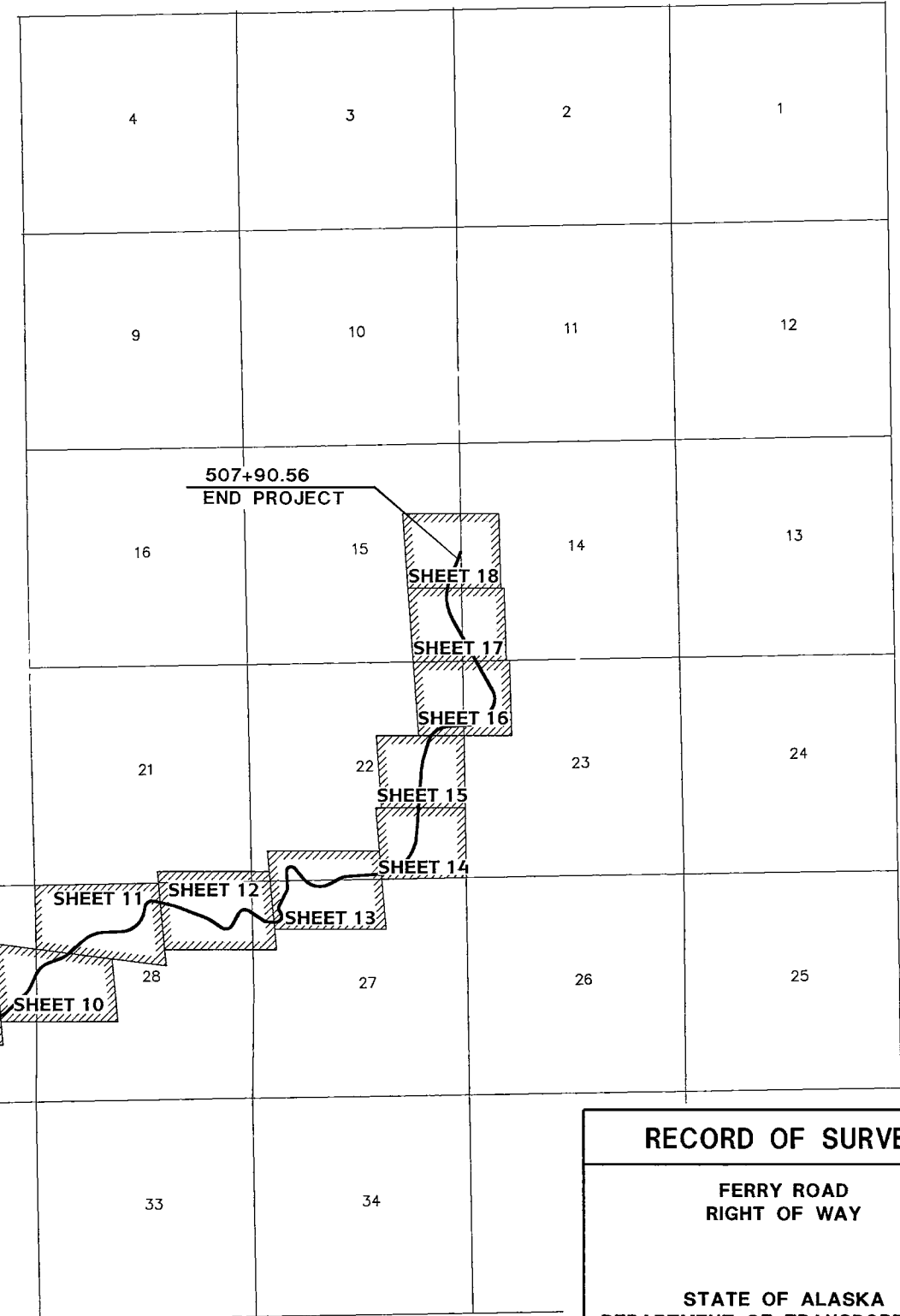

P:\2011\11054FB\2013 Record of Survey\11054FB-ROS-TITLE Set, Dec/21/13 11:09am

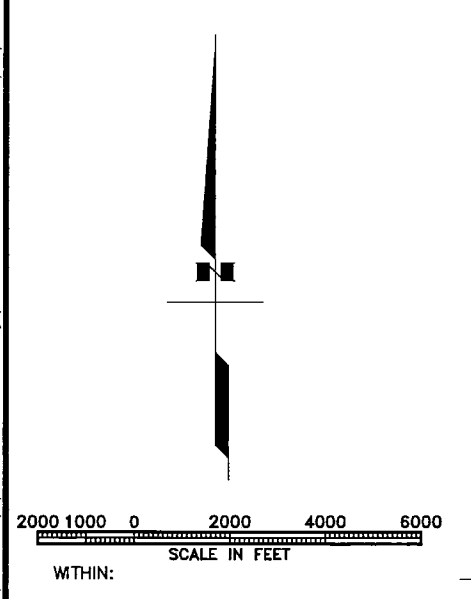

SECTIONS 30,29,28,27,23,22,15,14 T10S R7W FM
SECTIONS 27,26,25 T10S R8W FM

RECORD OF SURVEY

FERRY ROAD
RIGHT OF WAY

STATE OF ALASKA
DEPARTMENT OF TRANSPORTATION
AND
PUBLIC FACILITIES

PLANS DEVELOPED BY PDC, INC.

SCALE: 1"=3000'

TITLE SHEET

P:\2011\1105\FB\2013 Record of Survey\L1105\FB-ROS-SHT1 Sat, Dec/21/13 11:22am

MONUMENTS RECOVERED THIS SURVEY

POINT #	NORTHING	EASTING	DESCRIPTION	STATION	OFFSET
27	3659190.93	1785120.50	2 1/2" BRASS CAP	54+18.65	355.70 RT
205	3664845.88	1808541.77	2 1/4" BRASS CAP	314+18.18	1797.58 LT
206	3664927.58	1813837.58	2 1/2" BRASS CAP	362+50.85	700.70 LT
1504	3661865.06	1787719.82	2 1/2" BRASS CAP	76+12.77	2,362.50 LT
1505	3664658.69	1798224.59	2 1/4" BRASS CAP	196+20.44	3,314.17 LT
1515	3675577.47	1818904.80	2 1/4" BRASS CAP	538+04.41	284.73 RT
1608	3662291.78	1813891.74	2 1/2" BRASS CAP	355+77.98	1,610.96 RT
2202	3659381.96	1798308.96	2 1/2" BRASS CAP	186+77.65	1,871.18 RT
3006	3659472.02	1803372.24	2 1/4" BRASS CAP	233+21.03	2,420.94 RT
3007	3662211.18	1808597.06	2 1/2" BRASS CAP	265+84.79	106.83 LT
3009	3664975.10	1816467.72	2 1/2" BRASS CAP	405+21.84	105.50 RT

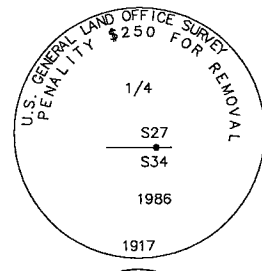

FOUND 2 1/2" BRASS CAP
1.1' ABOVE GROUND

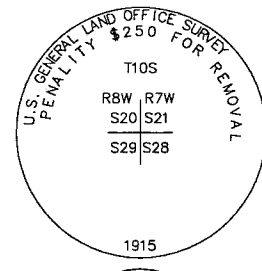

FOUND 2 1/4" BRASS CAP
1.0' ABOVE GROUND

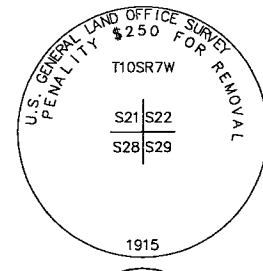

FOUND 2 1/2" BRASS CAP
0.8' ABOVE GROUND

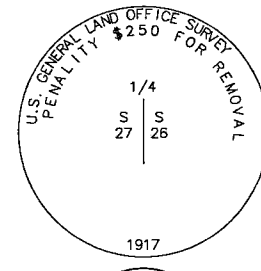

FOUND 2 1/2" BRASS CAP
0.8' ABOVE GROUND LEANS EAST

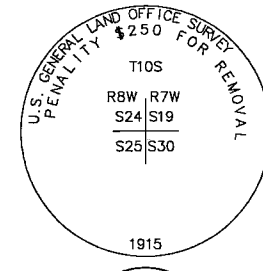

FOUND 2 1/4" BRASS CAP
1.0' ABOVE GROUND

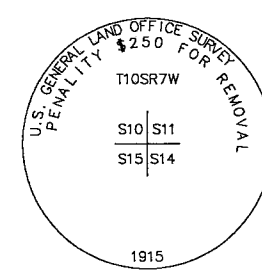
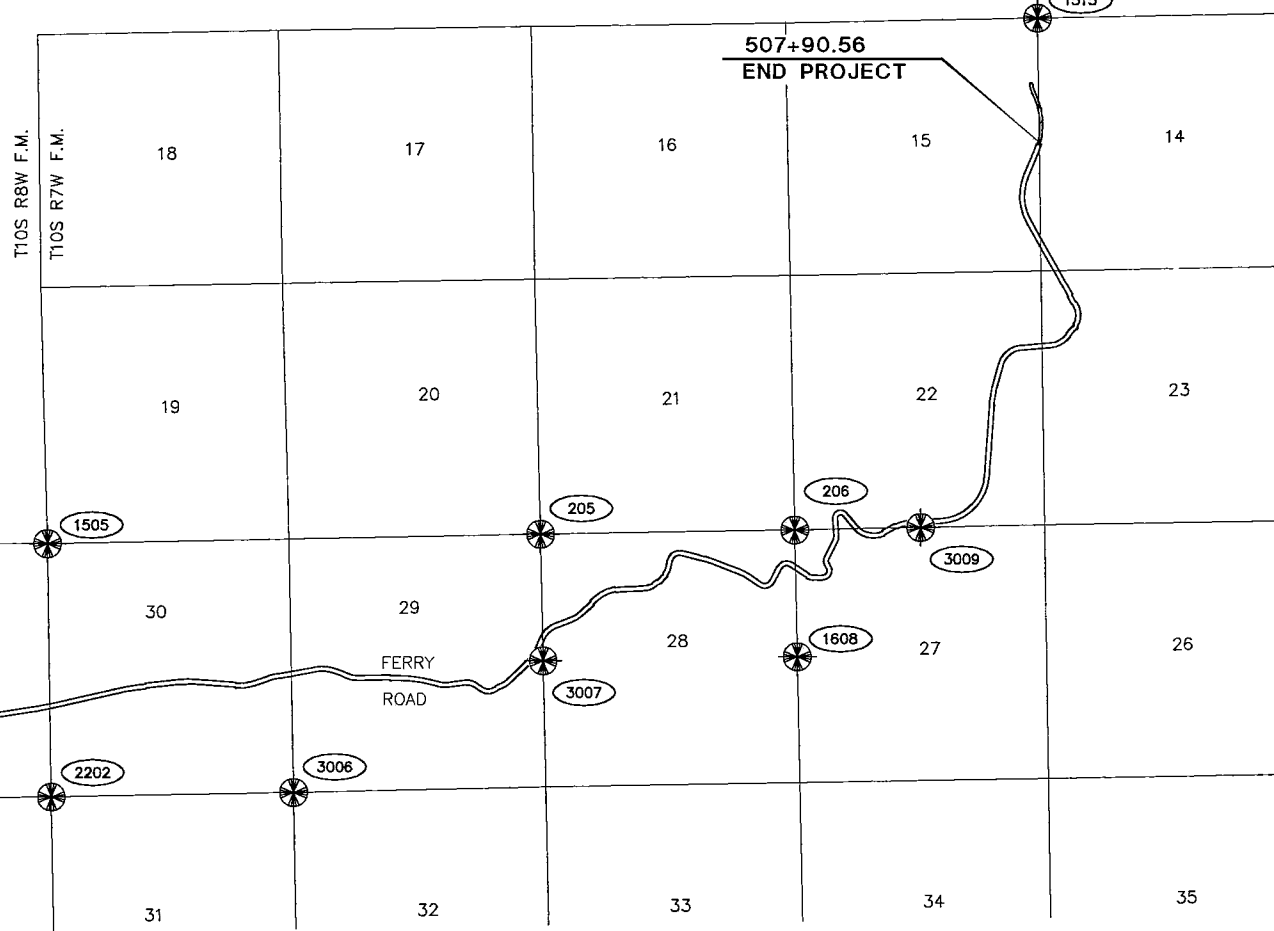

FOUND 2 1/4" BRASS CAP
1.3' ABOVE GROUND LEANS SOUTH

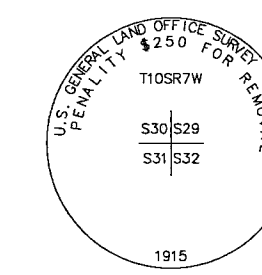

FOUND 2 1/4" BRASS CAP
1.2' ABOVE GROUND LEANS EAST

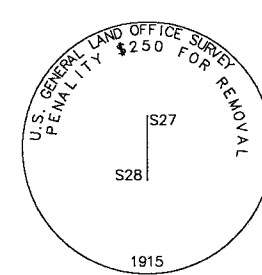

FOUND 2 1/2" BRASS CAP
1.7' ABOVE GROUND

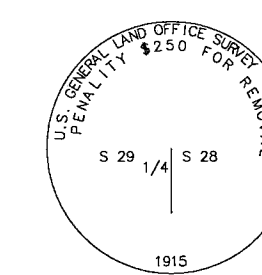

FOUND 2 1/2" BRASS CAP IN
POOR CONDITION

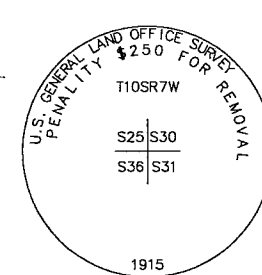

FOUND 2 1/2" BRASS CAP
0.4' ABOVE GROUND

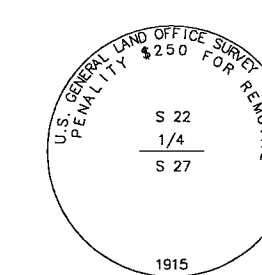

FOUND 2 1/2" BRASS CAP 1.0'
ABOVE GROUND

CONTROL TABLE

POINT #	NORTHING	EASTING	DESCRIPTION	STATION	OFFSET
25	3647281.66	1780440.76	3 1/2" NGS BRASS CAP "FERRY"	45+88.36	12,748.93 RT
551*	3657303.90	1781521.94	3 1/2" NGS BRASS CAP "STEEL"	38+08.95	3,292.60 RT

*SET/VERIFIED IN 2012

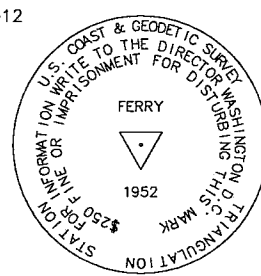

FOUND 3 1/2" BRASS CAP 0.3'
ABOVE GROUND

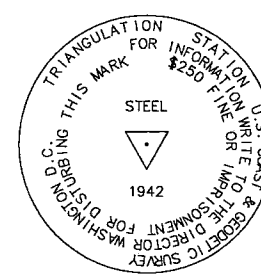

FOUND 3 1/2" BRASS CAP IN
CONCRETE FLUSH WITH GROUND

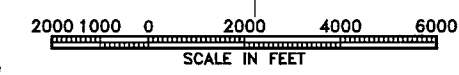

SCALE IN FEET

RECORD OF SURVEY

**FERRY ROAD
RIGHT OF WAY**

**STATE OF ALASKA
DEPARTMENT OF TRANSPORTATION
AND
PUBLIC FACILITIES**

SCALE: 1"=2000'

SHEET 1 OF 18

C:\Users\nickesposito\opdata\temp\AcPublish\3104\11054FB-RDS-SHT2 Thu, Dec/05/13 04:33pm

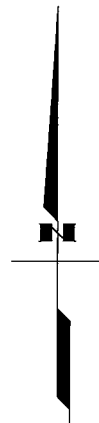
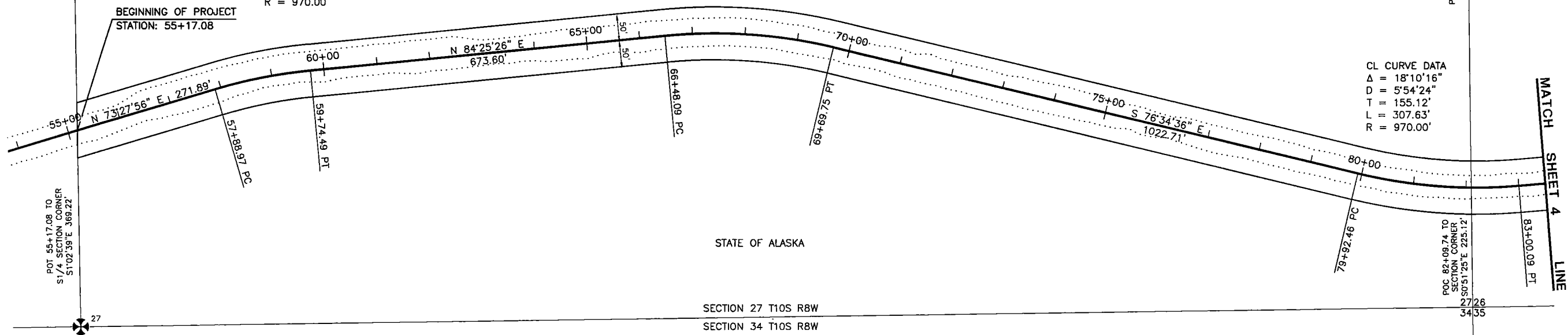

RECORD OF SURVEY

**FERRY ROAD
 RIGHT OF WAY**

**STATE OF ALASKA
 DEPARTMENT OF TRANSPORTATION
 AND
 PUBLIC FACILITIES**

SCALE: 1"=100' SHEET 2 OF 20

C:\Users\nickesposi\opdata\locatemp\AcPublish_3104\11054FB-R05-SHT3_Thu, Dec/05/13 04:33pm

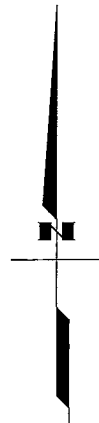

STATE OF ALASKA

CL CURVE DATA
 $\Delta = 23^{\circ}24'36''$
 $D = 5^{\circ}54'24''$
 $T = 200.97'$
 $L = 396.32'$
 $R = 970.00'$

MATCH SHEET 5 LINE

MATCH SHEET 3 LINE

SET PRIMARY MONUMENT WITH 9/16" STAINLESS STEEL ROD IN 4" PVC

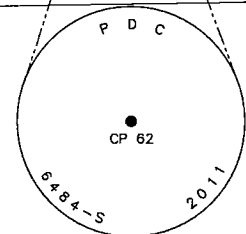

SET ALUMINUM SECONDARY MONUMENT WITH 1 1/2" CAP FLUSH WITH GROUND

SECTION 27 T10S R8W
 SECTION 34 T10S R8W

STATE OF ALASKA

CL CURVE DATA
 $\Delta = 27^{\circ}28'17''$
 $D = 5^{\circ}54'24''$
 $T = 237.10'$
 $L = 465.08'$
 $R = 970.00'$

MONUMENTS SET THIS SURVEY

POINT #	NORTHING	EASTING	DESCRIPTION	STATION	OFFSET
15	3659545.34	1788437.19	9/16" STAINLESS STEEL ROD	90+06.99	35.54 LT
62	3659466.04	1788439.36	1 1/2" ALUMINUM CAP	88+92.10	38.88 RT

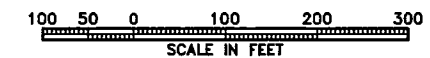

RECORD OF SURVEY

FERRY ROAD
 RIGHT OF WAY

STATE OF ALASKA
 DEPARTMENT OF TRANSPORTATION
 AND
 PUBLIC FACILITIES

SCALE: 1"=100'

SHEET 3 OF 18

STATE OF ALASKA

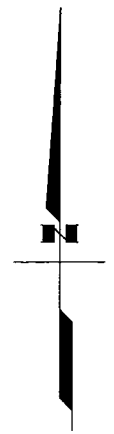

SET ALUMINUM SECONDARY MONUMENT
WITH 1 1/2" CAP
FLUSH WITH GROUND

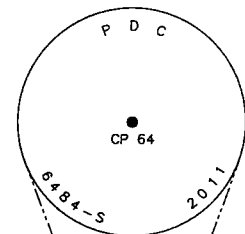

CL CURVE DATA
Δ = 2°25'50"
D = 0°36'28"
T = 200.03'
L = 400.00'
R = 9428.80'

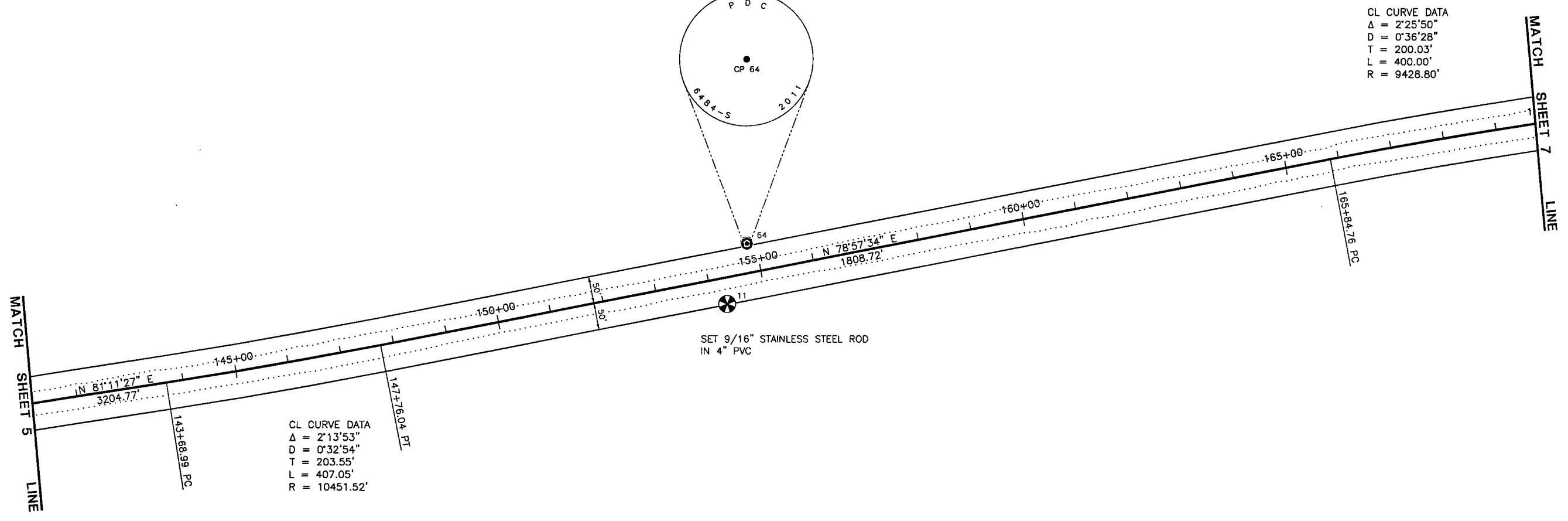

SET 9/16" STAINLESS STEEL ROD
IN 4" PVC

STATE OF ALASKA

MONUMENTS SET THIS SURVEY

POINT #	NORTHING	EASTING	DESCRIPTION	STATION	OFFSET
11	3660640.21	1794830.75	9/16" STAINLESS STEEL ROD	154+26.54	48.83 RT
64	3660752.36	1794867.10	1 1/2" ALUMINUM CAP	154+83.69	54.28 LT



RECORD OF SURVEY

FERRY ROAD
RIGHT OF WAY

STATE OF ALASKA
DEPARTMENT OF TRANSPORTATION
AND
PUBLIC FACILITIES

SCALE: 1"=100' SHEET 5 OF 18

C:\Users\nickespositio\appdata\local\temp\AcPublish_3104\11054FB-R05-SHT5 Thu, Dec/05/13 04:34pm

C:\Users\nickesposito\AppData\Local\Temp\AcPublish_3104\L11054FB-R05-SHF16_Thu, Dec/05/13 04:34pm

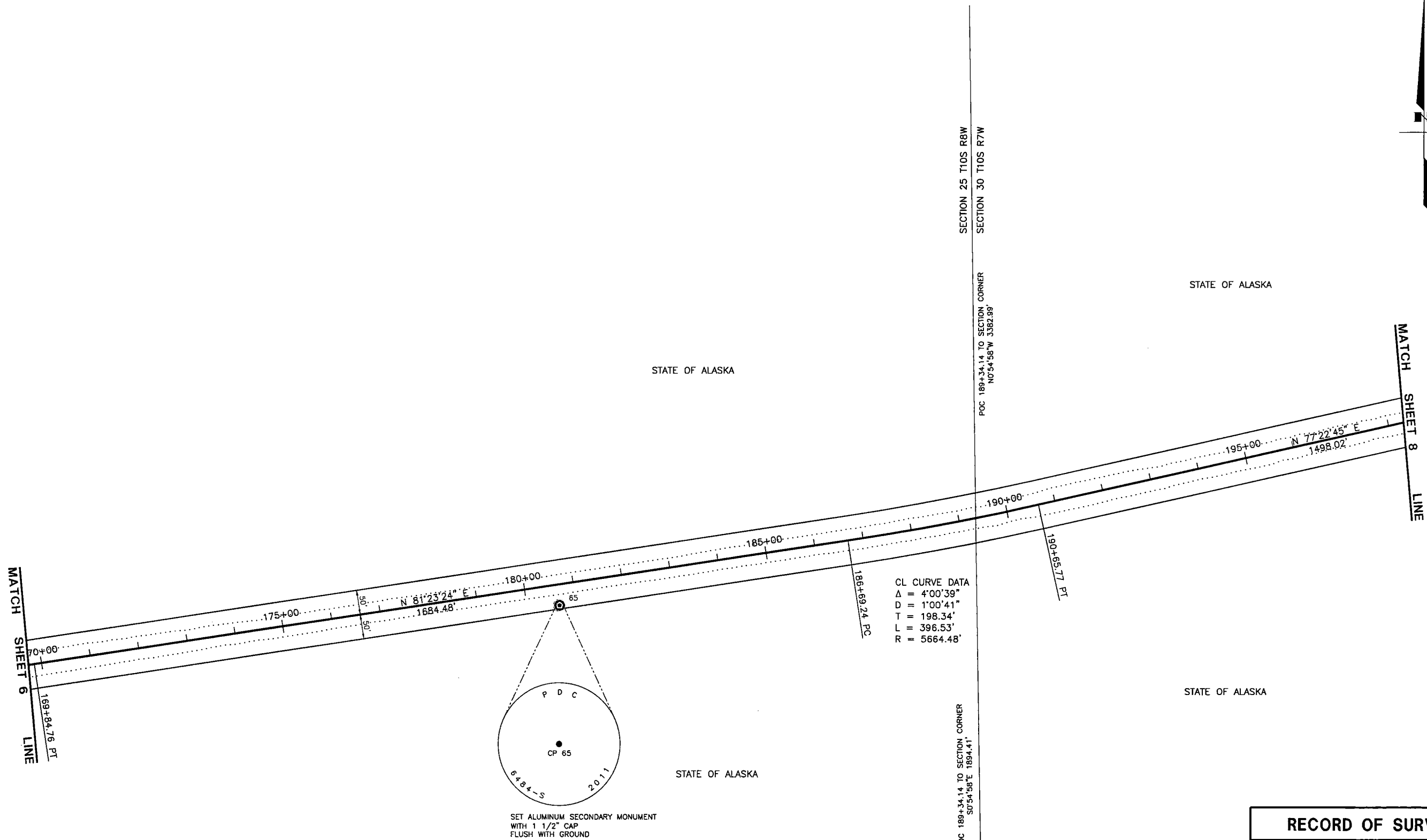
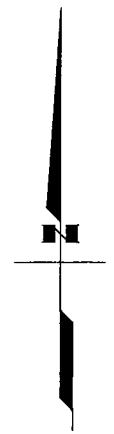

CL CURVE DATA
 $\Delta = 4^{\circ}00'39''$
 $D = 1^{\circ}00'41''$
 $T = 198.34'$
 $L = 396.53'$
 $R = 5664.48'$

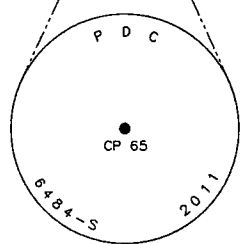

SET ALUMINUM SECONDARY MONUMENT
 WITH 1 1/2" CAP
 FLUSH WITH GROUND

MONUMENTS SET THIS SURVEY					
POINT #	NORTHING	EASTING	DESCRIPTION	STATION	OFFSET
65	3661097.88	1797427.56	1 1/2" ALUMINUM CAP	180+65.83	42.63 RT

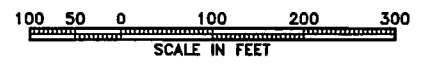

RECORD OF SURVEY

**FERRY ROAD
RIGHT OF WAY**

**STATE OF ALASKA
DEPARTMENT OF TRANSPORTATION
AND
PUBLIC FACILITIES**

SCALE: 1"=100' SHEET 6 OF 18

C:\Users\nickesposito\appdata\local\temp\AcPublish_3104\11054FB-R05-SH17 Thu, Dec/05/13 04:34pm



STATE OF ALASKA

SET ALUMINUM SECONDARY MONUMENT
WITH 1 1/2" CAP
FLUSH WITH GROUND

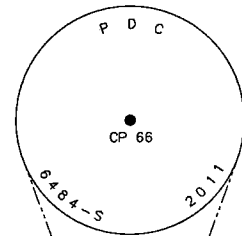

CL CURVE DATA
Δ = 6°36'00"
D = 2'40'17"
T = 123.66'
L = 247.05'
R = 2144.69'

SET 9/16" STAINLESS
STEEL ROD IN 4" PVC

CL CURVE DATA
Δ = 10°18'11"
D = 3'04'53"
T = 167.64'
L = 334.37'
R = 1859.42'

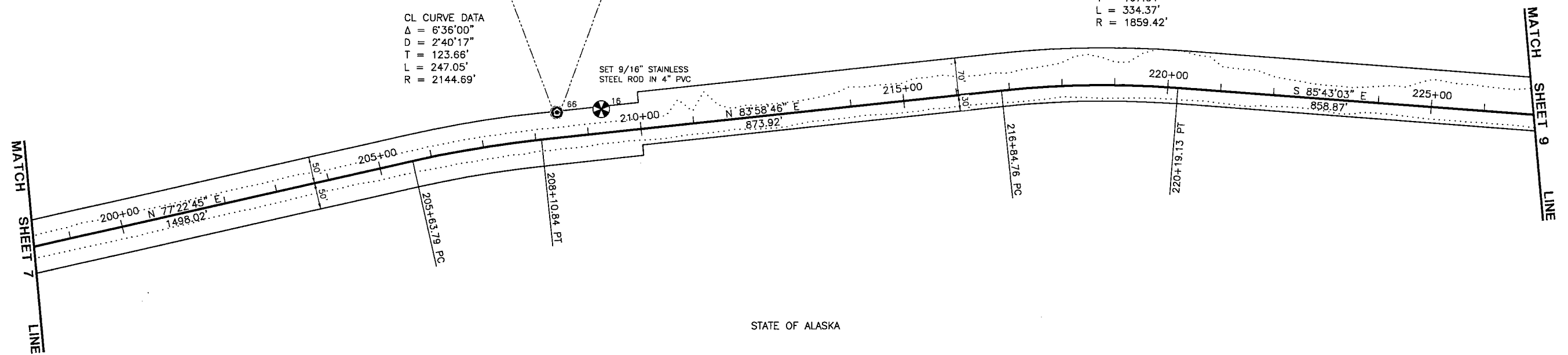

STATE OF ALASKA

MONUMENTS SET THIS SURVEY

POINT #	NORTHING	EASTING	DESCRIPTION	STATION	OFFSET
16	3661727.79	1800226.29	9/16" STAINLESS STEEL ROD	209+29.57	44.88 LT
66	3661721.68	1800142.23	1 1/2" ALUMINUM CAP	208+45.33	47.62 LT

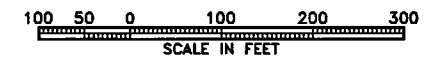

RECORD OF SURVEY

FERRY ROAD
RIGHT OF WAY

STATE OF ALASKA
DEPARTMENT OF TRANSPORTATION
AND
PUBLIC FACILITIES

SCALE: 1"=100'

SHEET 7 OF 18

C:\Users\nickesposito\appdata\local\temp\AcPublish_3104\11054FB-R05-SHT8_Thu, Dec/05/13 04:34pm

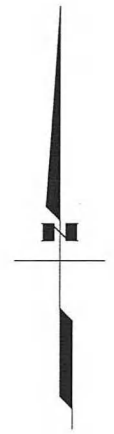

STATE OF ALASKA

STATE OF ALASKA

SECTION 30 T10S R7W
SECTION 29 T10S R7W

POT 240+63.33 TO SECTION CORNER POSITION
N1°04'14"W 2803.81'

POT 240+63.33 TO SECTION CORNER
S1°04'14"E 2475.39'

MATCH SHEET 8 LINE

MATCH SHEET 10 LINE

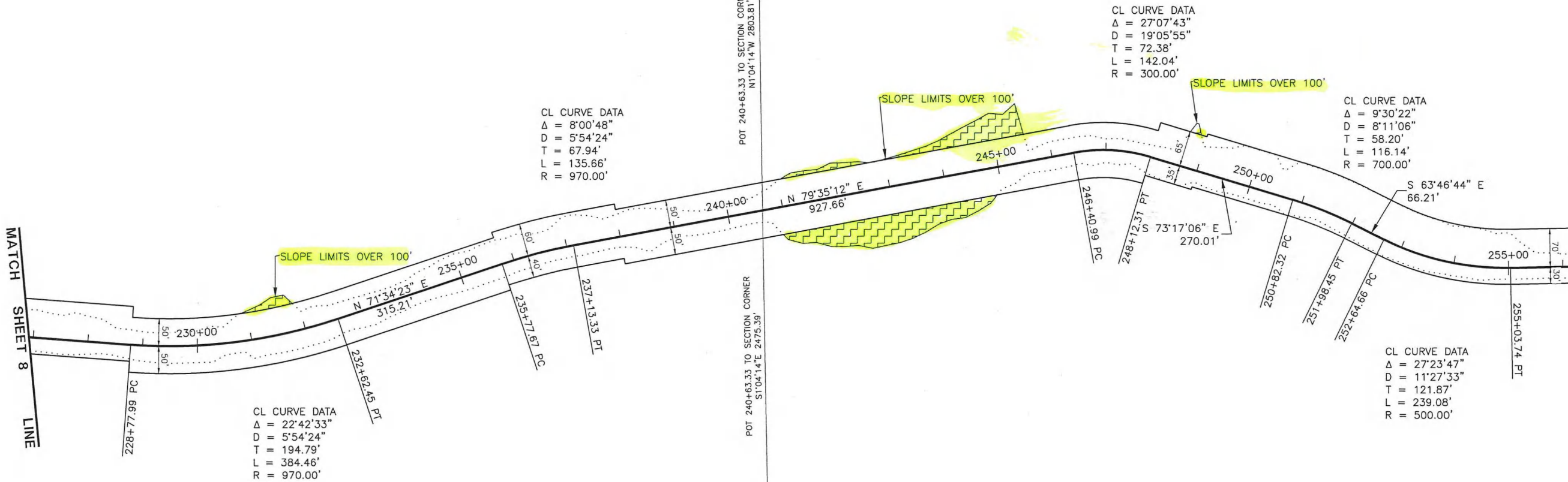

CL CURVE DATA
 $\Delta = 8^{\circ}00'48''$
 $D = 5'54'24''$
 $T = 67.94'$
 $L = 135.66'$
 $R = 970.00'$

CL CURVE DATA
 $\Delta = 27^{\circ}07'43''$
 $D = 19^{\circ}05'55''$
 $T = 72.38'$
 $L = 142.04'$
 $R = 300.00'$

CL CURVE DATA
 $\Delta = 9^{\circ}30'22''$
 $D = 8^{\circ}11'06''$
 $T = 58.20'$
 $L = 116.14'$
 $R = 700.00'$

CL CURVE DATA
 $\Delta = 22^{\circ}42'33''$
 $D = 5'54'24''$
 $T = 194.79'$
 $L = 384.46'$
 $R = 970.00'$

CL CURVE DATA
 $\Delta = 27^{\circ}23'47''$
 $D = 11^{\circ}27'33''$
 $T = 121.87'$
 $L = 239.08'$
 $R = 500.00'$

STATE OF ALASKA

STATE OF ALASKA

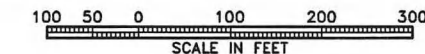

RECORD OF SURVEY	
FERRY ROAD RIGHT OF WAY	
STATE OF ALASKA DEPARTMENT OF TRANSPORTATION AND PUBLIC FACILITIES	
SCALE: 1"=100'	SHEET 8 OF 18

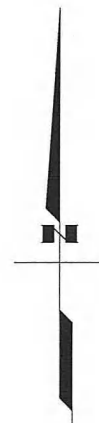

SET ALUMINUM SECONDARY MONUMENT
WITH 1 1/2" CAP
FLUSH WITH GROUND

STATE OF ALASKA

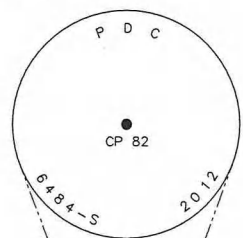

CL CURVE DATA
Δ = 16°10'15"
D = 1°54'35"
T = 426.19'
L = 846.71'
R = 3000.00'

CL CURVE DATA
Δ = 41°32'49"
D = 19°05'55"
T = 113.80'
L = 217.54'
R = 300.00'

CL CURVE DATA
Δ = 21°53'41"
D = 19°05'55"
T = 58.03'
L = 114.64'
R = 300.00'

CL CURVE DATA
Δ = 58°39'19"
D = 23°52'24"
T = 134.83'
L = 245.69'
R = 240.00'

SLOPE LIMITS OVER 100'

MATCH SHEET 9 LINE

MATCH SHEET 11 LINE

STATE OF ALASKA

MONUMENTS SET THIS SURVEY

POINT #	NORTHING	EASTING	DESCRIPTION	STATION	OFFSET
82	3661955.17	1805781.31	1 1/2" ALUMINUM CAP	265+84.79	106.83 LT

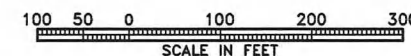

RECORD OF SURVEY

FERRY ROAD
RIGHT OF WAY

STATE OF ALASKA
DEPARTMENT OF TRANSPORTATION
AND
PUBLIC FACILITIES

SCALE: 1"=100'

SHEET 9 OF 18

20
29

SECTION 29 T10S R7W
SECTION 28 T10S R7W

SECTION 21 T10S R7W
SECTION 28 T10S R7W

MONUMENTS SET THIS SURVEY					
POINT #	NORTHING	EASTING	DESCRIPTION	STATION	OFFSET
17	3663849.74	1811064.32	9/16" STAINLESS STEEL ROD	328+31.17	32.51 RT
31	3663870.55	1811523.80	3 1/4" ALUMINUM CAP	330+46.18	395.25 RT
67	3663849.20	1811103.66	1 1/2" ALUMINUM CAP	328+56.88	60.45 RT

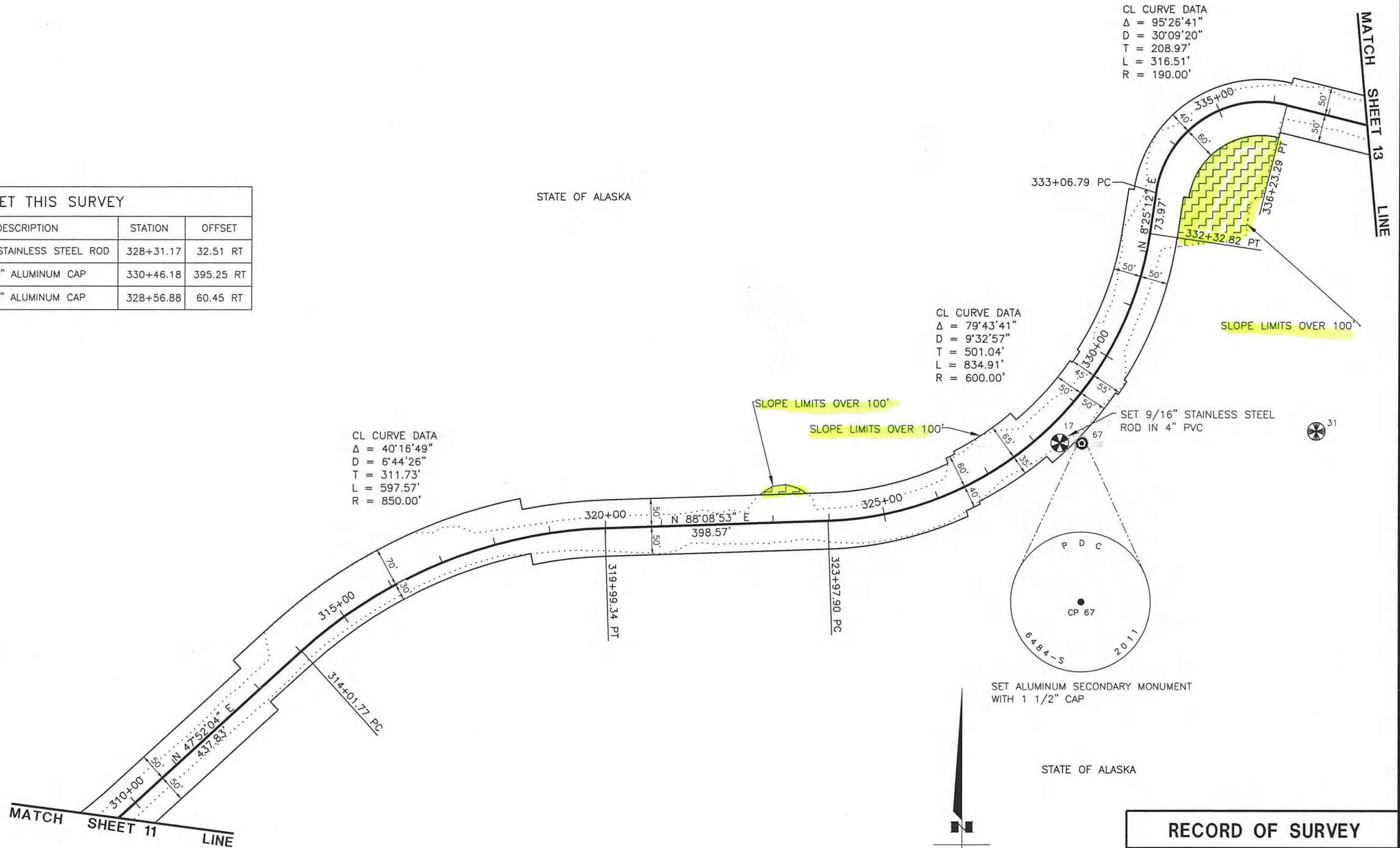

RECORD OF SURVEY	
FERRY ROAD RIGHT OF WAY	
STATE OF ALASKA DEPARTMENT OF TRANSPORTATION AND PUBLIC FACILITIES	
SCALE: 1"=100'	SHEET 11 OF 18

C:\Users\nickesposito\appdata\local\temp\AcPublish_3704\L11054FB-RCS-SHT12_Thu, Dec/05/13 04:34pm

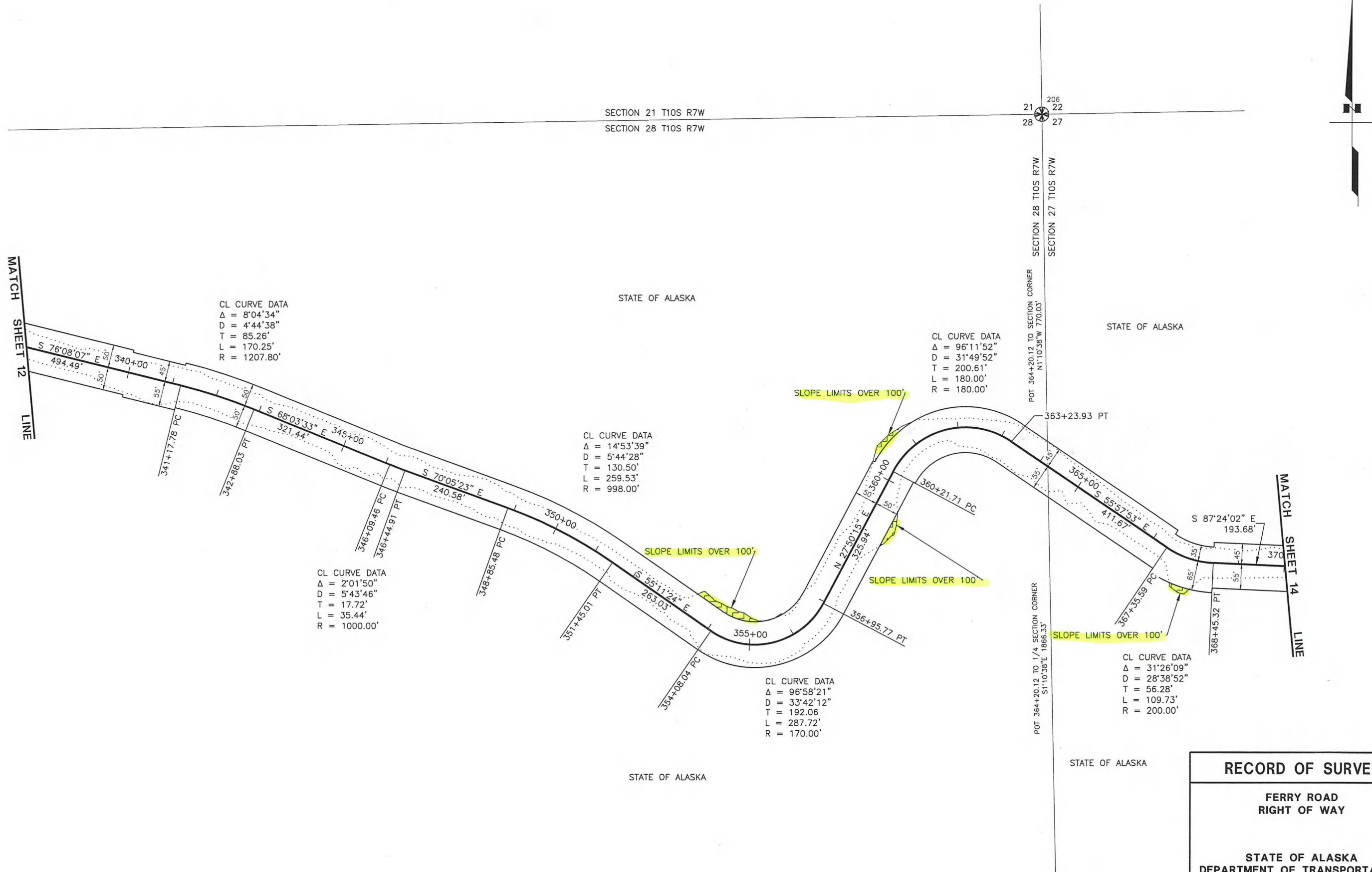

CL CURVE DATA
 $\Delta = 8^{\circ}04'34''$
 $D = 4'44'38''$
 $T = 85.26'$
 $L = 170.25'$
 $R = 1207.80'$

CL CURVE DATA
 $\Delta = 14^{\circ}53'39''$
 $D = 5'44'28''$
 $T = 130.50'$
 $L = 259.53'$
 $R = 998.00'$

CL CURVE DATA
 $\Delta = 96^{\circ}11'52''$
 $D = 31'49'52''$
 $T = 200.61'$
 $L = 180.00'$
 $R = 180.00'$

CL CURVE DATA
 $\Delta = 2^{\circ}01'50''$
 $D = 5'43'46''$
 $T = 17.72'$
 $L = 35.44'$
 $R = 1000.00'$

CL CURVE DATA
 $\Delta = 96^{\circ}58'21''$
 $D = 33'42'12''$
 $T = 192.06'$
 $L = 287.72'$
 $R = 170.00'$

CL CURVE DATA
 $\Delta = 31^{\circ}26'09''$
 $D = 28'38'52''$
 $T = 56.28'$
 $L = 109.73'$
 $R = 200.00'$

SECTION 21 T10S R7W
 SECTION 28 T10S R7W

21 206
 28 22
 27

SECTION 28 T10S R7W
 SECTION 27 T10S R7W

POT 364+20.12 TO SECTION CORNER
 $N11^{\circ}10'38''W$ 770.03'

POT 364+20.12 TO 1/4 SECTION CORNER
 $S11^{\circ}10'38''E$ 1866.33'

363+23.93 PT

SLOPE LIMITS OVER 100%

SLOPE LIMITS OVER 100%

SLOPE LIMITS OVER 100%

SLOPE LIMITS OVER 100%

STATE OF ALASKA

STATE OF ALASKA

STATE OF ALASKA

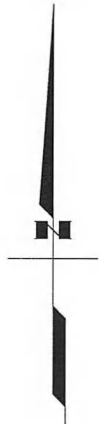

MATCH SHEET 12 LINE

MATCH SHEET 14 LINE

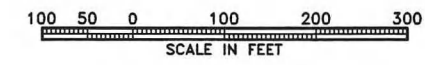

RECORD OF SURVEY

FERRY ROAD
 RIGHT OF WAY

STATE OF ALASKA
 DEPARTMENT OF TRANSPORTATION
 AND
 PUBLIC FACILITIES

SCALE: 1"=100' SHEET 12 OF 18

CL CURVE DATA
 $\Delta = 144^{\circ}14'45''$
 $D = 49^{\circ}49'21''$
 $T = 356.53'$
 $L = 289.52'$
 $R = 115.00'$

CL CURVE DATA
 $\Delta = 24^{\circ}19'01''$
 $D = 14^{\circ}19'26''$
 $T = 86.18'$
 $L = 169.76'$
 $R = 400.00'$

CL CURVE DATA
 $\Delta = 31^{\circ}05'49''$
 $D = 28^{\circ}38'52''$
 $T = 55.65'$
 $L = 108.55'$
 $R = 200.00'$

CL CURVE DATA
 $\Delta = 79^{\circ}03'05''$
 $D = 11^{\circ}27'33''$
 $T = 409.20'$
 $L = 685.87'$
 $R = 500.00'$

CL CURVE DATA
 $\Delta = 56^{\circ}22'21''$
 $D = 44^{\circ}04'25''$
 $T = 69.67'$
 $L = 127.91'$
 $R = 130.00'$

CL CURVE DATA
 $\Delta = 56^{\circ}22'21''$
 $D = 44^{\circ}04'25''$
 $T = 69.67'$
 $L = 127.91'$
 $R = 130.00'$

CL CURVE DATA
 $\Delta = 121^{\circ}52'30''$
 $D = 39^{\circ}30'52''$
 $T = 260.91'$
 $L = 308.43'$
 $R = 145.00'$

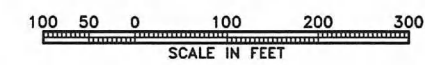
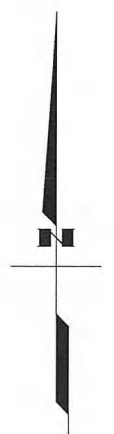
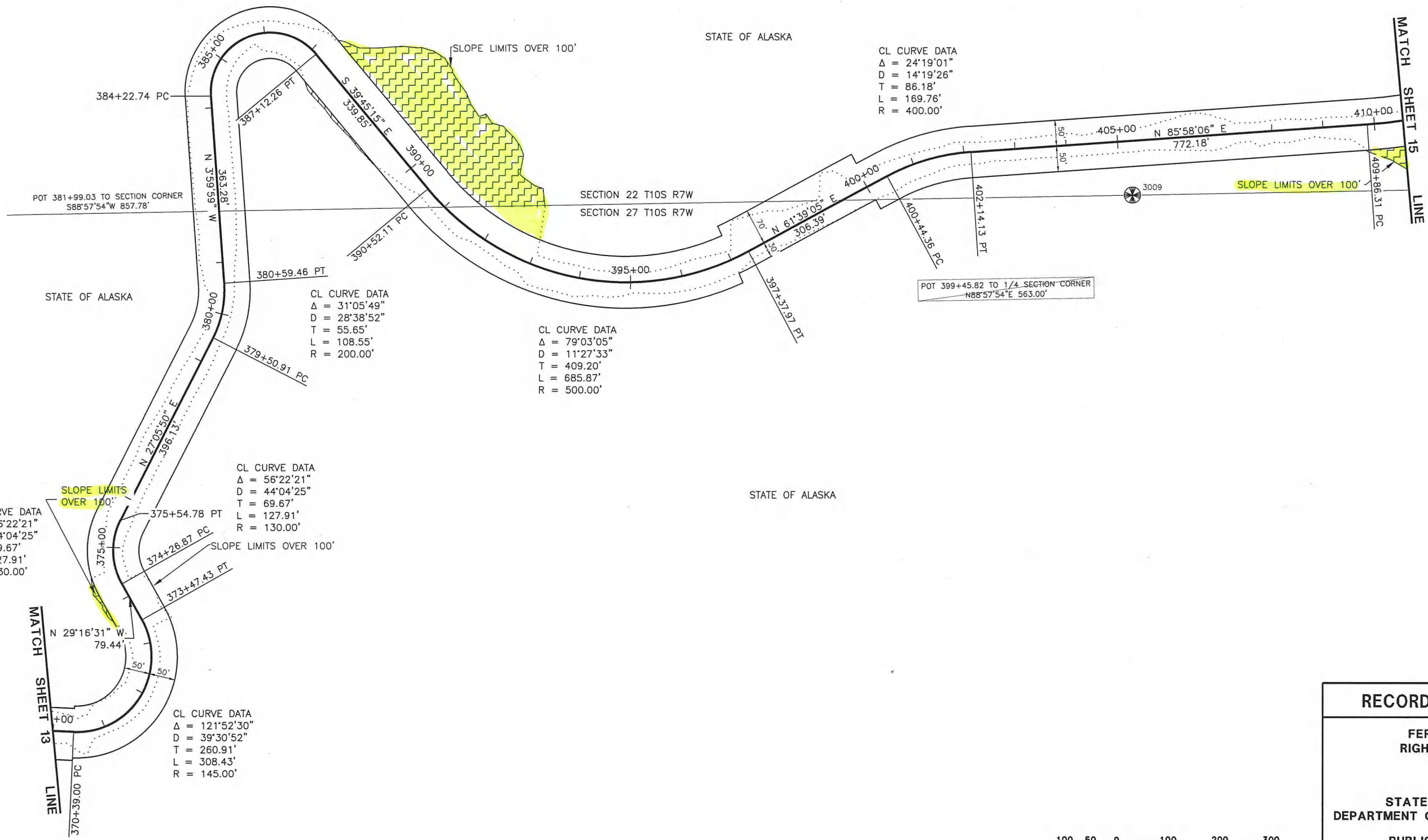

RECORD OF SURVEY

FERRY ROAD
 RIGHT OF WAY

STATE OF ALASKA
 DEPARTMENT OF TRANSPORTATION
 AND
 PUBLIC FACILITIES

SCALE: 1"=100' SHEET 13 OF 18

C:\Users\nickesposito\appdata\local\temp\AcP\publish_3104\11054FB-R05-SHT13_Thu, Dec/05/13 04:34pm

C:\Users\nickesposito\appdata\local\temp\AcPublish_3104\L11054FB-R05-SHT14_Thu, Dec/05/13 04:34pm

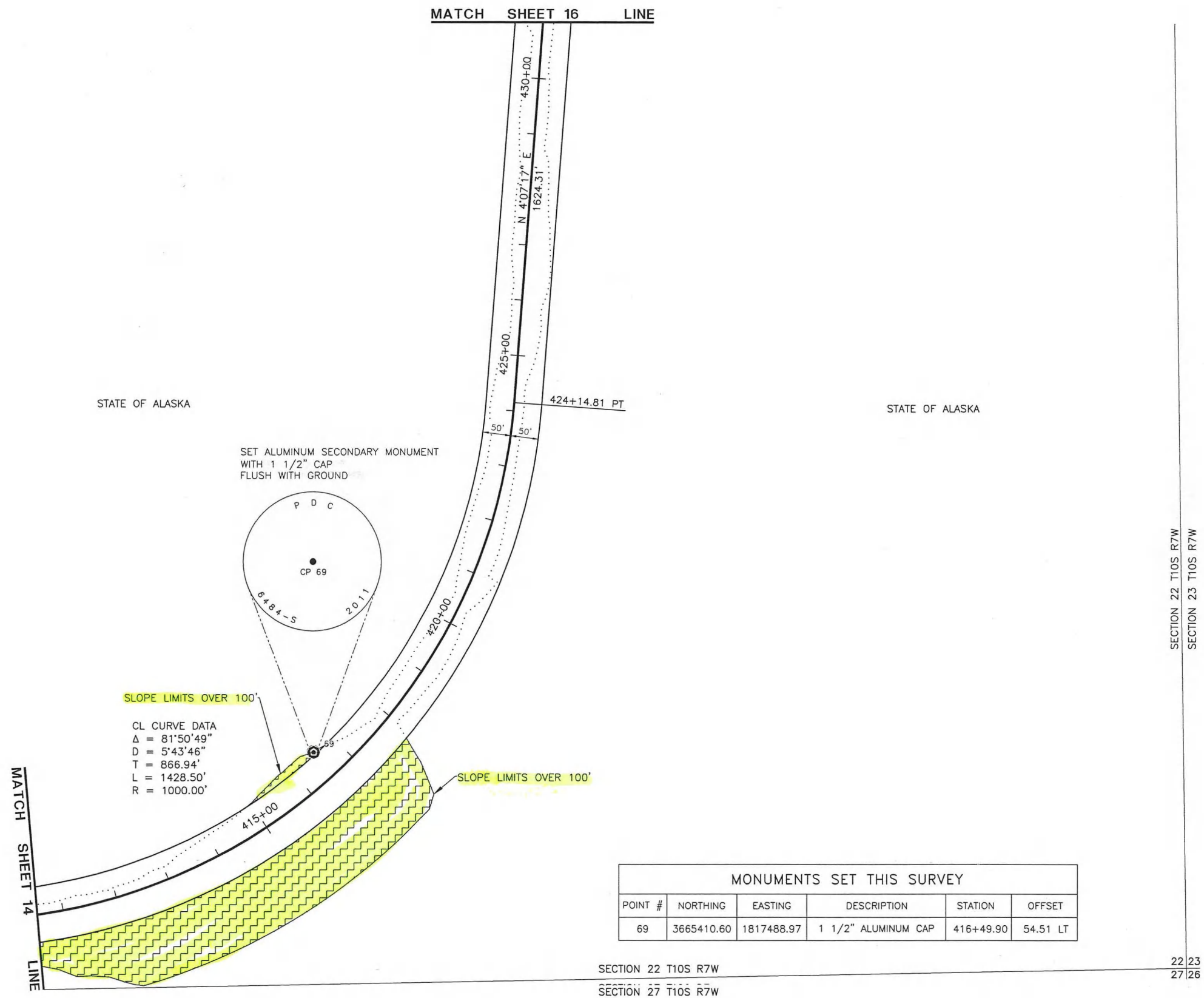

MONUMENTS SET THIS SURVEY					
POINT #	NORTHING	EASTING	DESCRIPTION	STATION	OFFSET
69	3665410.60	1817488.97	1 1/2" ALUMINUM CAP	416+49.90	54.51 LT

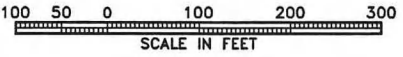

RECORD OF SURVEY	
FERRY ROAD RIGHT OF WAY	
STATE OF ALASKA DEPARTMENT OF TRANSPORTATION AND PUBLIC FACILITIES	
SCALE: 1"=100'	SHEET 14 OF 18

C:\Users\nickesposito\appdata\local\temp\AcPublish_3104\L11054FB-R0S-SHT15_Thu, Dec/05/13 04:34pm

MATCH SHEET 17 LINE

SLOPE LIMITS OVER 100'

CL CURVE DATA
Δ = 12°05'52"
D = 5'38'57"
T = 107.47'
L = 214.15'
R = 1014.23'

STATE OF ALASKA

STATE OF ALASKA

MATCH SHEET 15 LINE

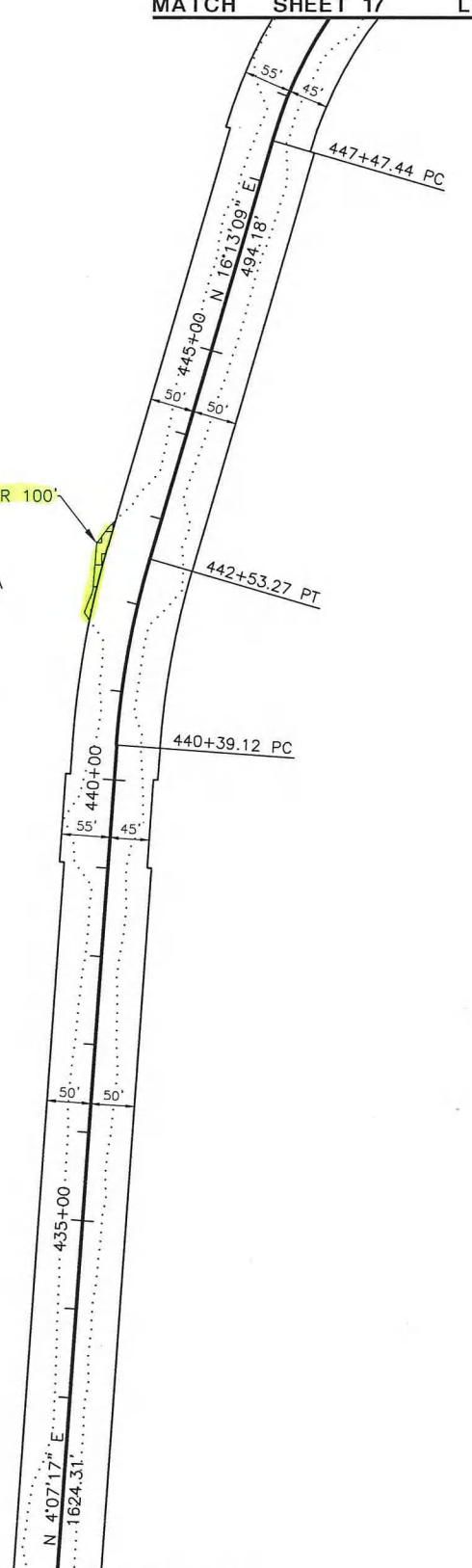

SECTION 22 T10S R7W
SECTION 23 T10S R7W

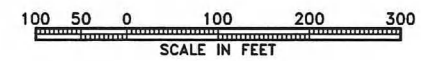
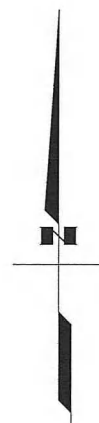

RECORD OF SURVEY

FERRY ROAD
RIGHT OF WAY

STATE OF ALASKA
DEPARTMENT OF TRANSPORTATION
AND
PUBLIC FACILITIES

SCALE: 1"=100'

SHEET 15 OF 18

C:\Users\nickesposito\appdata\local\temp\AcPublish_3104\L11054FB--ROS-SHT16_Thu, Dec/05/13_04:34pm

MONUMENTS SET THIS SURVEY					
POINT #	NORTHING	EASTING	DESCRIPTION	STATION	OFFSET
18	3668804.73	1818893.73	9/16" STAINLESS STEEL ROD	456+65.42	77.40 LT
83	3668679.58	1818904.57	1 1/2" ALUMINUM CAP	456+66.30	48.22 RT

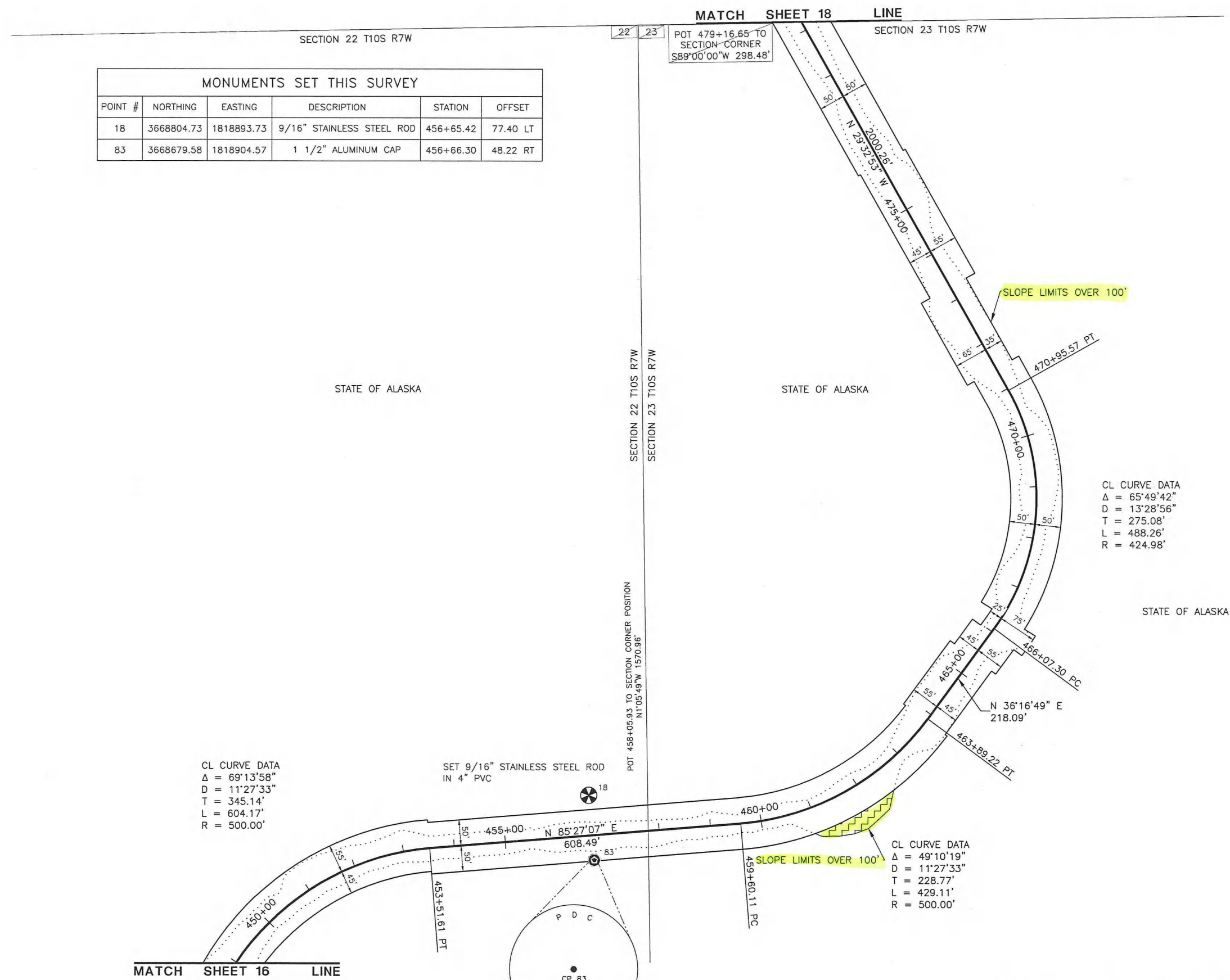

CL CURVE DATA
 $\Delta = 69^{\circ}13'58''$
 $D = 11^{\circ}27'33''$
 $T = 345.14'$
 $L = 604.17'$
 $R = 500.00'$

SET 9/16" STAINLESS STEEL ROD
 IN 4" PVC

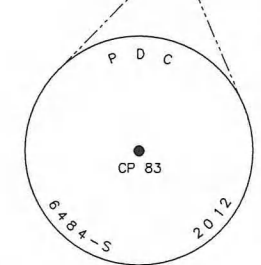

SET ALUMINUM SECONDARY MONUMENT
 WITH 1 1/2" CAP
 FLUSH WITH GROUND

CL CURVE DATA
 $\Delta = 49^{\circ}10'19''$
 $D = 11^{\circ}27'33''$
 $T = 228.77'$
 $L = 429.11'$
 $R = 500.00'$

CL CURVE DATA
 $\Delta = 65^{\circ}49'42''$
 $D = 13^{\circ}28'56''$
 $T = 275.08'$
 $L = 488.26'$
 $R = 424.98'$

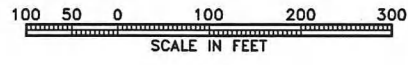

RECORD OF SURVEY

**FERRY ROAD
RIGHT OF WAY**

**STATE OF ALASKA
DEPARTMENT OF TRANSPORTATION
AND
PUBLIC FACILITIES**

SCALE: 1"=100' SHEET 16 OF 18

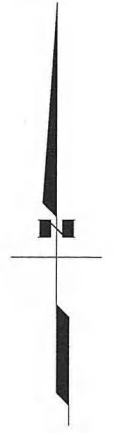

C:\Users\nickespoita\appdata\local\temp\AcPublish_310A\L11054FB-ROS-SHT17 Thu, Dec/05/13 04:34pm

MATCH SHEET 19 LINE

CL CURVE DATA
Δ = 52°20'35"
D = 5'18'22"
T = 530.65'
L = 986.45'
R = 1079.79'

STATE OF ALASKA

STATE OF ALASKA

STATE OF ALASKA

SECTION 15 T10S R7W
SECTION 14 T10S R7W

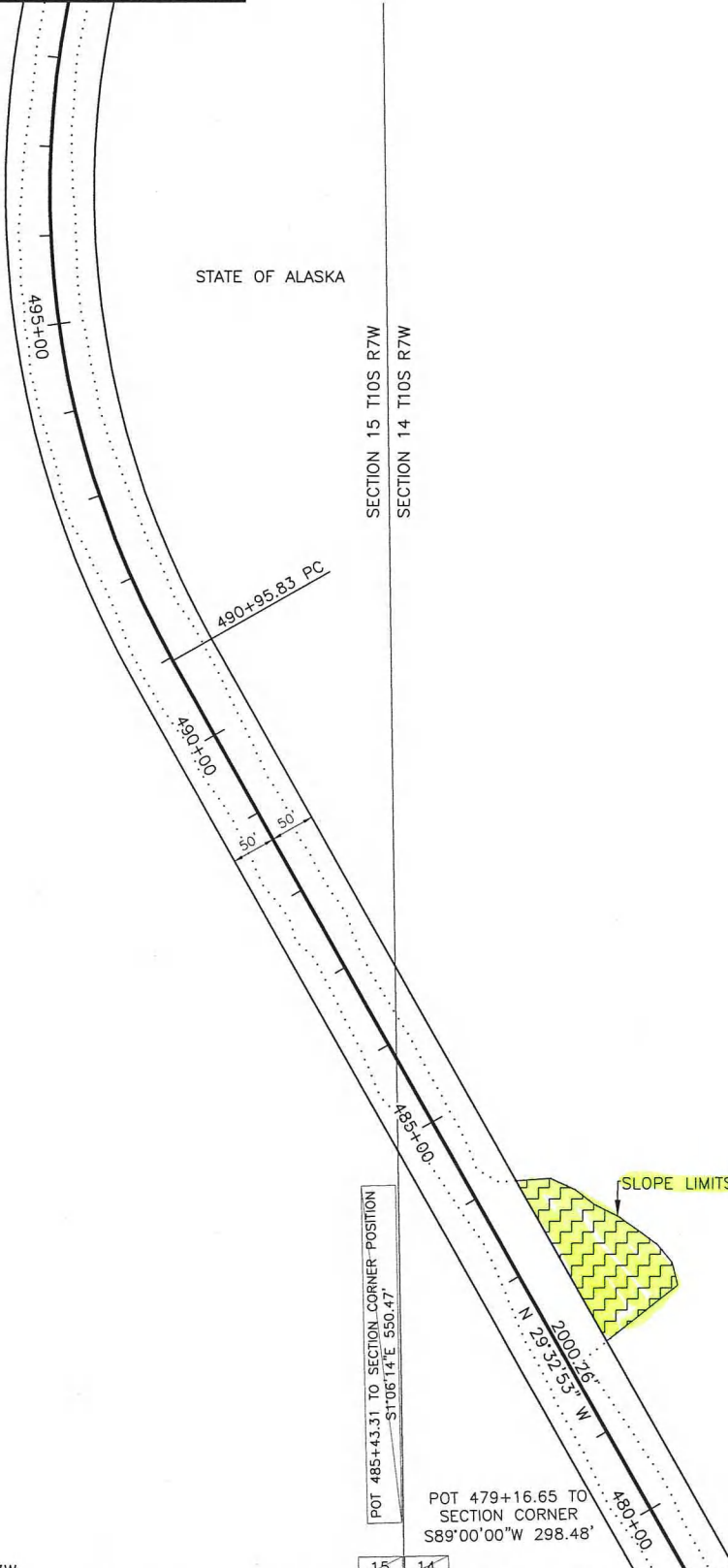

POT 485+43.31 TO SECTION CORNER POSITION
S1°06'14"E 550.47'

POT 479+16.65 TO SECTION CORNER
S89°00'00"W 298.48'

N 23°32'53" W
2000.26'

SECTION 15 T10S R7W

SECTION 14 T10S R7W

MATCH SHEET 17 LINE

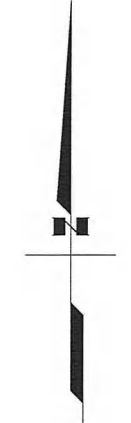
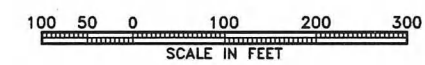

RECORD OF SURVEY	
FERRY ROAD RIGHT OF WAY	
STATE OF ALASKA DEPARTMENT OF TRANSPORTATION AND PUBLIC FACILITIES	
SCALE: 1"=100'	SHEET 17 OF 18

P:\2011\11054FB\2013 Record of Survey\11054FB-R05-SHT18 Sat, Dec/21/13 11:07am

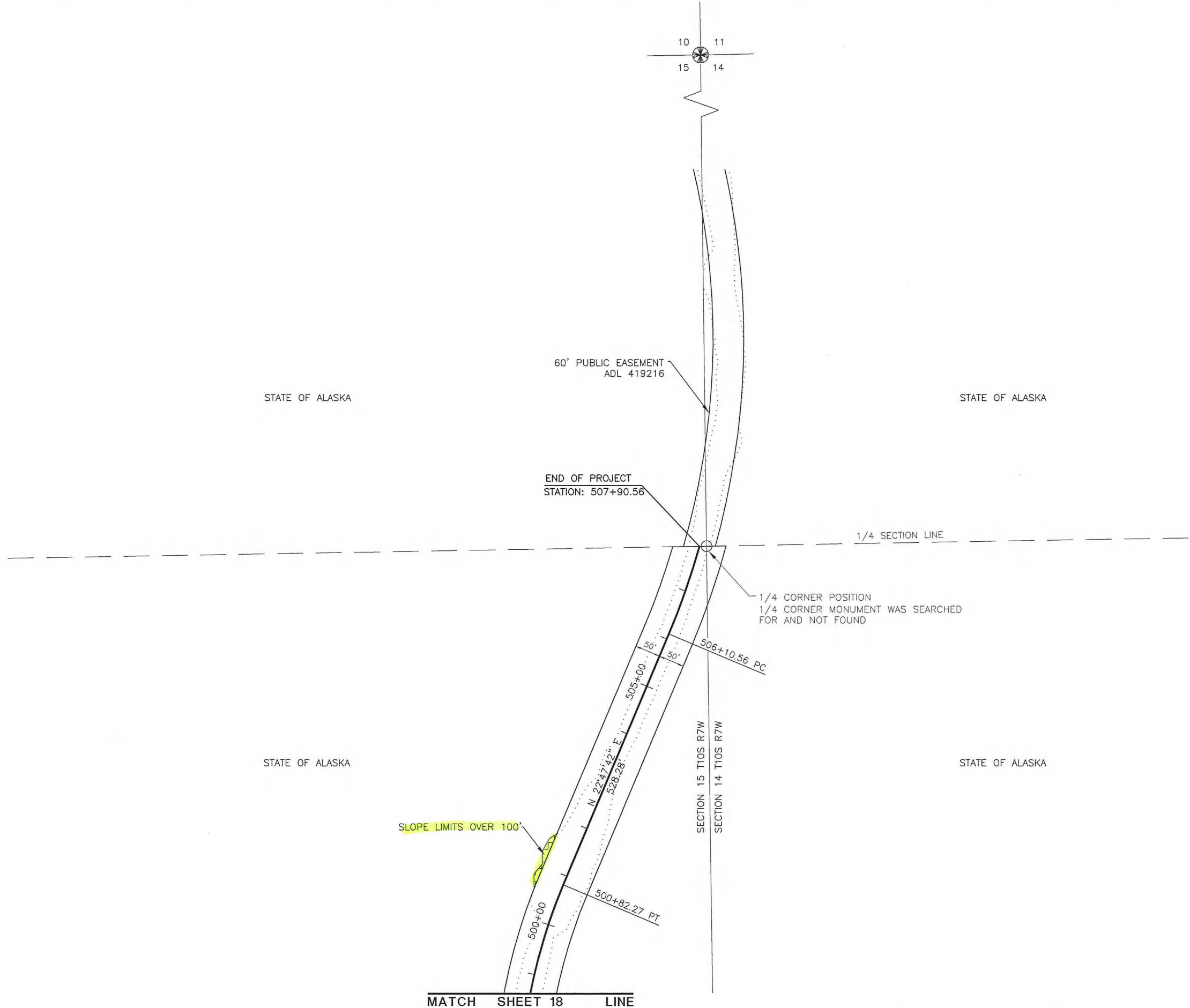
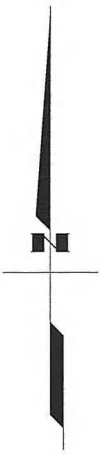
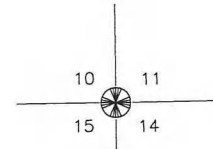

SLOPE LIMITS OVER 100'

MATCH SHEET 18 LINE

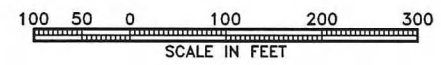

RECORD OF SURVEY	
FERRY ROAD RIGHT OF WAY	
STATE OF ALASKA DEPARTMENT OF TRANSPORTATION AND PUBLIC FACILITIES	
SCALE: 1"=100'	SHEET 18 OF 18