

TOWNSHIP 64 SOUTH, RANGE 84 EAST, OF THE COPPER RIVER MERIDIAN, ALASKA

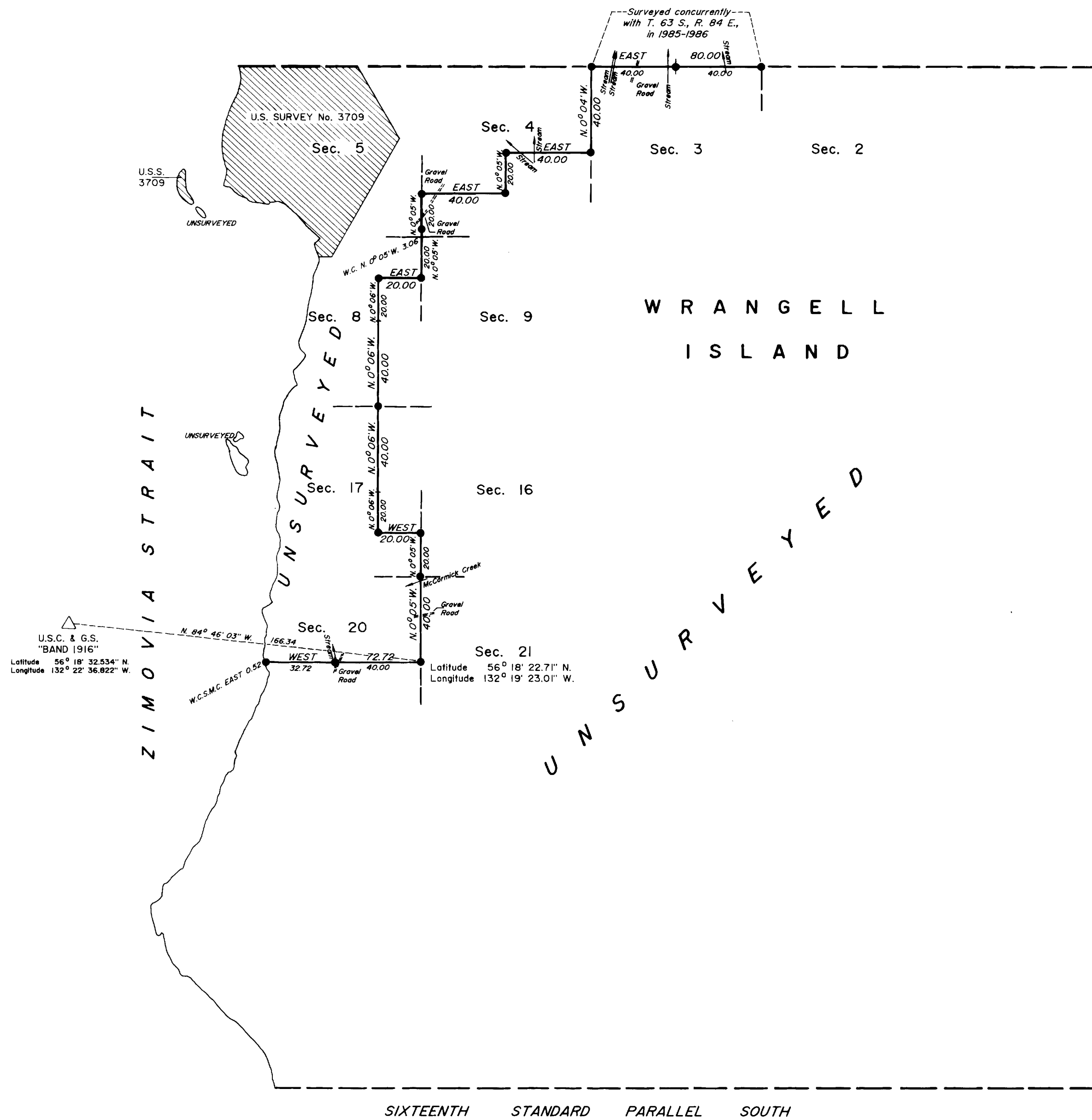

The history of surveys is contained in the field notes.

This plat and the field notes represent the survey of a portion of the subdivisional lines and the partial subdivision of selected sections of Township 64 South, Range 84 East, Copper River Meridian, Alaska.

This survey was executed by William Samuel Bunge, Cadastral Surveyor, U.S. Forest Service, May 20, 1985, through November 1, 1986, in accordance with the specifications set forth in the Manual of Surveying Instructions, 1973; Special Instructions for Group No. 433, Alaska, dated December 3, 1984, approved January 21, 1985; and Assignment Instructions dated March 6, 1985.

True Meridian

Mean Magnetic Declination 28° E.

U.S.C. & G.S. "BAND 1916"

Latitude 56° 18' 32.534" N.

Longitude 132° 22' 36.822" W.

SIXTEENTH STANDARD PARALLEL SOUTH

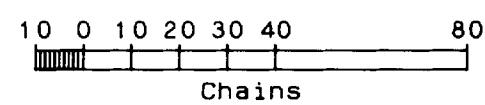

UNITED STATES DEPARTMENT OF THE INTERIOR
BUREAU OF LAND MANAGEMENT
Anchorage, Alaska

This plat is strictly conformable to the approved field notes, and the survey, having been correctly executed in accordance with the requirements of law and the regulations of this Bureau, is hereby accepted.

For the Director

James D. Riebtosh APRIL 4, 1988
Date

Deputy State Director for Cadastral Survey,
Alaska

ORIGINAL

Handwritten initials and number 95

UNITED STATES
DEPARTMENT OF THE INTERIOR
BUREAU OF LAND MANAGEMENT

FIELD NOTES

OF

THE SURVEY OF

A PORTION OF THE SOUTH BOUNDARY OF

TOWNSHIP 63 SOUTH, RANGE 84 EAST

AND

A PORTION OF THE SUBDIVISIONAL LINES

AND

PARTIAL SUBDIVISION OF SELECTED SECTIONS OF

TOWNSHIPS 63 AND 64 SOUTH, RANGE 84 EAST

Of the COPPER RIVER Meridian,
In the State of ALASKA.

EXECUTED BY

William Samuel Bunge, Cadastral Surveyor, U.S. Forest Service

Under special instructions dated December 3, 1984, approved January 21, 1985, which provided for the surveys included under Group Number 433, and assignment instructions dated March 6, 1985.

Survey commenced: May 20, 1985

Survey completed: November 1, 1986

GROUP NO. 433
COPPER RIVER MERIDIAN, ALASKA

CHAINS

U.S. Survey No. 3709, was surveyed by Walter W. Cooley, Cadastral Surveyor, in 1959 and 1960.

This survey establishes a portion of the south boundary of Township 63 South, Range 84 East, a portion of the subdivisional lines, and partial subdivision of selected sections of Townships 63 and 64 South, Range 84 East, of the Copper River Meridian, Alaska.

This survey was executed in accordance with the specifications set forth in the Manual of Surveying Instructions, 1973, the Memorandum of Agreement between the Bureau of Land Management, U.S. Department of the Interior, and the Forest Service, U.S. Department of Agriculture, dated March 19, 1980, and the Special Instructions for Group No. 433, Alaska, dated December 3, 1984.

The direction of all lines of this survey are referred to the true meridian, as determined by traverse from triangulation stations "HOPS 1916", "ARIES 1916", "BAND 1916", "HEAT 1916", "GARDEN 2 1916", "STROKE 1916", "PASS 2 1916", and "BOAT 2 1916", established by the U.S. Coast and Geodetic Survey.

The geographic position of the quarter section corner of sections 20 and 21, Township 64 South, Range 84 East, as determined by a traverse from the U.S. Coast and Geodetic Survey triangulation station "BAND 1916", is:

Latitude: 56°18'22.71" North
Longitude: 132°19'23.01" West

The mean magnetic declination as obtained from the U.S. Geological Survey quadrangle map "PETERSBURG (B-1)", Alaska, 1955 edition, with minor revisions in 1964 and 1978, indicates a mean value of 28° East.

PORTION OF THE SUBDIVISIONAL LINES
AND PARTIAL SUBDIVISION OF SELECTED SECTIONS OF
T. 64 S., R. 84 E., COPPER RIVER MER., ALASKA

Beginning at the point for the 1/4 sec. cor. of secs. 20 and 21, T. 64 S., R. 84 E.

Set an alum. post, 30 ins. long, 2 1/2 ins. diam., 26 ins. in the ground, with alum. cap mkd.

T 64 S R 84 E

1/4

S 20 | S 21

1985

from which

A hemlock, 8 ins. diam., bears S. 66° E.,
49 lks. dist., mkd. 1/4 S21 BT.

A hemlock, 12 ins. diam., bears S. 4° E.,
25 lks. dist., mkd. 1/4 S21 BT.

A hemlock, 14 ins. diam., bears N. 76° W.,
45 lks. dist., mkd. 1/4 S20 BT.

PORTION OF THE SUBDIVISIONAL LINES
AND PARTIAL SUBDIVISION OF SELECTED SECTIONS OF
T. 64 S., R. 84 E., COPPER RIVER MER., ALASKA

CHAINS	
	<p>From this point, U.S. Coast and Geodetic Survey triangulation station "BAND 1916", bears N. 84°46'03" W., 166.34 chs. dist., monumented with 3-in. diam. standard bronze disk, set in outcropping bedrock.</p>
	<p>West, on the E. and W. centerline of sec. 20.</p>
38.77	<p>Center of gravel road, 21 lks. wide, bears N. 25° E. and S. 25° W.</p>
39.90	<p>Stream, 15 lks. wide, 6 ins. deep, course N. 15° W.</p>
40.00	<p>Point for the center 1/4 sec. cor. of sec. 20.</p> <p>Set an alum. post, 30 ins. long, 2 1/2 ins. diam., 26 ins. in the ground, with alum. cap mkd.</p>
	<p style="text-align: center;">T 64 S R 84 E</p> <p style="text-align: center;">C 1/4 S 20</p> <p style="text-align: center;">1985</p>
	<p>from which</p>
	<p>A spruce, 2 ins. diam., bears N. 82° E., 32 lks. dist., mkd. X BT.</p>
	<p>A hemlock stump, 30 ins. diam., bears S. 72° W., 82 lks. dist., mkd. C 1/4 S20 BT.</p>
	<p>A hemlock stump, 26 ins. diam., bears N. 48° W., 14 lks. dist., mkd. C 1/4 S20 BT.</p>
72.20	<p>Point selected for the witness cor. to the special meander cor. on the E. and W. centerline of sec. 20.</p> <p>Set an alum. post, 30 ins. long, 2 1/2 ins. diam., 24 ins. in the ground, encircled with a collar of stone, with alum. cap mkd.</p>
	<p style="text-align: center;">WC</p> <p style="text-align: center;">SMC</p> <p style="text-align: center;">C S</p> <p style="text-align: center;">C 20</p> <p style="text-align: center;">1985</p>
	<p>from which</p>
	<p>A cedar, 8 ins. diam., bears S. 26° E., 33 lks. dist., mkd. X BT.</p>
	<p>A hemlock, 4 ins. diam., bears S. 12° W., 65 lks. dist., mkd. X BT.</p>
	<p>A spruce, 6 ins. diam., bears N. 64° W., 22 lks. dist., mkd. X BT.</p>
72.72	<p>True point for the special meander cor. on the eastern shore of Zimovia Strait, at the line of mean high tide, which bears N. 2° E. and S. 12° W.; not monumented due to the liability of destruction by ice and water action.</p>
	<p>From the 1/4 sec. cor. of secs. 20 and 21, hereinbefore described.</p>

PORTION OF THE SUBDIVISIONAL LINES
AND PARTIAL SUBDIVISION OF SELECTED SECTIONS OF
T. 64 S., R. 84 E., COPPER RIVER MER., ALASKA

CHAINS	
21.64	<p>N. 0°05' W., bet. secs. 20 and 21.</p> <p>Center of gravel road, 24 lks. wide, bears S. 75° W. and N. 81° E.</p>
38.15	<p>McCormick Creek, 23 lks. wide, 1 ft. deep, course S. 70° W.</p>
40.00	<p>Point for the cor. of secs. 16, 17, 20 and 21.</p> <p>Set an alum. post, 30 ins. long, 2 1/2 ins. diam., 26 ins. in the ground, with alum. cap mkd.</p>
	<p style="text-align: center;">T 64 S R 84 E S 17 S 16 S 20 S 21 1985</p>
	<p>from which</p> <p style="padding-left: 40px;">A hemlock, 12 ins. diam., bears N. 56° E., 24 lks. dist., mkd. T64S R84E S16 BT.</p> <p style="padding-left: 40px;">A hemlock, 18 ins. diam., bears S. 50° E., 11 lks. dist., mkd. T64S R84E S21 BT.</p> <p style="padding-left: 40px;">A hemlock, 14 ins. diam., bears S. 14° W., 61 lks. dist., mkd. T64S R84E S20 BT.</p> <p style="padding-left: 40px;">A spruce, 2 ins. diam., bears N. 48° W., 27 lks. dist., mkd. X BT.</p> <p>Land, hilly. Soil, organic and wet. Timber, hemlock and spruce, with occasional cedar and pine.</p>
20.00	<p>N. 0°05' W., bet. secs. 16 and 17.</p> <p>Point for the S. 1/16 sec. cor. of secs. 16 and 17.</p> <p>Set an alum. post, 30 ins. long, 2 1/2 ins. diam., 26 ins. in the ground, with alum. cap mkd.</p>
	<p style="text-align: center;">S 1/16 S 17 S 16 1985</p>
	<p>from which</p> <p style="padding-left: 40px;">A hemlock, 2 ins. diam., bears N. 48° E., 9 lks. dist., mkd. X BT.</p> <p style="padding-left: 40px;">A spruce, 2 ins. diam., bears S. 44° E., 25 lks. dist., mkd. X BT.</p> <p style="padding-left: 40px;">A spruce, 2 ins. diam., bears N. 48° W., 25 lks. dist., mkd. X BT.</p>
20.00	<p>West, on the E. and W. centerline of the SE 1/4 of sec. 17.</p> <p>Point for the SE 1/16 sec. cor. of sec. 17.</p>

PORTION OF THE SUBDIVISIONAL LINES
AND PARTIAL SUBDIVISION OF SELECTED SECTIONS OF
T. 64 S., R. 84 E., COPPER RIVER MER., ALASKA

CHAINS	
	<p>Set an alum. post, 30 ins. long, 2 1/2 ins. diam., 24 ins. in the ground, with alum. cap mkd.</p> <p style="text-align: center;">SE 1/16 S 17</p> <p style="text-align: center;">1985</p> <p>from which</p> <p style="padding-left: 40px;">A cedar, 14 ins. diam., bears S. 60° E., 11 lks. dist., mkd. SE 1/16 S17 BT.</p> <p style="padding-left: 40px;">A cedar, 12 ins. diam., bears S. 10° E., 48 lks. dist., mkd. SE 1/16 S17 BT.</p> <p style="padding-left: 40px;">A cedar, 26 ins. diam., bears N. 82° W., 25 lks. dist., mkd. SE 1/16 S17 BT.</p> <hr/> <p>N. 0°06' W., on the N. and S. centerline of the SE 1/4 of sec. 17.</p>
10.97	Center of gravel road, 21 lks. wide, bears N. 52° W. and S. 52° E.
12.43	Same road, bears N. 22° E. and S. 22° W.
13.68	Stream, 5 lks. wide, 6 ins. deep, course S. 74° W.
14.60	Same road, bears S. 70° W. and N. 70° E.
20.00	Point for the center E. 1/16 sec. cor. of sec. 17; not monumented.
	<hr/> <p>N. 0°06' W., on the N. and S. centerline of the NE 1/4 of sec. 17.</p>
40.00	Point for the E. 1/16 sec. cor. of secs. 8 and 17.
	<p>Set an alum. post, 30 ins. long, 2 1/2 ins. diam., 24 ins. in the ground, with alum. cap mkd.</p> <p style="text-align: center;">S 8 E 1/16 ——— S 17</p> <p style="text-align: center;">1986</p> <p>from which</p> <p style="padding-left: 40px;">A hemlock, 2 ins. diam., bears N. 24° E., 13 lks. dist., mkd. X BT.</p> <p style="padding-left: 40px;">A hemlock, 4 ins. diam., bears S. 68° E., 20 lks. dist., mkd. X BT.</p> <p style="padding-left: 40px;">A hemlock, 6 ins. diam., bears S. 14° W., 41 lks. dist., mkd. X BT.</p> <p>Land, steep westerly slope. Soil, organic and wet. Timber, hemlock and spruce, with patches of cedar.</p> <hr/> <p>N. 0°06' W. on the N. and S. centerline of the SE 1/4 of sec. 8.</p>
2.90	Draw, 15 ft. deep, drains S. 80° W.

PORTION OF THE SUBDIVISIONAL LINES
AND PARTIAL SUBDIVISION OF SELECTED SECTIONS OF
T. 64 S., R. 84 E., COPPER RIVER MER., ALASKA

CHAINS	
3.65	Draw, 20 ft. deep, drains S. 80° W.
4.40	Draw, 10 ft. deep, drains S. 80° W.
17.75	Draw, 20 ft. deep, drains S. 60° W.
18.65	Draw, 25 ft. deep, drains S. 60° W.
22.55	Draw, 25 ft. deep, drains S. 75° W.
24.90	Draw, 40 ft. deep, drains S. 75° W.
29.35	Draw, 20 ft. deep, drains S. 85° W.
30.95	Draw, 15 ft. deep, drains S. 85° W.
36.10	Draw, 20 ft. deep, drains W.
40.00	Point for the center E. 1/16 sec. cor. of sec. 18; not monumented.
	N. 0°06' W., on the N. and S. centerline of the NE 1/4 of sec. 8.
0.35	Draw, 30 ft. deep, drains N. 70° W.
13.80	Top of rocky cliff, bears NW and SE.
20.00	Point for NE 1/16 sec. cor. of sec. 8.
	Drilled a hole in ledge rock, 2 ins. deep, and cemented therein an alum. rod, 8 ins. long, 3/4 in. diam., with alum. cap, 3 ins. diam., mkd.
	NE 1/16 S 8
	1986
	from which
	A spruce, 4 ins. diam., bears N. 59° E., 14 lks. dist., mkd. X BT.
	A hemlock, 4 ins. diam., bears S. 25° E., 30 lks. dist., mkd. X BT.
	A spruce, 4 ins. diam., bears S. 80° W., 30 lks. dist., mkd. X BT.
	East, on the E. and W. centerline of the NE 1/4 of sec. 8.
15.20	Top of cliff, 70 ft. high, bears N. and S.
20.00	Point for the N. 1/16 sec. cor. of secs. 8 and 9.
	Set an alum. post, 30 ins. long, 2 1/2 ins. diam., 26 ins. in the ground, with alum. cap mkd.
	N 1/16
	S 8 S 9
	1986
	from which

PORTION OF THE SUBDIVISIONAL LINES
AND PARTIAL SUBDIVISION OF SELECTED SECTIONS OF
T. 64 S., R. 84 E., COPPER RIVER MER., ALASKA

CHAINS	
	<p>A hemlock, 18 ins. diam., bears N. 71° E., 24 lks. dist., mkd. N 1/16 S9 BT.</p> <p>A hemlock, 10 ins. diam., bears S. 52° E., 6 lks. dist., mkd. N 1/16 S9 BT.</p> <p>A hemlock, 28 ins. diam., bears S. 59° W., 38 lks. dist., mkd. N 1/16 S8 BT.</p>
	<p>N. 0°05' W., bet. secs. 8 and 9.</p>
17.75	Top of wall of rock pit, bears E. and W.
20.00	True point for the cor. of secs. 4, 5, 8 and 9; on a nearly vertical east wall of rock pit, composed of loose rock; unsafe position, not monumented.
	<p>Land, steep westerly slope. Soil, organic and wet. Timber, hemlock and spruce.</p>
	<p>N. 0°05' W., bet. secs. 4 and 5.</p>
1.80	Top of wall of rock pit, bears E. and W.
3.06	Point selected for the witness cor. to the cor. of secs. 4, 5, 8 and 9.
	<p>Set an alum. post, 30 ins. long, 2 1/2 ins. diam., 26 ins. in the ground, with alum. cap mkd.</p>
	<p style="text-align: center;"> WC T 64 S R 84 E S 5 S 4 S 8 S 9 ↓ 1985 </p>
	<p>from which</p> <p>A hemlock, 3 ins. diam., bears N. 42° E., 10 lks. dist., mkd. X BT.</p> <p>A spruce, 6 ins. diam., bears S. 85° E., 43 lks. dist., mkd. X BT.</p> <p>A hemlock, 3 ins. diam., bears S. 76° W., 6 lks. dist., mkd. X BT.</p> <p>A spruce, 5 ins. diam., bears N. 78° W., 24 lks. dist., mkd. X BT.</p>
9.15	Center of gravel road, 24 lks. wide, bears N. 40° E. and S. 40° W.
20.00	Point for the S. 1/16 sec. cor. of secs. 4 and 5.
	<p>Set an alum. post, 30 ins. long, 2 1/2 ins. diam., 26 ins. in the ground, with alum. cap mkd.</p>
	<p style="text-align: center;"> S 1/16 S 5 S 4 1985 </p>
	<p>from which</p>

PORTION OF THE SUBDIVISIONAL LINES
AND PARTIAL SUBDIVISION OF SELECTED SECTIONS OF
T. 64 S., R. 84 E., COPPER RIVER MER., ALASKA

CHAINS	
	<p>A spruce, 18 ins. diam., bears N. 22° E., 65 lks. dist., mkd. S 1/16 S4 BT.</p> <p>A hemlock, 4 ins. diam., bears S. 72° E., 19 lks. dist., mkd. X BT.</p> <p>A hemlock, 26 ins. diam., bears S. 14° W., 55 lks. dist., mkd. S 1/16 S5 BT.</p>
	<p>East, on the E. and W. centerline of the SW 1/4 of sec. 4.</p>
7.58	Center of gravel road, 24 lks. wide, bears N. 35° E. and S. 35° W.
40.00	Point for the center S. 1/16 sec. cor. of sec. 4.
	Set an alum. post, 30 ins. long, 2 1/2 ins. diam., 26 ins. in the ground, with alum. cap mkd.
	<div style="text-align: center;"> <p>C</p> <p>S 1/16 S 4</p> <p>C</p> <p>1985</p> </div>
	from which
	<p>A spruce, 4 ins. diam., bears N. 30° E., 41 lks. dist., mkd. X BT.</p> <p>A spruce, 4 ins. diam., bears S. 2° W., 15 lks. dist., mkd. X BT.</p> <p>A spruce, 2 ins. diam., bears N. 60° W., 46 lks. dist., mkd. X BT.</p>
	<p>N. 0°05' W., on the N. and S. centerline of sec. 4.</p>
20.00	Point for the center 1/4 sec. cor. of sec. 4.
	Set an alum. post, 30 ins. long, 2 1/2 ins. diam., 26 ins. in the ground, with alum. cap mkd.
	<div style="text-align: center;"> <p>T 64 S R 84 E</p> <p>C 1/4 S 4</p> <p>1985</p> </div>
	from which
	<p>A hemlock, 2 ins. diam., bears S. 64° E., 8 lks. dist., mkd. X BT.</p> <p>A spruce, 6 ins. diam., bears S. 52° W., 10 lks. dist., mkd. C 1/4 S4 BT.</p> <p>A hemlock, 4 ins. diam., bears N. 50° W., 18 lks. dist., mkd. X BT.</p>
	<p>East, on the E. and W. centerline of sec. 4.</p>
7.04	Stream, 12 lks. wide, 8 ins. deep, course N. 40° W.

PORTION OF THE SUBDIVISIONAL LINES
AND PARTIAL SUBDIVISION OF SELECTED SECTIONS OF
T. 64 S., R. 84 E., COPPER RIVER MER., ALASKA

CHAINS

13.12 Stream, 15 lks. wide, 1 ft. deep, course N.

40.00 Point for the 1/4 sec. cor. of secs. 3 and 4.

Set an alum. post, 30 ins. long, 2 1/2 ins. diam., 22 ins. in the ground, encircled with a collar of stone, with alum. cap mkd.

T 64 S R 84 E
1/4

S 4 | S 3

1985

from which

A pine, 6 ins. diam., bears N. 46° E.,
25 lks. dist., mkd. 1/4 S3 BT.

A hemlock, 12 ins. diam., bears S. 50° W.,
59 lks. dist., mkd. 1/4 S4 BT.

A pine, 6 ins. diam., bears N. 10° W.,
37 lks. dist., mkd. 1/4 S4 BT.

N. 0°04' W., bet. secs. 3 and 4.

40.00 Point for the cor. of secs. 3, 4, 33 and 34, on the N. bdy. of T. 64 S., R. 84 E..

Set an alum. post, 30 ins. long, 2 1/2 ins. diam., 26 ins. in the ground, with alum. cap mkd.

T 63 S R 84 E

S 33 | S 34
S 4 | S 3

T 64 S

1985

from which

A pine, 6 ins. diam., bears N. 76° E.,
23 lks. dist., mkd. T63S R84E S34 BT.

A cedar, 16 ins. diam., bears S. 62° E.,
72 lks. dist., mkd. T64S R84E S3 BT.

A pine, 6 ins. diam., bears S. 10° W.,
94 lks. dist., mkd. T64S R84E S4 BT.

A pine, 12 ins. diam., bears N. 54° W.,
45 lks. dist., mkd. T63S R84E S33 BT.

Land, moderate northwesterly slope.

Soil, organic and wet.

Timber, hemlock and spruce, with patches of pine.

PORTION OF THE S. BDY., T. 63 S., R. 84 E.
COPPER RIVER MERIDIAN, ALASKA

From the cor. of secs. 3, 4, 33 and 34, Tps. 63 and 64 S., R. 84 E., hereinbefore described.

East, bet. secs. 3 and 34.

PORTION OF THE S. BDY., T. 63 S., R. 84 E.
COPPER RIVER MERIDIAN, ALASKA

CHAINS	
9.85	Stream, 9 lks. wide, 6 ins. deep, course N. 10° E.
10.71	Stream, 3 lks. wide, 6 ins. deep, course N. 10° E.
21.04	Center of gravel road, 23 lks. wide, bears N. 18° E. and S. 18° W.
36.21	Stream, 6 lks. wide, 6 ins. deep, course N.
40.00	<p>Point for the 1/4 sec. cor. of secs. 3 and 34.</p> <p>Set an alum. post, 30 ins. long, 2 1/2 ins. diam., 26 ins. in the ground, with alum. cap mkd.</p> <p style="text-align: center;">T 63 S R 84 E S 34 1/4 ——— S 3</p> <p style="text-align: center;">T 64 S</p> <p style="text-align: center;">1985</p>
	<p>from which</p> <p style="padding-left: 40px;">A hemlock, 24 ins. diam., bears S. 44° E., 25 lks. dist., mkd. 1/4 S3 BT.</p> <p style="padding-left: 40px;">A hemlock, 12 ins. diam., bears S. 72° W., 60 lks. dist., mkd. 1/4 S3 BT.</p> <p style="padding-left: 40px;">A hemlock, 10 ins. diam., bears N. 4° W., 20 lks. dist., mkd. 1/4 S34 BT.</p>
62.84	Stream, 8 lks. wide, 1 ft. deep, course N. 10° W.
80.00	<p>Point for the cor. of secs. 2, 3, 34 and 35.</p> <p>Set an alum. post, 30 ins. long, 2 1/2 ins. diam., 22 ins. in the ground, encircled with a collar of stone, with alum. cap mkd.</p> <p style="text-align: center;">T 63 S R 84 E S 34 S 35 S 3 S 2</p> <p style="text-align: center;">T 64 S</p> <p style="text-align: center;">1985</p>
	<p>from which</p> <p style="padding-left: 40px;">A hemlock, 12 ins. diam., bears N. 66° E., 51 lks. dist., mkd. T63S R84E S35 BT.</p> <p style="padding-left: 40px;">A hemlock, 18 ins. diam., bears S. 50° E., 38 lks. dist., mkd. T64S R84E S2 BT.</p> <p style="padding-left: 40px;">A hemlock, 16 ins. diam., bears S. 18° W., 47 lks. dist., mkd. T64S R84E S3 BT.</p> <p style="padding-left: 40px;">A hemlock, 10 ins. diam., bears N. 12° W., 9 lks. dist., mkd. T63S R84E S34 BT.</p> <p>Land, moderate northwesterly slope. Soil, organic and wet. Timber, hemlock and spruce.</p>

PORTION OF THE SUBDIVISIONAL LINES
AND PARTIAL SUBDIVISION OF SECTION 26
T. 63 S., R. 84 E., COPPER RIVER MER., ALASKA

CHAINS	<p>PORTION OF THE SUBDIVISIONAL LINES AND PARTIAL SUBDIVISION OF SECTION 26 T. 63 S., R. 84 E., COPPER RIVER MER., ALASKA</p>
	<p>From the cor. of secs. 2, 3, 34 and 35, on the S. bdy. of T. 63 S., R. 84 E., hereinbefore described.</p> <p>N. 0°03' W., bet. secs. 34 and 35.</p>
9.27	Stream, 9 lks. wide, 1 ft. deep, course N. 65° W.
11.45	Stream, 3 lks. wide, 6 ins. deep, course N. 65° W.
12.49	Stream, 15 lks. wide, 2 ft. deep, course S. 76° W.
40.00	Point for the 1/4 sec. cor. of secs. 34 and 35.
	<p>Set an alum. post, 30 ins. long, 2 1/2 ins. diam., 20 ins. in the ground, encircled with a collar of stone, with alum. cap mkd.</p> <p style="text-align: center;">T 63 S R 84 E 1/4 S 34 S 35 1985</p> <p>from which</p> <p>A spruce, 24 ins. diam., bears N. 40° E., 20 lks. dist., mkd. 1/4 S35 BT.</p> <p>A cedar, 4 ins. diam., bears S. 45° E., 12 lks. dist., mkd. X BT.</p> <p>A hemlock, 10 ins. diam., bears N. 62° W., 33 lks. dist., mkd. 1/4 S34 BT.</p>
63.56	Top of bluff, bears NE and SW; descend.
78.87	Top of bluff, bears NE and SW; descend.
80.00	Point for the cor. of secs. 26, 27, 34 and 35.
	<p>Set an alum. post, 30 ins. long, 2 1/2 ins. diam., 24 ins. in the ground, encircled with a collar of stone, with alum. cap mkd.</p> <p style="text-align: center;">T 63 S R 84 E S 27 S 26 S 34 S 35 1985</p> <p>from which</p> <p>A hemlock, 10 ins. diam., bears N. 8° E., 15 lks. dist., mkd. T63S R84E S26 BT.</p> <p>A hemlock, 14 ins. diam., bears S. 60° E., 43 lks. dist., mkd. T63S R84E S35 BT.</p> <p>A hemlock, 18 ins. diam., bears S. 76° W., 55 lks. dist., mkd. T63S R84E S34 BT.</p> <p>A hemlock, 14 ins. diam., bears N. 36° W., 27 lks. dist., mkd. T63S R84E S27 BT.</p>

PORTION OF THE SUBDIVISIONAL LINES
AND PARTIAL SUBDIVISION OF SECTION 26
T. 63 S., R. 84 E., COPPER RIVER MER., ALASKA

CHAINS	
	<p>Land, moderate to steep northwesterly slope. Soil, organic and wet. Timber, hemlock and spruce.</p> <hr/> <p>East, bet. secs. 26 and 35.</p>
20.00	<p>True point for the W. 1/16 cor. of secs. 26 and 35, on a steep cliff, unsafe position, not monumented.</p> <p>From this point, the point selected for the witness cor. to the W. 1/16 sec. cor. of secs. 26 and 35, bears East, 3.10 chs. dist.</p> <p>Set an alum. post, 30 ins. long, 2 1/2 ins. diam., 26 ins. in the ground, encircled with a collar of stone, with alum. cap mkd.</p> <div style="text-align: center;"> <p>WC ← S 26 W 1/16 ——— S 35</p> <p>1986</p> </div> <p>from which</p> <p style="padding-left: 40px;">A hemlock, 18 ins. diam., bears S. 52° E., 30 lks. dist., mkd. X BT.</p> <p style="padding-left: 40px;">A cedar, 18 ins. diam., bears S. 66° W., 12 lks. dist., mkd. X BT.</p> <p style="padding-left: 40px;">A cedar, 14 ins. diam., bears N. 68° W., 33 lks. dist., mkd. X BT.</p> <p>This witness cor. is located 53 lks. E. of the edge of a steep cliff, bears NE and SW.</p> <hr/> <p>From the true point for the W. 1/16 sec. cor. of secs. 26 and 35.</p> <p>N. 0°02' W., on the N. and S. centerline of the SW 1/4 of sec. 26.</p> <p>Descend very steep cliff.</p>
20.00	<p>Point for the SW 1/16 sec. cor. of sec. 26.</p> <p>Set an alum. post, 30 ins. long, 2 1/2 ins. diam., 26 ins. in the ground, encircled with a collar of stone, with alum. cap mkd.</p> <div style="text-align: center;"> <p>SW 1/16 S 26</p> <p>1986</p> </div> <p>from which</p> <p style="padding-left: 40px;">A hemlock, 16 ins. diam., bears S. 21° E., 38 lks. dist., mkd. SW 1/16 S26 BT.</p> <p style="padding-left: 40px;">A hemlock, 12 ins. diam., bears S. 25° W., 37 lks. dist., mkd. SW 1/16 S26 BT.</p> <p style="padding-left: 40px;">A hemlock, 12 ins. diam., bears N. 18° W., 48 lks. dist., mkd. SW 1/16 S26 BT.</p>

PORTION OF THE SUBDIVISIONAL LINES
AND PARTIAL SUBDIVISION OF SECTION 26
T. 63 S., R. 84 E., COPPER RIVER MER., ALASKA

CHAINS	
	<p>East, on the E. and W. centerline of the SW 1/4 of sec. 26.</p>
	<p>Ascend very steep cliff.</p>
20.00	<p>True point for the center S. 1/16 sec. cor. of sec. 26, on a steep cliff, unsafe position, not monumented.</p>
	<p>From this point, the point selected for the witness cor. to the center S. 1/16 sec. cor. of sec. 26, bears S. 0°02' E., 3.53 chs. dist.</p>
	<p>Set an alum. post, 30 ins. long, 2 1/2 ins. diam., 26 ins. in the ground, with alum. cap mkd.</p>
	<div style="text-align: center;"> <p>WC</p> <p>C</p> <p>S 1/16 ↑ S 26</p> <p>C</p> <p>1986</p> </div>
	<p>from which</p> <p>A cedar, 8 ins. diam., bears N. 70° E., 42 lks. dist., mkd. X BT.</p> <p>A cedar, 16 ins. diam., bears S. 40° W., 38 lks. dist., mkd. X BT.</p> <p>A hemlock, 20 ins. diam., bears N. 82° W., 16 lks. dist., mkd. X BT.</p> <p>The witness cor. is located 23 lks. S. 0°02' E. of the top edge of a cliff, bears NE and SW.</p>
	<p>From the true point for the center S. 1/16 sec. cor. of sec. 26.</p> <p>N. 0°02' W., on the N. and S. centerline of sec. 26.</p> <p>Descend very steep cliff.</p>
27.00	<p>Base of cliff, bears NE and SW.</p>
40.00	<p>Point for the center N. 1/16 sec. cor. of sec. 26.</p>
	<p>Set an alum. post, 30 ins. long, 2 1/2 ins. diam., 26 ins. in the ground, with alum. cap mkd.</p>
	<div style="text-align: center;"> <p>C</p> <p>N 1/16 S 26</p> <p>C</p> <p>1985</p> </div>
	<p>from which</p> <p>A hemlock, 28 ins. diam., bears S. 70° E., 59 lks. dist., mkd. CN 1/16 S26 BT.</p> <p>A hemlock, 38 ins. diam., bears S. 35° E., 33 lks. dist., mkd. CN 1/16 S26 BT.</p>

PORTION OF THE SUBDIVISIONAL LINES
AND PARTIAL SUBDIVISION OF SECTION 26
T. 63 S., R. 84 E., COPPER RIVER MER., ALASKA

CHAINS	
	<p>A hemlock, 24 ins. diam., bears S. 32° W., 66 lks. dist., mkd. CN 1/16 S26 BT.</p>
13.98	<p>East, on the E. and W. centerline of the NE 1/4 of sec. 26.</p> <p>Ascend steep slope.</p> <p>Point selected for the witness cor. to the NE 1/16 sec. cor. of sec. 26.</p> <p>Set an alum. post, 30 ins. long, 2 1/2 ins. diam., 24 ins. in the ground, encircled with a collar of stone, with alum. cap mkd.</p> <div style="text-align: center;"> <p>WC</p> <p>NE 1/16 S 26</p> <p>→</p> <p>1985</p> </div> <p>from which</p> <p>A hemlock, 20 ins. diam., bears S. 72° E., 34 lks. dist., mkd. X BT.</p> <p>A hemlock, 16 ins. diam., bears S. 34° W., 27 lks. dist., mkd. X BT.</p> <p>A hemlock, 40 ins. diam., bears N. 52° W., 28 lks. dist., mkd. X BT.</p>
14.50	Base of very steep cliff.
20.00	True point for NE 1/16 sec. cor. of sec. 26, on a steep cliff; unsafe position, not monumented.
8.00	N. 0°02' W., on the N. and S. centerline of the NE 1/4 of sec. 26.
18.98	Base of very steep cliff, extends NE and SW.
20.00	Center of gravel road, 22 lks. wide, bears N. 70° E. and S. 70° W.
20.00	Point for the E. 1/16 sec. cor. of secs. 23 and 26.
	<p>Set an alum. post, 30 ins. long, 2 1/2 ins. diam., 20 ins. in the ground, encircled with a collar of stone, with alum. cap mkd.</p> <div style="text-align: center;"> <p>S 23</p> <p>E 1/16 ———</p> <p>S 26</p> <p>1985</p> </div> <p>from which</p> <p>A hemlock, 16 ins. diam., bears S. 53° W., 55 lks. dist., mkd. E 1/16 S26 BT.</p> <p>A hemlock, 30 ins. diam., bears N. 37° W., 18 lks. dist., mkd. E 1/16 S23 BT.</p>

PORTION OF THE SUBDIVISIONAL LINES
AND PARTIAL SUBDIVISION OF SECTION 26
T. 63 S., R. 84 E., COPPER RIVER MER., ALASKA

CHAINS

East, bet. secs. 23 and 26.

- 2.93 Center of gravel road, 22 lks. wide, bears N. 70° E. and S. 70° W.
- 17.25 Stream, 8 lks. wide, 1 ft. deep, course N. 15° E.
- 17.26 Tye Power Line, 3 strands, bears N. 44° W. and S. 44° E.
- 20.00 Point for the cor. of secs. 23, 24, 25 and 26.

Set an alum post, 30 ins. long, 2 1/2 ins. diam., 26 ins. in the ground, encircled with a collar of stone, with alum. cap mkd.

T 63 S	R 84 E
S 23	S 24
S 26	S 25

1985

from which

A spruce, 26 ins. diam., bears S. 25° E.,
73 lks. dist., mkd. T63S R84E S25 BT.

A hemlock, 10 ins. diam., bears S. 18° W.,
121 lks. dist., mkd. T63S R84E S26 BT.

A hemlock, 10 ins. diam., bears N. 87° W.,
130 lks. dist., mkd. T63S R84E S23 BT.

Land, extremely steep northwesterly slope.
Soil, organic and wet.
Timber, hemlock and spruce.

East, bet. secs. 24 and 25.

- 5.79 Stream, 8 lks. wide, 1 ft. deep, course N. 15° E.
- 13.06 Stream, 8 lks. wide, 1 ft. deep, course N. 20° E.
- 17.82 Stream, 3 lks. wide, 6 ins. deep, course N. 25° E.
- 20.77 Stream, 5 lks. wide, 6 ins. deep, course N. 14° E.
- 28.81 Stream, 5 lks. wide, 6 ins. deep, course N. 10° W.
- 40.00 Point for the 1/4 sec. cor. of secs. 24 and 25.

Set an alum. post, 30 ins. long, 2 1/2 ins. diam., 24 ins. in the ground, encircled with a collar of stone, with alum. cap mkd.

T 63 S	R 84 E
	S 24
1/4	—————
	S 25

1985

from which

A hemlock, 22 ins. diam., bears N.,
19 lks. dist., mkd. 1/4 S24 BT.

PORTION OF THE SUBDIVISIONAL LINES
AND PARTIAL SUBDIVISION OF SECTION 26
T. 63 S., R. 84 E., COPPER RIVER MER., ALASKA

CHAINS

A hemlock, 10 ins. diam., bears S. 52° E.,
22 lks. dist., mkd. 1/4 S25 BT.

A hemlock, 18 ins. diam., bears S. 8° E.,
27 lks. dist., mkd. 1/4 S25 BT.

72.28 Point selected for the witness cor. to the meander
cor. of secs. 24 and 25.

Set an alum. post, 30 ins. long, 2 1/2 ins. diam., 24
ins. in the ground, encircled with a collar of stone,
with alum. cap mkd.

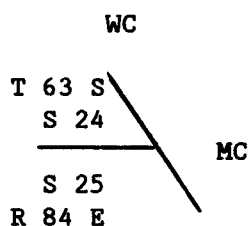

1985

from which

A spruce, 28 ins. diam., bears N. 25° E.,
32 lks. dist., mkd. X BT.

A hemlock, 16 ins. diam., bears S. 10° W.,
19 lks. dist., mkd. X BT.

A hemlock, 16 ins. diam., bears S. 71° W.,
26 lks. dist., mkd. X BT.

From this point, U.S. Coast and Geodetic survey tri-
angulation station "HOPS 1916", bears N. 10°21'21" W.,
165.30 chs. dist., monumented with 3-in. diam. stan-
dard bronze disk, with no marks.

Descend 15 ft. through boulders.

72.66 True point for the meander cor. of secs. 24 and 25, on
the western shore of Eastern Passage, at the line of
mean high tide, which bears N. 47° W. and S. 47° E.;
not monumented due to the liability of destruction by
ice and water action.

GENERAL DESCRIPTION

The lines surveyed, divide Wrangell Island from
Zimovia Strait to Eastern Passage, and are situated
approximately 9 miles southeasterly from the City of
Wrangell, Alaska.

This survey generally follows the southeasterly side
of a broad valley, with elevations ranging from sea
level to 1,000 feet above sea level. The survey
crosses numerous streams which drain into Pat Creek,
course southwesterly, or Lowe Creek, course north-
easterly.

The soil is organic and wet. Timber consists of west-
ern hemlock, Sitka spruce, yellow cedar and lodgepole
pine. Underbrush includes blueberry, devils-club and
alders.

GROUP NO. 433
COPPER RIVER MERIDIAN, ALASKA

CHAINS

There is an extensive network of gravel logging roads within the area surveyed. No land is under cultivation; however, houses are being constructed on state land subdivisions along the shores at each end of the valley. There is no mining activity within the area; however, there are numerous large pits from which crushed rocks have been taken.

Signs bearing the message, "National Forest land behind this sign" were placed on trees and fiberglass posts at 200 to 400 foot intervals along Tongass National Forest boundary lines. Bearing tree signs were placed on all bearing trees. National Forest boundary lines were blazed and painted red.

UNITED STATES
DEPARTMENT OF THE INTERIOR
BUREAU OF LAND MANAGEMENT

FIELD ASSISTANTS

NAMES	/	CAPACITY
Barry M. Blanchard (1985 & 86)	/	Surveying Technician
Mark S. Smith (1985)	/	Surveying Technician
Beverly DeCock (1986)	/	Surveying Technician
George Bisset (1985 & 86)	/	Surveying Technician
Debra Kent (1985)	/	Surveying Technician
Michael Reitz (1986)	/	Sawyer

U.S. DEPARTMENT OF THE INTERIOR
BUREAU OF LAND MANAGEMENT
ALASKA STATE OFFICE - ANCHORAGE, AK.

CERTIFICATE OF SURVEY

I, William Samuel Bunge, Cadastral Surveyor, U.S. Forest Service, HEREBY CERTIFY upon honor that, in pursuance of special instructions bearing date of the 3rd day of December 1984, I have surveyed a portion of the south boundary of Township 63 South, Range 84 East, a portion of the subdivisional lines, and partial subdivision of selected sections of Townships 63 and 64 South, Range 84 East of the Copper River Meridian, in the State of Alaska, which are represented in the foregoing field notes as having been executed by me, and under my direction; and that said survey has been made in strict conformity with said special instructions, the Manual of Instructions for the Survey of the Public Lands of the United States, and in specific manner described in the foregoing field notes.

21 March 1988
(Date)

Wm. Samuel Bunge
(Cadastral Surveyor)

CERTIFICATE OF APPROVAL

Bureau of Land Management
Anchorage, Alaska

The foregoing field notes of the survey of a portion of the south boundary of Township 63 South, Range 84 East, a portion of the subdivisional lines, and partial subdivision of selected sections of Townships 63 and 64 South, Range 84 East, Copper River Meridian, Alaska, executed by William Samuel Bunge, Cadastral Surveyor, having been critically examined and found correct, are hereby approved.

4 April 1988
(Date)

Lance D. Hest
(Deputy State Director for
Cadastral Survey, Alaska)

MAR 29 10 24 AM '88

BLM AK 80 950

ORIGINAL 195

R-119

UNITED STATES
DEPARTMENT OF THE INTERIOR
BUREAU OF LAND MANAGEMENT

FIELD NOTES
OF
THE RETRACEMENT OF A PORTION OF U.S. SURVEY NO. 3709,
AND A PORTION OF THE NORTH BOUNDARY,
THE SURVEY OF
A PORTION OF THE NORTH BOUNDARY
AND THE MEANDERS OF THE EASTERLY SHORELINE
OF ZIMOVIA STRAIT
TOWNSHIP 64 SOUTH, RANGE 84 EAST,
OF THE COPPER RIVER MERIDIAN,
IN THE STATE OF ALASKA.

EXECUTED BY

M. Scott McLane, Registered Alaska Land Surveyor
No. 4928 for McLane and Associates

Under special instructions for GROUP No. 486, ALASKA,
dated February 10, 1989, approved February 27, 1989,
Contract No. YA651-CT9-340059, awarded June 7, 1989,
and Notice to Proceed dated June 9, 1989.

Survey commenced: June 19, 1989
Survey completed: August 19, 1989

INDEX DIAGRAM

TOWNSHIP 64 SOUTH, RANGE 84 EAST. COPPER RIVER MERIDIAN

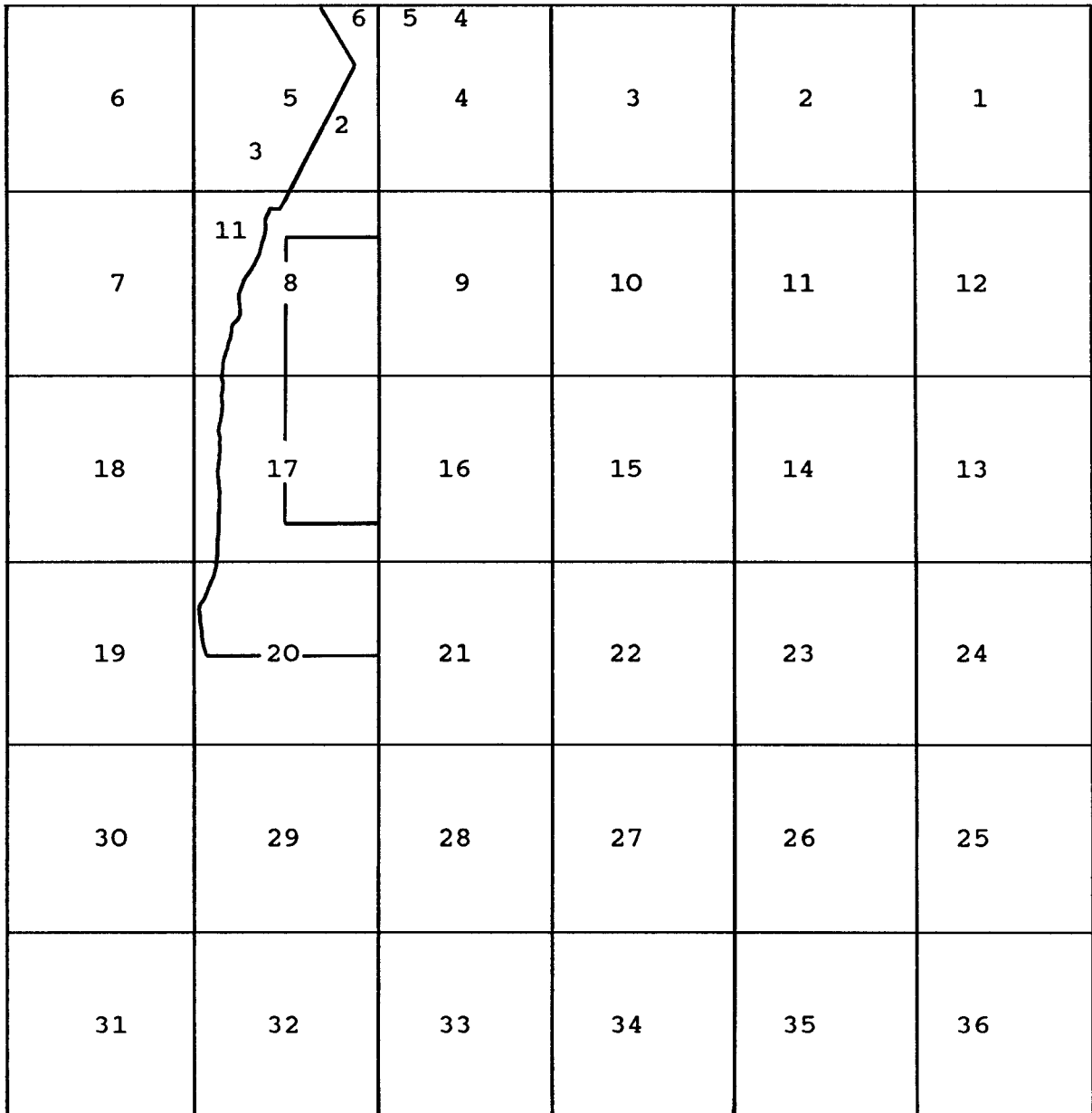

Meanders of Zimovia Strait
 Meanders of small island

Page 7 through Page 11
 Page 11

T. 64 S., R. 84 E. Copper River Meridian, Alaska

CHAINS

The following field notes are those of the retracement of a portion of U.S. Survey No. 3709, the retracement of a portion of the north boundary, the survey of a portion of the north boundary, and the meanders of the easterly shoreline of Zimovia Strait, Township 64 South, Range 84 East, Copper River Meridian, Alaska.

U.S. Survey No. 3709, was surveyed by Walter W. Cooley, Cadastral Surveyor in 1960.

A portion of the north boundary, a portion of the subdivisional lines, and partial subdivision of sections, Township 64 South, Range 84 East, Copper River Meridian, Alaska, was surveyed by William Samuel Bunge, Cadastral Surveyor, U.S. Forest Service in 1985 and 1986.

This survey was executed in accordance with the specifications set forth in the Manual of Surveying Instruction, 1973, the Special Instructions for Group No. 486, Alaska, dated February 10, 1989, and Contract No. YA651-CT9-340059, awarded June 7, 1989.

The direction of lines refer to the true meridian as determined by using horizontal control stations of record published by the U.S. Coast and Geodetic Survey situated throughout this survey.

The corner positions of this survey were established at their protracted positions using precomputed bearings and distances from horizontal control stations and positions of recovered existing corners of record. Lines were then surveyed between the corners. The protracted positions were based on the official Bureau of Land Management protraction diagrams.

The geographic position of secs. 4, 5, 32 and 33, Township 64 South, Range 84 East, is:

Latitude: 56°21'24.82" North
Longitude: 132°19'23.51" West
NAD 27

The magnetic declination, as taken from U.S. Geological Survey quadrangle map "Petersburg (B-2)," Alaska, 1953 edition, with minor revisions in 1963, and indicates a mean value of 29° E.

T. 64 S., R. 84 E., Copper River Meridian, Alaska

CHAINS	<p style="text-align: center;">PRELIMINARY STATEMENT</p> <p>Prior to the execution of this survey, it was necessary to retrace a portion of U.S. Survey No. 3709, and a portion of the north bdy. of T. 64 S., R. 84 E.</p> <p style="text-align: center;">RETRACEMENT OF A PORTION OF U.S. SURVEY No. 3709</p> <p>Beginning at the true point for cor. No. 2, Lot 5, identical with cor. 7, U.S. Survey 3709, not monumented.</p> <p>S. 28°52' W., on line 2-3, Lot 5, identical with line 7-8, U.S. Survey No. 3709.</p> <p>1.00 The witness cor. to cor. No. 2, Lot 5, identical with the witness cor. to cor. No. 7, U.S. Survey 3709, monumented with an iron post, 2 1/2 ins. diam., firmly set, extending 12 ins. above ground, with brass cap mkd. WC S3709 L5 NFB 1960, from which the original bearing trees.</p> <p style="padding-left: 40px;">A pine, 13 ins. diam., bears S. 78° W., 27 lks. dist., mkd. X BT, on partially healed blaze.</p> <p style="padding-left: 40px;">A dead cedar, 11 ins. diam., bears N. 42° W., 34 lks. dist., mkd. with healed blaze.</p> <p style="padding-left: 40px;">from which new bearing tree</p> <p style="padding-left: 40px;">A pine, 12 ins. diam., bears N. 37 1/2° W., 79 lks. dist., mkd. X BT.</p> <p>At the corner point, bury a clear DEEP-1 magnet, alongside the iron post, 14 ins. below ground.</p> <p>40.00 Witness point No. 15, U.S. Survey No. 3709, monumented with an iron rod, 3/4 in. diam., firmly set, extending 1 in. above ground, with brass cap mkd. S3709 WP NO 15 1960 from which bearing trees not of record.</p> <p style="padding-left: 40px;">A hemlock, 16 ins. diam., bears S. 83° E., 20 lks. dist., with healed blaze.</p> <p style="padding-left: 40px;">A hemlock, 10 ins. diam., bears N. 23° W., 34 lks. dist., with healed blaze.</p>
--------	---

T. 64 S., R. 84 E., Copper River Meridian, Alaska

<p>CHAINS</p> <p>60.99</p>	<p>Cor. No. 3, Lot 5, identical with cor. No. 8, U.S. Survey No. 3709, monumented with an iron post, 2 1/2 ins. diam., firmly set, extending 1 in. above ground, encircled by a collar of stone, with brass cap mkd. S3709 C8 L5 NFB 1960, from which the original bearing trees.</p> <p>A hemlock, 28 ins. diam., bears N. 36° E., 72 lks. dist., with healed blaze.</p> <p>A hemlock, 14 ins. diam., bears S. 30° E., 40 lks. dist., with healed blaze.</p>
<p>4.53</p> <p>5.03</p>	<p>S. 85°17' W., on line 3-4, Lot 5, identical with line 8-9, U.S. Survey No. 3709.</p> <p>The witness cor. to cor. No. 4, Lot 5, identical with the witness cor. to cor. No. 9, U.S. Survey No. 3709, both meander cors., monumented with an iron post, 2 1/2 ins. diam., firmly set, extending 8 ins. above ground, with brass cap mkd. WC S3709 C9 L5 MC NFB 1960, from which the original bearing trees.</p> <p>A spruce, 10 ins. diam., bears N. 8° E., 45 lks. dist., with healed blaze.</p> <p>A spruce, 24 ins. diam., bears N. 75° E., 27 1/2 lks. dist., with healed blaze.</p> <p>At the corner point.</p> <p>Encircle iron post in collar of stone, 24 ins. diam.</p> <p>True point for cor. No. 4, Lot 5, identical with with the true point for cor. No. 9, U.S. Survey No. 3709, both meander cors., on the easterly shore of Zimovia Strait, at the line of mean high tide, not monumented.</p>
	<p>RETRACEMENT OF A PORTION OF THE NORTH BDY. T. 64 S., R. 84 E., C.R.M.</p>
	<p>From the cor. of secs. 2, 3, 34, and 35, on the N. bdy. of the Tp., monumented with an alum. post, 2 1/2 ins. diam., firmly set, extending 7 ins. above ground, encircled by a collar of stone, with alum. cap mkd. T63S R84E S34 S35 S3 S2 T64S 1985 from which the original bearing trees</p>

Portion of the N. Bdy. of
T. 64 S., R. 84 E., Copper River Meridian, Alaska

CHAINS	
	<p>A hemlock, 12 ins. diam., bears N. 66° E., 51 lks. dist., mkd. T63S R84E S35 BT.</p> <p>A hemlock, 18 ins. diam., bears S. 50° E., 38 lks. dist., mkd. T64S R84E S2 BT.</p> <p>A hemlock, 16 ins. diam., bears S. 18° W., 47 lks. dist., mkd. T64S R84E S3 BT.</p> <p>A hemlock, 10 ins. diam., bears N. 12° W., 9 lks. dist., mkd. T63S R84E S34 BT.</p>
	<p>West, bet. secs. 3 and 34.</p>
40.00	<p>The 1/4 cor. of secs. 3 and 34, monumented with an alum. post, 2 1/2 ins. diam., firmly set, extending 7 ins. above ground, with alum. cap mkd., T63S R84E 1/4 S34 S3 T64S 1985, from which the original bearing trees</p> <p>A hemlock, 24 ins. diam., bears S. 44° E., 25 lks. dist., mkd. 1/4 S3 BT.</p> <p>A hemlock, 12 ins. diam., bears S. 72° W., 58 lks. dist., mkd. 1/4 S3 BT (Record 60 lks.)</p> <p>A hemlock, 10 ins. diam., bears N. 4° W., 20 lks. dist., mkd. 1/4 S34 BT.</p>
80.00	<p>The cor. of secs. 3, 4, 33, and 34, monumented with an alum. post, 2 1/2 ins. diam., firmly set, extending 6 ins. above ground, with alum. cap mkd. T63S R84E S33 S34 S4 S3 T64S 1985, from which the original bearing trees.</p> <p>A pine, 6 ins. diam., bears N. 76° E., 23 lks. dist., mkd., T63S R84E S34 BT.</p> <p>A cedar, 16 ins. diam., bears S. 62° E., 72 lks. dist., mkd. T64S R84E S3 BT.</p> <p>A pine, 6 ins. diam., bears S. 10° W., 94 lks. dist., mkd. T64S R84E S4 BT.</p> <p>A pine, 12 ins. diam., bears N. 54° W., 45 lks. dist., mkd., T63S R84E S33 BT.</p>

Portion of the N. Bdy. of
T. 64 S., R. 84 E., Copper River Meridian, Alaska

CHAINS	PORTION OF THE N. BDY., T. 64 S., R. 84 E., C.R.M.				
80.00	<p>From the cor. of secs. 3, 4, 33, and 34, on the N. bdy. of Tp., hereinbefore described.</p> <p>West, bet. secs. 4 and 33.</p> <p>The point for cor. of secs. 4, 5, 32, and 33.</p> <p>Drive an alum. rod, 15 ft. long, 3/4 in. diam., 14.8 ft. in ground, with alum. cap mkd.</p> <p style="text-align: center;">T63S R84E</p> <table style="margin-left: auto; margin-right: auto;"> <tr> <td style="border-right: 1px solid black; border-bottom: 1px solid black;">S32</td> <td style="border-bottom: 1px solid black;">S33</td> </tr> <tr> <td style="border-right: 1px solid black;">S5</td> <td>S4</td> </tr> </table> <p style="text-align: center;">T64S 1989</p> <p>from which</p> <p style="padding-left: 40px;">A hemlock, 5 ins. diam., bears S. 76° E., 89 lks. dist., mkd. T63S R84E S33 BT.</p> <p style="padding-left: 40px;">A spruce, 10 ins. diam., bears S. 0 1/2° E., 99 lks. dist., mkd. T64S R84E S4 BT.</p> <p style="padding-left: 40px;">A cedar, 13 ins. diam., bears S. 50° W., 53 lks. dist., mkd. T64S R84E S5 BT.</p> <p style="padding-left: 40px;">A hemlock, 8 ins. diam., bears N. 51° W., 70 lks. dist., mkd. T63S R84E S32 BT.</p> <p>Bury a clear DEEP-1 magnet alongside alum. rod, 12 ins. below ground.</p> <p>From this point, the U.S. Coast and Geodetic Survey triangulation station "PASS 1916", bears S. 80°39'19" W., 296.90 chs. dist., monumented with a standard bronze disk, 3 1/4 ins. diam., set firmly in bedrock.</p> <p>West, bet. secs. 5 and 32.</p> <p>Asc. gradual slope.</p>	S32	S33	S5	S4
S32	S33				
S5	S4				

Portion of the N. Bdy. of
T. 64 S., R. 84 E., Copper River Meridian, Alaska

CHAINS	
2.65	Desc. moderate slope through mature spruce, cedar, and hemlock timber.
7.84	Creek, 2 lks. wide, course South; begin ascent.
11.76	Dry stream bed, 6 lks. wide, course S. 10° W.
15.73	Creek, 5 lks. wide, course S. 30° E.; begin moderate ascent.
17.31	Top of bench; begin gradual descent over SW slope.
29.08	Begin steep descent.
29.35	Creek, 8 lks. wide, course S. 15° W.; center of drainage swale.
29.58	Begin ascent.
31.28	Top of slope; begin descent.
31.43	Stream, 9 lks. wide, course South; center of drainage swale, 20 ft. wide.
31.58	Begin steep ascent.
32.03	Top of bench; across S. facing slope.
32.98	Intersect E. bdy. of Lot 5, U.S. Survey No. 3709; point for the closing cor. of secs. 5, and 32.
	Set an iron post, 28 ins. long, 2 1/2 ins. diam., 22 ins. in ground, encircled by a collar of stone, 30 ins. diam. and 6 ins. deep., with brass cap mkd.
	<pre> T63S R84E S32 S 3709 /----- CC \ S5 T64S 1989 </pre>
	from which
	A cedar, 11 ins. diam., bears N. 52 1/2 ° E., 92 lks. dist., mkd. T63S R84E S32 CC BT.
	A hemlock, 12 ins. diam., bears S. 68° E., 32 lks. dist., mkd. T64S R84E S5 CC BT.

Portion of the N. Bdy. of
T. 64 S., R. 84 E., Copper River Meridian, Alaska

CHAINS	<p>Deposit a clear DEEP-1 magnet at base of iron post.</p> <p>From this point, cor. No. 2, Lot 4, identical with cor. No. 1, Lot 5, U.S. Survey No. 3709, bears N. 30°23' W., 1.05 chs. dist., monumented with an iron post, 2 1/2 ins. diam., loosely set, extending 10 ins. above ground, with brass cap incorrectly mkd. 3709 L4 NFE3 L5 1960, from which the original bearing trees.</p> <p style="padding-left: 40px;">A hemlock, 24 ins. diam., bears N. 38° E., 21 lks. dist., mkd. X BT on partially healed blaze.</p> <p style="padding-left: 40px;">A cedar, 16 ins. diam., bears S. 26° E., 39 lks. dist., mkd. X BT on partially healed blaze.</p> <p>At the corner point.</p> <p>Encircle iron post with collar of stone, 24 ins. diam. and 6 ins. high.</p> <p>From this same point, the true point for cor. No. 2, Lot 5, identical with the true point for cor. No. 7, U.S. Survey No. 3709, bears S. 30°23' E., 38.66 chs. dist., hereinbefore described.</p>								
<p>MEANDERS OF ZIMOVIA STRAIT T. 64 S., R. 84 E., COPPER RIVER MERIDIAN, ALASKA</p>									
<p>From the true point for cor. No. 4, Lot 5, identical the true point for cor. No. 9, U.S. Survey No. 3709, both meander cors., hereinbefore described.</p> <p>Thence with the meanders of the easterly shoreline of Zimovia Strait, along a fragmented rock and gravel beach, at the line of mean high tide.</p> <table style="width: 100%; border: none;"> <tr> <td style="padding-left: 40px;">S. 5°35' W.,</td> <td style="padding-left: 100px;">1.32 chs.</td> </tr> <tr> <td style="padding-left: 40px;">S. 2°00' W.,</td> <td style="padding-left: 100px;">6.68 chs.</td> </tr> <tr> <td style="padding-left: 40px;">S. 16°35' W.,</td> <td style="padding-left: 100px;">6.28 chs.</td> </tr> <tr> <td style="padding-left: 40px;">S. 10°28' W.,</td> <td style="padding-left: 100px;">10.52 chs.</td> </tr> </table>		S. 5°35' W.,	1.32 chs.	S. 2°00' W.,	6.68 chs.	S. 16°35' W.,	6.28 chs.	S. 10°28' W.,	10.52 chs.
S. 5°35' W.,	1.32 chs.								
S. 2°00' W.,	6.68 chs.								
S. 16°35' W.,	6.28 chs.								
S. 10°28' W.,	10.52 chs.								

Meanders of Zimovia Strait
T. 64 S., R. 84 E., Copper River Meridian, Alaska

CHAINS	
	S. 10°56' W., 5.88 chs. At end of course, creek, 3 lks. wide, course N. 82° W.
	S. 4°28' W., 5.72 chs.
	S. 36°26' W., 1.36 chs.
	S. 28°33' W., 0.81 ch. At end of course, creek, 3 lks. wide, course N. 80° W.
	S. 26°36' W., 5.63 chs.
	S. 8°12' E., 1.35 chs.
	S. 44°40' E., 3.48 chs.
	S. 3°39' E., 4.36 chs.
	S. 32°32' E., 2.38 chs.
	S. 50°23' W., 3.23 chs.
	S. 17°31' W., 1.16 chs.
	S. 3°20' E., 3.53 chs.
	S. 18°08' E., 2.36 chs. At end of course, creek, 5 lks. wide, course N. 47° W.
	S. 41°25' W., 3.30 chs.
	S. 45°56' W., 5.22 chs.
	S. 21°38' W., 6.06 chs.
	S. 7°01' W., 4.06 chs.
	S. 10°34' W., 4.51 chs. At end of course, creek, 3 lks. wide, course N. 75° W.
	S. 7°21' E., 1.43 chs.
	S. 6°02' W., 4.02 chs.

Meanders of Zimovia Strait
T. 64 S., R. 84 E., Copper River Meridian, Alaska

CHAINS		
	S. 2°45' E.,	3.81 chs.
	S. 16°56' W.,	2.74 chs.
	S. 17°05' E.,	4.66 chs. At end of course, creek, 6 lks. wide, course S. 85° W.
	S. 3°15' W.,	6.30 chs.
	S. 6°26' E.,	2.51 chs.
	S. 9°01' W.,	4.56 chs.
	S. 5°16' W.,	3.57 chs.
	S. 26°46' E.,	3.19 chs.
	S. 8°03' W.,	6.49 chs. At end of course, creek, 3 lks. wide, course N. 74° W.
	S. 12°47' W.,	2.87 chs.
	S. 10°14' E.,	3.56 chs.
	S. 8°05' E.,	5.62 chs.
	S. 1°10' E.,	4.34 chs.
	S. 7°54' W.,	5.32 chs.
	S. 13°29' E.,	2.32 chs.
	S. 2°49' W.,	5.27 chs.
	S. 39°13' W.,	5.69 chs.
	S. 9°59' W.,	6.27 chs. At end of course, stream, 12 lks. wide, course N. 76° W.
	S. 26°49' W.,	4.36 chs.
	S. 2°38' W.,	1.87 chs.
	S. 28°23' E.,	6.27 chs.

Meanders of Zimovia Strait
T. 64 S., R. 84 E., Copper River Meridian, Alaska

CHAINS	
	S. 28°14' W., 1.61 chs.
	S. 3°30' W., 5.26 chs. At end of course, creek, 3 lks. wide, course N. 75° W.
	S. 13°27' W., 1.71 chs.
	S. 48°20' E., 1.83 chs.
	S. 20°13' W., 4.79 chs.
	S. 3°22' E., 2.80 chs. At end of course, true point for the special meander cor., on the E. and W. centerline of sec. 20, and on the eastern shore of Zimovia Strait, not monumented.
	From this point, the witness cor. to the special meander cor. on the E. and W. centerline of sec. 20, bears East, 0.52 ch. dist., monumented with an alum. post, 2 1/2 ins. in diam., firmly set, extending 4 ins. above ground, encircled by a collar of stone, with alum. cap mkd. WC SMC S20 CC 1985, from which the original bearing trees
	A cedar, 8 ins. diam., bears S. 26° E., 33 lks. dist., mkd X BT.
	A hemlock, 4 ins. diam., bears S. 12° w., 65 lks. dist., mkd X BT.

Meanders of Zimovia Strait
T. 64 S., R. 84 E., Copper River Meridian, Alaska

CHAINS	<p style="text-align: right;">A spruce, 6 ins. diam., bears N. 64° W., 22 lks. dist., mkd X BT.</p>																								
ISLAND IN ZIMOVIA STRAIT																									
<p>From the most northerly point of a small island, situated within sec. 8, the witness cor. to cor. No. 4, Lot 5, identical with cor. No. 9, U.S. Survey No. 3709, both meander cors., bears N. 63°37' E., 20.03 chs. dist., hereinbefore described.</p> <p>Thence with the meanders of the island in a counter clockwise direction, along a gravel and fragmented rock beach, at the line of mean high tide.</p> <table style="width: 100%; border-collapse: collapse;"> <tr> <td style="padding: 2px 10px 2px 0;">S. 69°45' W.,</td> <td style="padding: 2px 10px 2px 0;">0.90 ch.</td> <td></td> </tr> <tr> <td style="padding: 2px 10px 2px 0;">S. 5°56' W.,</td> <td style="padding: 2px 10px 2px 0;">2.20 chs.</td> <td></td> </tr> <tr> <td style="padding: 2px 10px 2px 0;">S. 18°50' E.,</td> <td style="padding: 2px 10px 2px 0;">3.44 chs.</td> <td></td> </tr> <tr> <td style="padding: 2px 10px 2px 0;">S. 47°50' E.,</td> <td style="padding: 2px 10px 2px 0;">1.49 chs.</td> <td></td> </tr> <tr> <td style="padding: 2px 10px 2px 0;">N. 6°05' E.,</td> <td style="padding: 2px 10px 2px 0;">2.88 chs.</td> <td></td> </tr> <tr> <td style="padding: 2px 10px 2px 0;">N. 9°51' E.,</td> <td style="padding: 2px 10px 2px 0;">2.59 chs.</td> <td></td> </tr> <tr> <td style="padding: 2px 10px 2px 0;">N. 61°02' W.,</td> <td style="padding: 2px 10px 2px 0;">0.84 ch.</td> <td></td> </tr> <tr> <td style="padding: 2px 10px 2px 0;">N. 30°20' W.,</td> <td style="padding: 2px 10px 2px 0;">1.08 chs.</td> <td style="padding: 2px 10px 2px 0;">At end of course, the most northerly point of the island, and point of beginning.</td> </tr> </table>		S. 69°45' W.,	0.90 ch.		S. 5°56' W.,	2.20 chs.		S. 18°50' E.,	3.44 chs.		S. 47°50' E.,	1.49 chs.		N. 6°05' E.,	2.88 chs.		N. 9°51' E.,	2.59 chs.		N. 61°02' W.,	0.84 ch.		N. 30°20' W.,	1.08 chs.	At end of course, the most northerly point of the island, and point of beginning.
S. 69°45' W.,	0.90 ch.																								
S. 5°56' W.,	2.20 chs.																								
S. 18°50' E.,	3.44 chs.																								
S. 47°50' E.,	1.49 chs.																								
N. 6°05' E.,	2.88 chs.																								
N. 9°51' E.,	2.59 chs.																								
N. 61°02' W.,	0.84 ch.																								
N. 30°20' W.,	1.08 chs.	At end of course, the most northerly point of the island, and point of beginning.																							

T. 64 S., R. 84 E., Copper River Meridian, Alaska

CHAINS	<p data-bbox="651 289 1013 317" style="text-align: center;">GENERAL DESCRIPTION</p> <p data-bbox="444 373 1411 464">These lands are geographically located on Wrangell Island, on the easterly shore of Zimovia Strait, south of the City of Wrangell, in southeast Alaska.</p> <p data-bbox="444 491 1419 606">The terrain varies from nearly level to moderate sloping hillsides, with numerous small streams that flow in a northwesterly and southwesterly directions.</p> <p data-bbox="444 636 1378 695">Zimovia Strait extends the length of the surveyed area to the west.</p> <p data-bbox="444 724 1456 957">The vegetation consists of a dense forest of spruce, hemlock and cedar, with moderate to thick undergrowth of devils club, buckbrush and blueberry bushes. Portions of the area have been logged and in these areas the vegetation consists of dense young timber. Soil conditions are generally forest litter and duff over bedrock. Numerous maintained and abandoned logging roads traverse through the area.</p> <p data-bbox="444 987 1456 1066">Brown bear, black bear, blacktail deer, small rodents and numerous sea birds are in evidence throughout the area.</p> <p data-bbox="444 1096 1456 1129">The weather is maritime, typical of southeast Alaska.</p> <p data-bbox="444 1159 1438 1218">The survey area is uninhabited, however it is adjacent to the City of Wrangell.</p> <p data-bbox="444 1247 1325 1306">The industry in the Wrangell area is basically logging and fishing.</p>
--------	--

U.S. Department of the Interior
Bureau of Land Management
Alaska State Office, Anchorage, AK

FIELD ASSISTANTS

NAMES	CAPACITY
M. Scott McLane	Field Supervisor
Maxwell J. Best	Party Chief
Brian C. Cameron	Party Chief
Timothy L. Mullikin	Party Chief
Patrick J. Kelly	Instrumentman
David R. Litty	Brush Cutter
Frank H. Kerr	Brush Cutter

CERTIFICATE OF SURVEY

I, M. Scott McLane, for McLane and Associates, HEREBY CERTIFY upon honor that, in pursuance of special instructions bearing the date of the 27th day of February 1989, and under Contract No. YA651-CT9-340059 bearing the date of the 7th day of June, 1989, I have retraced a portion of U.S. Survey No. 3709, retraced a portion of the north boundary, surveyed a portion of the north boundary, and the meanders of the easterly shoreline of Zimovia Strait in Township 64 South, Range 84 East, of the Copper River Meridian, in the State of Alaska, which are represented in the foregoing field notes as having been executed by me, and under my direction; and that said survey has been made in strict conformity with said special instructions, the Manual of Instructions for the Survey of the Public Lands of the United States, and in the specific manner described in the foregoing field notes.

June 4, 1990

Date



Seal

CERTIFICATE OF APPROVAL

BUREAU OF LAND MANAGEMENT
Anchorage, Alaska

The foregoing field notes of the survey described in the Certificate of Survey above executed by M. Scott McLane, Registered Alaska Land Surveyor No. 4928, having been critically examined and found correct, are hereby approved.

8 JUNE 1990
Date

Robert Th. Anderson
Deputy State Director for Cadastral Survey