

See also "Requests for Land Work
1930 to 1944" - 14"

CLOSED

1944

See 14 -

Patents, Applications & Licenses
of the United States

Alaska Road Commission
Anchorage, Alaska
August 21, 1944

Mr. Clyde V. King, Foreman
Alaska Road Commission
Palmer, Alaska

Dear Sir:

We have received a petition in this office for the improvement of a road leading to the Max Sherrod homestead.

Please investigate and see what is required so that you can let us know how much of a job it will be to fix the road up as requested.

Very truly yours

H. C. Edmunds
Superintendent.

MCE/t

Palmer, Alaska,
Aug. 16, 1944.

To Alaska Road Commission,
Mr. M.C. Edmonds,
Anchorage, Alaska.

Dear Sir:-

We, the following citizens of Alaska request that the road terminating at the Max Sherrod farm and joining the Anchorage-Palmer highway, be widened and improved so as to make it an all weather, all year 'round usable road. We the following people live on this road:

R. B. Houston
Mrs. L. P. Morrison
Mrs. B. R. Bouwens
Bernard R. Bouwens
Mrs. John J. Jancke
Mrs. Owen Moffitt
Max Sherrod
Mrs. Emil Larsh
Harry S. Wimmer
Mr. Douglas Sherrod

DEPARTMENT OF THE INTERIOR
ALASKA ROAD COMMISSION
ANCHORAGE, ALASKA
August 21, 1944

Mr. R. B. Heaston
Palmer, Alaska

Dear Sir:

This acknowledges receipt of your letter of August 16, concerning the improvement of a road leading to the Max Sherrod farm.

I will take a look at this road the next time I visit Palmer and see what can be done to relieve the situation.

It is pretty hard to make an all weather, all year round usable road in this country, as this, so far, has been impossible on the main road but if a small amount of work will help you out, we will be glad to do what we can this fall.

Our equipment is all engaged at the present time working on the main road and it is doubtful whether we can undertake any considerable amount of work.

Very truly yours

M. C. Edmunds
Superintendent

MCE/2

UNITED STATES
DEPARTMENT OF THE INTERIOR
ALASKA ROAD COMMISSION
ANCHORAGE, ALASKA
MAY 24, 1944

Mr. Ernest L. Olson
Dillingham, Alaska

Dear Sir:

This acknowledges receipt of a petition signed by various residents of Dillingham and vicinity concerning the condition of the road between Dillingham and Snag Point.

Most of the roads in this area and other parts of the country have been in very poor condition this spring which is to be expected during the time that frost goes out of the ground. This condition happens on roads which are well graveled and it seems that there is very little that we can do about it.

After awhile when the roads dry up we are able to keep them up in fairly good shape but when the frost is coming out of the ground it is hard to fix them.

We have been handicapped during recent years at Dillingham, as in other fishing areas, with lack of help to do any work on the roads. When we are not able to get men to work there is bound to be some deterioration.

I understand that Mr. Herbert Nicholson will be available for a short time this spring to look after the road and am writing to him to try and fix up any bad holes which may require attention before he starts doing other work and hope that they may be fixed so that the road will be in fair shape for the remainder of the season.

Yours very truly,

M. C. Edmunds,
Superintendent.

MCR:p

UNITED STATES
DEPARTMENT OF THE INTERIOR
ALASKA ROAD COMMISSION
ANCHORAGE, ALASKA
MAY 24, 1944

Mr. Herbert B. Nicholson
Dillingham, Alaska

Dear Sir:

I have recently received a petition signed by numerous people in the Dillingham area asking that we try to put some gravel on the worst places on the road between Dillingham and Snag Point. With the lack of labor and scarcity of funds, we cannot expect to keep all the roads in first class condition but we should attempt to fix some of the worst holes so that car travel can pass over the road and avoid criticism.

If it is possible try to put some gravel upon the road so that the people may feel that we are trying to do the best we can under present circumstances.

Yours very truly,

M. C. Edmunds,
Superintendent.

MCE:p

Dillingham --- Kanakanak Alaska.
May 16 1944.

Mr. C. Edmonds.
Alaska Road Commissioner.
Anchorage,
Alaska.

Dear Mr. Edmonds:

We the undersigned residents and property owners of the villages of Dillingham and Kanakanak, do respectfully petition you to have the Dillingham, Kanakanak road repaired as soon as possible. At the present time it is bearly possible to get through with an empty vehicle, there are several places, each a hundred feet long or more, that are absolutely imposible to get through with a loaded truck. The supply boats are due to arrive shortly and we will not be able truck supplies to our respective homes. The entire road is badly in need of leveling off and gravel.

The road between Dillingham and Nelsonville needs graveling badly.

Respectfully submitted,

Ernest L. Olson	
Andrew J. Johnson	
Chris B. Danielsen	Elizabeth Armstrong
P. T. Danielsen	Joe Ismales
Richard B. Osthaus	Murphy Luntzen
Henry J. Raehl	Wick Smith
Te. W. Johnson	Edla Merguson
Earl Malbert	Anna Peterson
Yall Rogerson	Mary Bowman
M. J. MacCall	Mary Smith
W. S. Andrew	Hattie Zimmerman
Chas. Zimmerman	Louise Anderson
Butch Smith	Laura Zimmerman
Matt Flenburg	Marna England
Laura Flenburg	Beatrice Brandon
Edith Flenburg	Louise Arney

Floyd D. Smith
William R. Ingram
[unclear]
[unclear]
[unclear]

Ellen Gurtler
William C. Gurtler
Emma Olson
Ernest Olson Jr.
J. G. [unclear]
Albert Larson

Peter Johnson
Walter Neaddock
Nick Johnson
Cora Johnson

Mike [unclear]
Jaunte Pelagio
Lucille Pelagio

Mary K. Johnson
Lassa Wallona
Crisa Johnson
Martha H. Opland
Katie Hansen
Mary Ann Nelson
John Nelson
Annie Nelson
Emma Johnson
Thomas Nelson
R. E. Gurtler.

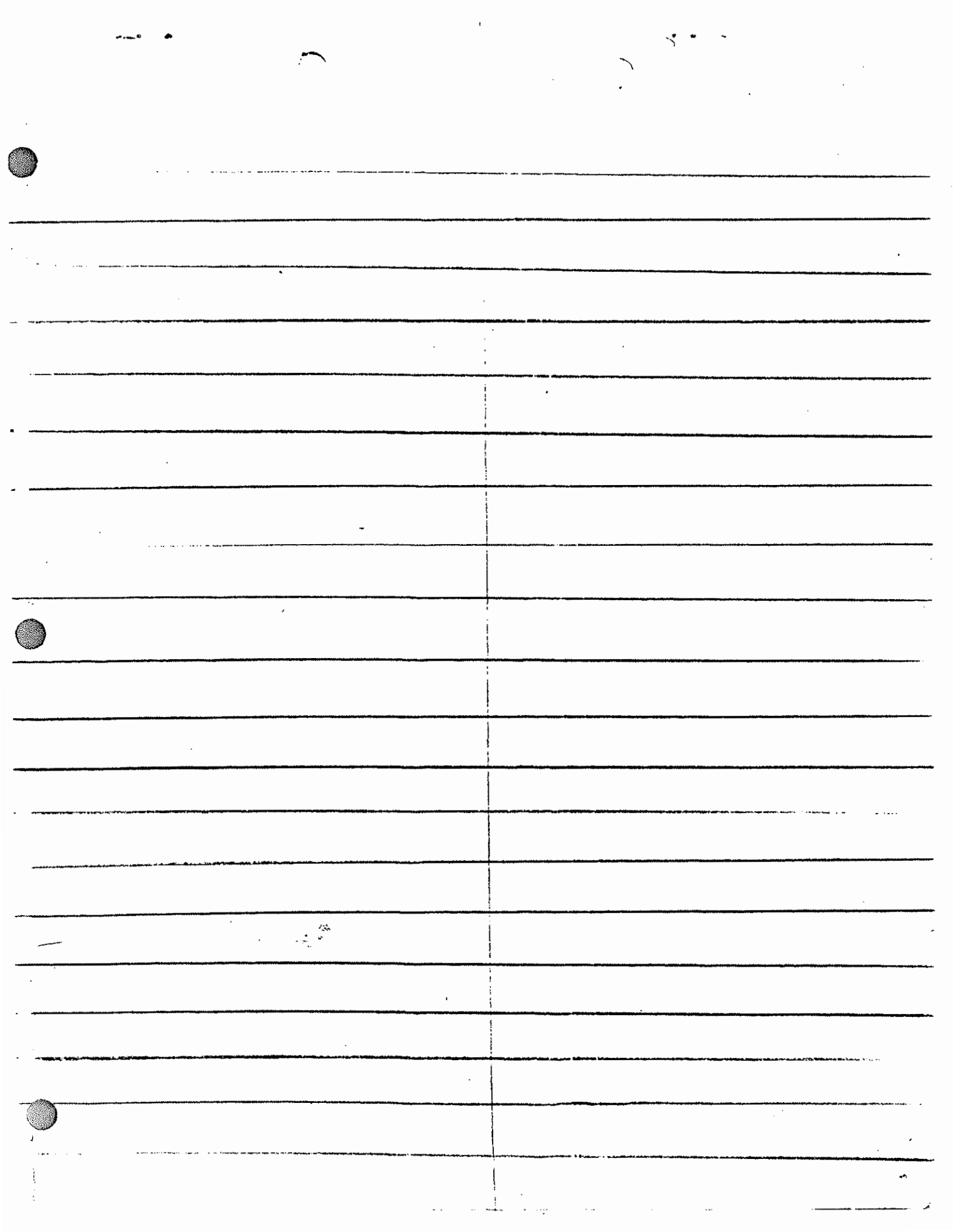

Dillingham Alaska.
April 9 1944.

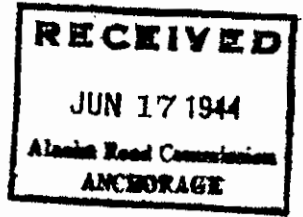

Mr. M. C. Edmonds.
Alaska Road Comm.
Anchorage, Alaska.

Dear Mr Edmonds:

We the undersigned residents and property owners of the Dillingham Community respectfully petition you to permit the Road Commission to gravel the road from the village to the airport and a short side road. The entire length of the roads mentioned is less than one eighth mile. In addition to making these roads passable at all times for the general public's use, these roads would make it possible for approximately thirty families who live near these roads to reach their homes with their supplies.

The equipment here would be ample to do the work which we would like to have done.

Respectfully submitted:

Martin E. Olsen	John P. Mabeck
Perry J. Danielson	Joshia F. Sorenson
Walter Nelson	Lucille Pelagis
Frank Wood	Olava Knudsen
Liva Olsen	Elizabeth Armstrong
Bertha Schroeder	Mrs. H. Vail
Ella Adhison	Red Vail
James Peters	Ellen V. ...
Blanche Nodden	Robert Nielsen
Allice Sawyer	Fleming Whelpley
Nina Nicholson	Kyle ...
Anna ...	Louise Gray
Carl E. Zehring	Floyd D. Smith
Alfred ...	Yael Rozenstein
Mrs. ...	Roscoe ...
Mrs. ...	Lyona ...
Mrs. ...	Virginia Spears
Jaime ...	Leta M. ...
Clyde Spears	Muriel ...

replied
to
A
similar
petition
May 24th
RFE 92-R

W. M. Johnson	Piel Jensen
Thos G. Hardinger	Wib Wells
Joseph T. Jensen	Boice Osterhaus
W. A. Olson	Oliver Brown
L. B. Johnson	John I. Pearson
Math Flensburg	Anna P. Nelson
Thomas J. Thorsen	Peter Nelson
S. G. Kowalski	Mrs. Alice Braswell
M. A. Addison	Emil Samuelsen
Stanley F. Hill	Louise Anderson
Walter Hill	Butch Smith
Simon Gubala	Olga Smith
John G. Smith	John R. Erickson
Chris B. Danielson	Eleph. Aberg
P. E. Walatta	Edla Merguson
Orville A. Braswell	William Ingram
Henry O. Smith	Lillian Gabriel
Arthur G. Smith	Annika Kristensen
Charles Simonsen	Mary Smith

Katie Zimmerman

Fred King

Jim Putwin

Robert Roub

Billie Owens

Elizabeth Larson

Alma Raehl

UNITED STATES
DEPARTMENT OF THE INTERIOR
ALASKA ROAD COMMISSION
ANCHORAGE, ALASKA
February 25, 1943

Mr. I. P. Taylor
Chief Engineer, A. R. C.
Juneau, Alaska

Dear Sir:

I am enclosing a petition received from some residents of Homer for the construction of a road up Fox River which I understand is near the head of Kachemak Bay, also copy of letter sent to the petitioners.

Yours very truly,

M. C. Edmunds,
Superintendent.

MCE:p
Encs

COPY

Homer Alaska
Nov. 12, 1942

Alaska Road Commission
Anchorage
Alaska

Gentlemen:

WE, THE UNDERSIGNED, having homesteads in Fox River Valley, do respectfully petition for a road from near the mouth of the Fox River, extending up the valley approximately eight miles.

At the present time all supplies must be transported by packboard, which makes it impossible to transport products to market.

The formation of the land is such that a road could be made at the base of the hills on the west side of the valley with little difficulty.

Your petitioners are:

Signed: Ethel I. Kavanaugh
Cline S. Koonz
John Dudas
Carle M. J. Kinzel
Wm. A. Eklof
O. R. Russell
Jay G. Bibby
Mrs. Hazel Russell
Chaney D. Phillips

14
Bibby



Box 230
1942

Homer, Alaska
Nov. 12, 1942

Alaska Road Commission
Anchorage
Alaska

Gentlemen:

WE, THE UNDERSIGNED, having homesteads in Fox River Valley, do respectfully petition for a road from near the mouth of the Fox River, extending up the valley approximately eight miles.

At the present time all supplies must be transported by packboard, which makes it impossible to transport products to market.

The formation of the land is such that a road could be made at the base of the hills on the west side of the valley with little difficulty.

Your petitioners are:

Esther J. Kavanaugh

Clive S. Koons

John Dudas

Carl W. J. Kinzel

Wm A & Blf.

A. R. Russell

James L. Bibb

Mrs Hazel Russell

Chancy D. Phillips

UNITED STATES
DEPARTMENT OF THE INTERIOR
ALASKA ROAD COMMISSION
ANCHORAGE, ALASKA
FEBRUARY 25, 1943

Mrs. Ethel I. Kavanaugh
C. F. A. Box 939
Anchorage, Alaska

Dear Mrs. Kavanaugh:

This acknowledges receipt of your letter of Nov. 18th petitioning for a road to be constructed up the Fox River valley, a distance of approximately eight miles.

I regret to inform you that we are concentrating all our men and equipment on roads that are essential to army activities and that it will be impossible to build the road requested at the present time.

We are doing a minimum amount of work on roads already constructed. In the Homer District we have a small crew working during the summer months in order to take care of maintenance of the roads already constructed. The Spit Road was badly damaged during the past few months and it will keep the road crew busy making repairs to this particular road during the coming summer.

Yours very truly,

W. C. Edmunds,
Superintendent

WCE:y

ADDRESS REPLY TO
ALASKA ROAD COMMISSION

UNITED STATES
DEPARTMENT OF THE INTERIOR
ALASKA ROAD COMMISSION
JUNEAU, ALASKA

February 26, 1938

Mr. Frank Clark
Palmer, Alaska

Dear Sir:

Receipt is acknowledged of petition signed by you and a number of other residents of Palmer requesting construction of a road from the main highway near the Matanuska Bridge to the southwest corner of Section 25.

Present indications are that funds to be made available for road work this season will be sufficient only for maintenance and no new projects can be undertaken.

However, your request will be given consideration along with numerous others when and if funds are available to undertake new work.

Very truly yours,

Ike P. Taylor,
Chief Engineer.

IPT:IW
CC Edmunds

14
Petitions

ME
WJH

ALASKA ROAD COMMISSION

Anchorage, Alaska
Nov 12th, 1942

Mr. Ivo P. Taylor
Chief Engineer
Juneau.

Dear Sirs

I am forwarding a petition sent to this office from the residents of Minilchik, asking for the erection of a bridge across the Minilchik River.

With the exception of some logs which were to be hauled from the woods, and about which I have not heard of recently, all of the material for the bridge is supposed to be on the ground, but it would be out of the question for us to send anyone down there in the near future, and it is recommended that this work be postponed indefinitely.

H.C. Edmunds
Supt.

11/21/42
this file

14

Ninilchik
November 2nd, 1942

We the undersigned petition the Alaska Road Commission to erect a new bridge across the Ninilchik River at Ninilchik, Alaska, for the following reasons:--

1. The present bridge is hazardous to anyone crossing on it and may result in the death or serious injury to someone if it collapsed.
2. A bridge is essential to the Community of Ninilchik as the landing field and the Post Office are across the bridge from the town.
3. Sufficient material for a new bridge is on hand in the community.
4. Approximately ten laborers are available in the town.
5. We the people of Ninilchik will assist the Alaska Road Commission in any way possible if they will consent to this petition.

K. Armstrong
John J. Matson
Mike Oskolkoff
Stev Churrine
Alex Kangin
Leroy A. Erickson
Mrs. Bill Kvasnikoff
Ralph Cooper
Mrs. Ralph Cooper
Mrs. Alex Kvasnikoff
Miss Pauline V. Smith
Frank Cooper
Joe A. Leman
Mrs. Louie Kvasnikoff

Mrs. Joe Leman
Mr. Chris P. Steik
Mrs. Chris P. Steik
Mrs. Lars A. Odman
Elmer Kelly
Charley Cooper
Alfred Cooper
Wm. Groke
John Kelly
Mrs. Wm. Groke
Alex Oskolkoff
Simeon Krasnikoff
Sam N. Kraskoff
Joe Leman, Jr.

Ninilchik
November 2nd, 1942

We the undersigned petition the Alaska Road Commission to erect a new bridge across the Ninilchik River at Ninilchik, Alaska, for the following reasons:--

1. The present bridge is hazardous to anyone crossing on it and may result in the death or serious injury to someone if it collapsed.
2. A bridge is essential to the Community of Ninilchik as the landing field and the Post Office are across the bridge from the town.
3. Sufficient material for a new bridge is on hand in the community.
4. Approximately ten laborers are available in the town.
5. We the people of Ninilchik will assist the Alaska Road Commission in any way possible if they will consent to this petition.

K. Armstrong
John J. Matson
Mike Oskolkoff
Stev Churrine
Alex Kangin
Leroy A. Erickson
Mrs. Bill Kvasnikoff
Ralph Cooper
Mrs. Ralph Cooper
Mrs. Alex Kvasnikoff
Miss Pauline V. Smith
Frank Cooper
Joe A. Leman
Mrs. Louie Kvasnikoff

Mrs. Joe Leman
Mr. Chris P. Steik
Mrs. Chris P. Steik
Mrs. Lars A. Odman
Elmer Kelly
Charley Cooper
Alfred Cooper
Wm. Groke
John Kelly
Mrs. Wm. Groke
Alex Oskolkoff
Simeon Krasnikoff
Sam N. Kraskoff
Joe Leman, Jr.

Anchorage, Alaska

December 19, 1941

Mr. Clyde Spears
Billingham, Alaska

Dear Sir:

This acknowledges receipt of your letter December 10,
concerning keeping the road open between Snag Point and
Kanakansk during the winter months.

I am contacting Elmer Nicholson and will have him attend
to this work.

Very truly yours,

H. C. Edmonds
Superintendent

MCE:ls

Anchorage, Alaska

December 19, 1941

Mr. Elmer Nicholson
% Sergeant Oakley
Anchorage, Alaska

Dear Sir:

A request has been received from Mr. Clyde Spears at Dillingham, that the road between Snag Point and Kenakauak be kept open during the winter months assuming that this road will not require to be ploughed out many times during the course of the winter. I have informed Mr. Spears that I would get in touch with you and make arrangements so that the road be kept open.

We will try it out this wintertime and see how much of a job it is to keep the road open.

Very truly yours,

M. C. Edmunds
Superintendent

MCE:ls

Dillingham, Alaska
December 10, 1941

Mr. M. C. Edmunds,
Alaska Road Commission,
Anchorage, Alaska.

Dear Mr. Edmunds:

In view of the dire national emergency which now exists and in view of the fact that the Dillingham-Kanakanak Communities are strategically important as communication centers, would it be possible for you to make arrangements whereby we could have the road between Dillingham and Kanakanak kept open this winter?

We have a radio station here in Dillingham and the Army Signal Corps has a station at Kanakanak. If one of our stations went out of commission we should be able to reach the other in the shortest possible time.

Elmer Nicholson is now in Anchorage, but he expects to return home soon. If you could give us any assistance, you could contact Elmer through the Bristol Bay Air Service.

We sincerely appreciate your kind considerations in the past and hope that you can help us now.

Very truly yours,

Clyde Spears
Clyde Spears

CS/mrs

23
928

Department of the Interior
ALASKA ROAD COMMISSION
Anchorage, Alaska.

September 22, 1941

Mr. C. H. Steiner,
Chief Clerk, Alaska
Assembly, Alaska

Dear Mr. Steiner:

In reply to your letter of September 16 enclosing a letter from the Anchorage Chamber of Commerce concerning the extension of the Campbell Creek road to Mile 105 on the Alaska Railroad.

We are planning on extending the Campbell Creek road the distance of one and one-half miles this fall. We started this road about two years ago and so far have only been able to build about one-half mile of road. There is always so much to do in the summer time without equipment and funds limited making it hard to build the secondary roads without neglecting other work which should be done on our roads.

This has been particularly true during the past few years when we have been called upon to build many roads for the C.A.A. and the Army during the latter part of the season.

The petition calls for the building of four miles of road but according to the way it would take six miles of road to serve the petitioners. Inasmuch as it has taken us such a long time to get around to the Campbell Creek road it is very doubtful whether we would be able to undertake the construction of the additional four miles that will be left to construct after this season's work is completed, especially in view of the relative importance of the roads.

Most of the contemplated in the petition have filed an immediate adjournment to the Alaska Railroad but so far very little work has been done towards developing the highways.

Without making a detailed survey, which is as not possible to do at this time, I would estimate that it would cost between \$25,000.00 and \$30,000.00 to construct the road after this season's work to Mile 105 on the Alaska Railroad.

Very truly yours,

M. C. SHENKINS
Superintendent

MCS/BN
CS Bureau

UNITED STATES
DEPARTMENT OF THE INTERIOR
ALASKA ROAD COMMISSION
JUNEAU, ALASKA

September 16, 1941

Mr. M. C. Edmunds
Superintendent, A. R. C.
Anchorage, Alaska

Dear Sir:

There is enclosed herewith copy of petition
for road construction in the vicinity of Campbell Station.

Please let us have a report concerning
this, including the probable cost.

Very truly yours,



G. H. Skinner
Chief Clerk

Enc.

14
1/2

ANCHORAGE CHAMBER OF COMMERCE

Anchorage, Alaska
Aug. 4, 1941

Alaska Road Commission,
Juneau, Alaska.

Gentlemen:

We are enclosing a petition signed by twelve people, requesting that the Campbell Creek road be extended to mile 105 on the Alaska Railroad. This extension would be approximately four miles in length.

We had a meeting of the Chamber of Commerce this date and a resolution was passed endorsing this petition, and we respectfully request that your body give this all possible consideration.

This would be of great benefit to the people who live on homesteads in this vicinity and would open up further grounds for settlement, also for timber cutting and wood supply.

There are so many reservations around Anchorage at the present time, we are experiencing great difficulty in securing timber and wood.

Thanking you for any consideration you see fit to give this matter, we are

Yours very truly,

ANCHORAGE CHAMBER OF COMMERCE

BY: /s/ R. S. Bragaw
Secretary

C
O
P
Y

To the Alaska Road Commission
Juneau, Alaska.

We, the undersigned, all being homesteaders or land owners in the vicinity of Campbell Station near Anchorage, Alaska, respectfully request you to extend the present Campbell road to mile 105 on the Alaska Railroad. The proposed route is as follows: Beginning at the present terminus of the Campbell road, which is at the N. W. corner of the N. E. quarter of Section 36 of Township 13 North, Range Four west of the Seward Meridian, thence Eastward one-half mile, thence Southward one mile to the Township corner, thence Southward and Eastward to mile 105 on the Alaska Railroad.

This extension would be approximately 4 miles in length.

This road would give a means of travel to us and would open up more land for settlement.

Signature:

Located on

Glen E. Fischer

o o o o o o o o o o

Fred O. Fischer

George Caras

Wm. J. Scott

Nels Axel Johnson

Jay Russell

E. Sperstad

Ann Hauge

Chris Peppademeteo

Fred C. Fischer

Nolan Hamm

Howard Estelle

C
O
PY

Department of the Interior
ALASKA ROAD COMMISSION
Anchorage, Alaska

July 28, 1941

Mr. Ike P. Taylor,
Chief Engineer, A.R.C.,
Juneau, Alaska.

Dear Mr. Taylor:

I am forwarding a petition for the construction of a road leading from Kasilof to Kenai, which has been sent in to this office, one copy addressed to you and one to Mr. Hesse and one to myself. I am also enclosing a copy of a letter acknowledging receipt of the petition.

I understand that about 4 miles of road has already been constructed from Libbey's cannery to the wharves at Kasilof to facilitate the moving of fish from the fishermen who live in this area and who fish between these two points.

I have forwarded Mr. Hesse's copy direct to him without any comment.

Yours very truly,

M. C. EDMONDS,
Superintendent

MCE:8

14

Department of the Interior
ALASKA ROAD COMMISSION
Anchorage, Alaska

July 28, 1941

Mr. Munrad Olsen,
Kasilof, Alaska.

Dear Mr. Olsen:

This acknowledges receipt of your petition dated July 9th, 1941 asking for the construction of a road following the beach from Kasilof to Libbey's cannery at Kenai.

This petition is being forwarded to the Juneau office for their consideration and your letter will be answered from there.

Yours very truly,

M. C. EDMUNDS,
Superintendent

MCE:8
cc - Juneau

PETITION FOR ROAD FROM LIBBY'S CANNERY ON THE KENAI RIVER, TO KASILOF AND CONNECTING WITH THE KASILOF ROAD.

C. W. Edmonds
Supt. Alaska Road Commission
Anchorage, Alaska

Kasilof, Alaska
July 9, 1941

We the undersigned residents of Kasilof and Kenai Vicinity, do hereby petition you to use your influence and authority in the most effective manner to obtain the necessary state approval to construct a road paralleling the beach from Kasilof to Libby's cannery on the Kenai River approximate distance being ten miles.

I. The importance of this project.

- (a) To aid farmers at Kasilof in distributing their farm produce to sill netters, Libby's cannery and Kenai.
- (b) The assurance of delivery of sill net fish to the cannery where as many times due to storms the fishermen cannot make their deliveries to the scows.

II. Number of people served by this proposed road.

- (a) Ten to fifteen farmers would benefit by making this market accessible.
- (b) The salmon caught from approximately fifty sill netters would be transported over this road to the cannery.
(Above sill netters are all residents of Kasilof and Kenai)
- (c) Around 400 people in these two localities would be benefited in various ways.

III. Construction of road.

- (a) This road would not be difficult to construct due to high well drained ground next to the beach.
- (b) No streams larger than culvert size.

NAAMES

Monrad Olsen

ADDRESS

Kasilof

Ray Olsen
Mrs O. H. Tiede
John Canon
O. E. Tiede
H. P. Jensen
Walter Buckinler

Kasilof
Kasilof
Kasilof
Kasilof

Niccolichite

Conrad Peterson
Joe L. Oskolkoff
Jack L. Oskolkoff
Isaac P. Shadrin
James A. Minnow
Alex Johansen
G. F. Johansen
C. D. Crocker
H. H. Oskolkoff
Larry Oskolkoff
Joe Oskolkoff
Othman Kooly
E. A. Mursidan
Mary Kooly
John Sandwich
Harry Heckel
Edward Ladd
A. L. Morkiel
H. J. Berg

Kenai
Ninilchik
Zouichuk
Kenai
Kenai
Kenai
Kenai
Kasilof
Ninilchik
Ninilchik
Kenai
Kenai
Kenai
Kasilof
Kasilof
Kasilof
Kasilof
Kenai

Ed. T. Othe
Alvares Johnson
Bernice Johnson
Blanche Johnson
Isabelle E. Huckel
C. L. Huckel
C. B. Cole
Fred Cole
Ted Johanson
Rachie P. McKane
Stanley McKane
Edward B. Gettle
Lillian Gettle
Ray S. Avery
A. M. Kiser
C. Mc Aubrey
Mrs Wallner
John Johnson
Mark W. Hermann
R. D. Johnson
Forest Peterson
Matrons Peterson

Kasilof
Kasilof
Kasilof
Kenai
Kasilof
Kasilof
Kasilof
Kasilof
Kenai
Kasilof
Kasilof
Kasilof
Kenai
Kenai
Kenai
Kenai
Kenai
Kenai
Kenai
Kenai
Kenai

John Consiel
Alex B. Franck
Mrs. John Consiel
Sig Lindgren

DILLINGHAM IGLOO NO. 28
PIONEERS OF ALASKA
DILLINGHAM, ALASKA
OFFICE OF THE SECRETARY

JUNE 16th.1941.

Mr. Edmunds
Anchorage, Alaska.

Dear Sir:

This is being written in some haste so please excuse the brevity, you will no doubt recall the request I sent you a year ago that something be done on that little strip leading from the hospital straight to the beach,

Jack Bourges told me you had given your consent that he go ahead with it but he was unable to get around to it on account of the amount of work to be done around the hospital, last night I asked Elmer Nicholson if you had notified him regarding the matter, he told me he had had no word from you hence this little reminder Mr. Edmunds, hoping you will give the go ahead signal on something that is needed very badly, I will co-operate as much as it is in my power to help the good work along.

Very truly yours,



Thos. F. Gardiner

112N

Department of the Interior
ALASKA ROAD COMMISSION
Anchorage, Alaska

June 25, 1941

Mr. Thomas P. Gardiner,
Dillingham, Alaska.

Dear Mr. Gardiner:

In reference to your letter of
June 16th concerning the extension of the road near
the hospital at Kanakanak.

I have informed Mr. Nicholson
that he is authorized to do this work, provided
that he has taken care of other projects for several
various people in the locality.

We have been trying to fix up
the road to Nelsonville and the one to the Scandinavian
Cannery for some years, but due to helping out other
departments of the Government, this important work
has been delayed and I have instructed Nicholson
that these two projects must be completed before he
starts on work which is more or less private, and
benefits only one or two persons.

Yours very truly,

M. C. EDWARDS,
Superintendent

MCE:3

cc - Mr. E. Nicholson

Department of the Interior.
ALASKA ROAD COMMISSION
Anchorage, Alaska

June 7, 1941

Mr. Frank H. Waskey,
Aleknagik, Alaska.

Dear Mr. Waskey:

This acknowledges receipt of your letter of June 3rd asking for the use of Road Commission equipment to build a branch road from the Wood River road to your warehouse.

I will instruct our man in charge to do this work for you at some convenient time, with the understanding that you are to pay all the costs. While we are permitted to rent our equipment for use on road work, we are not permitted to rent it to people for other purposes, therefore, I am sorry that we can not dig up the plot of ground you wish for a garden.

We expect to maintain the entire road from Kanakanak to Wood River and the portion of the road you mention will be taken care of by our crew the same as the balance of the road.

If I have an opportunity to come to Dillingham this summer, I will look you up and we can have a talk about the old times.

Best Wishes,

Sincerely,

M. C. EDMUNDS

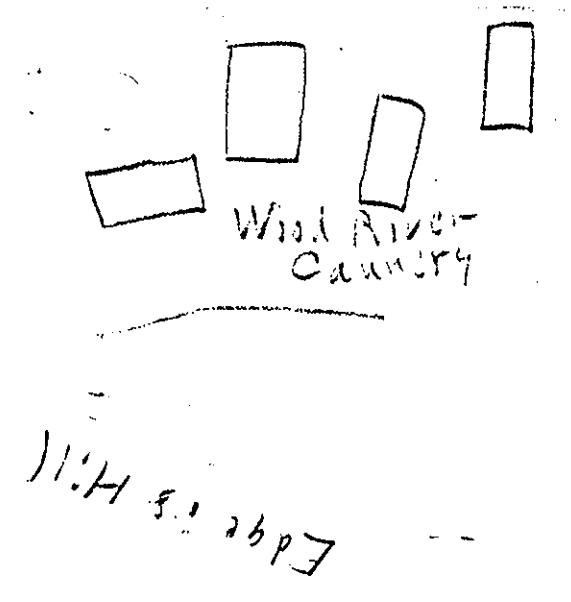
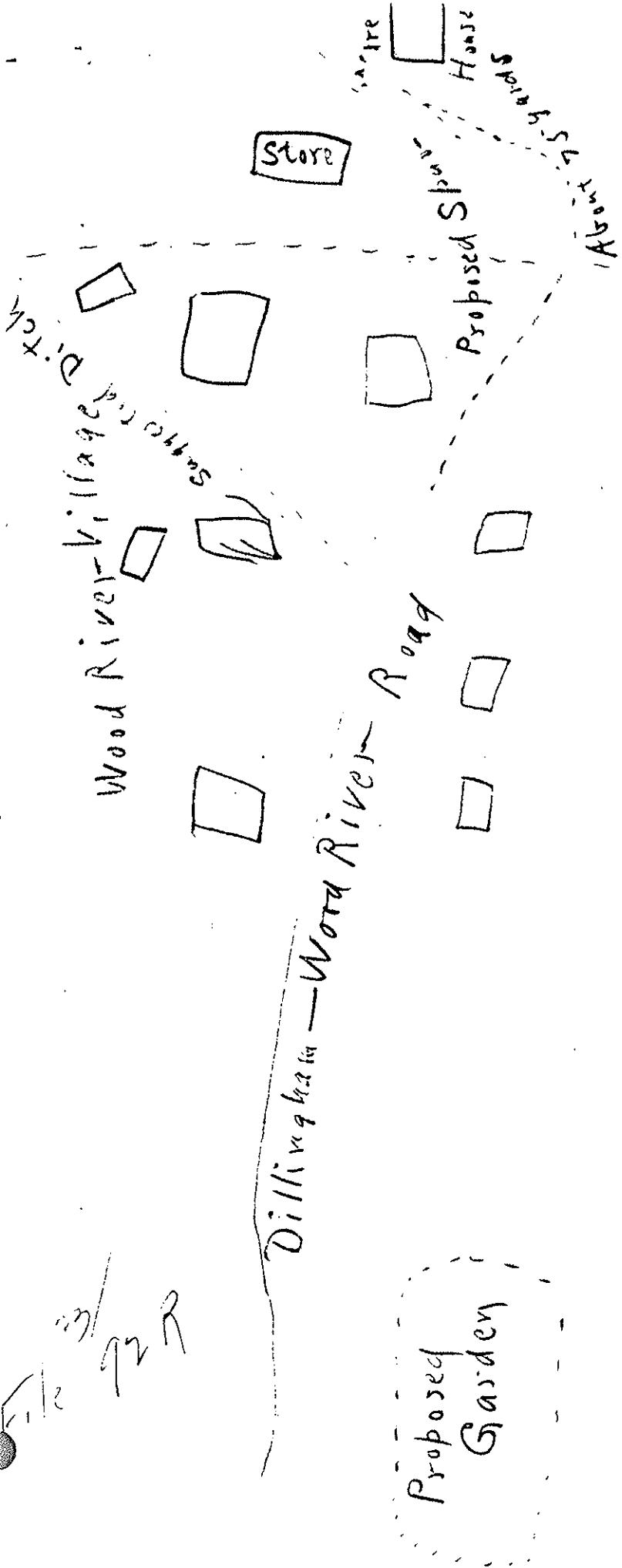

File 112
92 R

FRANK H. WASKEY

Fine Furs

ALEKNAGIK, ALASKA, June 3, 1941

Mr. Chris Edmunds,
Alaska Road Commission,
Anchorage, Alaska.

Dear Mr. Edmunds :

During the summer months, the writer runs a small trading post at Old Aleknagik, just above the Wood River Cannery of the Alaska Salmon Co. I am desirous of grading and gravelling a spur of about seventy five yards from the present road to my warehouse on the beach, as per rough sketch enclosed.

If at a convenient time for your work in this section this summer, I could secure the use of the A.R.C. Bulldozer and your driver, I will gladly pay the Commissions charges therefor. And also pay for the gravelling the spur after grading. *OK*

If it is possible for you to accommodate me as above, I would like also, if time and conditions permit, to secure the use of bulldozer and driver for another day, to dig up a plot of ground, near the road about two hundred yards west of the village, for a garden. *10*

During the past month there has been considerable traffic over the road between Wood River, and Dillingham and Kanakanak.

Recently, I asked Jesse Palagio, who operates 4 Taxis out of Dillingham what percentage of his business was over the road to Wood River. He assured me that much more than half of his business was to and from Wood River. Several of the others operating Taxis also compete for the Wood river Business. Matt Flensburg bases his Waco plane at Wood river, as Shelter is always to be had there and all Dillingham and Kanakanak Bound planes, when the river is rough at those two points come to Wood river to land and load their passengers.

Palagio, Flensburg and Martin Olson have brushed the road in a number of places early in the season. Now that it is dry, the road is in fair shape. When the rains start again, it will be difficult going over four or five short stretches. As the Wood river cannery is not operating this summer, during the canning season, there will be little traffic, altho the road is always a convenience to many.

But from July 25th to September 30th or later, there will again be twenty or more families resident at Wood river.

These folks and their visiting friends do a surprising amount of travel back and forth to Dillingham and Kanakanak .

Also during the stormy fall weather, practically all of the gas boats from interior , down river, and westward points, anchor in Sheltered Wood River and transact their business in Dillingham by plane and truck .

The writer and others earnestly trust that needed maintenance work may be done on the Wood river road during June or July .

Should you come to Dillingham this summer, I hope to have an opportunity to talk over old times with you, and incidentally tell you of my placer prospects up the Mulchatna.

You no doubt have heard that the old Aralik River and Good News sections are steadily if slowly showing up new creeks.

I am told that even old Butte Creek, showed some good bench ground last fall.

Fearing a repetition of conditions during 1917 and 1918 , when I tried to work a lease on Willow Creek at Marshall, I am going slow on my Mulchatna ground.

But if our benevolent Uncle Sam , keeps on paying \$35.00 for the yellow metal, I hope despite its distant location to once more open up a coarse gold creek.

With Kindest personal regards,

I am,

Truly,

Frank H. Warkley.

ADDRESS REPLY TO
ALASKA ROAD COMMISSION

UNITED STATES
DEPARTMENT OF THE INTERIOR
ALASKA ROAD COMMISSION
JUNEAU, ALASKA

January 23, 1941

Mr. M. C. Edmonds
Superintendent, A. R. C.
Anchorage, Alaska

Dear Sir:

There is enclosed a copy of reply to a petition from Ouzinkie for three miles of road thru the village and to Monks Lagoon.

I do not know whether anyone from your office has ever visited this location and unless you have definite information as to the probable location of the road and the type of ground it will cover, it is requested that at the first opportunity an investigation and report be made. If you do not expect to get down to that territory this spring, it might be desirable to have Carl Johnson make a trip to Ouzinkie—if the work at Kodiak is completed in time—before he returns to Anchorage.

Very truly yours,

Ike P. Taylor
Chief Engineer

Enc.

707
LE

DEPARTMENT OF THE INTERIOR
ALASKA ROAD COMMISSION
JUNEAU, ALASKA

January 23, 1941

Mr. G. S. Gugel, and others
Cuzinkie, Alaska

Gentlemen:

Receipt is acknowledged of a petition dated November 25, signed by various residents of Cuzinkie requesting the construction of approximately three miles of road.

In view of the many requests for road construction and improvement and due to the limited funds available for road work in Alaska, I believe it is very unlikely that the work you request could be undertaken during the coming summer. However, at the first opportunity an investigation will be made with a view to determining just what is required in the way of road work and the probable cost.

Very truly yours,

Eke P. Taylor
Chief Engineer

CCM

United Fishermen of Alaska, Kodiak, Alaska
Mr. Hesse, Juneau
Mr. Edmunds, Anchorage

ALASKA ROAD COMMISSION

Anchorage
February 6th, 1941

Mr Carl Johnson
General Foreman
Kodiak

Dear Sirs

The Juneau office has received a petition for the construction of three miles of road from Ousinkie to a place called Hanks Lagoon.

In case I do not get down to Kodiak before you get thro with the widening of the road to the Navy Base, I wish you would arrange to make a trip to Ousinkie at some convenient time and make a report on this project.

The main things we want to know about the project is as follows:

1. The distance of the road.
2. What the construction of it would entail, whether it is grading work, swampy ground, the kind of timber growing on the location, if any.
What facilities and equipment are available for doing the work.
3. What the estimated cost of the work would be.
4. The best way to get the work done, and if labor would be available and at what time it would be best to do the work.
5. If any equipment is available, what the prospect is of being able to rent it, and at what figure.
6. The number of people that would be benefitted by the building of the road, and whether you would consider the construction justified.

Yours very truly

M.C. Edwards
Sup't

C.C. Juneau

The name of the storekeeper at Ousinkie is Mr Grimes.
The petition originated with the "United Fishermen of Alaska", at Kodiak.

Kodiak, Alaska

Mar. 17, 1941.

Mr M.C. Edmunds
Supt. A.R.C.
Anchorage, Alaska

Dear Sir:

I left Kodiak for Uziutkie with Jack Benson of the Game Commission arriving there at noon March 14th and returned to Kodiak in the afternoon of the 16th.

After a stay of a couple hours in the village of Uziutkie we went down the coast three or four miles and camped. From the camp I walked to Monks Lagoon and back over most of the way to Uziutkie.

The distance between Uziutkie and the Lagoon scales 5 miles on the chart and would require about 6 miles of road.

There are some short swamps and small creeks to cross but most of the route is covered with spruce timber up

to 3 feet in diameter. The timbered part is very rough, one high knoll after another, and from the looks of the shore line which is high and rocky, these knolls may have solid rock close to the surface.

The Lagoon is at the south end of the island and as a high range of hills cross the island from north to south and from one half to one mile from the the shore the road would have to be located between the hills and the shore line.

To construct the road would entail heavy clearing and grading and for a passable auto road would cost at least five thousand dollars per mile.

There is no road equipment of any kind in Uziukie. Some labor may be had after the fishing season

I talked to the head of the Fishermen's Union in Kodiak and learned he had never been in Uziukie but still maintained they should have a road because roads are being built in other

sections of the Territory. His only other argument was that there was nothing but green timber for fuel around Uziukie and plenty of drift wood in Monk's Lagoon that could be hauled over the road.

— needless to say this wood can be towed in by boat —

There are a couple hundred persons living in Uziukie and a monk lives at the Lagoon. No sign of anyone living between the two places.

To construct the road would benefit the people of Uziukie to the extent of having a road to joy-ride over and in my opinion is not justified.

Yours very Truly

Carl Johnson
Foreman

ALASKA ROAD COMMISSION

Anchorage
March 27th. 1941

Mr Ike P. Taylor
Chief Engineer
Juneau

Dear Sirs

In answer to your letter of January 23rd, concerning a petition from Ouzinkie for 3 miles of road thru the village to Monks lagoon.

Carl Johnson, our foreman at Kodiak, investigated this project and reports as follows:

* I left Kodiak for Ouzinkie with Jack Benson of the Game Commission, arriving there at noon on March 14th, returning to Kodiak in the afternoon of the 15th.

After a stay of a couple of hours in the village of Ouzinkie we went down the coast three or four miles and camped. From the camp I walked to Monks lagoon and back over most of the way to Ouzinkie.

The distance between Ouzinkie and the lagoon scales 5 miles on the chart and would probably require 6 miles of road.

There are some small swamps to cross, probably 100 yards all told, and some small creeks to cross, but most of the route is covered with spruce timber up to three feet in diameter.

The timbered part is very broken up and rough, one high knoll after another, and, from the looks of the shore line, which is high and rocky, it is believed that rock is pretty close to the surface of the high places.

The lagoon is at the south end of the Island, and as a high range of hills cross the Island from North to South and from one half to one mile from the shore, the road would have to be located between the hills and the shore line.

To construct the road would entail heavy clearing and grading, and, for a passable auto road it is estimated that it would cost at least five thousand dollars per mile.

There is no road equipment of any kind available at Ouzinkie, some labor may be had after the end of the fishing season.

I talked with the head of the fishermen's union in Kodiak and learned he had ~~never~~ never been in Ouzinkie, but still maintained they should have a road because roads are being built in other sections of the Territory.

" His only other argument was that there was nothing but green timber for fuel around Ouzinkie and plenty of drift wood in Monks lagoon that could be hauled over the road.

Needless to say this wood could be towed in by boat at favorable periods.

There are a couple hundred persons living in Ouzinkie and a monk lives at the lagoon. No sign of anyone living between the two places.

To construct the road would benefit the people of Ouzinkie to the extent of having a road to joy-ride over and in my opinion is not justified"

Under these circumstances it is apparent that the expenditure of funds on this work is not merited.

Yours very truly

M.C. Edmunds
Sup't.

UNITED STATES
DEPARTMENT OF THE INTERIOR
ALASKA ROAD COMMISSION
JUNEAU, ALASKA

February 10, 1941

Mr. M. C. Edmunds
Superintendent, A. R. C.
Anchorage, Alaska

Dear Sir:

Reference is made to your letter of January 27 enclosing a petition about the Kodiak garbage road.

Last summer Mr. Hesse advised Warren Taylor that nothing could be done on this project until right of way was obtained along the most favorable location.

I believe your reply to the petition covers the situation and I am not writing directly to the petitioners. It is noted that Warren Taylor signed the petition and he should realize that the petition is unnecessary as the only obstacle to the construction of the road is the matter of right of way, since Mr. Hesse indicated in his letter to Taylor that he would be willing to put up the money for the road if the right of way were made available.

Very truly yours,

Ike P. Taylor
Ike P. Taylor
Chief Engineer

CC Mr. Hesse

ED

14
WJN

ME

UNITED STATES
DEPARTMENT OF THE INTERIOR
ALASKA ROAD COMMISSION
JUNEAU, ALASKA

February 24, 1941

Mr. M. C. Edmunds
Superintendent, A. R. C.
Anchorage, Alaska

Dear Sir:

Reference is made to your letter of
February 19 enclosing petition from Mountain View
Addition together with copy of your reply.

You are correct in your statement that
it will not be the policy of the Road Commission
to provide what amount to City Streets for the residents
of these Additions. I believe that your letter
fully explains this attitude.

Very truly yours,

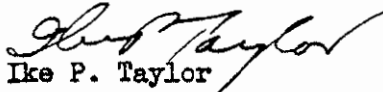
Ike P. Taylor
Chief Engineer

176
0-1-1
WJW

ALASKA ROAD COMMISSION

Anchorage
February 27th, 1941

Mr Ika P. Taylor
Chief Engineer
Juneau

Dear Sir:

In reference to your telegram of the 26th, concerning the proposed road to connect the City of Anchorage with Richardson field referred to in my letter of December 27th, 1939.

The situation in regard to this project at the present time is that, as anticipated, the City is unable to make any satisfactory arrangement with the land owners, and would have to recourse to legal means to get a right of way if the road is extended along Fourth Avenue.

It is now suggested that instead of coming along Fourth Avenue that the road connect with Fifth Avenue, where a road is already constructed past the Aviation field being a portion of the main road to Palmer.

The changing the location from Fourth Avenue to Fifth presents some engineering problems which preclude the locating of the road along "K" street, principally on account of a high bluff which swings in close to fifth Avenue at the point where the road would take off, and other plans are now being considered to build the road along the bench in a Northerly direction instead of running straight North along "K" street.

The changing of the road will still necessitate obtaining right of way thru private property, until a survey is made the land that will be required is not known- whether the land owners will be more cooperative or not remains to be determined- it is assumed that it will still be up to the City authorities to obtain necessary right of way.

In the meantime I am going to look into the situation so that I can advise you as requested in your telegram of the 26th, concerning construction costs, and will send you a telegram this afternoon after investigating the proposed location on the ground concerning estimated costs of building the road.

Yours very truly

M.C. Edmonds
Sup't.

ALASKA ROAD COMMISSION

Anchorage, Alaska
February 18th, 1941

Mr Joe P. Lucere et al.
Mountain View, Anchorage

Dear Sirs

This acknowledges receipt of a petition sent in by yourself and other persons living in the "Mountain View" subdivision, East of the Anchorage Aviation field, to have the streets in the subdivision graded and gravelled in the near future.

While the necessity of your streets being graded up and gravelled is acknowledged, it is not felt that this is a responsibility of the Alaska Road Commission.

It is felt that persons living in subdivisions are somewhat in the same class as persons living in towns- people in incorporated towns are taxed in order to take of their needs, such as roads, sewers water and light service etc, and the Alaska Road Commission is not permitted to do work within the city limits.

While the Mountain View subdivision is not within the city limits of Anchorage, the situation is practically the same, except that you are not incorporated, you have the same problems as the people in the townsite.

The building of streets and their maintenance, whether a town is incorporated or not, is not permitted with our funds, therefore I regret I am not able to do anything for you.

Respectfully

H. C. Edmunds
Sup't.

cc: JAMES

WJN

ALASKA ROAD COMMISSION

Anchorage
February 19th, 1941

Mr Ike P. Taylor
Chief Engineer
Juneau

Dear Sir:

I am forwarding a petition received from the residents of the "Mountain Home View Subdivision", located approximately three quarters of a mile East of the Anchorage Aviation field, asking to have the streets of the subdivision graded up and gravelled, and a copy of my reply thereto.

They claim that ninety two homes have been erected, that children have to come to Anchorage to school, that household necessities have to be delivered to their homes continuously, and that the men have to travel back and forth to work on the airbase project.

While the residents of the local subdivisions have mostly been in difficulties during the storm about ten days ago, obtaining no help from the Alaska Road Commission in opening up their streets, there is going to be a terrible mess later on in the spring, when the ground begins to thaw.

At this time, no doubt, there will be frantic calls and demands made for assistance, not only from this one subdivision, but several others located South and East of town.

With the extra traffic in this vicinity, we will have our hands full with the main roads in the spring- it has been nip and tuck the past few years keeping the roads open during the breakup- we used two different routes and a detour last spring to travel between Anchorage and Whitney, and conditions are going to be much more severe this year than at any previous time.

Even if we were authorized to do some work for these people, which I understand we are not, it would be impossible for us to do anything at a time when we have our hands full keeping the main arteries open.

While no doubt you understand this situation, I am commenting upon it at this time so that I may be advised in time in case there may be some change in the policy of not doing any work for persons living in subdivisions outside the town limits.

While the petition states that a number of homes have been built, the majority of the houses observed seem to be mostly shacks.

Yours very truly

M.C. Edwards, Sup't

WJW

Anchorage, Alaska
January 17th, 1941

PETITION.

The Alaska Road Commission

Sir:

We, the undersigned, respectfully petition your department to grade and gravel the streets in the Mountain View addition to the City of Anchorage, Alaska, and in support of this petition we represent that we are bona fide residents of such addition, that ninety two homes have been erected and are now occupied, principally by families; that the present condition of the streets are such that it is an unnecessary effort to secure deliveries of household requirements, and is inconvenient for children attending school and for adults to reach the bus line and we recommend that an early effort be made to relieve this condition.

Respectfully submitted

Joe. P. Lucero
Edmund Samve
O. Stanley Tollfson
Peggy Le Blanc
Leon F. Le Blanc
Henry O. Hansen
John A. Vancouver
Ethel A. Ross
Dan S. Ross
Kay Westoner
Roy F. Turner
Thelma Sauve
Mary J. Baehm
Joseph F. Baehm
Ora Gans Collier
Ernestina Adams
M.E. Edmonds
Mrs Simon Hebert
Nellie Edmonds
A.R. Wassenkan
Thelma Wassenkan
Norene Lucero
L.N. Sprague
Mr Torbergson
Mrs
Norman G. Lange
Ann Lange
Lorraine Cuendet
Lamon Bayle

Clara Rosen
James Rosen
Frank R. Vaile
Rita Hamlin
Roy Hamlin
Earl Petrie
Mrs M.E. Petrie
Willis K. Larsen
Myrtle M. Larson
Mr Lawrence Hutchings
Ida J. Hutchings
Alex Jourdain
Ellen Jourdain
Mr W.H. Darch
Mrs W.H. Darch
Eva Starbard
Roy Starbard
Velda Starbard
Roy Starbard Jr
Vera Warehime
Guy
Mrs S.P. Garton
Marie Struthenberg
Lowell R.
Miles T. Burrell
Henry Beyer
H.L. Godard
Leon L. Dudley
Mrs Douglas Pranzitz

Douglas Pranzitz
Mrs Ken.L. Pranzitz
Ken L.
F.D. Hancock
J.T. Wallace
Mrs F.D. Hancock
Betty Miller
Joe M.V. Miller
Frank Rowley
Stanley L. Rinehart
Edith C. Rinehart
Mr Herman Black
Mrs
Peggy Foster
Eugene Foster
Simon Dlafert
Warren Adams
Alvin J. Collier
Roy L. Slyter
W.F. Delap
Howard L. Beebe
E.W. Hall
Andrew A. Bandy
Dale Pierce
Arthur J. Flatt
Dolly Rose
Elsie M. Stanton
Donald J.

Neva Stiles
Carrol
Rolls L. Kintz
Mrs Edwin Bobrofski
E. A.
Ester Hanson
Dan McCullough
Mrs Dan McCullough
This C. Price
Rob't H. Romig

KODIAK PETITION Sheet No. 2.

Signers.

Ray Dell
Mrs Ray Dell
Alf Madsen
Arthur L. Beck
H.H.Lander
Barley G. Barton
Mrs J. Laughran
Nick Lehr
Alf Forgransen
Mrs Alfred Liam
Bill Morgan
Mrs Ita Morgan
Mrs Ben Kraft
Mrs H.F.MacDonald
H.F.MacDonald
Harry Morrison
Mrs Una McDonald
Angel Valensucha
S.H.Sears
Rudolf Wukstrom
Herman Felder
Geo. E. Waterman
Chas F. Toback
Dallas N. Hogline
C.H.Johnson
Charley Cook
Henry J. Horn
Ray Martin
Tom Grenin
M.J. Coon
Jack Hansen
Tim P. Gilmore
Clark Odekirk
Harry H. Farmer
O.E.Olsen
Fred Folberg
E.J.Gustafson
C.B.Warren
Carl Hayts
T.J.Clark
Jack Cousens

Oscar Sackerson
Mrs Scott Stream
Scott Stream
Alvin J. Moore
Isaac Hubley
B.H.Vigas
Donald Heaton
Herna Formson
R.F.Snyder
G.L.Sherman
Wm Hardin
Jesse Nelson
Chas D. Hopp
Cliff Sumerlin
S.B.Thorshelm
Bill Wynkoop
Enoch Uniler
Andrew Petersen
Mrs Andrew Peterson
Eli Matrokin
Mrs "
Lrocul Sears
Mrs A. Liets
Oscar Nelson
Mrs "
F.A.Feraman
Sig Krogetad
Louis Jensen
Freda Blinn
Marvin L. Larsen, Jr.
Cecil E. Helsel
Kelly Orgaroff
Ed. Mense
Elvin Allensten
Ralph Hansen
Karl Brunstad
Edward Getty
Chas G. Naughton
Emma Naughton
Floyd Garner
Joe Tyler
Jurig Swan

C.Sillethmon
Sid W. Old
Tom Williams
Harry A. Hank
Steve Harneys
Vera Pierce
Wayne Walclup
Mary Wilson
Raymond Cole
Barbara Demidoff
Real L. Larsen
Wilton White
Daggar Hansen
William Frame
Clayton Deland
Walter Otto Kraft
Wm Miller
Louie Thompson
W.A.Thomas, Sr.
R.V.Kotoff
Martin Gabrielson
Emil Knudsen
John Hubley
John Thevik
Jack Allman
Frank Marshall
Jessie Marshall
Clarence W. Selig
Warren A. Taylor
Gene D. Hotavitsky

It is noticeable that Erskine and his employees have not signed this petition, neither has Dr Johnson.

L

PETITION
TO THE
ALASKA ROAD COMMISSION

We, the undersigned residents of Kodiak, Alaska, respectfully submit petition for the following road work, which is outside the corporate limits of the town of Kodiak; namely, an extension to the present Mission road to and thre the homestead of C.E. Bryan.

This road is needed to serve the homesteader and further serve the town of Kodiak because it is contemplated to locate the city dump at the end of the road requested in this petition

NORMAN Nebbe

Jess Blinn

J.W. Judge

E. Bakke

Jack Graham

Al Manihant

E. Mejnusen

Gee. Magnusen

Nicholas Duff

R.H. Chadwick

Carl W. Pajoman

Harry Neryen

Talmage L. Smith

Frank M. Herman

R.J. Lee

C.W.Hinds

S.W. Burdman

L.R. Bemis

Robert Mahle

Charlie Marchall

R.E. Naughten

C.E. Alexander

Jack Olsen

Fred A. Henton

W.E. Hansha

H.G. Date

J.N. Rhodes

G.A. Robinson

Julian S. Ash

F. Latitonen

Ben Kraft

Chas M. Holden

W.A. Andersen

Alfred Lian

Clarence H. Freeman

Lionel Shuravloff

Midge Long

Karl Armstrong

H.F. Polter

Mrs O. Mahle

R. Gillis

Walter Panamaroff

Victor Norton

Anton Kvas

Emmet P. Conlin

W.E. Japman

G.W. Nielsen

G.A. Phillips

Wm H. Hollier

Fritz Morrison

Arkadie Pestrieff

Wile R. Kapp

Stanley C. Gray

Julien Morrison

C.P. Haugen

Fred Mahle

John Blom

Mrs Fred Mahle

K.C.L. Carlson

Ben Guytness

Sally King

Shirley George

G.D. Daally

Sterling Alfred

John M Brodikorb

A.H. Buseby

Stuart H. Mickels

Newt Ingersoll

Nels Lantz

Dan McCall

D.B. McKinlay

Joe Anderson

R.J. Leendertsen

Jack Liptrap

Mrs Jack C, Liptrap

Harry T. Becker

A. Morrison

Mike G. Putselos

Harry Brown

J.M. Steffgen

Jorgen Felduska

Christine Larsen

Seth Fersgren

Andrew Torland

R.C. King

C.R. King

Mrs C. King

Mike Agelff

Jack Delane

Mrs Jack Delane

Dr A. Bates Jones

Mrs A. Bates Jones

R.L. Lunday

George O. Thompson

George D. Scroggs

H. Olafsen

Malvin Johnson

John Holland

David Shapiro

O.S. Campbell

Miral D. Chase

Archib Greblay

W.E. Falconer

R.F. Pollman

Fred Whited

Jack King

Stella Anderson

L.L. Shaw

Andy Jergensen

E. Scoria

Helen King

A.W. Combes

B.E. O'Neill

Fred E. Lang

Ross Nutley

Al King

Mrs Glen Palmer

Mrs C.E. Helsel

J.M. Kessler

Paul G. Homnes

S.D. Austerman

Irene Enges

Sadie Herring

Georgia Sumerlin

Fred Sargent

Lloyd W. Swan

Oscar Bremick

Chas Madson

ALMER J. PETERSON
ATTORNEY AND COUNSELOR AT LAW
ANCHORAGE, ALASKA

September 17, 1940

Mr. M. C. Edmonds
Superintendent Alaska
Road Commission
Anchorage, Alaska

My Dear Mr. Edmonds:

Inclosed find petition mailed to me from residents of Palmer, asking me to see that the letter got in the proper hands.

Knowing that you were the right person to send the petition to, I am doing so, hoping that you can help those people out.

I am,

Very truly yours,



sgp/AJP

ALASKA ROAD COMMISSION

Anchorage
Sept. 18th, 1940

Mr Almer Peterson
Attorney
Anchorage

Dear Mr Peterson:

This acknowledges receipt of your letter of September 17th, forwarding a petition signed by various homesteaders at Palmer for the improvement of a road running North past the house of Ed Useek.

While our funds for this season are practically expended, I will look into this situation the next time I am in that vicinity with a view of making any improvements possible with our limited funds.

This road has already been graded by the Alaska Road Commission, and should not require much work to put it in good shape as far as grading is concerned, and no doubt we will be able to do something to grade it up, altho there is not much chance of putting gravel on at this time.

Yours very truly

M.C. Edmunds
Sup't

ROAD COMMISSION

WHEREAS: All public market roads are graded and surfaced in the Palmer district, we the undersigned are making a written request that the Public Road, extending due North of Palmer, and which continues North where the Palmer--Anchorage road turns to the East about 3/4 of a mile North of town, be graded and graveled for about 2400 feet, beginning at the Ed Ueck place.

WHEREAS: This road has considerable traffic

WHEREAS: This road is almost non-passable during bad weather

WHEREAS: this road will be used for a to market road

WHEREAS: It will serve as a year around road to several home owners, with the possibility of many more, We the undersigned feel that this is a just and reasonable request

Osa L. McVicker
Virgil McVicker
W. A. Sherrod.
T. A. Smith
Edw. A. Ueck.
Lance Sjodin
Max Sherrod
H. W. Anderson

UNITED STATES
DEPARTMENT OF THE INTERIOR
GENERAL LAND OFFICE
DISTRICT LAND OFFICE
Alaskan Fire Control Service

CCC
COOPERATION
Alaska Road Commission

Anchorage, Alaska
July 20, 1940

Mr. C. E. Edmunds
Superintendent
Alaska Road Commission
Anchorage, Alaska

Dear Mr. Edmunds:

Reference is made to the road petition submitted to your office for building a road south of the Oil Well road for an approximate distance of 2-1/2 miles which would serve a group of homesteaders located in that region.

Please be advised that if your organization will make the road survey, we will be glad to cooperate with you in the construction of this road.

Our work will consist in slashing, clearing the right-of-way and other hand work, such as placing corduroy on the swampy sections.

All of the above will, of course, be contingent upon the availability of CCC labor.

Very truly yours,

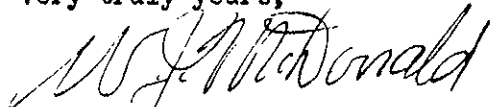

W. J. McDonald
Senior Forester

Enclosure
Extra copy for Mr. Edmunds

ALASKA ROAD COMMISSION

Anchorage
Sept. 13th, 1940

Mr W.J.McDonald
Senior Forester
Alaska Fire Control Service

Dear Mr McDonald:

In reference to your letter of July 20th, concerning the building of 2-1/2 miles of road South of the oilwell road to serve a group of homesteaders located in that area.

The Alaska Road Commission has made a survey for this road for a distance of one and a half miles South of the Oil well road, which takes in most of the persons who are interested at this time.

The location follows the property lines, conforming to the general practise of this office of keeping on the section or centers of sections where practicable where the locality is thickly settled.

Yours very truly

M.C.Edmonds
Sup't.

ALASKA ROAD COMMISSION

Anchorage
August 12th, 1940

Mr Ike P. Taylor
Chief Engineer
Juneau

Dear Sir:

I am forwarding a petition received recently from some homesteaders off the Oilwell road, together with a letter from Mr W.J. McDonald Senior Forester, concerning the project.

As Mr McDonald is interested in getting work for the CCC, and this road will serve the purpose of the road which was proposed to be built South of the Oilwell road, but which is now abandoned on account of being in the Army reserve, I have informed Mr McDonald that we would make the survey when we had a man available.

There is only necessity for two miles of road at this time, as it is hard to say, the way houses are springing up all over the country here, how much more may be needed by the time we get around to making the survey.

Yours very truly

M.C. Edwards
Sup't.

TO THE ALASKA ROAD COMMISSION:

We, the undersigned, all settlers in Sections 12.17-4, T13N, R3W
petition the Road Commission for a road survey.

Mr. McDonald, of the Fire Control Office, has referred us to
you.

Blaine M. Cunningham

Erik Hilding Anderson

John DELORNE

Marie P. Johnson

R. H. Fidler

Anchorage, Alaska
July 16, 1940

TO THE ALASKA ROAD COMMISSION

We, the undersigned, allsettlers in Sections 12-13 and 14, in Township 13 North, Range 3 West of the Seward meridian, petition the Alaska Road Commission for a road survey to serve our homesteads.

The distance of the road is about two miles, with a possible extension of one half mile more.

Signed

Blanche Cunningham

Erik Hilding Anderson

John DeLorne

Marion R. Johnson

R.H. Fidler.

Anchorage, Alaska
July 16th 1940

ALASKA ROAD COMMISSION

Anchorage
August 13th, 1940

Mr Ike P. Taylor
Chief Engineer
Juneau

Dear Sir:

I am forwarding a petition received from persons living along the Otis Lake road and an extension towards Geese Lake, which would call for the building of a road about one and a half miles from the end of the present road near the radio beam station of the Caa, which would serve about ten persons.

The clearing on this road is very light, and it would be very easy to construct, it is estimated that a secondary road could be graded up with 20% as surfacing for \$2,000.00, about half of this distance is already covered by the present road to Otis Lake.

A lot of people seem to be living in this vicinity, and the building of this road is recommended.

Yours very truly

M.C. Edmunds
Sup't.

August 9th, 1940

PETITION: To the Alaska Road Commission

SUBJECT: Improvement of the road known as the ^{old} Lake Otis Road , and its Extension to Goose Lake, and to homes en route.

We the undersigned, being residents in the district served or reached by the above named road, do petition the ~~Alaska~~ Alaska Road Commission to improve and maintain the above named road so that we may be able to use said road in commuting to Anchorage and to enable our children to attend school.

SIGNED.

H. B. Sutherland

John Karth

C.B. Atkinson

C.E. Gallagher

Peter Close

Melvin D. Hermansen)
Leona Jean ") one family
Leonard ")

Charles Hermansen)
Julia ") one family
Bernice E. ")

There are three other parties interested who were not available to sign the petition

Petition for the improvement of the Lake Otis Road

H.B Sutherland lives in the	Northwest 1/4 of Section 29
John Karth	" ditte
Peter Close	Northeast ditte
C.E.Gallagher	" ditte
Melvin D. Hermansen ?	Northwest Section 28
"	Southwest " 21
Hermansen ?	North half of section 28
C.B. Atkinson	ditte.

August 9th, 1940

PETITION: To the Alaska Road Commission

SUBJECT: Improvement of the road known as the ^{old} Lake Otis Road, and its Extension to Goose Lake, and to houses en route.

We the undersigned, being residents in the district served or reached by the above named road, do petition the Alaska Road Commission to improve and maintain the above named road so that we may be able to use said road in commuting to Anchorage and to enable our children to attend school.

SIGNED.

H. B. Sutherland

John Karik

C. B. Atkinson

C. E. Gallagher

Walter Glase

Melvin D. Hermanson

Leona Jean "

Leonard "

} one family

Charles Hermanson

Julia "

Bernice E. "

} one family

There are three other parties interested who were not available to sign the petition

ALASKA ROAD COMMISSION

Anchorage
August 12th, 1940

Mr Ike P. Taylor
Chief Engineer
Juneau

Dear Sir:

I am forwarding a petition received recently from some homesteaders off the oilwell road, together with a letter from Mr N.J. McDonald Senior Forester, concerning the project.

As Mr McDonald is interested in getting work for the CCC, and this road will serve the purpose of the road which was proposed to be built south of the Oilwell road, but which is now abandoned on account of being in the Army reserve, I have informed Mr McDonald that we would make the survey when we had a man available.

There is only necessity for two miles of road at this time, altho it is hard to say, the way houses are springing up all over the country here, how much more may be needed by the time we get around to making the survey.

Yours very truly

M.C. Edmunds
Sup't.

TO THE ALASKA ROAD COMMISSION

We, the undersigned, allsettlers in Sections 12-13 and 14, in Township 13 North, Range 3 West of the Seward meridian, petition the Alaska Road Commission for a road survey to serve our homesteads.

The distance of the road is about two miles, with a possible extension of one half mile more.

Signed

Blanche Cunningham

Erik Hilding Andersen

John DeLorne

Marion R. Johnson

R.H.Fidler.

Anchorage, Alaska
July 16th 1940

Kodiak, Alaska
May 15, 1940

Mr. Chris Edrunds
Superintendent, Alaska Road Commission
Anchorage, Alaska

We, the undersigned, all residents and property owners along the hillside extending from the ^{Greek} above the old Russian cemetery, in that part of Kodiak, Alaska, known as "Brooklyn", to that unnamed stream flowing easterly from the Friskine dam, respectfully request the Alaska Road Commission to grade a road along the said hillside for the use and convenience of the undersigned, as there is at present no roadway serving that part of the town of Kodiak, Alaska.

Blance Lewis
Albert Carlson
George O. Thompson
Chris Jensen
Mrs. Chris Jensen
Mrs R. P. Gophey
Roy P. Gophy
W. A. Petri
A. V. Elf
Loene Erriis
Betty Harrop
Ben Kraft
Widge Long
Phoebe Buchanan
Mrs. C. McKellar
Mrs. E. H. Van Meter
Carl W. Pajoman
T. L. Smith

John Stenlund
Elmer B. Harroy
W. P. Harris
George Dalilo
B. L. Shackelford
Wanen A. Taylor
H. E. Smith
I. E. Aver
Frank W. Lippard
Mrs. F. W. Lippard
Mr. and Mrs. Carl Hinkle
R. V. Langhead
Mrs. B. B. Thor sheim
Mrs. Cecil E. Hensel
Cecil E. Hensel
Margaret Roman
Freelov Fell
H. W. Edwards

UNITED STATES
DEPARTMENT OF THE INTERIOR
ALASKA ROAD COMMISSION
JUNEAU, ALASKA

May 13, 1940

Mr. B. J. Bingle
Palmer, Alaska

Dear Mr. Bingle:

Your letter of April 29 (enclosing petition) addressed to Mr. Edmunds regarding the road to Fish Creek has been referred to this office.

The road from Knik to Fish Creek, as you state, was built by private interests, and Mr. Hesse, the Territorial Highway Engineer, recently received a letter from Mr. McDougal requesting the territory to take over the maintenance of this road. Mr. McDougal stated, however, that he would expect to be reimbursed for the cost of the construction of the road if it were taken over as a public road. There is absolutely no way in which either the Territory or the Alaska Road Commission could reimburse Mr. McDougal and others for the construction of this road. Before the construction was undertaken by private parties the project was referred to both the Territory and the Road Commission and because of the purpose for which the road was desired neither agency felt justified in undertaking the work. It appeared at that time that the only reason for the road was to enable the mine operators to handle their freight somewhat cheaper than by way of The Alaska Railroad thru Wasilla. While this undoubtedly made a desirable project from the standpoint of the mine operators, it did not appear to justify its construction with public funds. I am sorry that I can offer you no encouragement on this portion of the request.

The road from Wasilla to Knik will be maintained as in former years so that it is at least passable. We are not in a position to provide a surface for the entire road at this time.

Very truly yours,

cc Edmunds -

Ike P. Taylor
Chief Engineer

ANCHORAGE
MAY 3rd, 1940

TAYLOR
JUNEAU

PETITION IN MAIL FROM BINGLE RE MAINTAINING ROAD FROM KNIK TO FISH
CREEK STOP SINCE MAILING HAVE RECEIVED LETTERS ON SAME SUBJECT FROM
GENERAL MANAGERS OF THE COOPERATIVE ASSOCIATION AND THE ARRC WHICH ARE
BEING FORWARDED JUNEAU

EDMUNDS

ALASKA ROAD COMMISSION

Anchorage
May 2nd, 1940

Mr. I. P. Taylor
Chief Engineer
Juneau

Dear Sirs:

I am forwarding a petition received in the last mail from the Rev. B. J. Bingle, of the Presbyterian Church, at Palmer, relative to the maintenance of the road leading from Knik to Fish Creek, this being a portion of the road built by McDeugal and the Cadwallader interests leading from Knik to Geese Bay.

They also ask for the construction of a short spur leading from the road at Fish Creek towards deep water, so that they can get beyond the mouth of Fish Creek to do their fishing.

Yours very truly

H. C. Edmunds
Sup't.

ALASKA ROAD COMMISSION

Anchorage
May 3rd, 1940

Mr Ike P. Taylor
Chief Engineer
Juneau

Dear Sir:

In reference to my letter of May 2nd, concerning a petition started by the Rev. B.J. Single, of Palmer, for the maintenance of the road from Knik to Fish Creek, and the construction of a short spur from Fish Creek to the fishing grounds, I am now enclosing two additional letters received on this subject, one from Mr Steck, the general manager of the Matanuska Valley Farmers Cooperative Association, and the other from Mr Herbert C. Hanson, the general manager of the Alaska Rural Rehabilitation Corporation.

Yours very truly

M.C. Edmunds
Sup't.

ADDRESS REPLY TO
ALASKA ROAD COMMISSION

UNITED STATES
DEPARTMENT OF THE INTERIOR
ALASKA ROAD COMMISSION
JUNEAU, ALASKA

March 5, 1940

Mr. Geo. H. Weatherell, Secretary
Talkeetna Commercial Club
Talkeetna, Alaska

Dear Sir:

Mr. Edmunds has forwarded to me a petition signed by you and other residents of Talkeetna and vicinity, requesting improvements of the winter trail from the lower Peters Creek crossing to Cache Creek.

You are advised that this work will be included in our program for the coming season and will no doubt be carried out early this fall.

Very truly yours,

Ike P. Taylor
Chief Engineer.

CC Edmunds
IPT:IW

WIN

UNITED STATES
DEPARTMENT OF THE INTERIOR
ALASKA ROAD COMMISSION
JUNEAU, ALASKA

March 6, 1940

Mr. C. C. Brix
Palmer, Alaska

Dear Sir:

Receipt is acknowledged of your letter of February 22 and of two petitions signed by a number of residents for the construction of a road up Moose Creek. In view of the limited funds available it is unlikely that it will be possible to undertake the construction of this road during the coming season. Practically all of our funds are required for maintenance and necessary improvements of the existing roads.

You may be assured, however, that this project will be given consideration along with numerous others which have been requested, when funds are available.

Very truly yours,

Ike P. Taylor
Chief Engineer

IPT:IW
CC Edmunds

NE
WJN

ALASKA ROAD COMMISSION

Anchorage
Feb. 16th, 1940

Mr. Iles P. Taylor
Chief Engineer
Juneau

Dear Sirs:

I am forwarding a petition sent in by the "Palkeena Commercial Club", concerning the necessity of doing some work between the Peters Creek bridge and Cache Creek, particularly with reference to a winter road, with recommendations that changes are made from the present route, which goes up Black Creek, so that the road is taken out of the creek bottom and put on higher ground on their bench so that a lot of wet ground is avoided which has to be bridged in many places when crossing Black Creek.

As far as I am aware the statements made in the petition are correct, there would not be much work entailed to change the winter road between Peters Creek and Spruce Creek, but I would hesitate, without going over the ground, to say what could be done towards going up the left bank of Cache Creek, where many high banks are cut by the streams.

While there is some doubt or uncertainty concerning the future of the operations of the Peters Creek Mining Co, there is no question but that this road serves a large number of people during the summer time, and I feel that this road should be gravelled as programmed to the crossing of Upper Peters Creek to take care of the numerous outfits in this area.

It is also true that this road is of no value as a winter road to outfits above the canyon, or to operators on Cache Creek, under ordinary conditions, as it would be too dangerous to freight thro the canyon during the winter or spring.

The work done along the winter route to Spruce Creek would also benefit the Palkeena district, where mining has been on the increase during the past few years.

It is believed that the work requested to Spruce Creek would be a great help to the miners in the Cache Creek district, and as a large number of the operators are in favor of it it is recommended that it be done this year, especially as very little work has been done for the Cache Creek operators for many years.

Yours very truly

H.C. Edmunds
Supt

C O P Y

Talkeetna, Alaska
February 12, 1940

Alaska Road Commission
Anchorage, Alaska

Attention: Mr. M. C. Edmunds

In accordance with the conferences with Mr. Taylor, at Juneau, and with you at your office in Anchorage, we submit herewith the outline of a program that we believe would prove beneficial to all of the interests of Cache Creek; Dutch Creek; Upper Peters Creek, and the Fairview Districts.

With the road now in existence between the Susitna River Landing, opposite Talkeetna, and the Peters Creek Bridge, good for both Summer and Winter hauling, we feel that the interests of everyone concerned would be best served by a program calling for extension from Peters Creek Bridge, directly over the high ground extending from the far end of the bridge to the Black Creek Summit; thence, by way of Spruce Creek, up the Left Limit of Cache Creek.

Under present road conditions all of our Winter freighting is by way of Lower Marten Creek and Black Creek to the Summit, and thence by way of Spruce Creek and the valley floor of Cache Creek. Use of this route entails the construction of many bridges along Marten and Black Creeks, and as these crossings go out every Spring the work must be done over each year. Also, the present route up the valley floor of Cache Creek necessitates the building of many bridges each year.

It seems to us that if the first two hills, situated a short distance beyond Peters Creek Bridge, are bulldozed to grade, and a road bulldozed up the Left Limit of Cache Creek, that the Winter movement of freight will be greatly expedited and the per ton cost materially reduced. At the same time it appears to us that this program would be comparatively inexpensive and that it can be completed in a short time.

The extensive drag-line operation on Peters Creek, with camp at Petersville, will be finished during the Summer of 1940, and while the road now constructed between Petersville and Elwell Bridge is very valuable for Summer hauling, as you are aware the road along the Peters Creek Canyon Rim will not make a desirable or safe winter road.

In order that you may have a record of the sentiment of the men interested we have affixed our signatures below to indicate to you that the above plan would meet with our whole-hearted approval.

Respectfully yours,

TALKEETNA COMMERCIAL CLUB

By Joseph Kummenaker President
Geo. H. Weatherall Secretary

Cache Creek Mining Co. by C. P. Morgan, Mgr.

H. W. Nagley

James G. Beaver

Fred Negus

Bud Stanton

Larry Cummins

C. M. Reeve

Thos. J. Thompson

Geo. A. Nelson

James A. Galbreath

Sam E. Wagner

George P. Perkins

Mrs. Isabella McDonald

Johan Hill

J. M. McDonald

Bert Haskins

Albert Stinson

John T. Campbell

George D. Poggas

Bert Fagerness

Ted Wasson

John Stanton

Mike A. Tryste

Frank Lee

Walter Minano

Cal Reeve

Matti Hamburg

XXXXXX

Anchorage
February 16th, 1940

Talkeetna Commercial Club
Talkeetna.

Gentlemen:

This acknowledges receipt of your letter of February 12th, concerning the location of a winter freighting road from the crossing of Peters Creek to Cache Creek by way of Spruce Creek, and the dozing of a winter road on the left limit of Cache Creek to the operations at the head of the creek.

The letter is being forwarded to Juneau, and will be given consideration when the work for the coming season in the Talkeetna area is decided upon.

While I am fairly familiar with the ground between Peters Creek and the mouth of Spruce Creek, and do not think there would be serious obstacles to the work required between these points, I would hesitate to offer an opinion as to whether it would be feasible or not from the mouth of Spruce Creek to upper Cache Creek along the left limit of the creek, where I believe some high banks would be encountered.

Yours very truly

H. C. Edmunds
Sup't.

ALASKA ROAD COMMISSION

Anchorage
October 27th, 1939

Mr Ike P. Taylor
Chief Engineer
Juneau

Dear Sir:

In reply to your letter of November 22nd, 1938, concerning a petition sent in by interested parties for a branch road leading from the Archangel road up Reed Creek.

The status of the work being done on this creek consists of prospecting. There are five outfits who have been doing considerable work in this area, but at the present time only two outfits are working this winter.

Considerable work has been done on a small scale, two small camps have been established in the basin at the head of the creek, and two camps constructed high on the hill sides.

The main requirement at the present time is the location of a road which later on can be made into a truck road, with enough work done on it so that supplies may be hauled by tractor to the head of the creek.

This is a comparatively simple matter, it is believed that \$1,000.00 would do this work, a road could be built on the right limit of the creek along the bench which would be about one mile long, there would be some rocks to remove but the maximum grade required would be about ten per cent- this road would leave the present road about 2.25 miles from the junction with the Willow Creek road.

One of the outfits have a small prospecting mill which might handle a half ton of ore a day, but this can hardly be classed as a real mill.

The men interested, about eight, said they would be glad to do any work to help out on the road during the time we had a dozer working, there would be numerous rock culverts to construct and some powder work to do.

The men concerned are very optimistic, as prospectors usually are, but Reed Creek is in a very promising area, and it is believed that the small amount of work required, which would enable them to take their mining timbers, coal, powder, and other supplies to the head of the creek by tractor instead of having to pack on their back in the summer, is justified, and it is recommended that this work be done next summer when we have equipment in that vicinity.

Yours very truly

M.C. Edwards
Sup't

UNITED STATES
DEPARTMENT OF THE INTERIOR
ALASKA ROAD COMMISSION
JUNEAU, ALASKA

November 22, 1938

Mr. M. C. Edmunds
Superintendent, A. R. C.
Anchorage, Alaska

Dear Sir:

We have your letter of November 15 enclosing petition for a branch road up Reed Creek.

Please advise those concerned that the construction of this road will be given consideration along with numerous other requests when preparing next season's program. It is not possible to make any definite commitment at this time as the amount of our appropriation and the Territorial appropriation for next year will not be known until in the spring.

In the meantime it is requested that you determine just what actually is underway in this area; whether it is all prospecting or if there are some actual milling operations. If the latter, advise how many and the number of men employed.

Very truly yours,

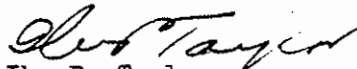
Ike P. Taylor,
Chief Engineer.

CC to Mr. Hesse, Juneau, Alaska.

ALASKA ROAD COMMISSION

Anchorage
December 2nd, 1938

Mr C.F.Peterson
Anchorage

Dear Sir:

In reference to the petition forwarded thro this office for the construction of a road up Reed Creek, I am advised by our Juneau office as follows:

" Please advise those concerned that the construction of this road will be given consideration along with numerous other requests when preparing next season's program.

It is not possible to make any definite commitment at this time as the amount of our appropriation and the Territorial for next year will not be known until the spring"

Yours very truly

M.C.Edmunds
Sup't

ANCHORAGE, November 1st, 1938

Mr M.C. Edmunds. Sup't
Alaska Road Commission
Anchorage

Dear Sir:

We, the undersigned, being quartz mine operators, miners and prospectors in the Willow Creek District, are very desirous that a road be constructed about one and a half miles long on upper Reed Creek, being about one mile North of the Mabel mine, where, at the present time at least ten different groups of claims are being developed, and others would be doing considerable work if transportation could be made available by the construction of a road

W. G. SMITH	Alaska Willow Creek Gold Mines	X
RAY C. FERRIN	Patsy Association	X
^{THO} THOMAS JOHNSON	Fish Hook Inn	X
BONNIE MARRETT	Bonnie Group	X
T. S. MCDUGAL	Fern Mine	X
W. H. I. O'NEAL	Cliff Group	✓
✓ SAM ERICKSON	Erickson and O'Neal	✓
C. B. RASH	Cliff Fraction	X
LLOYD MCNALLY	M. P. M.	✓
✓ LIEF JACOBSON		
C. F. PETERSON	Snow Bird Group	✓
✓ MARTIN CASING		
✓ OLE JOHNSON		
N. J. GAIKEMA	Cornwall Group	✓
✓ RUPERT D. BAIRD	Patsy Mine	✓
C. E. QUINTON		
✓ Matt Johannsen } Tomaseod }	Top hat	✓

The relief cabin Nancy-Susitna needs repairs as bears broke in, door damaged and window broken. Tripods replaced and windfalls cut out.

Susitna: Aviation field to be cleared and trail to lone island cut out, windfalls and brush.

Month of Alexandra-Tundra: Windfalls and brush to be cut.

Tundra to Theodore: Tripods replaced.

Theodore Beluga: Tripods replaced and brush cut out. Cable stretched across the river. Several people built a raft this winter and nearly perished in the ice flow, after the raft broke up.

THE ALASKA ROAD COMMISSION,
M. C. EDMUNDS, ANCHORAGE:

The foregoing is a petition from the residents of Susitna, in which they are asking for some road and trail work and improvements generally.

There is considerable activity in that region recently, considerable placer mining, homesteading and other things of that kind.

I would like to ask your consideration and do all you can for them. That section lies in the western part of my precinct for which reason the petition has come to me for dispatch to you. The folks over there are real people and are trying hard to make a go of things.

Please give them a hand and I am sure ~~xx~~ it will be deeply appreciated.

And I will personally thank you for all that can be done.

Sincerely yours

Howard W. Wilmoth
Commissioner, Wasilla, Alaska.

Original sent to Juneau with carbon
of the CE letter 6/9/39 to Howard Wilmoth.
Wasilla

~~Jeff~~
6-10-39

COPY OF PETITION OF MAY 22, 1939
from Susitna, Alaska.

PETITION FOR ROAD IMPROVEMENT.

To the Alaska Road Commission, Anchorage, Alaska, for the repair
of the trail Nancy-Susitna-AlexandrapTheodore-Beiuga-Tyonik.

Shem Pete
Billy Pete
Fred Winter
Chris Amodt
W.E. Austin
Paul James
R.S. Merrill
S. Anderson
Fred Nickanorka
Gaver (?) Steupen(?)
George Trainer
Mrs. Trainer
Henry ~~XXXXXX~~ George
T.B. Ryan
Mrs. T.B. Ryan
Peter Constantine
Annie Constantine
Robert Standifer
Peter P. Nulton
Nicholas -orenzo
Loris Bismark
Fred Bismark
Nester Chuit
Nandy Alexan
Simon Cook
Dick Mishakoff
Sergi Californsky
Lloyd McCord
Jenny Carp
Nester Constantine
Bill Standifer
Mrs. C.A. Carlson
C.A. Carlson
Nickefor Alexan
Teddy Petroff
Tom Stephen
Harry Trenton
Simon P. Chickalusion
Everett McCord
Alex Zaschney (?)
Steve E. Stephak
Albert Kalog
Wilson Nickoli

Terry Stephan
Nick Pete
Bobby Stephan
Pedro Goozmes
Nick Anton Steven Chmitt
Alex Peter
Charlie Kroto
Steve Bismark
Nick McCord
Tim Maxim (?)
Chas Steinbaugh
Jess R. Ward
Edward J. Hansen
Emil Giese
Edward Ward
A.B. Anderson
Carl Roberts
Felix Casper
Howard Kroiger
Lloyd Milton
Vernon S. Ross
Chester Diess
Ernest Bogel
Andy S. Olsen
Tom Krause
Peter James
Howard Wilmoth

ALASKA ROAD COMMISSION

Anchorage
June 9th, 1939

Mr Howard W. Kilworth
Commissioner
Wasilla.

Dear Sirs:

This acknowledges receipt of a petition forwarded thro your office for improvements on the trail leading from Naney to Tyonek, and repairs to the shelter cabin between Naney and Susitna station.

While this trail was used to some extent many years ago, recent surveys the information given to this office gives the impression would lead one to believe that the trail is practically abandoned, the only persons making use of it being an occasional trapper stationed in the vicinity during the winter months.

Since the advent of airplanes, and the discontinuance of dog teams for carrying mail during the winter months, most of the winter trails which were so important in the early days are not necessary-- the numerous roadhouses and shelter cabins which were constructed at various convenient places have all been abandoned on many trails, which are now used only by natives and others trapping and hunting, and there is no necessity of maintaining the trails, especially such as the one between Naney and Tyonek, where transportation during the summer months is by water, with planes available for emergency during the winter.

During the early fall an effort will be made to investigate the necessity for further work on this trail, and, if found necessary and justified repairs will be made-- It is noted, however, that the petition is signed by some residents of the Wasilla district who probably never was over the trail and have no idea of its condition.

Yours very truly

M.C.Edmonds
Sep't.

C.C. Juno

Ganes Creek, Takotna, Alaska.
May 8, 1939.

Mr. Carl Johnson, A.R.C. Sup't.
Takotna, Alaska.

Dear Sir;

We the undersigned hereby petition you to help us to open up the Takotna, Yankee, Ganes Creek road. Owing to the elements of nature last fall, we were unable to haul over the road our much needed supplies. We, all of us out here are much in need of Lumber, Fuel Oil, Machinery and Repair Parts, As well as many of our much needed camp supplies.

Thanking you in anticipation, We beg to remain
Respectfully Yours

Charles Holby
A. Holby checking co
Frank Spurgeon
Lawrence Zaiser
Chas Gabel
Tom Jackson
Joe Ramstad
Wesley Vibe

UNITED STATES
DEPARTMENT OF THE INTERIOR
ALASKA ROAD COMMISSION
JUNEAU, ALASKA

April 3, 1939

Mr. M. C. Edmunds
Superintendent, A. R. C.
Anchorage, Alaska

Dear Sir:

Receipt is acknowledged of your letter of March 28 enclosing petition from Mr. Urban for a road. This petition will be forwarded to Mr. Hesse for his records.

It is noted from the petition that three-fourths of a mile of road is needed. It was my understanding that the road to be built was much shorter than this and it appears doubtful if the thousand dollars set up will be sufficient to do the work. However, an effort should be made to get them a passable road if possible within these funds.

Very truly yours,

Ike P. Taylor
Chief Engineer

CC Mr. Hesse, with petition

ALASKA ROAD COMMISSION

Anchorage
March 28th, 1939

Mr Ike P. Taylor
Chief Engineer
Juneau

Dear Sirs:

I am forwarding a petition brought into this office yesterday by Mr J.D.Urban, for the construction of a short road off the Anchorage Loop road to his property.

This is a copy of the petition sent in from this office on January 22nd, 1937, and the road which we have been instructed to build this season.

Mr Urban stated that he had been in to see Mr Hesse, and that he requested him to send in the petition as soon as possible, therefore I am forwarding it to you.

Yours very truly

M.C.Edmunds
Sup't

UNITED STATES
DEPARTMENT OF THE INTERIOR
ALASKA ROAD COMMISSION
JUNEAU, ALASKA

March 9, 1939

Mr. M. C. Edmunds
Superintendent, A. R. C.
Anchorage, Alaska

Dear Sir:

Receipt is acknowledged of your letter of February 17 enclosing petition from Homer with reference to changing the foreman there.

It now appears very unlikely that the foremen will be included in Civil Service.

While I agree that it is not generally good policy to switch foremen around just because a few people complain, I think that in this instance it might be a good plan to change foremen at Homer if you have a good man that you can send down there. You could then use McCroskey around Anchorage.

Very truly yours,

Ike P. Taylor
Chief Engineer

Ed

5

WJN

ALASKA ROAD COMMISSION

Anchorage
February 17th, 1939

Mr Ika P. Taylor
Chief Engineer
Juneau

Dear Sir:

I am forwarding a petition received from Homer some time ago in reference to changing the foreman, altho no reason is given except that the person wording the petition did not like him.

The petition was started up by two men who came up to Palmer as colonists, and were weeded out and moved down to Homer.

Practically all of the signers are new people who have moved into the district during the past two seasons, most of them live on the hill.

Most of the new people moving into the district are without funds, and have to work to make a living - a lot of them have applied for work on the roads and do not like it because we are not able to take care of them - I see no reason why we should employ new comers to the detriment of men who have worked for us for years, faithfully, when they need money to supplement their incomes.

They are also peeved because we did not build the road leading to the hill straight up and down, where they wanted it, on an excessive grade and no doubt blame the foreman because it was built elsewhere.

I was informed by the Homer Civic League that they had no knowledge of this petition, and that they were not in accord with it - that as long as we worked on the roads it was immaterial to them who the foreman was, but as long as it was not a local man, who would be in hot water all the time.

One of the signers, Halsted, was a man who moved down to Homer late last fall, after working for the Alaska Railroad all summer.

Personally I see no reason why we should change our foremen to suit a bunch of disgruntled men who may hope to obtain work if a new man is sent down.

I am enclosing a letter from Chas Miller in reference to this matter.

Yours very truly

H.C. Edwards
Supt.

ALASKA ROAD COMMISSION

Anchorage
December 7th, 1938

Mr Charles Miller
Homer.

Dear Charlie:

I received a petition in the last mail signed by 64 persons, most of whom are strangers to me, asking to have another man sent to Homer next summer in McCroskeys place.

They do not state what the particular difficulty is, or why they want a new man.

One of the signers of the petition is a man who was never in Homer before the end of the working season this year- he certainly is not in any position to criticize.

I imagine most of the people who signed this petition did not know what they were signing, or that a lot of them are sore because they were not able to get work.

I would appreciate hearing from you as to the person or persons who started this petition, and what they expect to gain, whether they are sore at Jack Dietz and if that has something to do with it.

We have spent considerable money at Homer the past few years, and have a lot to show for the money expended- this is evident to anyone who understands construction work and the conditions under which the work has to be done.

Whether we continue to spend much more money at Homer is very doubtful, once the road is gravelled and graded up there is very little maintenance required, and no necessity of doing much work.

Trusting that things are going along alright with you these days

Yours very truly

H.C. Edwards
Sup't.

~~John ...~~
Edward ... x

Frank ... v

George ... x

John ... x

Donald ... w

Charles ... x

Jim ... x

Jack ... y

R. ... x

Wm ... ~~no~~ no record

Thor ... =

Glex ... x

Lloyd ... A

Ray ... x

Robert ...

Robert ... x

James ... x

John ... C

George ... D

Leonard E
 [unclear] F
 Frank [unclear] G
 [unclear] H
 [unclear] I
 [unclear] J
 [unclear] Bowling
 [unclear] K
 [unclear] L
 August [unclear] NR
 Hugh McCaughey HR
 H. P. [unclear] M
 Carl [unclear] N
 [unclear] O
 [unclear] P
 [unclear] Q
 [unclear] R
 [unclear] S
 [unclear] T
 Dick [unclear] X
 [unclear] V
 [unclear] X

Ronald W. Campbell, a
 James Rathbone
 Edwin Henderson, b
 Jay Chapman, x
 Melton Howe, c
 James Jones, d
 Frank Hopper, e
 Chas Anderson, x
 Floyd Cunningham, x
 Lee Wiedome, f
 Chas Chickson, g
 A. A. Mattos, x
 Karl Kohler, x
 Edward Anderson, h
 Solomon Brosky, i
 L. M. Moore, j
 Ole Norstad, x
 Floyd Manseth, x
 George Lighner, x
 Emily Anderson, x
 P. L. Lee, k
 Albert W. Linneman