

SURVEYED TOWNSHIP 12 NORTH RANGE 3 WEST OF THE SEWARD MERIDIAN, ALASKA

STATUS OF PUBLIC DOMAIN
LAND AND MINERAL TITLES
AND ACQUIRED LANDS

**MTP
SUPPL SEC 27**

NO 6

FOR ORDERS EFFECTING DISPOSAL OR USE OF UN-
IDENTIFIED LANDS WITHDRAWN FOR CLASSIFICATION
MINERALS, WATER AND/OR OTHER PUBLIC PURPOSES
REFER TO INDEX OF MISCELLANEOUS DOCUMENTS.

A058730 SS Reserved Mineral Estate Only

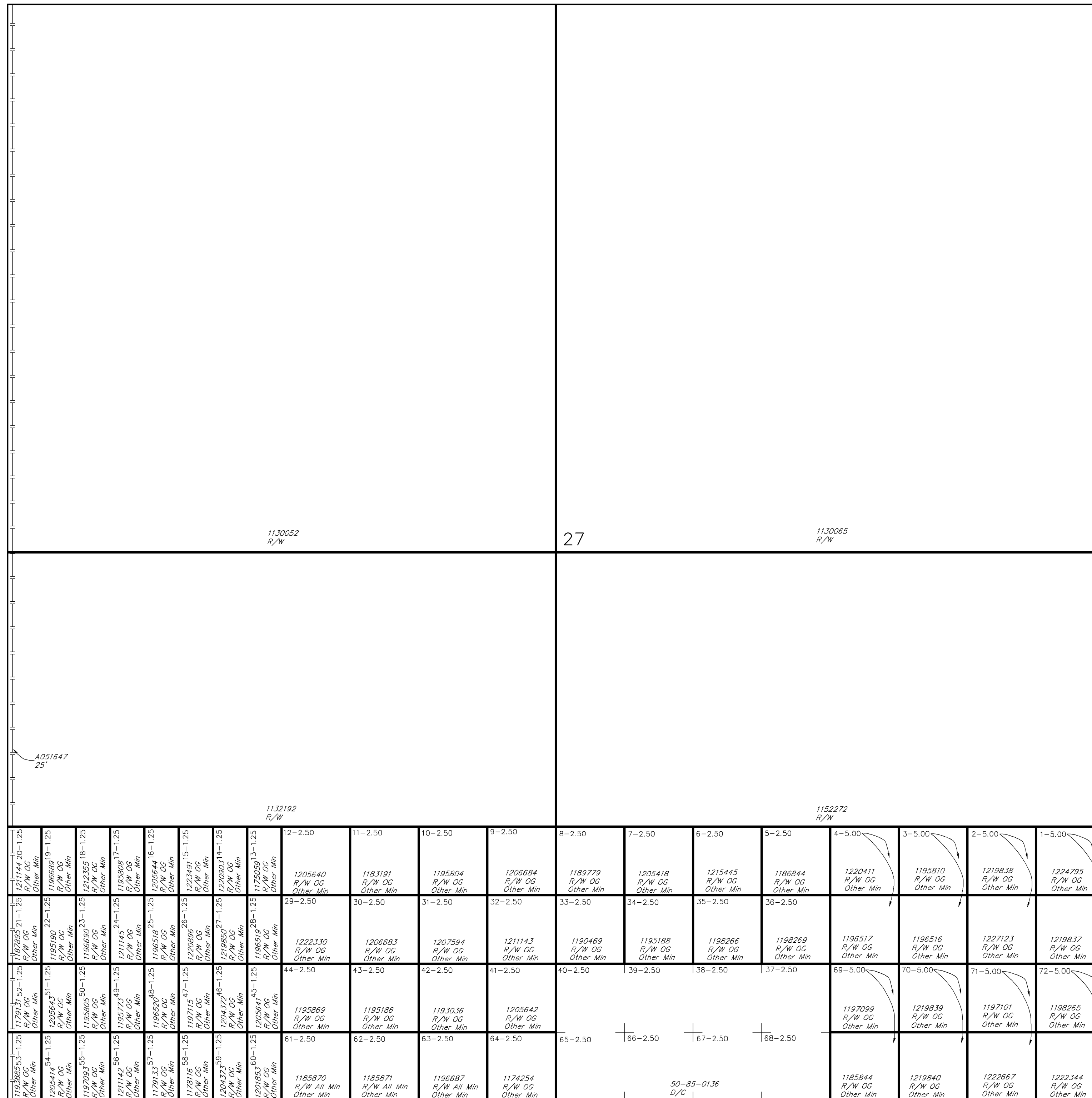

SCALE in chains

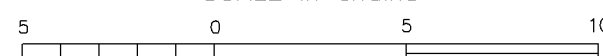

WARNING:
This plot is the Bureau's Record of Title, and should be used
only as a graphic display of the township survey data. Rec-
ords hereon do not reflect title changes which may have been
effected by lateral movements of rivers or other bodies of water.
Refer to the cadastral surveys for official survey information.

CURRENT TO	
7-14-2008	

Acq
NO 6
Sew Mer
T 12 N
R 3 W
ACAD