

SURVEYED TOWNSHIP 8 NORTH RANGE 87 WEST OF THE SEWARD MERIDIAN, ALASKA

STATUS OF PUBLIC DOMAIN
LAND AND MINERAL TITLES

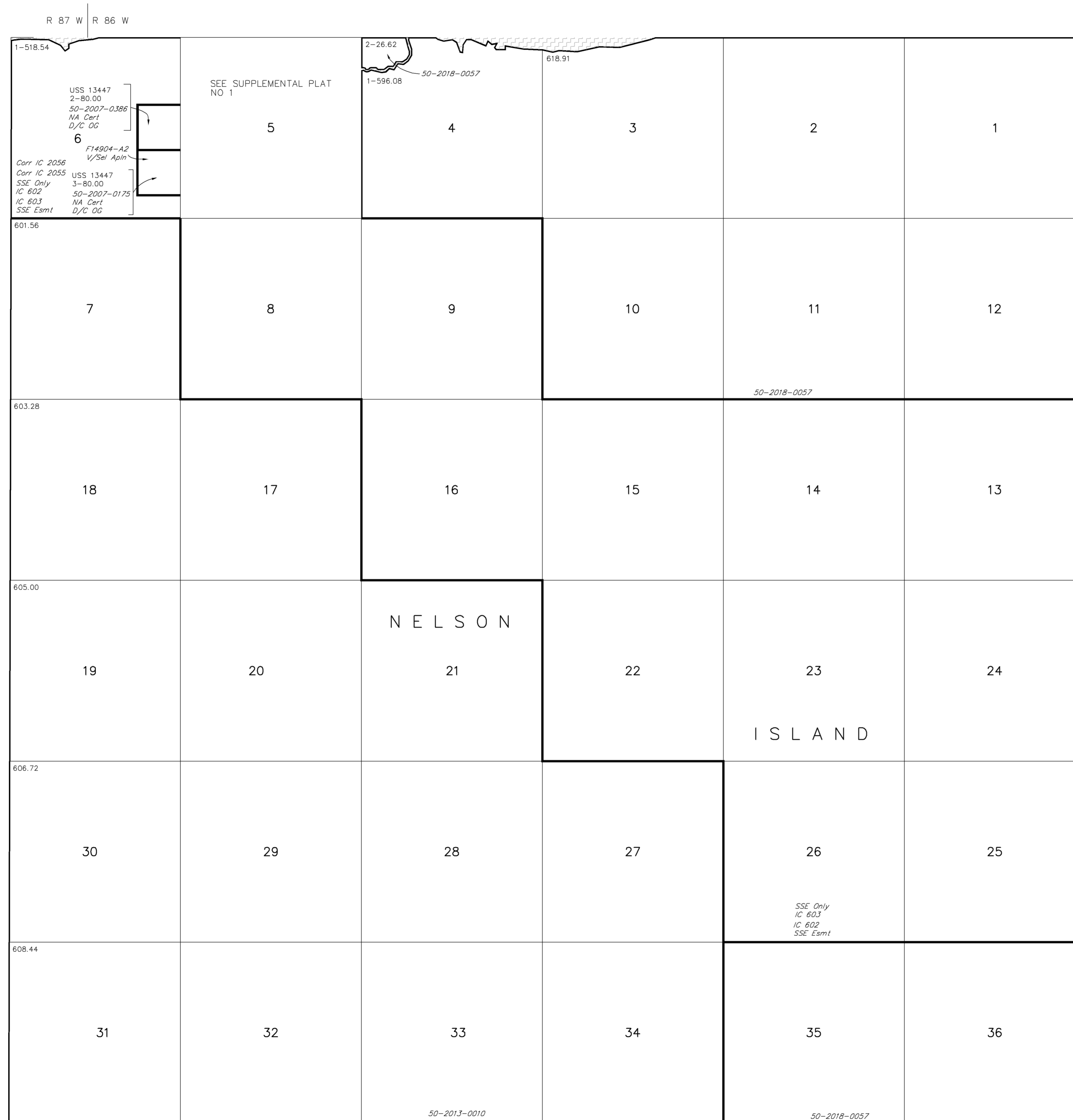

MTP

FOR ORDERS EFFECTING DISPOSAL OR USE OF UN-IDENTIFIED LANDS WITHDRAWN FOR CLASSIFICATION MINERALS, WATER AND/OR OTHER PUBLIC PURPOSES REFER TO INDEX OF MISCELLANEOUS DOCUMENTS.

PL 0 5184 Wdl CI affects Lds/Interests not conveyed

PL 96-487 Wdl Yukon Delta NWR entire Tp

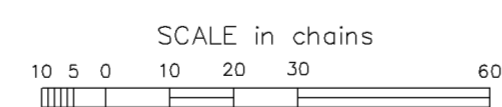

WARNING:
This plot is the Bureau's Record of Title, and should be used only as a graphic display of the township survey data. Records hereon do not reflect title changes which may have been effected by lateral movements of rivers or other bodies of water. Refer to the cadastral surveys for official survey information.

Lat 60°44'00.84"N
Long 164°27'18.30"W

CURRENT TO	
8-13-2018	

Sew Mer
T 8 N
R 87 W

ACAD

SURVEYED TOWNSHIP 8 NORTH RANGE 87 WEST OF THE SEWARD MERIDIAN, ALASKA

STATUS OF PUBLIC DOMAIN
LAND AND MINERAL TITLES

**MTP
SUPPL SEC 5**

NO 1

FOR ORDERS EFFECTING DISPOSAL OR USE OF UN-IDENTIFIED LANDS WITHDRAWN FOR CLASSIFICATION MINERALS, WATER AND/OR OTHER PUBLIC PURPOSES REFER TO INDEX OF MISCELLANEOUS DOCUMENTS.

PLO 5184 Wdl Cl affects Lds/Interests not conveyed

PLO 96-487 Wdl Yukon Delta NWR entire Tp

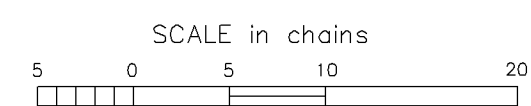
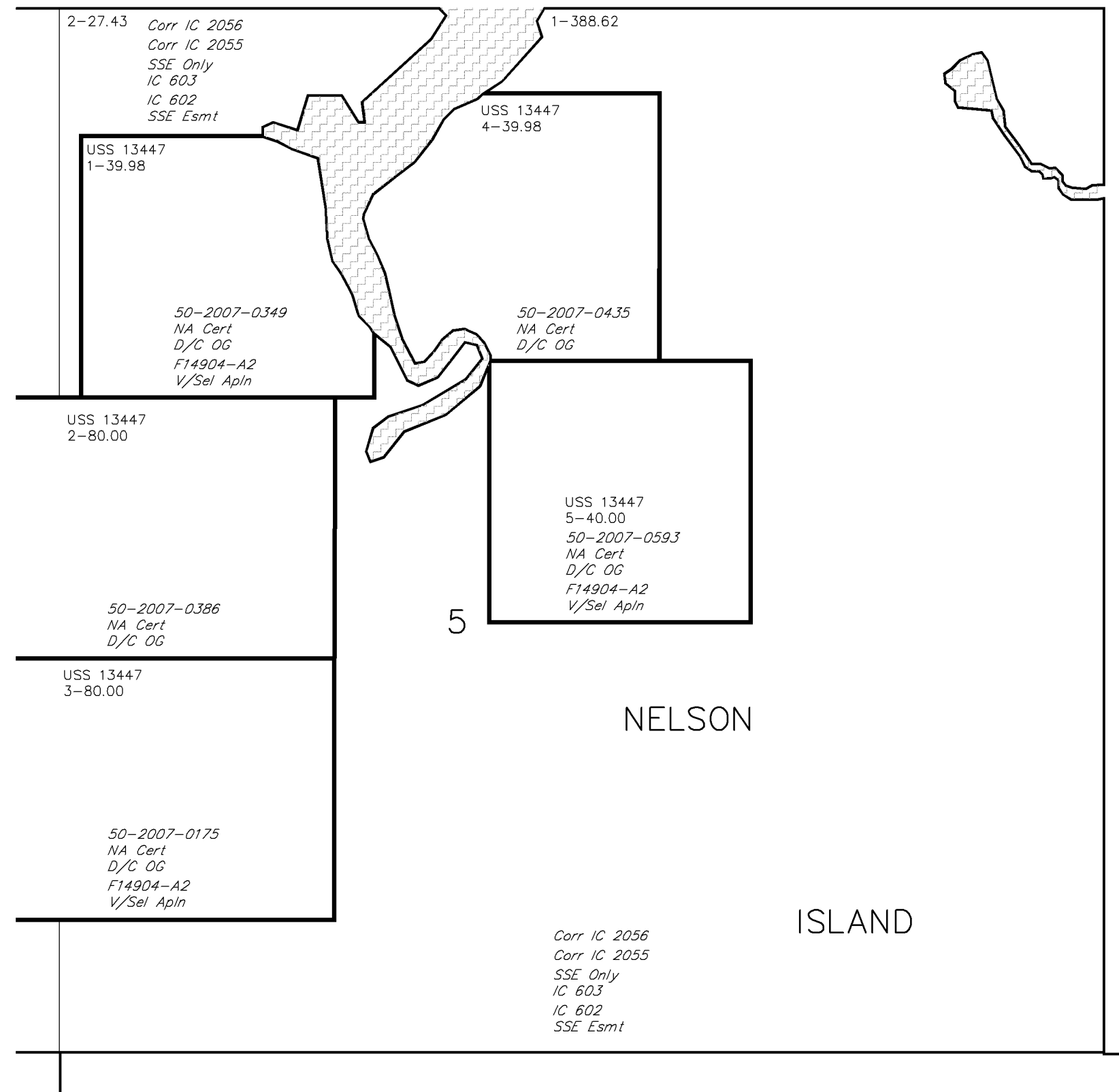

WARNING:
This plot is the Bureau's Record of Title, and should be used only as a graphic display of the township survey data. Records hereon do not reflect title changes which may have been effected by lateral movements of rivers or other bodies of water. Refer to the cadastral surveys for official survey information.

CURRENT TO	
3-28-2012	

NO 1
Sew Mer
T 8 N
R 87 W
ACAD