

Alaska Case Retrieval Enterprise System (ACRES)

Note: Reports are generated from a replicated database. Information can be one day old.

Case Abstract for: AKA 046677

CASE DATA						
Case Serial Num:	AKA 046677	FRC Site Code:	ANC			
Case Type:	256700 He Alaska	Accession Num:	49			
Case Status:	Closed	Box Num:	599 (of) --			
Case Status Actn:	Case Closed	Disp Date:	--			
Case Status Date:	18-FEB-1965	Location Code:	RIP			
SM Acres:	0.0000	Abnd Yr:	--			
Claim Name:	--					

CUSTOMER DATA			
Cust ID:	000084355		
Customer Name:	COWART BENJAMIN H	Interest Relationship:	Applicant
Customer Address:	Withheld	Percent Interest:	0.0000

ADMINISTRATIVE/STATUS ACTION DATA						
Date	Code Description:	Remarks	Doc ID	Ofc	Emp	Doc Img *
21-NOV-1958	906 Location Date	--	--	AJA	LH	--
25-NOV-1958	001 Application Filed	--	--	PSA	MER	--
17-NOV-1961	244 Final Proof Filed	--	--	AJA	LH	--
20-NOV-1961	244 Final Proof Filed	--	--	AJA	LH	--
04-DEC-1961	244 Final Proof Filed	--	--	AJA	LH	--
03-SEP-1964	001 Application Filed	--	--	AJA	LH	--
23-OCT-1964	176 Authorization Issued	ENTRY ALLOWED	--	AJA	LH	--
18-FEB-1965	879 Patent Issued	--	PA0050650462	PSA	JAK	View DjVu
18-FEB-1965	970 Case Closed	TITLE TRSF	--	AJA	LH	--
27-AUG-1992	996 Converted To Prime	--	--	940	BKM	--

FINANCIAL ACTION DATA						
Date	Code/Description	Ofc	Emp	Money Amt	Acct Adv	Asmt Yr
NO FINANCIAL ACTIONS FOUND						

GENERAL REMARKS
No Case Remarks found

GEOGRAPHIC NAMES
No Geonames found

LAND DESCRIPTION

Mr	Twp	Rng	Sec	Aliquot	Survey ID	Tr	Blk	Lot	Di	Bor	NR	LS	Acres	View
28	016 N	004 W	027	W2NW	--	--	--	--	04	170	07	PA	80.0000	MTP TWPLAT HI TWPALL
Doc ID: PA0050650462 (PDF)					18-Feb-1965		USR: 145 570 754							
28	016 N	004 W	028	E2NE	--	--	--	--	04	170	07	PA	80.0000	MTP TWPLAT HI TWPALL
Doc ID: PA0050650462 (PDF)					18-Feb-1965		USR: 145 570 754							
Total Case Acres:													160.0000	
CASE ACRES ANALYSIS														
Conveyed:													160.0000	
Total:													160.0000	
Patented:													160.0000	
Total:													160.0000	

[Report Information/Help](#)

No warranty is made by the Bureau of Land Management as to the accuracy, reliability, or completeness of these data. Refer to specific BLM case files for official land status information.
 For case data information/help, contact the BLM Alaska Public Information Center at (907) 271-5960.

Property of the United States Government
 This Document Contains Sensitive But Unclassified Information
 Category 1 (A) BLM Records that do not contain protected information
 and can be released in whole.

**DEPARTMENT OF THE INTERIOR
BUREAU OF LAND MANAGEMENT**

FORM 4-1179
AUG. 1957

No. 1351324

Sept. 3, 1964 DATE

Acct 046677 PARENT SERIAL NUMBER

HE Entry Appl.

APPLICANT:
**Benjamin H. Cowart
P.O. Box 4532
Spencer, Alaska**

SUBJECT
REMITTER IF DIFFERENT THAN APPLICANT:

PURPOSE	FUND SYMBOL	AMOUNT
FILING FEE EARNED	142599	25.00
ADVANCE FILING FEE AND/OR RENTAL	14X6900	

ACRES	COUNTY	OLD LEASE	NEW LEASE
NEW LEASE			

EFFECTIVE DATE

ASSIGNMENT:
COMPLETE AREA

PORTION OF AREA:
ASSIGNED AREA

RETAINED AREA

OF INTEREST BUT NOT
OF SPECIFIC AREA:

BOND FILED

NO BOND FILED

APPLY:
FILING FEE 142599

RENTAL

REFUND

RETAIN IN UNEARNED ACCOUNT

TOTAL

REMARKS

BY _____ DATE _____

**DO NOT ACCEPT THIS COPY AS A RECEIPT
CASE FOLDER COPY**

DEPARTMENT OF THE INTERIOR
BUREAU OF LAND MANAGEMENT

No. 777019

1179
1571

12/4/61

DATE
PARENT SERIAL NUMBER
ASSIGNMENT SERIAL NUMBER

Remitted Final Proof Fee

APPLICANT: REMITTER IF DIFFERENT THAN APPLICANT: SUBJECT

Benjamin E. Conner
P.O. Box 4338
Spenard, Alaska

PURPOSE	FUND SYMBOL	AMOUNT
3 FEE EARNED	142599	7.80
ANCE FILING FEE AND/OR RENTAL	14X6800	

ACRES	COUNTY	EFFECTIVE DATE	OLD LEASE	NEW LEASE
LEASE				

	FUND SYMBOL	COUNTY	AMOUNT
APPLY: FILING FEE 142599			
RENTAL			
REFUND			
RETAIN IN UNEARNED ACCOUNT			
TOTAL			
REMARKS			

INTEREST BUT NOT F SPECIFIC AREA:
 FILED
 NOT FILED

BY _____ DATE _____

DO NOT ACCEPT THIS COPY AS A RECEIPT
CASE FOLDER COPY

DEPARTMENT OF THE INTERIOR
BUREAU OF LAND MANAGEMENT

ORM 4-1178
AUG. 1957

No. 763833

11/25/58

DATE

Acct. 046677

PARENT SERIAL NUMBER

ASSIGNMENT SERIAL NUMBER

Homestead- Location Notice

APPLICANT:

SUBJECT
REMITTER IF DIFFERENT THAN APPLICANT:

Benjamin H. Covert
P. O. Box 4532
Spenard, Alaska

PURPOSE	FUND SYMBOL	AMOUNT
FILING FEE EARNED	142599	
ADVANCE FILING FEE AND/OR RENTAL	14X6800	10 00

ACRES	COUNTY	OLD LEASE	NEW LEASE
NEW LEASE			

FUND SYMBOL COUNTY AMOUNT

APPLY:

FILING FEE 142599

10

RENTAL

ASSIGNMENT:
COMPLETE AREA

PORTION OF AREA:
ASSIGNED AREA

RETAINED AREA

REFUND

RETAIN IN UNEARNED ACCOUNT

TOTAL

10

REMARKS

OF INTEREST BUT NOT
OF SPECIFIC AREA:

BOND FILED

NO BOND FILED

BY PPG DATE 6-5-59

DO NOT ACCEPT THIS COPY AS A RECEIPT
CASE FOLDER COPY

THIS CASE FILE HAS BEEN AUDITED & LOCKED

DATE 7-15-80

AUDITED THRU ACTION 992-1865

NAME Lynne. Homme (ADP)

PLEASE DO NOT REMOVE

SERIAL NO: A046677

CASE TYPE: 256700

A 046677 (041512)

CASE FILE ABSTRACT
07/07/80 (18:02)

PAGE 1

CASE TYPE: 256700 HOMESTEAD SETTLEMENT ✓
FILED IN: ANCHORAGE ✓
RES. AREA: ~~ANCHORAGE~~ PENINSULA ✓

STATUS: CLOSED
(87)

APPLICANT: 24490 COWART BENJAMIN H
BK 4832 ✓

~~ANCHORAGE~~ ANCHORAGE AK 99589

HISTORY:	DATE	ACT	PC	ACTION TAKEN	UNIT	CODR	SURVEY	AMOUNT
1.	11/25/1958	247	✓	LOCATION NOTICE FILED	PSA	MER		
2.	02/18/1965	271	✓	PATENT ISSUED	PSA	JAK		
3.	02/19/1965	148		CASE CLOSED NO CONVEYANCE	PSA	JAK		
4.	03/24/1977	289		CASE CLOSED TITLE TRST	PSA	JAK		

FINANCIAL: FILING FEE: 0.00

LITIGATION SERIAL#

ACCESSION# 66A753 PROC# 8814 BOX#

(CONTINUED)

map corrected

UNITED STATES
DEPARTMENT OF THE INTERIOR
BUREAU OF LAND MANAGEMENT

EXAMINATION OF CASE/CARD RECORD REQUEST

Serial Number or Name <i>A046677</i>		Type of Case <i>2567-File</i>	
I request to examine the case/card record bearing the above Serial Number or name. I agree not to remove or alter the contents of the file in any manner whatsoever and not to remove the file from the room designated for public examination of such records.			
Signature <i>[Signature]</i>		Date <i>5/7/75</i>	
Print name <i>Jeffrey D. Reed</i>			
Address (include zip code) <i>1629 W 3rd Ave</i>			
Date	Time checked out	<input type="checkbox"/> a.m. <input type="checkbox"/> p.m.	Time checked in
			<input type="checkbox"/> a.m. <input type="checkbox"/> p.m.

* U.S. Government Printing Office: 1974-781-739-374 Reg. 8

Form 1274-11 (June 1974)

Form 1274-11
(June 1964)
(formerly 4-1348)

U.S. DEPARTMENT OF THE INTERIOR
BUREAU OF LAND MANAGEMENT

REQUEST FOR EXAMINATION OF CASE/CARD RECORD

Serial Number or Name

A 046677
Patent # 50-65-0462

It is requested that the undersigned be authorized to examine the case/card record bearing the above Serial Number or name. My interest in the case is as indicated below. I agree not to remove or alter the contents of the file in any manner whatsoever and not to remove the file from the room designated for public examination of such records.

Interest (Specify lessee, assignee, attorney, agent, etc.)

Fish & Game

FRC 8814
Acc # 66-A953

Date <i>11-7-69</i>	Signature <i>Joseph R Blum</i>		
APPROVED			
Signature <i>Jm Reed</i>		Title <i>PS</i>	
Date <i>11/29/69</i>	Time checked out	<input type="checkbox"/> a.m. <input type="checkbox"/> p.m.	Time checked in
			<input type="checkbox"/> a.m. <input type="checkbox"/> p.m.

GPO 842-776

U.S. DEPARTMENT OF THE INTERIOR
BUREAU OF LAND MANAGEMENT

A046677

REQUEST FOR EXAMINATION OF CASE/CARD RECORD

It is requested that the undersigned be authorized to examine the case/card record bearing the above Serial Number or name. My interest in the case is as indicated below. I agree not to remove or alter the contents of the file in any manner whatsoever and not to remove the file from the room designated for public examination of such records.

Interest (Specify lessee, assignee, attorney, agent, etc.)

Alaska Division of Lands

Date <i>11/13/69</i>	Signature <i>Dale P. J. ...</i> <i>SC. District Manager</i>
-------------------------	--

APPROVED

Signature <i>W. J. Reed</i>	Title <i>PS</i>
--------------------------------	--------------------

Date <i>11/13/69</i>	Time checked out	<input type="checkbox"/> a.m. <input type="checkbox"/> p.m.	Time checked in	<input type="checkbox"/> a.m. <input type="checkbox"/> p.m.
-------------------------	------------------	--	-----------------	--

Form 4-1195
(August 1961)

UNITED STATES
DEPARTMENT OF THE INTERIOR
BUREAU OF LAND MANAGEMENT

Office

Anchorage

Serial Number

Anchorage 046677

Date

FEB 16 1965

CERTIFICATE

Act(s) of May 20, 1862 (12 Stat. 392)

IT IS HEREBY CERTIFIED, That Benjamin Harvey Cowart

has (have) complied with the requirements of the above act(s) for W $\frac{1}{2}$ NW $\frac{1}{4}$, Sec. 27; E $\frac{1}{2}$ NE $\frac{1}{4}$, Sec. 28

~~Section~~ _____, Township 16 North, Range 4 West,
Seward Meridian, State of Alaska, containing 160.00 acres

NOW, THEREFORE, BE IT KNOWN, That the DIRECTOR, BUREAU OF LAND MANAGEMENT, will issue a patent
subject to Reservations Number(s) SIX, TWELVE, THIRTEEN AND FOURTEEN

described on the reverse side hereof for the land above described, if all be found regular.

PATENT NO. 50-65-0462

Alfred P. Steger
(Signing Officer)

FEB 18 1965

Alfred P. Steger
Assistant Manager
Lands Branch

(Title)

Posted (date) _____ in Volume _____, Page _____, By _____

APPROVED for patent (date) February 9, 19 65, By Brigitte S. Amundson STATE 000543
Land Law Examiner

MINERAL RESERVATIONS

1. Patent to contain provisions, reservations, conditions, and limitations of Act of June 22, 1910 (36 Stat. 583; 30 U.S.C. secs. 83-85).
2. Patent to contain provisions, reservations, conditions, and limitations of Act of July 17, 1914 (38 Stat. 509; 30 U.S.C. secs. 121-123) as to (*specify mineral*) _____
3. Patent to contain provisions, reservations, conditions, and limitations of Act of July 17, 1914 (38 Stat. 509) as extended by the Act of March 4, 1933 (47 Stat. 1570; 30 U.S.C. sec. 124) as to (*specify sodium or sulphur*) _____
4. Patent to contain reservation of oil, gas, and all other mineral deposits under conditions and limitations as provided by Act of June 1, 1938 (52 Stat. 609; 43 U.S.C. sec. 682b) as amended.
5. Patent to contain reservation of coal and all other minerals under conditions and limitations as provided by Act of December 22, 1928 (45 Stat. 1069; 43 U.S.C. secs. 1068, 1068a, and 1068b) as amended.

RESERVATIONS OF RIGHTS-OF-WAY

6. Patent to contain reservation according to proviso of the Act of August 30, 1890 (26 Stat. 391; 43 U.S.C. sec. 945).
7. Patent to contain provisions, reservations, conditions, and limitations of section 24, Federal Power Act, June 10, 1920 (41 Stat. 1075) as amended by the Act of August 26, 1935 (49 Stat. 846; 16 U.S.C. sec. 818).
8. Patent to contain provisions, reservations, conditions, and limitations of section 24, Federal Power Act, June 10, 1920 (41 Stat. 1075) as amended by the Act of August 26, 1935 (49 Stat. 846; 16 U.S.C. sec. 818) as to that portion of the _____ said Section _____ lying within _____ feet of the center line of the transmission line right-of-way of the _____ Project No. _____
9. Patent to contain provisions, reservations, conditions, and limitations of section 24, Federal Power Act, June 10, 1920 (41 Stat. 1075) as amended by the Act of August 26, 1935 (49 Stat. 846; 16 U.S.C. sec. 818) as to that portion of the _____ said Section _____ lying within a strip _____ feet wide covered by the transmission line right-of-way of the _____
10. Right-of-way for a Federal Aid Highway under the Act of August 27, 1958 (72 Stat. 885; 23 U.S.C. secs. 107, 317).
11. Material site reserved under the Act of August 27, 1958 (72 Stat. 885; 23 U.S.C. secs. 107, 317).

RESERVATIONS APPLICABLE TO ALASKA

12. There is reserved to the United States a right-of-way for the construction of railroads, telegraph, and telephone lines under the Act of March 12, 1914 (38 Stat. 305; 48 U.S.C. secs. 301-302, 303-308).
13. Patent to contain provisions, reservations, conditions, and limitations of the Act of March 8, 1922 (42 Stat. 415; 48 U.S.C. secs. 376-377) as amended (*specify mineral*) oil and gas

OTHER RESERVATIONS

14. This entry is made under section 29 of the Act of February 25, 1920 (41 Stat. 449; 30 U.S.C. sec. 186) and the Act of March 4, 1933 (47 Stat. 1570; 30 U.S.C. sec. 124), and is subject to rights of prior permittees or lessees to use so much of the surface of said lands as is required for mining operations, without compensation to the patentee for damages resulting from proper mining operations. oil and gas lease A-022752
15. Patent to be issued subject to the Act of June 17, 1902 (32 Stat. 388; 43 U.S.C. sec. 372 *et seq.*) to sections 1 and 2 of Act of May 15, 1922 (42 Stat. 541; 43 U.S.C. secs. 511-512) and to section 3 of Act of August 9, 1912 (37 Stat. 266; 43 U.S.C. sec. 543).
16. Patent to be issued subject to the Act of June 17, 1902 (32 Stat. 388; 43 U.S.C. sec. 372 *et seq.*) and to all provisions of the Act of August 9, 1912 (37 Stat. 265; 43 U.S.C. secs. 541-546).
- 17.

Note—If reservation affects only a portion of the land entered, such portion must be indicated after the reservation

IO-Adm-6
Feb. '62

CHECK LIST OF INFORMATION ON FINAL CERTIFICATE

- Name of Patentee BENJAMIN HARVEY COWART
- Serial No. A. 046677 Type of Case HE 1.1
- Act May 20, 1862
- Description T 16 N, R 4 W, S M
Sec. 27: W²NW⁴; Sec. 28: E²NE⁴

- Area 160.00 acres
- Citizenship verified
- Military Service verified Not required
- Geological Survey Report Not required
- Clearance by Native Service Not required
- Clear status
- Final proof ~~ex-application to purchase~~
- All signatures properly affixed
- Supplemental Geological Survey Report
(Date of final proof or application to purchase)
 - Not required
 - Oil & Gas Waiver Not required
 - Coal Waiver Not required
- Posted on records or in tract book and serial book
- Field report
- Proof of publication (5 weeks) Not required

SPECIAL SURVEY

- Proof of publication (9 weeks)
- Proof of posting on land
- Posted on plat and in serial register
- Affidavit of Land Office Posting

PATENT RESERVATIONS

- Act of August 30, 1890 (No. 6) Prior mineral permittee or lessee (No. 14) A. 022752
- Act of March 12, 1914 (No. 12)
- Act of March 8, 1922 (No. 13) Other (specify) C. E. G.

ca
Examiner

UNITED STATES
 DEPARTMENT OF THE INTERIOR
 BUREAU OF LAND MANAGEMENT
 Anchorage District Office
 585 Cordova Street
 Anchorage, Alaska 99501
 Date: Oct. 23, 1964

NOTICE FOR PUBLICATION
 Notice is hereby given that Benjamin Harvey Cowart settler, of Seward, Alaska, together with his witnesses Lawrence R. McCoy of Seward, Alaska and Clarence E. Rice of Anchorage, Alaska has submitted final proof on his Homestead entry Anchorage Serial Number 04667 for a tract of land described as W1/2NW1/4, Sec. 27, E1/2NE1/4, Sec. 28, T. 16 N., R. 4 W., S.M. containing 160.00 acres, and it is now on file in the Land Office, Anchorage, Alaska. Any person, corporation, or association having or asserting any adverse interest in, or claim to, the tract of land or any part thereof sought, may file in the Anchorage Land Office, during the period of publication or within 20 days thereafter, under oath, an adverse claim setting forth the nature and extent thereof, and such adverse claimant shall, within sixty days after the filing of such adverse claim, begin action to quiet title in a court of competent jurisdiction within Alaska, and thereafter payment shall be assumed in conformity with the final decree of the court.

(s) Alfred P. Stager
 Acting Manager
 Anchorage District & Land Office
 Pub: Nov. 3, 10, 17, 24; Dec. 1, 1964

04667
1.1

Proof of Publication

zab

ANCHORAGE DAILY TIMES

KENNETH LAUGHLIN being duly sworn, according

to law declares: That he is the ADVERTISING MANAGER of The Anchorage Daily Times, a daily newspaper published in the town of Anchorage, in the Third Judicial Division, State of Alaska; that the notice of HOMESTEAD: BENJAMIN HARVEY COWART. a copy of which is hereto attached, was published

NOVEMBER 3, 10, 17, 24; DECEMBER 1, 1964

in said Anchorage Daily Times, beginning with the issue of NOVEMBER 3, 1964,

and ending with the issue of DECEMBER 1, 1964

Kenneth Laughlin jr

Subscribed and sworn to before me this 1st day of DECEMBER, 1964

Alfred P. Stager

Notary Public for the State of Alaska.

My Commission Expires JUNE 29, 1967

UNITED STATES
DEPARTMENT OF THE INTERIOR
BUREAU OF LAND MANAGEMENT
Anchorage District Office
555 Cordova Street
Anchorage, Alaska 99501

ALG:LG

046677

Date: OCT 23 1964

NOTICE FOR PUBLICATION

Notice is hereby given that Benjamin Harvey Cowart entryman,
of Spennard, Alaska, together with his witnesses
Lawrence R. McCoy of Spennard, Alaska and
Clarence E. Rice of Anchorage, Alaska has
submitted final proof on his Homestead entry(x)
Anchorage Serial Number(x) 046677 for a tract of land
described as W $\frac{1}{2}$ NW $\frac{1}{4}$, Sec. 27; E $\frac{1}{2}$ NE $\frac{1}{4}$, Sec. 28, T. 16 N., R. 4 W., S.M.

containing 100.00 acres, and it is now in the files of the Land Office,
Anchorage, Alaska. Any person, corporation, or association having or asserting
any adverse interest in, or claim to, the tract of land or any part thereof
sought, may file in the Anchorage Land Office, during the period of publication
or within 30 days thereafter, under oath, an adverse claim setting forth the
nature and extent thereof, and such adverse claimant shall, within sixty days
after the filing of such adverse claim, begin action to quiet title in a court
of competent jurisdiction within Alaska, and thereafter patent shall be issued
in conformity with the final decree of the court.

AP
Alfred P. Steger
~~Assistant Manager~~
Acting Manager
Anchorage District & Land Office

Post in Land Office

POSTED
OCT 23 1964
DEC 17 1964

ALO-Misc-66
March 62

UNITED STATES
DEPARTMENT OF THE INTERIOR
BUREAU OF LAND MANAGEMENT
Anchorage District & Land Office
555 Cordova Street
Anchorage, Alaska 99501

ALO:L6

OCT 23 1964

CERTIFIED MAIL - RETURN RECEIPT REQUESTED

Benjamin Harvey Cowart
P. O. Box 4532
Spennard, Alaska

Anchorage Serial No 046677

Type of Entry Homestead

Purchase Price -----

Enclosed is a Notice for Publication, together with a letter of instructions to the Anchorage Daily Times, in regard to the publication of your entry. The notice and letter are to be delivered to the newspaper. The newspaper will look to you for the payment of this publication.

Publication of the notice in the newspaper must begin within 60 days from receipt of this notice. Failure to do so will delay the processing of the case to patent.

At the end of the publication period, you are required to furnish or have the newspaper furnish proof of publication of the notice, such proof to consist of an Affidavit of Publication to which is attached a copy of the notice as published.

The purchase price, noted above, should be forwarded to the Anchorage District & Land Office, Cordova Building, 555 Cordova Street, Anchorage, Alaska, in the form of a check or money order payable to the Bureau of Land Management.

Sincerely yours,

INSTRUCTIONS TO DELIVERING EMPLOYEE	
<input type="checkbox"/> Deliver <i>ONLY</i> to addressee	<input type="checkbox"/> Show address where delivered
<i>(Additional charges required for these services)</i>	
BUREAU OF LAND MANAGEMENT CENTRAL RECEIPT	
Received the numbered article described on other side.	
SIGNATURE OF NAME OF ADDRESSEE (NAME MUST BE FILLED IN) OCT 27 9 55 AM '64	
RECEIVED SIGNATURE AND ADDRESS OF ADDRESSEE Benjamin H. Cowart	
DATE DELIVERED OCT 26 1964	SHOW WHERE DELIVERED (only if requested)

Ed P. Steger
District Manager
Anchorage District & Land Office



ALO-Misc-63
March 62

UNITED STATES
DEPARTMENT OF THE INTERIOR
BUREAU OF LAND MANAGEMENT
Land Office
Cordova Building
555 Cordova Street
Anchorage, Alaska

IN REPLY REFER TO:

ALO:L6

107 28 1962

Serial No. Anch 046677
Type Homestead
Entryman Benjamin Harvey Cowart
No. of Weeks 5

Anchorage Daily Times
Box 40
Anchorage, Alaska

Gentlemen:

Enclosed is a notice for publication of the claim identified above. This notice is to be published once each week in consecutive weekly issues (the same day each week) for the number of weeks indicated. You will look to the entryman for the payment of this publication.

At the expiration of the period of publication, please file proof of the publication.

It is requested that a copy of the first published notice be sent to this office and to the applicant.

Sincerely yours,

Alfred P. Steger
~~State of Alaska Section~~
Acting Manager
Anchorage District & Land Office

Enclosure:
Notice for publication

UNITED STATES
DEPARTMENT OF THE INTERIOR
BUREAU OF LAND MANAGEMENT
Anchorage District Office
555 Cordova Street
Anchorage, Alaska 99501

ALCL#

Date: 3-20-62

NOTICE FOR PUBLICATION

Notice is hereby given that Benjamin Harvey Gwart entryman,
of Seward, Alaska, together with his witnesses
Lawrence A. Malloy of Seward, Alaska and
Clarence E. Mico of Anchorage, Alaska has
submitted final proof on his Homestead entry(x)
Anchorage Serial Number(x) 040677 for a tract of land
described as W 1/4 NW 1/4, Sec. 27; S 1/4 NE 1/4, Sec. 28, T. 16 N., R. 4 W., S. M.

containing 100.00 acres, and it is now in the files of the Land Office,
Anchorage, Alaska. Any person, corporation, or association having or asserting
any adverse interest in, or claim to, the tract of land or any part thereof
sought, may file in the Anchorage Land Office, during the period of publication
or within 30 days thereafter, under oath, an adverse claim setting forth the
nature and extent thereof, and such adverse claimant shall, within sixty days
after the filing of such adverse claim, begin action to quiet title in a court
of competent jurisdiction within Alaska, and thereafter patent shall be issued
in conformity with the final decree of the court.

Alfred P. Steger
~~Chief, Lands Section~~
Acting Manager
Anchorage District & Land Office

ALO-166-34c
March 62

ALO:16

UNITED STATES
DEPARTMENT OF THE INTERIOR
BUREAU OF LAND MANAGEMENT
Land Office
Cordova Building
6th and Cordova
Anchorage, Alaska

107 28 1964

Benjamin Harvey Cowart : Serial No. Anch 046677
P.O. Box 4532 : Homestead 1.1
Spennard, Alaska : Act of May 20, 1862 (12 Stat. 392)

NOTICE OF ALLOWANCE

Your homestead entry, identified by the above serial number, has this date been allowed for the following lands:

W $\frac{1}{2}$ NW $\frac{1}{4}$, Sec. 27; E $\frac{1}{2}$ NE $\frac{1}{4}$, Sec. 28, T. 16 N., R. 4 W., S. M., containing 160.00 acres.

The act of March 8, 1922 (48 USC 376) provides that where a mineral lease or permit is issued pursuant to an application filed prior to the initiation of a homestead claim, the lands in the homestead claim are subject to the right of the permittee or lessee to occupy and use so much of the surface of the lands as may be reasonably required for mineral leasing operations, without liability to the entryman for crop and improvement damages resulting from such mineral activity (see 43 CFR Part 66).

The lands in your entry are covered by the following oil and gas lease(s) ~~and gas lease(s)~~

<u>Serial Number</u>	<u>Date Filed</u>
Anchorage 022752	11/7/52

All oil and gas deposits in the lands are reserved to the United States in accordance with and subject to the provisions of the act of March 8, 1922 (48 USC 376).

This entry is subject to established easements which may cross your claim. Easements include but are not limited to:

None of record.

You are advised that your entry is subject to further compliance with the law and regulations applicable to homesteads in Alaska.

Please refer to the serial number shown above when corresponding with this office concerning your entry.

~~Rocky Mountain~~
~~Alaska~~
~~Alaska~~

Alfred P. Steger
~~Chief of District~~
Acting Manager
Anchorage District & Land Office

sp:10/19/64

Form 4-007
(February 1964)

UNITED STATES
DEPARTMENT OF THE INTERIOR
BUREAU OF LAND MANAGEMENT

FORM APPROVED
BUDGET BUREAU NO. 42-R973.2

HOMESTEAD ENTRY APPLICATION
Section 2289 R.S. (43 USC 161)

Land Office
Anchorage, Alaska
Serial Number
046677

1. Name of Applicant (first, middle initial, and last) Address (include zip code)
Benjamin H. Cowart Spenard, Alaska PO Box 4532

2. Give legal description of lands applied for

TOWNSHIP	RANGE	MERIDIAN	SECTION	SUBDIVISION
T.16 N.	R.4W.	S.M.,	Sec. 27, W $\frac{1}{2}$ NW $\frac{1}{4}$; Sec. 28, E $\frac{1}{2}$ NE $\frac{1}{4}$, Containing 160 acres.	<i>East</i>
State of Alaska			Containing a total of	160 acres

3. Do you own more than 160 acres of land? Yes No (If "yes," give total acreage and location)
2 $\frac{3}{4}$ acres at Fire Lake. 2 $\frac{1}{2}$ acres on OMalley Road. 1 lot, Southwood Park

4. Are you under 21 years of age 21 years of age or over head of a family?

5. Are you a citizen of the United States? Yes No

a. If "yes," are you native born naturalized?

b. If "no," have you filed a declaration of intention? Yes No (If "yes," complete the following)

Give date	Name of court	City
-----------	---------------	------

6. Have you served in the United States military service? Yes No (If "yes," complete the following)

Branch of service	Dates of service	Serial number	Type of discharge
NAVY	9-24-42 to 4-3-1946	665-25-61	Honorable

7a. Have you made any entry under the nonmineral public land laws? Yes No *small tract*

b. Have you filed a soldier's or sailor's declaratory statement for any land? Yes No

c. Is there within the limits of the lands, any vein or lode of quartz or other rock in place bearing gold, silver, cinabar, lead, tin, or copper, or any deposit of coal, placer, cement, gravel, salt spring, or deposit of salt, or other valuable mineral deposit? Yes No

d. Is any portion of said land claimed for mining purposes under the local customs or rules of miners, or otherwise? Yes No

e. Is any portion of said land worked for mineral during any part of the year by any person or persons? Yes No

- 7f. Is the land occupied or improved by any Indian? Yes No
8. Does the land contain any hot springs? Yes No (If "yes," describe briefly, including daily capacity in gallons)
9. Have you attached required Petition for Classification (Form 4-1677)? Yes No

I CERTIFY That

- | | |
|---|---|
| <p>a. This application is made for the purpose of actual settlement and cultivation, and not as agent for or in collusion with or for the benefit of any other person, corporation, or syndicate.</p> <p>b. I will faithfully and honestly endeavor to comply with all the requirements of law as to settlement, residence, and cultivation necessary to acquire title to the land applied for.</p> <p>c. I do not apply to enter the same for the purpose of speculation, but in good faith to obtain a home for myself.</p> | <p>d. I will not directly or indirectly make any agreement or contract, in any way or manner, with any person or persons, corporations, or syndicate whatsoever, by which the title which I may acquire from the Government of the United States will inure in whole or in part to the benefit of any person except myself.</p> <p>e. I am well acquainted with the character of the land herein applied for and with each and every legal subdivision thereof, having personally examined same.</p> <p>f. The statements made by me in this application are true, complete, and correct to the best of my knowledge and belief and are made in good faith.</p> |
|---|---|

8-24-64

(Date)

Benjamin Harney Court
(Sign here with full name)

Title 18 U.S.C., Section 1001, makes it a crime for any person knowingly and willfully to make to any department or agency of the United States any false, fictitious or fraudulent statements or representations as to any matter within its jurisdiction.

I HEREBY CERTIFY that the foregoing application is for surveyed land of the class which the applicant is legally entitled to enter, that there is no prior valid adverse right to the same, and has this day been allowed.

(Date)

Alfred P. Steger
(Signature of Manager)

INSTRUCTIONS

- | | |
|--|--|
| <p>1. Type or print plainly in ink.</p> <p>2. Item 4 - Every applicant must state that he is 21 years of age or over or the head of the family, giving facts in support of this statement; or is entitled to make entry because of military or naval service, although under 21 years of age and not the head of the family. The applicant, if a married woman, must show that because of the mental or physical incapacitation of her husband she is the actual head of the family. If she makes application as a deserted wife, she must show that she is actually deserted by her</p> | <p>husband, stating duration of desertion, and whether he has helped to support her since desertion.</p> <p>3. Item 5a - If citizenship is claimed by virtue of naturalization of the father, evidence of his naturalization, and that applicant resided in the United States thereafter while a minor, should be furnished. Where husband and the wife were native born and a statement to that effect is made, additional information as to the marital status is not required. In other cases, a married woman or widow must show the date of her marriage; a widow must show, in addition, the date of the death of her husband.</p> |
|--|--|



UNITED STATES
DEPARTMENT OF THE INTERIOR
BUREAU OF LAND MANAGEMENT

ALO:15

ALO-166-81a
March 64

Anchorage District Office
555 Cordova Street
Anchorage, Alaska 99501

AUG 18 1964

Certified Mail
Return Receipt Requested

NOTICE

Benjamin H. Cowart
P.O. Box 4532
Spennard, Alaska

Serial No. Anch 046677
Homestead 1.1
Plat Filed June 15, 1964
Amount Due \$25.00

Adjustment to Plat of Survey and Application
to Enter Required

The plat of survey covering lands in your location notice was officially filed on the date shown above.

The regulations in 43 CFR 101.6(c) read in pertinent part:

"...it shall be the duty of the manager, upon the filing of the township plat in the land office,...to require the adjustment of the claim to the public survey within 30 days. In default of action by the party notified the manager will promptly adjust the claim..."

Accordingly, you are hereby allowed 30 days from receipt of this notice within which to adjust your claim to the plat of survey and to advise this office of the surveyed description of your claim. Failure to comply with this request will make it necessary for us to adjust your claim to the plat of survey, and to the description shown below.

Pertinent regulations regarding the protection of a preference right to enter lands unsurveyed when settled and on which plat of survey is filed, are set forth in 43 CFR 166.15:

"...Entry should be made within 3 months after settlement upon surveyed lands or within that time after the filing in the land office of the plat of survey of lands unsurveyed when settle-

the preference right (basis added)

adjusting to the plat of survey,

enclosed application is office together with

payable to the Bureau amount shown above to

fred P. Steger
ef, Lands Section

INSTRUCTIONS TO DELIVERING EMPLOYEE	
<input type="checkbox"/> Deliver ONLY to addressee	<input type="checkbox"/> Show address where delivered.
<i>(Additional charges required for these services)</i>	
RECEIPT	
Received the numbered article described on other side.	
SIGNATURE OR NAME OF ADDRESSEE (must appear in boldface)	
<i>Benjamin H. Cowart</i>	
SIGNATURE OF ADDRESSEE'S AGENT, IF ANY	
NOCH 100-111111	
DATE DELIVERED	SHOW WHERE DELIVERED (only if delivered to addressee)
8-24-64	

Enclosure:
Survey Plat
Form 4-007

* T. 16 N., R. 4 W., S.M., Sec. 27, 28, 29, 30, 31, 32, 33, 34, 35, 36, 37, 38, 39, 40, 41, 42, 43, 44, 45, 46, 47, 48, 49, 50, 51, 52, 53, 54, 55, 56, 57, 58, 59, 60, 61, 62, 63, 64, 65, 66, 67, 68, 69, 70, 71, 72, 73, 74, 75, 76, 77, 78, 79, 80, 81, 82, 83, 84, 85, 86, 87, 88, 89, 90, 91, 92, 93, 94, 95, 96, 97, 98, 99, 100, Containing 160 acres.

ALO-Adm-95 (May 1962)

OPTIONAL FORM NO. 10
5010-104

UNITED STATES GOVERNMENT

Memorandum

sol
DATE: 7/7/1964

TO : Case File Serial No. A046677

FROM : Records Unit, Anchorage Land Office

SUBJECT: Plat of survey officially filed this date **JUN 15 1964**

- Original Plat of Survey (Rect. Net)
- Supplemental Plat of Survey
- U. S. Survey No. _____
- Dependent Resurvey
- Independent Resurvey
- Other _____

Land Description now reads:

T. 16N., R. 4W., Sew-Mer.

Sec. 27, W² NW⁴
28, E² NE⁴

Acresage: 160.-

AIG:02
6-346677
IN 1-1

Anchorage District Office
Federal Building
Fourth and G Streets
Anchorage, Alaska 99501

APR 24 1964

Mr. Benjamin R. Cowart
P.O. Box 4532
Spencer, Alaska

Dear Mr. Cowart:

The survey returns for T. 16 N., R. 4 W., S.M., which accommodate your claim have been mailed to the Director's Office in Washington D.C., for examination and acceptance. We have been assured that special consideration will be given those survey returns. After the survey has been returned from Washington, the land office is required to direct publication in the Federal Register. This will take about thirty days. You will then be authorized publication of your claim in a local newspaper. We will notify you when this is ready.

After publication if everything is in order, your case will be ready for final certificate and patent.

We regret the delay, but it was necessary for our survey crews to return to the field several times to accommodate other claims that became valid subsequent to yours.

Sincerely yours,

James W. Scott
District Manager

AHolley;sp:4/14/64

Revised: 9/12/61

Dist: L.O.
I & M

UNITED STATES
DEPARTMENT OF THE INTERIOR
BUREAU OF LAND MANAGEMENT
ANCHORAGE LAND DISTRICT - AREA 4 - ALASKA
HOMESTEAD REPORT

Subject: 1.0 Homestead Final Proof Date of Stat. Off. Action APR 1962

Anch. Ser. No. 046677 Date of Examination October 11, 1961

Name Benjamin H. Cowart Signed: Robert A. Hampson, Land Examiner

Date December 4, 1961 Approved: [Signature] Name, Title

Date November 25, 1958 (Application - Final Proof) Approved: [Signature] Name, Title

(~~Entryman~~ Location Notice filed)

1. LANDS INVOLVED: What will be when surveyed: Chief, Branch of Field Investigations

T. 16 N., R. 4 W., S.M.

Section 27: NW1/4

Section 28: E1/2 ACREAGE: 160

2. INFORMATION FROM FINAL PROOF:

a. Military Service Claimed: From: 9/24/42 To: 4/2/46

42
Total Months Service

b. Residence Claimed: From: 11/21/58 To: 2/15/60

(Entryman ~~was~~ Benjamin H. Cowart)

c. Cultivation Claimed:

Timothy, rye, clover 20
Type Acreage

3. INFORMATION FROM FIELD EXAMINATION:

a. Identification of the Land: B.L.M. Monument: S21/S22
S28/S27
Other _____

(Other than proof witnesses)

b. Residence Indicated by Interviews:

Name: Ronald H. Bell Dates: Fall, 1958 to Spring, 1960

Address: _____ Dates: _____

Name: No other witnesses available Dates: _____

Address: _____ Dates: _____

c. Cultivation:

Acreage Required: 20 Acreage Cultivated: 25

Location: NW1/4 Sec. 27; NE1/4 Sec. 28 What Planted: Timothy, rye

d. Improvements:

Description	Size	Location
<u>Frame house</u>	<u>16' x 24'</u>	<u>NW1/4, Section 27</u>
_____	_____	_____
_____	_____	_____

4. STATUS OF THE LAND:

The records indicate no conflicts of appropriation. The lands are not embraced by any withdrawal or reservation, are not within the limits of any town or city, and are not otherwise segregated from appropriation under the Homestead laws. No other persons have any adverse claim to the improvements on the homestead. The lands are not within one-fourth mile of any mineral, medicinal or hot springs. ~~There is no evidence that the lands are within one-fourth mile of any mineral, medicinal or hot springs.~~

5. CONCLUSIONS: Has entryman met requirements as to:

Improvements Yes X No _____

Cultivation Yes X No _____

Residence Yes X No _____

Remarks: Survey is on ground, but the plat is not yet approved.

6. RECOMMENDATIONS:

Are Final Certificate and Patent recommended? Yes X No _____

Is survey recommended? Yes X Not applicable, Land is surveyed _____



UNITED STATES
DEPARTMENT OF THE INTERIOR
BUREAU OF LAND MANAGEMENT
Land Office
Cordova Building
6th and Cordova
Anchorage, Alaska

IN REPLY REFER TO:
Anch 046677

FA-2
Hampson

DEC 1 2 1961

SUPPLEMENTAL

MEMORANDUM

To: Director, Geological Survey, Washington 25, D.C.
From: **Manager, Anchorage Land Office**
Subject: Report of Mineral and Water Resources

RECEIVED
FEB 7 1962
GEOLOGICAL SURVEY

A report is requested as to the mineral and water resources of the lands described below.

Please specify in your report the mineral or minerals involved, and where applicable, whether disposal of the lands would unreasonably interfere with operations under the mineral leasing acts.

In those cases where satisfactory final proof has been submitted, the report must show whether or not the lands were known to be valuable for the minerals at the date of proof and the facts upon which this information is based.

Kind of case: Homestead		Name: Benjamin H. Cowart
Filed: 11/25/53	Allowed: 6/12/59 Known: 6/12/59	Date satisfactory final proof was received: 12/4/61
Date entry will be confirmed: _____		Date of last report: 3/19/59

Remarks:

Please advise whether these lands are valuable or prospectively valuable for coal, oil and gas prior to, on date of, and subsequent to the final proof date, December 4, 1961.

Land description:

~~W&W~~, Sec. 27; ~~E&W~~, Sec. 28, T. 16 N., R. 4 W., S.M.

Warner T. May

(Signature) **Manager, Anchorage Land Office**
(Title)

Form 4-110a
(May 1958)

INT.-DUP. SER., WASH., D.C. 35804

FEB 10 1962

Bureau of Land Management

Survey information indicates that this land is valuable prospectively for prior to, as of, and subsequent to ~~oil & gas~~ and that it is without value for other minerals, either metalliferous or nonmetalliferous, and that the exercise of surface rights thereon would not interfere unreasonably with operations under the mineral leasing law.

OIL & GAS

The land is not withdrawn for waterpower or storage purposes.

(Sgd) J. C. Miller

For the Director
Bureau of Land Management

ALO:A3
Anch 046677
HE 1.1

Land Office
Cordova Building
6th and Cordova
Anchorage, Alaska

November 21, 1961

Mr. Benjamin R. Cowart
P.O. Box 4532
Spenard, Alaska

Dear Mr. Cowart:

Your homestead entry final proof, testimony of claimant, was received in the Anchorage Land Office and placed in your case folder. However, no action can be taken until the required fees are submitted.

Please make check or money order in the amount of \$7.50 (regular final proof fees) payable to the Bureau of Land Management and return it as soon as possible.

Sincerely yours,

FOR THE MANAGER

M. J. Teclaw

Form 4-369
(July 1958)

UNITED STATES
DEPARTMENT OF THE INTERIOR
BUREAU OF LAND MANAGEMENT

HOMESTEAD ENTRY FINAL PROOF

TESTIMONY OF CLAIMANT

FORM APPROVED BUDGET BUREAU NO. 42-R971.1
Land Office Anchorage, Alaska
Serial Number (Original Entry) 345677
Serial Number (Additional En.) NONE

NOTE: The officer before whom this proof is made will see that all answers are complete and responsive to the questions, and that the answers bring out the pertinent facts showing the entryman's compliance or noncompliance with the laws under which the land was entered. Neither of the witnesses may be present while the testimony of the claimant is being given.

1. Name (Give first name, middle initial, & last name): Benjamin H. Cowart	Full post office address: Seward, Alaska P.O. box 4532	Age 39
---	--	---------------

2a. I am a citizen of the United States Yes No Native born Naturalized

b. I claim citizenship through my own naturalization through my husband's naturalization

Certificate Number _____ Name of Court _____

City in which Court is located _____

Evidence of naturalization submitted with Entry No. _____ with this final proof

c. I am Single Married Widowed Divorced Date of marriage Dec. 22, 1959

d. My husband is or was a native born citizen naturalized citizen Date of husband's death _____

e. My family living with me consists of
Wife
One child

3. I am entitled to credit for military service (43 CFR, Part 181) Yes No

Name of Veteran Benjamin H. Cowart	Relationship to claimant _____
Date of Induction September 24, 1942	Date of Discharge April 2, 1946
Branch of Service Navy	Serial Number 66512516
Type of Discharge Honorably	Certified copy of discharge attached <input checked="" type="checkbox"/> Yes <input type="checkbox"/> No

4. I am am not the person who made the homestead entry or entries noted above.
The person who made the homestead entry or entries noted above is (Give name of entryman & relationship to claimant): _____

5. The description of the lands included in the entry or entries noted above is as follows:
section 27, 1/2 of 1/4
section 28, 1/2 of 1/4

BUREAU of LAND MANAGEMENT
ANCHORAGE LAND OFFICE

Section 27 & 28, Township 15, Range 24, Seward Meridian

6. I am a married woman and my husband did did not hold an unperfected homestead during the period of residence claimed by me. He resided on the land with me for a total of _____ months during my period of residence.

7a. The residence I claim was made upon the original entry additional entry

b. I first established actual residence on (Give month, day, & year): 11/22/58

c. I am making this proof for an additional entry under Section 7 of the enlarged homestead law for lands within 20 miles of the original homestead on which my residence is maintained.
 I did did not own the original entry during the entire period of such residence.

d. I am making this proof for a contiguous additional entry and have submitted proof of required residence in connection with the original entry.

e. Other facts in connection with my residence necessary to claim compliance with the law are as follows: _____

8a. I have have not a habitable house on the land. The house was built on 3/12/59 (Give month, day, & year)

b. The house was built after residence was established Yes No
 Before the house was built, I resided at: near same location in tent house.

9a. PERIODS OF ACTUAL RESIDENCE ON THE LAND IN THE HOMESTEAD

I ACTUALLY RESIDED ON THE LAND			MY FAMILY ACTUALLY RESIDED ON THE LAND	
RESIDENCE YEAR*	FROM (Give month, day, & year)	TO (Give month, day, & year)	FROM (Give month, day, & year)	TO (Give month, day, & year)
11/21/58	11/21/58	2/15/60		
Cleared and seeded ten acres first year. Second year, cleared ten acres and seeded twenty acres. Claiming first seven months of residence and military time instead of commuting as had originally planned.				

9b. PERIODS OF ABSENCES FROM THE LAND IN THE HOMESTEAD AND REASONS FOR ABSENCES

RESIDENCE YEAR*	FROM (Give month, day, & year)	TO (Give month, day, & year)	WHO WAS ABSENT (Specify "claimant", "family", or "both")	REASON FOR ABSENCE
3/1/59	3/1/59	3/3/59	Claimant had no family	out of town on business for FAA
3/26/59	3/26/59	3/31/59	Claimant	out of town on business for FAA
5/11/59	5/11/59	5/13/59	Claimant	out of town on business for FAA
10/12/59	10/12/59	10/25/59	Claimant	out of town on business for FAA

10. CHARACTER OF LAND EMBRACED IN THE HOMESTEAD

SECTION	LEGAL SUBDIVISION	GENERAL CHARACTER OF THE LAND	NUMBER OF ACRES			BOARD FEET OF SAW TIMBER
			NOW CULTIVATED	NOT CULTIVATED BUT CULTIVABLE	CONTAINING TREES OR BRUSH	
27 & 28		flat to rolling	20 acres	90 acres	160	very little

11. ACTUAL AGRICULTURAL USE OF THE LANDS IN THE HOMESTEAD

CALENDAR YEAR	KIND OF CROP PLANTED	NO. OF ACRES CULTIVATED	QUANTITY OF CROP HARVESTED	EXTENT OF GRAZING USE OF LAND			REASON FOR CULTIVATING LESS ACRES THAN REQUIRED BY LAW
				NO. OF MONTHS	ANIMALS		
					Kind	Number	
1960	timothy eye clover	10	none	none			
1961	timothy eye clover	10	none	none			

12a. IMPROVEMENTS PLACED ON THE LANDS IN THE HOMESTEAD

SECTION	LEGAL SUBDIVISION	DESCRIPTION OF IMPROVEMENTS	YEAR MADE	VALUE OF MATERIALS	VALUE OF LABOR	TOTAL VALUE
27 & 28		tent house	1958	75.00	75.00	150.00
		built cabin	1959	\$500.00	\$450.00	\$950.00
		cleared & seeded 10 ac.	1960	30.00	1000.00	1030.00
		cleared 10 acres seeded 20	1961	\$65.00	\$1000.00	\$1065.00
		moved cabin and	1961	610.00	500.00	1110.00
		small tractor and plows		\$	\$	\$ 900.00
		D-7 Caterpillar				6500.00
		to accomplish efforts (Champion plane, floats, wheels, sleds)				5000.00
				\$	\$ total	11,705.00

12b. PRESENT VALUE OF IMPROVEMENTS less plane 11,705.00

Estimated present value of improvements placed on the homestead: \$ 11,705.00

* The first "residence year" begins with the day on which residence was first established.

13. My homestead is within the limits of an incorporated town or selected site of a city or town Yes No
(If "yes" explain):

14. My homestead is used for trade or business Yes No (If "yes" explain):

15. There are no indications of coal, salines, or minerals of any kind on my homestead except (If none, write "none"):
NONE

16. I have sold, conveyed, agreed to sell or convey, or optioned, mortgaged, or agreed to option or mortgage the land in my homestead, or any part thereof Yes No (If "yes" give names of parties to the transaction and date, amount, and purpose of transaction):

17. I have made another homestead entry Yes No (If "yes" give land office, entry numbers, and land description):

18. Other entries which I have made, other than homestead and mineral entries and public sale purchases, since August 30, 1890 are as follows (Give land office, kind of entry, entry number, and description of land by legal subdivision; if none, write "none"):
None also, 014671, T15, R2W, Sec. 25, lot 122
T2S R1E 059102

19. Neither of the witnesses was present while I was giving the above testimony Yes No

20. The witnesses did did not inform me of their testimony in connection with this proof.

21. I do now apply to perfect the above-described entry or entries and for the purpose do solemnly affirm that I am a citizen of the United States; that there is a habitable house upon Sec. 27W 1/2 of NW 1/4 Sect. 28 1/2 of T2S
(Land description)

that residence and agricultural use of the land has been performed as set forth in my testimony; that no part of said land has been transferred or conveyed to any other person, or otherwise alienated except as provided in section 2288 of the Revised Statutes; that I will bear true allegiance to the Government of the United States; and, further, that I have not heretofore perfected or abandoned an entry made under the homestead laws of the United States, except (If none, write

"none"): NONE

10-30-61
(Date)

Benjamin Harvey Cowart
(Sign full name)

I HEREBY CERTIFY that the deponent was examined separately and apart from the witnesses in the case; that the foregoing deposition and affidavit were read to or by the deponent and affiant in my presence before he or she affixed signature thereto; that I verily believe deponent and affiant to be a creditable person and the identical person hereinbefore described, and that

said deposition and affidavit were duly subscribed and sworn to before me at my office in Anchorage
(Town)
County, State of Alaska

within the Third Div. land district, this 4 day of November, 1961.

Paul E. Combs
(Signature)

Notary Public
Official Designation Expire 5-1-26

Form 4-369a
(April 1958)

UNITED STATES
DEPARTMENT OF THE INTERIOR
BUREAU OF LAND MANAGEMENT

HOMESTEAD ENTRY FINAL PROOF

TESTIMONY OF WITNESS

FORM APPROVED
BUDGET BUREAU NO. 42-R886.1

Land Office ANCHORAGE ALASKA
Serial Number (Original Entry) 046677
Serial Number (Additional Entry) _____

NOTE: The officer before whom this proof is made will see that all answers are complete and responsive to the questions, and that the answers bring out the pertinent facts showing the entryman's compliance or noncompliance with the laws under which the land was entered. Neither the claimant nor the other witness may be present while the testimony of this witness is being taken.

1. Name (First name, middle initial, & last name): <u>LAWRENCE R. M. COY</u>	Full post office address: <u>Box 515 SEWARD</u>	Age <u>33</u>
---	--	------------------

2. I am am not the same person mentioned in the published notice as

Note: Officer before whom proof is taken will fill in the name as published.

3. The description of the lands included in the entry or entries noted above is as follows:

BUREAU OF LAND MANAGEMENT
ANCHORAGE LAND OFFICE

Section 27 and 28, Township 16N, Range 10W, Seward Meridian.

4a. I have known the entryman <u>5</u> years.	b. The entryman's family consists of: <u>WIFE AND CHILD</u>
c. The entryman <input checked="" type="checkbox"/> is <input type="checkbox"/> is not married.	

5a. I have known the above-described land <u>3y. Long</u> .	b. I have seen the land <u>MANY TIMES</u> each year.
---	--

c. The homestead is not within the limits of an incorporated town and is not used in any way for trade or business except (if so, give the details; otherwise, write "none").

NONE

d. The entryman has resided on his original entry additional entry

e. The entryman established actual residence on said homestead on (Give month, day, & year): 11-21-58

f. I have seen entryman and his family residing on the homestead MANY times each year.

g. Since actual residence was established, the entryman or his family did not maintain a residence elsewhere than on this land except (if so, state place and period of residence; otherwise, write "none").

NONE

h. There is now not now a habitable house on the land.

6. PERIODS OF ACTUAL RESIDENCE ON THE HOMESTEAD

WHO WAS PRESENT (Specify "claimant," "family," or "both")	FROM (Month, day, & year)	TO (Month, day, & year)
<u>CLAIMANT</u>	<u>11-21-58</u>	<u>SP 2-15-60</u>

7. PERIODS OF ABSENCE FROM THE HOMESTEAD

WHO WAS ABSENT (Specify "claimant," "family," or "both")	FROM (Month, day, & year)	TO (Month, day, & year)	REASON FOR ABSENCE
SOME	NOT KNOWN	NOT KNOWN	NOT KNOWN

8. CHARACTER OF LAND EMBRACED IN THE HOMESTEAD

LEGAL SUBDIVISION	GENERAL CHARACTER OF THE LAND	NUMBER OF ACRES			BOARD FEET OF SAW TIMBER
		NOW CULTIVATED	NOT CULTIVATED BUT CULTIVABLE	CONTAINING TREES	
NONE	Rolling Hills	Approx 80	Approx 140	40 ASD	UNKNOWN

9. ACTUAL AGRICULTURAL USE OF LANDS IN THE HOMESTEAD

CALENDAR YEAR	NO. OF ACRES CULTIVATED	KIND OF CROP PLANTED	EXTENT OF GRAZING USE OF LAND
1960	10	HAY	NONE
1961	20	HAY	NONE

10a. IMPROVEMENTS PLACED ON LANDS IN THE HOMESTEAD

SECTION	LEGAL SUBDIVISION	DESCRIPTION OF IMPROVEMENTS	YEAR MADE	COST OF MATERIAL	COST OF LABOR	TOTAL COST
27+28	NONE	TENT (TEMPORARY QUARTERS)	1958	\$ 75.20	\$ 78.00	\$ 153.20
		CABIN	1959	\$ 600.00	\$ 850.00	\$ 1450.00
		CLEARED & SEEDD (10) ACRES	1960	\$ 80.00	\$ 1000.00	\$ 1080.00
		CLEARED (10) ACRES PLANTED 20 ACRES	1961	\$ 160.00	\$ 1000.00	\$ 1160.00
		D-7 CAT FORM ALL TRACTORS & Mows		\$ 7000	\$ 900	\$ 7900.00

10b. PRESENT VALUE OF IMPROVEMENTS

Estimated present value of improvements placed on the homestead

\$ 11,743.00

TOTAL 11,743.00

11a. LAND TREATMENTS INCREASING PRODUCTIVITY OF LANDS IN THE HOMESTEAD

SECTION	LEGAL SUBDIVISION	NUMBER OF ACRES					COST OF WORK
		CULTIVATED	IRRIGATED	CLEARED	SEEDD TO GRASS	OTHERWISE TREATED	
27+28		20		20	20		\$ 2240.00
							\$
							\$
							\$
							\$

11b. Give brief description of above treatment measures:

CLEARED OFF BUSH OVER BURDEN TO TOP SOIL, WIND BOWED ALL BUSH + OVER BURDEN, DISKED TOP SOIL. SOWED WITH HAY

12. There are no indications of coal, salines, or minerals of any kind on the homestead except (if none, write "none"):

NONE

13. I have no knowledge or information that the entryman has sold, conveyed, agreed to sell or convey, or optioned, mortgaged, or agreed to option or mortgage the land in the homestead, or any part thereof, except (if entryman has, give name of parties to the transaction and date, amount, and purpose of transaction; otherwise write "none"):

NONE

14. I am not interested in this homestead, or related to the entryman except (if so, explain; if not, write "none"):

NONE

15. I have have not personal knowledge, from my own observation, that the entryman and his family actually resided upon and cultivated the land each year in accordance with my testimony. My personal knowledge is based upon:

HEARD BUILD CABIN LISTED FAMILY AND FLOWN OVER PROPERTY MANY TIMES

16. The entryman was was not and the other witness was was not present while I was giving the above testimony.

17. I do do not have any actual knowledge of any statement made by either the entryman or the other witness in their testimony in connection with this proof.

11-15-61
(Date)

Lawrence R. McEay
(Sign full name)

I HEREBY CERTIFY that the deponent was examined separately and apart from the other witnesses in the case; that the foregoing deposition was read to or by deponent in my presence before deponent affixed signature thereto; that I verily believe deponent to be the identical person hereinbefore described, and that said deposition was duly subscribed and sworn to before me

at my office, in Anchorage, Alaska County, within the land district, this 15th day of November, 1961.

Betty E. Klehnerold
(Signature)

Notary Public
(Official Designation)

STATE 000566

C3006971

Series C

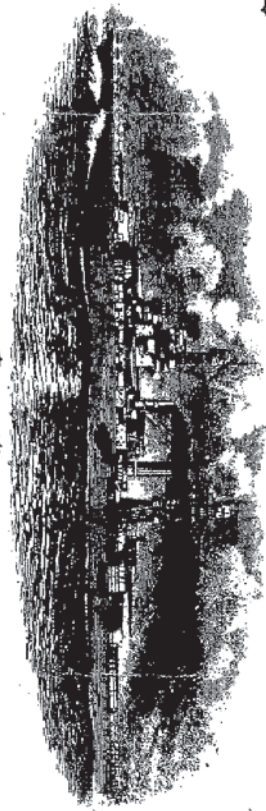

Home type

Honorable Discharge

This is hereby that

BENJAMIN HARVEY COWART

U. S. Motor Machinist's Mate, First Class

Honorable Discharge

from the Personnel Separation Center, USNB

Bremerton, Washington and from the Naval Service of the United States

This 2nd day of April 1946

This certificate is awarded as a testimonial of fidelity and
Obedience

Filed this 6 day June 1949
Recorded in book & page 75
A 8 5

HAROLD RYE, Captain, USN

F.S.N.S. 1-28-46 20M

Authority for discharge AINav 395-45

Following Data Transcribed from NavPers 553, Notice of Separation.

Serial or file number 665 25 61

Date and place of birth 19 May 1922 Mt. Home, Arkansas
(Date) (Place)

Date of entry into active service 24 September 1942

Highest rank or rating held MoMMLc

Service (vessels and stations served on)

NTS, San Diego, Calif.

Amphib. Boat Pool, Wellington, N. Zealand

Boat Pool No. 8

Nav. Base, Munda, Navy 250

SRU, Navy 3002

PSC, USNB, Bremerton, Wash.

Remarks

Asiatic-Pacific Area Campaign Medal (2 Stars)

Good Conduct Medal

World War II Victory Medal

Philippine Liberation Medal

*Award of Navy Unit Commendation to U.S.S. PRESIDENT ADAMS 1.
 Auth. Ltr. Chief Naval Personnel, Pers-1013-CWC MM/665 25 61227 May 49.
 (the above copied by me from original letter 7 June 49 and 7 50
 so certify) *Quincy Smith* Circuit Clerk, Baxter County, Ark.

C. E. Boyd
 C. E. BOYD, Captain, USN

Other entries previously made hereon now covered by NAVPERS-553, Notice of Separation.

Form 4-369a
(April 1958)

UNITED STATES
DEPARTMENT OF THE INTERIOR
BUREAU OF LAND MANAGEMENT

HOMESTEAD ENTRY FINAL PROOF

TESTIMONY OF WITNESS

FORM APPROVED
BUDGET BUREAU NO. 42-R886.1

Land Office Anchorage, Alaska
Serial Number (Original Entry) 046677
Serial Number (Additional Entry) None

NOTE: The officer before whom this proof is made will see that all answers are complete and responsive to the questions, and that the answers bring out the pertinent facts showing the entryman's compliance or noncompliance with the laws under which the land was entered. Neither the claimant nor the other witness may be present while the testimony of this witness is being taken.

1. Name (First name, middle initial, & last name): Clarence E. Rice
Full post office address: *See Note: on back page
C/O PAA-ALASKA
C/O PAA Anchorage Alaska
Box 440
Age 47

2. I am am not the same person mentioned in the published notice as

Note: Officer before whom proof is taken will fill in the name as published.

3. The description of the lands included in the entry or entries noted above is as follows:

Section 27, W 1/2 of N 1/4 Section 28, E 1/2 of NE 1/4

BUREAU OF LAND MANAGEMENT

Section _____, Township 16N, Range 4W, Seward Meridian.

4a. I have known the entryman 9 years.
b. The entryman's family consists of:
Himself
His wife Mrs. Jo Nell Cowart
" daughter Miss Donna Cowart

c. The entryman is is not married.

5a. I have known the above-described land 3 years.
b. I have seen the land several times each year.

c. The homestead is not within the limits of an incorporated town and is not used in any way for trade or business except (if so, give the details; otherwise, write "none"): None

d. The entryman has resided on his original entry additional entry

e. The entryman established actual residence on said homestead on (Give month, day, & year): latter part of 1958

f. I have seen entryman and his family residing on the homestead several times each year.

g. Since actual residence was established, the entryman or his family did not maintain a residence elsewhere than on this land except (if so, state place and period of residence; otherwise, write "none"): none to my knowledge

h. There is now not now a habitable house on the land.

6. PERIODS OF ACTUAL RESIDENCE ON THE HOMESTEAD

WHO WAS PRESENT (Specify "claimant," "family," or "both")	FROM (Month, day, & year)	TO (Month, day, & year)
<u>I spent considerable time with claimant exchanging work first year. Within the last 2 1/2 years I have visited he & his family several times. Exact dates I don't remember.</u>		

1. PERIODS OF ABSENCE FROM THE HOMESTEAD

WHO WAS ABSENT (Specify "claimant," "family," or "both")	FROM (Month, day, & year)	TO (Month, day, & year)	REASON FOR ABSENCE
During the first year the claimant was absent on several occasions for short durations. I work for the same organization and know his job required a few short absences. Exact records of his absences not kept here. Neither do I know exact dates he and his family have been on or off the homestead.			

8. CHARACTER OF LAND EMBRACED IN THE HOMESTEAD

LEGAL SUBDIVISION	GENERAL CHARACTER OF THE LAND	NUMBER OF ACRES			BOARD FEET OF SAW TIMBER
		NOW CULTIVATED	NOT CULTIVATED BUT CULTIVABLE	CONTAINING TREES	
	Timbered except for clearings	Estimated 20 to 25	Practically all	most of wooded ground	Not known

9. ACTUAL AGRICULTURAL USE OF LANDS IN THE HOMESTEAD

CALENDAR YEAR	NO. OF ACRES CULTIVATED	KIND OF CROP PLANTED	EXTENT OF GRAZING USE OF LAND
1960	Estimated 10	Grain	None to my knowledge
1961	" 20 to 30	Grain	" " " "

10a. IMPROVEMENTS PLACED ON LANDS IN THE HOMESTEAD

SECTION	LEGAL SUBDIVISION	DESCRIPTION OF IMPROVEMENTS	YEAR MADE	COST OF MATERIAL	COST OF LABOR	TOTAL COST
27-28		Clearing as shown above	59 to 61	\$	\$ Not known	\$ Not known
"	"	seeded 10 to 30 Acres	60 to 61	\$ Not known	\$ Not known	\$ " "
"	"	Built Cabin	1957	\$ Estimated 700 ⁰⁰	\$ Estimated 700 ⁰⁰	\$ Estimated 1400 ⁰⁰
"	"	moved cabin & built addition	1961	\$ Estimated 600 ⁰⁰	\$ Estimated 900 ⁰⁰	\$ Estimated 1500 ⁰⁰

10b. PRESENT VALUE OF IMPROVEMENTS

Estimated present value of improvements placed on the homestead \$ 8 To 16 thousand

11a. LAND TREATMENTS INCREASING PRODUCTIVITY OF LANDS IN THE HOMESTEAD

SECTION	LEGAL SUBDIVISION	NUMBER OF ACRES					COST OF WORK
		CULTIVATED	IRRIGATED	CLEARED	SEEDED TO GRASS	OTHERWISE TREATED	
To the best of my knowledge clearing and cultivation of acreage mentioned above. And additionally use of some commercial fertilizer on garden area							\$
							\$
							\$
							\$
							\$
							\$

11b. Give brief description of above treatment measures:

See 11 A

12. There are no indications of coal, salines, or minerals of any kind on the homestead except (if none, write "none"):

None to my knowledge

13. I have no knowledge or information that the entryman has sold, conveyed, agreed to sell or convey, or optioned, mortgaged, or agreed to option or mortgage the land in the homestead, or any part thereof, except (if entryman has, give name of parties to the transaction and date, amount, and purpose of transaction; otherwise write "none"):

None to my knowledge

14. I am not interested in this homestead, or related to the entryman except (if so, explain; if not, write "none"):

None

15. I have have not personal knowledge, from my own observation, that the entryman and his family actually resided upon and cultivated the land each year in accordance with my testimony. My personal knowledge is based upon:

frequent visits to homestead, changing of work, etc. I am a neighboring homesteader.

16. The entryman was was not and the other witness was was not present while I was giving the above testimony.

17. I do do not have any actual knowledge of any statement made by either the entryman or the other witness in their testimony in connection with this proof.

Except for legal description of homestead which was taken from record of location of settlement or occupancy, posted on land near Mr. Court's place.

11-17-61
(Date)

Clarence Edgar Rice
(Sign full name)

I HEREBY CERTIFY that the deponent was examined separately and apart from the other witnesses in the case; that the foregoing deposition was read to or by deponent in my presence before deponent affixed signature thereto; that I verily believe deponent to be the identical person hereinbefore described, and that said deposition was duly subscribed and sworn to before me

at my office, in Greubanks, 4th Judicial County, State of Alaska within the Anchorage land district, this 17th day of November, 1961.

Karen G. Sorenson
(Signature)

Notary Public
(Official Designation)

STATE 000571

* I am immediately on the way section 28 & 29
T 16 N - R 4 W - Section 17 - a neighbor of Mr. Casart,

I work for FAA, am presently on furlough and may
be here 45 to 60 days yet. If I am not back on my desk
when you desire an interview, please write me c/o FAA-ALASKA,
Box 440, Anchorage and I will be glad to call you when I return.
John
John

Box 4532
Spencer, Alaska
3-16-60

Bureau of Land Management
Land office
334 E Fifth Avenue
Anch. Alaska

Gentlemen;

copy

Discontinued permanent residence
residence on homestead, serial 046677 as of
Feb. 15-1960. Will proceed with clearing
and planting this summer.

Benjamin H. Cowart

[Faint, illegible text]

ALO 274
Rev. Jan. '59

UNITED STATES
DEPARTMENT OF THE INTERIOR
BUREAU OF LAND MANAGEMENT
Land Office
334 E. Fifth Avenue
Anchorage, Alaska

ALO:L1
Anch. 046677
Homestead Original
Act of May 20, 1862
(12 Stat. 392)

JUN 12 1959

Benjamin H. Cowart
P.O. Box 4532
Spenard, Alaska

Dear Mr. Cowart:

Your notice of location of settlement or occupancy has been assigned serial number Anchorage 046677.

Our records show that the lands are subject to settlement or occupancy. Enclosed is literature describing the requirements for acquiring title to the lands claimed.

The Acts of March 8, 1922 (42 Stat. 415) and August 23, 1958 (72 Stat. 730) state:

"Should it be discovered at any time prior to the issuance of a final certificate on any claim initiated for unreserved lands in Alaska that the lands are coal, oil, or gas in character, the patent issued on such entry shall contain the reservation * * * of coal or oil and gas to the United States.

Therefore, if it should be discovered prior to issuance of final certificate for your claim that the lands are coal, oil, or gas in character, you will be called upon to file a waiver of claim to the coal or oil and gas in the lands.

(FILED 5/8/59)

The regulations pertaining to the leasing of minerals particularly provide that where a mineral lease or permit, an offer to lease, or application for permit, is filed prior to the initiation of a claim, the lands in the claim are subject to the right of the permittee or lessee to occupy and use so much of the surface of the lands as may be reasonably required for mineral leasing operations, without liability to the claimant for crop and improvement damages resulting from such mineral activity.

The lands in your claim are covered by the following oil and gas lease ~~offer~~ filed prior to the date on which you indicated that you had initiated settlement.

<u>Serial Number</u>	<u>Date Filed</u>
Anchorage 022752	November 7, 1952

File

Please refer to your assigned serial number in connection with inquiries concerning your claim.

Sincerely yours,

ARS

Alfred P. Steger
Chief, Lands Adjudication Unit

UNITED STATES
DEPARTMENT OF THE INTERIOR
BUREAU OF LAND MANAGEMENT

MINERAL WAIVER

: Office
: LAND OFFICE
: 334 E. FIFTH AVENUE
: ANCHORAGE, ALASKA

: Serial Number

: Anchorage 046677

(Acts of June 22, 1910, 36 Stat. 538, 30 USC 83; July 17, 1914, 38 Stat. 509, 30 USC 121; March 8, 1922, 42 Stat. 415, 48 USC 376; March 4, 1933; 47 Stat. 1570, 30 USC 124; et al.)

Name

Benjamin H. Cowart

Type of Application or Entry

Homestead

Type of Mineral

: ***** Oil and Gas *****

Land Description

E $\frac{1}{2}$ NE $\frac{1}{4}$, Sec. 28, W $\frac{1}{2}$ NW $\frac{1}{4}$, Sec. 27, T. 16 N., R. 4 W., S.M.

I hereby consent to the amendment of the above-designated application, entry, or claim so as to reserve to the United States all the deposits of the above-named mineral(s) in the land embraced in said application, entry, or claim, pursuant to the provisions, conditions, reservations, and limitations of applicable law.

5-8-59
(Date)

Anch. Land Office
(Place)

Benjamin H. Cowart
(Signature of Claimant)

(Date)

(Place)

Hester Mess
(Signature of Witness)

5-8-59
(Date)

Anch. Land Office
(Place)

Gladys R. Killian
(Signature of Witness)

Est

ALO 257
Rev. Nov. '58

Reproduced at the National Archives at Anchorage
DEPARTMENT OF THE INTERIOR
BUREAU OF LAND MANAGEMENT
Anchorage, Alaska

APR 22 1959

Benjamin H. Covart
P. O. Box 4532
Spennard, Alaska

046677

Mineral Rights Reserved

A notice of location of settlement, or occupancy, filed by the above applicant has been received and assigned the serial number. Any future correspondence with this office, regarding this claim, should cite this serial number.

The Geological Survey has determined that the lands upon which this settlement is claimed are primarily of the oil & gas type. Under the provisions of the Act of March 3, 1953 (Public Law 333), settlement claims in Alaska must be mineral in character unless the claimant files a statement of the mineral in character.

Attached is a copy of the decision rendered. Thirty days from the date of receipt of this decision you will be required to take the following actions:

- (1) Execute and file with this office, in triplicate, the enclosed form.
- (2) Petition for reclassification of the lands as nonmineral in character. If a petition is filed, it must be supported by geologic or other technical data supporting the contention that the lands are not mineral in character.

If one of the above actions is not taken within the time prescribed, the above numbered case will be treated as abandoned.

The right of appeal to the Director, Bureau of Land Management, is allowed in accordance with instructions in enclosed Form 4-1364 made a part hereof. An appeal filed in accordance with the regulations in attached Form 4-1364 will be properly filed.

*Case file
pp 4/4/59*

AMS

POST OFFICE DEPARTMENT

RECEIVED

APR 24 1959

LAND OFFICE

ANCHORAGE, ALASKA

334 E. 5TH AVE.

STREET ADDRESS

REGISTERED NO.

DETERMINED NO.

INSURED NO.

POST OFFICE DEPARTMENT

ANCHORAGE, ALASKA

334 E. 5TH AVE.

STREET ADDRESS

REGISTERED NO.

DETERMINED NO.

INSURED NO.

1.1 NE Loc Not

Benjamin K. Cowart
P.O. Box 4532
Spenard, Alaska

Anchorage
046677

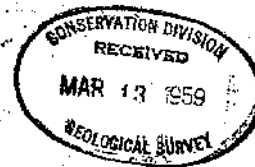

~~Range~~ Sec. 28, ~~W. 1/4~~ Sec. 27, T. 15 N., R. 4 W., S.M.

160 acres

11-23-58

Appl. recd.

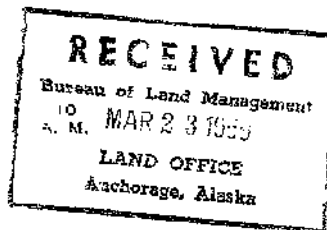

MAR 19 1959

The Director
Bureau of Land Management

Survey information indicates that this land
is valuable prospectively for *oil & gas*;
that it is without valuable minerals,
either so-called or known minerals, and
that the exercise of surface rights therein
would not interfere unfavorably with opera-
tions under the mineral leasing law.
The land is not withdrawn for waterpower or
storage purposes.

(Sgd) *J. C. Miller*

For the Director
Geological Survey

UNITED STATES
DEPARTMENT OF THE INTERIOR

DM-7
(Approved December 1943)

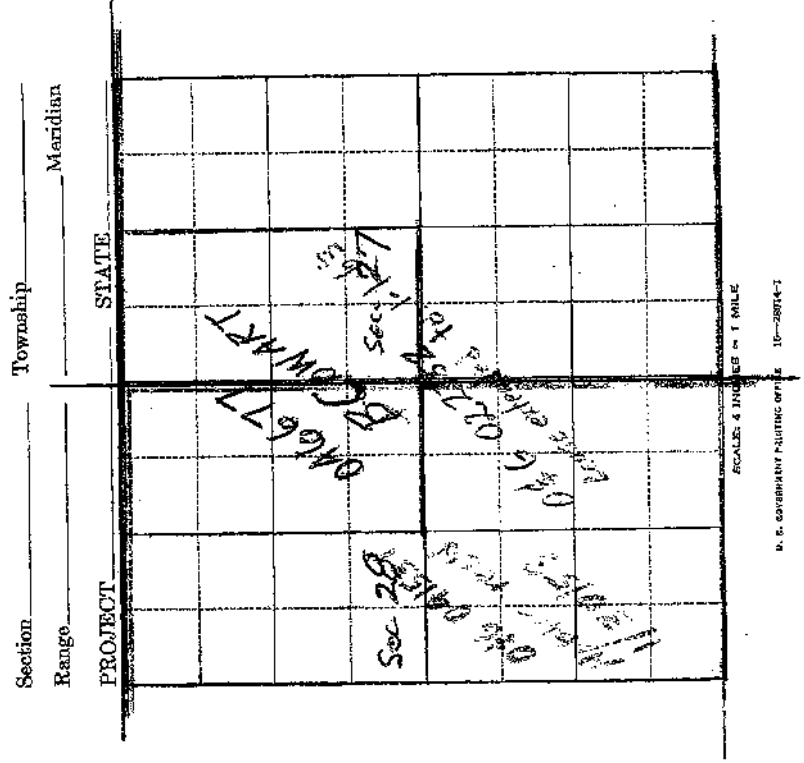

UNITED STATES
DEPARTMENT OF THE INTERIOR
BUREAU OF LAND MANAGEMENT

BRANCH OF LAND STATUS: Please furnish status of lands described in Case No. 100-77 or on the following described lands _____

Sec. _____, Twp. _____, Range _____, Meridian _____, County, State _____

Other data required _____

Name of requestor _____ Branch _____ Date _____

6	5	4	3	2	1
7	8	9	10	11	12
18	17	16	15	14	13
19	20	21	22	23	24
30	29	28	27	26	25
31	32	33	34	35	36

LEGEND

- Outline of area of which status is required
- Public land in Federal ownership
- Patented land (minerals reserved)
- Patented land (S. R. Act 12/29/16)
- Patented land (Act 7/17/14)
- School lands
- Indian allotments
-
-
-

Does posting and survey agree with the lands as described? _____

Conflicts There are no conflicts with any other lands in the area.

Withdrawals _____

Rights-of-way _____

UNITED STATES GOVERNMENT

*Memorandum*ALM:RAH:vs
A. 046677

TO : Land Office Manager, Anchorage

DATE: October 30, 1961

FROM : Lands and Minerals Officer

SUBJECT: Status Report - A. 046677, Homestead Entry of Benjamin E. Cowart

At the time the claims in this township were initiated the area was unsurveyed. The rectangular survey has now been extended over the area on the ground, but the plat has not yet been approved. The examinations of the claims in this area were made to determine their locations with reference to the survey now on the ground.

This claim was examined during the week of October 9-13, 1961. The field party consisted of Griffith, Klein, and Hampson. The description given by the applicant and the location of any improvements were established in relation to the rectangular survey on the ground. The locations of the claim and any improvements are shown on the attached map. This map is made from a 2X enlargement of U.S.G.S. quadrangles of the area. The protracted section lines closely approximate their actual location on the ground.

The location notice was filed November 25, 1958, alleging occupancy since November 21, 1958. At the time of examination the improvements consisted of a frame house and approximately 25 acres of cultivation. No one was living there at the time.

The entry can properly be described, in terms of the survey now on the ground, as:

T. 16 N., R. 4 W., S.M.,
Section 27: $W\frac{1}{2}NW\frac{1}{4}$
Section 28: $E\frac{1}{2}NE\frac{1}{4}$

The entry is shown in this same location on the Land Office status records of this township.

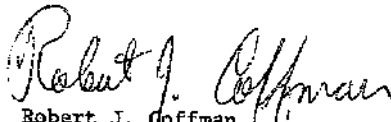
Robert J. Goffman
Lands and Minerals Officer

Attachment: map

FORM NO. 4-1154
(JULY 1957)

UNITED STATES
DEPARTMENT OF THE INTERIOR
BUREAU OF LAND MANAGEMENT

ORIGINAL

FORM APPROVED
BUDGET BUREAU NO. 42-R986

NOTICE OF LOCATION OF SETTLEMENT OR OCCUPANCY
CLAIM IN ALASKA

(Act of April 29, 1950, 64 Stat. 94, 48 U.S.C. 371-371c, 461a)
SEE INSTRUCTIONS ON REVERSE OF FORM

Land Office	ANCHORAGE
Serial Number	046677
Receipt No.	

1. BENJAMIN H COWART
(First Name) (Middle Initial) (Last Name)
of post office address SPENARD, ALASKA, P.O. 4532
hereby file notice of location of settlement or occupancy for the public land described as follows:

Sec. 28, 1/2 of NE 1/4 *Sec. 27, 1/2 NW 1/4*

SPENARD

Section _____, Township T16N, Range R4W, Seward Meridian.

2. I am 21 years of age or older Yes No
I am a citizen of the United States Native born Naturalized
 Declared my intention to become a citizen

3. This notice is made for settlement or occupancy under the
 Homestead laws Homestead law
 Headquarters site law Trade and manufacturing site law

4. Date settlement or occupancy was made by me: 11-21-58

5. There are no buildings or improvements except (if none write "none"):
NONE

6. I have not filed application or notice of location of the type checked in Item 3 except:
NONE

7. The kind of trade, manufacture or other productive industry for which the claim is maintained or desired is:
FARM

8. I am a veteran with military service as follows:
Date of induction SEPT 24, 1942 Date of honorable discharge APRIL 2, 1946
Branch of service NAVY Serial number 665-25-61

9. The lands described in Item 1 are adjacent to, or traversed by, a road or highway maintained by the Bureau of Public Roads as follows (if none write "none"):
NONE

10. I enclose a filing fee of \$10

11. I CERTIFY that the statements made by me in this notice are true, complete and correct to the best of my knowledge and belief, and are made in good faith.

11-25-58
(Date)

Benjamin H. Cowart
(Signature in full)

18 U.S.C. sec. 1001, makes it a crime for any person knowingly and willfully to make to any department or agency of the United States any false, fictitious or fraudulent statements or representations as to any matter within its jurisdiction.

INSTRUCTIONS

(Numbers correspond to the question numbers)

1. *Surveyed land:*

If notice is for surveyed land, it must be prepared in *duplicate* and filed in the proper Land office. Surveyed land must be described by legal subdivisions, section, township and range numbers, and meridian.

Unsurveyed land:

If notice is for unsurveyed land, it must be prepared in *duplicate* and filed in the proper Land office. Unsurveyed land must be described by metes and bounds as accurately as possible, giving the length and direction of each of the boundaries of the tract; the description of each of the several corners; and the position of the land with reference to established survey monuments, towns, roads, creeks, rivers, mountain peaks, or other prominent topographic points, natural objects or other points of reference. If desired, to provide certainty of location of the tract, the approximate latitude and longitude of one of the corners should be given. A topographic or other map containing an outline of the boundaries of the tract may be submitted with this notice.

3. The applicable laws are as follows:

- Homestead laws* (Act of May 14, 1898, 30 Stat. 409, 48 U.S.C. 371, as amended, 43 CFR, Part 65).
- Headquarters site law* (Act of March 3, 1927, 44 Stat. 1364, 48 U.S.C. 461, 43 CFR, Part 64).
- Homesite law* (Act of May 26, 1934, 48 Stat. 809, 48 U.S.C. 461, 43 CFR, Part 64).
- Trade and manufacturing site law* (Act of May 14, 1898, 30 Stat. 413, 48 U.S.C. 461, 43 CFR, Part 81).

- 5. Describe improvements and identify their ownership. If none, write "none."
- 6. Identify all previous applications or notices. If none, write "none."
- 7. This item will be filled out if the notice is for a claim under the Headquarters site act of 1927 or under the Trade and manufacturing site act of 1898. For Headquarters site claims, in addition to the information requested on the form, show the ownership of the business in connection with which the claim is maintained or desired.



The KNIK IDITAROD

TRAIL PROJECT

