







LEGEND

-  SS Drive Rod in case Control Point
-  Federal Primary Monument
-  Control Point
-  Bench Mark
-  Monument Number
-  Section Line
-  Township Line
-  Property Line

HORIZONTAL AND VERTICAL CONTROL							
NAD83(2011) GEODETIC COORDINATES			LOCAL GROUND COORDINATES		ELL. HT. ORTHO HT.		DESCRIPTION
POINT	LATITUDE	LONGITUDE	NORTHING	EASTING	FT.	FT.	
767	67°46'30.13267"N	164°24'56.08576"W	5037977.368	1859882.102	20.46	20.50	Fd IP/BC [BLM]; T28N R26W R25W S36 S31 S1 S6 T27N 1976
780	67°48'16.31407"N	164°24'52.99442"W	5048769.685	1859724.586	72.45	72.52	Fd IP/BC [BLM]; WC T28N R26W R25W S24 S19 S25 S30 2008
781	67°48'14.04072"N	164°20'31.34565"W	5048802.206	1869783.868	59.62	59.60	Fd Copper Coated Steel Post [BLM]; S20 S21 S28 S29 T28N R25W
782	67°49'57.91644"N	164°20'32.02496"W	5059356.256	1869474.903	366.27	366.27	Fd IP/BC [BLM]; S8 S9 S16 S17 T28N R25W
783	67°49'57.93456"N	164°24'56.08149"W	5059092.510	1859341.492	31.25	31.34	Fd SS POST BC [BLM]; S7 S12 S13 S18 T28N R26W R25W 2008
784	67°44'46.22779"N	164°24'56.09895"W	5027419.440	1860151.905	14.68	14.67	Fd SS POST BC [BLM]; S7 S12 S13 S18 T27N R26W R25W 2008 1976
785	67°46'30.16333"N	164°36'36.92804"W	5037332.521	1832919.044	4.94	5.21	Set Rbr/AC [LS5480]; MC 31 T28N S6 T27N R26W 2016

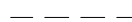
Position, Heights and Elevations derived using Static GPS methods.

Refer to sheets 6 and 7 for more detailed monument descriptions.

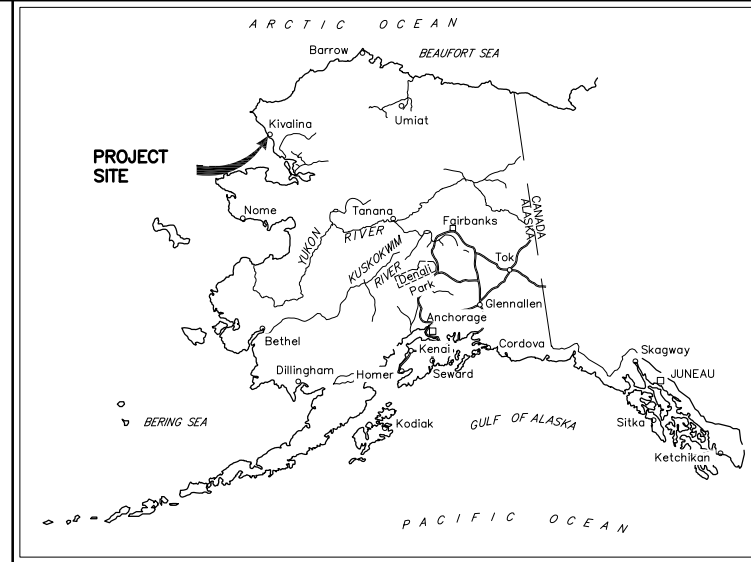
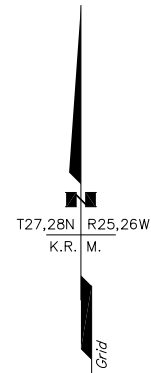
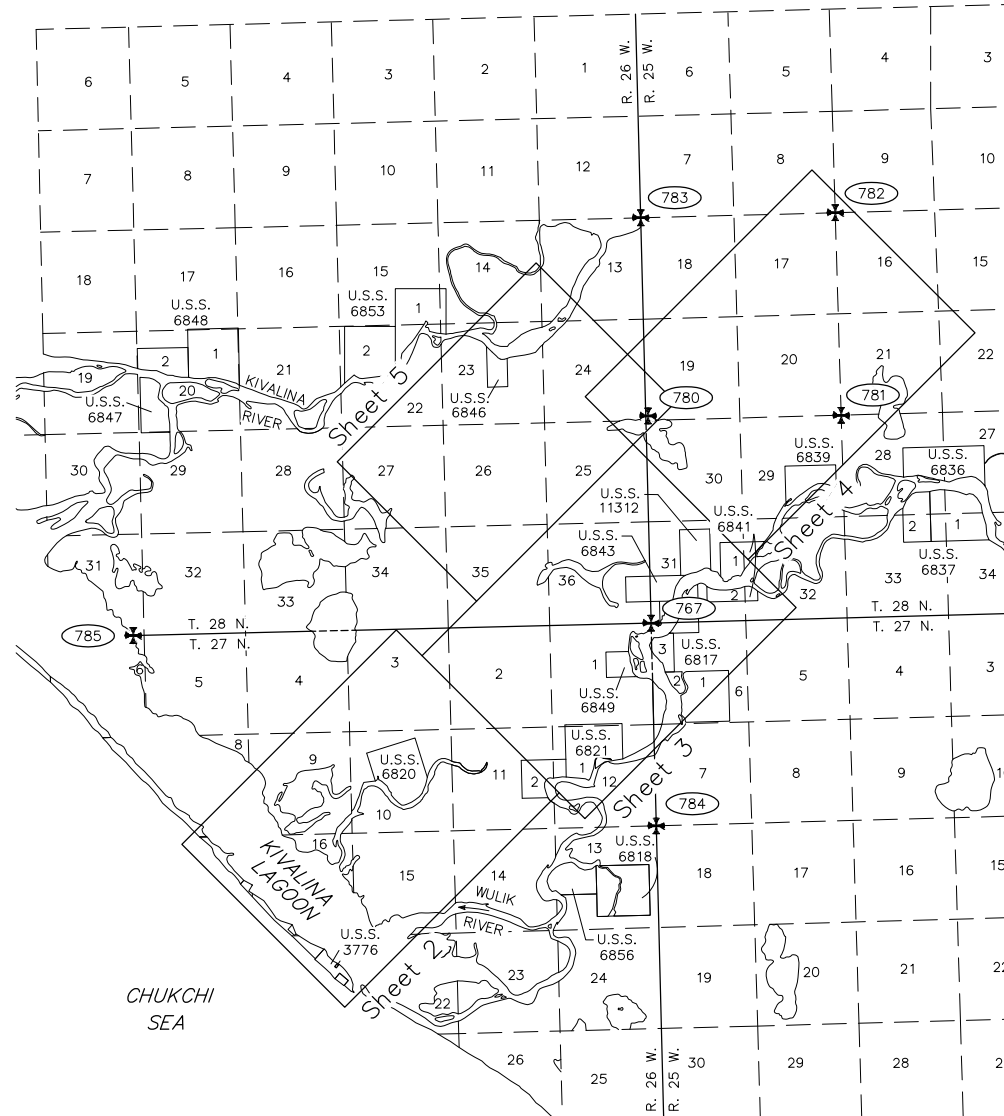

HORIZONTAL CONTROL STATEMENT

Basis of Coordinates:
This project uses a new coordinate system developed for the Kivalina Evacuation Road Project. Specifically, it is a modified NAD83(1992) Alaska State Plane Zone 7 coordinate system, U.S. Survey Feet, scaled to ground. It is scaled at point 564 (SACS KVL C), N5,020,923.786, E1,842,249.468 using the combined scale factor of 1.000049160456. Note that this project is not scaled at N0, E0.

The Basis of Bearing is grid.

Transformation Parameters:
To convert local ground coordinates to NAD83 Alaska State Plane Zone 7, scale the local coordinates at point 564 using 0.999950842. No rotation, no translation.

To convert NAD83 Alaska State Plane Zone 7 coordinates to ground, local, scale the SPC coordinates at point 564 using 1.000049160456. No rotation, no translation.

VERTICAL CONTROL STATEMENT

Elevations are NAVD88 orthometric heights expressed in US Survey Feet. The Basis of Elevations is point 564, SACS KVL C, having a value of 16.11 Feet. The NAVD 88 orthometric height for this point is taken from the National Geodetic Survey Datasheet.

The NAVD 88 orthometric height for all other listed points was determined by static GPS observations recorded Sept. 14 through Sept. 21, 2016 using Topcon dual frequency GPS receivers and geoid model (Geoid-2012A).

NOTES:

- The information shown hereon is based on a field survey performed by McClintock Land Associates, Inc. from Sept. 14 through Sept. 21, 2016. Background information depicted is shown for orientation only and should not be used for any other purpose.
- The purpose of this survey was to provide new survey control and tie existing monuments that will determine future project limits and rectangular PLSS monuments of significance.
- Primary horizontal control was established using Static GPS techniques with Topcon dual frequency receivers. Vectors were adjusted by a simultaneous least squares adjustment using Magnet Office v 8.2.3. All recovered monuments were located using Static GPS techniques for positioning. This survey meets or exceeds 1:10,000 closure.
- Roads and property lines are shown for background and orientation only. A true boundary survey was not a part of this survey and no determination has been made to ensure the boundaries are depicted in the proper location. PLSS monuments shown are in their true location related to the project coordinate system. There was no attempt to rectify the background information such that monuments appear to fall in the proper relationship to section and subdivision of section lines.
- All dimensions and coordinates shown are in U.S. Survey Feet unless otherwise noted.
- Micheal P. Frame, PLS (LS6093), was the field surveyor for this project.

Kotzebue Recording District
This survey does not constitute a subdivision as defined by AS 40.15.900

STATE OF ALASKA
DEPARTMENT OF TRANSPORTATION
&
PUBLIC FACILITIES

Survey Control Diagram
Record Of Survey
AKSAS Project No. 0002384/NFHWW00162
**The Kivalina Evacuation and
School Site Access Road**
Environmental Documentation

Located within:
Sections 6, 7, 18, T.27N., R.25W.
Sections 1, 6, 10-13, 17, 21, T.27N., R.26W.
Sections 7-9, 16-21, 28-32, T.28N., R.25W.
Sections 12, 13, 23-25, 31, 35, 36, T.28N., R.26W.
Koteel River Meridian, Alaska

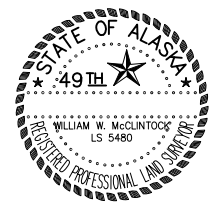

William W. McClintock, LS-5480

DRAWN SKS	DATE 11-09-16	SCALE 1" = 5000'
CHECKED WM	DATE 11-09-16	SHEET 1 OF 7

SURVEYOR'S CERTIFICATE

I hereby certify that I am properly Registered and Licensed to practice Land Surveying in the State of Alaska, and that this drawing represents a survey made by me or under my direct supervision, and that the monuments shown hereon actually exist as described, and that all dimensions and other details are correct to the extent shown hereon.

William W. McClintock, LS-5480

Date

GRAPHIC SCALE

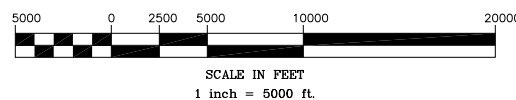

HORIZONTAL AND VERTICAL CONTROL							
NAD83(2011) GEODETIC COORDINATES			LOCAL GROUND COORDINATES		ELL. HT.	ORTHO HT.	DESCRIPTION
POINT	LATITUDE	LONGITUDE	NORTHING	EASTING	FT.	FT.	
563	67°44'24.08502"N	164°34'18.87557"W	5024641.809	1838525.994	9.72	9.97	Fd SS ROD/BC[USK-H]: KVL B 2011 SAC
564	67°43'46.66315"N	164°32'44.55681"W	5020923.786	1842249.468	15.88	16.11	Fd SS ROD/BC[USK-H]: KVL C 2011 SAC
567	67°43'45.86231"N	164°32'43.86136"W	5020843.038	1842278.188	15.09	15.25	Fd AC[S6714]: KACE-2 2006
601	67°43'29.08156"N	164°31'58.04249"W	5019179.520	1844084.793	15.26	15.39	Fd SS ROD: TBM 1253 E 84
602	67°43'38.17969"N	164°32'21.64028"W	5020082.537	1843153.177	16.31	16.45	Fd SS ROD: TBM 1253 G 84
755	67°43'43.40985"N	164°32'38.57637"W	5020598.620	1842487.774	16.50	16.65	Fd IP[BLM]: WCMC1 L1 USS 3776
756	67°43'45.76375"N	164°32'32.68980"W	5020843.148	1842709.075	10.17	10.32	Fd IP[BLM]: WCMC8 L1 USS 3776
757	67°45'02.07751"N	164°27'56.36260"W	5028855.032	1853168.450	13.27	13.33	Fd SS POST/BC[BLM]: C4 L2 USS 6821 1994
758	67°45'21.55617"N	164°27'56.36659"W	5030834.313	1853119.226	14.22	14.29	Fd SS POST/BC[BLM]: C3 L2 USS 6821 1994
790	67°45'14.04724"N	164°31'15.17219"W	5029884.934	1845482.789	7.17	7.30	Fd SS POST/BC[BLM]: WCMC1 USS 6820 1994
791	67°45'28.37641"N	164°31'13.54418"W	5031342.489	1845510.669	9.77	9.90	Fd SS POST/BC[BLM]: WC2 USS 6820 1994
792	67°45'34.28536"N	164°30'19.17494"W	5031993.222	1847589.408	11.18	11.29	Fd SS POST/BC[BLM]: C3 USS 6820 1994
793	67°45'15.23263"N	164°30'04.76561"W	5030070.610	1848191.015	10.66	10.76	Fd SS POST/BC[BLM]: WCMC4 USS 6820 1994

Position, Heights and Elevations derived using Static GPS methods. Refer to sheets 6 and 7 for more detailed monument descriptions.

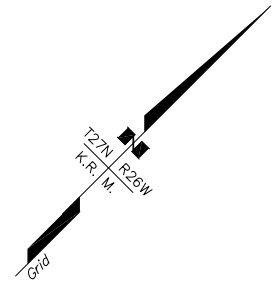

Magnetic Declination 11°9'E
NOAA Geophysical Data Center
Sept. 2016

LEGEND

- SS Drive Rod in case Control Point
- Federal Primary Monument
- Control Point
- Bench Mark
- Monument Number
- Section Line
- Township Line
- Property Line

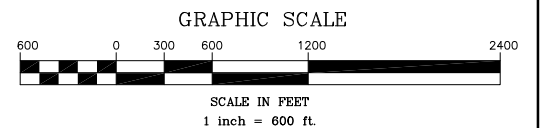

Kotzebue Recording District
This survey does not constitute a
subdivision as defined by AS 40.15.900

STATE OF ALASKA
DEPARTMENT OF TRANSPORTATION
&
PUBLIC FACILITIES
Survey Control Diagram
Record Of Survey
AKSAS Project No. 0002384/NFHWHY00162
**The Kivalina Evacuation and
School Site Access Road
Environmental Documentation**
Located within:
Sections 6, 7, 16, T.27N., R.25W.
Sections 1, 6, 10-13, 17, 21, T.27N., R.26W.
Sections 7-9, 16-21, 28-32, T.28N., R.25W.
Sections 12, 13, 23-25, 31, 35, 36, T.28N., R.26W.
Kotzebue River Meridian, Alaska

DRAWN	SKS	DATE	11-09-16	SCALE	1" = 600'
CHECKED	WM	DATE	11-09-16	SHEET	2 OF 7

POINT	NAD83(2011) GEODETIC COORDINATES		LOCAL GROUND COORDINATES		HORIZONTAL AND VERTICAL CONTROL		DESCRIPTION
	LATITUDE	LONGITUDE	NORTHING	EASTING	ELL. HT. FT.	ORTHO HT. FT.	
401	67°46'42.27263"N	164°28'31.01328"W	5039003.225	1851583.140	71.06	71.15	Set SS ROD/AC[L55480]; KER CP 401
759	67°45'21.56017"N	164°26'56.00892"W	5030892.651	1855443.158	15.55	15.59	Fd SS POST/BC[BLM]; C2 L2 USS 6821 1994
760	67°45'39.10623"N	164°26'54.29283"W	5032677.206	1855464.532	13.91	13.97	Fd SS POST/BC[BLM]; C2 L1 USS 6821 1994
761	67°45'39.10185"N	164°25'38.90674"W	5032750.009	1858366.500	20.07	20.10	Fd SS POST/BC[BLM]; C3 L1 USS 6821 1994
762	67°45'26.80492"N	164°25'38.92363"W	5031500.481	1858397.600	14.42	14.45	Fd SS POST/BC[BLM]; WCMC4 L1 USS 6821 1994
763	67°46'02.92831"N	164°25'20.29198"W	5035189.293	1859021.341	20.07	20.10	Fd SS POST/BC[BLM]; WCMC1 USS 6849 1994
764	67°46'02.91742"N	164°25'58.30874"W	5035151.011	1857558.348	20.41	20.46	Fd SS POST/BC[BLM]; C2 USS 6849 1994
765	67°46'15.90304"N	164°25'58.33082"W	5036470.485	1857524.082	22.31	22.36	Fd SS POST/BC[BLM]; C3 USS 6849 1994
766	67°46'15.90999"N	164°25'31.08200"W	5036497.809	1858572.535	22.65	22.69	Fd SS POST/BC[BLM]; WCMC4 USS 6849 1994
767	67°46'30.13267"N	164°24'56.08576"W	5037977.368	1859882.102	20.46	20.50	Fd IP/BC[BLM]; T28N R26W R25W S36 S31 S1 S6 T27N 1976
768	67°46'30.13810"N	164°24'42.82776"W	5037990.997	1860392.136	20.71	20.74	Fd SS POST/BC[BLM]; MC S6 S31 T27N T28N R25W
769	67°46'31.40410"N	164°24'43.89790"W	5038118.579	1860347.666	21.29	21.33	Fd SS POST/BC[BLM]; WCMC1 L5 USS 6817 1994
770	67°46'41.21748"N	164°24'32.72488"W	5039126.771	1860751.859	23.65	23.68	Fd SS POST/BC[BLM]; WCMC3 L5 USS 6817 1994
771	67°46'41.21565"N	164°24'43.90725"W	5039115.536	1860321.723	23.00	23.04	Fd SS POST/BC[BLM]; C2 L5 USS 6817 1994
772	67°46'41.21382"N	164°24'56.07743"W	5039103.350	1859853.590	23.81	23.85	Fd SS POST/BC[BLM]; CC S36 S31 T28N R26W R25W L3-4 USS 6843 2008
773	67°46'41.20748"N	164°25'29.10473"W	5039070.269	1858583.178	22.65	22.69	Fd SS POST/BC[BLM]; C3 USS 6843 2008 1994
774	67°46'54.19435"N	164°25'29.12587"W	5040389.870	1858548.770	21.94	21.99	Fd SS POST/BC[BLM]; C2 USS 6843 1994
775	67°46'54.19921"N	164°24'56.08025"W	5040422.813	1859819.696	24.61	24.66	Fd SS POST/BC[BLM]; CC S36 S31 T28N R26W R25W L1-2 USS 6843 2008
776	67°46'54.20477"N	164°24'14.38137"W	5040464.595	1861423.419	23.50	23.54	Fd SS POST/BC[BLM]; C4 USS 11312 1994
778	67°47'17.58198"N	164°24'14.40211"W	5042839.961	1861361.350	28.38	28.43	Fd SS POST/BC[BLM]; C3 USS 11312 1994
779	67°47'17.58136"N	164°23'33.45981"W	5042880.649	1862935.547	42.52	42.55	Fd SS POST/BC[BLM]; C2 USS 11312 1994

Position, Heights and Elevations derived using Static GPS methods.

Refer to sheets 6 and 7 for more detailed monument descriptions.

MATCH LINE SHEET 2

MATCH LINE SHEET 4

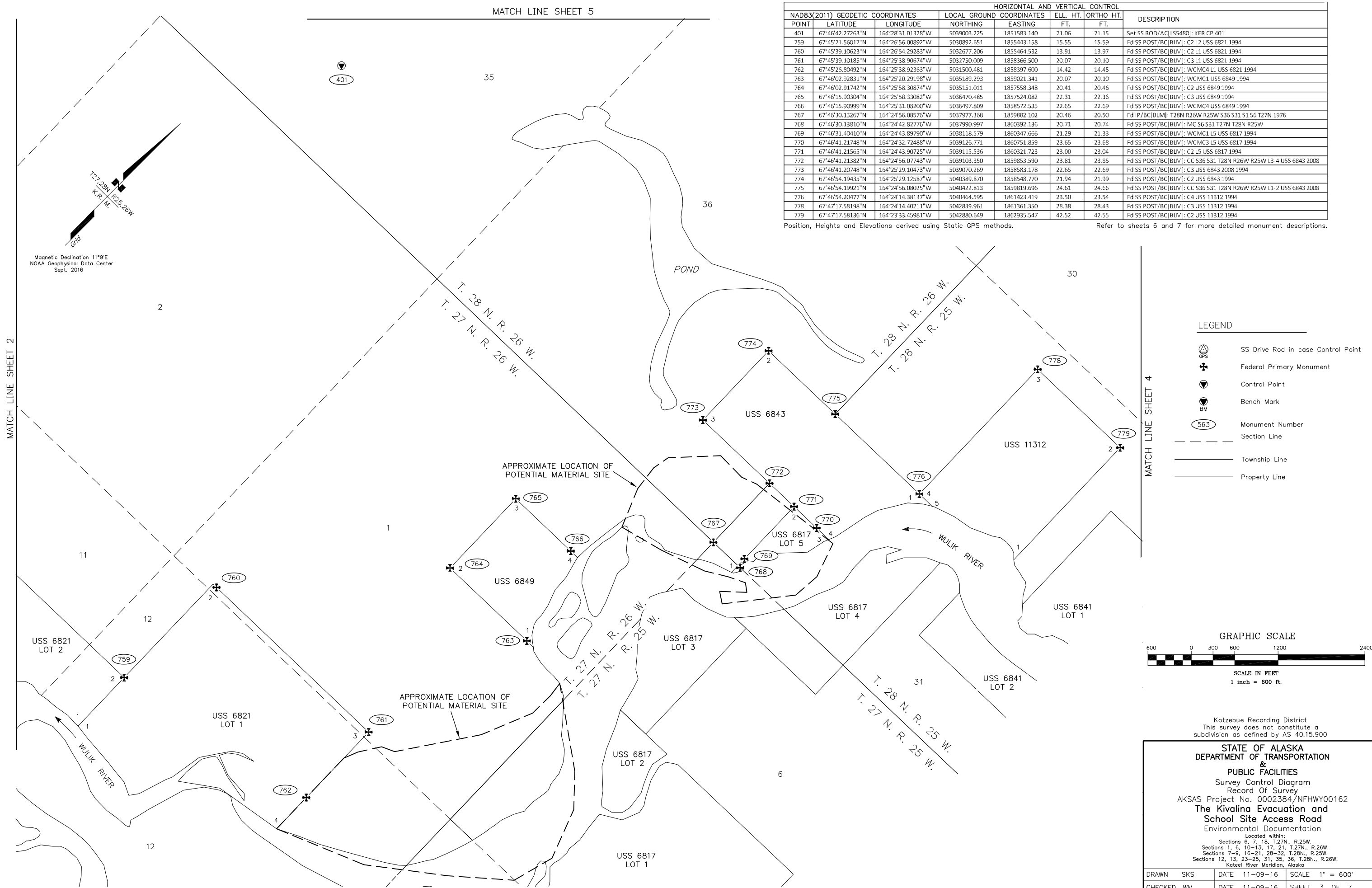

LEGEND

- SS Drive Rod in case Control Point
- Federal Primary Monument
- Control Point
- Bench Mark
- Monument Number
- Section Line
- Township Line
- Property Line

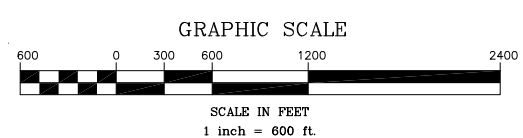

Kotzebue Recording District
 This survey does not constitute a
 subdivision as defined by AS 40.15.900

STATE OF ALASKA
DEPARTMENT OF TRANSPORTATION
&
PUBLIC FACILITIES
 Survey Control Diagram
 Record of Survey
 AKSAS Project No. 0002384/NFHWY00162
The Kivalina Evacuation and
School Site Access Road
 Environmental Documentation
 Located within:
 Sections 6, 7, 18, T27N, R.25W.
 Sections 1, 6, 10-13, 17, 21, T.27N., R.26W.
 Sections 7-9, 16-21, 28-32, T.28N., R.25W.
 Sections 12, 13, 23-25, 31, 35, 36, T.28N., R.26W.
 Kotzei River Meridian, Alaska

DRAWN	SKS	DATE	11-09-16	SCALE	1" = 600'
CHECKED	WM	DATE	11-09-16	SHEET	3 OF 7

HORIZONTAL AND VERTICAL CONTROL							
POINT	NAD83(2011) GEODETIC COORDINATES		LOCAL GROUND COORDINATES		ELL. HT.	ORTHO HT.	DESCRIPTION
	LATITUDE	LONGITUDE	NORTHING	EASTING	FT.	FT.	
73	67°48'16.84662"N	164°23'13.85267"W	5048922.257	1863532.439	87.83	87.87	Set SS ROD/AC[LS5480]; KER GPS 73 CP
780	67°48'16.31407"N	164°24'52.99442"W	5048769.685	1859724.586	72.45	72.52	Fd IP/BC[BLM]: WC T28N R26W R25W S24 S19 S25 S30 2008
781	67°48'14.04072"N	164°20'31.34565"W	5048802.206	1869783.868	59.62	59.60	Fd Copper Coated Steel Post[BLM]: S20 S21 S28 S29 T28N R25W
782	67°49'57.91644"N	164°20'32.02496"W	5059356.256	1869474.903	366.27	366.27	Fd IP/BC[BLM]: S8 S9 S16 S17 T28N R25W

Position, Heights and Elevations derived using Static GPS methods.

Refer to sheets 6 and 7 for more detailed monument descriptions.

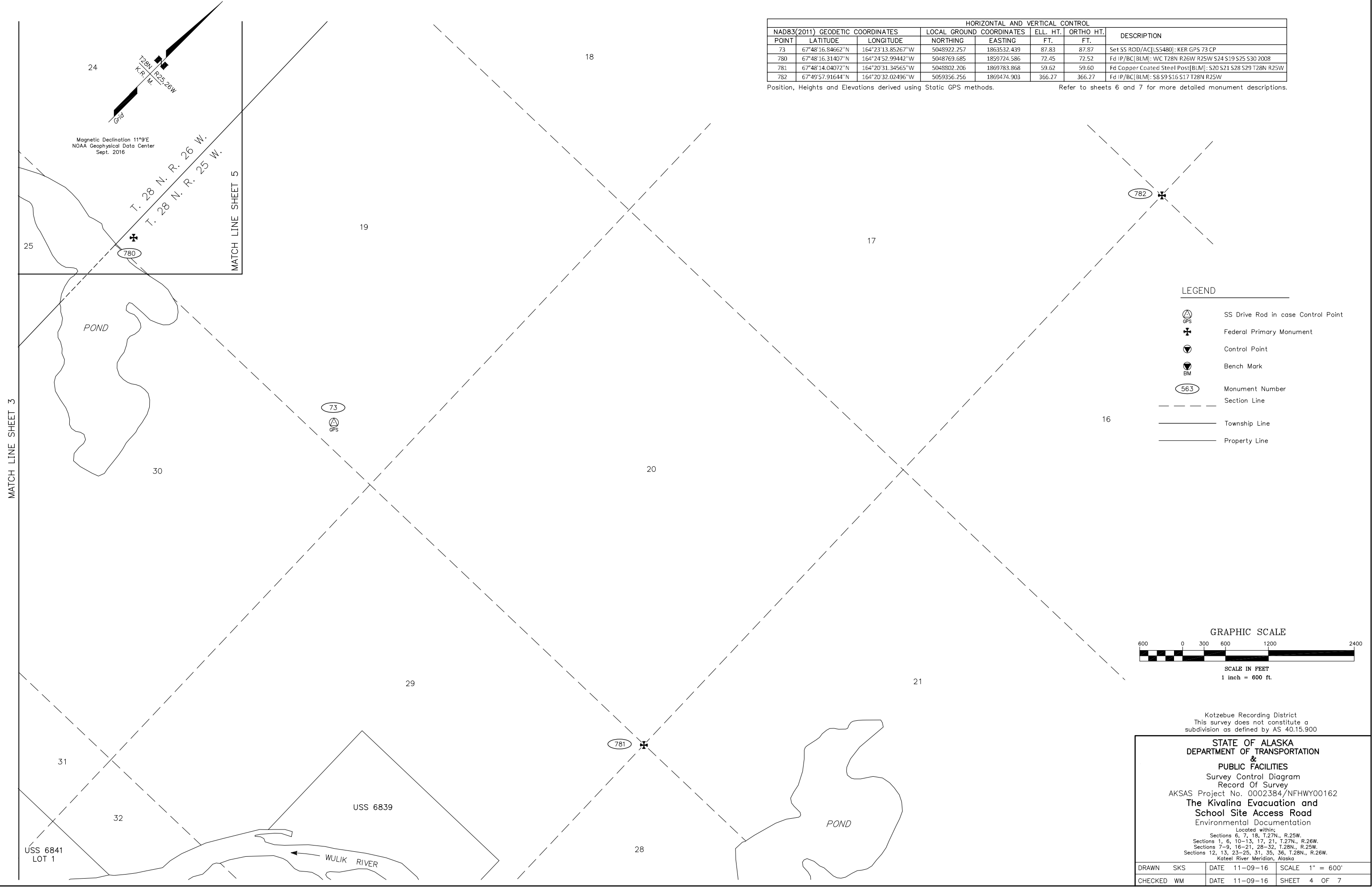

LEGEND

	SS Drive Rod in case Control Point
	Federal Primary Monument
	Control Point
	Bench Mark
	Monument Number
	Section Line
	Township Line
	Property Line

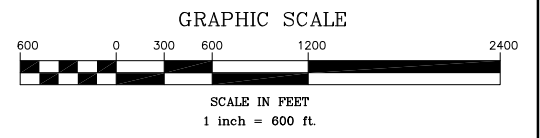

Kotzebue Recording District
This survey does not constitute a
subdivision as defined by AS 40.15.900

STATE OF ALASKA
DEPARTMENT OF TRANSPORTATION
&
PUBLIC FACILITIES
Survey Control Diagram
Record Of Survey
AKSAS Project No. 0002384/NFHWY00162
The Kivalina Evacuation and
School Site Access Road
Environmental Documentation
Located within:
Sections 6, 7, 18, T.27N., R.25W.
Sections 1, 6, 10-13, 17, 21, T.27N., R.26W.
Sections 7-9, 16-21, 28-32, T.28N., R.25W.
Sections 12, 13, 23-25, 31, 35, 36, T.28N., R.26W.
Kotzebue River Meridian, Alaska

DRAWN	SKS	DATE	11-09-16	SCALE	1" = 600'
CHECKED	WM	DATE	11-09-16	SHEET	4 OF 7

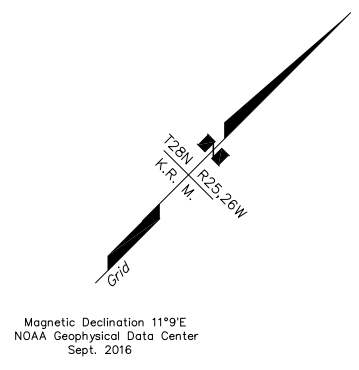
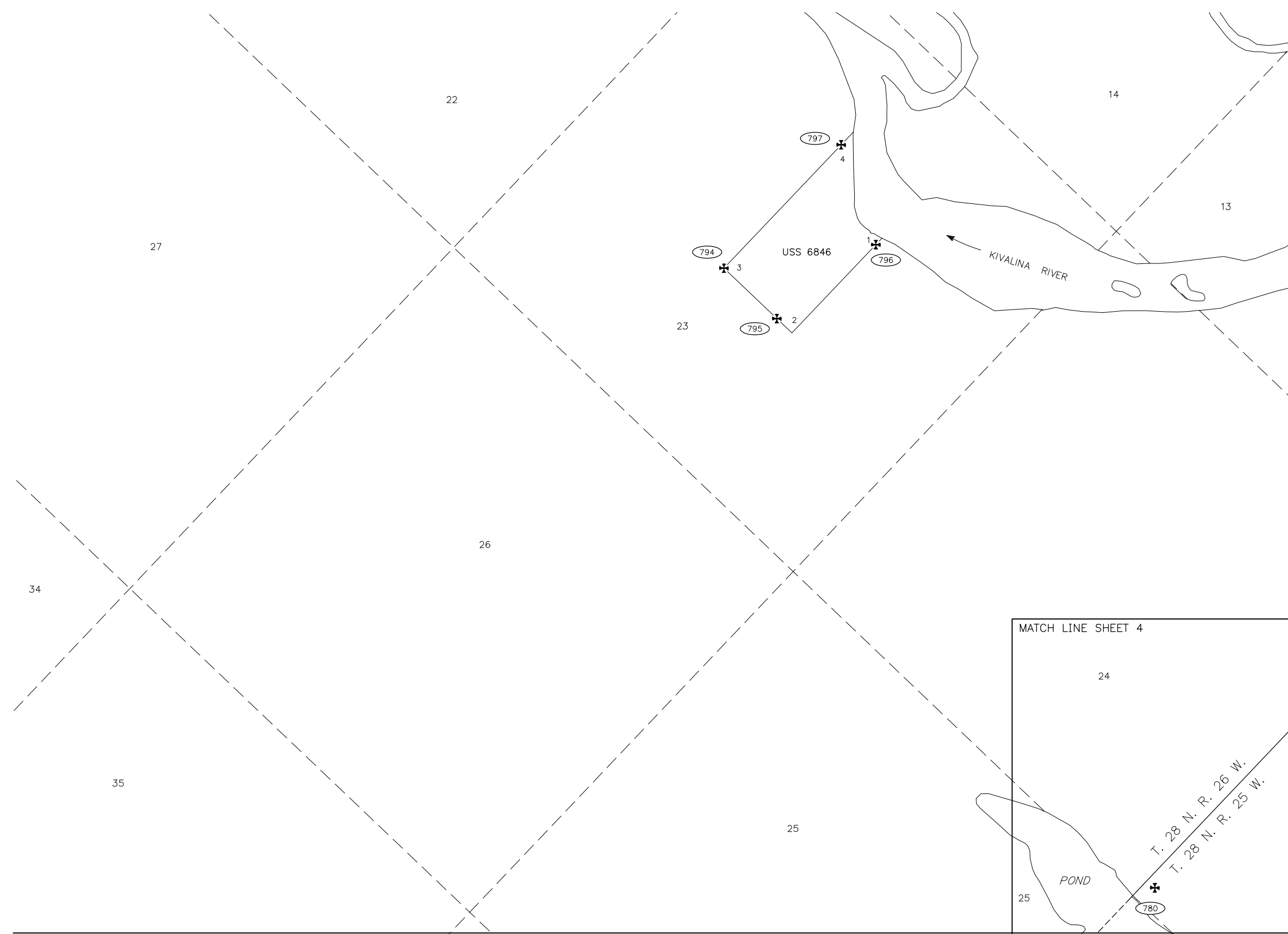

- LEGEND**
- SS Drive Rod in case Control Point
 - Federal Primary Monument
 - Control Point
 - Bench Mark
 - Monument Number
 - Section Line
 - Township Line
 - Property Line

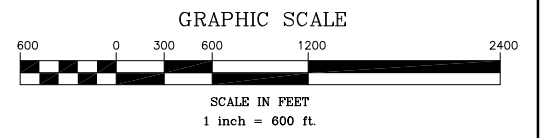

Kotzebue Recording District
 This survey does not constitute a
 subdivision as defined by AS 40.15.900

STATE OF ALASKA
DEPARTMENT OF TRANSPORTATION
 &
PUBLIC FACILITIES
 Survey Control Diagram
 Record Of Survey
 AKSAS Project No. 0002384/NFHWY00162
The Kivalina Evacuation and
School Site Access Road
 Environmental Documentation

Located within:
 Sections 6, 7, 18, T.27N., R.25W.
 Sections 1, 6, 10-13, 17, 21, T.27N., R.26W.
 Sections 7-9, 16-21, 28-32, T.28N., R.25W.
 Sections 12, 13, 23-25, 31, 35, 36, T.28N., R.26W.
 Kotzebue River Meridian, Alaska

DRAWN SKS	DATE 11-09-16	SCALE 1" = 600'
CHECKED WM	DATE 11-09-16	SHEET 5 OF 7

POINT	NAD83(2011) GEODETIC COORDINATES		LOCAL GROUND COORDINATES		ELL. HT.		ORTHO HT.		DESCRIPTION
	LATITUDE	LONGITUDE	NORTHING	EASTING	FT.	FT.	FT.		
780	67°48'16.31407"N	164°24'52.99442"W	5048769.685	1859724.586	72.45	72.52		Fd IP/BC[BLM]: WC T28N R26W R25W S24 S19 S25 S30 2008	
794	67°48'33.12871"N	164°28'29.38873"W	5050269.271	1851367.952	27.56	27.68		Fd SS POST/BC[BLM]: C3 USS 6846 1994	
795	67°48'33.13399"N	164°28'08.00558"W	5050290.098	1852189.387	31.72	31.84		Fd SS POST/BC[BLM]: WC2 USS 6846 1994	
796	67°48'46.61396"N	164°28'01.92078"W	5051665.636	1852389.199	21.34	21.46		Fd SS POST/BC[BLM]: WCMC1 USS 6846 1994	
797	67°48'51.96611"N	164°28'29.41645"W	5052183.388	1851319.696	23.34	23.46		Fd SS POST/BC[BLM]: WCMC4 USS 6846 1994	

Position, Heights and Elevations derived using Static GPS methods. Refer to sheets 6 and 7 for more detailed monument descriptions.

MATCH LINE SHEET 3

MATCH LINE SHEET 4

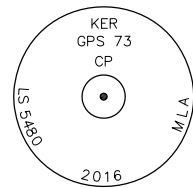

73

Set 9/16 in. stainless steel rod and datum point, 23.5 ft. long with 2 1/2 in. aluminum cap in 6 in. pvc case. Carsonite post set 1 ft. North.

Set reference monuments as shown at right:

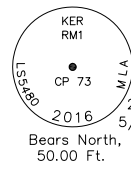

401

Set 2 in. aluminum cap on a 5/8 in. x 30 in. pointed rebar, 1 in. above the ground.



563

Found 9/16 in. stainless steel rod and datum point with 3 in. brass cap, in a 6 in. PVC case with aluminum ring and cap. Excellent condition.



564

Found 9/16 in. stainless steel rod and datum point with 3 in. brass cap, in a 6 in. PVC case with aluminum ring and cap. Excellent condition.

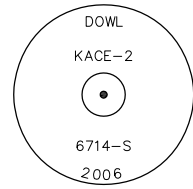

567

Found 3 1/2 in. aluminum cap, 1 in. below ground. Great condition.



601

Found 9/16 in. stainless steel rod and datum point, no cap, in a 5 in. PVC case. Excellent condition.

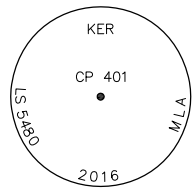

602

Found 9/16 in. stainless steel rod and datum point, no cap, in a 5 in. PVC case. Excellent condition.

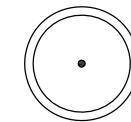

755

Found 2 1/2 in. iron post, 8 in. below ground, cap missing, tack in center. Good condition.

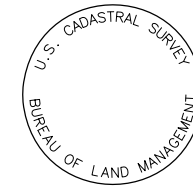

756

Found 3 1/4 in. brass cap on 2 1/2 in. iron post, flush with the ground. Cap markings illegible. Excellent condition.

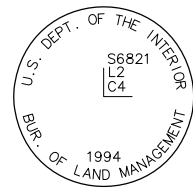

757

Found 3 1/4 in. brass cap on 2 1/2 in. stainless steel post, 4 in. above ground. Excellent condition.

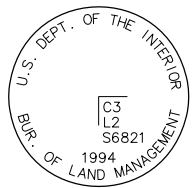

758

Found 3 1/4 in. brass cap on 2 1/2 in. stainless steel post, 4 in. above ground. Excellent condition.

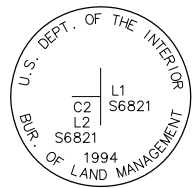

759

Found 3 1/4 in. brass cap on 2 1/2 in. stainless steel post, 3 in. above ground. Excellent condition.

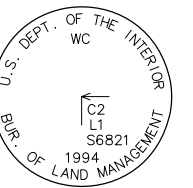

760

Found 3 1/4 in. brass cap on 2 1/2 in. stainless steel post, 3 in. above ground. Excellent condition.

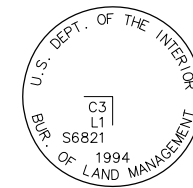

761

Found 3 1/4 in. brass cap on 2 1/2 in. stainless steel post, 5 in. above ground. Excellent condition.

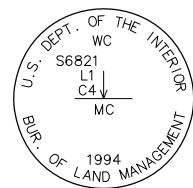

762

Found 3 1/4 in. brass cap on 2 1/2 in. stainless steel post, 3 in. above ground. Excellent condition.

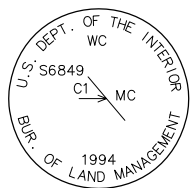

763

Found 3 1/4 in. brass cap on 2 1/2 in. stainless steel post, 4 in. above ground. Excellent condition.

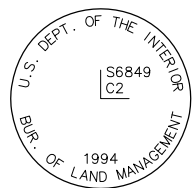

764

Found 3 1/4 in. brass cap on 2 1/2 in. stainless steel post, 4 in. above ground. Excellent condition.

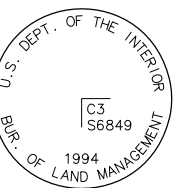

765

Found 3 1/4 in. brass cap on 2 1/2 in. stainless steel post, 4 in. above ground. Excellent condition.

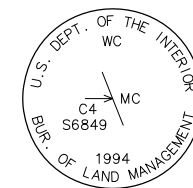

766

Found 3 1/4 in. brass cap on 2 1/2 in. stainless steel post, 5 in. above ground. Excellent condition.

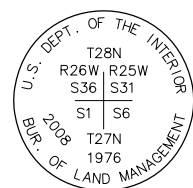

767

Found 3 1/4 in. brass cap on 2 1/2 in. iron pipe, projecting 1 in. above ground. Good condition.



768

Found 3 1/4 in. brass cap, 14 in. below ground, cap markings illegible. Good condition.

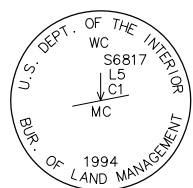

769

Found 3 1/4 in. brass cap on 2 1/2 in. stainless steel post, flush with the ground. Excellent condition.

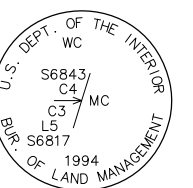

770

Found 3 1/4 in. brass cap on 2 1/2 in. stainless steel post, 5 in. above ground. Excellent condition.

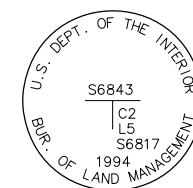

771

Found 3 1/4 in. brass cap on 2 1/2 in. stainless steel post, 2 in. above ground. Excellent condition.

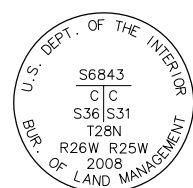

772

Found 3 1/4 in. brass cap on 2 1/2 in. stainless steel post, 8 in. above ground. Drive to 6 in. above ground. Excellent condition.

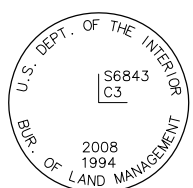

773

Found 3 1/4 in. brass cap on 2 1/2 in. stainless steel post, 2 in. above ground. Excellent condition.

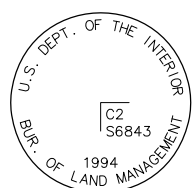

774

Found 3 1/4 in. brass cap on 2 1/2 in. stainless steel post, 2 in. above ground. Excellent condition.

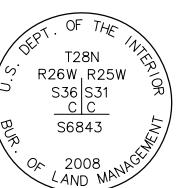

775

Found 3 1/4 in. brass cap on 2 1/2 in. stainless steel post, 8 in. above ground. Excellent condition.

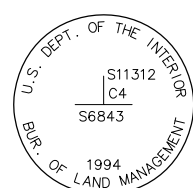

776

Found 3 1/4 in. brass cap on 2 1/2 in. stainless steel post, 3 in. above ground. Excellent condition.



778

Found 3 1/4 in. brass cap on 2 1/2 in. stainless steel post, 2 in. above ground. Excellent condition.



779

Found 3 1/4 in. brass cap on 2 1/2 in. stainless steel post, 2 in. above ground. Excellent condition.

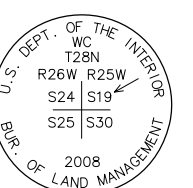

780

Found 3 1/4 in. brass cap on 2 1/2 in. iron pipe, projecting 8 in. above ground. Good condition. Triangle North 6.6 ft.

Kotzebue Recording District
This survey does not constitute a
subdivision as defined by AS 40.15.900

STATE OF ALASKA
DEPARTMENT OF TRANSPORTATION
&
PUBLIC FACILITIES
Survey Control Diagram
Record Of Survey
AKSAS Project No. 0002384/NFHWY00162
The Kivalina Evacuation and
School Site Access Road
Environmental Documentation

Located within:
Sections 6, 7, 18, T27N., R.25W.
Sections 1, 6, 10-13, 17, 21, T.27N., R.26W.
Sections 7-9, 16-21, 28-32, T.28N., R.25W.
Sections 12, 13, 23-25, 31, 35, 36, T.28N., R.26W.
Kotzebue River Meridian, Alaska

DRAWN	SKS	DATE	11-09-16	SCALE	N/A
CHECKED	WM	DATE	11-09-16	SHEET	6 OF 7

781



Found 5/8 in. copper coated steel rod, no cap, 24 in. above ground. Poor condition.

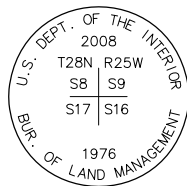

782

Found 3 1/4 in. brass cap on 2 1/2 in. iron pipe, 8 in. above a rock mound, 2.5 ft. diam. Excellent condition.

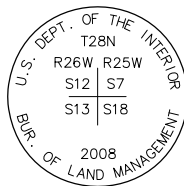

783

Found 3 1/4 in. brass cap on 2 1/2 in. stainless steel post, 2 in. above ground. Excellent condition.

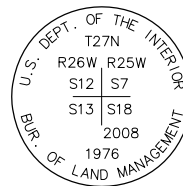

784

Found 3 1/4 in. brass cap on 2 1/2 in. stainless steel post, 2 in. above ground. Excellent condition.

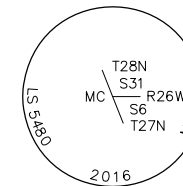

785

Found 3 1/4 in. brass cap on 5/8 in. copper coated steel rod, 36 in. above ground, bent. Average condition.

Replaced with 2 1/2 in. alum cap on 2 in. aluminum post, marked as shown, projecting 1 in. above ground. Buried original cap alongside.

Set reference monuments as shown below:

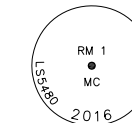

Bears N 88°43'11" E 50.00 Ft.

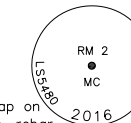

Bears N 88°43'11" E 100.00 Ft.

790

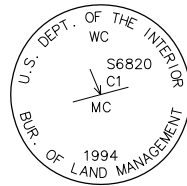

Found 3 1/4 in. brass cap on 2 1/2 in. stainless steel post, 8 in. above ground. Firmed and plumbed. Good condition.

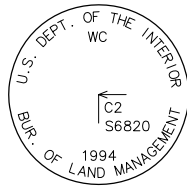

791

Found 3 1/4 in. brass cap on 2 1/2 in. stainless steel post, 6 in. above ground. Good condition.



792

Found 3 1/4 in. brass cap on 2 1/2 in. stainless steel post, 3 in. above ground. Good condition.

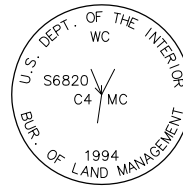

793

Found 3 1/4 in. brass cap on 2 1/2 in. stainless steel post, 12 in. above ground, leaning. Firmed, plumbed and drove to 3 in. below ground. Good condition.

794

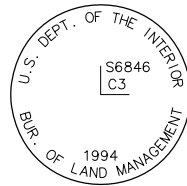

Found 3 1/4 in. brass cap on 2 1/2 in. stainless steel post, 5 in. above ground. Excellent condition.

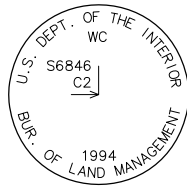

795

Found 3 1/4 in. brass cap on 2 1/2 in. stainless steel post, 5 in. above ground. Good condition.

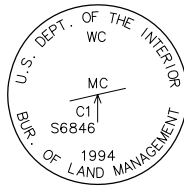

796

Found 3 1/4 in. brass cap on 2 1/2 in. stainless steel post, 8 in. above ground, bent. Good condition.

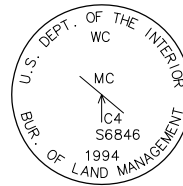

797

Found 3 1/4 in. brass cap on 2 1/2 in. stainless steel post, 4 in. above ground. Good condition.

Kotzebue Recording District
This survey does not constitute a
subdivision as defined by AS 40.15.900

STATE OF ALASKA
DEPARTMENT OF TRANSPORTATION
&
PUBLIC FACILITIES

Survey Control Diagram
Record Of Survey
AKSAS Project No. 0002384/NFHWHY00162
The Kivalina Evacuation and
School Site Access Road
Environmental Documentation

Located within:
Sections 6, 7, 18, T27N., R.25W.
Sections 1, 6, 10-13, 17, 21, T27N., R.26W.
Sections 7-9, 16-21, 28-32, T28N., R.25W.
Sections 12, 13, 23-25, 31, 35, 36, T28N., R.26W.
Koteel River Meridian, Alaska

DRAWN	SKS	DATE	11-09-16	SCALE	N/A
CHECKED	WM	DATE	11-09-16	SHEET	7 OF 7