

NOTES:
 1) BEARINGS AND DISTANCES SHOWN HEREON ARE RECORD, UNLESS OTHERWISE NOTED.
 2) RECORD INFORMATION ON THIS PLAT IS TAKEN FROM THE ORIGINAL PLAT OF US SURVEY 5582.
 3) THE PURPOSE OF THIS PLAT IS TO CORRECT DEFICIENCIES AND ERRORS IN THE VACATION OF RIGHT OF WAY PLAT FILED AS PLAT NO. 2008-3, KOTZEBUE RECORDING DISTRICT, AND TO UPDATE LOT 4 BOUNDARIES TO REFLECT THE DECLARATION OF TAKING RECORDED AT 2008-000370-0, KOTZEBUE RECORDING DISTRICT.

LEGEND
 (C) CALCULATED DATA
 — BOUNDARY LINE REMOVED P2008-3
 ▨ AREA VACATED PLAT 2008-3
 L1 LINE NUMBER

LINE TABLE		
L1	S19°56'18"W	37.92
L2	S36°05'08"W	43.31
L3	S67°51'50"W	37.51
L4	N41°31'00"E	26.23

BASIS OF BEARING
 The Basis of Bearing for this plat is Astronomic North, from the original plat of US Survey 5582.

SURVEYOR'S CERTIFICATE
 I certify that I am properly registered and licensed to practice land surveying in the State of Alaska, that this plat represents only the vacation of right of ways as shown, and the areas of reverted ownership under rights of reversion. No field survey was conducted for the preparation of this plat.
 David Lucas
 Registered Land Surveyor
 Date: 1/20/2009

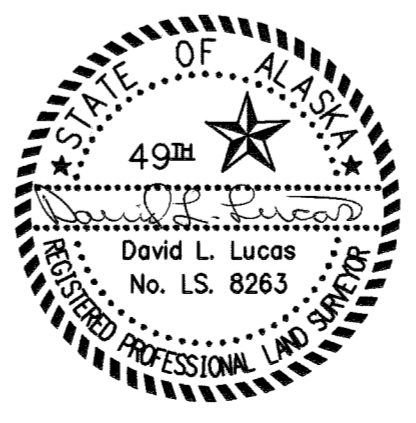

TAX CERTIFICATE
 Parcels affected by this plat are not subject to taxation, at the time of filing.

CERTIFICATE OF OWNERSHIP
 I, the undersigned, hereby certify that I am the true owner of Lot 4A as shown on this plat. I approve this plat and dedicate for public use, as noted, all easements, public utility areas, and rights-of-way, if any, as shown and described on this plat.
 Cheryl Sage
 P. O. Box 32
 Kiviina, Alaska 99750
 Authorized Signature: *Cheryl Sage*
 Cheryl Sage
 Date: 04.03.09

NOTARY'S ACKNOWLEDGEMENT
 Subscribed and sworn to before me this 24 day of April, 2009.
 by Cheryl Sage (Name) (Title)
 Eva J. Hunt (Name) 4/20/09 (Title)
 Notary Public for Alaska My commission expires:

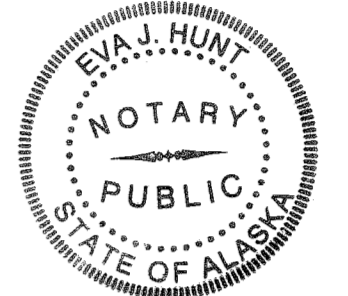

U.S. DEPT. OF THE INTERIOR, BUREAU OF INDIAN AFFAIRS ALASKA REGION
 In accordance with the provisions of Public Law 108-337, 118 Stat. 1357, the within plat and any dedication(s) specifically noted in the owner's certificate thereon are hereby approved this 23rd day of July, 2009, by authority of the Secretary of the Interior, as delegated to the undersigned by 209 DM B, 230 DM1, and 3 IAM 4.
 Regional Director, Alaska Region
 Date: 7/23/09

NOTARY'S ACKNOWLEDGEMENT
 Subscribed and sworn to before me this 23rd day of July, 2009.
 by Mathilda E. Lawrence (Name) Notary Public (Title)
 Mathilda E. Lawrence (Name) May 2, 2011 (Title)
 Notary Public for Alaska My commission expires:

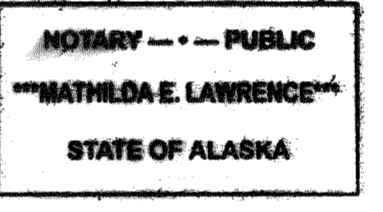

CERTIFICATE OF OWNERSHIP
 I, the undersigned, Mayor of the City of Kiviina, certify that the City of Kiviina is the owner Lot 2A as shown on this plat.
 Hon. Bert Adams Sr.
 P. O. Box 50079
 Kiviina, Alaska 99750
 Authorized Signature: *Bert Adams Sr.*
 Mayor, City of Kiviina
 Date: 6/29/09

NOTARY'S ACKNOWLEDGEMENT
 Subscribed and sworn to before me this 29th day of June, 2009.
 by Marilyn Swan (Name) Notary (Title)
 Marilyn Swan (Name) 9-20-2012 (Title)
 Notary Public for Alaska My commission expires:

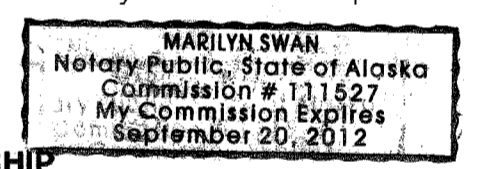

CERTIFICATE OF OWNERSHIP
 I, the undersigned, hereby certify that I am the true owner of Lot 1A as shown on this plat. I approve this plat and dedicate for public use, as noted, all easements, public utility areas, and rights-of-way, if any, as shown and described on this plat.
 Walter Sampson
 P.O. Box 49
 Kotzebue, Alaska 99752
 Authorized Signature: *Walter Sampson*
 NANA Corporation
 Date: 6/17/09

NOTARY'S ACKNOWLEDGEMENT
 Subscribed and sworn to before me this 17th day of June, 2009.
 by Walter Sampson (Name) Vice President Lands (Title)
 Eva J. Hunt (Name) 4/20/13 (Title)
 Notary Public for Alaska My commission expires:

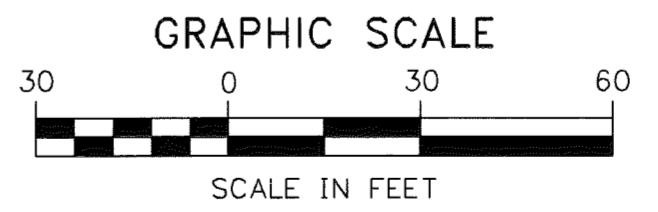
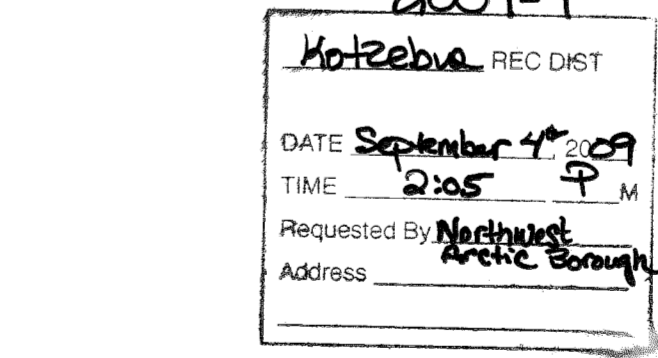
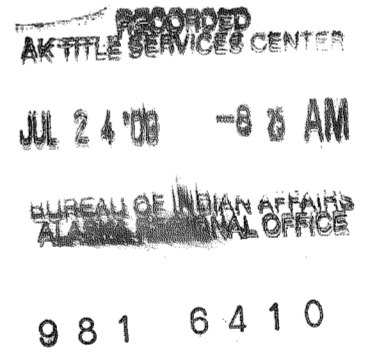
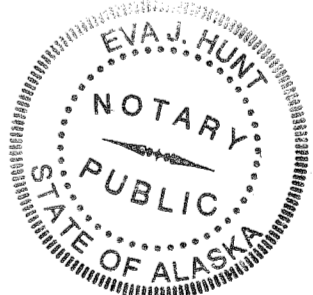

PLAT APPROVAL
 This plat is approved by the Mayor of the Northwest Arctic Borough, or the Mayor's designee, in accordance with AS 40.15.
 Mayor: *David Lucas* Date: 06-15-09

KIVALINA ANTHC REPLAT
 A REPLAT OF LOTS 1 AND 2 BLOCK 6, AND LOT 4 BLOCK 3, US SURVEY 5582 AND PLAT 2008-3

IN SECTION 21, T27N, R26W, KATEEL RIVER MERIDIAN
 KIVALINA, ALASKA KOTZEBUE RECORDING DISTRICT

Prepared By:
 Alaska Native Tribal Health Consortium
 DEHE
 1901 Bragaw Street, Suite 200
 Anchorage, Alaska, 99508-3440
 (907) 729-3600
 DAVID L. LUCAS, RLS #8263

Survey Date: N/A Scale: 1" = 30'
 Date Prepared: 1/19/2009 Drawn By: DLL
 Project No: AN 04-R77 Checked By: DLL
 PA No: Sheet No: 1 of 1

