

KIVALINA AIRPORT - AIRSPACE SURVEY - BANDWIDTH CARS

SEARCH FOR & LOC. BANDWIDTH CARS

TRIMBLE  
DE JOB "KVL BRAD"  
5190 ft BOW

KVL-A R7 RTK HI 1582 M

P#	DESCRIP
500	FOUND WGN-1
501	FOUND WGN-7
CHK 103	CHK Pt 103 (SPK)
CHK KVL C	CHK SHOT SAC NAD KVL C

P-500 (WGN-1) FOUND 2 1/2"  $\phi$  SS PIPE (CAP MISSING) PUMP-FORM  
GOOD COND - DROVE WOOD STAKE INTO PIPE W/ NAIL  
AT APPROX CNTR. PHOTOS P-500 FIND WGN-1 & 1A

P-501 (WGN-7) GRAVEYARD - FOUND 2 1/2"  $\phi$  IP BGL - BEING OVER  
CAP MISSING - BOX FORM - DUG UP & SHOT NEAR Pt  
OF VERT ENTRY TO GND - SEE PHOTOS P-501 WGN-7 & 7A

CALC Pts 706 (USCGS "KIVALINA") & 707 (USLM 2246)  
POSITIONS GONE TO EROSION BY SEA

CALC Pts 701, 702, 704 & 705 STILL SEEM TO BE ORIG GROUND  
ALL 4 FALL TO ATV TRACKS - NORTH WHILE TO  
SEARCH AGAIN W/ LOCATOR - DUG 3 FT AROUND  
CALC POSITIONS

JULY 3, 2011

W01309900

11-05 (21)

TRIMBLE R-7 BASE / TRIMBLE R-8 RANGE

BRAD JENINE  
KVAL KVAL

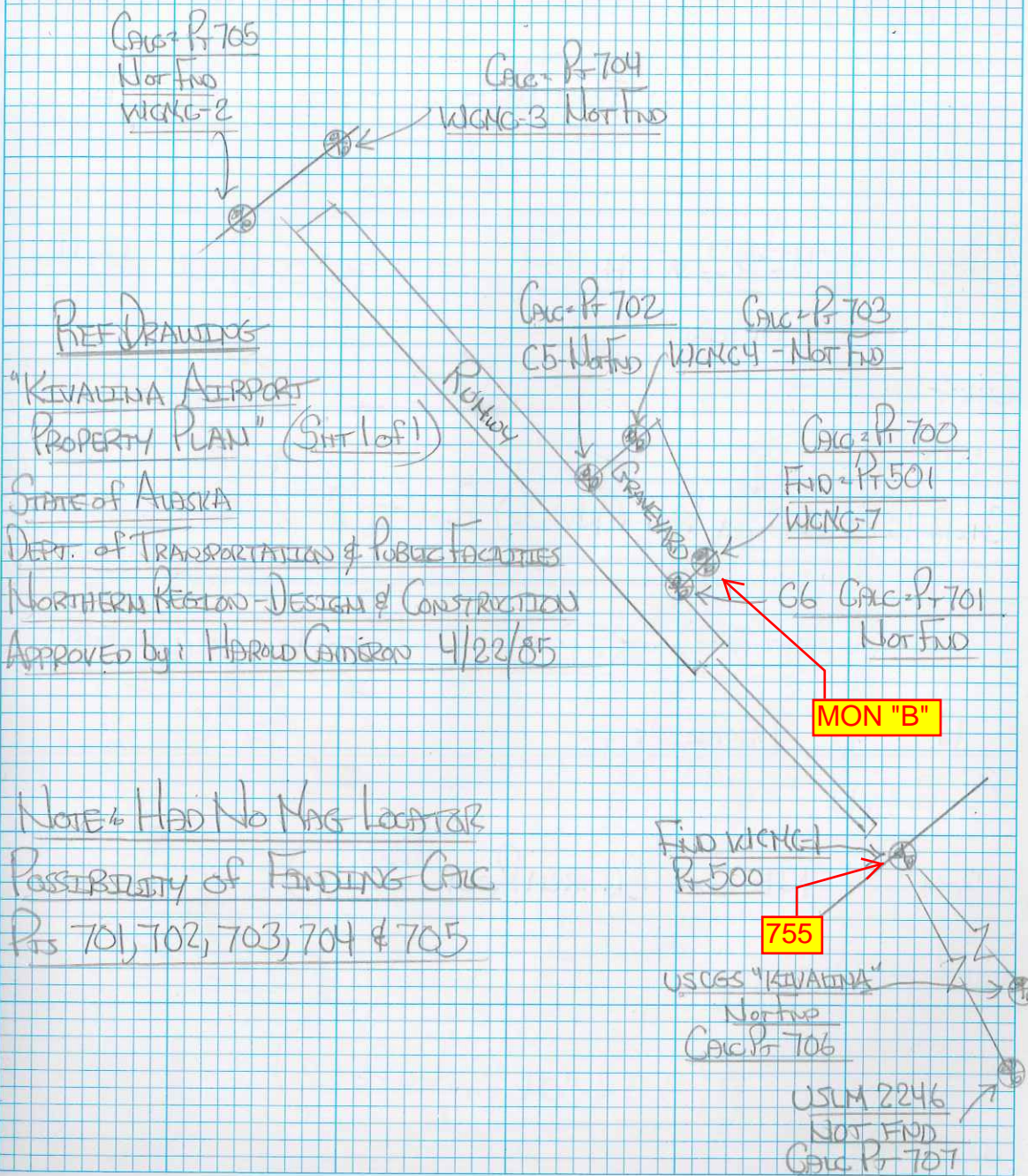

NOTE: HAD NO MAG LOCATOR  
POSSIBILITY OF FINDING CALC  
Pts 701, 702, 703, 704 & 705