

# Community Map KIVALINA

67° 43' 47" N 164° 32' 45" W (NAD 83)  
 Approximate Elevation: 15'  
 Township 27 North, Range 26 West, Kateel River Meridian, AK  
 U.S.G.S. Quadrangle "NOATAK C-5, D-5, & D-6", Alaska  
 KOTZEBUE RECORDING DISTRICT

## LEGEND

- Residential Building
- Commercial Building
- Public Building
- Basis of Coordinates
- Erosion Area
- Boat Parking
- AMNWR Boundary
- Water Line
- Sewer Line
- Sewer Force Main
- Electric
- Telephone
- Underground Electric
- Underground Telephone
- Electric & Telephone
- Fuel Line
- Edge of Water

SCALE: 1"=100'  
 Date of Photography: June 12, 2013  
 Magnetic Declination computed by U.S.G.S. Geomag  
 Program using IGRF10.COF model as of August 1, 2013

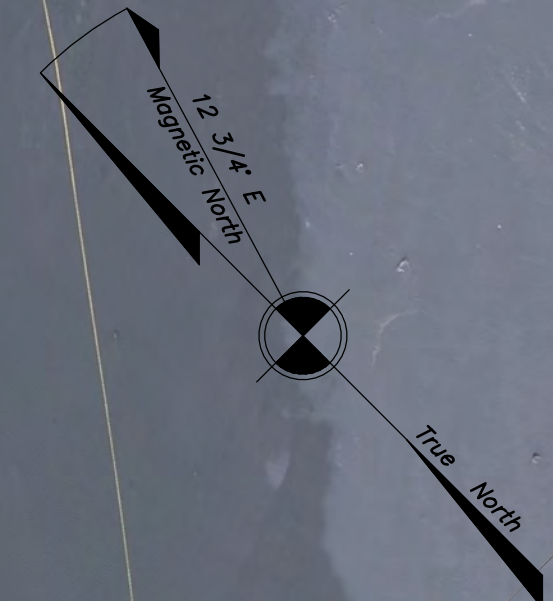

**MAP NOTES**  
 This map was prepared by the Northwest Arctic Borough in cooperation with the Alaska Department of Commerce, Community, and Economic Development, Division of Community and Regional Affairs using funding from the Northwest Inupiat Housing Authority, NANA Regional Corporation, and Maniilaq Association. The Northwest Arctic Borough contracted with Global Positioning Services, Inc. in April of 2013 to prepare the map.  
 This map should not be construed as a survey. On-site surveys should be conducted prior to engineering or construction. This map was compiled to meet horizontal and vertical accuracy in accordance with national map accuracy standards.  
 Property and utility information has been generated from readily available sources with limited accuracy checks. Property information is not intended to represent a title search of the Records Office record. Utility location is approximate and shows only the main lines. Generally, the information is current as of September 2013. ANTHC provided sanitation facility records.  
 This map is based on photography acquired on June 12, 2013, at a nominal scale of 1 in = 800 ft. Quantum Spatial prepared the orthophoto and topographic mapping. The topographic contours were prepared at two (2) foot intervals with index contours every ten (10) feet.  
**HORIZONTAL AND VERTICAL CONTROL**  
 The horizontal and vertical control station for this digital map and orthophoto was an NGS OPUS solution for a 2011 Kivalina Airport Monument. The horizontal datum NAD 1983 coordinates for this monument are North 67° 43' 46.66187" and West 164° 32' 44.55836". The Geoid 12 elevation for this monument is 16.05 ft.  
 This map projection is based upon NAD 83, ASP Zone 8 as expressed in US Survey Feet.

Plot No.	Lot	Blk	Deed Type	Owner	Book	Page	Date
89-4	9B & 9C	2	Trustee Deed	NANA Regional Housing Authority	23	450	5/24/1982
2000-6	1A	9	Lease Agreement	Northwest Inupiat Housing Authority	56	759-769	8/18/2000
2000-6	1B	9	Trustee Deed	City of Kivalina	34	605-606	10/19/1988
2000-6	1A & 1B	10	Lease Agreement	Northwest Inupiat Housing Authority	56	759-769	8/18/2000
2000-6	1C	10	Trustee Deed	City of Kivalina	34	609-610	10/19/1988
2001-13	4A & 4B	5	Trustee Deed	NANA Regional Housing Authority	23	452	5/24/1982
2009-9	1A	6	Patent	NANA Regional Corporation Inc	25	831-832	10/31/1983
2009-9	2A	6	Trustee Deed	City of Kivalina	34	597-598	10/19/1988

Lot	Blk	Deed Type	Owner	Book	Page	Date
1	1	Trustee Deed	City of Kivalina	34	587-588	10/19/1988
2 & 3	1	Lease	Kivalina IRA Council	44	25-29	5/15/1995
1	2	Trustee Deed	City of Kivalina	34	591-592	10/19/1988
1	3	Trustee Deed	Native Village of Kivalina	32	584-585	3/27/1987
1	4	Trustee Deed	City of Kivalina	34	593-594	10/19/1988
3	4	Trustee Deed	Kivalina Friends Church	34	624-625	10/25/1988
1	5	Trustee Deed	City of Kivalina	34	595-596	10/19/1988
4	7	Trustee Deed	City of Kivalina	34	599-600	10/19/1988
1	8	Trustee Deed	City of Kivalina	23	219	3/24/1982
SW 3	8	Trustee Deed	Alaska Village Electric Cooperative Inc	29	799	11/22/1985
NE 3	8	Trustee Deed	City of Kivalina	34	632-633	10/27/1988
4	8	Trustee Deed	Epiphany Episcopal Church of Kivalina	34	626-627	10/25/1988
6	8	Trustee Deed	City of Kivalina	34	601-602	10/19/1988
7	8	Trustee Deed	City of Kivalina	25	312	7/08/1983
8	8	Trustee Deed	City of Kivalina	34	603-604	10/19/1988
4 & 7	9	Lease Agreement	Northwest Inupiat Housing Authority	56	759-769	8/18/2000
3	10	Trustee Deed	NANA Regional Housing Authority	23	457	5/24/1982
5	12	Quit Claim Deed	Alaska Yearly Meeting of Friends	36	145-146	8/11/1989
6	12	Quit Claim Deed	Kivalina Epiphany Church	36	143-144	8/11/1989
2	13	Quit Claim Deed	Kivalina IRA Council	56	861	9/14/2000
3	13	Trustee Deed	City of Kivalina	34	613-614	10/19/1988
4	14	Trustee Deed	City of Kivalina	34	615-616	10/19/1988
5	14	Trustee Deed	NANA Regional Housing Authority	23	460	5/24/1982
6	14	Trustee Deed	City of Kivalina	34	617-618	10/19/1988

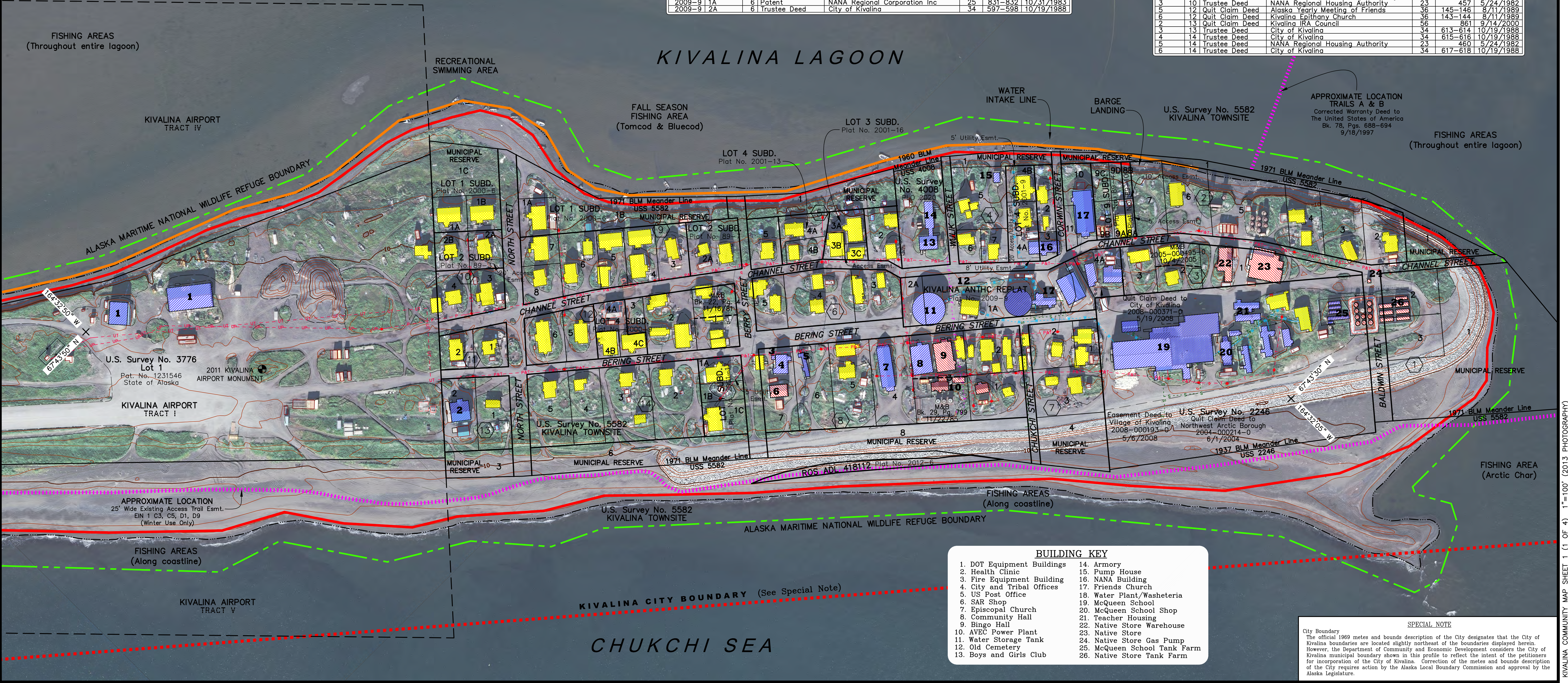

BUILDING KEY	
1. DOT Equipment Buildings	14. Armory
2. Health Clinic	15. Pump House
3. Fire Equipment Building	16. NANA Building
4. City and Tribal Offices	17. Friends Church
5. US Post Office	18. Water Plant/Washeteria
6. SAR Shop	19. McQueen School
7. Episcopal Church	20. McQueen School Shop
8. Community Hall	21. Teacher Housing
9. Bingo Hall	22. Native Store Warehouse
10. AVEC Power Plant	23. Native Store
11. Water Storage Tank	24. Native Store Gas Pump
12. Old Cemetery	25. McQueen School Tank Farm
13. Boys and Girls Club	26. Native Store Tank Farm

**SPECIAL NOTE**  
 City Boundary  
 The official 1969 metes and bounds description of the City designates that the City of Kivalina boundaries are located slightly northeast of the boundaries displayed herein. However, the Department of Commerce and Economic Development considers the City of Kivalina municipal boundary shown in this profile to reflect the intent of the petitioners for incorporation of the City of Kivalina. Correction of the metes and bounds description of the City requires action by the Alaska Local Boundary Commission and approval by the Alaska Legislature.