

U.S. SURVEY No. 6853, ALASKA

COMPRISING TOTAL LAND
SITUATED
ON
THE RIGHT BANK OF THE KIVALINA RIVER
APPROXIMATELY 6 MILES NORTHWESTERLY
OF
KIVALINA, ALASKA

GEOGRAPHIC POSITION
OF
CORNER NO. 2, LBT 2, E3:
LATITUDE: 67°49'08.49" NORTH
LONGITUDE: 164°31'30.59" WEST

AREA: 319.97 ACRES

SURVEYED
BY
BRYAN S. SEIBOLD, CADASTRAL SURVEYOR
AUGUST 12 THROUGH AUGUST 21, 1981
UNDER SPECIAL INSTRUCTIONS
DATED AUGUST 20, 1980
APPROVED JUNE 17, 1981

UNITED STATES DEPARTMENT OF THE INTERIOR
BUREAU OF LAND MANAGEMENT
Anchorage, Alaska May 12, 1982

This plat is strictly conformable to the approved field notes, and the survey, having been correctly executed in accordance with the requirements of law and the regulations of this Bureau, is hereby accepted.

For the Director

Francis A. Dietrich

Chief, Division of Cadastral Survey, Alaska

ORIGINAL
UNITED STATES
DEPARTMENT OF THE INTERIOR
BUREAU OF LAND MANAGEMENT

U 144

9

FIELD NOTES

OF

U.S. SURVEY NO. 6853,

COMPRISING LOTS 1 AND 2,

SITUATED

ON THE RIGHT BANK OF THE KIVALINA RIVER,

APPROXIMATELY 6 MILES NORTHEASTERLY OF

THE VILLAGE OF KIVALINA

THE GEOGRAPHIC POSITION

OF CORNER NO. 2, LOT 2, IS:

LATITUDE 67°49'08.49" NORTH, LONGITUDE 164°31'30.59" WEST

Of the _____ Meridian,

In the State of _____ ALASKA _____

EXECUTED BY

Bryan S. Seibold, Cadastral Surveyor

Under special instructions dated August 20, 1980, approved June 17, 1981,

_____, which provided for the surveys included under U.S. Survey/~~6853~~
Number 6853, and assignment instructions dated August 3, 1981.

Survey commenced August 12, 1981

Survey completed August 21, 1981

U.S. SURVEY NO. 6853, ALASKA

CHAINS

This survey was executed in accordance with the specifications set forth in the Manual of Surveying Instructions, 1973, and the Special Instructions dated August 20, 1980.

The azimuth was obtained from a direct tie to U.S. Coast and Geodetic Survey triangulation station "ASTRO ... 1950", and refers to the true meridian.

The geographic position of cor. No. 2, Lot 2, as determined from a tie to U.S. Coast and Geodetic Survey triangulation station "ASTRO AZ 1950", is:

Latitude 67°49'08.49" North, Longitude 164°31'30.59" West.

The magnetic declination was not measured. U.S. Geological Survey quadrangle map "NOATAK (D-5) and (D-6)," Alaska, 1955 editions, indicate a mean magnetic declination of 18 $\frac{1}{4}$ ° East.

LOT 1

Beginning at the true point for cor. No. 1, Lot 1, which is a meander cor., on the right bank of the Kivalina River, at the line of mean high-water, not monumented due to the liability of destruction by ice and water action.

N. 1°19' E., along line 1-2, Lot 1.

Over level tundra with willow brush.

- 2.00 Point selected for the witness cor. to cor. No. 1, Lot 1, which is a meander cor.

Drive an aluminum rod, 108 ins. long, $\frac{3}{8}$ in. diam., 100 ins. in the ground, with aluminum cap mkd.

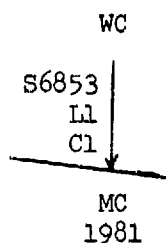

No suitable accessories available, pits impractical.

- 17.65 South bank of a slough, bears N. 68° W. and S. 68° E.
 18.60 North bank of a slough, bears N. 68° W. and S. 68° E.
 20.35 South bank of a slough, bears N. 65° W. and S. 65° E.
 20.85 North bank of a slough, bears N. 65° W. and S. 65° E.
 35.86 Point for cor. No. 2, Lot 1.

Drive an aluminum rod, 108 ins. long, $\frac{3}{8}$ in. diam., 100 ins. in the ground, with aluminum cap mkd.

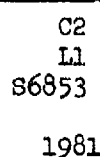

11

LOT 1, U.S. SURVEY NO. 6853, ALASKA

CHAINS

No suitable accessories available, pits impractical.

N. $88^{\circ}41'$ W., along line 2-3, Lot 1.

Over nearly level tundra.

40.00 Point for cor. No. 3, Lot 1.

Drive an aluminum rod, 72 ins. long, $\frac{3}{4}$ in. diam., 64 ins. in the ground, with aluminum cap mkd.

C3
L1
S6853

1981

No suitable accessories available, pits impractical.

S. $1^{\circ}19'$ W., along line 3-4, Lot 1, identical in part with line 3-4, Lot 2.

Over rolling tundra.

29.73 Point for cor. No. 3, Lot 2, hereinafter described.

56.74 Point selected for the witness cor. to cor. No. 4, Lot 1, identical with the witness cor. to cor. No. 4, Lot 2, both meander cors.

Drive an aluminum rod, 108 ins. long, $\frac{3}{4}$ in. diam., 100 ins. in the ground, with aluminum cap mkd.

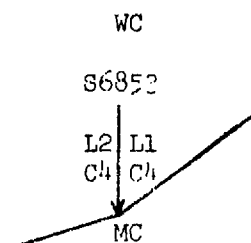

1981

from which

An aluminum rod, 72 ins. long, $\frac{3}{4}$ in. diam., driven 60 ins. in the ground, bears N. $1^{\circ}19'$ E., 10 lks. dist., with an orange triangle marker bolted to the top.

65.74 True point for cor. No. 4, Lot 1, identical with the true point for cor. No. 4, Lot 2, both meander cors., on the right bank of the Kivalina River, at the line of mean high-water, not monumented due to the liability of destruction by ice and water action.

Thence upstream with meanders of the right bank of the Kivalina River, along a well defined bank, 1 to 5 ft. high, at the line of mean high-water.

LOT 1, U.S. SURVEY NO. 6853, ALASKA

CHAINS

N. 31°16' E., 7.81 chs.
 N. 10°43' E., 7.93 chs.
 N. 40°46' E., 7.81 chs.
 N. 47°02' E., 3.79 chs.
 N. 37°44' E., 5.19 chs.
 N. 34°51' E., 13.09 chs.
 N. 24°22' E., 2.01 chs. At the end of course, right bank of slough outlet, bears N. 32° E.
 S. 69°02' E., 0.77 ch. At the end of course, left bank of slough outlet, bears N. 33° E.
 S. 38°40' E., 1.39 chs.
 S. 16°36' W., 1.36 chs.
 S. 44°52' W., 2.18 chs.
 S. 26°04' E., 0.96 ch.
 S. 85°14' E., 1.89 chs.
 S. 16°28' E., 3.15 chs.
 S. 75°02' E., 6.00 chs.
 S. 82°43' E., 7.19 chs. At the end of course, true point for cor. No. 1, Lot 1, which is a meander cor., and point of beginning.

LOT 2

Beginning at the true point for cor. No. 1, Lot 2, which is a meander cor., on the right bank of the Kivalina River, at the line of mean high-water, not monumented due to the liability of destruction by ice and water action.

N. 1°19' E., along line 1-2, Lot 2.



Over rolling tundra.

2.00 Point selected for the witness cor. to cor. No. 1, Lot 2, which is a meander cor.

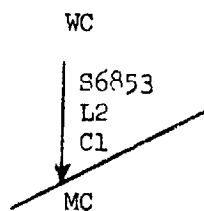
Drive an aluminum rod, 72 ins. long, $\frac{3}{4}$ in. diam., 63 ins. in the ground, with aluminum cap mkd.

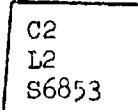

LOT 2, U.S. SURVEY NO. 6853, ALASKA

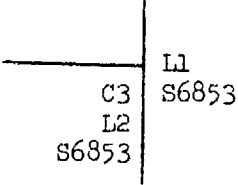
CHAINS	
44.89	<p>No suitable accessories available, pits impractical.</p> <p>Point for cor. No. 2, Lot 2.</p> <p>Set an aluminum post, 30 ins. long, 2½ ins. diam., 18 ins. in the ground, encircled by a collar of stone, with alum. cap mkd.</p> <div style="text-align: center;">  <p>1981</p> </div> <p>No suitable accessories available, pits impractical.</p> <p>From this point, U.S. Coast and Geodetic Survey triangulation station "ASTRO AZ 1950", at Latitude 67°49'06.043" N., Longitude 164°31'19.671"W., bears S. 59°18' E., 7.39 chs. dist., monumented with a soil pipe, 2 ins. diam., firmly set, projecting 6 ins. above ground, with standard disk brazed to the top, mkd.</p> <div style="text-align: center;"> <p>ASTRO AZ</p>  <p>1950</p> </div>
40.00	<p>S. 88°41' E., along line 2-3, Lot 2.</p> <p>Over nearly level tundra.</p> <p>Point for cor. No. 3, Lot 2, on line 3-4, Lot 1.</p> <p>Set an aluminum post, 30 ins. long, 2½ ins. diam., 18 ins. in the ground, encircled by a collar of stone, with alum. cap mkd.</p> <div style="text-align: center;">  <p>1981</p> </div> <p>No suitable accessories available, pits impractical.</p>
27.01 36.01	<p>S. 1°19' W., along line 3-4, Lot 2, identical with a portion of line 3-4, Lot 1.</p> <p>Over rolling tundra.</p> <p>The witness cor. to cor. No. 4, Lot 2, identical with the witness cor. to cor. No. 4, Lot 1, both meander cors., hereinbefore described.</p> <p>True point for cor. No. 4, Lot 2, identical with the true point for cor. No. 4, Lot 1, both meander cors., on the right bank of the Kivalina River, at the line of mean high-water, not monumented due to the liability of destruction by ice and water action.</p>

LOT 2, U.S. SURVEY NO. 6853, ALASKA

CHAINS

Thence downstream with meanders of the right bank of the Kivalina River, along a well defined bank, 1 to 5 ft. high, at the line of mean high-water.

S. 31°16' W., 0.31 ch.

S. 61°13' W., 5.38 chs.

S. 88°34' W., 6.03 chs.

S. 84°10' W., 15.30 chs.

N. 81°53' W., 1.32 chs.

N. 61°35' W., 3.42 chs. At end of course, southerly bank of a slough, bears N. 42° E.

N. 46°56' W., 1.54 chs. At the end of course, northerly bank of a slough, bears N. 48° E.

S. 50°23' W., 4.92 chs.

S. 49°42' W., 5.05 chs. At end of course, true point for cor. No. 1, Lot 2, which is a meander cor., and point of beginning.

GENERAL DESCRIPTION

U.S. Survey No. 6853, comprising lots 1 and 2, is located on the right bank of the Kivalina River, approximately 6 miles northeasterly of Kivalina, Alaska.

The land varies from nearly level to rolling, at an elevation of 200 ft. above sea level. The soil is rocky with clay. Vegetation consists of willow brush.

Access to the survey was by helicopter.

16

CERTIFICATE OF SURVEY

(I) (~~was~~) Bryan S. Seibold, Cadastral Surveyor, HEREBY CERTIFY upon honor that, in pursuance of special instructions bearing date of the 20th day of August, 19 80, (I) (~~was~~) have surveyed U.S. Survey No. 6853, comprising lots 1 and 2, located on the right bank of the Kivalina River, approximately 6 miles northeasterly of Kivalina,

of the Meridian, in the State of Alaska, which are represented ... the foregoing field notes as having been executed by (me), (~~us~~) and under (my) (~~our~~) direction; and that said survey has been made in strict conformity with said special instructions, the Manual of Instructions for the Survey of the Public Lands of the United States, and in specific manner described in the foregoing field notes.

MAY 3, 1982
(Date)

Bryan S. Seibold
(Cadastral Surveyor)

(Date)

(Cadastral Surveyor)

CERTIFICATE OF APPROVAL

BUREAU OF LAND MANAGEMENT
Anchorage, Alaska

The foregoing field notes of the survey of U.S. Survey No. 6853, comprising lots 1 and 2, located on the right bank of the Kivalina River, approximately 6 miles northeasterly of Kivalina, Alaska,

executed by Bryan S. Seibold, Cadastral Surveyor, having been critically examined and found correct, are hereby approved.

MAY 12 1982
(Date)

Francis R. Bixler
(Chief, Division of Cadastral Survey)
Alaska

CERTIFICATE OF TRANSCRIPT

~~I CERTIFY That the foregoing transcript of the field notes of the above described surveys is a true copy of the original field notes.~~

~~_____
(Date)~~

~~_____
(Chief, Division of Cadastral Survey)
Alaska~~