

MEANDERS

Lot 1

- Along an unstable bank, 4-8 ft. high, at the line of ordinary high water.
- N. 15°26' W. 0.94 ch.
 - N. 9°11' W. 1.65 chs.
 - N. 30°24' W. 1.34 chs.
 - N. 43°05' W. 3.21 chs.
 - N. 5°25' E. 1.36 chs.
 - N. 17°36' E. 1.13 chs.
 - N. 3°07' E. 2.15 chs.
 - N. 16°22' W. 0.91 ch.
 - N. 6°41' E. 2.95 chs.
 - N. 7°55' W. 3.11 chs.
 - N. 4°35' W. 3.64 chs.
 - N. 60°17' E. 4.92 chs.
 - N. 23°03' E. 3.94 chs.

Lot 2

- Along a well-defined bank, 2-8 ft. high, at the line of ordinary high water.
- S. 11°36' W. 3.73 chs.
 - S. 15°28' E. 1.73 chs.
 - S. 22°39' E. 2.87 chs.
 - S. 26°59' E. 1.89 chs.
- Along a gently sloping bank, at the line of ordinary high water.
- S. 5°36' E. 3.94 chs.
 - S. 14°11' W. 1.78 chs.
 - S. 46°40' W. 2.13 chs.
 - S. 76°16' W. 2.44 chs.
- Along a well-defined bank, 2-4 ft. high, at the line of ordinary high water.
- N. 52°29' W. 0.88 ch.
 - N. 36°25' W. 2.47 chs.
- Along an unstable bank, 2-8 ft. high, at the line of ordinary high water.
- N. 45°39' W. 5.09 chs.
 - N. 29°13' W. 3.74 chs.
- Along a well-defined bank, 6-8 ft. high, at the line of ordinary high water.
- N. 22°01' W. 5.41 chs.
 - N. 26°48' W. 3.34 chs.

MEANDERS

Lot 3

- Along an unstable bank, 6-8 ft. high, at the line of ordinary high water.
- S. 47°17' W. 1.63 chs.
 - S. 69°22' W. 1.65 chs.
 - S. 70°55' W. 2.88 chs.
 - S. 79°45' W. 3.27 chs.
- Along a well-defined bank, 4-8 ft. high, at the line of ordinary high water.
- N. 88°37' W. 3.47 chs.
 - S. 33°45' W. 4.87 chs.
 - S. 25°23' W. 2.16 chs.
 - S. 18°20' E. 3.95 chs.
 - S. 31°11' E. 4.23 chs.
 - S. 42°48' E. 4.14 chs.
 - S. 38°38' E. 3.38 chs.
 - S. 57°42' E. 2.00 chs.
 - S. 16°50' E. 2.27 chs.
 - S. 12°59' E. 3.93 chs.
 - S. 12°00' E. 1.31 chs.

Lot 4

- Along a poorly defined bank, at the line of ordinary high water.
- S. 66°58' W. 3.06 chs.
 - S. 46°25' W. 4.77 chs.
 - S. 28°41' W. 3.82 chs.
 - N. 41°30' W. 1.84 chs.
 - N. 28°20' E. 3.20 chs.
 - S. 59°44' W. 2.92 chs.
 - S. 33°02' W. 3.73 chs.
 - S. 0°47' W. 4.89 chs.
 - S. 6°55' E. 3.73 chs.
 - S. 14°49' W. 2.57 chs.
 - S. 25°31' W. 3.77 chs.
- Along an unstable bank, 6-8 ft. high, at the line of ordinary high water.
- S. 19°04' W. 5.20 chs.
 - S. 29°43' W. 2.61 chs.
 - S. 32°27' W. 3.20 chs.
 - S. 33°48' W. 2.85 chs.
 - S. 41°33' W. 2.83 chs.
 - S. 48°48' W. 1.35 chs.

Lot 5

- Along an unstable bank, 2-4 ft. high, at the line of ordinary high water.
- S. 23°51' W. 1.08 chs.
 - S. 13°29' W. 4.10 chs.
 - S. 44°36' W. 6.86 chs.
- Along a poorly defined bank, at the line of ordinary high water.
- S. 18°54' W. 1.62 chs.
 - S. 84°27' W. 1.43 chs.
 - S. 2°12' W. 2.62 chs.
 - S. 52°38' W. 1.16 chs.
 - S. 16°58' W. 1.88 chs.
 - S. 38°58' E. 0.53 ch.
- At end of course, the meander corner of Secs. 6 and 31, Tps. 27 and 28 N., R. 25W., K.R.M., Alaska
- S. 51°45' E. 0.78 ch.
 - S. 33°08' W. 1.51 chs.
 - S. 67°18' W. 0.45 ch.

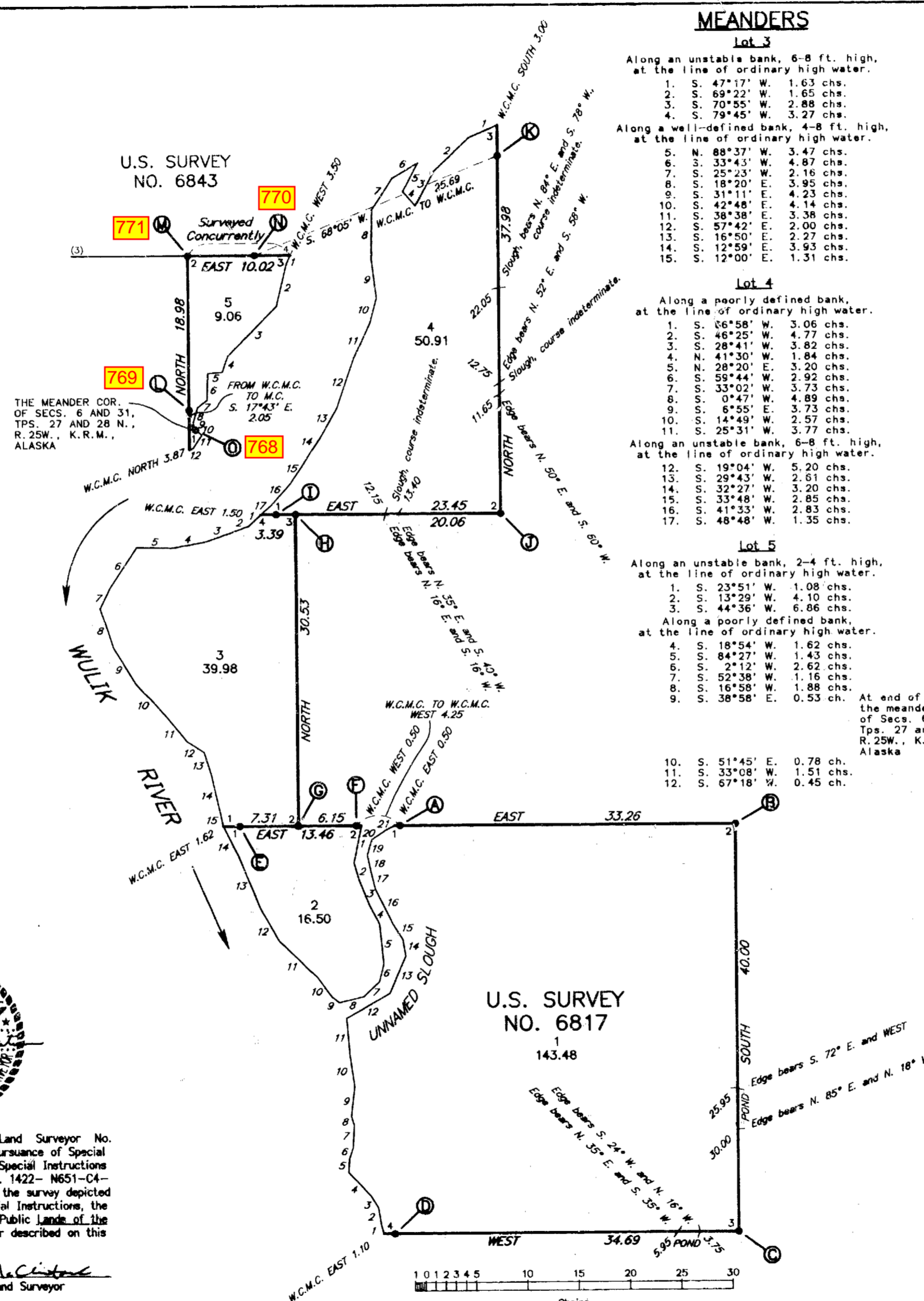

U.S. SURVEY NO. 6817, ALASKA

This plat contains the entire survey record.

The north and west boundaries and a portion of the subdivisional lines of fractional Township 27 North, Range 25 West, Katoel River Meridian, were surveyed in 1976.

U.S. Survey No. 6843 was surveyed concurrently by William W. McClintock, Registered Alaska Land Surveyor No. LS-5480, for Meziq Association, under Special Instructions dated August 14, 1993, approved May 4, 1981.

This survey was executed by William W. McClintock, Registered Alaska Land Surveyor No. LS-5480, for Maniqaq Association, June 24, 1994 through July 9, 1994, in accordance with the specifications set forth in the Manual of Surveying Instructions, 1973, Special Instructions dated July 29, 1980, approved June 10, 1981, Amended Special Instructions dated December 8, 1992, approved May 14, 1993, under Contract No. 1422-N651-C4-3040 awarded May 31, 1994, and Notice to Proceed dated June 9, 1994.

Field Assistants were:

- Andrew B. Alexander, Party Chief
- Douglas W. Moore, Instrument Person
- Thomas A. Gaffe, Survey Technician

Area: 259.93 Acres.

The azimuth was obtained from direct observations of the sun, using the hour angle method, and refers to the true meridian.

The geographic position of the witness corner to corner No. 1, Lot 5, a meander corner, as determined by a direct tie to the meander corner of sections 6 and 31, Townships 27 and 28 North, Range 25 West, Katoel River Meridian, Alaska, is:

Latitude: 67° 46' 33.85" North
 Longitude: 164° 24' 33.40" West
 (NAD 27)

The mean magnetic declination was taken from U.S. Geological Survey quadrangle map "NOATAK D-5," Alaska, 1955 edition.

This survey is located on both banks of the Wulik River, approximately 5 miles northeasterly of Kivalina, Alaska.

Lots 1, 2 and the southerly portion of Lot 3 are level tundra vegetated with native grasses and berry bushes, with dense willow along the river. Lots 4, 5 and the northerly portion of Lot 3 are level ground vegetated with low willow brush.

Permafrost lies approximately 4 to 8 inches below the topsoil of organics and silt.

Access to the site is by boat in the summer and by snowmachine or dogteam in the winter.

Acceptance of this survey does not purport to transfer any interest in submerged lands to which the State of Alaska is entitled under the Equal Footing Doctrine and Section 6(m) of the Alaska Statehood Act, P.L. 85-508, notwithstanding the use, location, or absence of meander lines to depict water bodies.

UNITED STATES DEPARTMENT OF THE INTERIOR
BUREAU OF LAND MANAGEMENT
Anchorage, Alaska

The survey represented by this plat, having been correctly executed in accordance with the requirements of law and the regulations of this Bureau, is hereby accepted.

For the Director

Jerry Dinkerton April 26, 1995
 Deputy State Director for Cadastral Survey, Alaska

I, William W. McClintock, Registered Alaska Land Surveyor No. LS-5480, HEREBY CERTIFY upon honor that in pursuance of Special Instructions dated July 29, 1980, Amended Special Instructions dated December 8, 1992, and under Contract No. 1422-N651-C4-3040 awarded May 31, 1994, I have executed the survey depicted on this plat in strict conformity with said Special Instructions, the Manual of Instructions for the Survey of the Public Lands of the United States, 1973, and in the specific manner described on this plat.

4-20-95 *William W. McClintock*
 Date Registered Land Surveyor

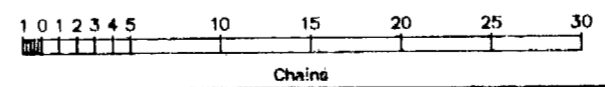

U.S. SURVEY
NO. 6817, ALASKA

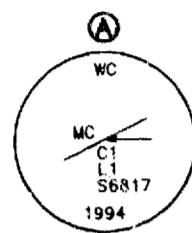

Set a stainless steel post, 28 ins. long, 2 1/2 ins. diam., 26 ins. in the ground, with brass cap mkd. as shown, from which

A magnet in a metallic silver plastic case, bears N. 45° E., 15 lks. dist., buried 18 ins. below the ground.

A magnet in a fluorescent pink plastic case, bears S. 45° E., 15 lks. dist., buried 18 ins. below the ground.

Deposit a magnet in a clear plastic case at the base of the stainless steel post.

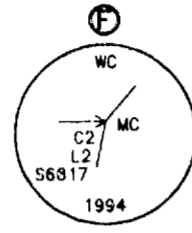

Set a stainless steel post, 28 ins. long, 2 1/2 ins. diam., 26 ins. in the ground, with brass cap mkd. as shown, from which

A magnet in a fluorescent blue plastic case, bears S. 45° W., 15 lks. dist., buried 18 ins. below the ground.

A magnet in a fluorescent orange plastic case, bears N. 45° W., 15 lks. dist., buried 18 ins. below the ground.

Deposit a magnet in a clear plastic case at the base of the stainless steel post.



Set a stainless steel post, 28 ins. long, 2 1/2 ins. diam., 25 ins. in the ground, with brass cap mkd. as shown, from which

A magnet in a fluorescent pink plastic case, bears S. 45° E., 15 lks. dist., buried 18 ins. below the ground.

A magnet in a fluorescent blue plastic case, bears S. 45° W., 15 lks. dist., buried 18 ins. below the ground.

Deposit a magnet in a clear plastic case at the base of the stainless steel post.

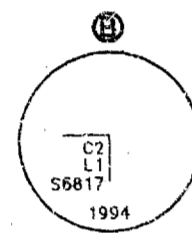

Set a stainless steel post, 28 ins. long, 2 1/2 ins. diam., 26 ins. in the ground, with brass cap mkd. as shown, from which

A magnet in a fluorescent blue plastic case, bears S. 45° W., 15 lks. dist., buried 18 ins. below the ground.

A magnet in a fluorescent orange plastic case, bears N. 45° W., 15 lks. dist., buried 18 ins. below the ground.

Deposit a magnet in a clear plastic case at the base of the stainless steel post.

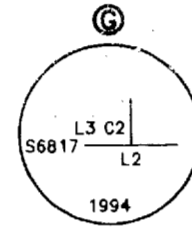

Set a stainless steel post, 28 ins. long, 2 1/2 ins. diam., 26 ins. in the ground, with brass cap mkd. as shown, from which

A magnet in a metallic silver plastic case, bears N. 45° E., 15 lks. dist., buried 18 ins. below the ground.

A magnet in a fluorescent orange plastic case, bears N. 45° W., 15 lks. dist., buried 18 ins. below the ground.

Deposit a magnet in a clear plastic case at the base of the stainless steel post.

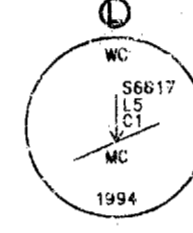

Set a stainless steel post, 28 ins. long, 2 1/2 ins. diam., 26 ins. in the ground, with brass cap mkd. as shown, from which

A magnet in a metallic silver plastic case, bears N. 45° E., 15 lks. dist., buried 18 ins. below the ground.

A magnet in a fluorescent orange plastic case, bears N. 45° W., 15 lks. dist., buried 18 ins. below the ground.

Deposit a magnet in a clear plastic case at the base of the stainless steel post.

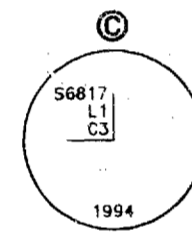

Set a stainless steel post, 28 ins. long, 2 1/2 ins. diam., 26 ins. in the ground, with brass cap mkd. as shown, from which

A magnet in a metallic silver plastic case, bears N. 45° E., 15 lks. dist., buried 18 ins. below the ground.

A magnet in a fluorescent orange plastic case, bears N. 45° W., 15 lks. dist., buried 18 ins. below the ground.

Deposit a magnet in a clear plastic case at the base of the stainless steel post.

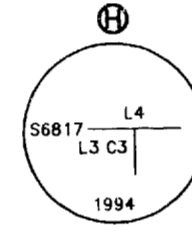

Set a stainless steel post, 28 ins. long, 2 1/2 ins. diam., 25 ins. in the ground, with brass cap mkd. as shown, from which

A magnet in a fluorescent pink plastic case, bears N. 45° E., 15 lks. dist., buried 18 ins. below the ground.

A magnet in a fluorescent blue plastic case, bears S. 45° W., 15 lks. dist., buried 18 ins. below the ground.

Deposit a magnet in a clear plastic case at the base of the stainless steel post.

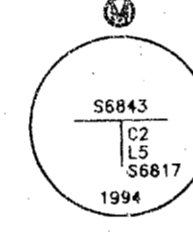

Set a stainless steel post, 28 ins. long, 2 1/2 ins. diam., 26 ins. in the ground, with brass cap mkd. as shown, from which

A magnet in a fluorescent blue plastic case, bears S. 45° W., 15 lks. dist., buried 18 ins. below the ground.

A magnet in a fluorescent orange plastic case, bears N. 45° E., 15 lks. dist., buried 18 ins. below the ground.

Deposit a magnet in a clear plastic case at the base of the stainless steel post.



Set a stainless steel post, 28 ins. long, 2 1/2 ins. diam., 25 ins. in the ground, with brass cap mkd. as shown, from which

A magnet in a metallic silver plastic case, bears N. 45° E., 15 lks. dist., buried 18 ins. below the ground.

A magnet in a fluorescent pink plastic case, bears S. 45° E., 15 lks. dist., buried 18 ins. below the ground.

Deposit a magnet in a clear plastic case at the base of the stainless steel post.

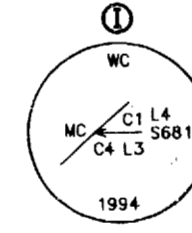

Set a stainless steel post, 28 ins. long, 2 1/2 ins. diam., 26 ins. in the ground, with brass cap mkd. as shown, from which

A magnet in a metallic silver plastic case, bears N. 45° E., 15 lks. dist., buried 18 ins. below the ground.

A magnet in a fluorescent pink plastic case, bears S. 45° E., 15 lks. dist., buried 18 ins. below the ground.

Deposit a magnet in a clear plastic case at the base of the stainless steel post.

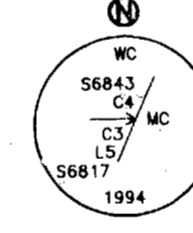

Set a stainless steel post, 28 ins. long, 2 1/2 ins. diam., 24 ins. in the ground, with brass cap mkd. as shown, from which

A magnet in a fluorescent blue plastic case, bears S. 45° W., 15 lks. dist., buried 18 ins. below the ground.

A magnet in a fluorescent orange plastic case, bears N. 45° E., 15 lks. dist., buried 18 ins. below the ground.

Deposit a magnet in a clear plastic case at the base of the stainless steel post.

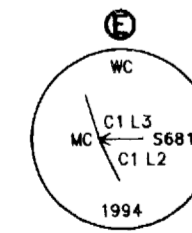

Set a stainless steel post, 28 ins. long, 2 1/2 ins. diam., 26 ins. in the ground, with brass cap mkd. as shown, from which

A magnet in a metallic silver plastic case, bears N. 45° W., 15 lks. dist., buried 18 ins. below the ground.

A magnet in a fluorescent pink plastic case, bears S. 45° E., 15 lks. dist., buried 18 ins. below the ground.

Deposit a magnet in a clear plastic case at the base of the stainless steel post.

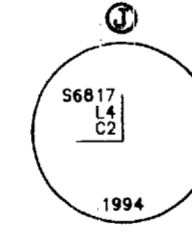

Set a stainless steel post, 28 ins. long, 2 1/2 ins. diam., 26 ins. in the ground, with brass cap mkd. as shown, from which

A magnet in a fluorescent blue plastic case, bears S. 45° W., 15 lks. dist., buried 18 ins. below the ground.

A magnet in a fluorescent orange plastic case, bears N. 45° W., 15 lks. dist., buried 18 ins. below the ground.

Deposit a magnet in a clear plastic case at the base of the stainless steel post.

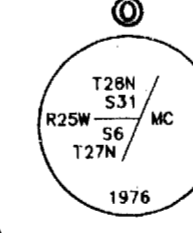

Found an iron post, 2 1/2 ins. diam., 9 ins. below the ground, with brass cap mkd. as shown

REFERENCE SHOULD BE MADE
TO
SHEET No. 1
FOR SURVEY INFORMATION

UNITED STATES DEPARTMENT OF THE INTERIOR
BUREAU OF LAND MANAGEMENT
Anchorage, Alaska

The survey represented by this plat, having been correctly executed in accordance with the requirements of law and the regulations of this Bureau, is hereby accepted.

For the Director

Jerry J. Imbertson April 26, 1995
Deputy State Director for Cadastral Survey, Alaska
Date