

# TOWNSHIPS 26 TO 28 NORTH, RANGES 25 TO 28 WEST, KATEEL RIVER MERIDIAN, ALASKA PROTRACTED (UNSURVEYED)

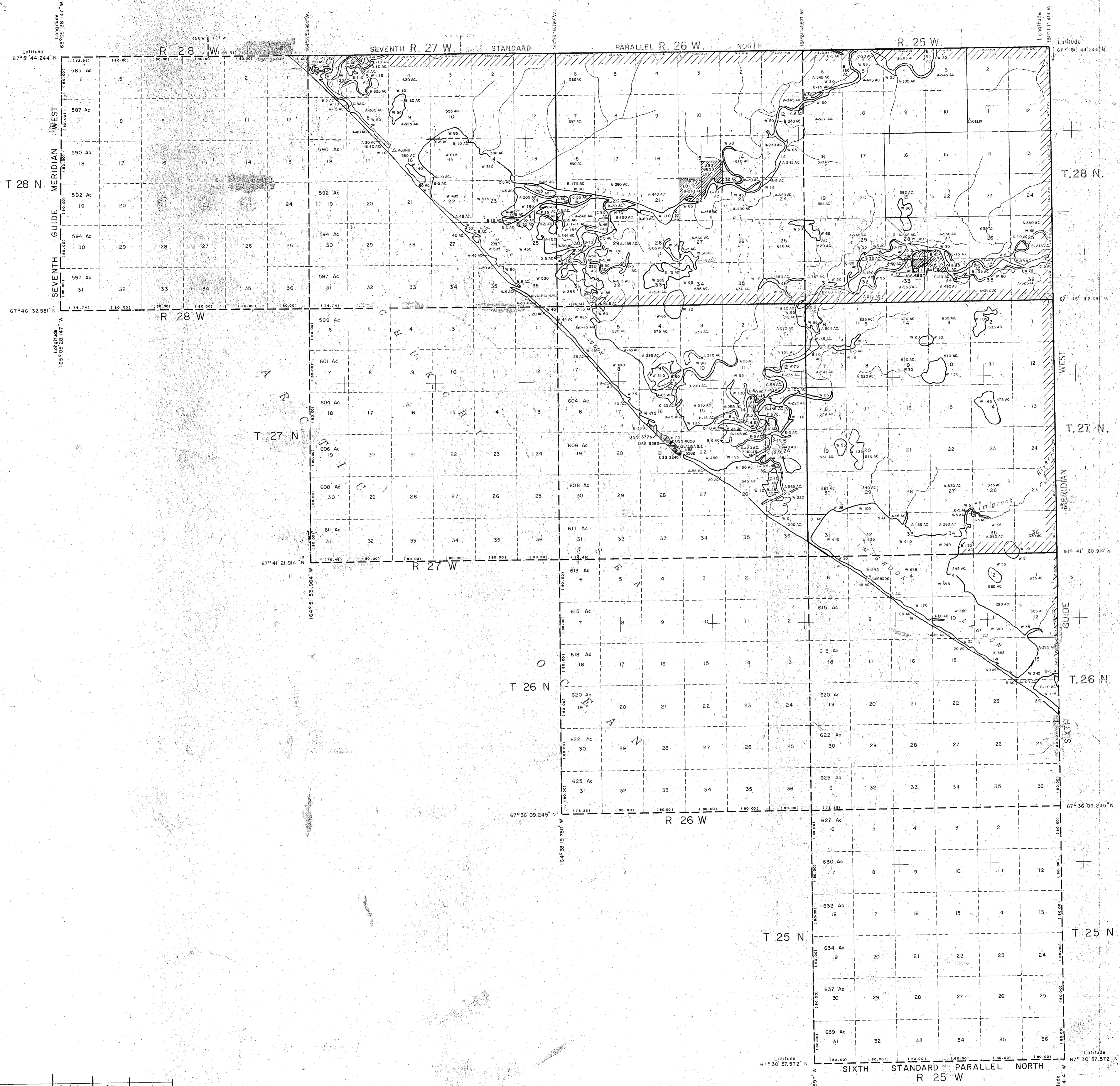

10/11/82	Plotted USS 6837 in T26N, R25W	ED	ED	AKA
10/11/82	Plotted USS 6833 in T26N, R26W	ED	ED	AKA
9/29/82	Added surveyed Top & Sec. lines T26N, R25W	WAS	WAS	AKA
DATE	REVISION	DRN BY	CKD BY	APPR BY

 Surveied land, refer to official survey plats for this area.  
 Unless otherwise shown each Section contains 640 acres.  
 Fractional portions of land areas in each Section designated by letters A, B, C, etc.  
 Water area in each Section designated by letter W.  
 Water areas based upon U.S.G.S. and A.M.S. quadrangles

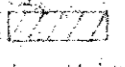
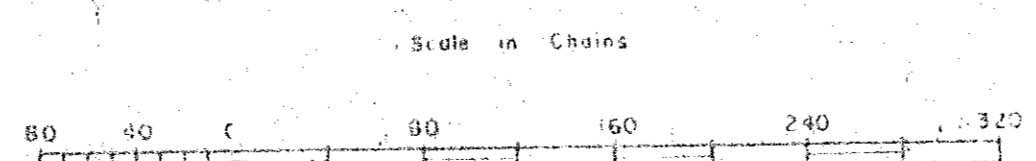
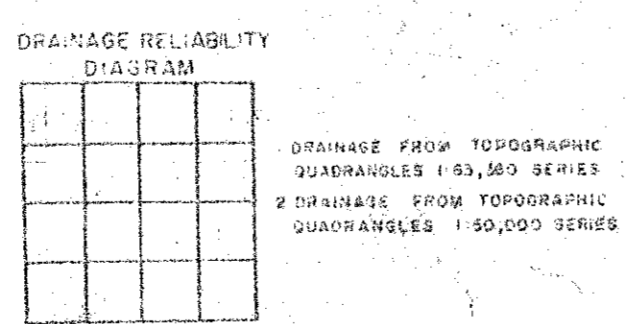

1 meter = 32808333 US. survey ft.  
 1 meter = .4047096 US. chain  
 1 US. acre = 404687 Hectare

11/6/80	Added surveyed Top & Sec. lines for T27N, R25,26,27W & T28N, R25 thru 28W	LRE	WAS	MWC
12/5/77	Plotted USS 3776, 4008 in T27N, R26W	LRE	WAS	MWC
12/5/77	Plotted USS 5582 in T27N, R26W	LRE	WAS	MWC
7/19/67	Extended section grid to offshore area.	LRE	js	T/20
DATE	REVISION	DRN BY	CKD BY	APPR BY

UNITED STATES  
 DEPARTMENT OF THE INTERIOR  
 BUREAU OF LAND MANAGEMENT

WASHINGTON, D.C. SEPT. 14, 1960  
 This diagram represents the official production of the rectangular system of surveys and is hereby approved.

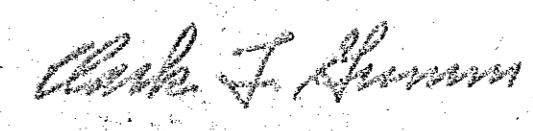
For the Director  
  
 Acting Cadastral Engineering Staff Officer