

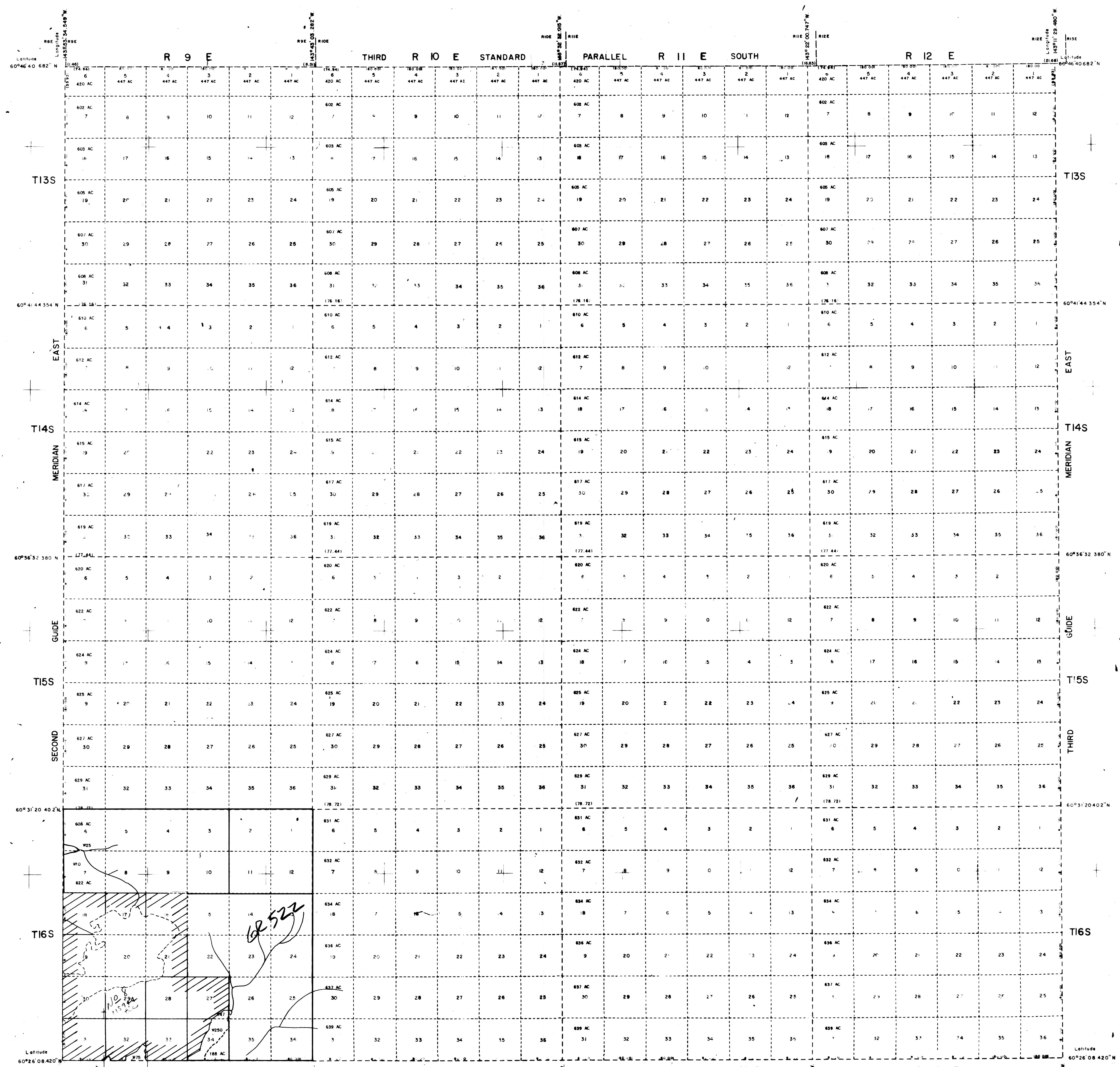

TOWNSHIPS 13 TO 16 SOUTH, RANGES 9 TO 12 EAST, COPPER RIVER MERIDIAN, ALASKA  
PROTRACTED (UNSURVEYED)



 Surveyed; See official plats for areas.  
 Unless otherwise shown each Section contains 640 acres.  
 Fractional portions of land areas in each Section  
 designated by letters A, B, C, etc.  
 Water area in each Section designated by letter W.  
 Water area based upon USGS quadrangle sheets.

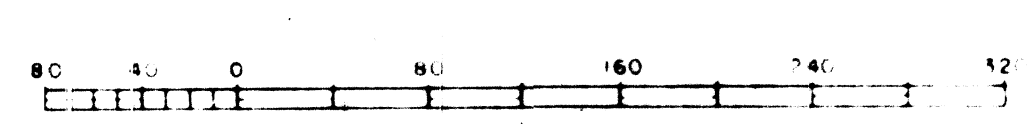
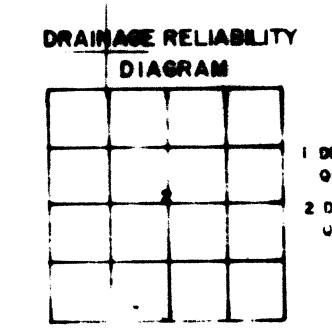

Revised After Approval  
 Bids of T 16S, R 9 E added 10/78.  
 T 16S, R 9 E, ADDED 11/21/95

UNITED STATES  
 DEPARTMENT OF THE INTERIOR  
 BUREAU OF LAND MANAGEMENT  
 WASHINGTON D C SEPTEMBER 20, 1960

This diagram represents the official  
 protraction of the rectangular system  
 of surveys and is hereby approved.

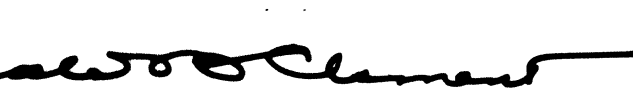
For the Director  

Cadastral Engineering Staff Officer

