

# TOWNSHIPS 13 TO 16 SOUTH, RANGES 5 TO 8 EAST, COPPER RIVER MERIDIAN, ALASKA AMENDED PROTRACTION DIAGRAM (UNSURVEYED)

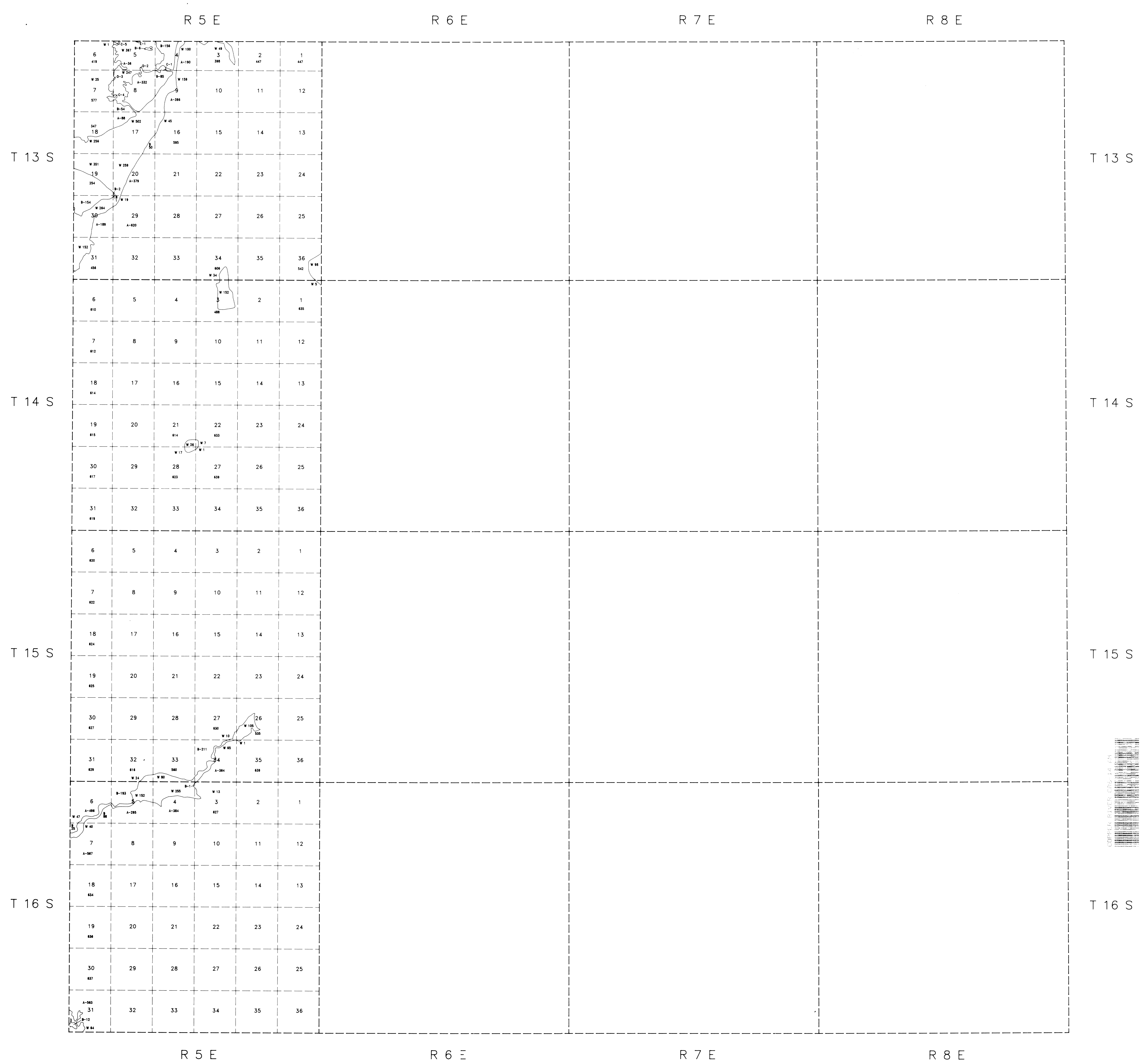

NOTE:  
REFER TO ORIGINAL PROTRACTION DIAGRAM FOR GEOGRAPHIC  
COORDINATES AND OTHER DATA NOT SHOWN HEREON.

This amended protraction diagram updates hydrographic and area information shown on the original diagram. Amended hydrography derived from 1:63,360-scale USGS serial maps photorevised by BLM in 1985 from 1:60,000-scale CIR aerial photography taken between 1978 and 1984.

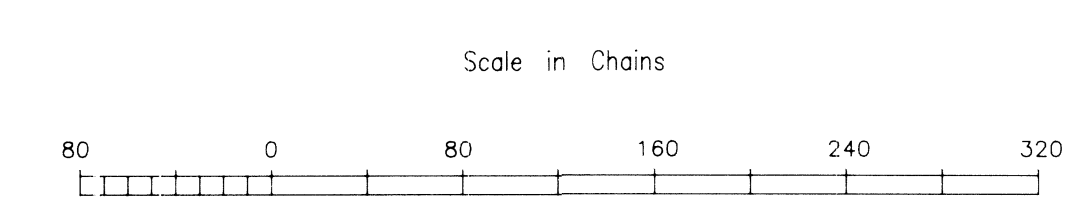

UNITED STATES  
DEPARTMENT OF THE INTERIOR  
BUREAU OF LAND MANAGEMENT  
ANCHORAGE, ALASKA      OCTOBER 2, 1987

This amended diagram represents the official protraction of the rectangular system of surveys and is hereby approved.

For the Director,

*Janni O'Neil*

Deputy State Director for Cadastral Survey, Alaska.

