

STATE	PROJECT DESIGNATION	YEAR	SHEET NO.	TOTAL SHEETS
ALASKA	RS-HES-M-0663(2)	1987	1	20

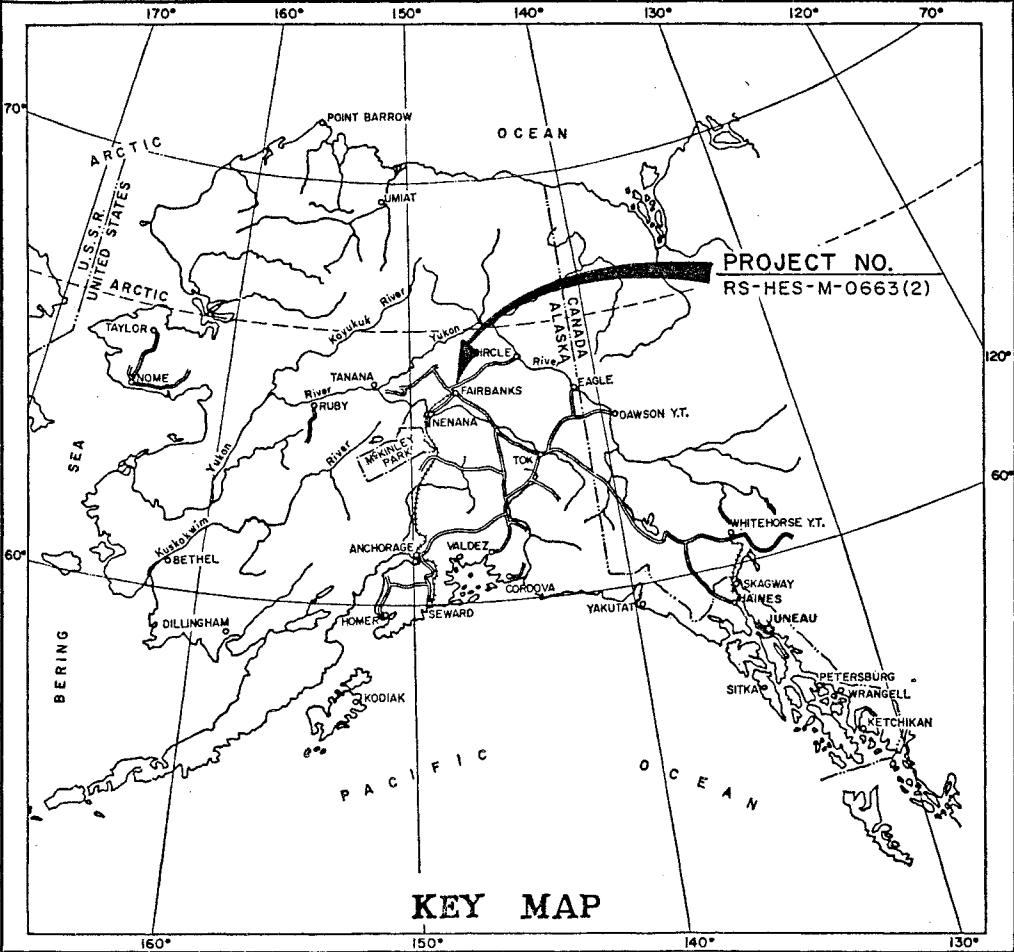

# STATE OF ALASKA DEPARTMENT OF TRANSPORTATION & PUBLIC FACILITIES

## PLAN AND PROFILE PROPOSED HIGHWAY PROJECT

### CUSHMAN ST./GAFFNEY RD. GEOMETRIC & SIGNAL UPGRADE RS-HES-M-0663(2) / 60487

**AS-BUILT PLANS**

INITIALS: CS DATE: 10-11-90  
 CONTRACTOR: EARTH MOVERS OF FAIRBANKS INC.  
 DATE STARTED: JUNE 14, 1989  
 DATE COMPLETED: OCTOBER 25, 1989  
 RESIDENT ENGINEER: CHARLES E. ECKERT  
Printed  
 RESIDENT ENGINEER: Charles S. Eckert  
Signature

INDEX OF SHEETS	
SHEET NO	DESCRIPTION
1	TITLE SHEET
2	EST. OF QUANTITIES-TYPICAL SECTIONS
3	GENERAL NOTES
4	GEOMETRIC LAYOUT
5	DETAILS-SIDEWALK-CURB-RAMP-MISC.
6	MISCELLANEOUS DETAILS
7	CURB INLETS- STORM DRAIN - MANHOLE DETAILS
8	FIRE HYDRANT INSTALLATION
9	SIGNING & STRIPING NOTES- SIGN SUMMARY
10-11	SIGNING & STRIPING DETAILS
12	SIGNAL & LIGHTING NOTES
13-19	SIGNAL & LIGHTING DETAILS
20	TRAFFIC CONTROL PLAN

THE FOLLOWING STANDARD DRAWINGS APPLY TO THIS PROJECT:  
 A-1, C-01.02, C-02.00, D-01.01, D-05.10, D-23.00, D-26.01, F-01.01, I-20.01, L-03.01,  
 L-30.01, S-00.00, S-05.00, S-20.00, T-20.00, T-21.01, T-22.01,  
 T-30.00, T-31.00, T-32.00, T-33.01, T-34.00 and T-52.01

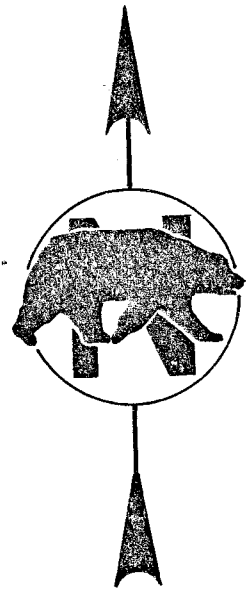

PROJECT LOCATION

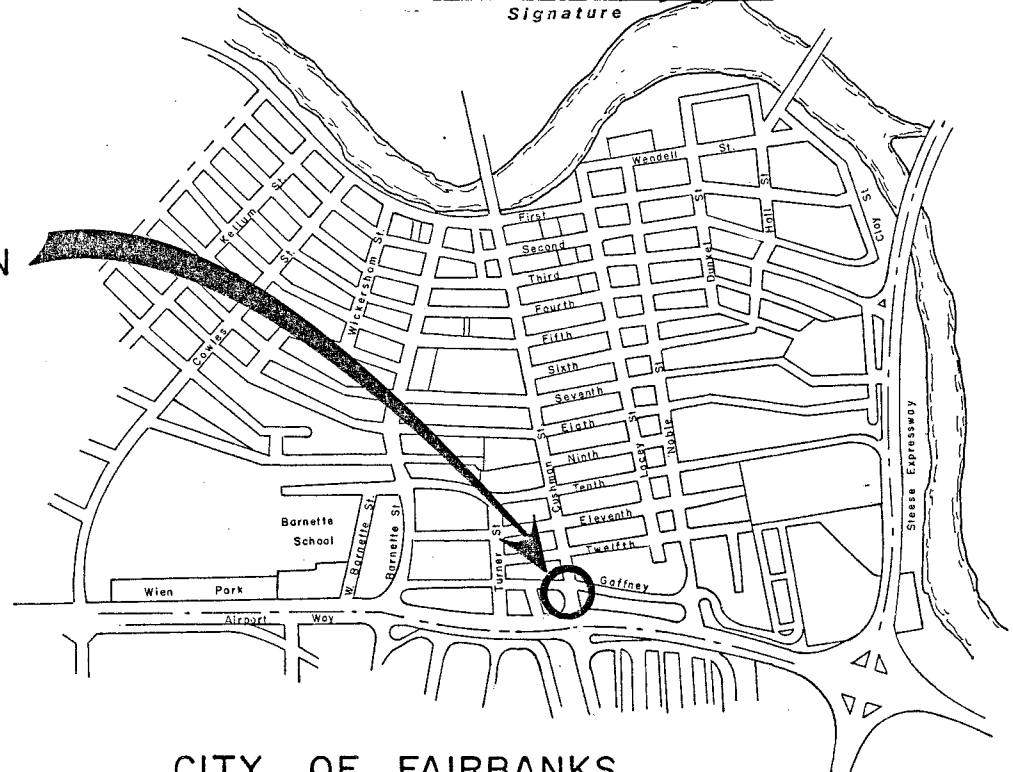

CITY OF FAIRBANKS

Plans Developed by: JOHN MANCUSO

Under the Supervision of:

STATE OF ALASKA  
DEPARTMENT OF TRANSPORTATION  
&  
PUBLIC FACILITIES

APPROVED  
*Stephen Leslie*  
 Date 10/26/88

ESTIMATE OF QUANTITIES			AS - BUILT
ITEM NO.	ITEM	UNIT	QUANTITY
109 (2)	DBE & WBE ADJUSTMENTS	C.S.	ALL REQ'D.
110 (2)	MOBILIZATION & DEMOBILIZATION	L.S.	ALL REQ'D
114 (1)	CONSTRUCTION SURVEYING BY THE CONTRACTOR	L.S.	ALL REQ'D
115 (1)	TRAFFIC MAINTENANCE	L.S.	ALL REQ'D
115 (2)	TRAFFIC CONTROL	L.S.	ALL REQ'D
115 (3)	PERMANENT CONSTRUCTION SIGNING	L.S.	ALL REQ'D
115 (4)	TRAFFIC CONTROL DEVICES	C.S.	ALL REQ'D
203 (5B)	BORROW TYPE A	L.S.	ALL REQ'D
301 (1)	CRUSHED AGG. BASE COURSE, D-1	L.S.	ALL REQ'D
401 (1)	ASPHALT CONCRETE TYPE II	TON	181.53
604 (5)	INLETS	EACH	3
608 (1)	CONCRETE SIDEWALK 4 INCH DEPTH	S.Y.	318
609 (2)	CURB & GUTTER — TYPE I	L.F.	546
615 (1)	STANDARD SIGN	S.F.	163.00
628 (7)	FIRE HYDRANT RELOCATION	EACH	1
660 (1)	TRAFFIC SIGNAL SYSTEM COMPLETE	L.S.	ALL REQ'D
670 (1)	PAINTED TRAFFIC MARKINGS	L.S.	ALL REQ'D
660 (9)	2" CONDUIT EWO* 2	L.S.	ALL REQ'D

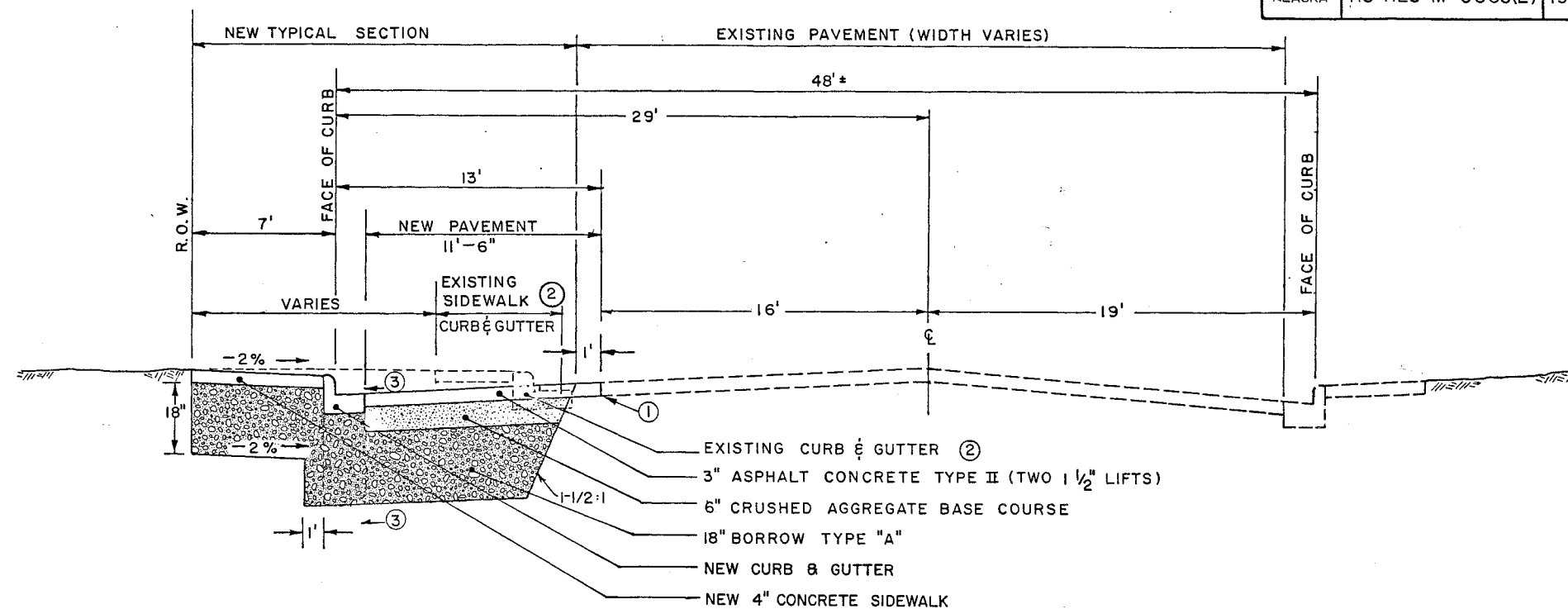

TYPICAL SECTION  
"C" LINE

NOTES

- ① SAW CUT TO OBTAIN A UNIFORM LINE AND VERTICAL SURFACE FOR THE JOINT, CUTTING SHALL BE DONE JUST PRIOR TO PAVING. PAINT VERTICAL SURFACE WITH APPROVED ASPHALT MATERIAL JUST PRIOR TO PAVING. EXISTING PAVEMENT THICKNESS MAY EXCEED 4"
- ② EXISTING SIDEWALK AND CURB AND GUTTER (TO BE REMOVED).
- ③ CROSS SLOPE AND CURB GRADES AS REQUIRED FOR POSITIVE DRAINAGE. SEE GENERAL NOTE 19, SHEET 3.
- ④ EXCAVATION LIMITS AND AREAS OF NEW PAVEMENT AT RADII SHALL BE AS DIRECTED BY THE ENGINEER. UNLESS NOTED OTHERWISE.
- ⑤ SEE SHEET 5 FOR INTERSECTION RADIUS IMPROVEMENT TYPICALS. (CURB RAMP DETAILS).

ITEM NO	ITEM	FACTOR
203(5B)	BORROW, TYPE A	2.0 TONS/CU.YD.
301(1)	CRUSHED AGGREGATE BASE COURSE, D-1	2.0 TONS/CU.YD.
401(1)	ASPHALT CONCRETE TYPE II (6.3% ASPHALT)	110 lb/SQ. YD. IN.

**AS-BUILT PLANS**

INITIALS: CE DATE: 10-11-90



NOT TO SCALE

ESTIMATE OF  
QUANTITIES  
TYPICAL SECTIONS  
DETAILS

# GENERAL NOTES

60487505	STATE	PROJECT DESIGNATION	YEAR	SHEET NO.	TOTAL SHEETS
	ALASKA	RS-HES-M-0663 (2)	1987	3	20

- (1) WORK AND MATERIALS NOT SPECIFICALLY REFERRED TO UNDER A CONTRACT BID ITEM SHALL BE CONSIDERED INCIDENTAL TO BID SCHEDULE PAY ITEMS AND SHALL REQUIRE NO ADDITIONAL COMPENSATION.
- (2) PRIOR TO OTHER CONSTRUCTION, EXCEPT TRAFFIC MAINTENANCE, THE CONTRACTOR SHALL LOCATE AND MAINTAIN R.O.W. AND EASEMENT LIMITS. THIS WORK SHALL BE INCIDENTAL TO ITEM 114(1) CONSTRUCTION SURVEYING BY THE CONTRACTOR. (SEE SHEET 4 AND PROJECT R.O.W. MAPS FOR ADDITIONAL INFORMATION).
- (3) THE CONTRACTOR SHALL PROTECT TREES AND SHRUBS, RESTORE LAWNS AND PARKING LOT PAVEMENTS ON THE RIGHT OF WAY (R.O.W.) AND CONSTRUCTION EASEMENTS. THIS WORK AND MATERIALS SHALL BE AS APPROVED BY THE ENGINEER AND SHALL BE INCIDENTAL TO BID SCHEDULE PAY ITEMS.
- (4) PRIOR TO INSTALLING FOUNDATIONS, CONDUITS, J-BOXES, POLES, ANCHORS OR REMOVING SIDEWALKS & CURBS OR ANY EXCAVATION, THE CONTRACTOR SHALL LOCATE AND PROTECT ALL EXISTING UNDERGROUND UTILITIES INCLUDING FIBER OPTICS, WATER, TELEPHONE CABLE, AND SEWER SERVICES TO PRIVATE PROPERTY. THIS WORK SHALL BE INCIDENTAL TO ITEM 114(1) CONSTRUCTION SURVEYING BY THE CONTRACTOR. (SEE SECTION 107-1.16)
- (5) ALL EXISTING UNDERGROUND UTILITIES ARE NOT SHOWN ON THE PLANS.
- (6) ALL WORK ON EXISTING UTILITIES SHALL BE IN ACCORDANCE WITH THE PLANS AND SPECIFICATIONS AND SHALL BE ACCEPTABLE TO THE UTILITY OWNER.
- (7) THE EXISTING STORM DRAIN INLETS AND MANHOLES LOCATED IN AREAS OF NEW SIDEWALK, CURB & GUTTER AND NEW PAVEMENT MAY REQUIRE MODIFICATIONS BY REMOVING AND REPOURING PORTIONS OF THE CONCRETE BOXES AS DIRECTED BY THE ENGINEER. THIS WORK AND MATERIALS SHALL BE INCIDENTAL TO BID SCHEDULE PAY ITEMS. (MAXIMUM OF 3 INLETS AND 3 MANHOLES)
- (8) EXISTING DROP INLETS LOCATED AT THE NW AND NE CORNERS OF CUSHMAN & GAFFNEY AND THE NW CORNER OF CUSHMAN & AIRPORT RD. SHALL BE CLEANED OUT. DEBRIS SHALL BE DISPOSED OF AS APPROVED BY THE ENGINEER. THIS WORK AND MATERIALS SHALL BE INCIDENTAL TO BID SCHEDULE PAY ITEMS.
- (9) THE EXISTING CURB TYPE STORM DRAIN INLET LOCATED AT THE N.W. CORNER OF THE CUSHMAN ST. / AIRPORT ROAD INTERSECTION WILL REQUIRE MODIFICATION TO A NEENAH R-3403-F OR EQUIVALENT GUTTER INLET FRAME AND GRATE. THIS WORK AND MATERIALS SHALL BE INCIDENTAL TO BID SCHEDULE PAY ITEMS.
- (10) THE CONTRACTOR SHALL CONTACT THE CITY ENGINEER 2 WEEKS PRIOR TO WORKING ON EACH EXISTING UTILITY, INCLUDING STORM DRAINS, FIRE HYDRANTS AND LIGHTING SYSTEMS TO ALLOW THE AFFECTED UTILITY THE OPPORTUNITY TO INSPECT THE WORK. THE CITY WILL INSPECT VALVE BOXES PRIOR TO ANY ADJUSTMENTS. REPAIRS REQUIRED TO VALVES OR VALVE BOXES PRIOR TO ADJUSTMENT BY THE CONTRACTOR WILL BE BY THE UTILITY AT THE CITY'S EXPENSE. VALVE BOX ADJUSTMENT SHALL BE INCIDENTAL TO BID SCHEDULE PAY ITEMS.
- (11) THE CONTRACTOR SHALL FURNISH WRITTEN ACCEPTANCE, FROM THE CITY OF ALL UTILITY WORK, PRIOR TO FINAL INSPECTION AND ACCEPTANCE OF THE PROJECT.
- (12) ALL WORK REQUIRED UNDER SECTION 202 REMOVAL OF STRUCTURES AND OBSTRUCTIONS INCLUDING BUT NOT LIMITED TO THE FOLLOWING SHALL BE CONSIDERED INCIDENTAL TO THE BID SCHEDULE PAY ITEMS EXCEPT WHEN INCIDENTAL TO A SPECIFIC ITEM:  
REMOVAL & DISPOSAL OF SIDEWALK, CURB & GUTTER, SIGNS, POST, FOUNDATIONS, FENCES AND PAVEMENT.
- (13) HOLES CREATED BY REMOVAL OF POLES/POSTS OR OTHER EXISTING IMPROVEMENTS SHALL BE BACKFILLED AND COMPACTED WITH MATERIALS AND METHODS, AS APPROVED BY THE ENGINEER, TO PREVENT SETTLEMENT OF NEW FOUNDATIONS, SIDEWALKS AND PAVED AREAS.
- (14) AT THE S.E. CORNER OF CUSHMAN/GAFFNEY REMOVE & DISPOSE OF EXISTING SEAR'S CONCRETE SIGN POLE FOUNDATION, LIGHT POLE, AND CONCRETE LIGHT POLE FOUNDATION AS APPROVED BY THE ENGINEER. SEE NOTE 4, THIS SHEET.
- (15) AT THE S.W. CORNER OF CUSHMAN/GAFFNEY REMOVE & DISPOSE THAT PORTION OF THE CONCRETE PAD FOUNDATION WHICH IS WITHIN THE R.O.W. TO A DEPTH OF 1' BELOW BACK OF NEW SIDEWALK GRADE, AS APPROVED BY THE ENGINEER. SEE NOTE 4, THIS SHEET.
- (16) AT THE N.W. CORNER OF CUSHMAN STREET AND AIRPORT WAY REMOVE EXISTING FENCE AND POSTS (BETWEEN CURB AND SIDEWALK) TO THE P.C. OF NEW CURB RADIUS AS DIRECTED BY THE ENGINEER. INSTALL NEW TERMINAL POST, BRACES AND HARDWARE AS DETAILED IN STANDARD DRAWING F-01.01 THIS WORK SHALL BE INCIDENTAL TO BID SCHEDULE PAY ITEMS.
- (17) UNLESS NOTED OTHERWISE ON THE PLANS OR DIRECTED BY THE ENGINEER EXISTING MATERIALS NOT REUSED ON THIS PROJECT, EXCEPT SIGNAL HEADS AND SIGNS, SHALL BE SALVAGED AND DELIVERED TO THE D.O.T. MAINTENANCE YARD AT 2301 PEGER ROAD AND STORED AS DIRECTED BY THE ENGINEER. SIGNAL HEADS AND SIGNS SHALL BE SALVAGED AND DELIVERED TO CITY MAINTENANCE YARD AT 2121 PEGER RD. AND STORED AS DIRECTED BY THE ENGINEER. THIS WORK SHALL BE INCIDENTAL TO BID SCHEDULE PAY ITEMS.
- (18) THE CONTRACTOR SHALL ESTABLISH THE CUSHMAN ST. CENTERLINE BY USING THE EXISTING CENTERLINE MONUMENT LOCATED AT THE 15 TH. AVE. INTERSECTION AND THE BRASS PIN AT THE CUSHMAN/GAFFNEY RD. INTERSECTION. THE CENTERLINE MONUMENT AT AIRPORT WAY IS NOT ON LINE. VERTICAL CONTROL SHALL BE EXISTING PAVEMENTS, SIDEWALKS AND CURB & GUTTER WHERE THEY MATCH NEW IMPROVEMENTS. WHERE PROFILE ELEVATIONS ARE REQUIRED THE CONTRACTOR SHALL USE U.S.G.S. BENCHMARK D-53, ELEVATION 439.51 LOCATION AT THE S.E. CORNER OF OLD MAIN SCHOOL.
- (19) CONSTRUCTION GRADES SHALL BE PROPOSED IN WRITING BY THE CONTRACTOR AND APPROVED OR REVISED BY THE ENGINEER. THE CONTRACTOR SHALL ALSO FURNISH THE ENGINEER WITH EXISTING SIDEWALK, GUTTER, INLET AND PAVEMENT PROFILE ELEVATIONS, TAKEN EVERY 5 TO 10 FT. AS REQUIRED BY THE ENGINEER, TO CONFIRM POSITIVE DRAINAGE GRADES TO INLETS IN THE AREAS OF THE PROPOSED IMPROVEMENTS. THIS WORK SHALL BE INCIDENTAL TO ITEM 114(1) CONSTRUCTION SURVEYING BY THE CONTRACTOR. THE ABOVE INFORMATION SHALL BE PROVIDED TO THE ENGINEER THREE WORKING DAYS IN ADVANCE OF ANY WORK REQUIRING GRADING SUCH AS J-BOXES, FOUNDATIONS, SIDEWALKS, CURB AND GUTTER AND PAVING.
- (20) WHERE THE EDGE OF ANY EXISTING PAVEMENT MEETS THE NEW PAVEMENT OR PAVEMENT REPAIRS IT SHALL BE SAW CUT TO OBTAIN A UNIFORM LINE AND VERTICAL SURFACE FOR THE JOINT. PAINT THE VERTICAL SURFACE WITH APPROVED ASPHALT MATERIAL. THIS WORK AND MATERIALS SHALL BE INCIDENTAL TO BID SCHEDULE PAY ITEMS.
- (21) 1/2 INCH EXPANSION JOINT MATERIAL (SEALED) SHALL BE INSTALLED AROUND J-BOXES, FOUNDATIONS, INLETS, FIRE HYDRANTS, WOOD POLES, AND MANHOLE CASTINGS IN AREAS OF CONCRETE CURB AND CONCRETE SIDEWALK. ALL EXPANSION JOINT MATERIAL SHALL BE SET 1/4" BELOW THE SURFACE AND SEALED WITH APPROVED MATERIAL.
- (22) THE CONSTRUCTION EASEMENT ALONG THE WEST SIDE OF CUSHMAN ST. FROM GAFFNEY RD. TO AIRPORT WAY IS IN EFFECT FOR ONLY 60 CONSECUTIVE CALENDER DAYS BEGINNING JUNE 1, 1989. ALL WORK DONE REQUIRING THE USE OF THIS EASEMENT, EXCLUDING SURVEY WORK, SHALL BE COMPLETED WITHIN THE ABOVE SPECIFIED TIME FRAME.
- (23) ACCESS TO ALL EXISTING APPROACHES SHALL BE MAINTAINED FOR THE DURATION OF THE PROJECT.

**AS-BUILT PLANS**

INITIALS: CE      DATE: 10-11-90

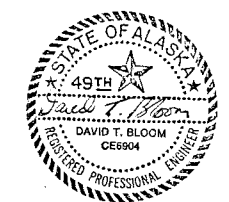

GENERAL NOTES

STATE	PROJECT DESIGNATION	YEAR	SHEET NO.	TOTAL SHEETS
ALASKA	RS-HES-M-0663(2)	1988	4	20

**AS-BUILT PLANS**

INITIALS: C.E.      DATE: 10-11-90

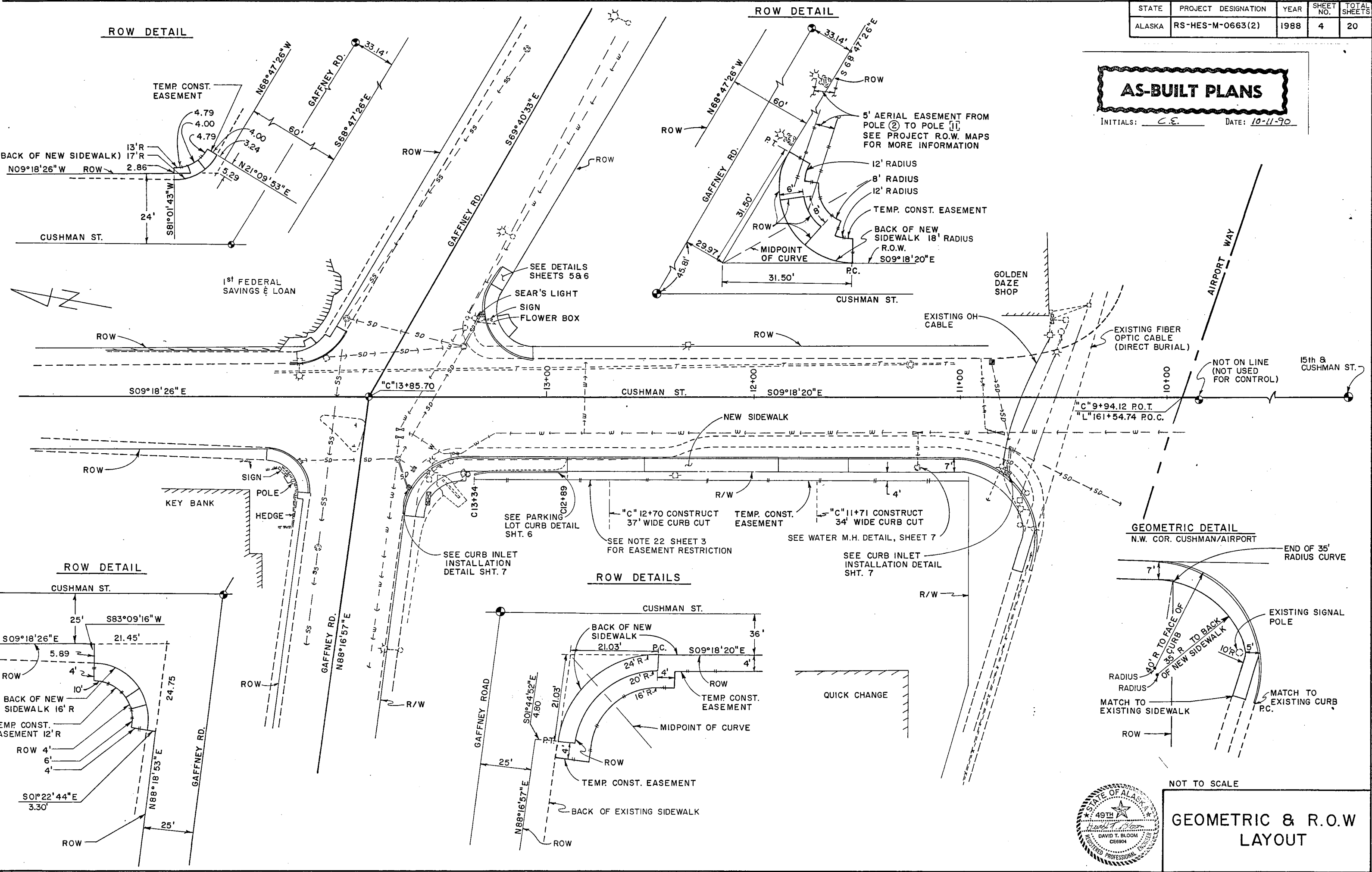

NOT TO SCALE

**GEOMETRIC & R.O.W. LAYOUT**