

C:\Users\cweiler\appdata\local\temp\AcPublish_5892\AKSAS 64078 Airport Way Cushman SCD LDP.dwg Feb 25, 2019 - 10:17am

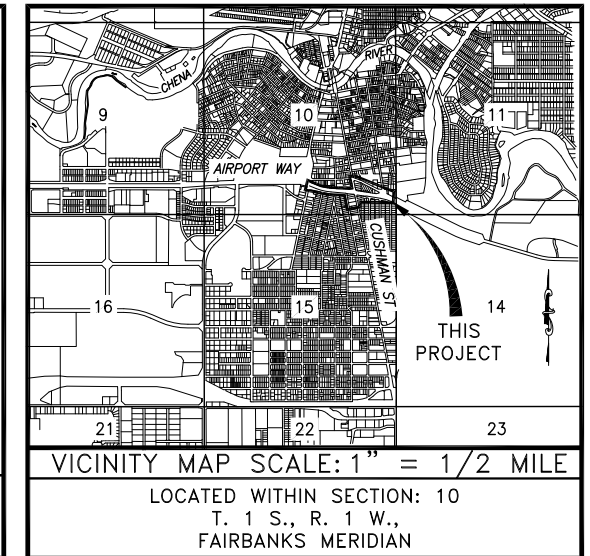
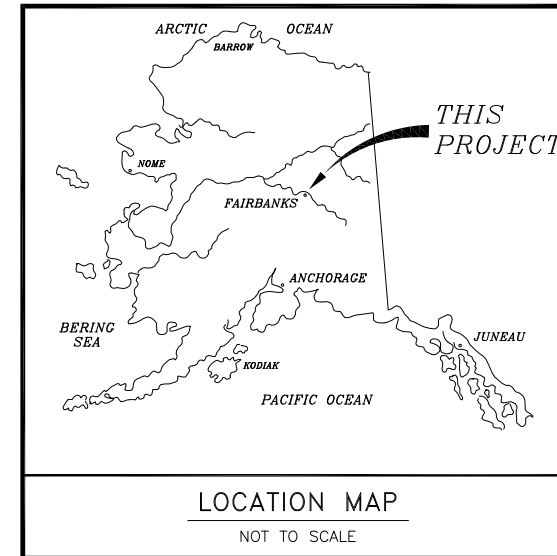
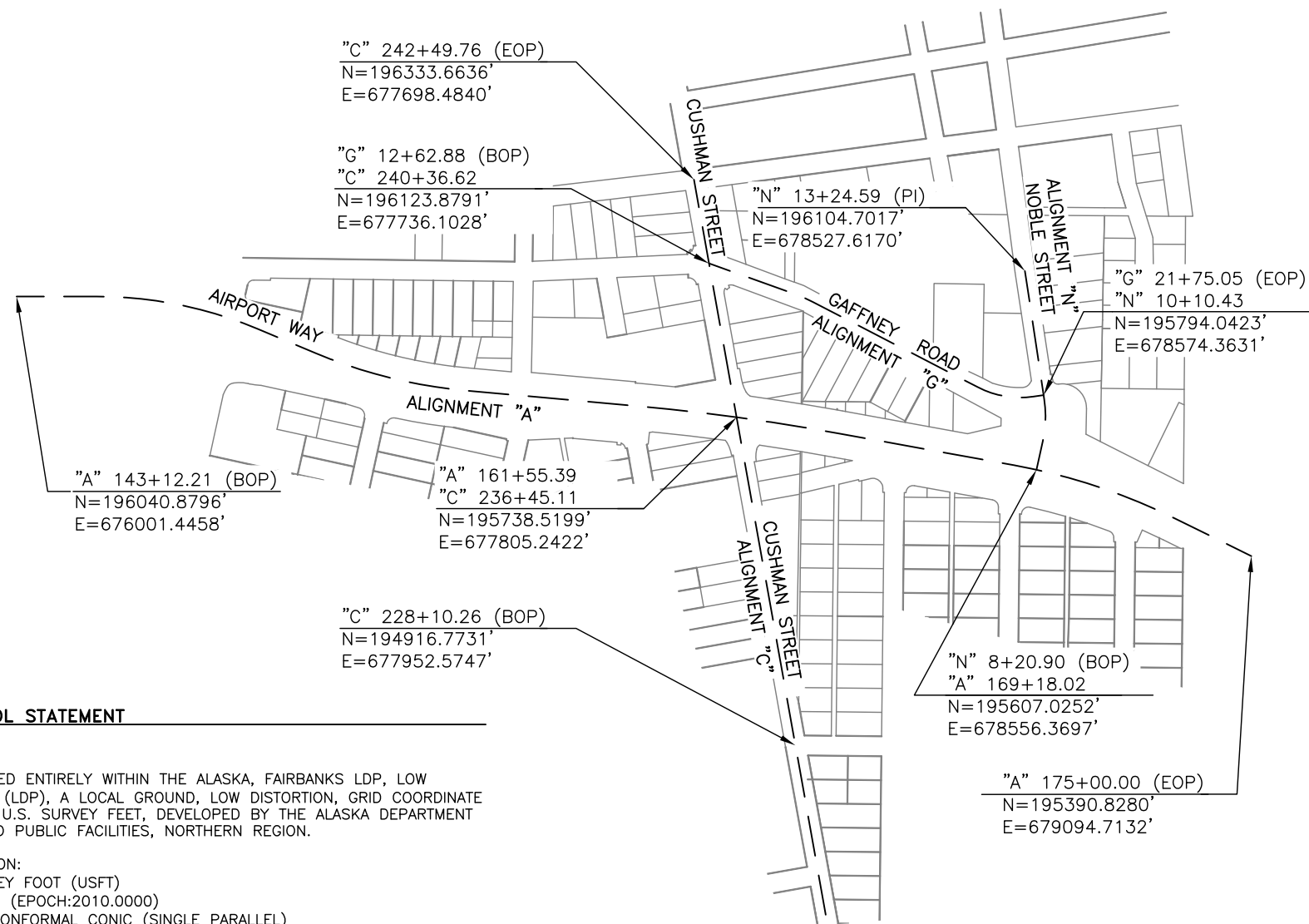

HORIZONTAL CONTROL STATEMENT

COORDINATE SYSTEM:
THIS PROJECT IS LOCATED ENTIRELY WITHIN THE ALASKA, FAIRBANKS LDP, LOW DISTORTION PROJECTION (LDP), A LOCAL GROUND, LOW DISTORTION, GRID COORDINATE SYSTEM, EXPRESSED IN U.S. SURVEY FEET, DEVELOPED BY THE ALASKA DEPARTMENT OF TRANSPORTATION AND PUBLIC FACILITIES, NORTHERN REGION.

FAIRBANKS LDP DEFINITION:
LINEAR UNIT: U.S. SURVEY FOOT (USFT)
DATUM: NAD83 (2011) (EPOCH:2010.0000)
PROJECTION: LAMBERT CONFORMAL CONIC (SINGLE PARALLEL)
STANDARD PARALLEL AND GRID ORIGIN: 64°51'00.0" N
CENTRAL MERIDIAN (GRID ORIGIN): 146°56'00.0" W
FALSE NORTHING: 200,000.0 USFT
FALSE EASTING: 800,000.0 USFT
STANDARD PARALLEL SCALE: 1.00003 (EXACT)

BASIS OF COORDINATES:
THE BASIS OF COORDINATES IS POINT NUMBER 1, A SET 3-1/4" ALUMINUM CAP MONUMENT ON A 2-1/2" ALUMINUM POST. THE GEODETIC POSITION WAS ESTABLISHED BY AVERAGING FIVE OPUS SOLUTIONS, ALL OF WHICH BASED UPON AT LEAST 8-HOURS OF STATIC GPS OBSERVATION TIME. SAID BASIS OF COORDINATES HAS THE FOLLOWING COORDINATES:

NAD83(2011)(2010.0000) GEODETIC COORDINATES (AVERAGED):
LAT. = 64°50'11.14441" NORTH
LONG. = 147°43'03.85626" WEST
ORTHOMETRIC HEIGHT = 445.68 US FEET (NAVD88/GEOID12B)

PROJECT COORDINATES:
N. = 195,792.7166 US FEET, E. = 677,851.3241 US FEET

BASIS OF BEARINGS:
PROJECT BEARINGS ARE FAIRBANKS LDP GRID BEARINGS.

VERTICAL CONTROL STATEMENT
THE VERTICAL DATUM IS NAVD88 (GEOID12B). THE BASIS OF VERTICAL CONTROL IS POINT NUMBER 1, A SET 3-1/4" ALUMINUM CAP MONUMENT ON A 2-1/2" ALUMINUM POST. THE ORTHOMETRIC HEIGHT WAS ESTABLISHED BY AVERAGING FIVE OPUS SOLUTIONS, ALL OF WHICH BASED UPON AT LEAST 8-HOURS OF STATIC GPS OBSERVATION TIME. THE NAVD88 ORTHOMETRIC WAS AVERAGED AS 445.68 US FEET.

PROJECT ELEVATIONS WERE ESTABLISHED BY DIFFERENTIAL LEVEL LOOPS, PERFORMED BY R&M CONSULTANTS, INC. USING A LEICA DNA10 DIGITAL LEVEL AND ALL LEVEL LOOPS WERE CLOSED, ADJUSTED AND MEET OR EXCEED THIRD ORDER ACCURACY.

NOTES

1. THE FIELD SURVEY WAS PERFORMED BY R&M CONSULTANTS, INC. (R&M) DECEMBER 2, 2015 THROUGH JANUARY 26, 2016, MAY 20, 2016 THROUGH JUNE 3, 2016, AND JANUARY 23, 2019 THROUGH JANUARY 26, 2019. FIELD SURVEY INFORMATION IS LOCATED IN R&M FIELD BOOKS 2336.01, BOOKS 1 THRU 6.
2. ALL DISTANCES SHOWN ARE GROUND DISTANCES IN U.S. SURVEY FEET.
3. THIS SURVEY DOES NOT CONSTITUTE A SUBDIVISION AS DEFINED BY ALASKA STATUTE 40.15.900(5)(A).
4. VERIFY HORIZONTAL AND VERTICAL CONTROL PRIOR TO USE.
5. BACKGROUND MAPPING IS SHOWN FOR ORIENTATION PURPOSES ONLY.
6. SEE SHEET 2 FOR ALIGNMENT INFORMATION.

ALIGNMENT SHEET INDEX

- SHEET 2 = AIRPORT WAY: "A" STA 143+12.21 TO 165+40.00
- SHEET 3 = AIRPORT WAY: "A" STA 165+40.00 TO 175+00.00
- SHEET 3 = NOBLE STREET: "N" STA 8+20.90 TO 13+24.59
- SHEET 4 = CUSHMAN STREET: "C" STA 228+10.26 TO 242+49.76
- SHEET 4 = GAFFNEY ROAD: "G" STA 12+62.88 TO 21+75.05

SURVEYORS CERTIFICATE

I HEREBY CERTIFY THAT I AM PROPERLY REGISTERED AND LICENSED TO PRACTICE LAND SURVEYING IN THE STATE OF ALASKA, AND THAT THIS PLAT REPRESENTS A SURVEY MADE BY ME OR UNDER MY DIRECT SUPERVISION, AND THAT THE MONUMENTS SHOWN HEREON ACTUALLY EXIST AS DESCRIBED, AND THAT ALL DIMENSIONS AND OTHER DETAILS ARE CORRECT TO THE EXTENT SHOWN HEREON.

DATE: _____ REGISTRATION NUMBER _____

CHAD A. WEILER, PLS
R&M CONSULTANTS, INC.
9101 VANGUARD DRIVE
ANCHORAGE, AK 99507
CERTIFICATE OF AUTHORIZATION
NO. AECC111
(907) 522-1707

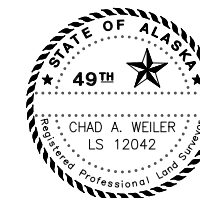

STATE BUSINESS, NO CHARGE FOR RECORDING

DATE: FEB 2019

DATE OF SURVEY Beginning: 12/02/2015 Ending: 1/26/2019	NAME AND ADDRESS: Department of Transportation and Public Facilities (DOT&PF) 2301 Peger Road Fairbanks, Alaska 99709		
RECORD OF SURVEY			
PRE-CONSTRUCTION CONTROL DIAGRAM AIRPORT/CUSHMAN INTERSECTION RECONSTRUCTION AKSAS 64078 within SECTION 10 T 1 S., R 1 W FAIRBANKS MERIDIAN, ALASKA FAIRBANKS RECORDING DISTRICT			
DRAWN BY: KJR/JAA	SCALE: 1"=200'	CHECKED BY: CAW	FILE NO.:

**AIRPORT WAY - ALIGNMENT "A"
STA 143+12.21 TO 165+40.00**

SEE SHEET 4

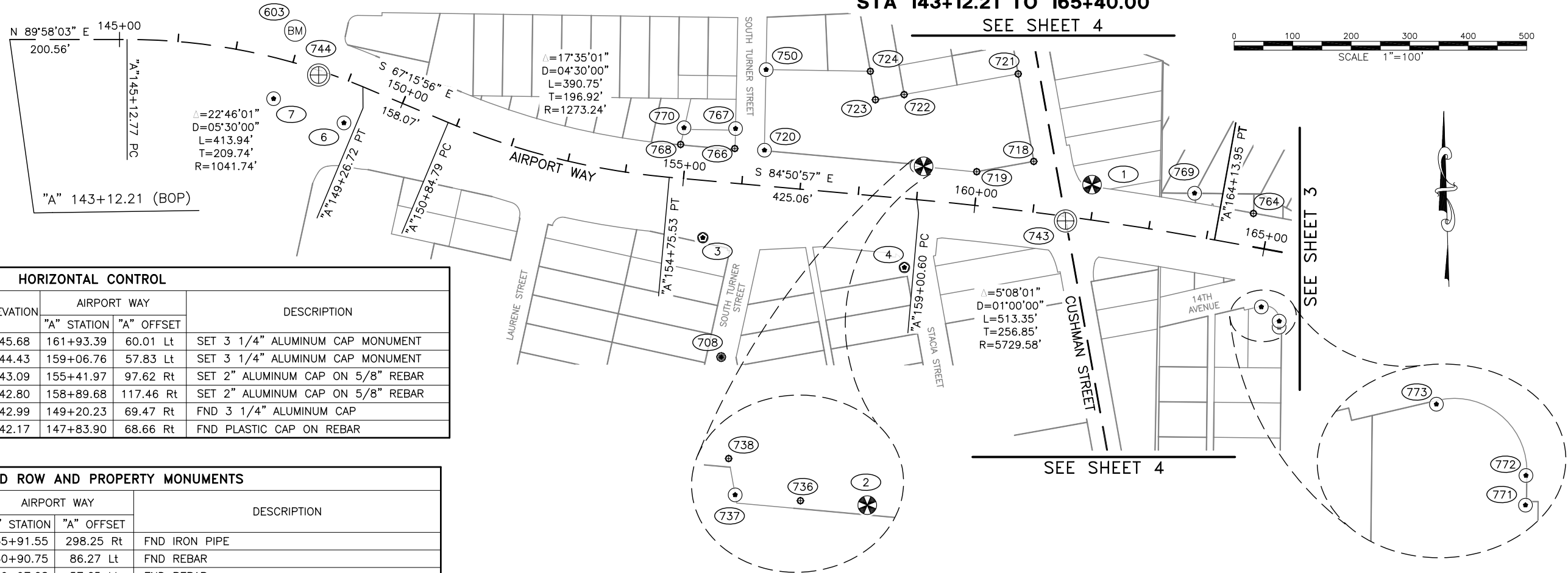
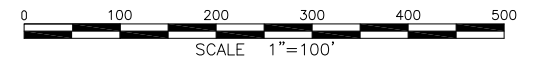

HORIZONTAL CONTROL						
POINT	PROJECT (GROUND) COORDINATES		ELEVATION	AIRPORT WAY		DESCRIPTION
	NORTHING	EASTING		"A" STATION	"A" OFFSET	
1	195792.7166	677851.3241	445.68	161+93.39	60.01 Lt	SET 3 1/4" ALUMINUM CAP MONUMENT
2	195824.0581	677563.4653	444.43	159+06.76	57.83 Lt	SET 3 1/4" ALUMINUM CAP MONUMENT
3	195701.9936	677186.1366	443.09	155+41.97	97.62 Rt	SET 2" ALUMINUM CAP ON 5/8" REBAR
4	195651.0180	677530.6555	442.80	158+89.68	117.46 Rt	SET 2" ALUMINUM CAP ON 5/8" REBAR
6	195898.3098	676572.7548	442.99	149+20.23	69.47 Rt	FND 3 1/4" ALUMINUM CAP
7	195939.7033	676452.4775	442.17	147+83.90	68.66 Rt	FND PLASTIC CAP ON REBAR

RECOVERED ROW AND PROPERTY MONUMENTS						
POINT	PROJECT (GROUND) COORDINATES		AIRPORT WAY		DESCRIPTION	
	NORTHING	EASTING	"A" STATION	"A" OFFSET		
708	195497.7279	677217.5051	155+91.55	298.25 Rt	FND IRON PIPE	
718	195832.4325	677751.7358	160+90.75	86.27 Lt	FND REBAR	
719	195814.8767	677654.2310	159+97.08	57.65 Lt	FND REBAR	
720	195851.6209	677291.4952	156+33.47	60.86 Lt	FND 1 1/2" ALUMINUM CAP	
721	195982.1037	677725.1400	160+47.72	231.71 Lt	FND REBAR	
722	195946.7759	677530.1747	158+62.65	177.06 Lt	FND REBAR	
723	195937.9293	677481.1412	158+14.61	163.84 Lt	FND REBAR	
724	195986.6322	677472.3945	158+01.52	211.56 Lt	FND REBAR	
*725	196130.9914	677067.3829	153+55.34	314.71 Lt	FND REBAR	
736	195824.4383	677557.7559	159+01.10	57.69 Lt	FND REBAR	
737	195824.9361	677552.1807	158+95.50	57.68 Lt	FND 1 1/2" ALUMINUM CAP	
738	195828.0434	677551.6271	158+94.67	60.73 Lt	FND REBAR	
743	195730.5941	677806.0396	161+57.24	7.75 Rt	FND 2 1/2" BRASS CAP MONUMENT	
744	195980.2351	676529.4872	148+48.44	7.72 Rt	FND 2 1/2" BRASS CAP MONUMENT	
750	195989.3992	677294.3588	156+23.96	198.34 Lt	FND 1 1/2" ALUMINUM CAP	
764	195743.4228	678127.2435	164+71.43	56.48 Lt	FND REBAR	
766	195854.4683	677240.7346	155+82.66	59.14 Lt	FND REBAR	
767	195888.5902	677242.0776	155+80.94	93.24 Lt	FND 1 1/2" ALUMINUM CAP	
768	195861.4105	677148.1304	154+89.81	57.74 Lt	FND REBAR	
769	195778.0389	678026.6067	163+66.82	72.77 Lt	FND 1 1/2" ALUMINUM CAP	
770	195889.9927	677153.9295	154+93.02	86.72 Lt	FND 1 1/2" ALUMINUM CAP	
771	195548.9862	678171.0977	165+49.29	127.01 Rt	FND 1 1/2" ALUMINUM CAP	
772	195559.1374	678171.2597	165+47.64	116.99 Rt	FND 1 1/2" ALUMINUM CAP	
773	195583.5143	678140.6512	165+13.17	98.47 Rt	FND 1 1/2" ALUMINUM CAP	

* NOT SHOWN

VERTICAL CONTROL						
POINT	PROJECT (GROUND) COORDINATES		ELEVATION	AIRPORT WAY		DESCRIPTION
	NORTHING	EASTING		"A" STATION	"A" OFFSET	
603	196056	676489	444.36	147+89	53 Lt	SCRIBED "X" ON SOUTHEAST BOLT AT BASE OF TRAFFIC SIGNAL POLE

ALIGNMENT INFORMATION

- THE AIRPORT WAY ALIGNMENT AND STATIONING IS BASED UPON THE ADOT&PF RIGHT OF WAY PLANSET FOR PROJECT F-062-4(21), TITLED "PROPOSED HIGHWAY PROJECT IN FAIRBANKS FROM GILLAM WAY E & S", DATED 12/30/1968. THE BASIS OF STATIONING IS CONSISTENT WITH THE ASBUILTS FOR PROJECTS F-062-4(27) AND F-037-1(27).
- THE CUSHMAN STREET ALIGNMENT IS BASED UPON THE RECORD OF SURVEY OF SOUTH CUSHMAN STREET RECORDED AS PLAT 96-93 IN THE FAIRBANKS RECORDING DISTRICT. THE BASIS OF STATIONING IS THE COMPUTED POSITION AT THE STREET INTERSECTION OF CUSHMAN STREET AND GAFFNEY ROAD.
- THE GAFFNEY ROAD ALIGNMENT IS BASED UPON THE CITY OF FAIRBANKS ASBUILT PLAN SET, TITLED "GAFFNEY ROAD IMPROVEMENTS FB-09-15". THE BASIS OF STATIONING IS THE COMPUTED POSITION AT THE STREET INTERSECTION OF CUSHMAN STREET AND GAFFNEY ROAD.
- THE NOBLE STREET ALIGNMENT IS BASED UPON AN ADOT&PF UNRECORDED RECORD OF SURVEY, TITLED "PROJECT NO. STP-000S(413)/61725 FAIRBANKS NOBLE STREET UPGRADE", DATED 04/10/15. THE BASIS OF STATIONING IS 10+00.00, A PT NEAR THE INTERSECTION OF NOBLE STREET AND GAFFNEY ROAD.

NOTES

- SEE SHEET 1 FOR NOTES.

LEGEND

- FOUND CENTERLINE MONUMENT IN CASING
- SET PRIMARY MONUMENT
- SET TEMPORARY BENCHMARK THIS SURVEY
- FOUND REBAR WITH CAP
- SET REBAR WITH CAP
- FOUND REBAR
- FOUND IRON PIPE
- SURVEY POINT NUMBER

DATE: FEB 2019



DATE OF SURVEY Beginning: 12/02/2015 Ending: 1/26/2019	NAME AND ADDRESS: Department of Transportation and Public Facilities (DOT&PF) 2301 Peger Road Fairbanks, Alaska 99709
--	---

RECORD OF SURVEY

PRE-CONSTRUCTION CONTROL DIAGRAM
AIRPORT/CUSHMAN INTERSECTION RECONSTRUCTION
AKSAS 64078
within
SECTION 10
T 1 S, R 1 W
FAIRBANKS MERIDIAN, ALASKA
FAIRBANKS RECORDING DISTRICT

DRAWN BY: KJR/JAA	SCALE: 1"=100'	CHECKED BY: CAW	FILE NO.:
----------------------	-------------------	--------------------	-----------

**AIRPORT WAY - ALIGNMENT "A"
STA 165+40.00 TO 175+00.00
&
NOBLE STREET - ALIGNMENT "N"
STA 8+20.90 TO 13+24.59**

VERTICAL CONTROL								
POINT	PROJECT (GROUND) COORDINATES		ELEVATION	AIRPORT WAY		NOBLE STREET		DESCRIPTION
	NORTHING	EASTING		"A" STATION	"A" OFFSET	"N" STATION	"N" OFFSET	
601	195661	678690	447.40	170+31	86 Lt	9+01	119 Rt	SCRIBED "X" ON TOP NORTHEAST FLANGE BOLT OF FIRE HYDRANT

HORIZONTAL CONTROL								
POINT	PROJECT (GROUND) COORDINATES		ELEVATION	AIRPORT WAY		NOBLE STREET		DESCRIPTION
	NORTHING	EASTING		"A" STATION	"A" OFFSET	"N" STATION	"N" OFFSET	
5	195700.1396	678487.6707	444.66	168+33.79	78.24 Lt	8+97.91	87.18 Lt	FND PLASTIC CAP ON REBAR

RECOVERED ROW AND PROPERTY MONUMENTS							
POINT	PROJECT (GROUND) COORDINATES		AIRPORT WAY		NOBLE STREET		DESCRIPTION
	NORTHING	EASTING	"A" STATION	"A" OFFSET	"N" STATION	"N" OFFSET	
712	196414.5413	678306.7958	165+28.28	748.87 Lt	-	-	FND 2" BRASS CAP MONUMENT
714	196104.7017	678527.6170	168+00.87	483.43 Lt	13+24.59	0.00	FND 2 1/2" BRASS CAP MONUMENT
716	194910.7306	678482.9570	170+62.11	692.00 Rt	-	-	FND 1 1/2" ALUMINUM CAP
730	195998.5628	678518.3181	168+10.67	377.34 Lt	12+21.01	24.99 Lt	FND REBAR
731	196246.0457	678483.5298	167+32.25	614.63 Lt	-	-	FND IRON PIPE
732	196244.7290	678534.1255	167+82.27	622.37 Lt	-	-	FND REBAR
733	196073.5934	678299.9277	165+82.39	412.17 Lt	-	-	FND 1 1/2" ALUMINUM CAP
734	196014.7653	678566.5649	168+55.25	401.89 Lt	12+29.86	25.13 Rt	FND REBAR
735	196071.9957	678425.3279	167+06.06	432.99 Lt	13+07.46	106.02 Lt	FND REBAR
742	195599.5959	678554.7262	169+18.02	7.61 Rt	-	-	FND 2 1/2" ALUMINUM CAP MONUMENT
752	195836.7280	678421.8910	167+44.68	200.89 Lt	10+75.33	144.42 Lt	FND 1 1/2" ALUMINUM CAP

SEE SHEET 4
SEE SHEET 2

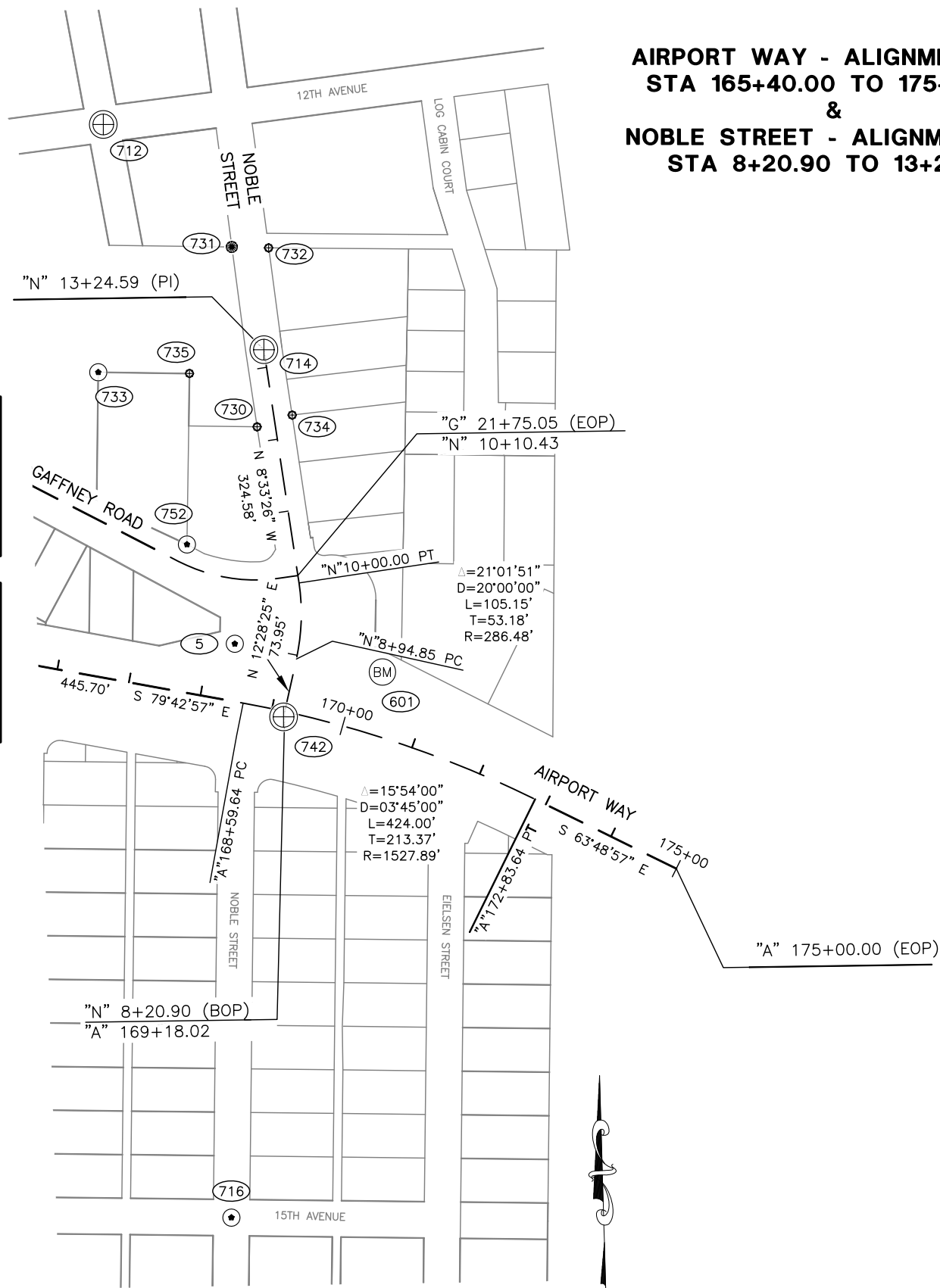

LEGEND

- ⊕ FOUND CENTERLINE MONUMENT IN CASING
- BM SET TEMPORARY BENCHMARK THIS SURVEY
- FOUND REBAR WITH CAP
- FOUND REBAR
- FOUND IRON PIPE
- ⑤ SURVEY POINT NUMBER

NOTES

1. See Sheet 1 for Notes.



DATE: FEB 2019

DATE OF SURVEY Beginning: 12/02/2015 Ending: 1/26/2019	NAME AND ADDRESS: Department of Transportation and Public Facilities (DOT&PF) 2301 Peger Road Fairbanks, Alaska 99709
--	---

RECORD OF SURVEY

PRE-CONSTRUCTION CONTROL DIAGRAM
AIRPORT/CUSHMAN INTERSECTION RECONSTRUCTION
AKSAS 64078
 within
 SECTION 10
 T 1 S, R 1 W
 FAIRBANKS MERIDIAN, ALASKA
 FAIRBANKS RECORDING DISTRICT

DRAWN BY: KJR/JAA	SCALE: 1"=100'	CHECKED BY: CAW	FILE NO.:
----------------------	-------------------	--------------------	-----------

CUSHMAN STREET - ALIGNMENT "C"
STA 228+10.26 TO 242+49.76
&
GAFFNEY ROAD - ALIGNMENT "G"
STA 12+62.88 TO 21+75.05

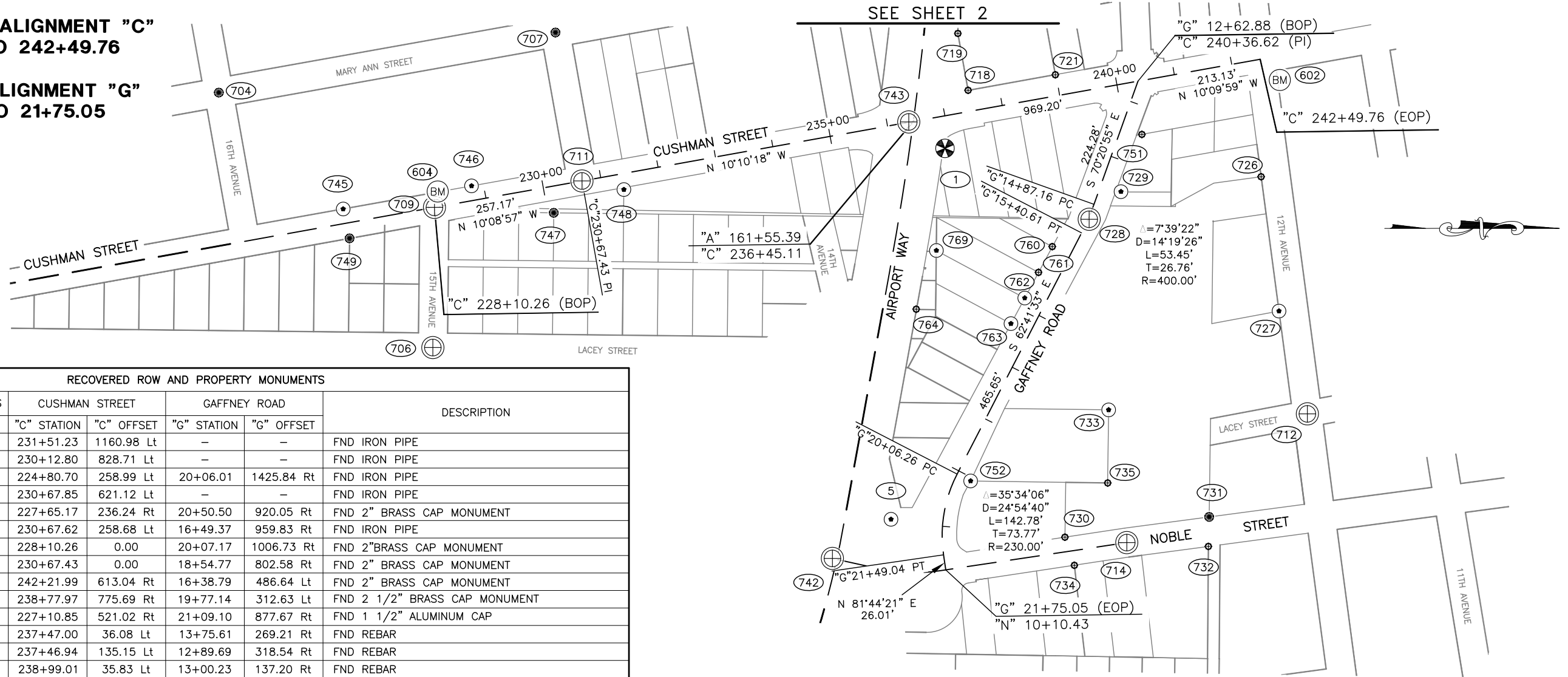

RECOVERED ROW AND PROPERTY MONUMENTS							
POINT	PROJECT (GROUND) COORDINATES		CUSHMAN STREET		GAFFNEY ROAD		DESCRIPTION
	NORTHING	EASTING	"C" STATION	"C" OFFSET	"G" STATION	"G" OFFSET	
*701	195047.3779	676749.7279	231+51.23	1160.98 Lt	-	-	FND IRON PIPE
*702	194970.1126	677101.1411	230+12.80	828.71 Lt	-	-	FND IRON PIPE
704	194546.7280	677755.7162	224+80.70	258.99 Lt	20+06.01	1425.84 Rt	FND IRON PIPE
*705	195060.6461	677295.8259	230+67.85	621.12 Lt	-	-	FND IRON PIPE
706	194914.0225	678193.0666	227+65.17	236.24 Rt	20+50.50	920.05 Rt	FND 2" BRASS CAP MONUMENT
707	195124.4182	677652.6074	230+67.62	258.68 Lt	16+49.37	959.83 Rt	FND IRON PIPE
709	194916.7731	677952.5747	228+10.26	0.00	20+07.17	1006.73 Rt	FND 2" BRASS CAP MONUMENT
711	195169.9143	677907.2588	230+67.43	0.00	18+54.77	802.58 Rt	FND 2" BRASS CAP MONUMENT
712	196414.5413	678306.7958	242+21.99	613.04 Rt	16+38.79	486.64 Lt	FND 2" BRASS CAP MONUMENT
714	196104.7017	678527.6170	238+77.97	775.69 Rt	19+77.14	312.63 Lt	FND 2 1/2" BRASS CAP MONUMENT
*716	194910.7306	678482.9570	227+10.85	521.02 Rt	21+09.10	877.67 Rt	FND 1 1/2" ALUMINUM CAP
718	195832.4325	677751.7358	237+47.00	36.08 Lt	13+75.61	269.21 Rt	FND REBAR
719	195814.8767	677654.2310	237+46.94	135.15 Lt	12+89.69	318.54 Rt	FND REBAR
721	195982.1037	677725.1400	238+99.01	35.83 Lt	13+00.23	137.20 Rt	FND REBAR
726	196335.2260	677900.0856	242+15.71	198.71 Rt	13+46.24	254.18 Lt	FND REBAR
727	196365.8602	678130.4638	242+05.20	430.88 Rt	15+21.65	363.34 Lt	FND 1 1/2" ALUMINUM CAP
728	196040.1645	677972.9921	239+12.39	218.38 Rt	15+14.03	1.73 Lt	FND 3 1/4" ALUMINUM CAP
729	196094.7159	677925.6367	239+74.45	181.40 Rt	14+51.18	36.27 Lt	FND 1 1/2" ALUMINUM CAP
730	195998.5628	678518.3181	237+75.14	747.79 Rt	21+48.19	210.45 Lt	FND REBAR
731	196246.0457	678483.5298	240+24.88	757.25 Rt	18+73.12	418.00 Lt	FND IRON PIPE
732	196244.7290	678534.1255	240+14.65	806.82 Rt	19+18.69	440.04 Lt	FND REBAR
733	196073.5934	678299.9277	238+87.56	546.08 Rt	17+89.10	180.54 Lt	FND 1 1/2" ALUMINUM CAP
734	196014.7653	678566.5649	237+82.57	798.14 Rt	-	-	FND REBAR
735	196071.9957	678425.3279	238+63.84	669.23 Rt	19+01.26	236.65 Lt	FND REBAR
742	195599.5959	678554.7262	233+76.02	713.17 Rt	21+37.34	190.15 Rt	FND 2 1/2" ALUMINUM CAP MONUMENT
743	195730.5941	677806.0396	236+37.17	0.61 Lt	14+61.00	346.86 Rt	FND 2 1/2" BRASS CAP MONUMENT
745	194760.1784	677955.3362	226+55.63	24.88 Lt	20+19.50	1146.88 Rt	FND 1 1/2" ALUMINUM CAP
746	194980.3875	677915.6954	228+79.38	25.09 Lt	19+49.21	967.11 Rt	FND 1 1/2" ALUMINUM CAP
747	195121.4518	677961.9455	230+10.09	45.29 Rt	19+25.59	820.55 Rt	FND IRON PIPE
748	195241.7885	677922.0224	231+35.56	27.22 Rt	18+34.91	731.94 Rt	FND 1 1/2" ALUMINUM CAP
749	194771.1020	678005.7055	226+57.51	26.63 Rt	20+26.60	1117.04 Rt	FND IRON PIPE
751	196130.6160	677827.4197	240+27.13	91.07 Rt	13+46.61	37.05 Lt	FND REBAR
752	195836.7280	678421.8910	236+32.88	624.30 Rt	20+06.14	26.02 Lt	FND 1 1/2" ALUMINUM CAP
760	195976.8539	678019.8781	-	-	15+84.64	33.90 Rt	FND REBAR
761	195953.2508	678064.0871	-	-	16+34.75	34.59 Rt	FND REBAR
762	195929.6135	678108.0860	-	-	16+84.69	35.41 Rt	FND 1 1/2" ALUMINUM CAP
763	195905.9626	678151.9770	-	-	17+34.54	36.29 Rt	FND 1 1/2" ALUMINUM CAP
764	195743.4228	678127.2435	-	-	17+87.13	192.06 Rt	FND REBAR
769	195778.0389	678026.6067	-	-	16+81.83	207.47 Rt	FND 1 1/2" ALUMINUM CAP

* NOT SHOWN

VERTICAL CONTROL						
POINT	PROJECT (GROUND) COORDINATES		ELEVATION	CUSHMAN STREET		DESCRIPTION
	NORTHING	EASTING		"C" STATION	"C" OFFSET	
602	196367	677734	445.79	242+77	41 Rt	SCRIBED "X" ON TOP NORTHWEST FLANGE BOLT OF FIRE HYDRANT
604	194922	677925	445.77	228+21	26 Lt	SCRIBED "X" ON NORTHEAST BOLT AT BASE OF METAL LUMINAIRE

HORIZONTAL CONTROL								
POINT	PROJECT (GROUND) COORDINATES		ELEVATION	CUSHMAN STREET		GAFFNEY ROAD		DESCRIPTION
	NORTHING	EASTING		"C" STATION	"C" OFFSET	"G" STATION	"G" OFFSET	
1	195792.7166	677851.3241	445.68	236+90.32	54.93 Rt	14+82.76	273.13 Rt	SET 3 1/4" ALUMINUM CAP MONUMENT
5	195700.1396	678487.6707	444.66	234+86.82	664.93 Rt	20+95.73	89.00 Rt	FND PLASTIC CAP ON REBAR

- LEGEND**
- ⊕ FOUND CENTERLINE MONUMENT IN CASING
 - ⊗ SET PRIMARY MONUMENT
 - ⊙ SET TEMPORARY BENCHMARK THIS SURVEY
 - ⊙ FOUND REBAR WITH CAP
 - ⊙ SET REBAR WITH CAP
 - ⊙ FOUND REBAR
 - ⊙ FOUND IRON PIPE
 - ① SURVEY POINT NUMBER
- NOTES**
- SEE SHEET 1 FOR NOTES.

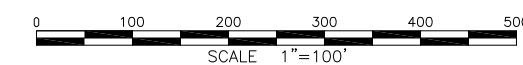

DATE: FEB 2019

DATE OF SURVEY Beginning: 12/02/2015 Ending: 1/26/2019	NAME AND ADDRESS: Department of Transportation and Public Facilities (DOT&PF) 2301 Peger Road Fairbanks, Alaska 99709
--	---

RECORD OF SURVEY

PRE-CONSTRUCTION CONTROL DIAGRAM
AIRPORT/CUSHMAN INTERSECTION RECONSTRUCTION
AKSAS 64078
 within
 SECTION 10
 T 1 S, R 1 W
 FAIRBANKS MERIDIAN, ALASKA
 FAIRBANKS RECORDING DISTRICT

DRAWN BY: KJR/JAA	SCALE: 1"=100'	CHECKED BY: CAW	FILE NO.:
----------------------	-------------------	--------------------	-----------

C:\Users\cweiler\appdata\local\temp\5892\AKSAS 64078 Airport Way Cushman SCD LDP.dwg Feb 25, 2019 - 10:18am

C:\Users\cweiler\appdata\local\temp\AcPublish_5892\AKSAS 64078 Airport Way Cushman SCD LDP.dwg Feb 25, 2019 - 10:18am

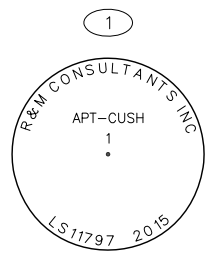

SET 3-1/4" ALUMINUM CAP ON A 2-1/2" X 30" ALUMINUM POST 0.4' BELOW GRADE, MAGNET SET AT BASE OF MON.

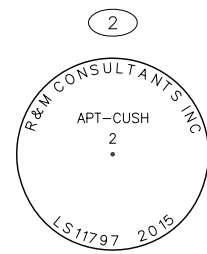

SET 3-1/4" ALUMINUM CAP ON A 2-1/2" X 30" ALUMINUM POST 0.3' BELOW GRADE, MAGNET SET AT BASE OF MON.



SET 2" ALCAP ON 5/8" X 30" REBAR 0.3' BELOW GRADE.



SET 2" ALCAP ON 5/8" X 30" REBAR 0.3' BELOW GRADE.

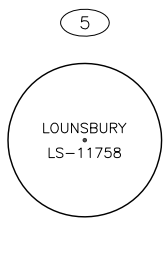

FOUND 1" YELLOW PLASTIC CAP 0.1' BELOW GRADE.

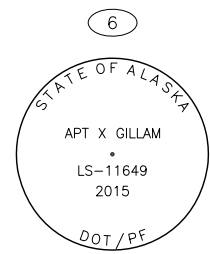

FOUND 3-1/4" ALUMINUM CAP 0.2' BELOW GRADE, ORANGE CARSONITE MAKER BEARS SOUTH 2.2' FROM MONUMENT.

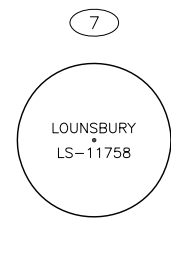

FOUND 1" YELLOW PLASTIC CAP 0.1' BELOW GRADE.

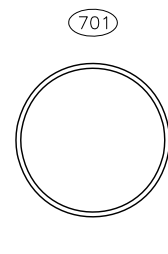

FOUND 2" IRON PIPE FLUSH WITH ASPHALT.

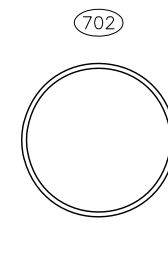

FOUND 2" IRON PIPE INSIDE A MONUMENT CASE, MONUMENT IS 0.5' BELOW RIM OF CASE.

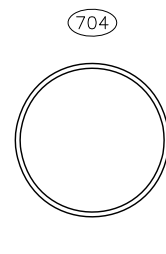

FOUND 2" IRON PIPE INSIDE A MONUMENT CASE, MONUMENT IS 0.2' BELOW RIM OF CASE.

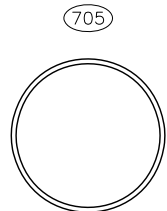

FOUND 2" IRON PIPE INSIDE A MONUMENT CASE, MONUMENT IS 0.6' BELOW RIM OF CASE.

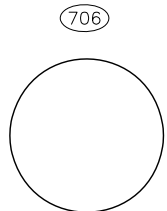

FOUND 2" BRASS CAP INSIDE A MONUMENT CASE, CAP IS 1.1' BELOW RIM, NO LEGIBLE MARKINGS, SIGHTED CENTER OF CAP.

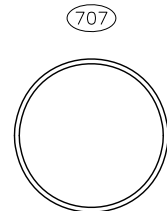

FOUND 2" IRON PIPE INSIDE A MONUMENT CASE, MONUMENT IS 1.0' BELOW RIM OF CASE.

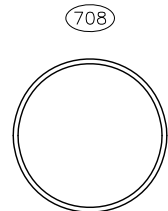

FOUND 2" IRON PIPE FLUSH WITH ASPHALT.

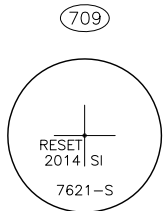

FOUND 2" BRASS CAP INSIDE A MONUMENT CASE, CAP IS 0.5' BELOW RIM.

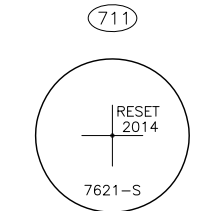

FOUND 2" BRASS CAP INSIDE A MONUMENT CASE, CAP IS 0.4' BELOW RIM.

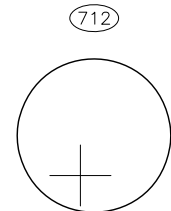

FOUND 2" BRASS CAP INSIDE A MONUMENT CASE, CAP IS 1.1' BELOW RIM.

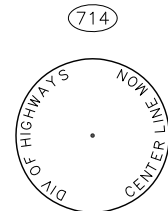

FOUND 2-1/2" BRASS CAP INSIDE A MONUMENT CASE, CAP IS 0.5' BELOW RIM.

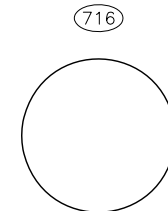

FOUND 1-1/2" ALCAP FLUSH WITH ASPHALT, NO LEGIBLE MARKINGS, SIGHTED CENTER OF CAP.

718



FOUND 5/8" REBAR FLUSH WITH ASPHALT.

719



FOUND 5/8" REBAR FLUSH WITH ASPHALT.

720

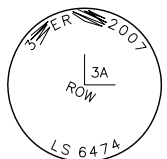

FOUND 1-1/2" ALCAP 0.1' BELOW GRADE.

721



FOUND 5/8" REBAR FLUSH WITH GRADE, BENT NORTHEASTERLY, SIGHTED POINT OF VERTICAL.

722



FOUND 5/8" REBAR 0.2' BELOW GRADE.

723



FOUND 5/8" REBAR FLUSH WITH GRADE.

724



FOUND 5/8" REBAR FLUSH WITH GRADE.

725



FOUND 5/8" REBAR FLUSH WITH GRADE.

726



FOUND 5/8" REBAR 0.1' ABOVE GRADE.

727

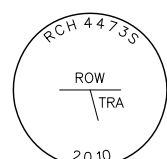

FOUND 1-1/2" ALCAP 0.1' BELOW GRADE.

728

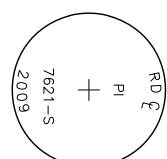

FOUND 3-1/4" ALUMINUM CAP INSIDE A MONUMENT CASE, CAP IS 0.2' BELOW RIM.

729



FOUND 1-1/2" ALCAP FLUSH WITH ASPHALT.

730



FOUND 5/8" REBAR FLUSH WITH GRADE.

731

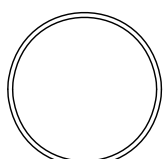

FOUND 1" IRON PIPE 0.5' BELOW GRADE.

732



FOUND 1/2" REBAR FLUSH WITH GRADE.

733

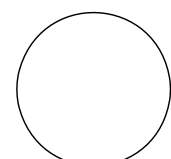

FOUND 1-1/2" ALCAP 0.1' BELOW GRADE, CAP ILLEGIBLE, SIGHTED CENTER OF CAP.

734



FOUND 1/2" REBAR 0.1' ABOVE GRADE, BENT SOUTHERLY, SIGHTED POINT OF VERTICAL.

735



FOUND 1/2" REBAR 0.3' ABOVE GRADE, BENT NORTHERLY, SIGHTED POINT OF VERTICAL.



DATE: FEB 2019

DATE OF SURVEY Beginning: 12/02/2015 Ending: 1/26/2019	NAME AND ADDRESS: Department of Transportation and Public Facilities (DOT&PF) 2301 Peger Road Fairbanks, Alaska 99709		
RECORD OF SURVEY			
PRE-CONSTRUCTION CONTROL DIAGRAM AIRPORT/CUSHMAN INTERSECTION RECONSTRUCTION AKSAS 64078 within SECTION 10 T 1 S, R 1 W FAIRBANKS MERIDIAN, ALASKA FAIRBANKS RECORDING DISTRICT			
DRAWN BY: KJR/JAA	SCALE:	CHECKED BY: CAW	FILE NO.:

C:\Users\cweiler\appdata\local\temp\AcPublish_5892\AKSAS 64078 Airport Way Cushman SCD LDP.dwg Feb 25, 2019 - 10:18am

<p>736</p> <p>FOUND 5/8" REBAR 0.2' BELOW GRADE.</p>	<p>737</p> <p>FOUND 1-1/2" ALCAP 0.3' BELOW GRADE.</p>	<p>738</p> <p>FOUND 5/8" REBAR 0.3' BELOW GRADE.</p>	<p>739</p> <p>FOUND 3-1/4" ALUMINUM CAP IN A MONUMENT CASE, CAP IS 0.5' BELOW RIM.</p>	<p>742</p> <p>FOUND 2-1/2" ALUMINUM CAP INSIDE A MONUMENT CASE, CAP IS 0.7' BELOW RIM.</p>	<p>743</p> <p>FOUND 2-1/2" BRASS CAP IN A MONUMENT CASE, CAP IS 0.5' BELOW RIM, CAP ILLEGIBLE, SIGHTED CENTER OF CAP.</p>	<p>744</p> <p>FOUND 2-1/2" BRASS CAP INSIDE A MONUMENT CASE, CAP IS 0.6' BELOW RIM.</p>	<p>745</p> <p>FOUND 1-1/2" ALCAP ON 5/8" REBAR 0.3' ABOVE GRADE, NO OTHER LEGIBLE MARKINGS.</p>	<p>746</p> <p>FOUND 1-1/2" ALCAP ON 5/8" REBAR 0.3' ABOVE GRADE.</p>	<p>747</p> <p>FOUND 1-3/4" IRON PIPE 0.2' BELOW GRADE.</p>
<p>748</p> <p>FOUND 1-1/2" ALCAP ON 5/8" REBAR 0.4' BELOW GRADE.</p>	<p>749</p> <p>FOUND 1-1/2" IRON PIPE 0.1' BELOW GRADE.</p>	<p>750</p> <p>FOUND 1-1/2" ALCAP 0.1' ABOVE GRADE.</p>	<p>751</p> <p>FOUND 5/8" REBAR FLUSH WITH GRADE.</p>	<p>752</p> <p>FOUND 1-1/2" ALCAP 0.2' BELOW GRADE, CAP ILLEGIBLE, SIGHTED CENTER OF CAP.</p>	<p>753</p> <p>FOUND 1-1/2" ALCAP 0.1' BELOW GRADE, NO OTHER LEGIBLE MARKINGS.</p>	<p>760</p> <p>FOUND 5/8" REBAR 0.4' BELOW GRADE. TOP 0.3' BENT, SIGHTED POINT OF VERTICAL.</p>	<p>761</p> <p>FOUND 5/8" REBAR 0.1' BELOW GRADE. PLUMB.</p>	<p>762</p> <p>FOUND 1-1/2" ALCAP JUST BELOW FLUSH. PLUMB.</p>	<p>763</p> <p>FOUND 1-1/2" ALCAP JUST BELOW FLUSH. PLUMB. NO OTHER MARKINGS LEGIBLE.</p>
<p>764</p> <p>FOUND 5/8" REBAR 0.6' BELOW GRADE. PLUMB.</p>	<p>766</p> <p>FOUND 5/8" REBAR 0.6' BELOW GRADE. SIGHTED POINT OF VERTICAL.</p>	<p>767</p> <p>FOUND 1-1/2" ALCAP 0.1' BELOW GRADE. PLUMB. NO OTHER LEGIBLE MARKINGS.</p>	<p>768</p> <p>FOUND 5/8" REBAR 0.1' BELOW GRADE. PLUMB.</p>	<p>769</p> <p>FOUND 1-1/2" ALCAP 0.2' BELOW GRADE. PLUMB. NO LEGIBLE MARKINGS.</p>	<p>770</p> <p>FOUND 1-1/2" ALCAP 0.1' BELOW GRADE. PLUMB.</p>	<p>771</p> <p>FOUND 1-1/2" ALCAP 0.3' BELOW GRADE. PLUMB.</p>	<p>772</p> <p>FOUND 1-1/2" ALCAP 0.4' BELOW GRADE. PLUMB.</p>	<p>773</p> <p>FOUND 1-1/2" ALCAP 0.2' BELOW GRADE. PLUMB.</p>	



DATE: FEB 2019

<p>DATE OF SURVEY Beginning: 12/02/2015 Ending: 1/26/2019</p>	<p>NAME AND ADDRESS: Department of Transportation and Public Facilities (DOT&PF) 2301 Peger Road Fairbanks, Alaska 99709</p>		
<p>RECORD OF SURVEY</p> <p>PRE-CONSTRUCTION CONTROL DIAGRAM AIRPORT/CUSHMAN INTERSECTION RECONSTRUCTION AKSAS 64078 within SECTION 10 T 1 S, R 1 W FAIRBANKS MERIDIAN, ALASKA FAIRBANKS RECORDING DISTRICT</p>			
<p>DRAWN BY: KJR/JAA</p>	<p>SCALE:</p>	<p>CHECKED BY: CAW</p>	<p>FILE NO.:</p>