

PLAT  
 OF  
**U. S. SURVEY No. 161**  
 OF THE  
**HOMESTEAD CLAIM**  
 OF  
**E. D. MENDELL**

SITUATE

*at the head of Chilkoot Inlet*

**DISTRICT OF ALASKA**

SCALE OF 4.00 CHS. TO INCH  
 VARIATION 30° EAST  
 AREA 17.15 ACRES  
 AS

SURVEYED BY  
**CLINTON GURNEE, JR.**  
 U. S. DEPUTY SURVEYOR

*The original field notes of the survey of the Soldiers' Additional Homestead Claim of E. D. Mendell from which this plat has been made have been examined and approved, and are on file in this office; and I hereby certify that they furnish such an accurate description of said claim as will, if incorporated into a patent, serve fully to identify the premises, and that such reference is made therein to natural objects and permanent monuments as will perpetuate and fix the LOCUS thereof.*  
*And I further certify that this is a correct plat of said claim, made in conformity with said original field notes of the survey thereof. And the same is hereby approved.*

Surveyor General's Office,

Sitka, Alaska, *April 30*, 1900.

*Clinton Gurnee, Jr.*  
 U. S. Deputy Surveyor

**CERTIFICATE OF DEPUTY SURVEYOR**

I, *Clinton Gurnee* U. S. Deputy Surveyor for Alaska, do hereby certify that this is a true and correct plat of a tract of 17.15 acres of land claimed for entry through the exercise of Soldiers' Additional Homestead right by *E. D. Mendell* and in accordance with accompanying field notes of the survey of the same made by me August 12, 1898.

*Clinton Gurnee, Jr.*  
 U. S. Deputy Surveyor.

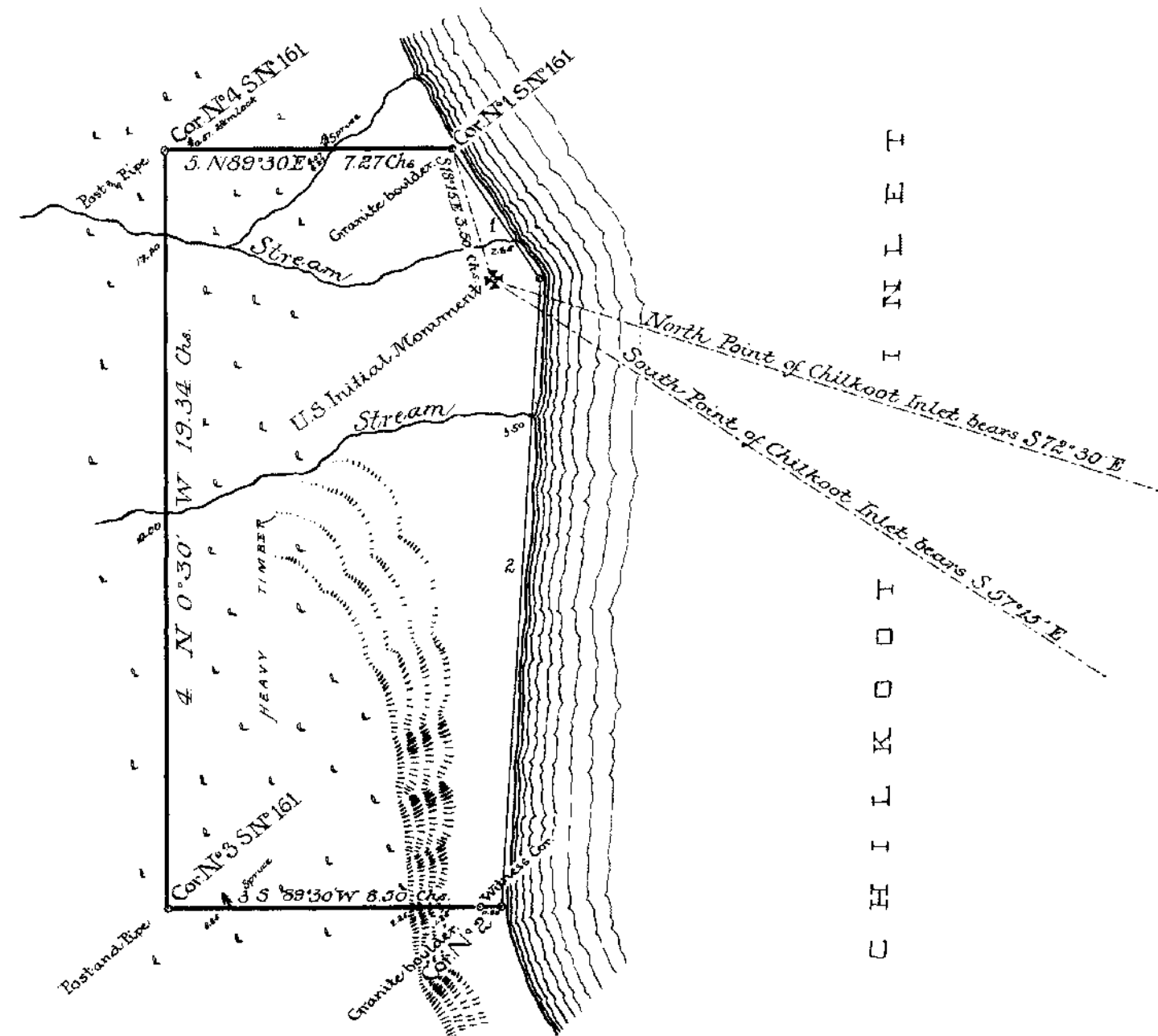

S  
I  
L  
L  
E  
T  
I  
E  
R  
S  
C  
H  
I  
L  
K  
O  
O  
T

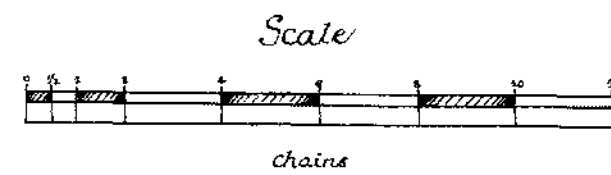
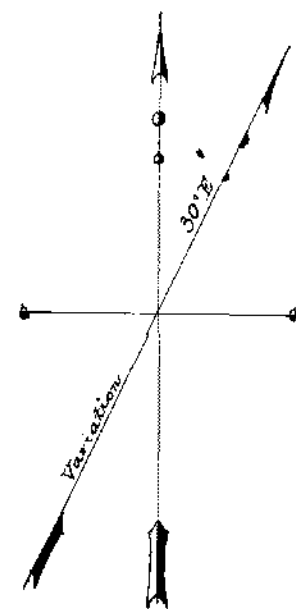

- Meanders
1. S 33° 15' E 400 Chs
  2. S 3° 15' W 16.00 ..

Examined - 0/14

Homestead

278A

S. G. O.

APR 3 1899

ANSWERED

Alaska

FIELD NOTES

of

U. S. SURVEY, NO. 161

of the

Homestead Claim

of

E. D. MENDELL

Situate

at the head of Chilkoot Inlet in the  
DISTRICT of ALASKA

As Surveyed by

C. Anton Gurnee, Jr.

U. S. Deputy Surveyor.

Survey commenced August 12, 1899.

completed " 14, "

## FIELD NOTES of SURVEY, NO. 181.

## Names and Duties of Assistants.

Robert Smith	Chairman
Sam Knudsen	•

Preliminary Oaths of Assistants.

280

We do solemnly swear that we will well and faithfully execute the duties of chain carriers, that we will level the chain upon even and uneven ground, and stretch the lines taut either by sticking or dropping the same, that we will report the true distances to all notable objects, and the true length of our lines that we assist in measuring, to the best of our skill and ability, and in accordance with the instructions given us, in the survey of the tract of public land claimed by E. D. McDonald under the act of May 14, 1898, situate at the head of Chicko or Inlet, in the District of Alaska.

Robert Smith Chairman  
Sam Anderson Chairman

Subscribed and sworn to by the above named persons before me this 12<sup>th</sup> day of August, 1899.

Clinton Sumner Jr.  
U.S. Deputy Surveyor.

## FIELD NOTES of SURVEY, NO. 161.

Survey commenced August 12, 1899, and executed with a Mountain Transit made by J. C. Sala of San Francisco, California, having two verniers reading to  $30''$  of an arc.

Which instrument was tested and adjusted on the true meridian at San Francisco as per certificate No. 73, filed with the Surveyor General for Alaska.

As the weather was continually foggy and overcast, it raining almost every night during my stay in this vicinity, making an observation on the elongation of Polaris impossible, I adopt the variation as found at Chilcat, which is also shown on the Isogonic Chart to be for this point  $30''$  East.

At a point about 12 ft. above high water mark, at head of Chilkoot Inlet, between two streams of water as shown by annexed map, I set a granite boulder 30 x 15 x 10 ins., marked neatly and deeply U. S. I. M. in stone m'd., 4 ft. base and 3 ft. high for U. S. Initial Monument. From which

North Point of Chilkoot Inlet bears S.  $72^{\circ} 30'$  E.  
 South " " " " " " S.  $57^{\circ} 15'$  E.  
 Beginning Cor., No. 1 " " " " N.  $18^{\circ} 15'$  W.

Beginning at a point at ordinary high water mark on Chilkoot Inlet, at which point I set a granite boulder 24 x 14 x 8 ins., marked neatly and deeply on side facing claim, S. No. 161, Cor. No. 1., with 2" iron pipe, same marks, 5 ft. long, 3 ft. in the ground alongside.

Raised mds. of stone, 3 ft. base, 1 1/2 ft. high around monument. Pits impracticable.

U. S. Initial Monument bears S.  $18^{\circ} 15'$  E., 3.50 chs. dist.

Thence along East Ed'y.

Meanders on Chilkoot Inlet at high water mark.

Var.  $30''$  E.

1. S.  $33^{\circ} 15'$  E., 4.00 chs. At 2.85 chs. center of mouth of stream, course from West.
2. S.  $3^{\circ} 15'$  W. 16.00 chs. At 3.50 chs. cross stream





## FIELD NOTES of SURVEY, NO. 161.

## GENERAL DESCRIPTION.

The land embraced in this survey is rolling in character, the western portion being covered with heavy spruce and hemlock timber. The soil is not very thick above the granite bed rock but is very rich being composed of decayed vegetation.

A few Indian summer houses used in the fishing season lie North of this survey about 5 obs. dist.

## EXPLANATIONS.

As there was no commissioner or other person authorized to administer an oath nearer than Skagway, and no transportation thereto, I, as U. S. Deputy Surveyor, administered the necessary oaths to my assistants.

*Clinton Gurnee Jr.*  
U. S. Deputy Surveyor.



**Tabling** of the Final Survey of *U. S. Airways No. 16*

Surveyed by *Clinton Turner Jr.* 1899

No.	COURSE	DIST.	N.	S.	E.	W.	C	C	N.	S.	E.	W.	LAT.	DEP.	D. M. D.	+ AREA	- AREA		
1	S 33 1/2° E.	4.00		3.35	2.19		42			3.35	2.21					16.83	56.3805		
2	S 3 1/2° W.	16.00		15.99		0.91	-			15.99		0.90				18.14	289.6958		
3	S 89 1/2° W.	8.50		.07		8.50	.5			.07		8.45				8.79	.6153		
4	N 1/2° W.	19.34	19.34			.17	-		19.33			.19				.17		328.61	
5	N 89 1/2° E.	19.34	.06						.06							.06			
			19.40	19.39	9.06	9.08	1	19.39	19.39	9.12	9.05							346.6916	3.7247
																346.6916			
																3.7247			
																342.9669			
																17.15	area		

# Final Oath of Assistants

286

We solemnly swear that we assisted Clinton Greenup, Jr., United States  
Deputy Surveyor, under the authority of the act of Congress, passed for a purpose  
marking the corner and surveying the boundaries of the land of public  
land claimed by S. D. McDonald

and act approved May 10, 1898 in the District of Alaska, which tract is  
represented in the foregoing field notes a survey being made by said  
Deputy Surveyor, and under his direction, and that said survey has been in  
accordance with the best of our knowledge and belief, with the maps and  
instructions, and the corner and boundary monuments established  
according to law, and the instructions furnished by the U. S. Surveyor General  
for Alaska.

Robert Smithy  
Sam Knudsen

Chairman  
Chairman

Subscribed and sworn to by the above  
named persons before me, this 14th day  
August, 1898.

Clinton Greenup Jr  
U. S. Deputy Surveyor.

FINAL CERTIFICATE OF U. S. DEPUTY SURVEYOR.

I, Clinton Gurnee Jr., U. S. Deputy Surveyor for Alaska, under Act approved May 14, 1898, do solemnly swear that I have well, faithfully and truly, in my own proper person and in strict conformity with the laws of the United States, the Official Regulations, the Surveying Manual and the instructions thereunder, faithfully and correctly executed the survey of the tract of public land in Alaska claimed by E. D. Mendell situate at the head of Chicook Inlet, Alaska.

that said field notes accurately show, and in a specific manner describe, the boundaries of said tract, as distinctly marked, established and perpetuated by proper monuments on the ground; that the foregoing are the true and original field notes of said survey and my report therein; and that should any fraud be detected, I will suffer the penalty of perjury under the provisions of an Act of Congress, approved August 8, 1846; that the above mentioned survey was made by me on the 12<sup>th</sup> 14<sup>th</sup>

days of August 1899; that said field notes and the plat of said survey thereto attached, are true and correct; and that the said tract of land is not known to contain either coal or the precious metals; that said survey includes no improvements made by or in possession of another, except by a grantee prior to or since the passage of said Act; nor any land to which the natives of Alaska have prior right by virtue of actual occupation; nor any portion of a townsite; nor lands occupied by a missionary station; or reserved, selected or occupied by the United States for any purpose; or the U. S. Commissioner of Fish and Fisheries; or reserved from sale under the provisions of said Act, and that said field notes, as given above, furnish such an accurate description of said surveyed tract as will, if incorporated into a patent, serve fully to identify the premises, and that such references are made therein to natural objects, permanent monuments, and initial points, as will perpetuate and fix the exact identity of the said tract so surveyed. Said survey is used, occupied and possessed under said Act.

And that the said survey does not include more than eighty (80) rods of shore line on any navigable water, and that said tract is not within eighty (80) rods of any tract sold or entered under said Act.

Clinton Gurnee Jr.

U. S. Deputy Surveyor.

Subscribed and sworn to before me, this 12<sup>th</sup> day of March 1900.

Subscribed & sworn to before me this 13<sup>th</sup> day of April 1900

J. J. Renty Wm. L. Austin  
Notary Public in and for the City of San Francisco, State of California, U. S. Surveyor General for Alaska.

U. S. SURVEYOR GENERAL'S CERTIFICATE  
OF APPROVAL.

Office of U. S. Surveyor General.

Sitka, Alaska, *April 30, 1900.*

The foregoing field notes of a survey made by *Clinton Sumner Jr.*, U. S. Deputy Surveyor, of a tract of public land, situate at *Chilkoot Inlet* Alaska, claimed by *E. D. Mendell* for entry under provisions of law, relating to the acquisition of title through *Soldiers' Additional Homestead* - rights, have been examined, the necessary corrections and explanations made, the said field notes and the survey they describe are hereby approved.

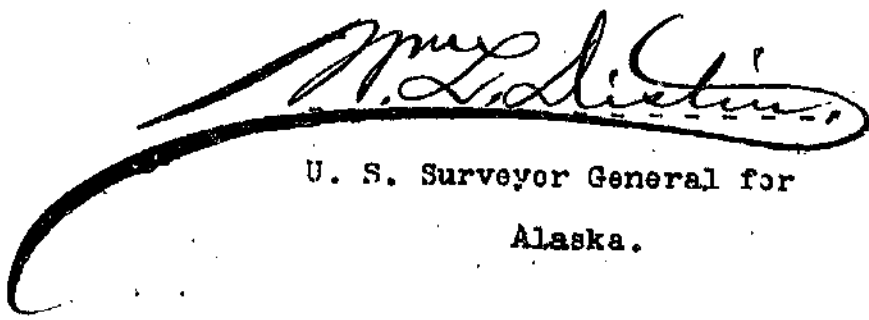
  
U. S. Surveyor General for  
Alaska.