

DATE MARCH 1, 1990

U.S. SURVEY  
 No. 8723, ALASKA  
 COMPRISING 4 LOTS  
 AND  
 THE DEPENDENT RESURVEY OF  
 PORTIONS OF MINERAL SURVEY No. 1102

SITUATED  
 ON THE CRIPPLE RIVER  
 AND NORTON SOUND  
 APPROXIMATELY 11 MILES WESTERLY FROM  
 NOME, ALASKA

THE APPROXIMATE GEOGRAPHIC POSITION OF  
 THE WITNESS CORNER TO CORNER NO. 1, LOT 1

A MEANDER CORNER, IS:  
 LATITUDE: 64°32.4' NORTH NAD 27  
 LONGITUDE: 165°48.2' WEST

AREA: 639.93 ACRES  
 SURVEYED

BY  
 MICHAEL D. WILSON, CADASTRAL SURVEYOR  
 JUNE 7 THROUGH JUNE 15, 1986  
 UNDER SPECIAL INSTRUCTIONS  
 DATED OCTOBER 21, 1985  
 APPROVED NOVEMBER 14, 1985

UNITED STATES DEPARTMENT OF THE INTERIOR  
 BUREAU OF LAND MANAGEMENT  
 Anchorage, Alaska

This plat is strictly conformable to the approved field notes, and the survey, having been correctly executed in accordance with the requirements of law and the regulations of this Bureau, is hereby accepted.

For the Director

*James J. Pankster* FEB. 7, 1990  
 Date  
 Deputy State Director for Cadastral Survey, Alaska

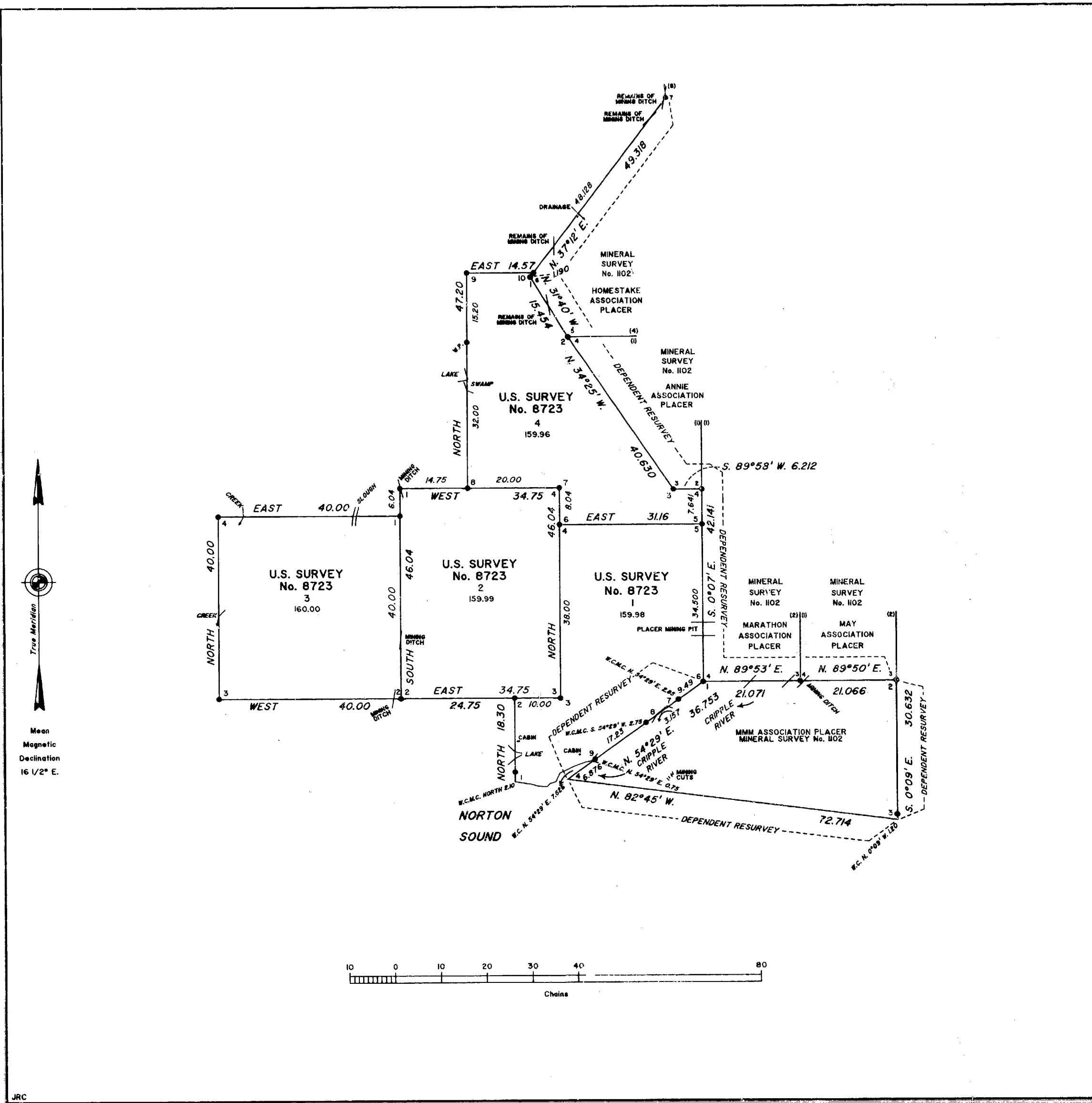

JRC

**ORIGINAL**

UNITED STATES  
DEPARTMENT OF THE INTERIOR  
BUREAU OF LAND MANAGEMENT

**FIELD NOTES**

OF

U.S. SURVEY NO. 8723

COMPRISING 4 LOTS

AND

THE DEPENDENT RESURVEY OF PORTIONS

OF

MINERAL SURVEY NO. 1102

SITUATED

ON THE CRIPPLE RIVER AND NORTON SOUND  
APPROXIMATELY 11 MILES WESTERLY FROM NOME

THE APPROXIMATE GEOGRAPHIC POSITION OF  
THE WITNESS CORNER TO CORNER NO. 1, LOT 1

A MEANDER CORNER, IS:

LATITUDE 64°32.4' NORTH, LONGITUDE 165°48.2' WEST

NAD 27

In the State of ALASKA

EXECUTED BY

Michael D. Wilson, Cadastral Surveyor

Under special instructions dated October 21, 1985, approved November 14, 1985, which provided for the surveys included under U.S. Survey Number 8723, and assignment instructions dated May 19, 1986.

Survey commenced: June 7, 1986Survey completed: June 15, 1986

## U.S. SURVEY NO. 8723, ALASKA

## CHAINS

The following field notes are those of the survey of U.S. Survey No. 8723 and the dependent resurvey of a portion of Mineral Survey No. 1102.

Mineral Survey No. 1102 was surveyed by Arthur G. Blake, U.S. Mineral Surveyor, in 1913.

Township 11 South, Range 36 West, Kateel River Meridian, was surveyed by Maurice P. Oswald and Richard K. DeCamp, under Bureau of Land Management contract in 1975.

This survey was executed in accordance with the specifications set forth in the Manual of Surveying Instructions, 1973, and special instructions dated October 21, 1985.

Preliminary to the resurvey the lines of the original survey were retraced and a search was made for all corners and other calls of the record. Identified corners were remonumented in their original positions; lost corners were restored and monumented at proportionate positions based on the original record. The retracement data were thoroughly verified and only the true line field notes are given herein.

The azimuth was obtained from direct observations of the sun, using the altitude and hour angle methods, and refers to the true meridian.

The approximate geographic position of the witness corner to corner No. 1, Lot 1, a meander corner, as scaled from U.S. Geological Survey quadrangle map "NOME (C-2)", Alaska, 1950 edition, with minor revisions in 1973, is:

Latitude: 64°32.4' North NAD 27  
Longitude: 165°48.2' West

The approximate mean magnetic declination as shown on U.S. Geological Survey quadrangle map "NOME (C-2)", Alaska, 1950 edition, with minor revisions in 1973, is 16 1/2° East.

## INTRODUCTION

Prior to the execution of this survey, the meander line depicted on the 1981 plat of Township 11 South, Range 36 West, Kateel River Meridian, was determined to be substantially the same as the present 1986 mean high tide line in the vicinity of this survey.

DEPENDENT RESURVEY OF PORTIONS OF  
MINERAL SURVEY NO. 1102

Beginning at the point for cor. No. 1, MM Association Placer, identical with cor. No. 4, Marathon Association Placer, Mineral Survey No. 1102, at proportionate dist.; the only remaining evidence of the original cor. was located, disturbed and out of position

Set an alum. post, 30 ins. long, 2 1/2 ins. diam., 28 ins. in the ground, with alum. cap mkd.

DEPENDENT RESURVEY OF PORTIONS OF  
MINERAL SURVEY NO. 1102

CHAINS

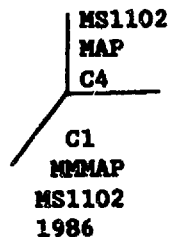

From this point, a fir post, 4 ft. long, 4 ins. sq., with fragments of red paint, was found laying on the ground in a disturbed position, bears S. 45° E., 0.10 chs. dist., mkd. 1-4 1102 MNK and MAR.

Reset the remains of the mkd. fir post alongside the alum. post.

Drive a steel fence post, 6 ft. long, 3 ft. in the ground, N. of the alum. post.

N. 89°53' E., on line 1-2, MMM Association Placer, identical in part with line 4-3, Marathon Association Placer, Mineral Survey No. 1102.

Over level flood plain, through scrub willow and grass.

10.308 Right bank of Cripple River, course SW.

18.645 Left bank of Cripple River; thence asc. gradual NW slope, through scrub willow transitioning to open tundra.

21.071 Cor. No. 4, May Association Placer, identical with cor. No. 3, Marathon Association Placer, Mineral Survey No. 1102, monumented with a fir post, 2 1/2 ft. long, 4 ins. sq., with fragments of red paint, firmly set, broken off flush with the ground, in an earth mound, 3 ft. diam., 1 ft. high, with the remaining portion of the fir post, 2 ft. long, laying alongside, mkd. 4-3 1102 MAR and MAY.

At the corner point

Set an alum. post, 30 ins. long, 2 1/2 ins. diam., 29 ins. in the ground, with alum. cap mkd.

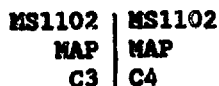

MMAP  
MS1102

1986

Deposit remains of the original mkd. fir post alongside the alum. post.

Drive a steel fence post, 6 ft. long, 3 ft. in the ground, N. of the alum. post.

N. 89°50' E., beginning new measurement on line 1-2, MMM Association Placer, identical in part with line 4-3, May Association Placer, Mineral Survey No. 1102.

Over gently rolling, open tundra.

DEPENDENT RESURVEY OF PORTIONS OF  
MINERAL SURVEY NO. 1102

CHAINS

0.864 Mining ditch, 5 lks. wide, bears NE and SW.

21.066 Cor. No. 2, MMM Association Placer, identical with cor. No. 3, May Association Placer, Mineral Survey No. 1102, monumented with a well-defined earth mound, 3 ft. diam., 1 ft. high, with a hole, 8 ins. deep, 4 ins. sq., in the center of the mound.

At the corner point

Set an alum. post, 30 ins. long, 2 1/2 ins. diam., 29 ins. in the ground, with alum. cap mkd.

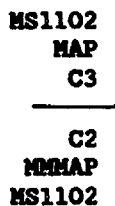

1986

From this point, a deteriorating fir post, 3 1/2 ft. long, 4 ins. sq., was found laying on the ground in a disturbed position, N. 21°36' E., 3.22 chs. dist., mkd. 3-2 1102 MAY and MMM; deposit same post alongside the alum. post.

Drive a steel fence post, 6 ft. long, 3 ft. in the ground, N. of the alum. post.

S. 0°09' E., on line 2-3, MMM Association Placer, Mineral Survey No. 1102.

Over gently rolling, open tundra.

29.432 Point selected for the witness cor. to cor. No. 3, MMM Association Placer, Mineral Survey No. 1102.

Set an alum. post, 30 ins. long, 2 1/2 ins. diam., 29 ins. in the ground, with alum. cap mkd.



1986

Drive a steel fence post, 6 ft. long, 3 ft. in the ground, N. of the alum. post.

30.10 Leave tundra; desc. moderately escarped bank, 10 ft. high, to sand and gravel beach.

30.632 True point for cor. No. 3, MMM Association Placer, Mineral Survey No. 1102, at proportionate dist.; there is no remaining evidence of the original cor.; not monumented due to the liability of destruction by ice and water action.

From the true point, the northern shore of Norton Sound, bears South 1.40 chs. dist., shore bears S. 93° E. and N. 83° W.

DEPENDENT RESURVEY OF PORTIONS OF  
MINERAL SURVEY NO. 1102

CHAINS	<p>N. 82°45' W., on line 3-4, MMM Association Placer, Mineral Survey No. 1102.</p> <p>Over beach, near an escarped bank, 10 to 15 ft. high.</p> <p>61.644 From this point, the following original improvements</p> <p>The northwesterly end of a cut, 38 ft. long, 4 ft. deep, bears N. 76°28' E., 12.40 chs. dist., long side extending S. 20° E.</p> <p>The northwesterly end of a cut, 23 ft. long, 4 ft. deep, bears N. 77°58' E., 11.93 chs. dist., long side extending S. 55° E.</p> <p>The northwesterly end of a cut, 25 ft. long, 4 ft. deep, bears N. 79°22' E., 11.55 chs. dist., long side extending S. 45° E.</p> <p>The northwesterly end of a cut, 24 ft. long, 4 ft. deep, bears N. 80°22' E., 11.31 chs. dist., long side extending S. 45° E.</p> <p>The northwesterly end of a cut, 44 ft. long, 4 ft. deep, bears N. 81°57' E., 10.92 chs. dist., long side extending S. 45° E.</p> <p>72.00 Left bank of Cripple River, bears NW and SW, course SW.</p> <p>72.714 True point for cor. No. 4, MMM Association Placer, Mineral Survey No. 1102, at proportionate dist.; there is no remaining evidence of the original cor.; falls in Cripple River, not monumented.</p> <hr/> <p>N. 54°29' E., on line 4-1, MMM Association Placer, Mineral Survey No. 1102.</p> <p>(Over Cripple River.</p> <p>6.876 Right bank of Cripple River, bears S. 70°34' E. and N. 70°34' W.; thence over level ground, through grass.</p> <p>7.626 Point selected for the witness cor. to cor. No. 4, MMM Association Placer, Mineral Survey No. 1102.</p> <p>Set an alum. post, 30 ins. long, 2 1/2 ins. diam., flush with the ground, with alum. cap mkd.</p> <div style="text-align: center;"> <p>WC MS1102 MMMAP CA</p> <p>1986</p> </div> <p>Drive a steel fence post, 6 ft. long, 3 ft. in the ground, W. of the alum. post.</p> <p>15.65 Enter scrub willow, edge bears SE and NW.</p> <p>24.106 Right bank of Cripple River, bears N. 49°49' E. and S. 50° W.; continue along the right bank.</p> <p>27.263 Leave right bank of Cripple River, bears S. 71°45' E. and N. 71°45' W.; thence enter scattered scrub willow, 6 ft. high.</p>
--------	--

DEPENDENT RESURVEY OF PORTIONS OF  
MINERAL SURVEY NO. 1102

CHAINS													
36.753	<p>Cor. No. 1, MMM Association Placer, identical with cor. No. 4, Marathon Association Placer; heretofore described.</p> <hr/> <p>From cor. No. 2, Annie Association Placer, on line 4-1, Marathon Association Placer, Mineral Survey No. 1102, monumented with a well-defined earth and rock mound, 2 ft. diam., 8 ins. high, with a hole, 8 ins. deep, 4 ins. sq., in the center of the mound.</p> <p>At the corner point</p> <p>Set an alum. post, 30 ins. long, 2 1/2 ins. diam., 29 ins. in the ground, with alum. cap mkd.</p> <div style="text-align: center;"> <table border="0"> <tr> <td>MS1102</td> <td> </td> <td></td> </tr> <tr> <td>AAP</td> <td> </td> <td></td> </tr> <tr> <td>C2</td> <td> </td> <td>HAP</td> </tr> <tr> <td colspan="2">-----</td> <td>MS1102</td> </tr> </table> <p>1986</p> </div> <p>From this point, a fir post, 4 ft. long, 4 ins. sq., with fragments of red paint, was found laying on the ground in a disturbed position, N. 43°11' E., 0.26 ch. dist., mkd. 2 1102 and ANNIE; deposit the mkd. fir post alongside the alum. post.</p> <p>Drive a steel fence post, 6 ft. long, 3 ft. in the ground, N. of the alum. post.</p> <p>S. 0°07' E., on a portion of line 1-4, Marathon Association Placer, Mineral Survey No. 1102.</p> <p>Ascend gradual NE slope, over open tundra.</p> <p>6.00 Begin level ground.</p> <p>29.180 Northern edge of placer mining pit, 10 ft. deep, edge bears E and W.</p> <p>32.212 Southern edge of same pit, edge bears E and W; thence desc. gradual SE slope to flood plain, vegetated in scattered scrub willow.</p> <p>42.141 Cor. No. 4, Marathon Association Placer, identical with cor. No. 1, MMM Association Placer, Mineral Survey No. 1102; heretofore described.</p> <hr/> <p>From cor. No. 2, Annie Association Placer, on line 4-1, Marathon Association Placer, Mineral Survey No. 1102; heretofore described.</p> <p>S. 89°58' W., on line 2-3, Annie Association Placer, Mineral Survey No. 1102.</p> <p>Ascend gradual NE slope, over open tundra.</p> <p>6.212 Cor. No. 3, Annie Association Placer, Mineral Survey No. 1102, monumented with a fir post, 4 ft. long, 4 ins. sq., with fragments of red paint, loosely set, extending 2 1/2 ft. above the ground, in an earth and stone mound, 3 ft. diam., 8 ins. high, mkd. 3 1102 ANNIE.</p> <p>At the corner point</p>	MS1102			AAP			C2		HAP	-----		MS1102
MS1102													
AAP													
C2		HAP											
-----		MS1102											

DEPENDENT RESURVEY OF PORTIONS OF  
MINERAL SURVEY NO. 1102

CHAINS

Set an alum. post, 30 ins. long, 2 1/2 ins. diam., 29 ins. in the ground, with alum. cap mkd.

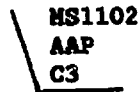

1986

Deposit the mkd. fir post alongside the alum. post.

Drive a steel fence post, 6 ft. long, 3 ft. in the ground, N. of the alum. post.

N. 34°25' W., on line 3-4, Annie Association Placer, Mineral Survey No. 1102.

Across a gradual NE slope, over open tundra.

40.630

Cor. No. 4, Annie Association Placer, identical with cor. No. 5, Homestake Association Placer, Mineral Survey No. 1102, monumented with a fir post, 4 ft. long, 4 ins. sq., with fragments of red paint, loosely set, extending 2 1/2 ft. above the ground, in an earth mound, 3 ft. diam., 1 ft. high, mkd. 4 5 1102 and in part H.

At the corner point

Set an alum. post, 30 ins. long, 2 1/2 ins. diam., 29 ins. in the ground, with alum. cap mkd.

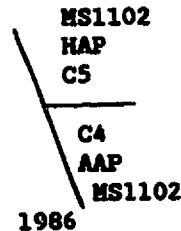

1986

Deposit the mkd. fir post alongside the alum. post.

Drive a steel fence post, 6 ft. long, 3 ft. in the ground, N. of the alum. post.

From cor. No. 5, Homestake Association Placer, identical with cor. No. 4, Annie Association Placer, Mineral Survey No. 1102; heretofore described.

N. 31°40' W., on line 5-6, Homestake Association Placer, Mineral Survey No. 1102.

Ascend gradual NE slope, over open tundra.

7.970

Remains of a mining ditch, 10 lks. wide, bears S. 10° E. and N. 10° W.

15.454

Cor. No. 6, Homestake Association Placer, Mineral Survey No. 1102, monumented with a well-defined earth and rock mound, 4 ft. diam., 1 ft. high, with a hole, 8 ins. deep, 4 ins. sq., in the center of the mound, with various pieces of wood, not of record, in the mound, firmly set, not mkd.

At the corner point



7  
334

DEPENDENT RESURVEY OF PORTIONS OF  
MINERAL SURVEY NO. 1102

CHAINS

Set an alum. post, 30 ins. long, 2 1/2 ins. diam., 29 ins. in the ground, with alum. cap mkd.

MS1102  
HAP  
C6

1986

From this point, a fir post 4 ft. long, 4 ins. sq., was found layin. on the ground in a disturbed position, bears N. 71°30' W., 0.36 chs. dist., mkd. faintly 6 1102 H; deposit same alongside the alum. post.

Drive a steel fence post, 6 ft. long, 3 ft. in the ground, N. of the alum. post.

N. 37°12' E., on line 6-7, Homestake Association Placer, Mineral Survey No. 1102.

Across rolling SE slope, over open tundra.

- 7.333 Remains of a mining ditch, 12 lks. wide, bears North and South.
- 16.288 Drainage, drains SE.
- 42.348 Remains of a mining ditch, 12 lks. wide, bears NE and SW.
- 47.576 Remains of same mining ditch, 12 lks. wide, bears N. 10° E. and S. 10° W.
- 49.318 Cor. No. 7, Homestake Association Placer, Mineral Survey No. 1102, monumented with a schist stone, 32 x 8 x 7 ins., firmly set, extending 4 in. above the ground, mkd. 7 1102 H and with an X on top.

At the corner point

Set an alum. post, 30 ins. long, 2 1/2 ins. diam., 29 ins. in the ground, with alum. cap mkd.

MS1102  
HAP  
C7

1986

Deposit the mkd. stone alongside the alum. post.

Drive a steel fence post, 6 ft. long, 3 ft. in the ground, N. of the alum. post.

LOT 1, U.S. SURVEY NO. 8723, ALASKA

Beginning at the true point for cor. No. 1, Lot 1, a meander cor., on the northerly shore of Norton Sound; not monumented due to the liability of destruction by ice and water action.

## LOT 1, U.S. SURVEY NO. 8723, ALASKA

## CHAINS

From the true point, the BLM location marker, a wood post, 8 ins. diam., firmly set, extending 5 ft. above the ground, bears N. 35°33' E., 4.06 chs. dist., with alum. tag mkd. MIKE WILLOYA F-15017.

North, on line 1-2, Lot 1, marking the true line.

Over level gravel and sand beach, with scattered beach grass.

2.10 Point selected for the witness cor. to cor. No. 1, Lot 1, a meander cor.

Set an alum. post, 30 ins. long, 2 1/2 ins. diam., 6 ins. below the ground surface, with alum. cap mkd.

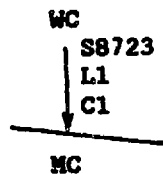

1986

Deposit a magnet at base of alum. post.

Drive a steel fence post, 6 ft. long, 3 ft. in the ground, N. of the alum. post.

From the witness cor., the following improvements:

The NE cor. of a frame cabin, 12 x 32 ft., bears N. 8°11' E., 6.77 chs. dist., long side extends S. 80° W.

The NW cor. of a frame cabin, 12 x 16 ft., bears N. 75°14' E., 14.50 chs. dist., long side extends East.

5.05 Southern edge of small lake, bears N. 60° E. and S. 50° W.

6.50 Northern edge of same lake, bears S. 80° E. and N. 45° W.; thence over level grassland.

7.00 Base of S slope; asc. 15 ft. over grass and tundra.

8.80 Top of slope; thence over level tundra.

10.00 Across E side of draw, draining S. 10° E., through scattered scrub willow.

18.30 Point for cor. No. 2, Lot 1, on line 2-3, Lot 2.

Set an alum. post, 30 ins. long, 2 1/2 ins. diam., 27 ins. in the ground, with alum. cap mkd.

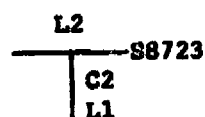

1986

Drive a steel fence post, 6 ft. long, 3 ft. in the ground, N. of the alum. post.

## LOT 1, U.S. SURVEY NO. 8723, ALASKA

CHAINS																					
<p>1.00</p> <p>10.00</p>	<p>East, on line 2-3, Lot 1, identical with a portion of line 2-3, Lot 2.</p> <p>Ascend gradual W slope, over tundra, with scattered scrub willow.</p> <p>Top of ascent; thence over level, open tundra.</p> <p>Point for cor. No. 3, Lot 1, identical with cor. No. 3, Lot 2.</p> <p>Set an alum. post, 30 ins. long, 2 1/2 ins. diam., 28 ins. in the ground, with alum. cap mkd.</p> <div style="text-align: center;"> <p>S8723</p> <table border="0"> <tr><td>L2</td><td> </td><td></td></tr> <tr><td>C3</td><td> </td><td></td></tr> <tr><td colspan="3"><hr/></td></tr> <tr><td></td><td> </td><td>C3</td></tr> <tr><td></td><td> </td><td>L1</td></tr> </table> <p>1986</p> </div> <p>Drive a steel fence post, 6 ft. long, 3 ft. in the ground, W. of the alum. post.</p>	L2			C3			<hr/>					C3			L1					
L2																					
C3																					
<hr/>																					
		C3																			
		L1																			
<p>38.00</p>	<p>North, on line 3-4, Lot 1, identical with a portion of line 3-4, Lot 2.</p> <p>Over level, open tundra.</p> <p>Point for cor. No. 4, Lot 1, identical with cor. No. 6, Lot 4.</p> <p>Drive an alum. rod, 9 ft. long, 3/4 in. diam., 8.7 ft. in the ground, with alum. cap mkd.</p> <div style="text-align: center;"> <p>S8723</p> <table border="0"> <tr><td></td><td> </td><td>L4</td></tr> <tr><td></td><td> </td><td>C6</td></tr> <tr><td>L2</td><td> </td><td><hr/></td></tr> <tr><td></td><td> </td><td>C4</td></tr> <tr><td></td><td> </td><td>L1</td></tr> </table> <p>1986</p> </div> <p>Drive a steel fence post, 8 ft. long, 3 ft. in the ground, W. of the alum. rod.</p>			L4			C6	L2		<hr/>			C4			L1					
		L4																			
		C6																			
L2		<hr/>																			
		C4																			
		L1																			
<p>31.00</p>	<p>East, on line 4-5, Lot 1, identical with line 6-5, Lot 4.</p> <p>Over level, open tundra.</p> <p>Point for cor. No. 5, Lot 1, identical with cor. No. 5, Lot 4, on line 1-4, Marathon Association Placer, Mineral Survey No. 1102.</p> <p>Set an alum. post, 30 ins. long, 2 1/2 ins. diam., 29 ins. in the ground, with alum. cap mkd.</p> <div style="text-align: center;"> <table border="0"> <tr><td></td><td> </td><td>L4</td><td></td></tr> <tr><td></td><td> </td><td>C5</td><td>MS1102</td></tr> <tr><td>S8723</td><td> </td><td><hr/></td><td>MAP</td></tr> <tr><td></td><td> </td><td>C5</td><td></td></tr> <tr><td></td><td> </td><td>L1</td><td></td></tr> </table> <p>1986</p> </div>			L4				C5	MS1102	S8723		<hr/>	MAP			C5				L1	
		L4																			
		C5	MS1102																		
S8723		<hr/>	MAP																		
		C5																			
		L1																			

LOT 1, U.S. SURVEY NO. 8723, ALASKA

CHAINS

Drive a steel fence post, 6 ft. long, 3 ft. in the ground, alongside the alum. post.

S. 0°07' E., on line 5-6, Lot 1, identical with a portion of line 1-4, Marathon Association Placer, Mineral Survey No. 1102; heretofore described.

34.500 Point for cor. No. 6, Lot 1, identical with cor. No. 1, MMM Association Placer, and cor. No. 4, Marathon Association Placer, Mineral Survey No. 1102; heretofore described.

Add marks to alum. cap to read

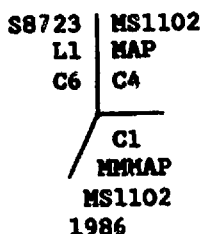

S. 54°29' W., on line 6-7, Lot 1, identical with a portion of line 1-4, MMM Association Placer, Mineral Survey No. 1102; heretofore described.

6.64 Point selected for the witness cor. to cor. No. 7, Lot 1, a meander cor.

Set an alum. post, 30 ins. long, 2 1/2 ins. diam., 27 ins. in the ground, with alum. cap mkd.

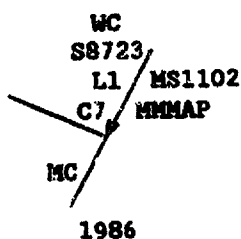

Drive a steel fence post, 6 ft. long, 3 ft. in the ground, N. of the alum. post.

9.49 True point for cor. No. 7, Lot 1, a meander cor., on the right bank of the Cripple River; not monumented due to the liability of destruction by ice and water action.

Thence downstream with the meanders of the right bank of the Cripple River, along a well-defined bank, 2 to 4 ft. high.

N. 71°45' W., 0.30 chs.  
S 49°49' W., 2.99 chs.

At end of course, true point for cor. No. 8, Lot 1, a meander cor. on line 1-4, MMM Association Placer, Mineral Survey No. 1102; not monumented due to the liability of destruction by ice and water action.

## LOT 1, U.S. SURVEY NO. 8723, ALASKA

## CHAINS

S. 43°41' W., 0.96 chs.

At end of course, confluence of the Cripple River with Norton Sound; thence westerly along the northern shore of Norton Sound, along a gradually sloping sand and gravel beach, approximately 3 chs. wide.

N. 85°51' W., 1.95 chs.

N. 74°02' W., 1.50 chs.

N. 80°49' W., 3.50 chs.

At end of course, true point for cor. No. 1, Lot 1, a meander cor., and point of beginning.

## LOT 2

Beginning at the point for cor. No. 1, Lot 2.

Set an alum. post, 30 ins. long, 2 1/2 ins. diam., 28 ins. in the ground, with alum. cap mkd.

C1
L2
S8723

1986

Drive a steel fence post, 6 ft. long, 3 ft. in the ground, N. of the alum. post.

From this point, a scrub willow bush, 5 ft. high, bears S. 15°44' E., 10.43 chs. dist., with fragments of survey ribbon and a fragment of BLM alum. tag attached, with no marks.

South, on line 1-2, Lot 2, identical in part with line 1-2, Lot 3.

Over generally level tundra.

6.04 Cor. No. 1, Lot 3; hereinafter described.

33.20 Mining ditch, 80 lks. wide, bears N. 5° E. and S. 5° W.

46.04 Point for cor. No. 2, Lot 2, identical with cor. No. 2, Lot 3.

Set an alum. post, 30 ins. long, 2 1/2 ins. diam., 29 ins. in the ground, with alum. cap mkd.

S8723
L3   L2
C2   C2

1986

Drive a steel fence post, 6 ft. long, 3 ft. in the ground, N. of the alum. post.

East, on line 2-3, Lot 2, identical in part with line 2-3, Lot 1; heretofore described.

LOT 1, U.S. SURVEY NO. 8723, ALASKA

CHAINS

S. 54°29' W., on line 8-9, Lot 1, identical with a portion of line 1-4, MMM Association Placer, Mineral Survey No. 1102; heretofore described.

2.75 Point selected for the witness cor. to cor. No. 8, Lot 1, a meander cor.

Set an alum. post, 30 ins. long, 2 1/2 ins. diam., flush with the ground, with alum. cap mkd.

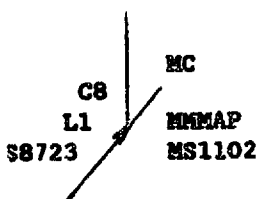

1986

Drive a steel fence post, 6 ft. long, 3 ft. in the ground, N. of the alum. post.

16.42 Point selected for the witness cor. to cor. No. 9, Lot 1, a meander cor., identical with the witness cor. to cor. No. 4, MMM Association Placer, Mineral Survey No. 1102; heretofore described.

Add marks to alum. cap to read

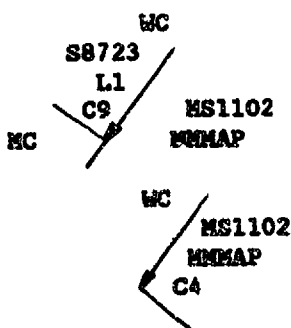

1986

17.23 True point for cor. No. 9, Lot 1, a meander cor., on the right bank of the Cripple River; not monumented due to the liability of destruction by ice and water action.

From the true point, cor. No. 4, MMM Association Placer, Mineral Survey No. 1102, bears S. 54°20' W., 6.876 chs. dist.; falls in Cripple River, not monumented.

Thence downstream with the meanders of the right bank of the Cripple River, along a well-defined bank, 2 to 4 ft. high.

N. 70°34' W., 0.23 chs. At end of course, slough, 10 lks. wide, course S. 40° W.

S. 80°01' W., 1.41 chs.  
S. 69°31' W., 2.69 chs.  
S. 65°00' W., 2.34 chs.  
S. 26°00' W., 2.14 chs.  
S. 72°41' W., 1.37 chs.

## LOT 2, U.S. SURVEY NO. 8723, ALASKA

## CHAINS

Over generally level tundra.

22.25 Descend gradual E slope.

23.50 Bottom of draw, drains S. 10° E.; thence asc. moderate W slope.

24.75 Cor. No. 2, Lot 1; heretofore described.

34.75 Cor. No. 3, Lot 2, identical with cor. No. 3, Lot 1; heretofore described.

North on line 3-4, Lot 2, identical in part with both line 3-4, Lot 1 and line 6-7, Lot 4; the former of which is heretofore described.

38.00 Cor. No. 4, Lot 1, identical with cor. No. 6, Lot 4; heretofore described.

Over generally level tundra.

46.04 Point for cor. No. 4, Lot 2, identical with cor. No. 7, Lot 4.

Set an alum. post, 30 ins. long, 2 1/2 ins. diam., 27 ins. in the ground, with alum. cap mkd.

```

      L4
      C7
  C4 |
  L2 |
      S8723
  
```

1986

Drive a steel fence post, 6 ft. long, 3 ft. in the ground, N. of the alum. post.

West, on line 4-1, Lot 2, identical in part with line 7-8, Lot 4.

Over generally level, open tundra.

20.00 Cor. No. 8, Lot 4, hereinafter described.

33.60 Mining ditch, 50 lks. wide, bears S. 15° E. and N. 15° W.

34.75 Cor. No. 1, Lot 2, and point of beginning.

## LOT 3

Beginning at the point for cor. No. 1, Lot 3, on line 1-2, Lot 2.

Set an alum. post, 30 ins. long, 2 1/2 ins. diam., 29 ins. in the ground, with alum. cap mkd.

```

  ———— L2
      C1
      L3
      S8723
  
```

1986

## LOT 3, U.S. SURVEY NO. 8723, ALASKA

CHAINS	
	<p>Drive a steel fence post, 6 ft. long, 3 ft. in the ground, N. of the alum. post.</p> <p>South, on line 1-2, Lot 3, identical with a portion of line 1-2, Lot 2; heretofore described.</p> <p>40.00 Point for cor. No. 2, Lot 3, identical with cor. No. 2, Lot 2; heretofore described.</p>
	<p>West, on line 2-3, Lot 3.</p> <p>Descend gradual SW slope, over open tundra.</p> <p>1.65 Mining ditch, 80 lks. wide, bears N. 10° E. and S. 10° W.</p> <p>40.00 Point for cor. No. 3, Lot 3.</p> <p>Set an alum. post, 30 ins. long, 2 1/2 ins. diam., 27 ins. in the ground, with alum. cap mkd.</p> <div data-bbox="843 1127 931 1213" style="border: 1px solid black; padding: 2px; margin: 10px auto;">       S8723 L3 C3     </div> <p style="text-align: center;">1986</p> <p>Drive a steel fence post, 6 ft. long, 3 ft. in the ground, N. of the alum. post.</p>
	<p>North, on line 3-4, Lot 3.</p> <p>Ascend gradual S slope, over open tundra.</p> <p>18.15 Creek, 10 lks. wide, course S. 10° W. from N. 45° E., in a draw, 5 chs. wide.</p> <p>40.00 Point for cor. No. 4, Lot 3.</p> <p>Set an alum. post, 30 ins. long, 2 1/2 ins. diam., 28 ins. in the ground, with alum. cap mkd.</p> <div data-bbox="855 1830 943 1924" style="border: 1px solid black; padding: 2px; margin: 10px auto;">       C4 L3 S8723     </div> <p style="text-align: center;">1986</p> <p>Drive a steel fence post, 6 ft. long, 3 ft. in the ground, N. of the alum. post.</p>
	<p>East, on line 4-1, Lot 3.</p> <p>Over generally level tundra.</p> <p>5.60 Creek, 10 lks. wide, course S. 30° W. from N. 5° W., in a draw, approximately 5 chs. wide.</p> <p>29.65 Western edge of slough, bears N. 15° E. and S. 5° W., flow indeterminate.</p> <p>30.35 Eastern edge of same slough, bears N. 15° E. and S. 5° W.</p>



## LOT 3, U.S. SURVEY NO. 8723, ALASKA

## CHAINS

40.00

Cor. No. 1, Lot 3, on line 1-2, Lot 2, and point of beginning.

## LOT 4

Beginning at the point for cor. No. 1, Lot 4, identical with cor. No. 6, Homestake Association Placer, Mineral Survey No. 1102; heretofore described.

Add marks to alum. cap to read

```

S8723 / MS1102
  L4 / HAP
  C1 / C6
      \
      1986
  
```

S. 31°40' E., on line 1-2, Lot 4, identical with line 6-5, Homestake Association Placer, Mineral Survey No. 1102; heretofore described.

15.454

Point for cor. No. 2, Lot 4, identical with cor. No. 4, Annie Association Placer and cor. No. 5, Homestake Association Placer, Mineral Survey No. 1102; heretofore described.

Add marks to alum. cap to read

```

      MS1102
      HAP
      C5
C2 /-----/
  L4 / C4
S8723 / AAP
      MS1102
      1986
  
```

S. 34°25' E., on line 2-3, Lot 4, identical with line 4-3, Annie Association Placer, Mineral Survey No. 1102; heretofore described.

40.630

Point for cor. No. 3, Lot 4, identical with cor. No. 3, Annie Association Placer, Mineral Survey No. 1102; heretofore described.

Add marks to alum. cap to read

```

      MS1102
      AAP
      C3
      /-----/
      C3
      L4
      S8723
      1986
  
```

N. 89°58' E., on line 3-4, Lot 4, identical with line 3-2, Annie Association Placer, Mineral Survey No. 1102; heretofore described.

## LOT 4, U.S. SURVEY NO. 8723, ALASKA

## CHAINS

6.212 Point for cor. No. 4, Lot 4, identical with cor. No. 2, Annie Association Placer, on line 1-4, Marathon Association Placer, Mineral Survey No. 1102; heretofore described.

Add marks to alum. cap to read

MS1102	
AAP	
C2	MAP
C4	MS1102
L4	
S8723	
	1986

S. 0°07' E., on line 4-5, Lot 4, identical in part with line 1-4, Marathon Association Placer, Mineral Survey No. 1102; heretofore described.

7.641 Point for cor. No. 5, Lot 4, identical with cor. No. 5, Lot 1; heretofore described.

West, on line 5-6, Lot 4, identical with line 5-4, Lot 1; heretofore described.

31.16 Point for cor. No. 6, Lot 4, identical with cor. No. 4, Lot 1, on line 3-4, Lot 2; heretofore described.

North, on line 6-7, Lot 4, identical with a portion of line 3-4, Lot 2; heretofore described.

8.04 Point for cor. No. 7, Lot 4, identical with cor. No. 4, Lot 2; heretofore described.

West, on line 7-8, Lot 4, identical with a portion of line 4-1, Lot 2; heretofore described.

20.00 Point for cor. No. 8, Lot 4.

Set an alum. post, 30 ins. long, 2 1/2 ins. diam., 27 ins. in the ground, with alum. cap mkd.

L4	
C8	
	S8723
L2	
	1986

Drive a steel fence post, 6 ft. long, 3 ft. in the ground, N. of the alum. post.

North, on line 8-9, Lot 4.

Over generally level, open tundra.

21.30 Enter swamp, edge bears S. 70° E. and N. 20° W.

23.65 Leave swamp; southern edge of lake, bears N. 30° E. and S. 30° W.

344

## LOT 4, U.S. SURVEY NO. 8723, ALASKA

CHAINS	
24.25	Northern edge of lake, bears S. 25° E. and N. 15° W.; thence over level, open tundra.
32.00	<p>Point selected for a witness point.</p> <p>Set an alum. post, 30 ins. long, 2 1/2 ins. diam., 28 ins. in the ground, with alum. cap mkd.</p> <div style="text-align: center;"> <p>WP</p> <p> </p> <p>S8723</p> <p>L4</p> <p>1986</p> </div>
47.20	<p>Point for cor. No. 9, Lot 4.</p> <p>Set an alum. post, 30 ins. long, 2 1/2 ins. diam., 27 ins. in the ground, with alum. cap mkd.</p> <div style="text-align: center;"> <p>C9</p> <p>L4</p> <p>S8723</p> <p>1986</p> </div>
14.57	<p>East, on line 9-10, Lot 4.</p> <p>Over level, open tundra.</p> <p>Point for cor. No. 10, Lot 4, on line 6-7, Homestake Association Placer, Mineral Survey No. 1102.</p> <p>Set an alum. post, 30 ins. long, 2 1/2 ins. diam., 29 ins. in the ground, with alum. cap mkd.</p> <div style="text-align: center;"> <p>C10 / HAP</p> <p>L4 / MS1102</p> <p>S8723 /</p> <p>1986</p> </div> <p>Drive a steel fence post, 6 ft. long, 3 ft. in the ground, N. of the alum. post.</p> <p>From this point, cor. No. 7, Homestake Association Placer, Mineral Survey No. 1102, bears N. 37°12' E., 48.128 chs. dist.; heretofore described.</p>
1.190	<p>S. 37°12' W., on line 10-1, Lot 4, identical with a portion of line 7-6, Homestake Association Placer, Mineral Survey No. 1102; heretofore described.</p> <p>Cor. No. 1, Lot 4, identical with cor. No. 6, Homestake Association Placer, Mineral Survey No. 1102, and point of beginning.</p>

## U.S. SURVEY NO. 8723, ALASKA

CHAINS

## GENERAL DESCRIPTION

U.S. Survey No. 8723, comprising 4 lots, is situated on the Cripple River and Norton Sound, approximately 11 miles westerly from Nome, Alaska.

All of the lots of this survey are contiguous. The 4 lots are also contiguous with the MMM, Marathon, Annie and Homestake Association Placer claims, Mineral Survey No. 1102.

The land is generally level, open tundra. No timber. A limited number of draws, creeks and ditches drain the land into the Cripple River and Norton Sound. The Cripple River is tidally influenced in the portions which intersect this survey. Also Norton Sound is tidally influenced.

No active mining operations were observed. Evidence of past placer mining and mining ditches were noticed.

No agricultural activity was noted.

UNITED STATES  
DEPARTMENT OF THE INTERIOR  
BUREAU OF LAND MANAGEMENT

FIELD ASSISTANT

NAME	/	CAPACITY
Norman H. Frank	/	Surveying Technician

U.S. DEPARTMENT OF THE INTERIOR  
BUREAU OF LAND MANAGEMENT  
ALASKA STATE OFFICE - ANCHORAGE, ALASKA

CERTIFICATE OF SURVEY

I, Michael D. Wilson, Cadastral Surveyor, HEREBY CERTIFY upon honor that, in pursuance of special instructions bearing date of the 21st day of October, 1985, I have surveyed U.S. Survey No. 8723, comprising 4 lots, and dependently resurveyed portions of Mineral Survey No. 1102, situated on the Cripple River and Norton Sound, approximately 11 miles westerly from Nome, in the State of Alaska, which are represented in the foregoing field notes as having been executed by me and under my direction; and that said survey has been made in strict conformity with said special instructions, the Manual of Instructions for the Survey of the Public Lands of the United States, and in the specific manner described in the foregoing field notes.

27 SEPTEMBER 1989  
(Date)

Michael D. Wilson  
(Cadastral Surveyor)

CERTIFICATE OF APPROVAL

Bureau of Land Management  
Anchorage, Alaska

The foregoing field notes of the survey described in the Certificate of Survey above executed by Michael D. Wilson, Cadastral Surveyor, having been critically examined and found correct, are hereby approved.

FEBRUARY 7, 1990  
(Date)

Jerry L. Pinkerton  
(Deputy State Director for  
Cadastral Survey, Alaska)