

# SURVEYED TOWNSHIP 9 SOUTH RANGE 36 WEST OF THE KATEEL RIVER

R 36 W | R 35 W

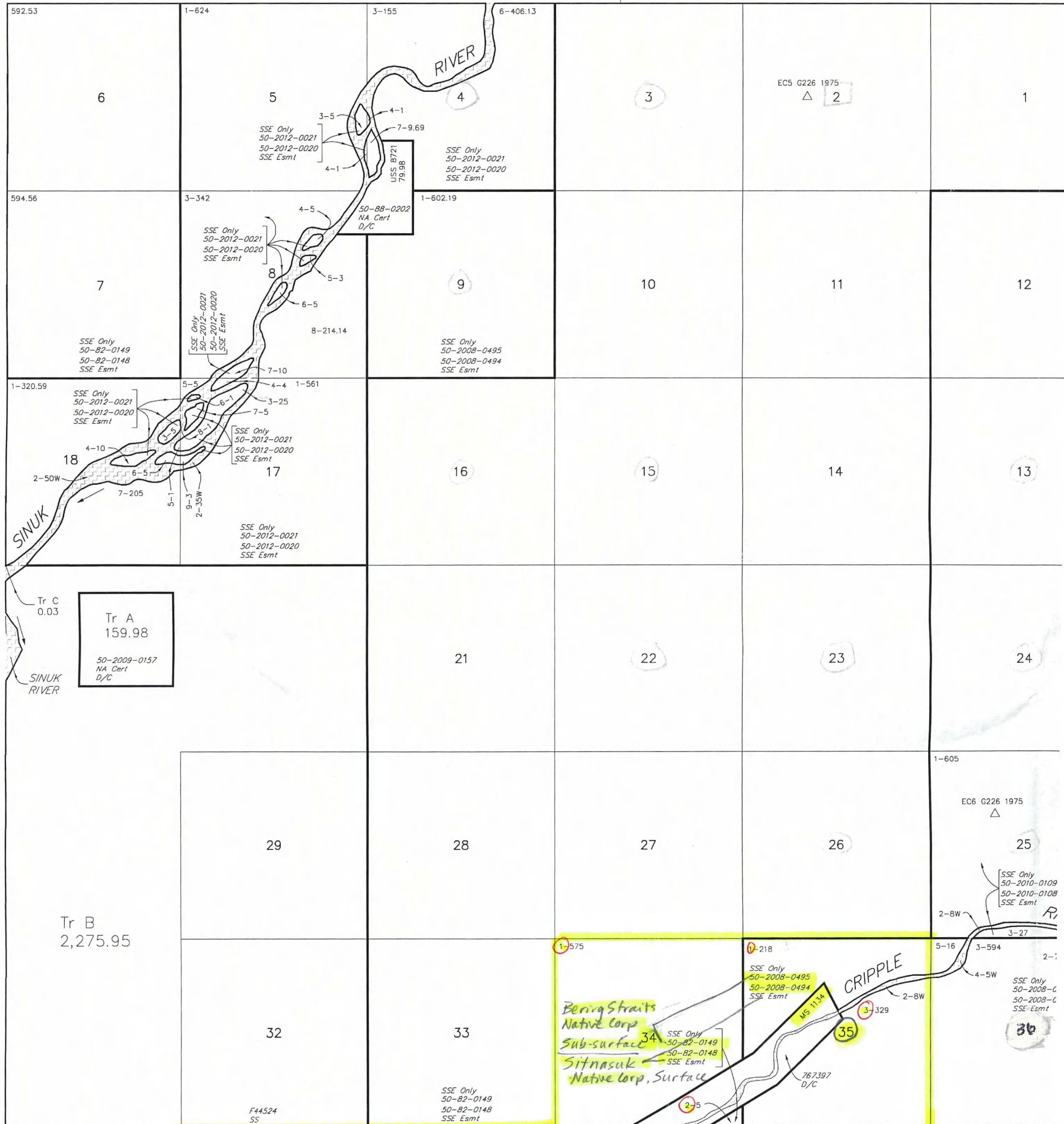

**WARNING:**  
 This plot is the Bureau's Record of Title, and should only be used as a graphic display of the township survey records hereon do not reflect title changes which may be effected by lateral movements of rivers or other means. Refer to the cadastral surveys for official survey.

TH RANGE 36 WEST OF THE KATEEL RIVER MERIDIAN, ALASKA

R 36 W | R 35 W

STATUS OF PUBLIC DOMAIN  
 LAND AND MINERAL TITLES

**MTP**

FOR ORDERS EFFECTING DISPOSAL OR USE OF UN-IDENTIFIED LANDS WITHDRAWN FOR CLASSIFICATION MINERALS, WATER AND/OR OTHER PUBLIC PURPOSES REFER TO INDEX OF MISCELLANEOUS DOCUMENTS.

PL 92-203 Wdl V/Sel F14908, Lds W/I F14908-A2, F14908-B, F14908-B2, F14908-C

PLO 5184 Wdl CI affects Lds/Interests not conveyed

F35186 Reindeer Gr Per affects Unapprop Lds W/I Tp

IC 558 & IC 559 Excl F23164 MS Apln



Patent (Sec 34)  
 50-82-0148  
 Sitnasuk Native Corp, Surface  
 50-82-0149  
 Bering Straits Native Corp, Subsurface

Patent (Sec 35)  
 50-2008-0494  
 Sitnasuk Native Corp, Surface  
 50-2008-0495  
 Bering Straits Native Corp, Subsurface

O = SECTIONS LISTED IN UNDESIGNED 2014  
 SITNASUK / AK GOLD EXPOSITIONS  
 TEMPORARY ACCESS ESMT. AGMT,  
 SEC. 35 ONLY  
 □ = SECTIONS LISTED IN UNDESIGNED 2014  
 WITHDRAWN TO AVOID THE TOWN NOT  
 LISTED IN UNDESIGNED 2014 SITNASUK/  
 CRIPPLE RIVER TEMP. ACCESS AGMT,  
 LOTTED OUT FROM SURVEY

Lat 64°39'30.39"N  
 Long 165°45'54.50"W

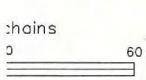

WARNING:  
 This plot is the Bureau's Record of Title, and should be used only as a graphic display of the township survey data. Records hereon do not reflect title changes which may have been effected by lateral movements of rivers or other bodies of water. Refer to the cadastral surveys for official survey information.

CURRENT TO		KR Mer
3-15-2012		T 9 S
		R 36 W

ACAD