

# SURVEYED TOWNSHIP 11 SOUTH, RANGE 35 WEST OF THE KATEEL RIVER

Lat 64°34'18.57"N  
 Long 165°45'54.61"W

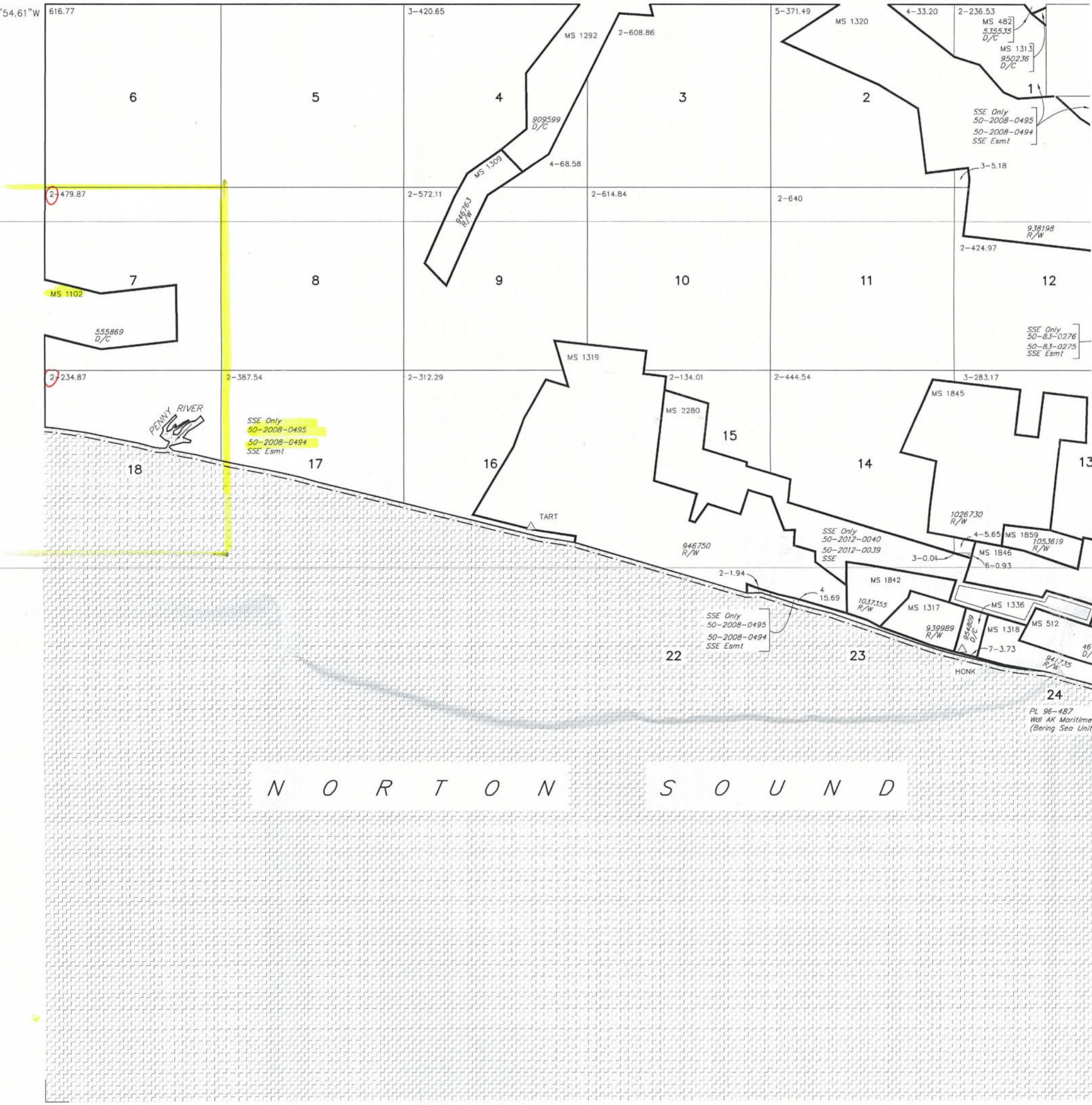

N O R T O N      S O U N D

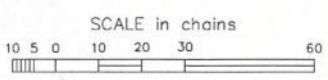

**WARNING:**  
 This plot is the Bureau's Record of Title, and should be only as a graphic display of the township survey data. Orders hereon do not reflect title changes which may have been effected by lateral movements of rivers or other bodies. Refer to the cadastral surveys for official survey information.

TOWNSHIP 11 SOUTH, RANGE 35 WEST OF THE KATEEL RIVER MERIDIAN, ALASKA

STATUS OF PUBLIC DOMAIN  
 LAND AND MINERAL TITLES

MTP

FOR ORDERS EFFECTING DISPOSAL OR USE OF UN-IDENTIFIED LANDS WITHDRAWN FOR CLASSIFICATION MINERALS, WATER AND/OR OTHER PUBLIC PURPOSES REFER TO INDEX OF MISCELLANEOUS DOCUMENTS.

PL 92-203 Wdl F14908 Lds W/1 F14908-B

PLO 5184 Wdl CI affects Lds/interest not conveyed

F14908-B V/Sel excludes valid existing rights

F35186 Reindeer Gr Per affects Unapprop Lds this Tp

Sec 18  
 RST 158, Nome-Teller Coastal Trail  
 RST 170, Penny River Trail

Patent  
 50-2008-0494  
 Sitnasuk Native Corp. Surface  
 50-2008-0495  
 Bering Straits Native Corp. Sub-Surface

NO SECTIONS IN THIS TOWNSHIP  
 LISTED IN UNSIGNED 2014  
 SITNASUK/AK GOLD EXPOSITIONS  
 Temporary Access Esmt. Agmt.

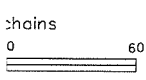
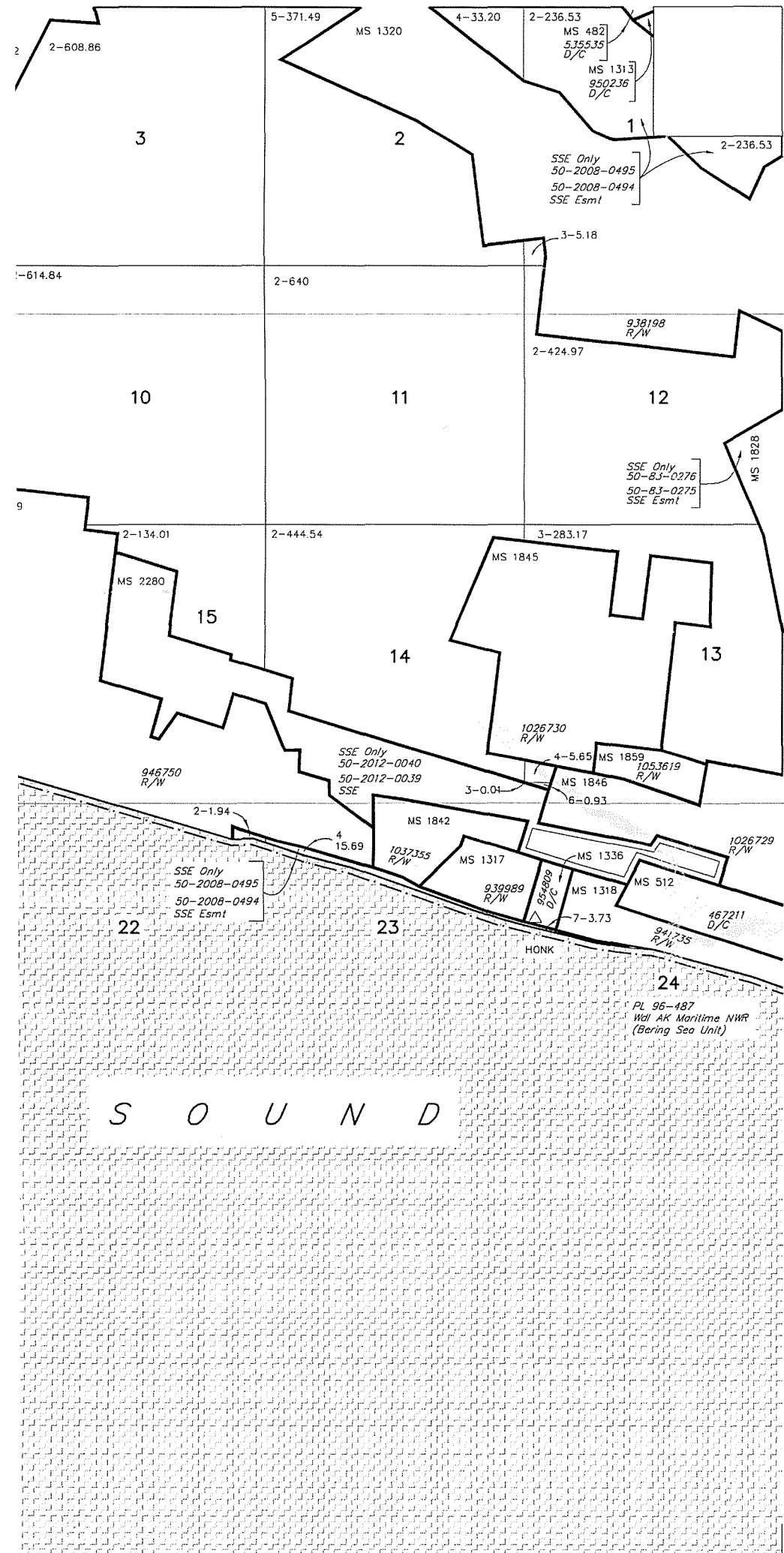

WARNING:  
 This plot is the Bureau's Record of Title, and should be used only as a graphic display of the township survey data. Records herein do not reflect title changes which may have been effected by lateral movements of rivers or other bodies of water. Refer to the cadastral surveys for official survey information.

CURRENT TO		KR Mer
9-12-2012		T 11 S
		R 35 W

ACAD