

DRAWING NUMBER

DRAWING NUMBER

DRAWING NUMBER

DRAWING NUMBER

GENERAL NOTES:

1. THE BASIS OF COORDINATES IS THE RECOVERED BLM MONUMENT SHOWN AS CONTROL POINT #2, WHICH IS C5, LOT 16 OF U.S. SURVEY No. 6664.

NAD 83 LATITUDE AND LONGITUDE  
LATITUDE 64°44'01.56225" N, LONGITUDE 156°46'42.24119" W

NAD 83 ALASKA STATE PLANE, ZONE 6 (METERS)  
N: 1196182.12 METERS, E: 558193.93 METERS

PROJECT (GROUND) COORDINATES (US SURVEY FEET)  
N: 3924474.19 FEET, E: 1831341.26 FEET

2. THE BASIS OF BEARING IS N 86°20'42" W BETWEEN THE RECOVERED MONUMENTS CP #2 AND CP #6, GALENA DIKE.

3. THE BASIS OF ELEVATIONS IS THE OPUS AVERAGED GEIOD06 (NAVD88) ELEVATION OF 158.82 FEET AT CP #6, GALENA DIKE. GEIOD06 WAS DELIBERATELY USED SO THAT CONTROL INFORMATION CORRESPONDS WITH ROAD DESIGN DATA THAT WAS BASED ON GEIOD06 ELEVATIONS.

4. TO ESTABLISH PROJECT (GROUND) COORDINATES: THE INVERSE COMBINED SCALE FACTOR OF 1.000071290, DERIVED FROM AN AVERAGE OF ALL GPS CONTROL POINTS USING LEICA GEO OFFICE SOFTWARE VERSION 7.0, WAS APPLIED TO THIS PROJECT. A TRANSLATION OF -85.2758 M IN NORTHING AND -39.7937 M IN EASTING WAS USED TO PLACE THE SCALED COORDINATES BACK TO CP #2.

5. THIS SURVEY DOES NOT CONSTITUTE A SUBDIVISION AS DEFINED BY ALASKA STATUTE 40.15.900(5)(A).

6. THE HORIZONTAL CLOSURE FOR THIS SURVEY MEETS OR EXCEEDS 1 PART IN 10,000. THE LARGEST NETWORK HORIZONTAL SEMI-MAJOR ERROR ELLIPSE OF 0.001 METERS AT THE 95% CONFIDENCE LEVEL WAS OBSERVED FOR THE STATIC GPS, AND THE MINIMUM LOOP MISCLOSURE MEETS OR EXCEEDS 1 PART IN 944,936.

7. VERIFY HORIZONTAL AND VERTICAL CONTROL PRIOR TO USE. ON MULTI YEAR PROJECTS, VERIFY ALL CONTROL ON A SEASONAL BASIS.

8. PROPERTY LINES DEPICTED IN THIS DRAWING ARE FOR VISUAL REFERENCE ONLY.

9. BENCHMARKS ARE NOT SHOWN ON THIS SHEET BECAUSE OF SPACE CONSIDERATIONS.

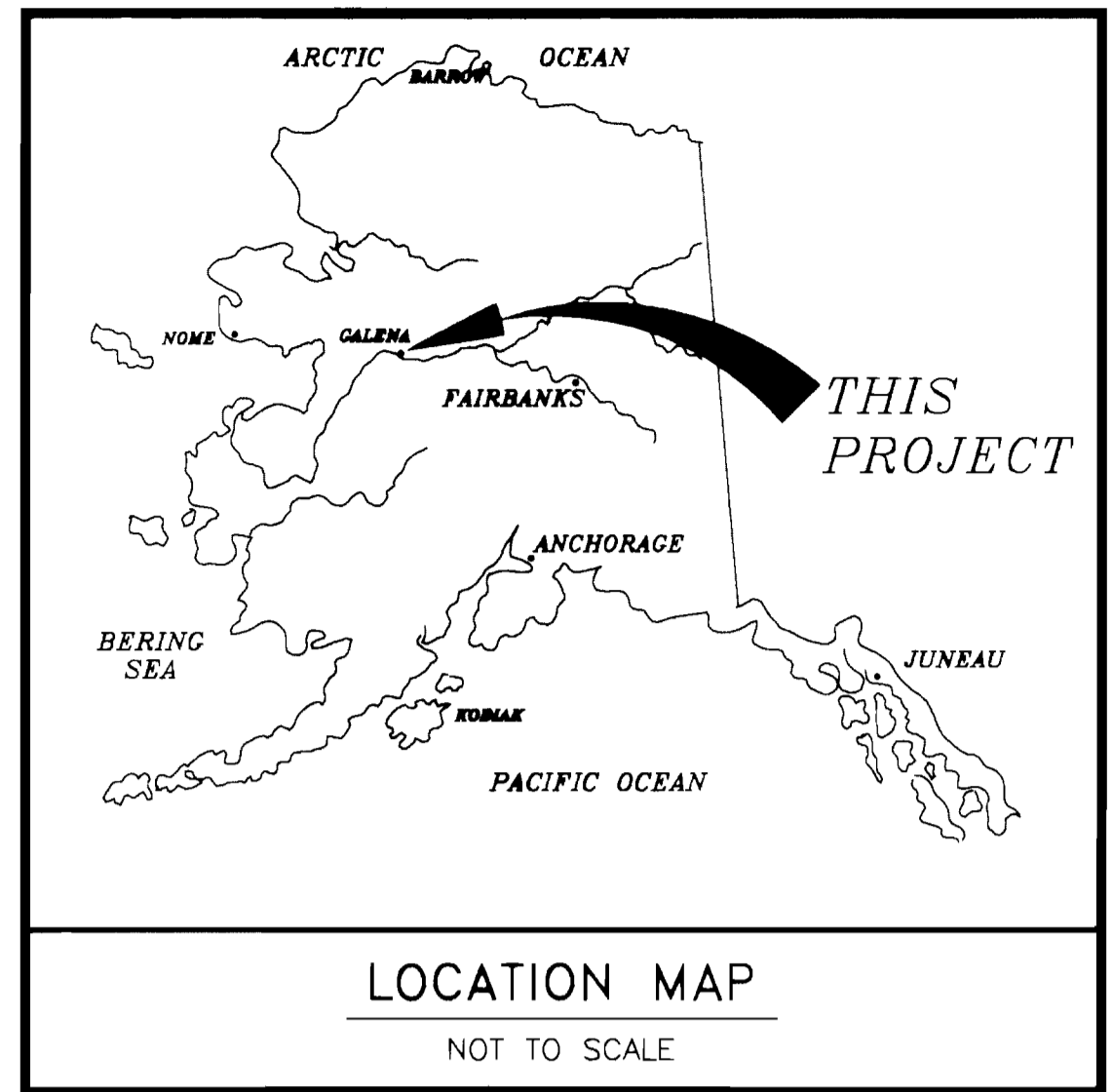
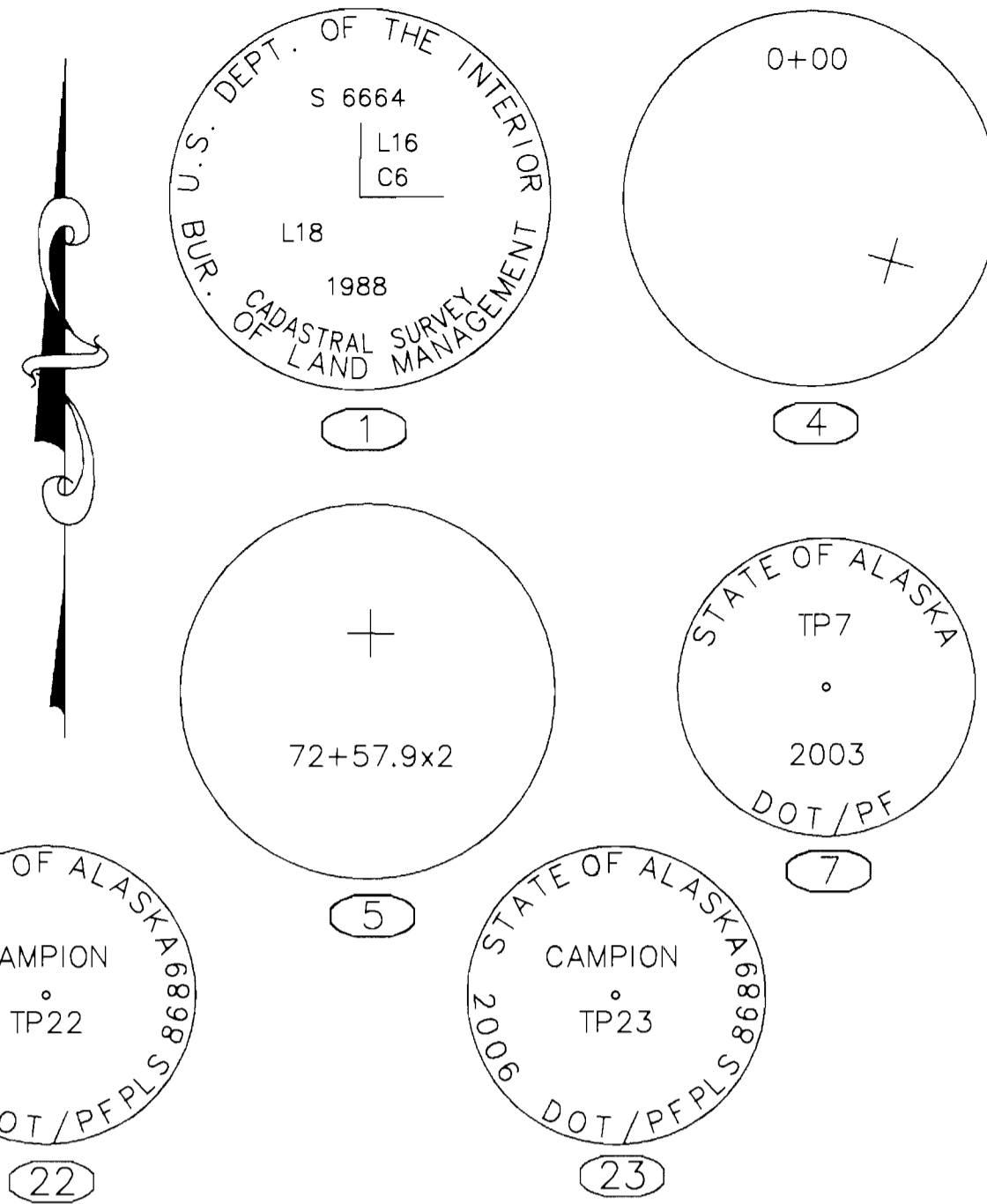

I hereby certify that I am properly Registered and Licensed to practice Land Surveying in the State of Alaska, and that this plat represents a survey made by me or under my direct supervision, and that the monuments shown hereon actually exist as described and that all dimensions and other details are correct to the extent shown hereon.

DATE: Jan 3, 2012 LS-11297  
Larry S. Durfee Registration Number  
Larry S. Durfee Registered Land Surveyor

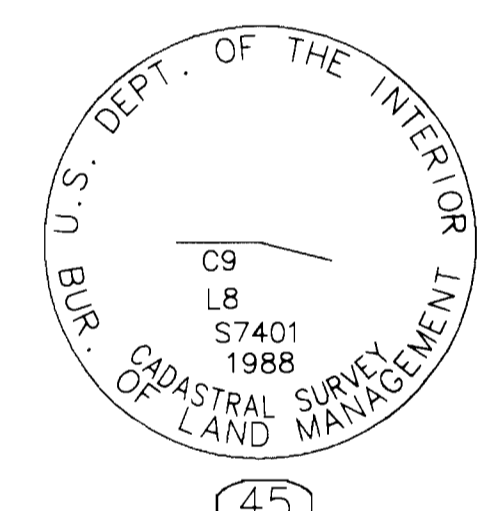
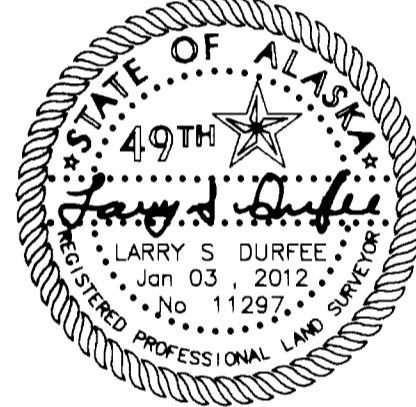

LEGEND

- BLM MONUMENT RECOVERED
- PRIMARY MONUMENT RECOVERED
- REBAR AND CAP SET
- REBAR AND CAP RECOVERED

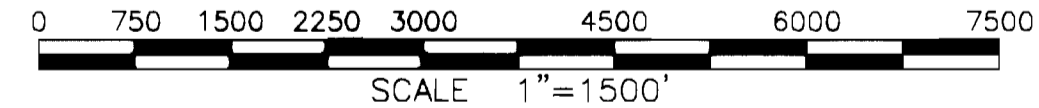

DATE: 01/03/12

DATE OF SURVEY Beginning: 07/14/06 Ending: 09/30/11	NAME AND ADDRESS: Department of Transportation and Public Facilities (DOT&PF) 2301 Peger Road Fairbanks, Alaska 99709
---	---

RECORD OF SURVEY	
CONTROL DRAWING OF CAMPION ROAD GPS SURVEY STP-0002(146)/61653 within SECS. 32, 33, 34 & 35, T. 8 S., R. 10 E. AND SEC. 1, T. 9 S., R. 10 E. KATEEL RIVER MERIDIAN Nulato Recording District	

DRAWN BY: DNC	SCALE: 1"=1500'	CHECKED BY: LSD	FILE NO.:
------------------	--------------------	--------------------	-----------

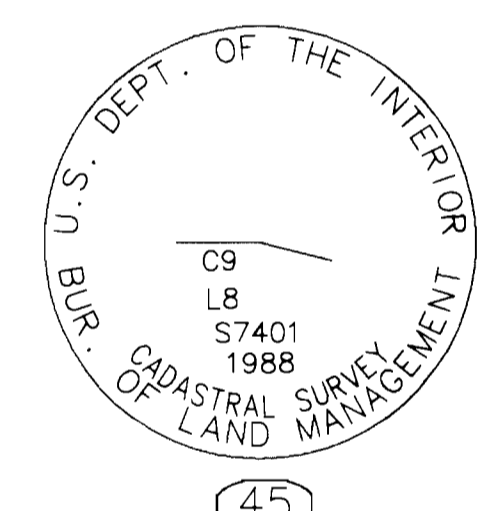
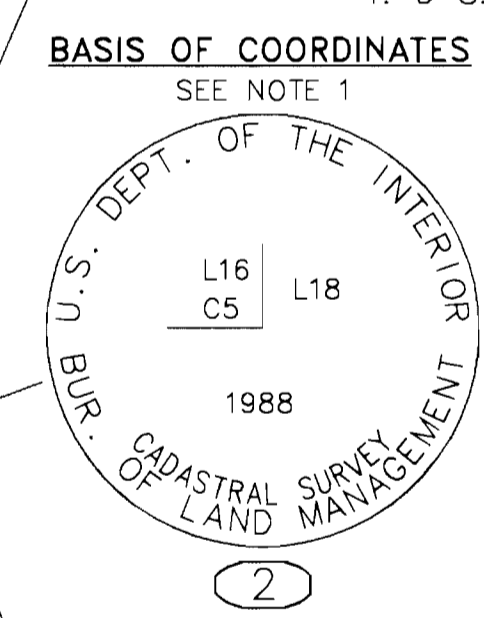
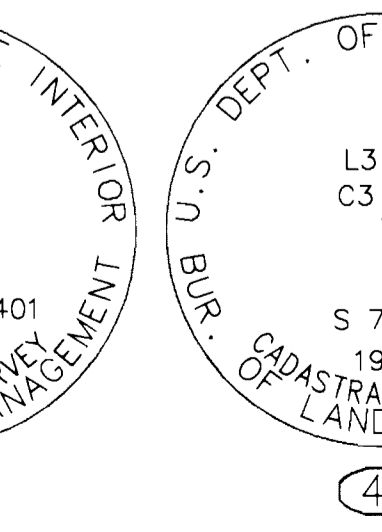
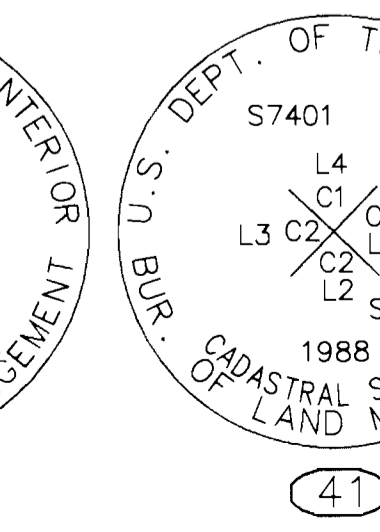
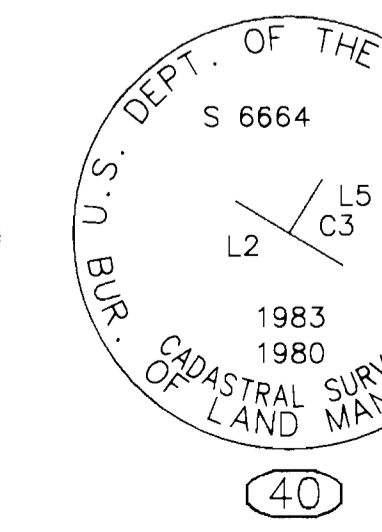
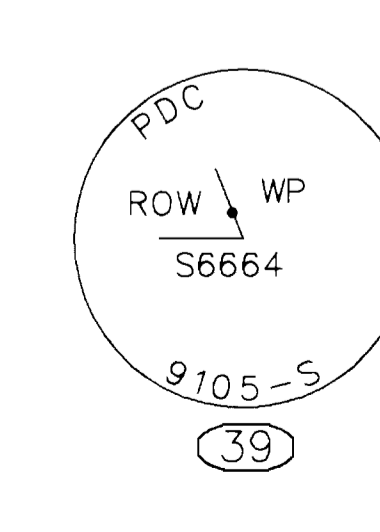
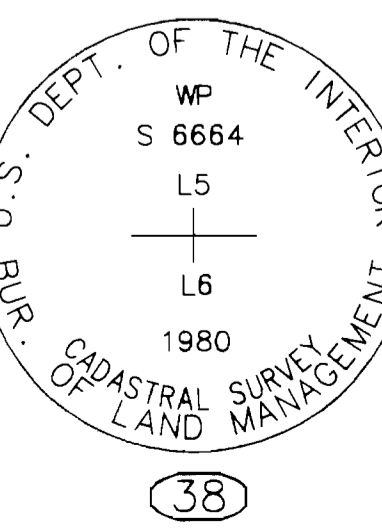
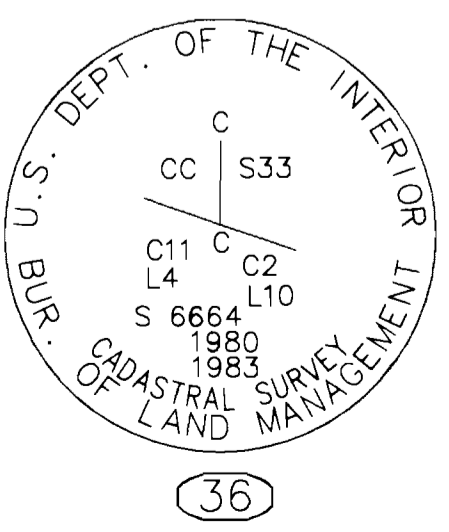
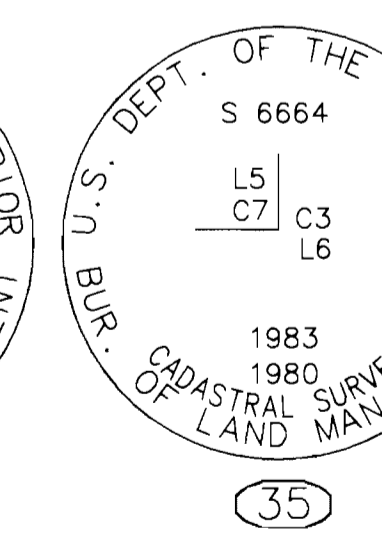
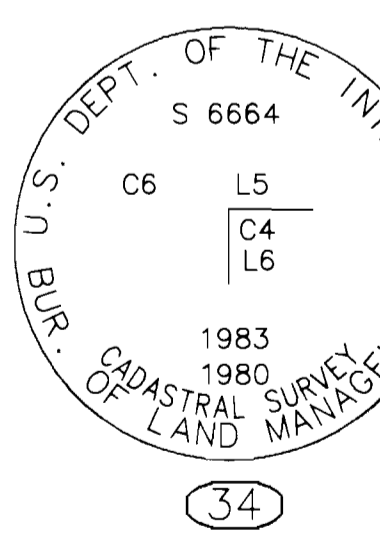
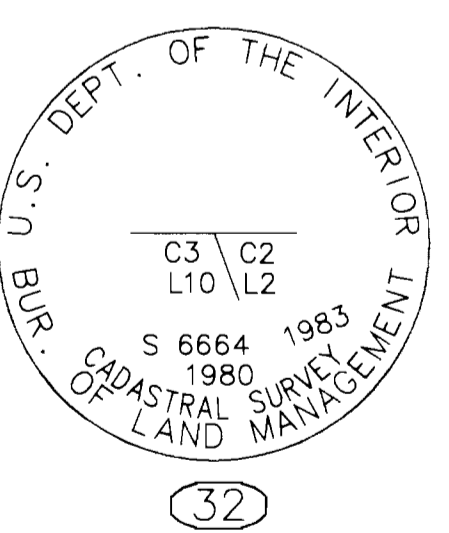
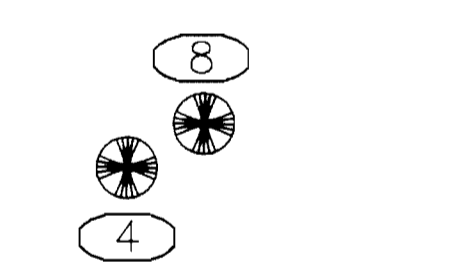
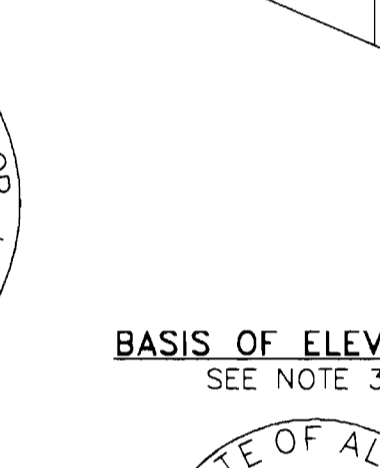
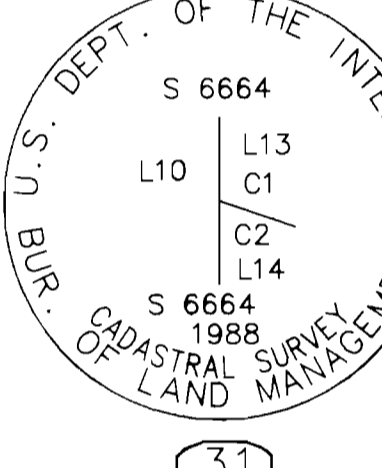
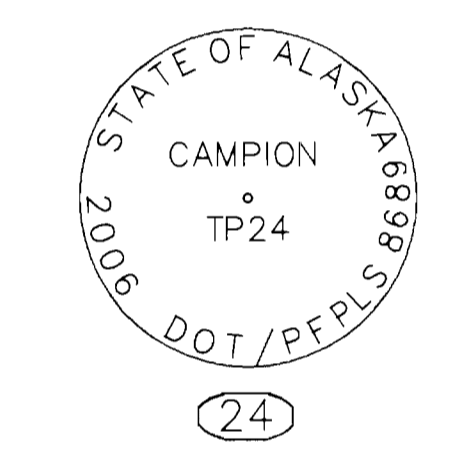
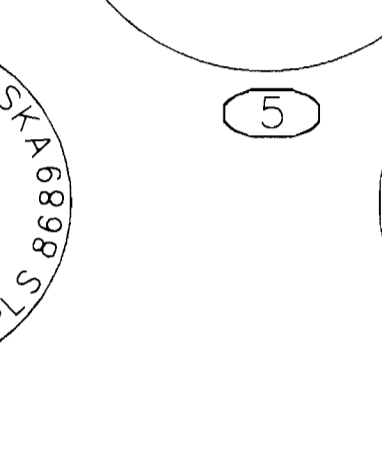
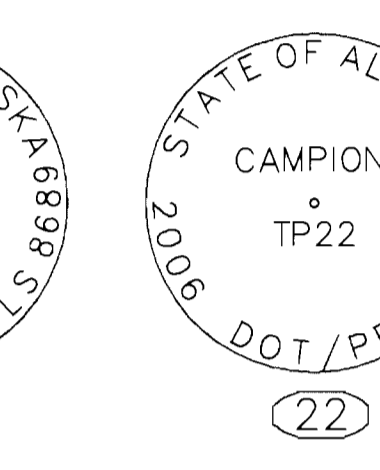
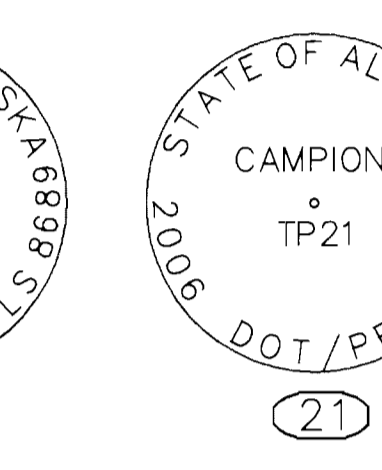
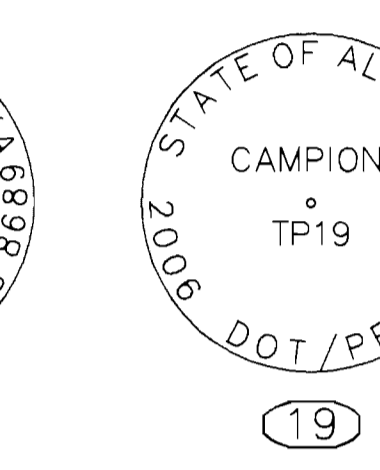
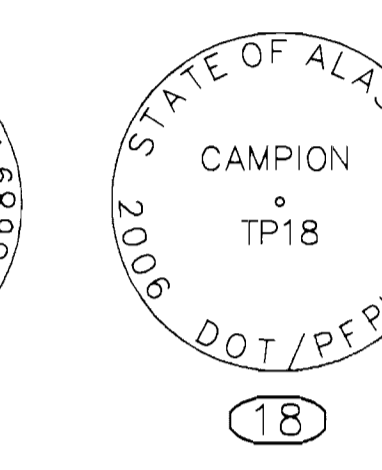
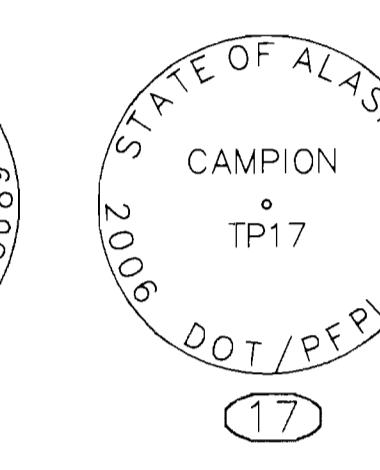
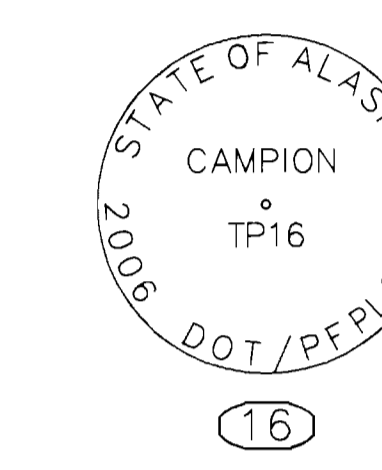
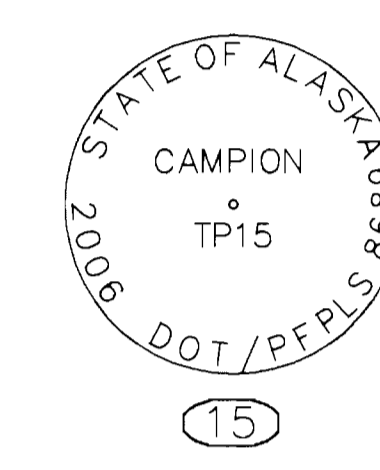
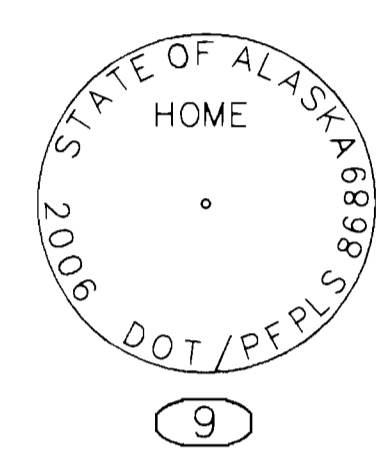
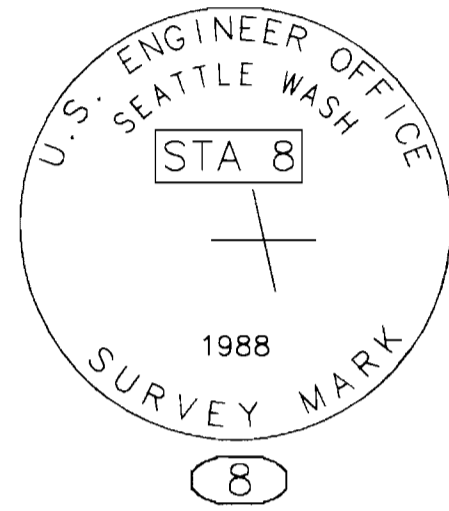
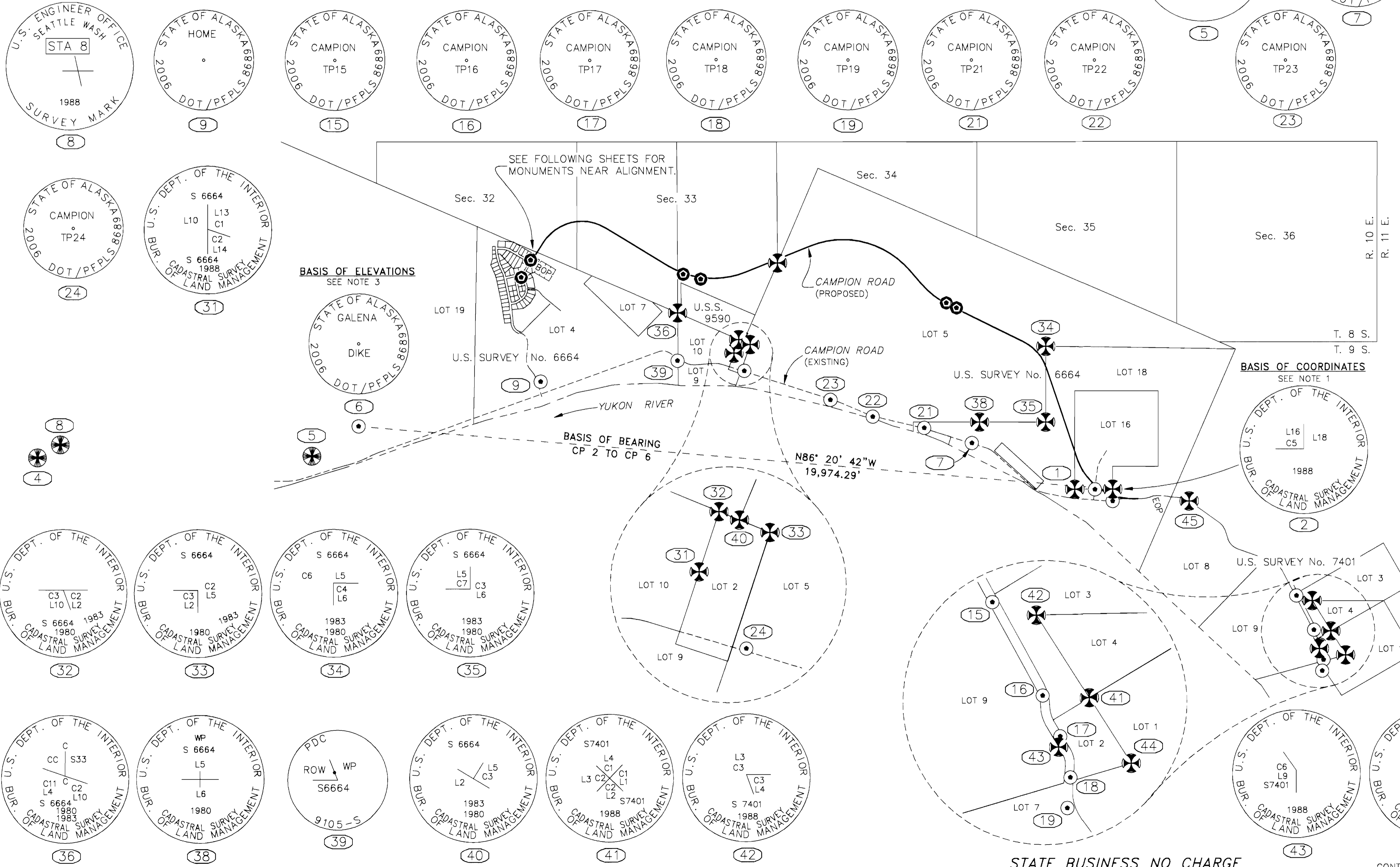

STATE BUSINESS NO CHARGE

CONTROL SHEET 1 OF 5

Plat No. 2012-2 Nulato Recording District

DRAWING NUMBER

DRAWING NUMBER

Sheet 2 of 5 Drawing No. 7141  
Galena Campion Road Erosion  
Protection  
Project No. STP-0002(146)/6165 ROS

DRAWING NUMBER

MONUMENTS					
Station	Offset	Point #	Northing	Easting	Description
N/A	N/A	4	3924754.83	1802935.93	PRIMARY MONUMENT FOUND
N/A	N/A	8	3925110.08	1803532.88	PRIMARY MONUMENT FOUND
N/A	N/A	5	3924936.96	1810191.20	PRIMARY MONUMENT FOUND
N/A	N/A	6	3925747.55	1811407.58	REBAR WITH CAP FOUND
N/A	N/A	101	3929759.26	1815618.86	REBAR WITH CAP SET
100+49.77	-33.70	102	3930216.95	1815857.28	REBAR WITH CAP SET
131+19.18	4353.96	9	3927018.56	1816187.18	REBAR WITH CAP FOUND
148+76.81	28.65	103	3929922.25	1819896.36	REBAR WITH CAP SET
150+21.55	1045.68	36	3928897.91	1819770.04	BLM MONUMENT FOUND
151+99.59	2269.26	39	3927637.61	1819794.68	REBAR WITH CAP FOUND
153+50.10	41.03	104	3929803.25	1820361.16	REBAR WITH CAP SET
159+68.53	2008.29	31	3927865.81	1821279.02	BLM MONUMENT FOUND
160+67.60	1672.59	32	3928226.78	1821398.37	BLM MONUMENT FOUND
160+69.85	2510.57	24	3927404.98	1821562.36	REBAR WITH CAP FOUND
161+30.57	1746.99	40	3928176.33	1821521.16	BLM MONUMENT FOUND

"O"118+00 PI  
 $\Delta = 88^{\circ}33'55"$   
 $D = 4^{\circ}45'00"$   
 $T = 1176.39'$   
 $L = 1864.53'$   
 $R = 1206.23'$

TBMs						
Station	Offset	TBM #	Northing	Easting	Elevation	Description
N/A	N/A	2011-1	3929726	1815607	157.25	SPIKE IN TREE
N/A	N/A	2011-2	3930136	1815798	155.97	SPIKE IN TREE
148+16.93	48.96	2011-3	3929923	1819832	151.90	SPIKE IN 11" SPRUCE
153+39.82	151.33	2011-4	3929695	1820337	149.66	SPIKE IN 7" BIRCH
225+45.43	-56.01	2011-5	3929349	1826839	148.94	SPIKE IN 6" SPRUCE
228+90.73	-59.84	2011-6	3929206	1827151	148.69	SPIKE IN 7" SPRUCE
289+04.89	733.10	03-04	3924288	1830116	156.26	SPIKE IN 5" SPRUCE
293+07.54	319.99	03-05	3924232	1830791	153.50	SPIKE IN 5" BIRCH

'O' LINE CENTERLINE GEOMETRY POINTS					
Station	Offset	Point #	Northing	Easting	Description
100+00.00	0	1601	3930156.90	1815860.08	BOP
106+23.61	0	1608	3930688.99	1816185.31	PC
124+88.14	0	1627	3931104.53	1817817.62	PT
144+29.08	0	1648	3930134.06	1819498.52	PC
165+49.08	0	1670	3930009.20	1821539.92	PT
184+01.67	0	1690	3930733.07	1823245.24	PC
212+41.67	0	1719	3930156.96	1825843.89	PT
217+20.64	0	1725	3929801.01	1826164.39	PC
226+40.64	0	1735	3929257.44	1826898.98	PT
248+44.73	0	1758	3928325.95	1828896.56	PC
257+92.10	0	1768	3927645.30	1829520.27	PT
283+55.58	0	1795	3925236.41	1830397.04	PC
302+84.47	0	1815	3924232.36	1831894.98	PT
303+93.81	0	1817	3924236.81	1832004.23	EOP

MONUMENTS					
Station	Offset	Point #	Northing	Easting	Description
162+20.06	1863.41	33	3928100.99	1821704.09	BLM MONUMENT FOUND
174+23.16	93.30	37	3930264.85	1822380.97	BLM MONUMENT FOUND
220+07.36	3853.14	23	3926685.08	1823849.70	REBAR WITH CAP FOUND
224+50.27	3550.95	22	3926262.31	1824967.45	REBAR WITH CAP FOUND
225+77.36	-17.08	105	3929300.24	1826849.65	REBAR WITH CAP SET
228+75.46	-19.99	106	3929176.32	1827120.25	REBAR WITH CAP SET
235+05.31	3196.81	21	3925994.73	1826331.61	REBAR WITH CAP FOUND
253+45.00	-276.48	34	3928210.11	1829501.77	BLM MONUMENT FOUND
265+79.85	2128.09	38	3926177.20	1827789.95	BLM MONUMENT FOUND
270+36.53	2499.49	7	3925621.03	1827597.15	REBAR WITH CAP FOUND
271+46.64	472.48	35	3926210.84	1829539.56	BLM MONUMENT FOUND
289+20.86	453.88	1	3924453.66	1830341.62	BLM MONUMENT FOUND
292+50.30	88.47	11	3924458.78	1830872.52	REBAR WITH CAP FOUND
296+63.97	-152.29	2	3924474.19	1831341.26	BLM MONUMENT FOUND
297+70.90	142.32	3	3924161.20	1831346.55	REBAR WITH CAP FOUND
N/A	N/A	45	3924202.03	1833362.98	BLM MONUMENT FOUND
N/A	N/A	15	3921767.60	1836239.94	REBAR WITH CAP FOUND
N/A	N/A	42	3921642.27	1836662.20	BLM MONUMENT FOUND
N/A	N/A	16	3920873.12	1836723.17	REBAR WITH CAP FOUND
N/A	N/A	43	3920379.17	1836875.53	BLM MONUMENT FOUND
N/A	N/A	17	3920483.04	1836891.06	REBAR WITH CAP FOUND
N/A	N/A	19	3919796.95	1836959.86	REBAR WITH CAP FOUND
N/A	N/A	18	3920089.72	1836989.17	REBAR WITH CAP FOUND
N/A	N/A	41	3920850.53	1837169.24	BLM MONUMENT FOUND
N/A	N/A	44	3920223.96	1837570.47	BLM MONUMENT FOUND

LEGEND

- REBAR AND CAP SET
- TEMPORARY BENCHMARK SET

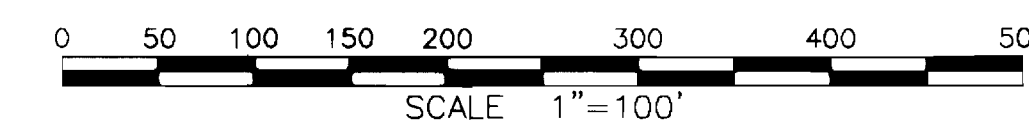

DATE: 01/03/12

DATE OF SURVEY Beginning: 07/14/06 Ending: 09/30/11	NAME AND ADDRESS: Department of Transportation and Public Facilities (DOT&PF) 2301 Peger Road Fairbanks, Alaska 99709
---	---

RECORD OF SURVEY

CONTROL DRAWING OF  
 CAMPION ROAD GPS SURVEY  
 STP-0002(146)/61653  
 within  
 SECS. 32, 33, 34 & 35, T. 8 S., R. 10 E.  
 AND SEC. 1, T. 9 S., R. 10 E.  
 KATEEL RIVER MERIDIAN  
 Nulato Recording District

DRAWN BY: DNC	SCALE: 1"=100'	CHECKED BY: LSD	FILE NO.:
------------------	-------------------	--------------------	-----------

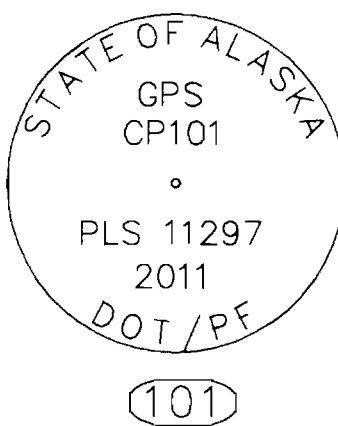
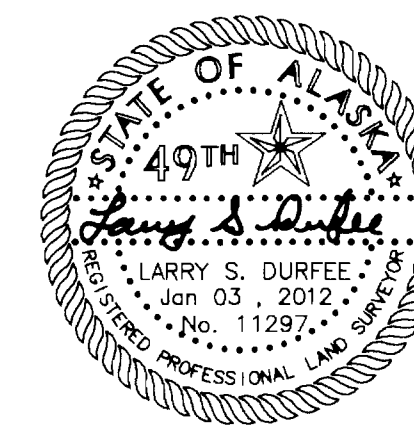

CONTROL SHEET 2 OF 5

Plat No 2012-2 Nulato Recording District

DRAWING NUMBER

DRAWING NUMBER

DRAWING NUMBER

SAFCO PRODUCTS • NEW HAVEN, CONNECTICUT  
REPRODUCTION OF THIS DRAWING IS PROHIBITED

SAFCO PRODUCTS • NEW HAVEN, CONNECTICUT  
REPRODUCTION OF THIS DRAWING IS PROHIBITED

Sheet 3 of 5 Drawing No. 7142  
Galena Campion Road Erosion  
Protection STP-0002(146)/6165 ROS

SAFCO PRODUCTS • NEW HAVEN, CONNECTICUT  
REPRODUCTION OF THIS DRAWING IS PROHIBITED

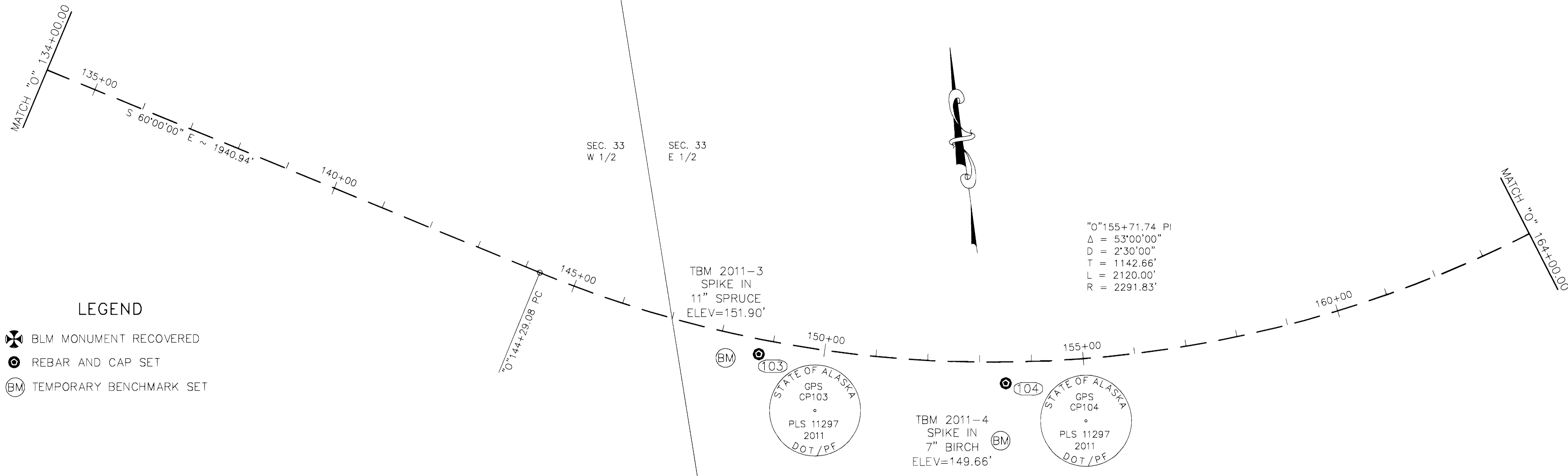

LEGEND

- BLM MONUMENT RECOVERED
- REBAR AND CAP SET
- TEMPORARY BENCHMARK SET

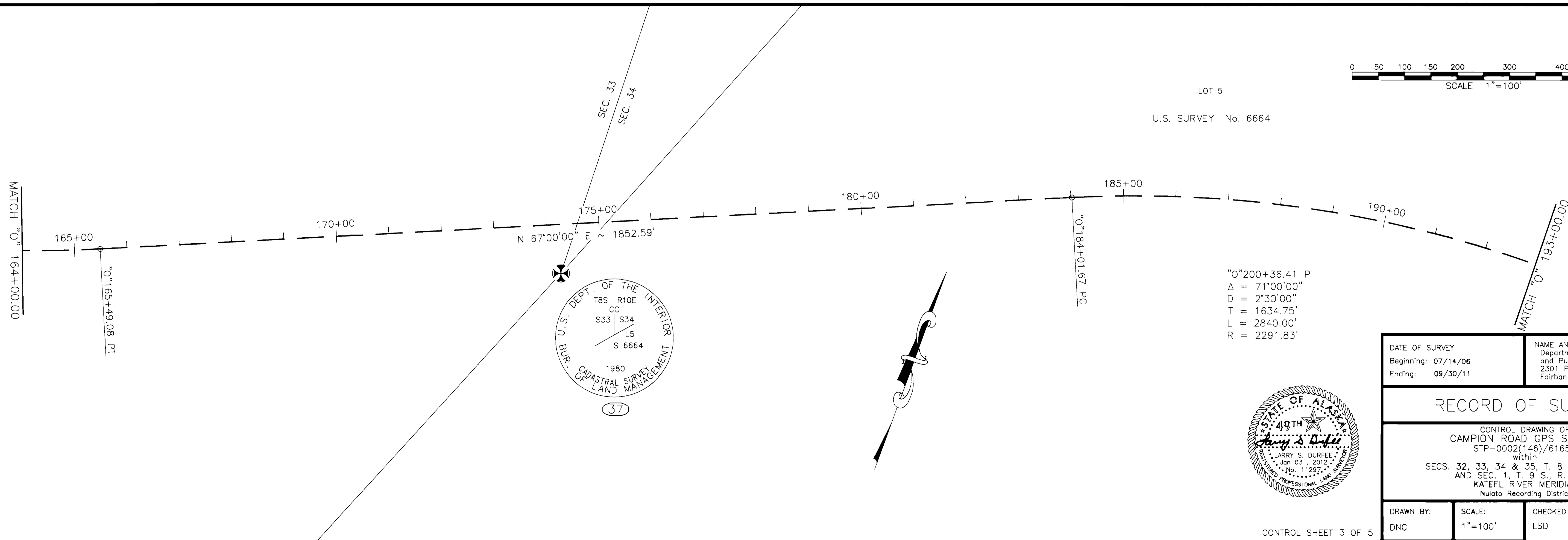
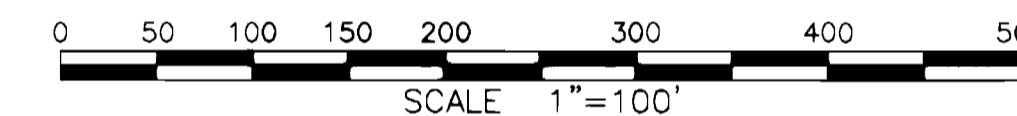

DATE: 01/03/12

DATE OF SURVEY Beginning: 07/14/06 Ending: 09/30/11	NAME AND ADDRESS: Department of Transportation and Public Facilities (DOT&PF) 2301 Peger Road Fairbanks, Alaska 99709
---	---

RECORD OF SURVEY

CONTROL DRAWING OF  
CAMPION ROAD GPS SURVEY  
STP-0002(146)/61653  
within  
SECS. 32, 33, 34 & 35, T. 8 S., R. 10 E.  
AND SEC. 1, T. 9 S., R. 10 E.  
KATEEL RIVER MERIDIAN  
Nulato Recording District

DRAWN BY: DNC	SCALE: 1"=100'	CHECKED BY: LSD	FILE NO.:
------------------	-------------------	--------------------	-----------

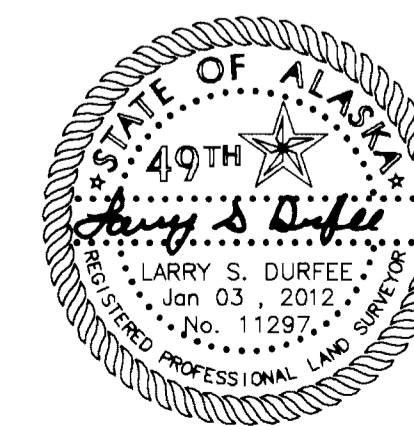

CONTROL SHEET 3 OF 5

Plat No. 2012-2 Nulato Recording District

DRAWING NUMBER

DRAWING NUMBER

DRAWING NUMBER

Sheet 4 of 5  
Drawing No. 7143  
Galena Campion Road Erosion  
Protection  
Project No. STP-0002(146)/6165 ROS  
SARCO PRODUCTS - S.V. HOFF, INC. - MINNESOTA  
RECORDED BY: PART 1, ALBERT 6553

SARCO PRODUCTS - S.V. HOFF, INC. - MINNESOTA  
RECORDED BY: PART 1, ALBERT 6553  
MATCH LINE OF POINT ON THIS LINE

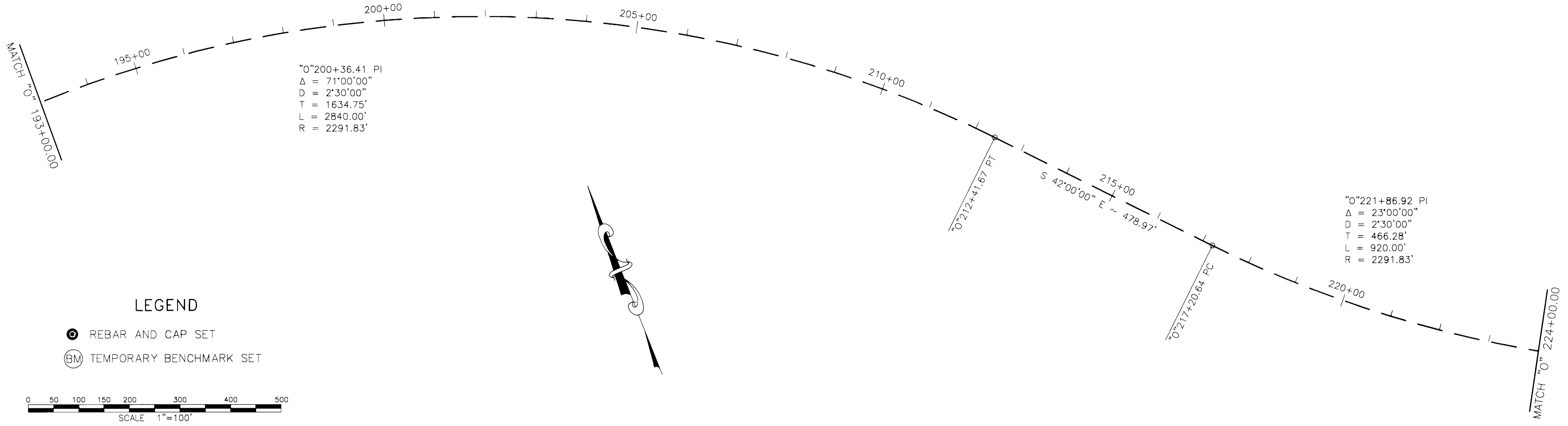

LEGEND

- REBAR AND CAP SET
- TEMPORARY BENCHMARK SET

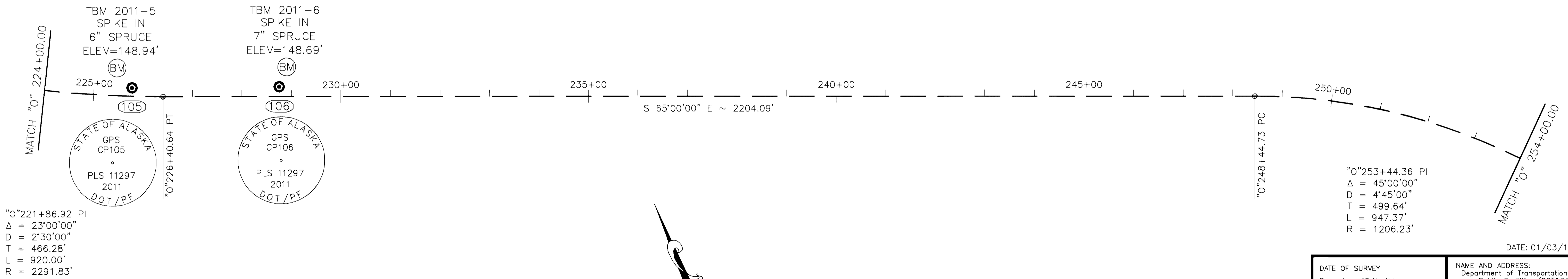
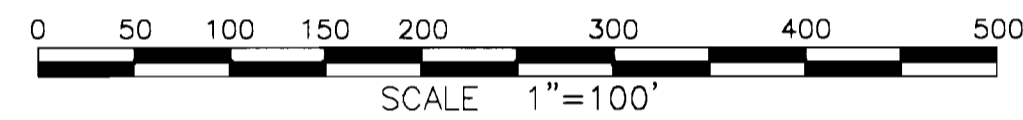

"O"221+86.92 PI  
 $\Delta = 23^{\circ}00'00''$   
 $D = 2'30'00''$   
 $T = 466.28'$   
 $L = 920.00'$   
 $R = 2291.83'$

"O"253+44.36 PI  
 $\Delta = 45^{\circ}00'00''$   
 $D = 4'45'00''$   
 $T = 499.64'$   
 $L = 947.37'$   
 $R = 1206.23'$

DATE: 01/03/12

DATE OF SURVEY Beginning: 07/14/06 Ending: 09/30/11	NAME AND ADDRESS: Department of Transportation and Public Facilities (DOT&PF) 2301 Peger Road Fairbanks, Alaska 99709
---	---

RECORD OF SURVEY

CONTROL DRAWING OF  
 CAMPION ROAD GPS SURVEY  
 STP-0002(146)/61653  
 within  
 SECS. 32, 33, 34 & 35, T. 8 S., R. 10 E.  
 AND SEC. 1, T. 9 S., R. 10 E.  
 KATEEL RIVER MERIDIAN  
 Nulato Recording District

DRAWN BY: DNC	SCALE: 1"=100'	CHECKED BY: LSD	FILE NO.:
------------------	-------------------	--------------------	-----------

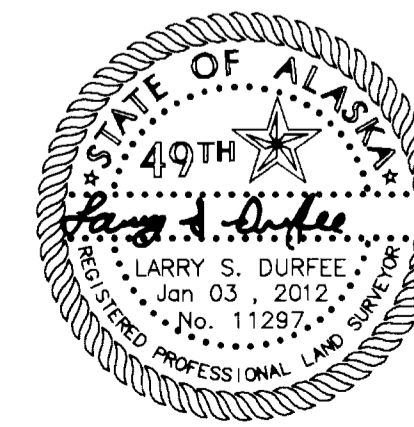

CONTROL SHEET 4 OF 5

Plat No. 2012-2 Nulato Recording District

SATCO PRODUCTS • NEW HORIZONS MINNESOTA  
REGISTERED BY PART NUMBER 6550

SATCO PRODUCTS • NEW HORIZONS MINNESOTA  
REGISTERED BY PART NUMBER 6550

Sheet 5 of 5 Drawing No. 7144  
Galena Campion Road Erosion  
Protection  
Project No. STP-0002(146)/6165 ROS  
DATE: 01/03/12

SATCO PRODUCTS • NEW HORIZONS MINNESOTA  
REGISTERED BY PART NUMBER 6550

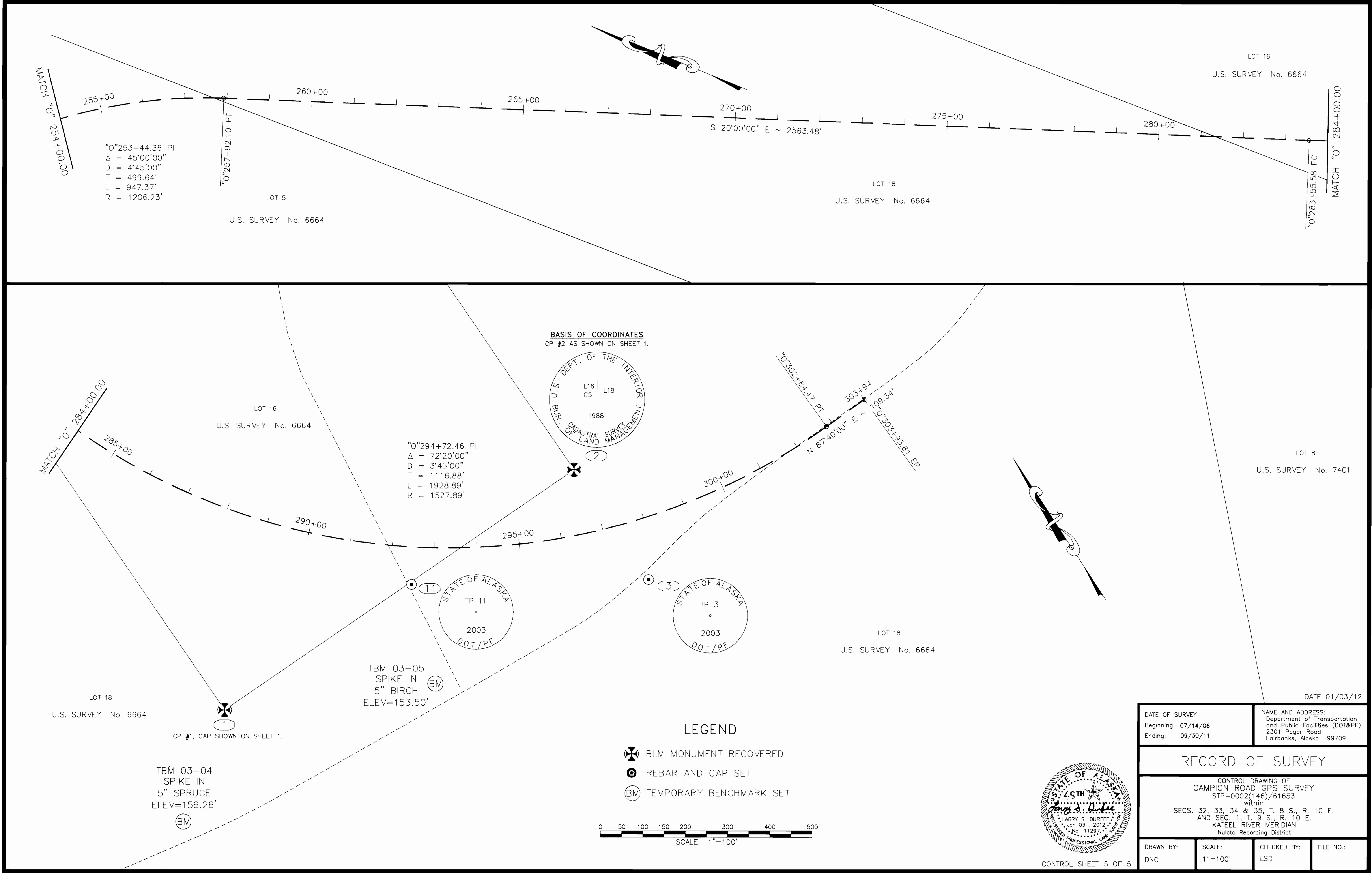

BASIS OF COORDINATES  
CP #2 AS SHOWN ON SHEET 1.

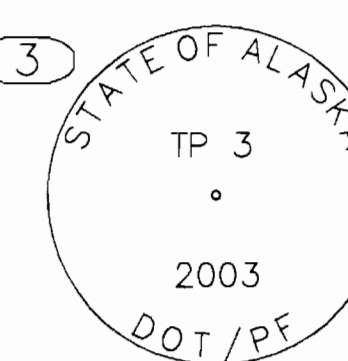
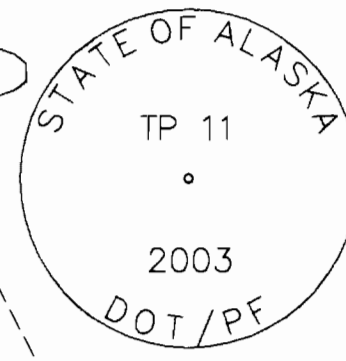
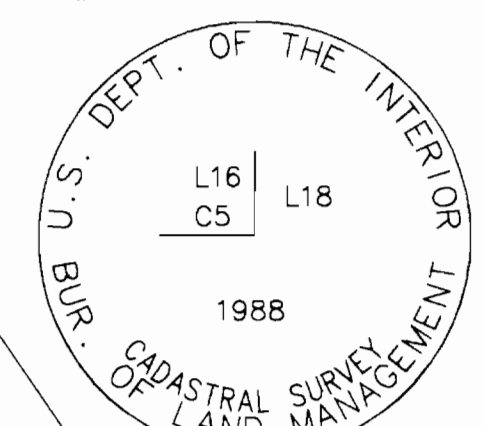

TBM 03-04 SPIKE IN 5" SPRUCE ELEV=156.26'  
TBM 03-05 SPIKE IN 5" BIRCH ELEV=153.50'

LEGEND

- BLM MONUMENT RECOVERED
- REBAR AND CAP SET
- TEMPORARY BENCHMARK SET

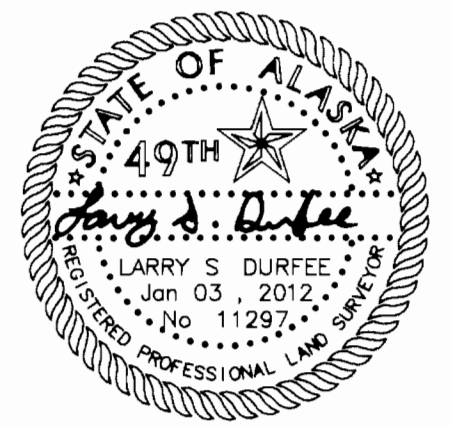
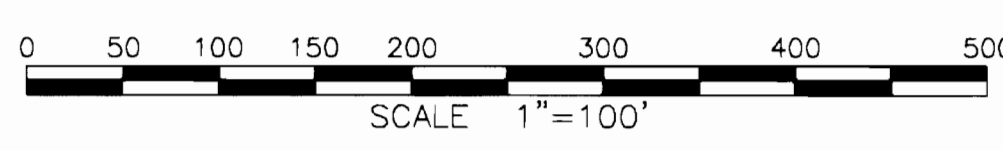

CONTROL SHEET 5 OF 5

DATE OF SURVEY Beginning: 07/14/06 Ending: 09/30/11	NAME AND ADDRESS: Department of Transportation and Public Facilities (DOT&PF) 2301 Peger Road Fairbanks, Alaska 99709
---	---

RECORD OF SURVEY			
CONTROL DRAWING OF CAMPION ROAD GPS SURVEY STP-0002(146)/61653 within SECS. 32, 33, 34 & 35, T. 8 S., R. 10 E. AND SEC. 1, T. 9 S., R. 10 E. KATEEL RIVER MERIDIAN Nulato Recording District			

DRAWN BY: DNC	SCALE: 1"=100'	CHECKED BY: LSD	FILE NO.:
------------------	-------------------	--------------------	-----------