

**NOTES:**

- At the time of filing of this plat, a portion of the lands included within the boundaries of this subdivision lies within the flood hazard area of the North Fork of Little Campbell as defined by the U.S. Army Corps of Engineers. These lands may be subject to periodic flooding, and development or use shall not occur unless approved by the G.A.A.B. Public Works Dept. as required by Ordinance.
- Direct vehicular access will not be allowed from Lot 8, Blk. 4, Lots 1 through 11, Blk. 5 to 68th AVE. & Lot 1, 2 & 3 Blk. 2, Lots 1 through 8, Blk. 1 to 64th AVE.
- This subdivision, at the time of filing, is not served by public water & sewer facilities. No on-site water and/or sewer disposal facility may be constructed without prior approval of the Health Department.

| CURVE NO. | RADIUS | CHORD LENGTH | DELTA        | ARC LENGTH | TANGENT LENGTH |
|-----------|--------|--------------|--------------|------------|----------------|
| 1         | 110.00 | 121.80       | 67° 13' 57"  | 129.08     | 73.13          |
| 2         | 110.00 | 137.22       | 77° 10' 47"  | 148.17     | 87.78          |
| 3         | 110.00 | 19.08        | 09° 56' 50"  | 19.09      | 9.57           |
| 4         | 20.00  | 22.13        | 67° 10' 46"  | 23.46      | 13.28          |
| 5         | 50.00  | 46.28        | 66° 07' 47"  | 48.11      | 26.10          |
| 6         | 50.00  | 43.50        | 51° 33' 58"  | 45.00      | 24.16          |
| 7         | 50.00  | 18.86        | 21° 44' 17"  | 18.97      | 19.60          |
| 8         | 20.00  | 24.60        | 75° 54' 41"  | 26.50      | 15.60          |
| 9         | 140.00 | 52.50        | 21° 36' 44"  | 52.81      | 26.72          |
| 10        | 140.00 | 45.59        | 18° 39' 30"  | 45.59      | 23.00          |
| 11        | 80.00  | 39.80        | 77° 10' 47"  | 107.76     | 63.84          |
| 12        | 365.00 | 11.37        | 01° 47' 04"  | 11.37      | 5.68           |
| 13        | 365.00 | 69.84        | 10° 59' 18"  | 70.00      | 35.11          |
| 14        | 80.00  | 31.62        | 38° 52' 12"  | 32.18      | 16.67          |
| 15        | 170.00 | 12.67        | 04° 13' 13"  | 12.67      | 6.34           |
| 16        | 50.00  | 20.57        | 23° 44' 16"  | 20.72      | 10.51          |
| 17        | 50.00  | 20.57        | 23° 44' 16"  | 20.72      | 10.51          |
| 18        | 200.00 | 100.97       | 29° 14' 32"  | 102.08     | 52.18          |
| 19        | 170.00 | 25.93        | 08° 44' 54"  | 25.96      | 13.00          |
| 20        | 170.00 | 80.48        | 20° 29' 38"  | 80.81      | 30.73          |
| 21        | 230.00 | 28.59        | 07° 07' 37"  | 28.61      | 14.32          |
| 22        | 230.00 | 67.62        | 16° 54' 20"  | 67.66      | 34.19          |
| 23        | 365.00 | 179.77       | 29° 20' 00"  | 181.75     | 92.91          |
| 24        | 365.00 | 123.91       | 20° 08' 07"  | 124.55     | 62.92          |
| 25        | 365.00 | 57.14        | 09° 13' 53"  | 57.20      | 28.66          |
| 26        | 365.00 | 79.86        | 11° 54' 20"  | 80.00      | 40.14          |
| 27        | 365.00 | 69.90        | 10° 25' 03"  | 70.00      | 35.10          |
| 28        | 365.00 | 47.08        | 07° 00' 37"  | 47.11      | 23.58          |
| 29        | 325.00 | 67.85        | 11° 58' 58"  | 67.97      | 34.11          |
| 30        | 325.00 | 2.08         | 00° 21' 57"  | 2.08       | 1.04           |
| 31        | 20.00  | 29.73        | 98° 00' 36"  | 33.51      | 22.22          |
| 32        | 20.00  | 30.86        | 100° 58' 29" | 35.25      | 24.25          |
| 33        | 230.00 | 10.00        | 02° 29' 28"  | 10.00      | 5.00           |
| 34        | 230.00 | 74.67        | 18° 41' 00"  | 75.00      | 37.94          |
| 35        | 230.00 | 53.60        | 13° 22' 57"  | 53.72      | 26.98          |
| 36        | 50.00  | 16.27        | 21° 03' 25"  | 16.38      | 9.29           |
| 37        | 200.00 | 159.40       | 40° 55' 13"  | 163.96     | 86.90          |
| 38        | 170.00 | 84.12        | 28° 36' 52"  | 85.00      | 43.41          |
| 39        | 170.00 | 42.85        | 14° 25' 52"  | 42.97      | 21.60          |
| 40        | 210.00 | 101.92       | 28° 05' 20"  | 102.96     | 52.53          |
| 41        | 150.00 | 67.36        | 28° 05' 20"  | 68.24      | 45.03          |
| 42        | 225.00 | 31.96        | 08° 08' 39"  | 31.96      | 16.02          |
| 43        | 275.00 | 54.34        | 11° 20' 26"  | 54.43      | 27.31          |
| 44        | 225.00 | 184.80       | 42° 59' 15"  | 189.81     | 98.00          |
| 45        | 250.00 | 309.00       | 76° 20' 26"  | 315.10     | 196.62         |
| 46        | 50.00  | 69.76        | 73° 23' 26"  | 64.06      | 37.26          |
| 47        | 50.00  | 36.94        | 46° 50' 12"  | 40.00      | 21.14          |
| 48        | 50.00  | 62.27        | 69° 01' 31"  | 65.00      | 30.66          |
| 49        | 50.00  | 55.75        | 67° 41' 31"  | 59.13      | 33.57          |
| 50        | 275.00 | 11.98        | 02° 29' 44"  | 11.98      | 5.99           |
| 51        | 275.00 | 59.98        | 12° 30' 03"  | 60.00      | 30.12          |
| 52        | 200.00 | 97.88        | 28° 19' 45"  | 98.89      | 50.43          |
| 53        | 170.00 | 70.86        | 24° 03' 32"  | 71.00      | 36.23          |
| 54        | 230.00 | 20.67        | 06° 09' 07"  | 20.68      | 10.33          |
| 55        | 230.00 | 33.01        | 08° 13' 50"  | 33.04      | 16.55          |
| 56        | 230.00 | 69.83        | 14° 56' 48"  | 60.00      | 30.17          |
| 57        | 50.00  | 27.53        | 31° 57' 36"  | 27.89      | 14.32          |
| 58        | 50.00  | 24.74        | 28° 36' 52"  | 25.00      | 12.77          |
| 59        | 50.00  | 28.25        | 90° 00' 00"  | 31.42      | 20.00          |
| 60        | 230.00 | 20.91        | 05° 12' 35"  | 20.91      | 10.46          |
| 61        | 50.00  | 16.37        | 18° 50' 25"  | 16.44      | 8.29           |

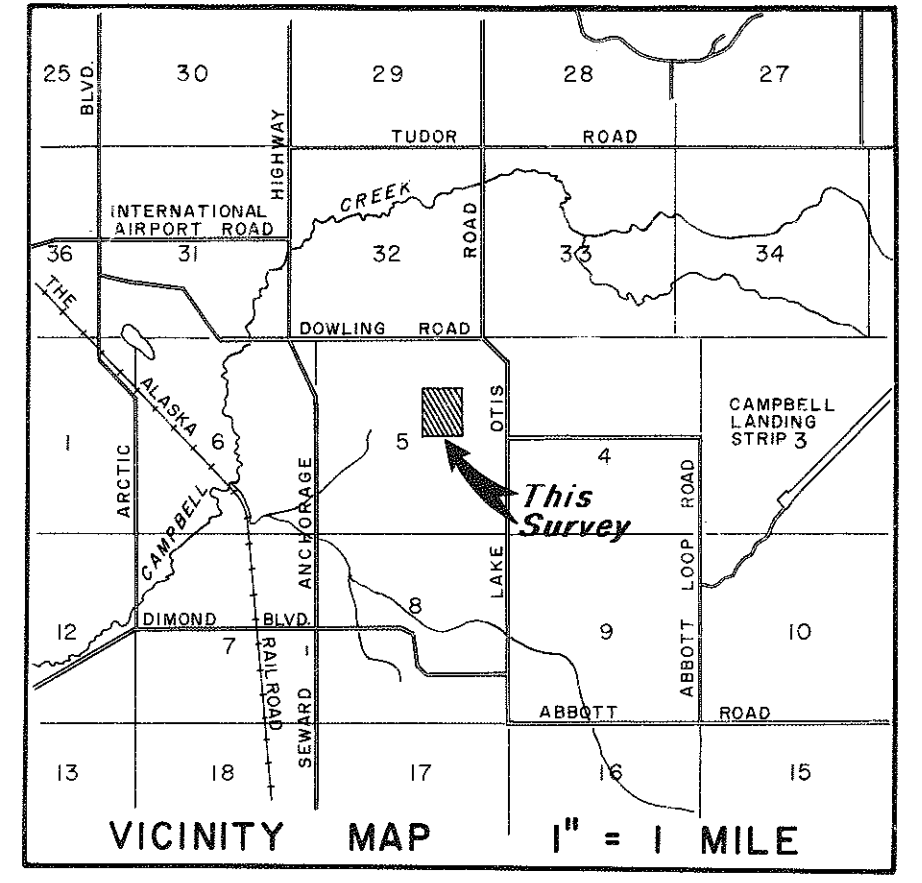

**CERTIFICATE OF OWNERSHIP & DEDICATION:**

We hereby certify that we are the owners of the property shown and described hereon. We hereby request approval of this plat, showing such easements for public utilities, roadways and alleys dedicated by us for public use.

72-113  
 RECORDED - FILED 6. - Date: June 1, 1972.  
 Anchorage  
 DATE: 7-10-72  
 TIME: 8:30 A.M.  
 BY: G.A.A.B.  
 GENE JOHNSON  
 ALLEN R. THOMPSON  
 855 10th Ave.  
 Santa Monica, Calif. 90406

**NOTARY'S ACKNOWLEDGEMENT:**

Subscribed and sworn to before me this 1st day of June, 1972.  
 My commission expires \_\_\_\_\_  
 NOTARY FOR CALIFORNIA

**NOTARY'S ACKNOWLEDGEMENT:**

Subscribed and sworn to before me this 1st day of June, 1972.  
 My commission expires 6-30-74  
 NOTARY FOR ALASKA

**PLAT APPROVAL:**

Plat approved by the Borough Planning Commission this 29th day of March, 1972.

**SURVEYOR'S CERTIFICATE:**

I, the undersigned registered surveyor, hereby certify that a land survey has been completed by me or under my direct supervision and that corners and monuments have been located and established and that the dimensions shown hereon are true and correct.

Date: June 1, 1972.

79-58  
 RECORDED - FILED 10.00  
 Anchorage REC. DIST.  
 DATE: 5-22 1979  
 TIME: 1:56 P.M.  
 STATE OF ALASKA  
 49th  
 NO. 6155  
 REGISTERED LAND SURVEYOR

**NOTE:**

No structure or building will be constructed until water and sewer service is available to each lot.

- ⊕ GLO or BLM BC Monument Existing
- ⊙ D/O BC Monument set this survey

10' wide Utility Easement each side of lot line unless otherwise noted.

All other corners are 5/8" X 30" Rebar set this survey