

SURVEYED TOWNSHIP 1 NORTH RANGE 86 WEST OF THE SEWARD MERIDIAN, ALASKA

STATUS OF PUBLIC DOMAIN
LAND AND MINERAL TITLES

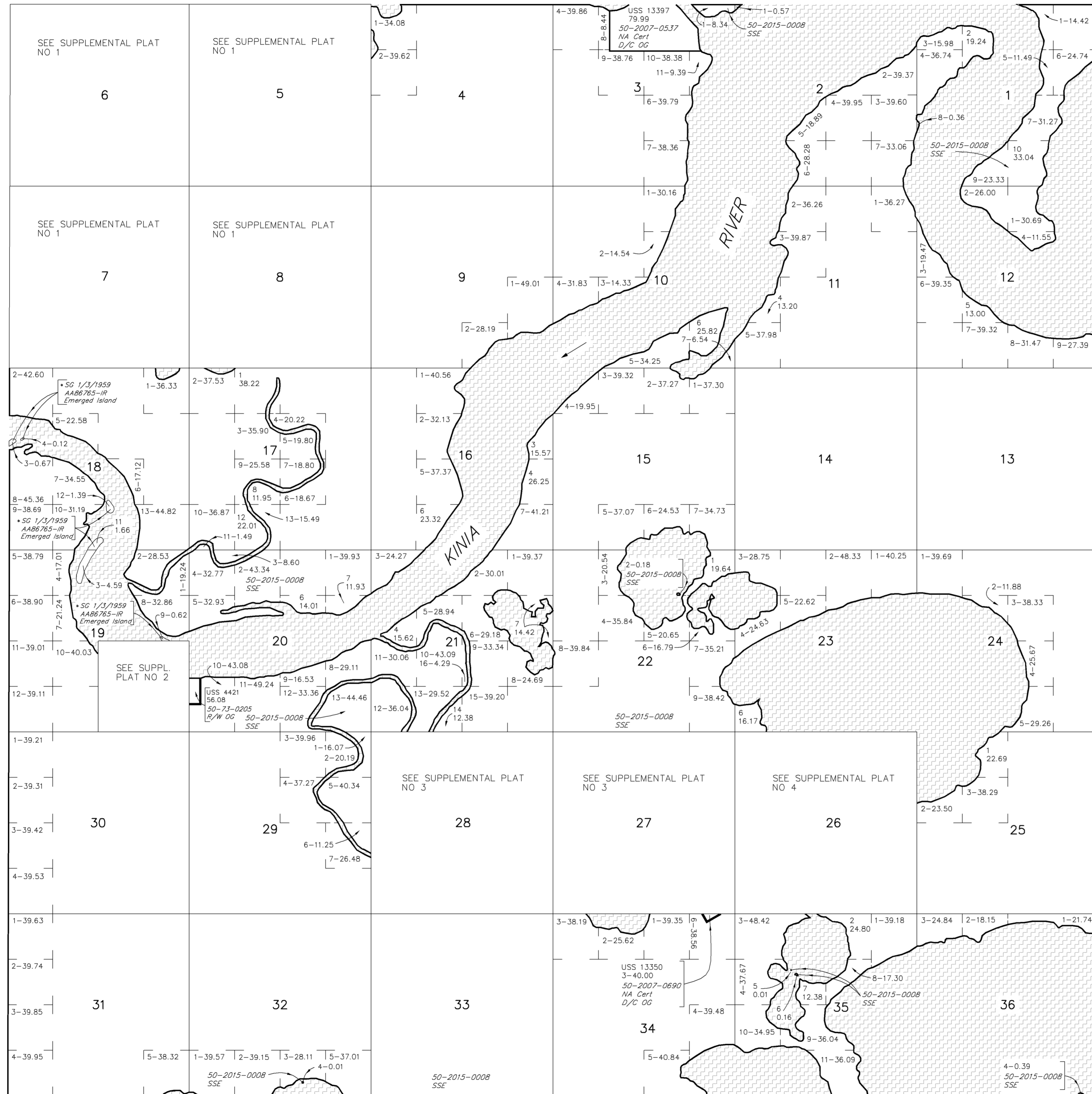

MTP

FOR ORDERS EFFECTING DISPOSAL OR USE OF UN-IDENTIFIED LANDS WITHDRAWN FOR CLASSIFICATION MINERALS, WATER AND/OR OTHER PUBLIC PURPOSES REFER TO INDEX OF MISCELLANEOUS DOCUMENTS.

PL 2213 Wdl Clarence Rhode National Wildlife Range affects Lds/interests not conveyed

PL 5183 Wdl Aid of Leg & Cl affects Lds/interests not conveyed

PL 92-203 Wdl F14848

F14848-A2 V/Sel Apln & Unpat Lds W/i Sec 8 Excl NA F17717 Par B & NA F17716 Par D Sec 27

PL 96-487 Wdl Yukon Delta NWR (Clarence Rhode Unit) entire tp

US Survey 4421, approved 6/2/2010, affects patented Lds w/ section(s) 19,20

** Islands det to have emerged from bed of nav water body which passed to State of Alaska under Equal Footing Doctrine at time of statehood. See AAB6718-IR*

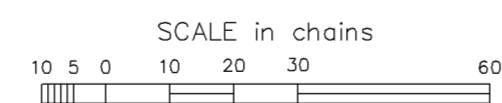

WARNING:
This plot is the Bureau's Record of Title, and should be used only as a graphic display of the township survey data. Records hereon do not reflect title changes which may have been effected by lateral movements of rivers or other bodies of water. Refer to the cadastral surveys for official survey information.

Lat 60°08'22.74"N
Long 164°07'20.41"W

CURRENT TO		Sew Mer
5-20-2015		T 1 N
		R 86 W

ACAD

SURVEYED TOWNSHIP 1 NORTH RANGE 86 WEST OF THE SEWARD MERIDIAN, ALASKA

STATUS OF PUBLIC DOMAIN
LAND AND MINERAL TITLES

**MTP
SUPPL SECS 5, 6, 7
& 8**

NO 1

FOR ORDERS EFFECTING DISPOSAL OR USE OF UN-IDENTIFIED LANDS WITHDRAWN FOR CLASSIFICATION MINERALS, WATER AND/OR OTHER PUBLIC PURPOSES REFER TO INDEX OF MISCELLANEOUS DOCUMENTS.

PL 2213 Wdl Clarence Rhode National Wildlife Range affects Lds/interests not conveyed

PL 5183 Wdl Aid of Leg & Cl affects Lds/interests not conveyed

PL 92-203 Wdl F14848

*F14848-A2 V/Sel Apin & Unpat Lds W/I:
Sec: 8 Excl NA F17717 Par B & NA F17716 Par D*

PL 96-487 Wdl Yukon Delta NWR (Clarence Rhode Unit) entire Tp

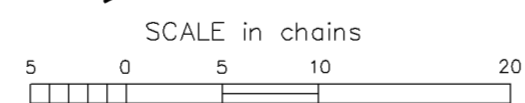
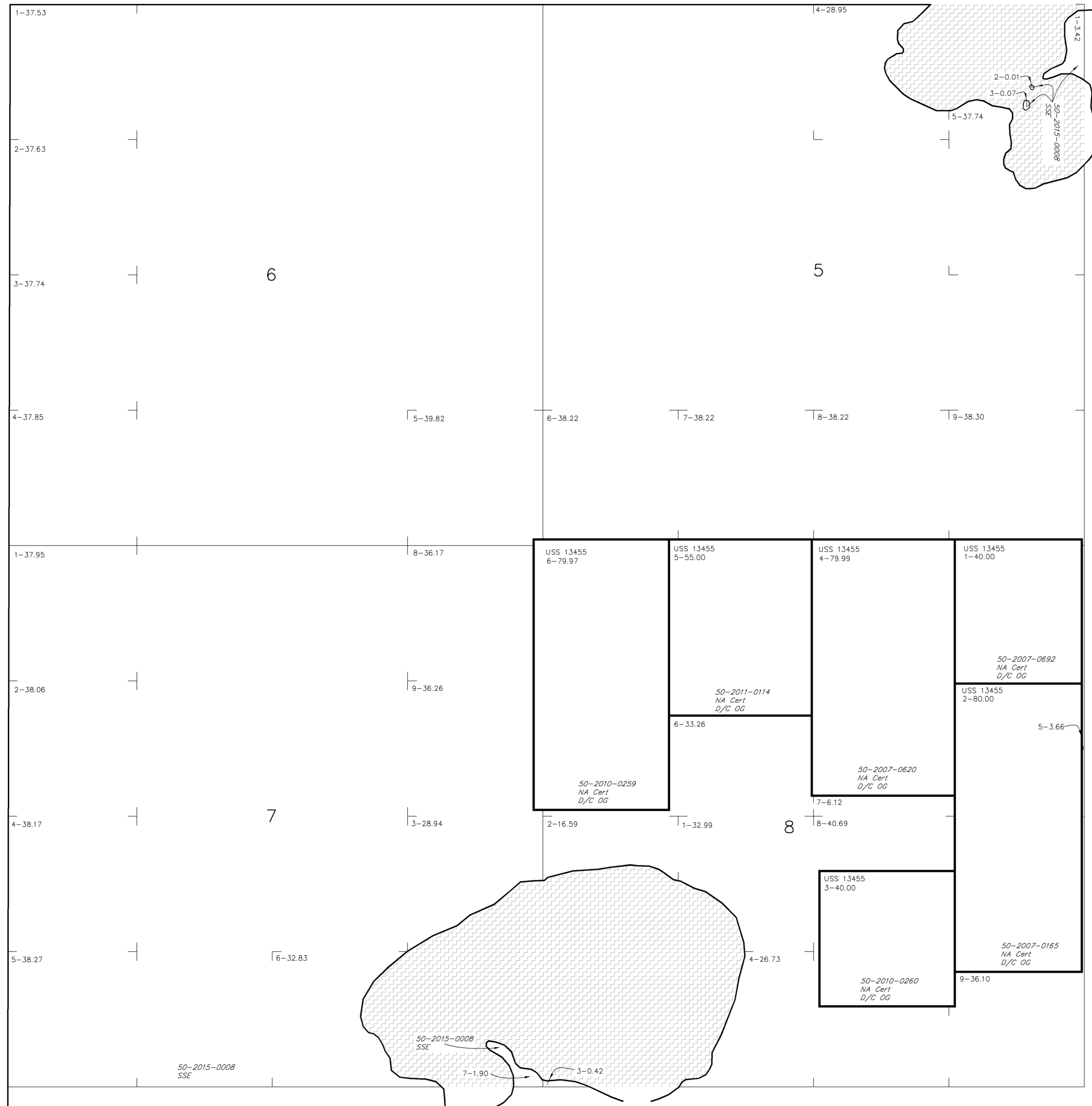

WARNING:
This plot is the Bureau's Record of Title, and should be used only as a graphic display of the township survey data. Records hereon do not reflect title changes which may have been effected by lateral movements of rivers or other bodies of water. Refer to the cadastral surveys for official survey information.

CURRENT TO	
5-20-2015	

NO 1
Sew Mer
T 1 N
R 86 W
ACAD

SURVEYED TOWNSHIP 1 NORTH RANGE 86 WEST OF THE SEWARD MERIDIAN, ALASKA

STATUS OF PUBLIC DOMAIN
LAND AND MINERAL TITLES

MTP SUPPL SE1/4 SEC 19

NO 2

FOR ORDERS EFFECTING DISPOSAL OR USE OF UN-IDENTIFIED LANDS WITHDRAWN FOR CLASSIFICATION MINERALS, WATER AND/OR OTHER PUBLIC PURPOSES REFER TO INDEX OF MISCELLANEOUS DOCUMENTS.

PL0 2213 Wdl Clarence Rhode National Wildlife Range affects Lds/interests not conveyed

PL0 5183 Wdl Aid of Leg & Cl affects Lds/interests not conveyed

Pl 92-203 Wdl F14848

*F14848-A2 V/Sel Apin & Unpat Lds W/i:
Sec: 19*

PL 96-487 Wdl Yukon Delta NWR (Clarence Rhode Unit) entire Tp

US Survey 4421, approved 6/2/2010, affects patented Lds W/i section(s) 19,20

** Islands det to have emerged from bed of nav water body which passed to State of Alaska under Equal Footing Doctrine at time of statehood. See AA86718-IR*

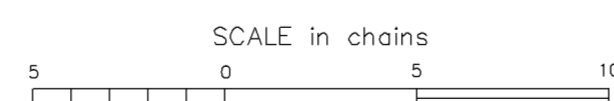
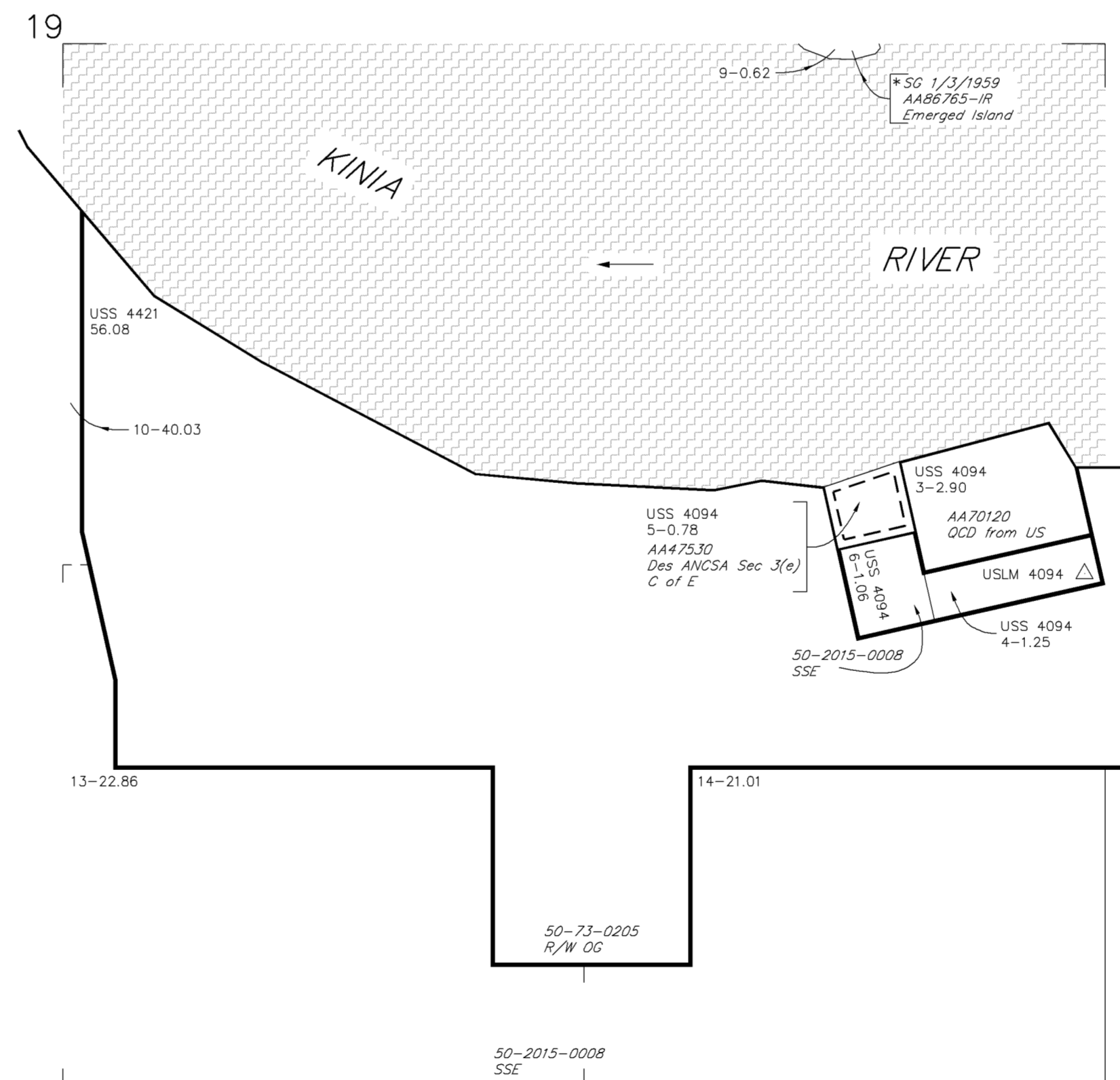

WARNING:
This plot is the Bureau's Record of Title, and should be used only as a graphic display of the township survey data. Records hereon do not reflect title changes which may have been effected by lateral movements of rivers or other bodies of water. Refer to the cadastral surveys for official survey information.

CURRENT TO	
5-20-2015	

NO 2
Sew Mer
T 1 N
R 86 W
ACAD

SURVEYED TOWNSHIP 1 NORTH RANGE 86 WEST OF THE SEWARD MERIDIAN, ALASKA

STATUS OF PUBLIC DOMAIN
LAND AND MINERAL TITLES

**MTP
SUPPL SEC'S 27 & 28**

NO 3

FOR ORDERS EFFECTING DISPOSAL OR USE OF UN-IDENTIFIED LANDS WITHDRAWN FOR CLASSIFICATION MINERALS, WATER AND/OR OTHER PUBLIC PURPOSES REFER TO INDEX OF MISCELLANEOUS DOCUMENTS.

PL 2213 Wdl Clarence Rhode National Wildlife Range affects Lds/interests not conveyed

PL 5183 Wdl Aid of Leg & Cl affects Lds/interests not conveyed

Pl 92-203 Wdl F14848

*F14848-A2 V/Sel Apin & Unpat Lds W/i:
Sec: 27*

PL 96-487 Wdl Yukon Delta NWR (Clarence Rhode Unit) entire Tp

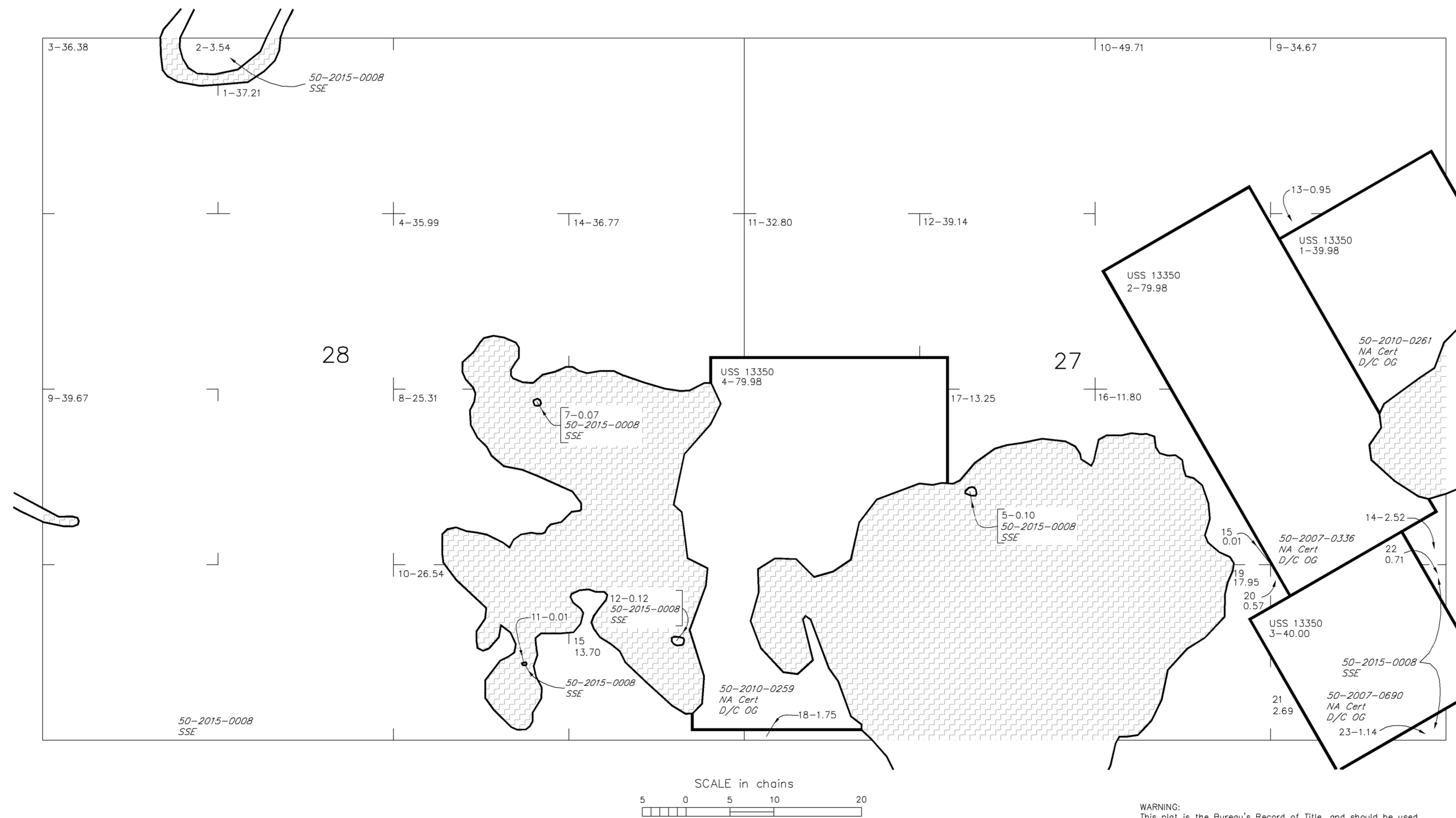

CURRENT TO		NO 3
5-20-2015		Sew Mer
		T 1 N
		R 86 W

ACAD

SURVEYED TOWNSHIP 1 NORTH RANGE 86 WEST OF THE SEWARD MERIDIAN, ALASKA

STATUS OF PUBLIC DOMAIN
LAND AND MINERAL TITLES

MTP SUPPL SEC 26

NO 4

FOR ORDERS EFFECTING DISPOSAL OR USE OF UN-IDENTIFIED LANDS WITHDRAWN FOR CLASSIFICATION MINERALS, WATER AND/OR OTHER PUBLIC PURPOSES REFER TO INDEX OF MISCELLANEOUS DOCUMENTS.

PL 0 2213 Wdl Clarence Rhode National Wildlife Range affects Lds/interests not conveyed

PL 0 5183 Wdl Aid of Leg & Cl affects Lds/interests not conveyed

PL 92-203 Wdl F14B4B

PL 96-487 Wdl Yukon Delta NWR (Clarence Rhode Unit) entire Tp

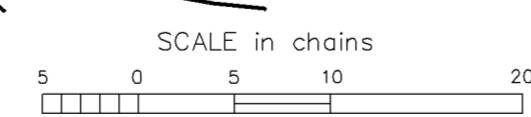

WARNING:
This plot is the Bureau's Record of Title, and should be used only as a graphic display of the township survey data. Records hereon do not reflect title changes which may have been effected by lateral movements of rivers or other bodies of water. Refer to the cadastral surveys for official survey information.

CURRENT TO	
5-20-2015	

NO 4
Sew Mer
T 1 N
R 86 W
ACAD