

| PROPERTY STATUS | | | | | | | | |
|-----------------|--------------------------|--------------------------|-------------------------|--------------------|-----------|----------|--------------------------|------------------------|
| PARCEL NO. | INTEREST TO BE ACQUIRED | GRANTOR | GRANTEE | LARGER PARCEL AREA | NET TAKE | REMAIN | RECORDED DOCUMENT NUMBER | ACQUIRED UNDER AIP NO. |
| TRACT I | FEE / SURFACE | OCEANSIDE CORPORATION | STATE OF ALASKA, DOT/PF | LARGE | 86 AC ± | LARGE | BK 19 PG 544 | 6-02-0218-01/80 |
| | FEE / SUBSURFACE | BRISTOL BAY NATIVE CORP. | STATE OF ALASKA, DOT/PF | LARGE | | | NOT ACQUIRED | |
| TRACT II | TRUSTEE PERMIT | BLM, TOWNSITE TRUSTEE | STATE OF ALASKA, DOT/PF | LARGE | 3.10 AC | LARGE | BK 19, PG 0587 | 6-02-0218-01/80 |
| TRACT III | TRUSTEE PERMIT | BLM, TOWNSITE TRUSTEE | STATE OF ALASKA, DOT/PF | LARGE | 1.05 AC | LARGE | BK 19, PG 0587 | 6-02-0218-01/80 |
| PARCEL 1 | FEE / SURFACE | OCEANSIDE CORPORATION | STATE OF ALASKA, DOT/PF | LARGE | 8.770 AC | LARGE | 2005-000470 | 3-02-0218-0105 |
| | FEE / SUBSURFACE | BRISTOL BAY NATIVE CORP. | STATE OF ALASKA, DOT/PF | LARGE | | | 2005-000469 | 3-02-0218-0105 |
| PARCEL 2 | 30 YEAR LEASE / SURFACE | STATE OF ALASKA, DCED | STATE OF ALASKA, DOT/PF | 2.197 AC | 1.667 AC | 0.523 AC | 2005-000483 | 3-02-0218-0105 |
| | FEE / SUBSURFACE | BRISTOL BAY NATIVE CORP. | STATE OF ALASKA, DOT/PF | LARGE | | | 2005-000484 | 3-02-0218-0105 |
| PARCEL 3 | FEE / SURFACE | OCEANSIDE CORPORATION | STATE OF ALASKA, DOT/PF | LARGE | 9.582 AC | LARGE | 2005-000470 | 3-02-0218-0105 |
| | FEE / SUBSURFACE | BRISTOL BAY NATIVE CORP. | STATE OF ALASKA, DOT/PF | LARGE | | | 2005-000469 | 3-02-0218-0105 |
| PARCEL 4 | 30 YEAR LEASE / SURFACE | STATE OF ALASKA, DCED | STATE OF ALASKA, DOT/PF | LARGE | 22.807 AC | LARGE | 2005-000483 | 3-02-0218-0105 |
| | FEE / SUBSURFACE | BRISTOL BAY NATIVE CORP. | STATE OF ALASKA, DOT/PF | LARGE | | | 2005-000484 | 3-02-0218-0105 |
| PARCEL 5 | AVIGATION & HAZARD EASE. | STATE OF ALASKA, DNR | STATE OF ALASKA, DOT/PF | | 16.459 AC | | TO BE ACQUIRED | 3-02-0218-0105 |
| ADA-06753 | 25 YEAR ROAD PERMIT | STATE OF ALASKA, DOT/PF | BRISTOL BAY HOUSING | | 0.647 AC | | BK 41, PG 465 | |

GENERAL NOTES

- The BASIS OF BEARINGS for this Survey, was determined by a high precision GPS survey using Leica 500 & 1200 Series receivers differentially corrected and processed using Leica Geomatics Office Version 5.0 software.
- The error of closure of this survey does not exceed 1:5000.
- All bearings shown are true bearings as oriented to the Basis of Bearing, and the distances shown are reduced to horizontal field distances.
- The purpose of this survey was to establish monumentation around the boundary of Parcels 1 - 4 of the Perryville Airport, and asphalt the new runway and improvements done as part of the reconstruction project. This survey was completed February 2007 by DOT/PF Survey Field Crews. Refer to DOT/PF field book 2007.04.01 for project notes.
- The project centerlines for the Taxiways and Airport Access Road were monumented during this survey with 2" Aluminum Caps set on 3/8" Rebar. The Runway Centerline was monumented with 3/4" Aluminum Monuments at Stations 17+20.00 and 55+69.96.
- The Natural Meanders of the line of Mean High Water of the Pacific Ocean form a portion of the True Boundary of these Parcels. The Approximate Line of Mean High Water shown is for Area Computations Only, with the True Tract Corners being on the extension of the Tract side lines and their intersection with the natural meanders of the Pacific Ocean.

LEGEND

- ⊕ Recovered Brass Cap Monument
See Sheet 3 for Description
- ⊕ Recovered Aluminum Primary Monument
See Sheet 3 for Description
- Recovered Aluminum Secondary Monument
See Sheet 3 for Description
- ⊕ Set Primary Monument This Survey
See Sheet 3 for Description
- ⊕ Set Secondary Airport Monument This Survey
See Sheet 3 for Description
- ⊕ Set Secondary Road Centerline Monument This Survey
See Sheet 3 for Description
- ⊕ Monument per Plat 2000-6, A.I.R.D.
Recovered 1999
- ⊕ Monument of Record
Not Recovered This Survey
- (xx) Record Data, "ANCSA 14(c) at Perryville"
Plat 93-9 Aleutian Islands Recording District
- xx- Record Data, "RECORD OF SURVEY, Perryville Airport Boundary"
Plat 2000-6 Aleutian Islands Recording District
- < xx > Record Data, "Oceanside Estates Subdivision"
Plat 89-8, Aleutian Islands Recording District
- [xx] Record Data, "Perryville Tank Farm Road ROW"
Plat 2004-10, Aleutian Islands Recording District
- Surveyed Airport Boundary
- Surveyed Parcel Boundary
- Surveyed Centerline
- Un-Surveyed
- Fee Parcel
- Lease Parcel
- Avigation & Hazard Easement
- Existing Road Right-of-Way
- XXXX Monument Number This Survey
See Sheet 3

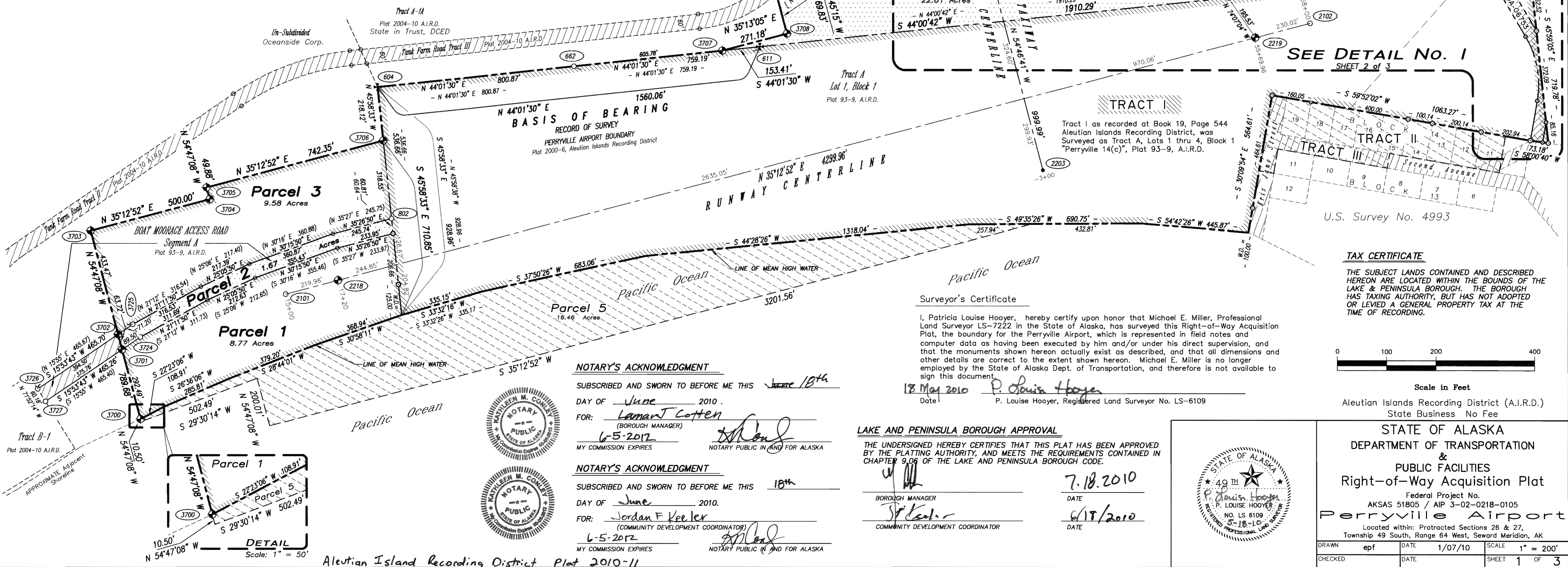
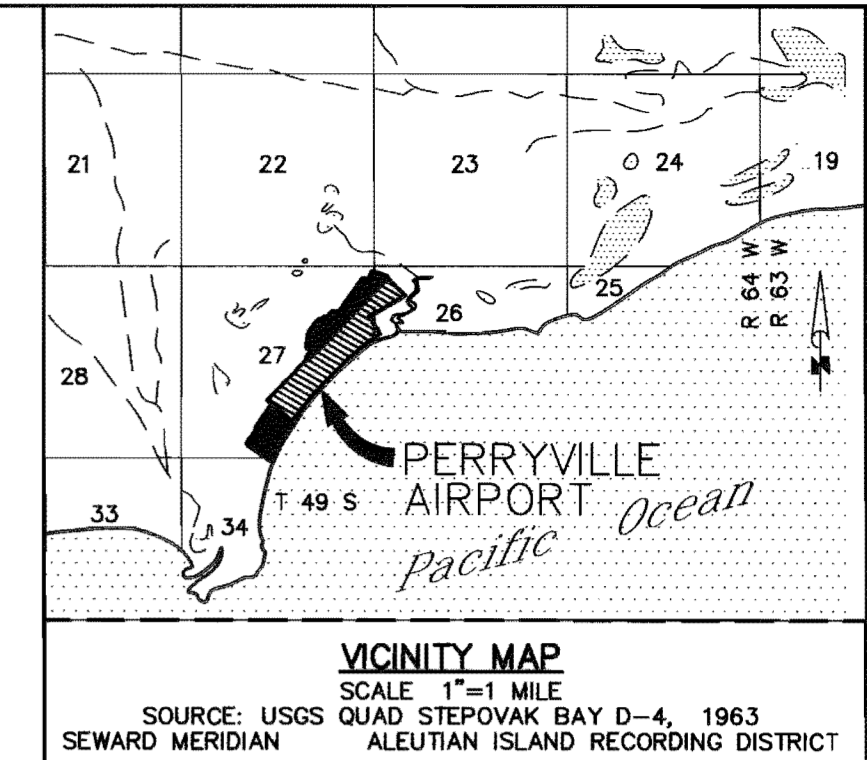

NOTARY'S ACKNOWLEDGMENT
 SUBSCRIBED AND SWORN TO BEFORE ME THIS June 18th
 DAY OF June 2010.
 FOR: Laman J Cotten
 (BOROUGH MANAGER)
6-5-2012
 MY COMMISSION EXPIRES _____ NOTARY PUBLIC IN AND FOR ALASKA

NOTARY'S ACKNOWLEDGMENT
 SUBSCRIBED AND SWORN TO BEFORE ME THIS 18th
 DAY OF June 2010.
 FOR: Jordan F Keeler
 (COMMUNITY DEVELOPMENT COORDINATOR)
6-5-2012
 MY COMMISSION EXPIRES _____ NOTARY PUBLIC IN AND FOR ALASKA

Surveyor's Certificate
 I, Patricia Louise Hooyer, hereby certify upon honor that Michael E. Miller, Professional Land Surveyor LS-7222 in the State of Alaska, has surveyed this Right-of-Way Acquisition Plat, the boundary for the Perryville Airport, which is represented in field notes and computer data as having been executed by him and/or under his direct supervision, and that the monuments shown hereon actually exist as described, and that all dimensions and other details are correct to the extent shown hereon. Michael E. Miller is no longer employed by the State of Alaska Dept. of Transportation, and therefore is not available to sign this document.
 Date 18 May 2010 P. Louise Hooyer
 P. Louise Hooyer, Registered Land Surveyor No. LS-6109

LAKE AND PENINSULA BOROUGH APPROVAL
 THE UNDERSIGNED HEREBY CERTIFIES THAT THIS PLAT HAS BEEN APPROVED BY THE PLATTING AUTHORITY, AND MEETS THE REQUIREMENTS CONTAINED IN CHAPTER 9.06 OF THE LAKE AND PENINSULA BOROUGH CODE.
 BOROUGH MANAGER [Signature] DATE 7.18.2010
 COMMUNITY DEVELOPMENT COORDINATOR [Signature] DATE 6/18/2010

TAX CERTIFICATE
 THE SUBJECT LANDS CONTAINED AND DESCRIBED HEREON ARE LOCATED WITHIN THE BOUNDS OF THE LAKE & PENINSULA BOROUGH. THE BOROUGH HAS TAXING AUTHORITY, BUT HAS NOT ADOPTED OR LEVIED A GENERAL PROPERTY TAX AT THE TIME OF RECORDING.

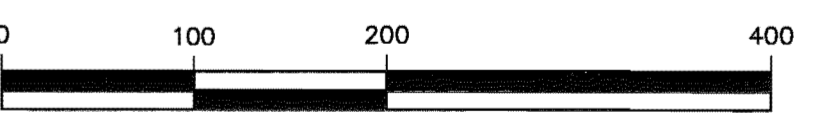

Scale in Feet
 Aleutian Islands Recording District (A.I.R.D.)
 State Business No Fee

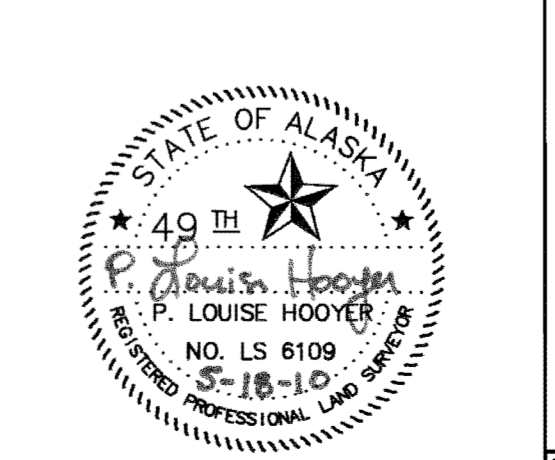

STATE OF ALASKA
 DEPARTMENT OF TRANSPORTATION
 &
 PUBLIC FACILITIES
 Right-of-Way Acquisition Plat
 Federal Project No.
 AKSAS 51805 / AIP 3-02-0218-0105
Perryville Airport
 Located within: Protracted Sections 26 & 27,
 Township 49 South, Range 64 West, Seward Meridian, AK

| | | | | | |
|---------|-----|------|---------|-------|-----------|
| DRAWN | epf | DATE | 1/07/10 | SCALE | 1" = 200' |
| CHECKED | | DATE | | SHEET | 1 OF 3 |

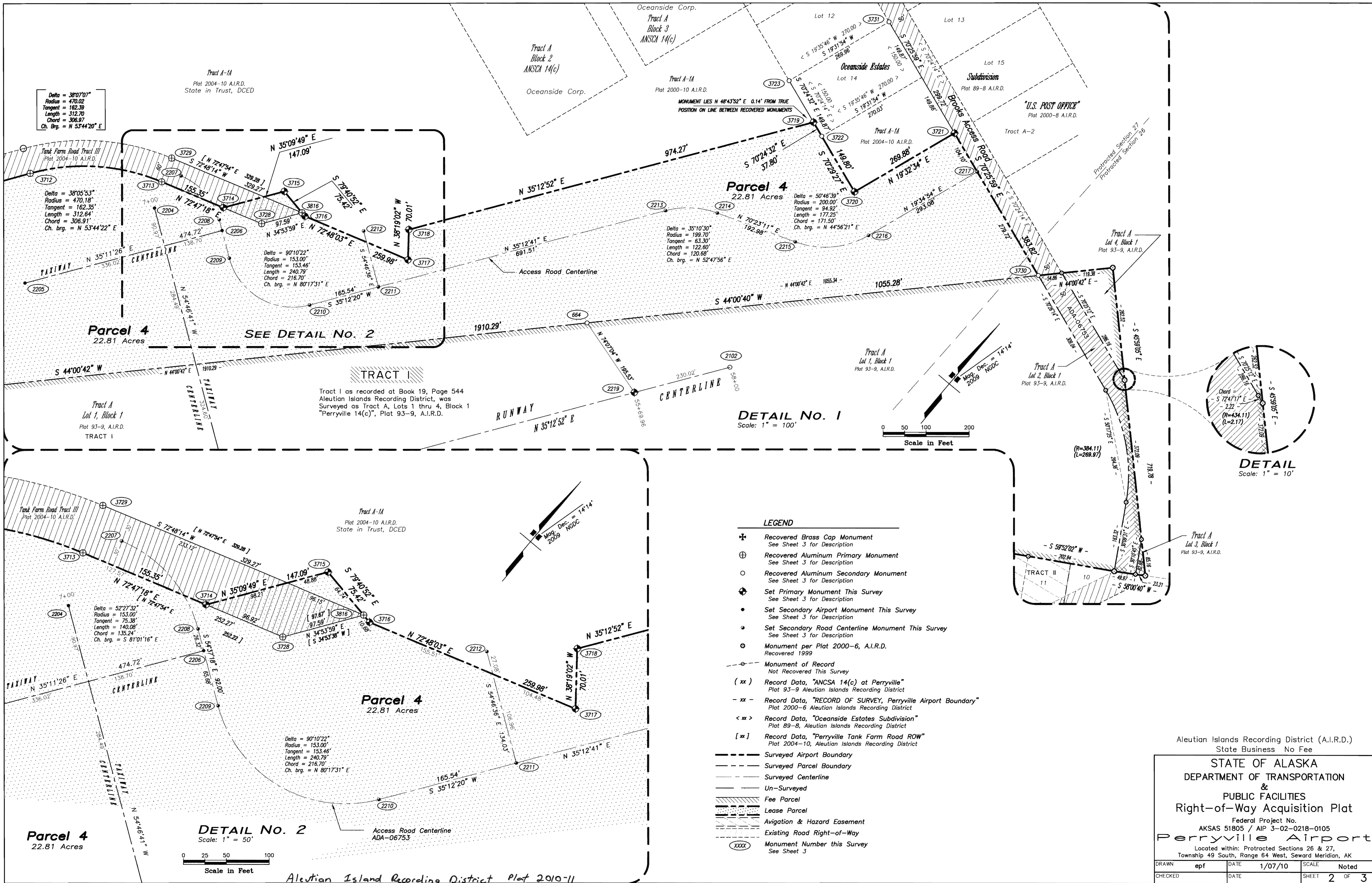

Delta = 38°07'07"
 Radius = 470.02
 Tangent = 162.39
 Length = 312.70
 Chord = 306.97
 Ch. brg. = N 53°44'20" E

Delta = 38°05'53"
 Radius = 470.18
 Tangent = 162.35
 Length = 312.64
 Chord = 306.91
 Ch. brg. = N 53°44'22" E

Delta = 90°10'22"
 Radius = 153.00
 Tangent = 153.46
 Length = 240.79
 Chord = 216.70
 Ch. brg. = N 80°17'31" E

Delta = 35°10'30"
 Radius = 199.70
 Tangent = 63.30
 Length = 122.60
 Chord = 120.68
 Ch. brg. = N 52°47'56" E

Delta = 50°46'39"
 Radius = 200.00
 Tangent = 94.92
 Length = 177.25
 Chord = 171.50
 Ch. brg. = N 44°56'21" E

Tract I as recorded at Book 19, Page 544
 Aleutian Islands Recording District, was
 Surveyed as Tract A, Lots 1 thru 4, Block 1
 "Perryville 14(c)", Plat 93-9, A.I.R.D.

DETAIL NO. 1
 Scale: 1" = 100'

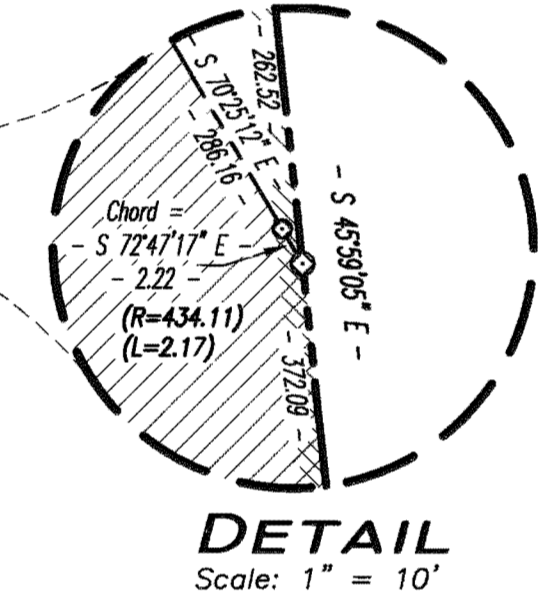
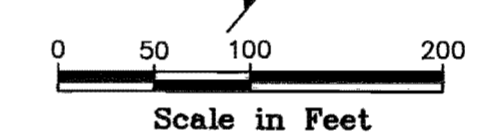

DETAIL
 Scale: 1" = 10'

- LEGEND**
- ⊕ Recovered Brass Cap Monument
See Sheet 3 for Description
 - ⊕ Recovered Aluminum Primary Monument
See Sheet 3 for Description
 - Recovered Aluminum Secondary Monument
See Sheet 3 for Description
 - ⊕ Set Primary Monument This Survey
See Sheet 3 for Description
 - Set Secondary Monument This Survey
See Sheet 3 for Description
 - Set Secondary Road Centerline Monument This Survey
See Sheet 3 for Description
 - Monument per Plat 2000-6, A.I.R.D.
Recovered 1999
 - Monument of Record
Not Recovered This Survey
 - (xx) Record Data, "ANCSA 14(c) at Perryville"
Plat 93-9 Aleutian Islands Recording District
 - xx- Record Data, "RECORD OF SURVEY, Perryville Airport Boundary"
Plat 2000-6 Aleutian Islands Recording District
 - <xx> Record Data, "Oceanside Estates Subdivision"
Plat 89-8, Aleutian Islands Recording District
 - [xx] Record Data, "Perryville Tank Farm Road ROW"
Plat 2004-10, Aleutian Islands Recording District
 - Surveyed Airport Boundary
 - Surveyed Parcel Boundary
 - Surveyed Centerline
 - Un-Surveyed
 - ▨ Fee Parcel
 - ▨ Lease Parcel
 - ▨ Avigation & Hazard Easement
 - Existing Road Right-of-Way
 - XXXX Monument Number This Survey
See Sheet 3

DETAIL NO. 2
 Scale: 1" = 50'

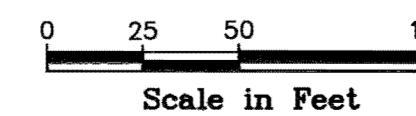

Aleutian Island Recording District Plot 2010-11

Aleutian Islands Recording District (A.I.R.D.)
 State Business No Fee

STATE OF ALASKA
 DEPARTMENT OF TRANSPORTATION
 &
 PUBLIC FACILITIES
 Right-of-Way Acquisition Plat
 Federal Project No.
 AKSAS 51805 / AIP 3-02-0218-0105
Perryville Airport
 Located within: Protracted Sections 26 & 27,
 Township 49 South, Range 64 West, Seward Meridian, AK

| | | | | | |
|---------|-----|------|---------|-------|--------|
| DRAWN | epf | DATE | 1/07/10 | SCALE | Noted |
| CHECKED | | DATE | | SHEET | 2 OF 3 |

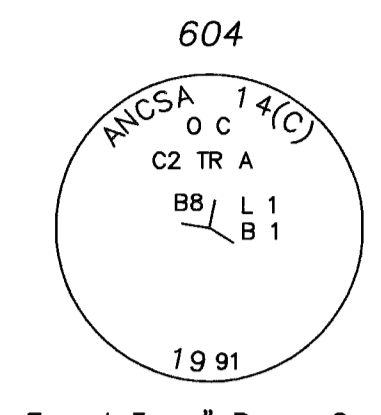

604
Found 3 1/2" Brass Cap Monument flush with ground.

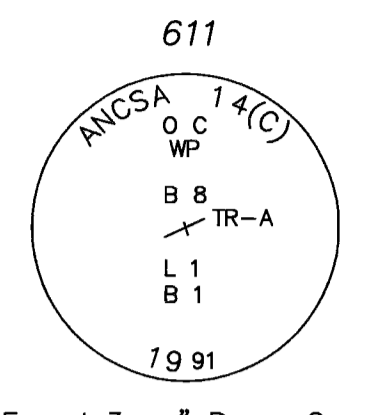

611
Found 3 1/2" Brass Cap Monument 0.1 feet above ground.

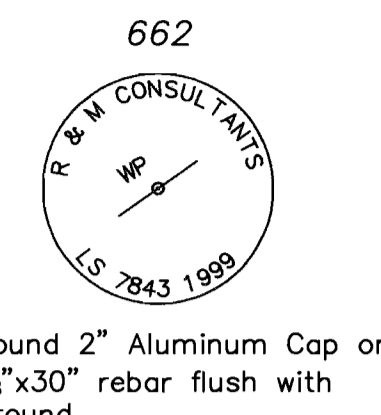

662
Found 2" Aluminum Cap on 3/8"x30" rebar flush with ground.

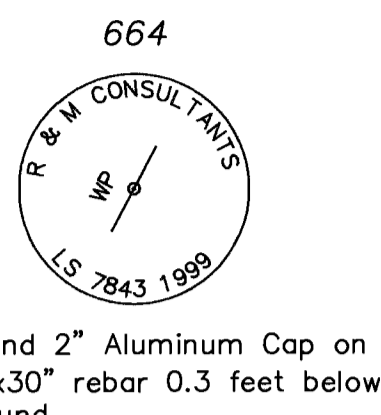

664
Found 2" Aluminum Cap on 3/8"x30" rebar 0.3 feet below ground.

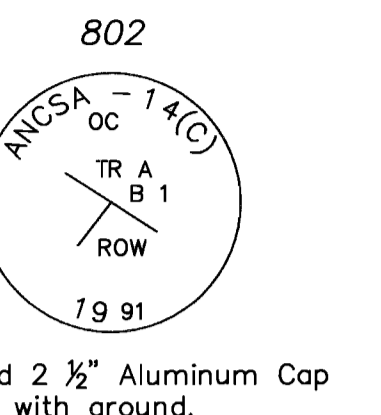

802
Found 2 1/2" Aluminum Cap flush with ground.

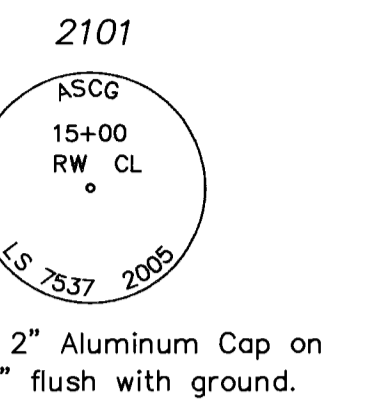

2101
Found 2" Aluminum Cap on 3/8"x30" flush with ground.

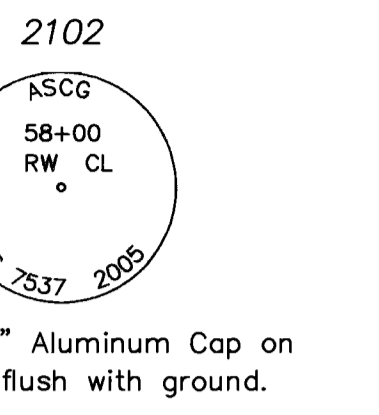

2102
Found 2" Aluminum Cap on 3/8"x30" flush with ground.

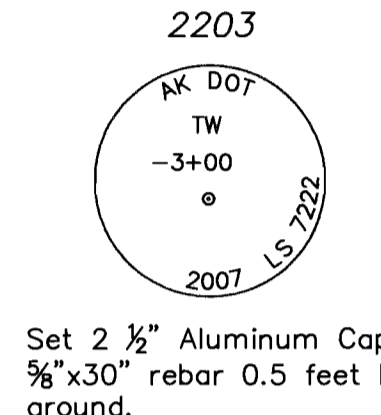

2203
Set 2 1/2" Aluminum Cap on 3/8"x30" rebar 0.5 feet below ground.

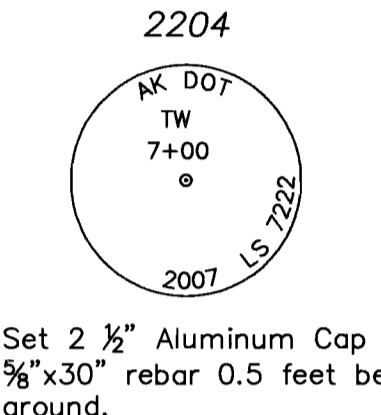

2204
Set 2 1/2" Aluminum Cap on 3/8"x30" rebar 0.5 feet below ground.

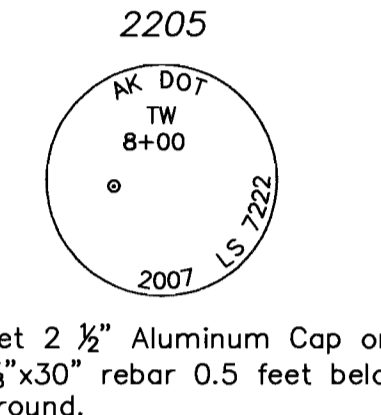

2205
Set 2 1/2" Aluminum Cap on 3/8"x30" rebar 0.5 feet below ground.

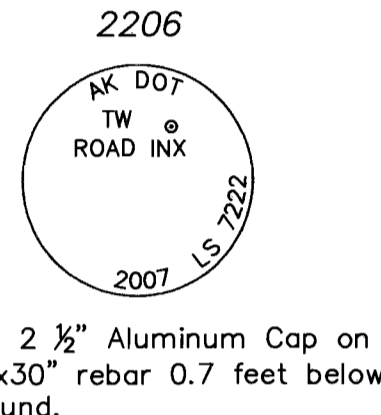

2206
Set 2 1/2" Aluminum Cap on 3/8"x30" rebar 0.7 feet below ground.

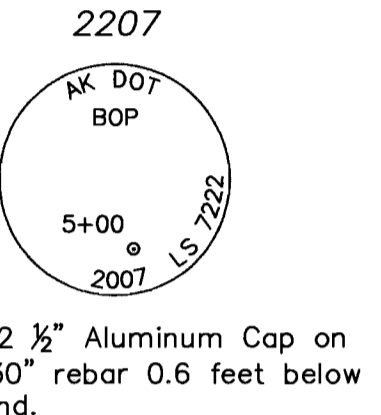

2207
Set 2 1/2" Aluminum Cap on 3/8"x30" rebar 0.6 feet below ground.

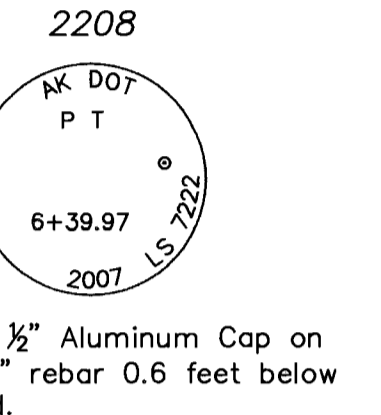

2208
Set 2 1/2" Aluminum Cap on 3/8"x30" rebar 0.6 feet below ground.

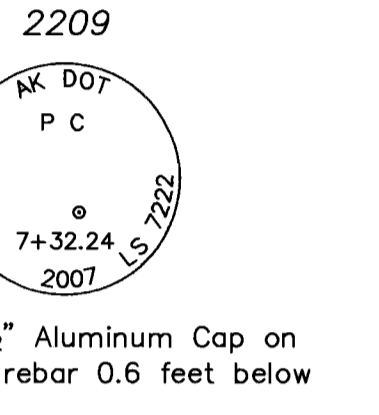

2209
Set 2 1/2" Aluminum Cap on 3/8"x30" rebar 0.6 feet below ground.

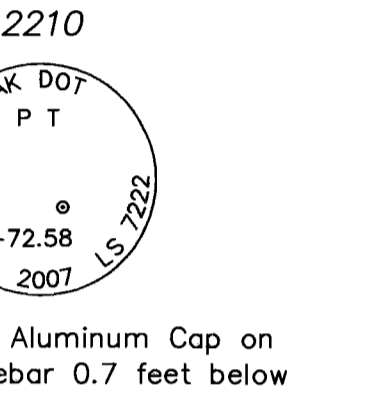

2210
Set 2 1/2" Aluminum Cap on 3/8"x30" rebar 0.7 feet below ground.

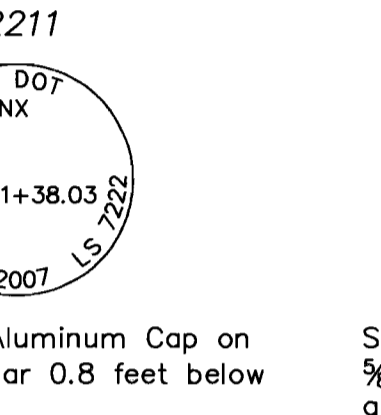

2211
Set 2 1/2" Aluminum Cap on 3/8"x30" rebar 0.8 feet below ground.

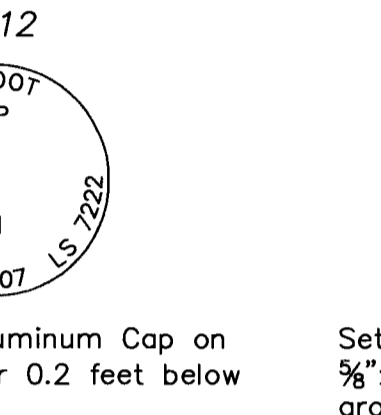

2212
Set 2 1/2" Aluminum Cap on 3/8"x30" rebar 0.2 feet below ground.

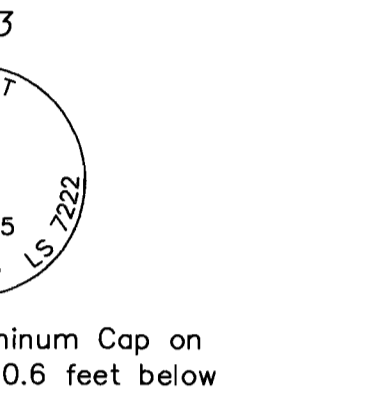

2213
Set 2 1/2" Aluminum Cap on 3/8"x30" rebar 0.6 feet below ground.

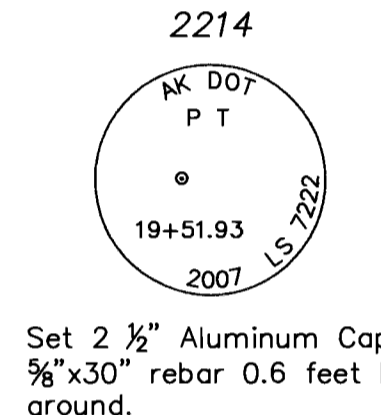

2214
Set 2 1/2" Aluminum Cap on 3/8"x30" rebar 0.6 feet below ground.

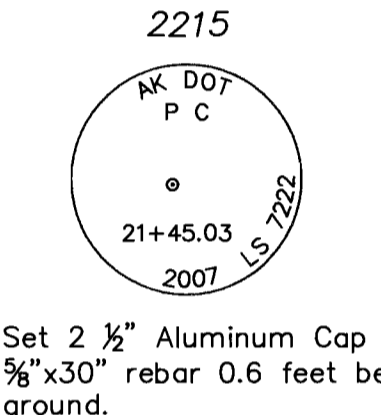

2215
Set 2 1/2" Aluminum Cap on 3/8"x30" rebar 0.6 feet below ground.

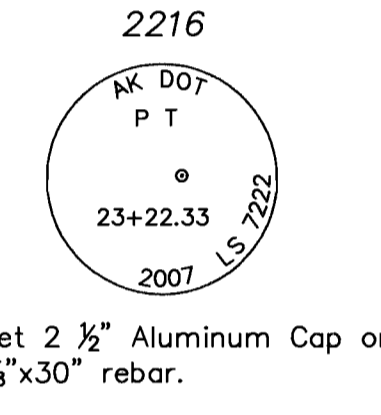

2216
Set 2 1/2" Aluminum Cap on 3/8"x30" rebar.

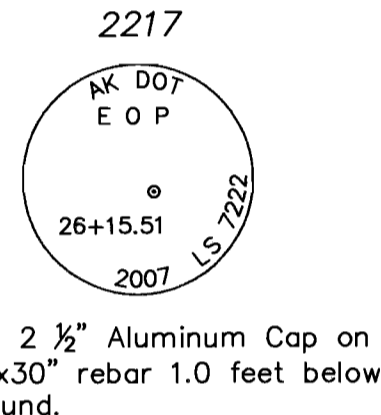

2217
Set 2 1/2" Aluminum Cap on 3/8"x30" rebar 1.0 feet below ground.

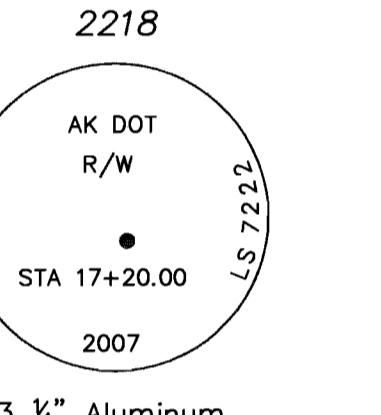

2218
Set 3 1/4" Aluminum Monument 0.7 feet below ground.

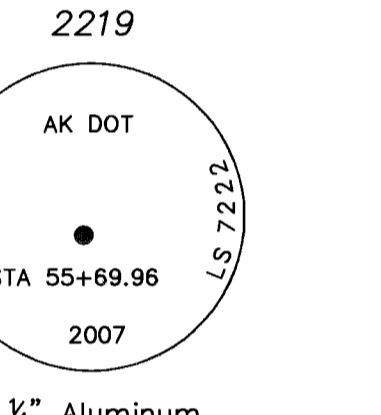

2219
Set 3 1/4" Aluminum Monument 0.6 feet below ground.

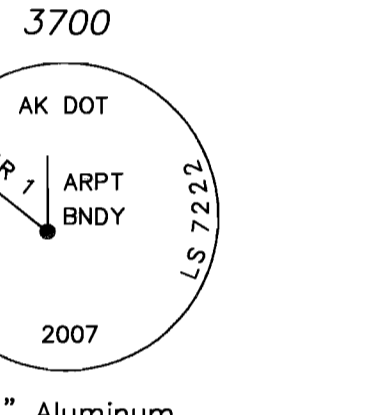

3700
Set 3 1/4" Aluminum Monument 0.4 feet below ground.

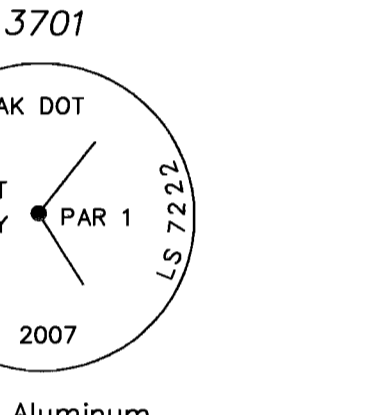

3701
Set 3 1/4" Aluminum Monument 0.2 feet below ground.

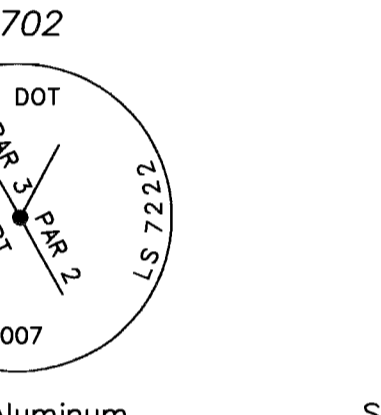

3702
Set 3 1/4" Aluminum Monument 0.3 feet below ground.

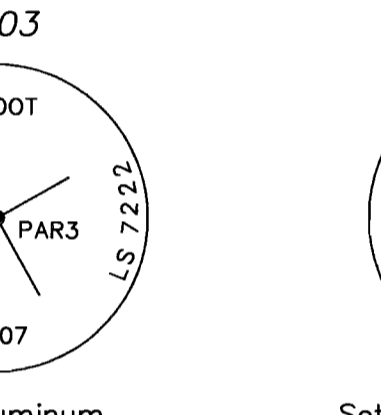

3703
Set 3 1/4" Aluminum Monument 0.2 feet below ground.

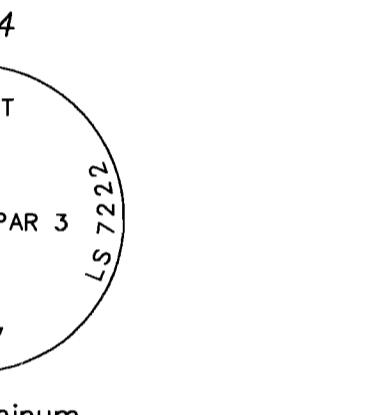

3704
Set 3 1/4" Aluminum Monument 0.2 feet below ground.

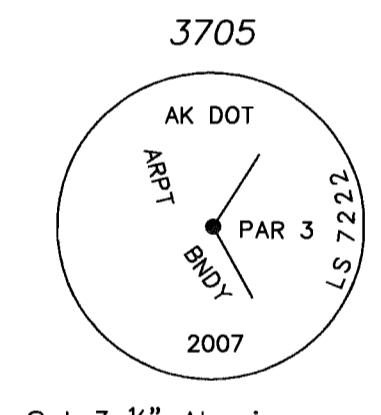

3705
Set 3 1/4" Aluminum Monument 0.2 feet below ground.

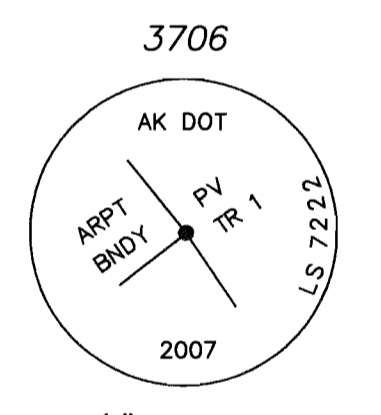

3706
Set 3 1/4" Aluminum Monument 0.4 feet below ground.

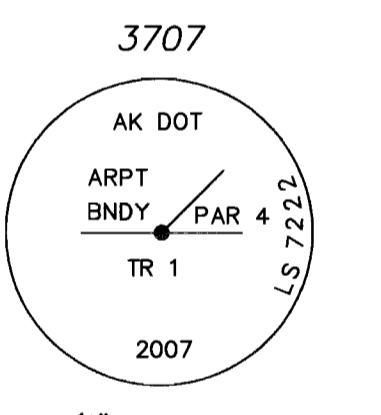

3707
Set 3 1/4" Aluminum Monument 0.3 feet below ground.

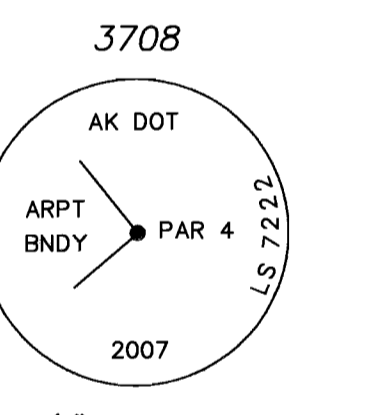

3708
Set 3 1/4" Aluminum Monument 0.3 feet below ground.

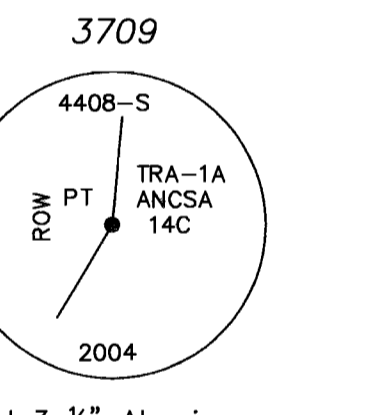

3709
Found 3 1/4" Aluminum Monument flush with ground.

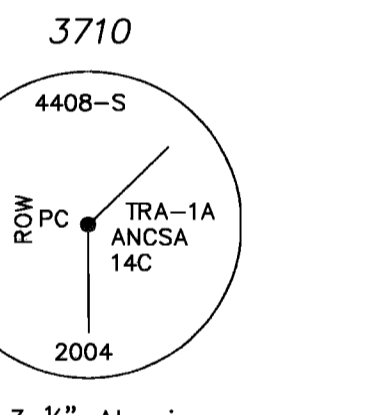

3710
Found 3 1/4" Aluminum Monument flush with ground.

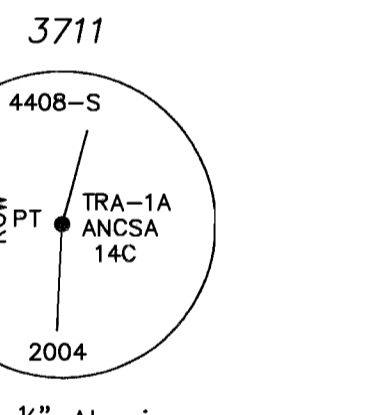

3711
Found 3 1/4" Aluminum Monument flush with ground.

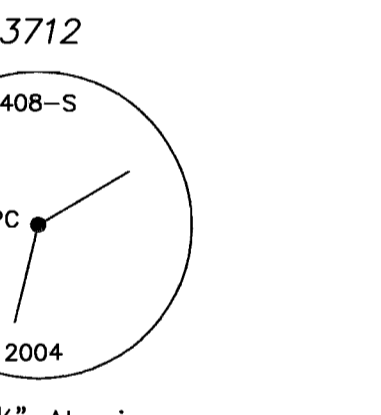

3712
Found 3 1/4" Aluminum Monument flush with ground.

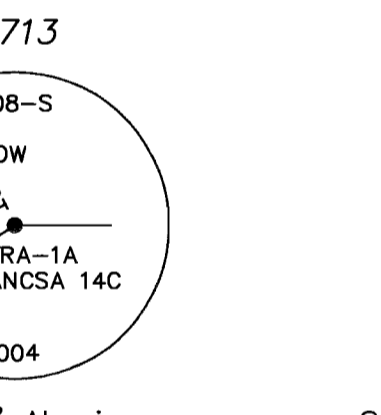

3713
Found 3 1/4" Aluminum Monument flush with ground.

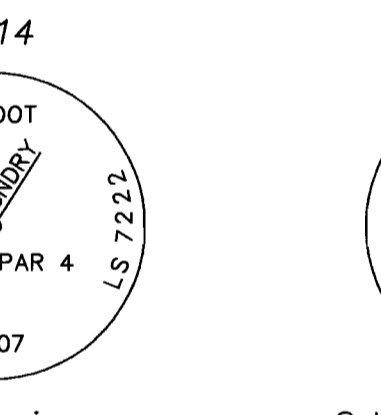

3714
Set 3 1/4" Aluminum Monument 0.6 feet below ground.

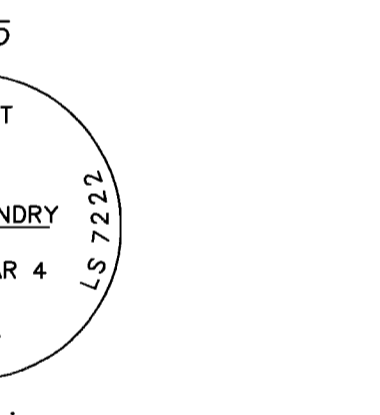

3715
Set 3 1/4" Aluminum Monument.

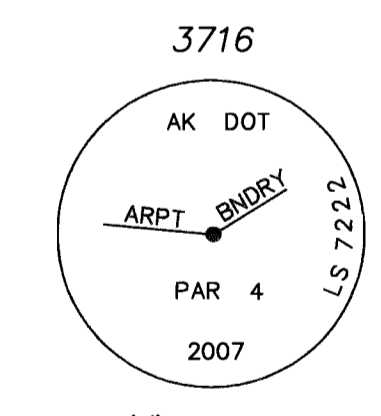

3716
Set 3 1/4" Aluminum Monument flush with ground.

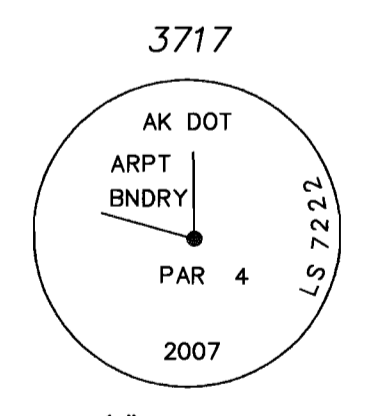

3717
Set 3 1/4" Aluminum Monument.

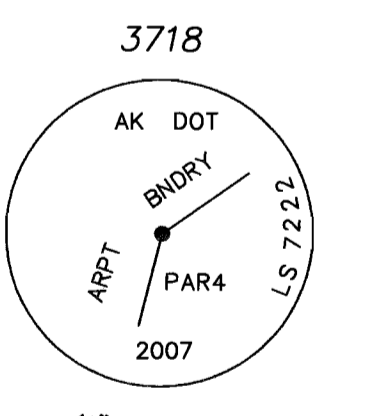

3718
Set 3 1/4" Aluminum Monument 0.1 feet below ground.

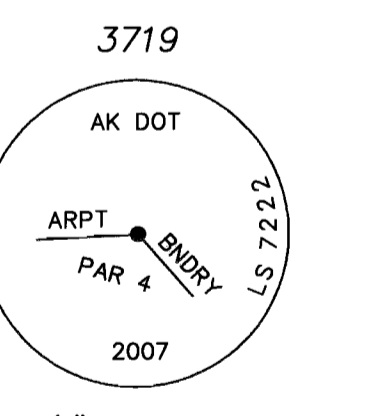

3719
Set 3 1/4" Aluminum Monument 0.2 feet below ground.

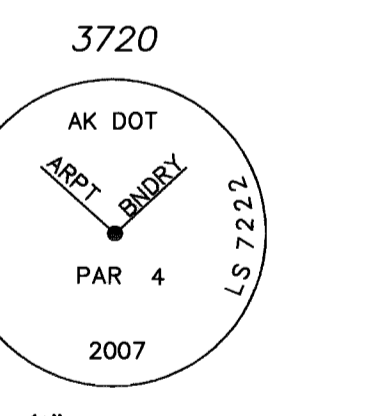

3720
Set 3 1/4" Aluminum Monument 0.3 feet below ground.

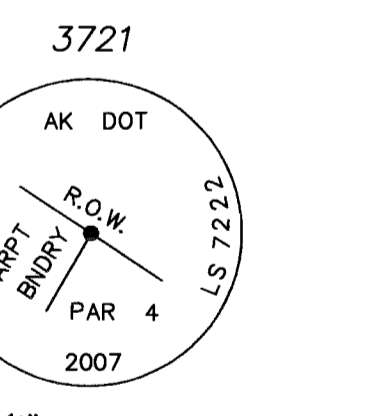

3721
Set 3 1/4" Aluminum Monument flush with ground.

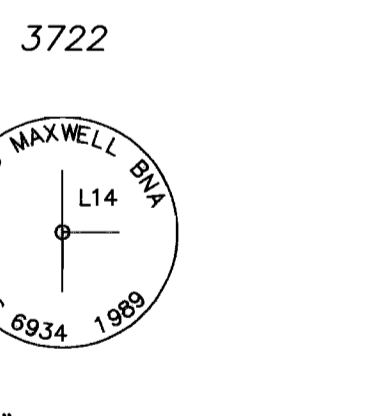

3722
Found 2" Aluminum Cap 0.2 feet above ground.

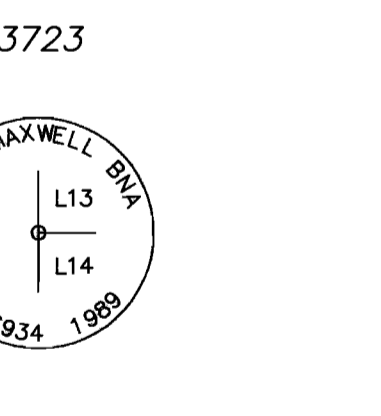

3723
Found 2" Aluminum Cap 0.3 feet above ground.

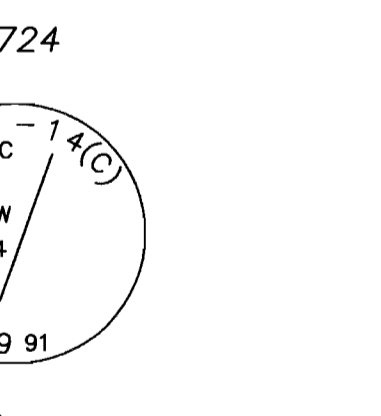

3724
Found 2 1/2" Aluminum Cap 0.3 feet below ground.

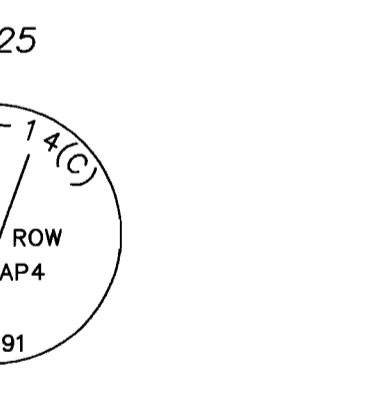

3725
Found 2 1/2" Aluminum Cap.

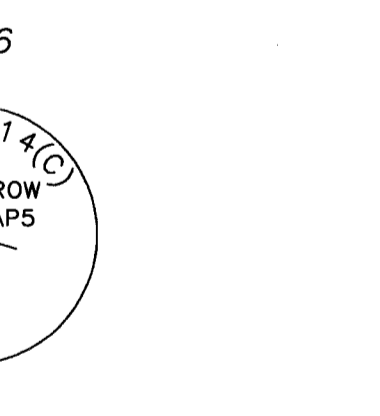

3726
Found 2 1/2" Aluminum Cap 0.1 feet below ground.

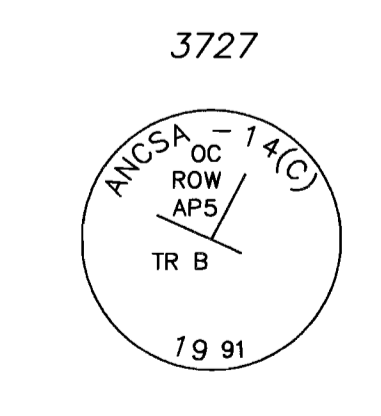

3727
Found 2 1/2" Aluminum Cap on 3/8" rebar 1.0 feet below ground. Rebar is leaning northerly approx 0.2 feet.

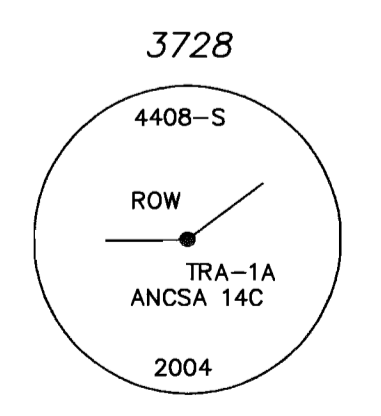

3728
Found 3 1/4" Aluminum Monument flush with ground.

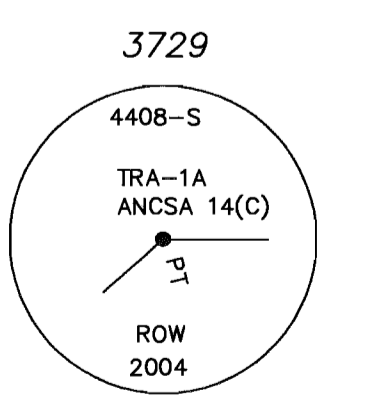

3729
Found 3 1/4" Aluminum Monument flush with ground.

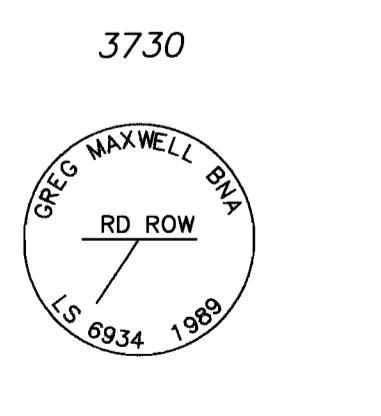

3730
Found 2 1/2" Aluminum Cap.

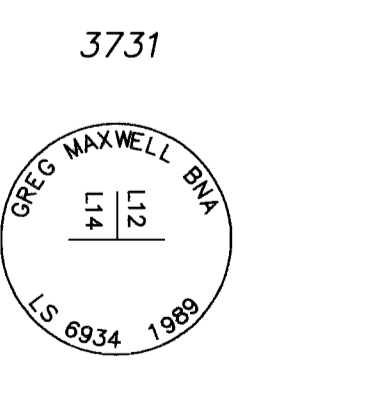

3731
Found 2 1/2" Aluminum Cap 1.2 feet below ground.

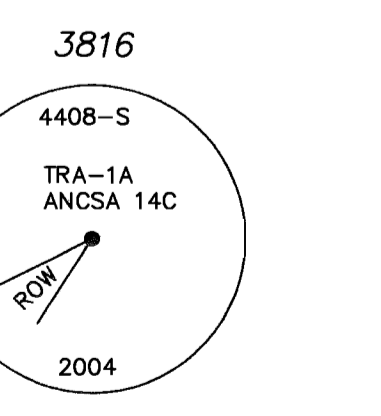

3816
Found 3 1/4" Aluminum Monument flush with ground.

2010-11
Aleutian Islands
DIST
6-222010
DATE
2:36 PM
TIME

Aleutian Islands Recording District (A.I.R.D.)
State Business No Fee

STATE OF ALASKA
DEPARTMENT OF TRANSPORTATION
&
PUBLIC FACILITIES
Right-of-Way Acquisition Plat

Federal Project No.
AKSAS 51805 / AIP 3-02-0218-0105
Perryville Airport

Located within: Protracted Sections 26 & 27,
Township 49 South, Range 64 West, Seward Meridian, AK

| | | | | | |
|---------|-----|------|---------|-------|--------|
| DRAWN | epf | DATE | 1/07/10 | SCALE | NONE |
| CHECKED | | DATE | | SHEET | 3 OF 3 |