

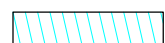

**LEGEND**

- PATENTED RR LANDS 
- EXISTING HIGHWAY ROW 
- EX HWY ROW TO BE RELINQUISHED TO DNR 
- RELOCATED HIGHWAY CORRIDOR 
- EXISTING RIP RAP TOE 

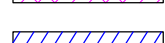
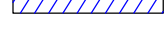
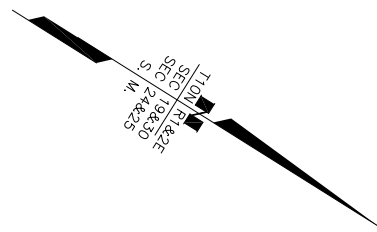

TURNAGAIN ARM

BEGIN BASE MAPPING  
STA 1217+05.46

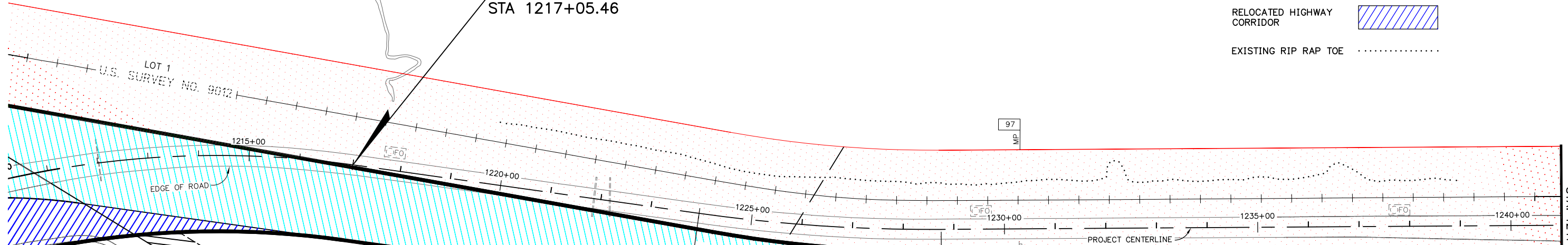

MATCH LINE SHEET 7  
STA. 1241+00

ANCHORAGE RECORDING DISTRICT

DATE	REVISIONS	BY



**DRAFT**

STATE OF ALASKA  
DEPARTMENT OF TRANSPORTATION  
&  
PUBLIC FACILITIES  
RIGHT OF WAY BASE MAP  
ALASKA PROJECT  
0A31 (051)  
59765  
SEWARD HIGHWAY: RIGHT OF WAY STUDY  
MP 97-105

DRAWN	GEL	DATE	1/27/2014	SCALE	1"=100'
CHECKED	WDC	DATE	1/27/2014	SHEET	6 OF 21

**LEGEND**

- PATENTED RR LANDS
- EXISTING HIGHWAY ROW
- EX HWY ROW TO BE RELINQUISHED TO DNR
- RELOCATED HIGHWAY CORRIDOR
- EXISTING RIP RAP TOE

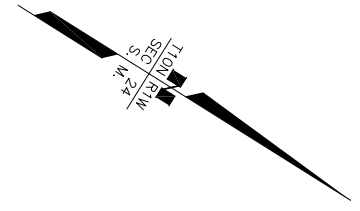

TURNAGAIN ARM

MATCH LINE SHEET 6  
STA. 1241+00.00

MATCH LINE SHEET 8  
STA. 1270+00.00

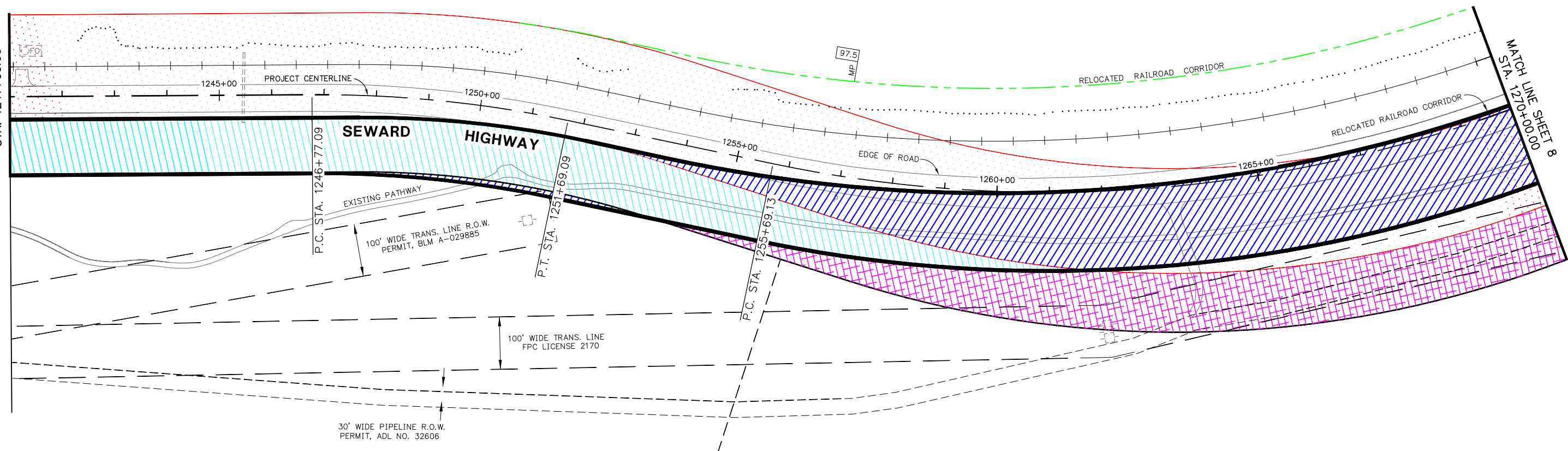

P.C. STA. 1246+77.09  
EXISTING PATHWAY  
100' WIDE TRANS. LINE R.O.W.  
PERMIT, BLM A-029885

P.T. STA. 1251+69.09

P.C. STA. 1255+69.13

100' WIDE TRANS. LINE  
FPC LICENSE 2170

30' WIDE PIPELINE R.O.W.  
PERMIT, ADL NO. 32606

BLM LOT 1  
SECC. 24  
T10N R1W

CHUGACH STATE PARK

STATE OF ALASKA MATERIAL SITE  
MS 31-2-021-1  
ADL 22792

**DRAFT**



CONSULTANT RIGHT OF WAY SURVEYORS CERTIFICATE

ANCHORAGE RECORDING DISTRICT

DATE	REVISIONS	BY

STATE OF ALASKA  
DEPARTMENT OF TRANSPORTATION  
&  
PUBLIC FACILITIES  
RIGHT OF WAY BASE MAP  
ALASKA PROJECT  
**0A31 (051)**  
59765  
SEWARD HIGHWAY: RIGHT OF WAY STUDY  
MP 97-105

DRAWN	GEL	DATE	1/27/2014	SCALE	1"=100'
CHECKED	WDC	DATE	1/27/2014	SHEET	7 OF 21

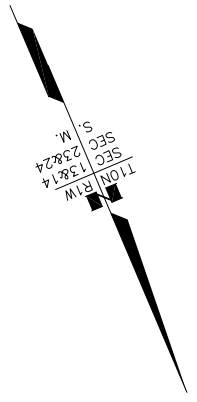

TURNAGAIN ARM

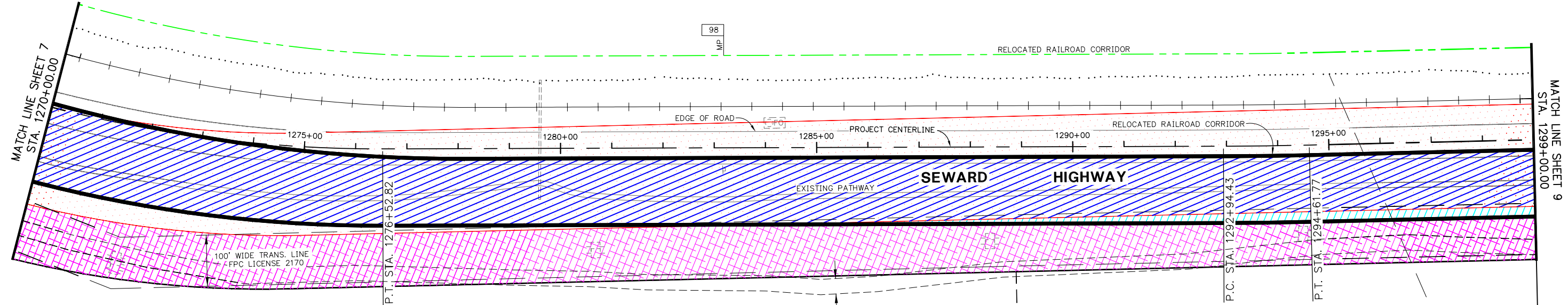

LEGEND

- PATENTED RR LANDS
- EXISTING HIGHWAY ROW
- EX HWY ROW TO BE RELINQUISHED TO DNR
- RELOCATED HIGHWAY CORRIDOR
- EXISTING RIP RAP TOE

STATE OF ALASKA MATERIAL SITE  
MS 31-2-021-1  
ADL 22792

30' WIDE PIPELINE R.O.W.  
PERMIT, ADL NO. 32606

CHUGACH STATE PARK

**DRAFT**



CONSULTANT RIGHT OF WAY SURVEYORS CERTIFICATE

ANCHORAGE RECORDING DISTRICT

DATE	REVISIONS	BY

STATE OF ALASKA  
DEPARTMENT OF TRANSPORTATION  
&  
PUBLIC FACILITIES  
RIGHT OF WAY BASE MAP  
ALASKA PROJECT  
0A31 (051)  
59765  
SEWARD HIGHWAY: RIGHT OF WAY STUDY  
MP 97-105

DRAWN	GEL	DATE	1/27/2014	SCALE	1"=100'
CHECKED	WDC	DATE	1/27/2014	SHEET	8 OF 21

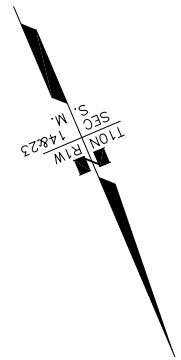

TURNAGAIN ARM

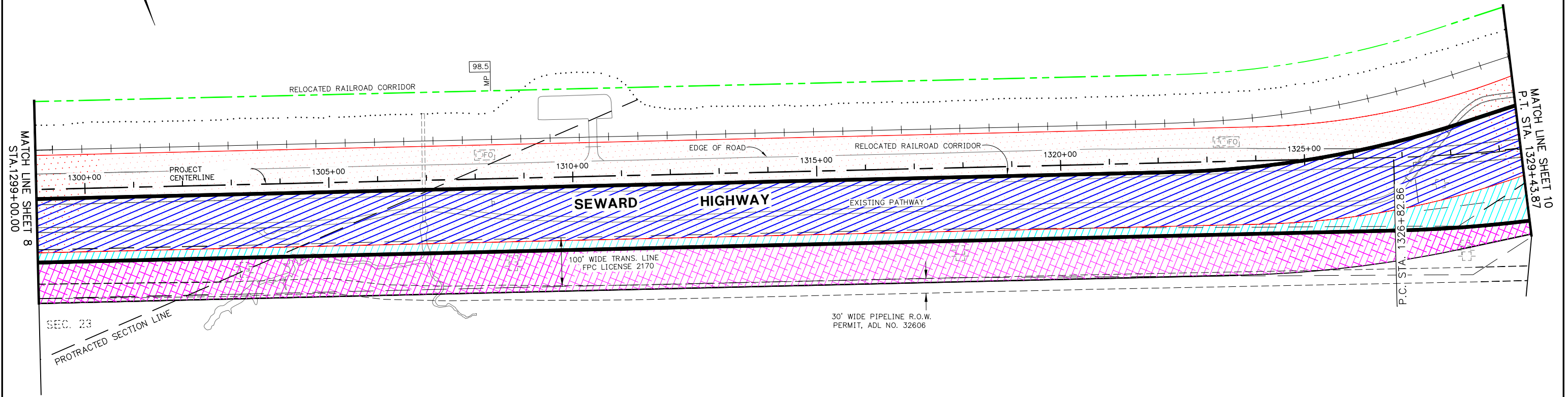

**LEGEND**

PATENTED RR LANDS	
EXISTING HIGHWAY ROW	
EX HWY ROW TO BE RELINQUISHED TO DNR	
RELOCATED HIGHWAY CORRIDOR	
EXISTING RIP RAP TOE	

SEC. 14  
T10N R1W  
CHUGACH STATE PARK

**DRAFT**



CONSULTANT RIGHT OF WAY SURVEYORS CERTIFICATE



ANCHORAGE RECORDING DISTRICT

DATE	REVISIONS	BY

STATE OF ALASKA  
DEPARTMENT OF TRANSPORTATION & PUBLIC FACILITIES  
RIGHT OF WAY BASE MAP  
ALASKA PROJECT  
0A31 (051)  
59765  
SEWARD HIGHWAY: RIGHT OF WAY STUDY  
MP 90-97

DRAWN	GEL	DATE	1/27/2014	SCALE	1"=100'
CHECKED	WDC	DATE	1/27/2014	SHEET	9 OF 21

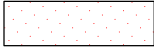
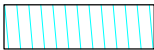
LEGEND

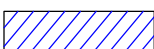
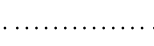
- PATENTED RR LANDS 
- EXISTING HIGHWAY ROW 
- EX HWY ROW TO BE RELINQUISHED TO DNR 
- RELOCATED HIGHWAY CORRIDOR 
- EXISTING RIP RAP TOE 

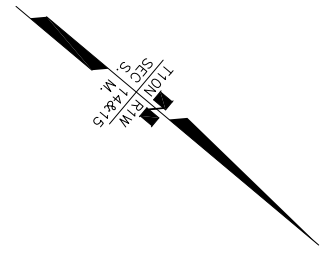

TURNAGAIN ARM

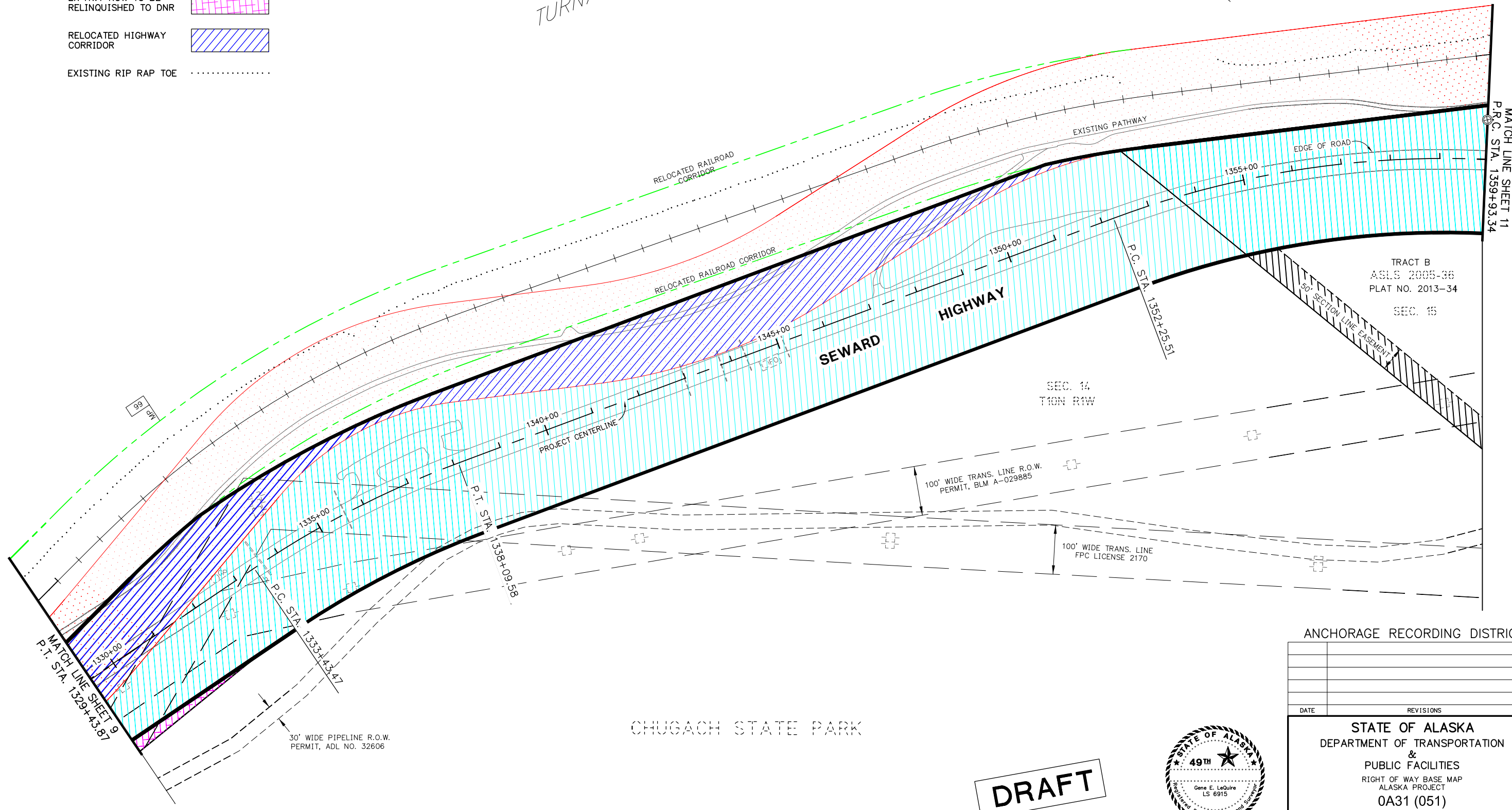

CHUGACH STATE PARK

ANCHORAGE RECORDING DISTRICT

DATE	REVISIONS	BY

**DRAFT**



CONSULTANT RIGHT OF WAY SURVEYORS CERTIFICATE

STATE OF ALASKA  
 DEPARTMENT OF TRANSPORTATION  
 &  
 PUBLIC FACILITIES  
 RIGHT OF WAY BASE MAP  
 ALASKA PROJECT  
 0A31 (051)  
 SEWARD HIGHWAY: RIGHT OF WAY STUDY

DRAWN	GEL	DATE	1/27/2014	SCALE	1"=100'
CHECKED	WDC	DATE	1/27/2014	SHEET	10 OF 21