

Interior Gas Utility (Phase II)

December 17, 2014

ATTACHMENT "C": FNSB/CITY OF NORTH POLE ROAD SERVICE AREA MAPS

- RSA Index (1 page)
- RSA Maps (18 pages)



Innovating Today for Alaska's Tomorrow

IGU Phase II

Road Service Districts within Phase II Area

Legend

-  FNSB Road Service Districts

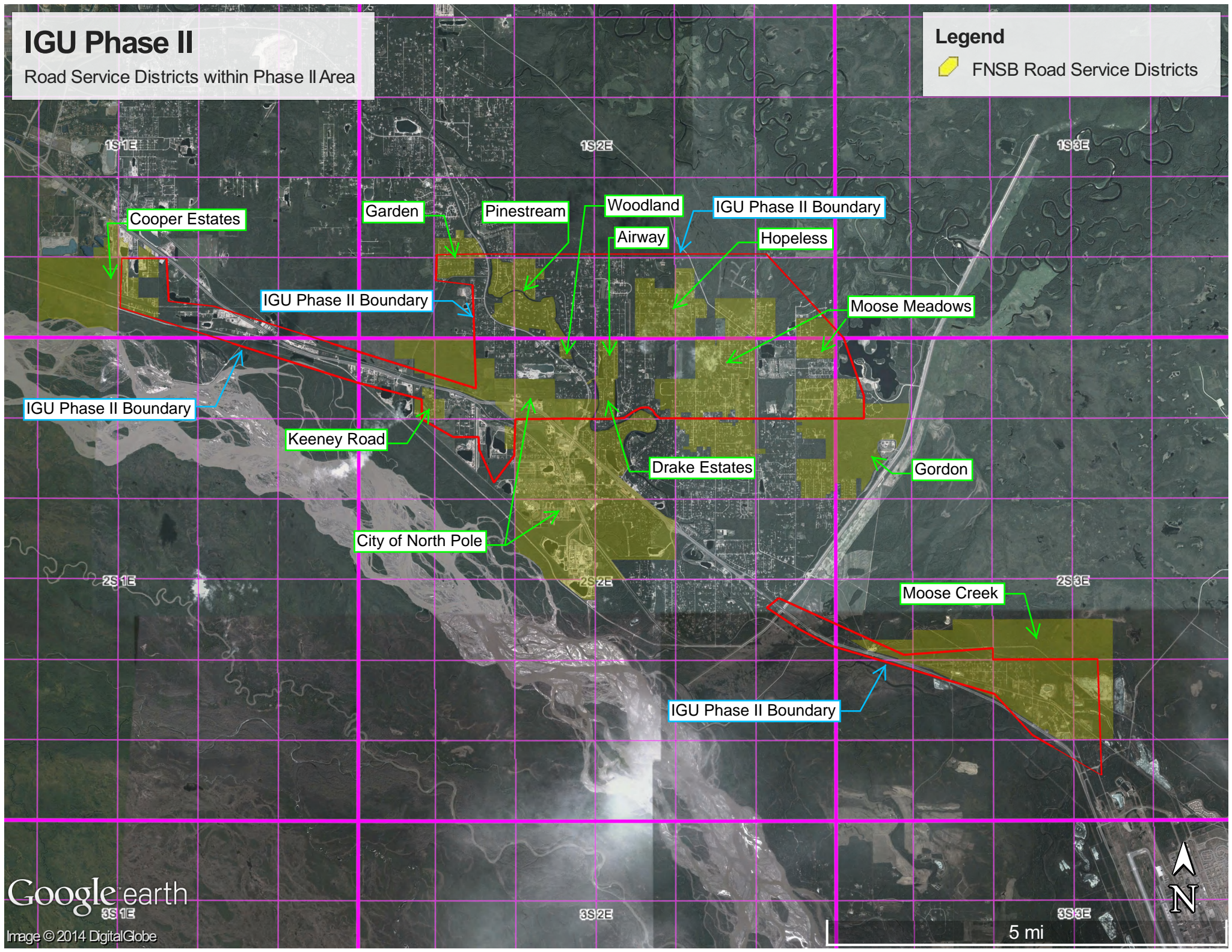



AIRWAY SERVICE AREA

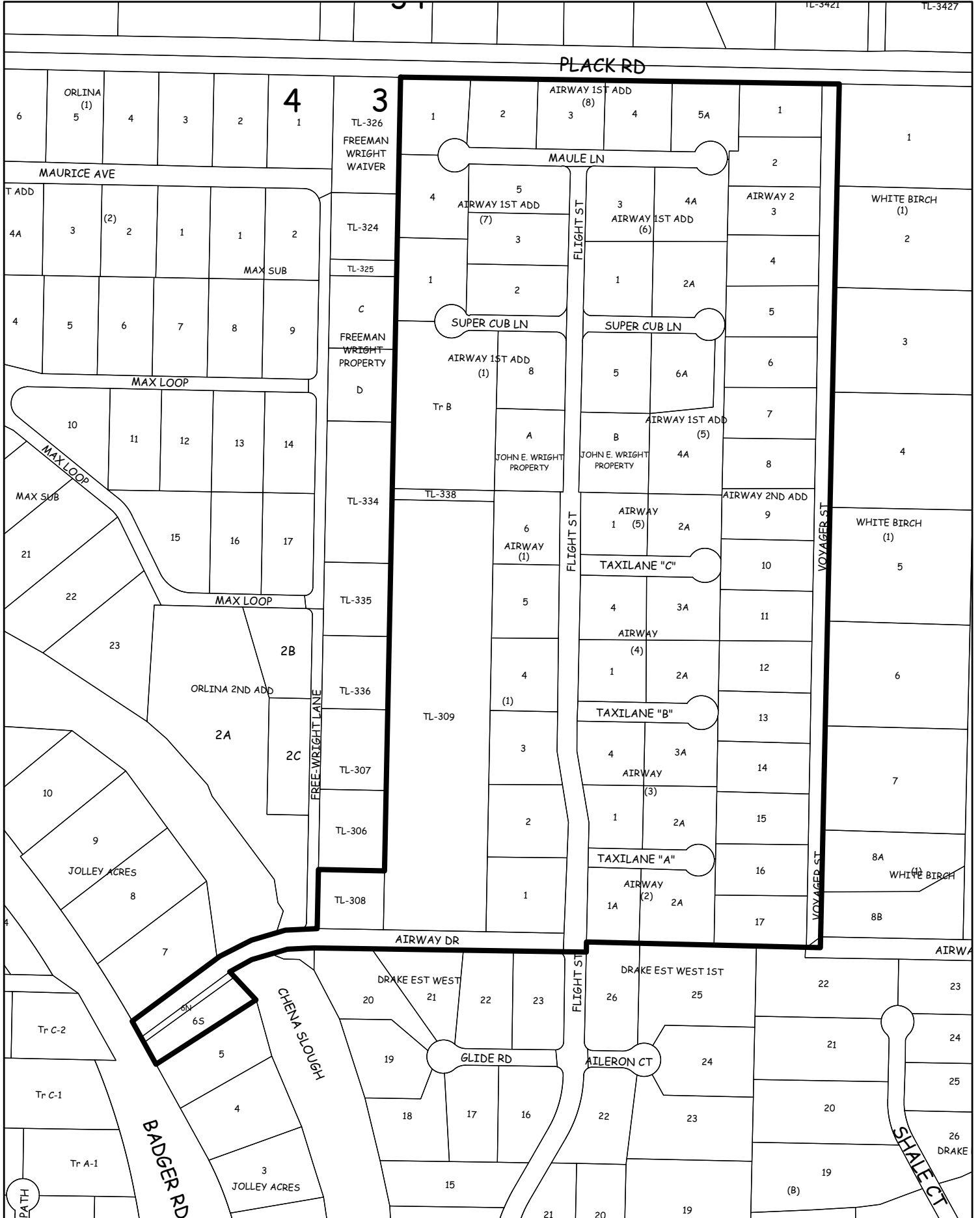



COOPER ESTATES SERVICE AREA

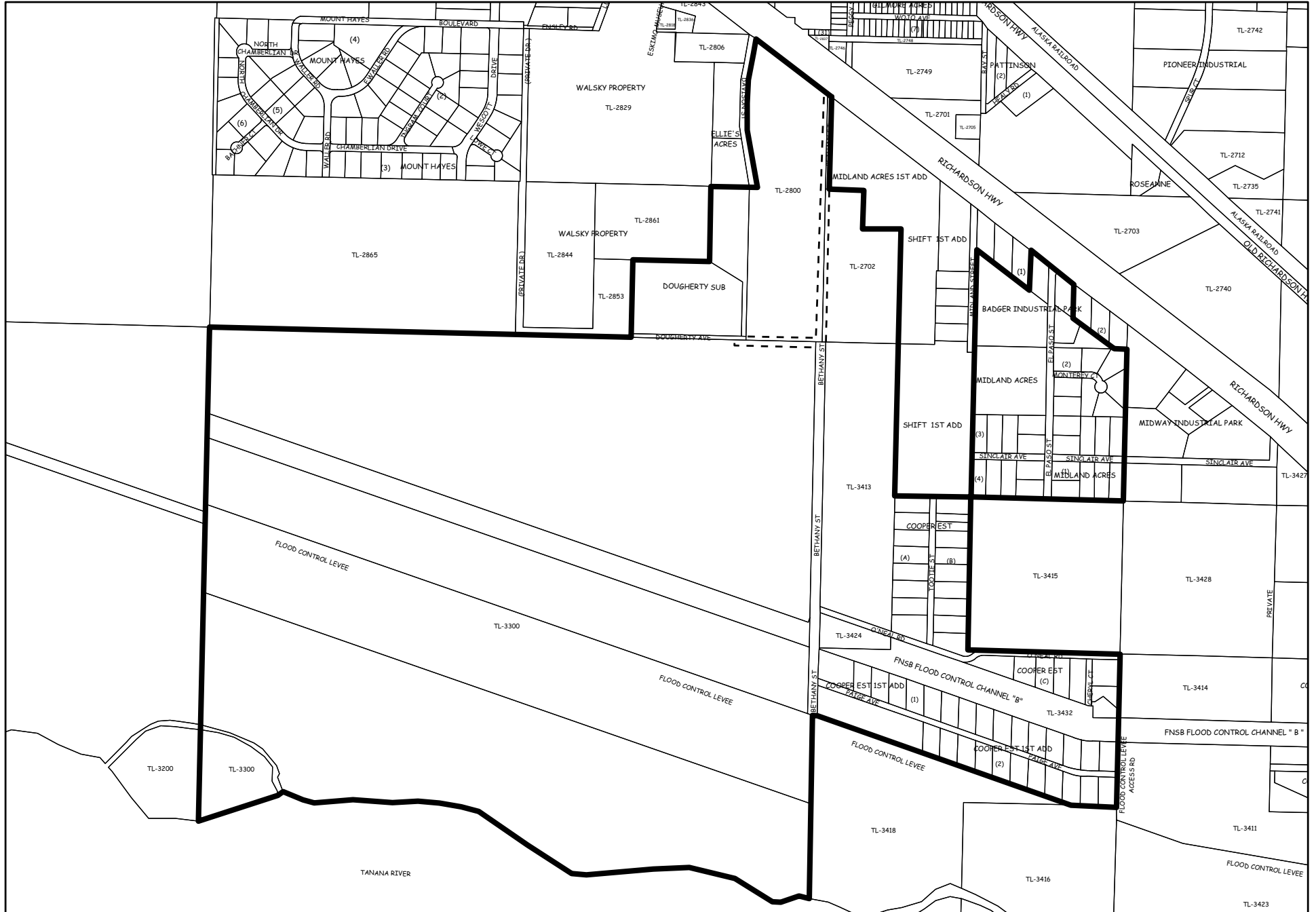



DRAKE ESTATES SERVICE AREA

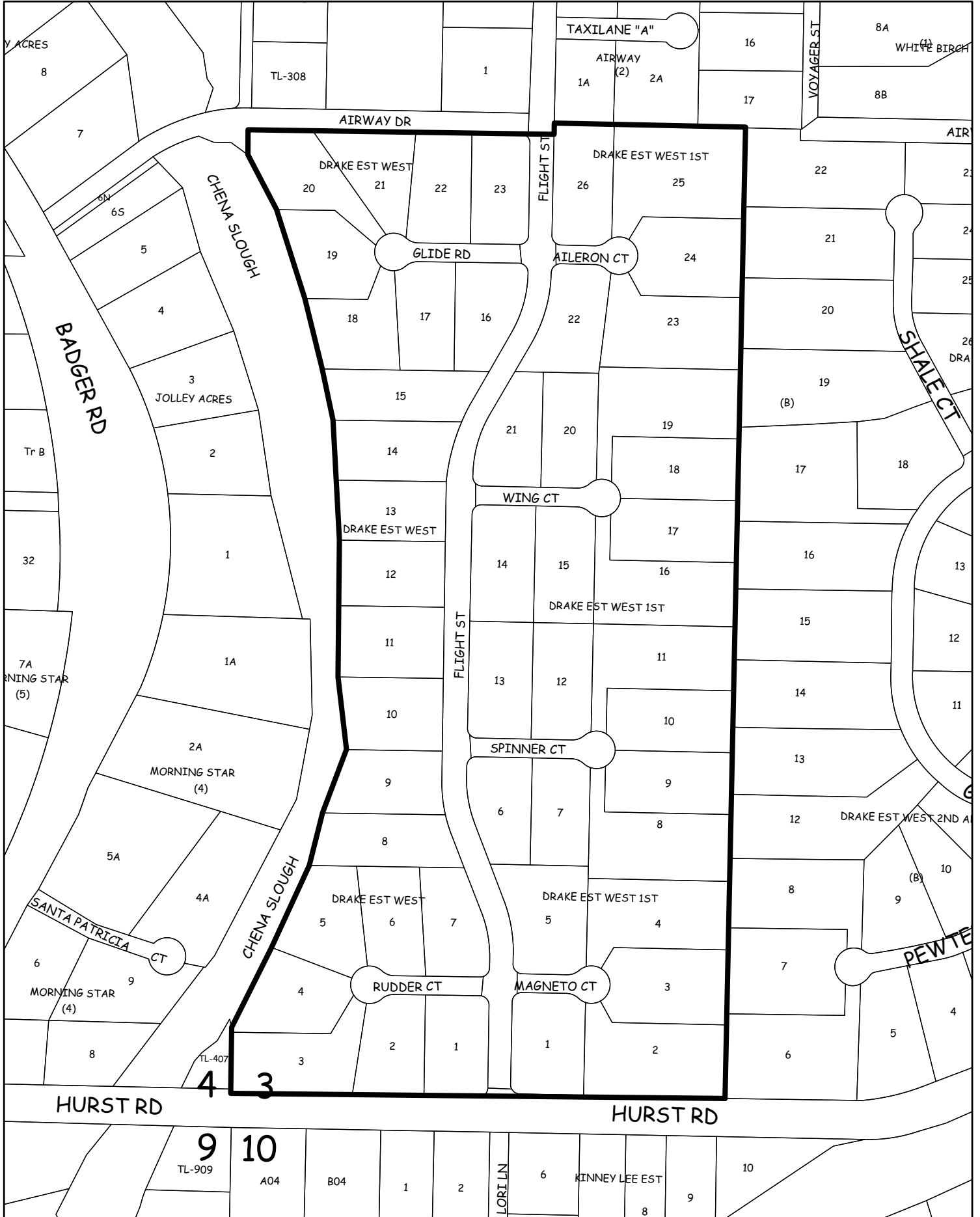



GARDEN SERVICE AREA

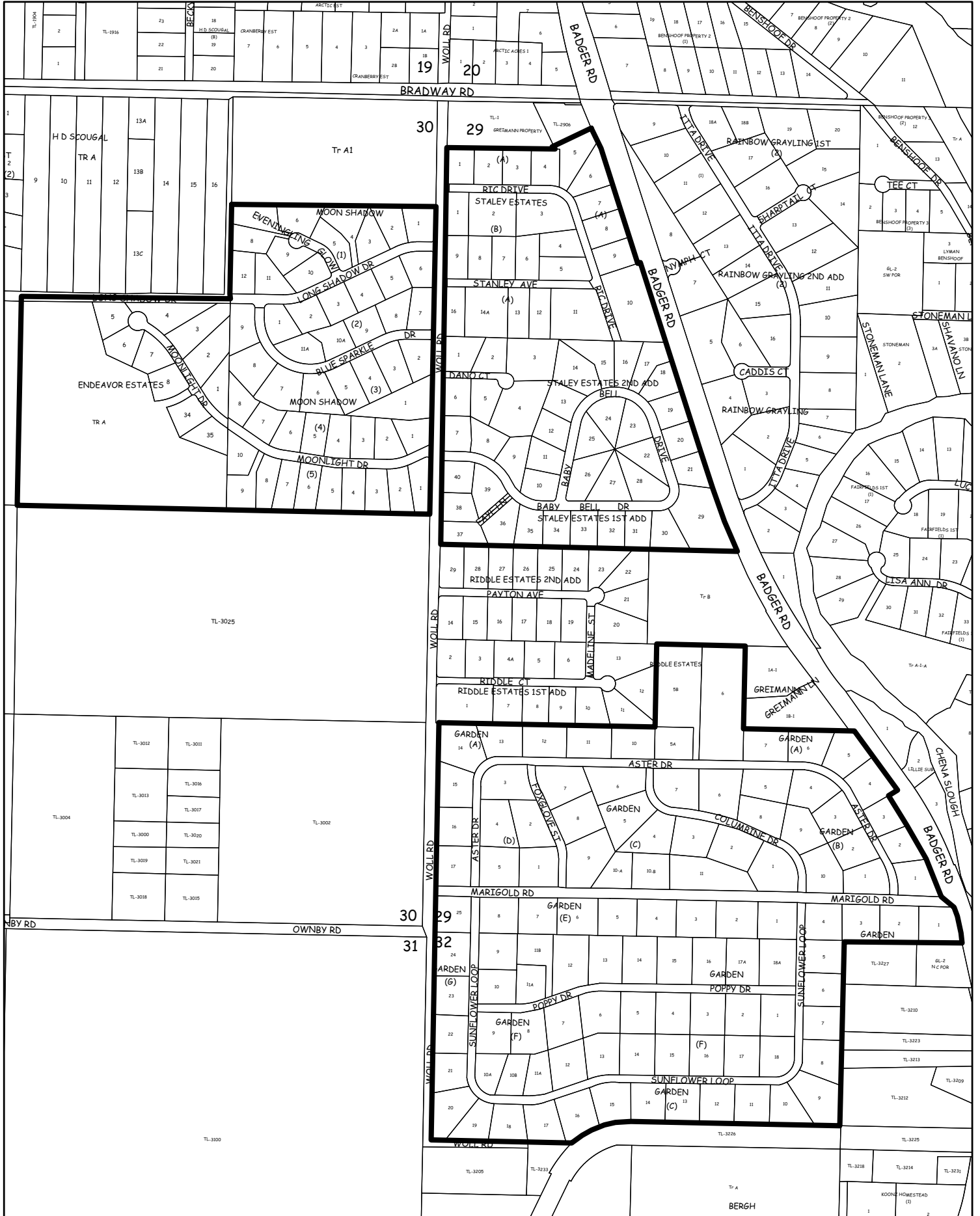



GORDON SERVICE AREA

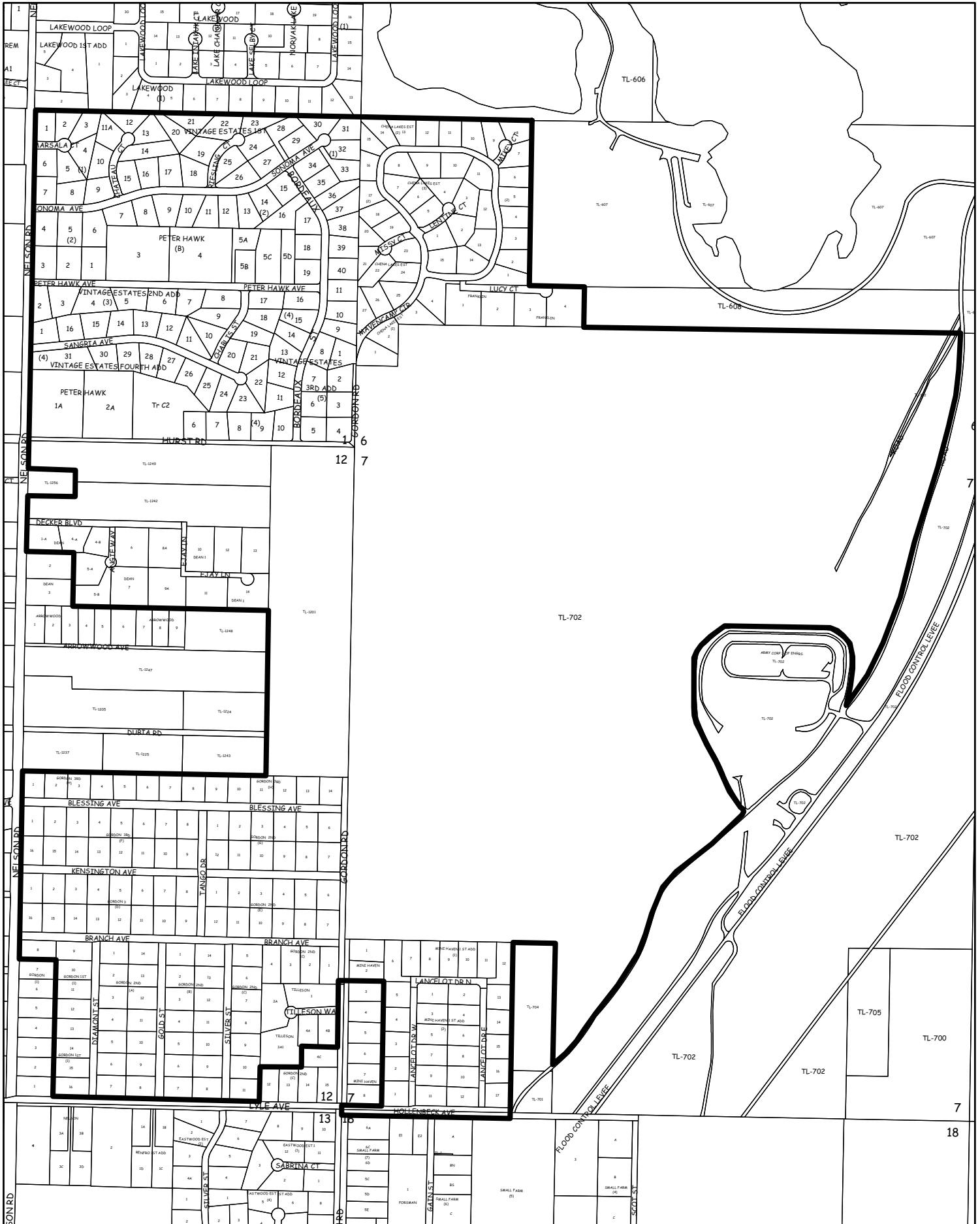



HOPELESS SERVICE AREA

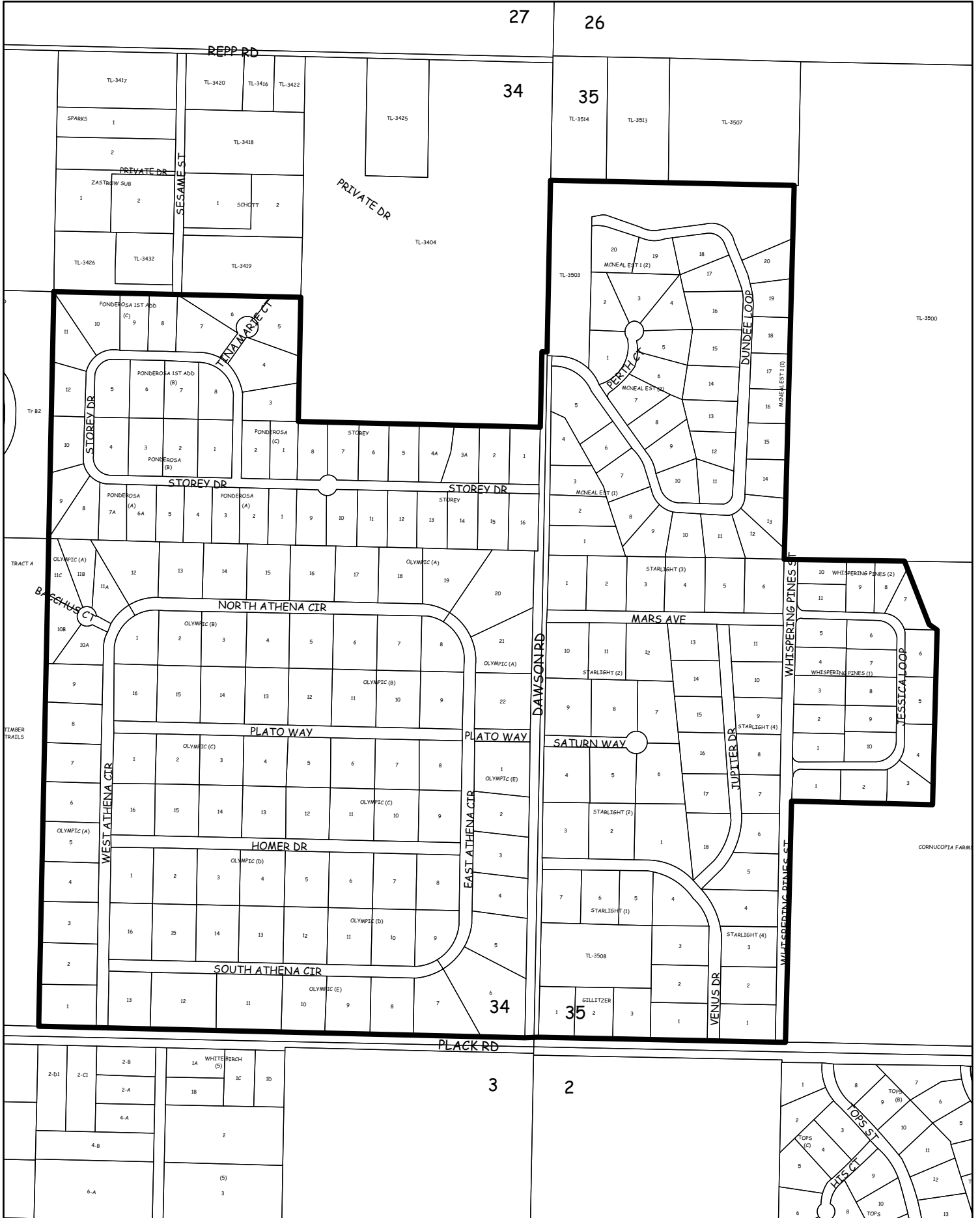



MOOSE CREEK SERVICE AREA

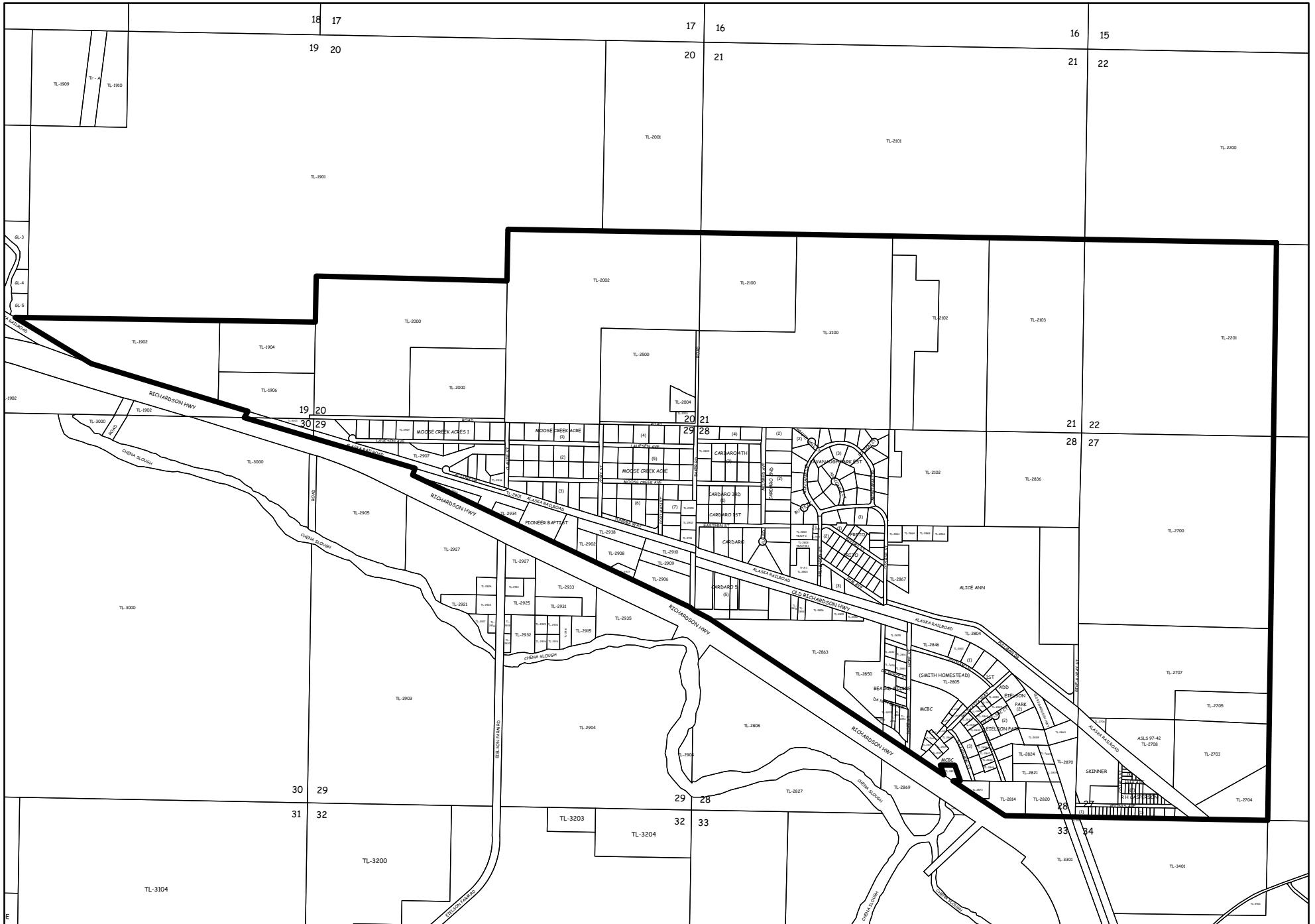



MOOSE CREEK SERVICE AREA NORTH-WEST PORTION





MOOSE CREEK SERVICE AREA NORTH-EAST PORTION

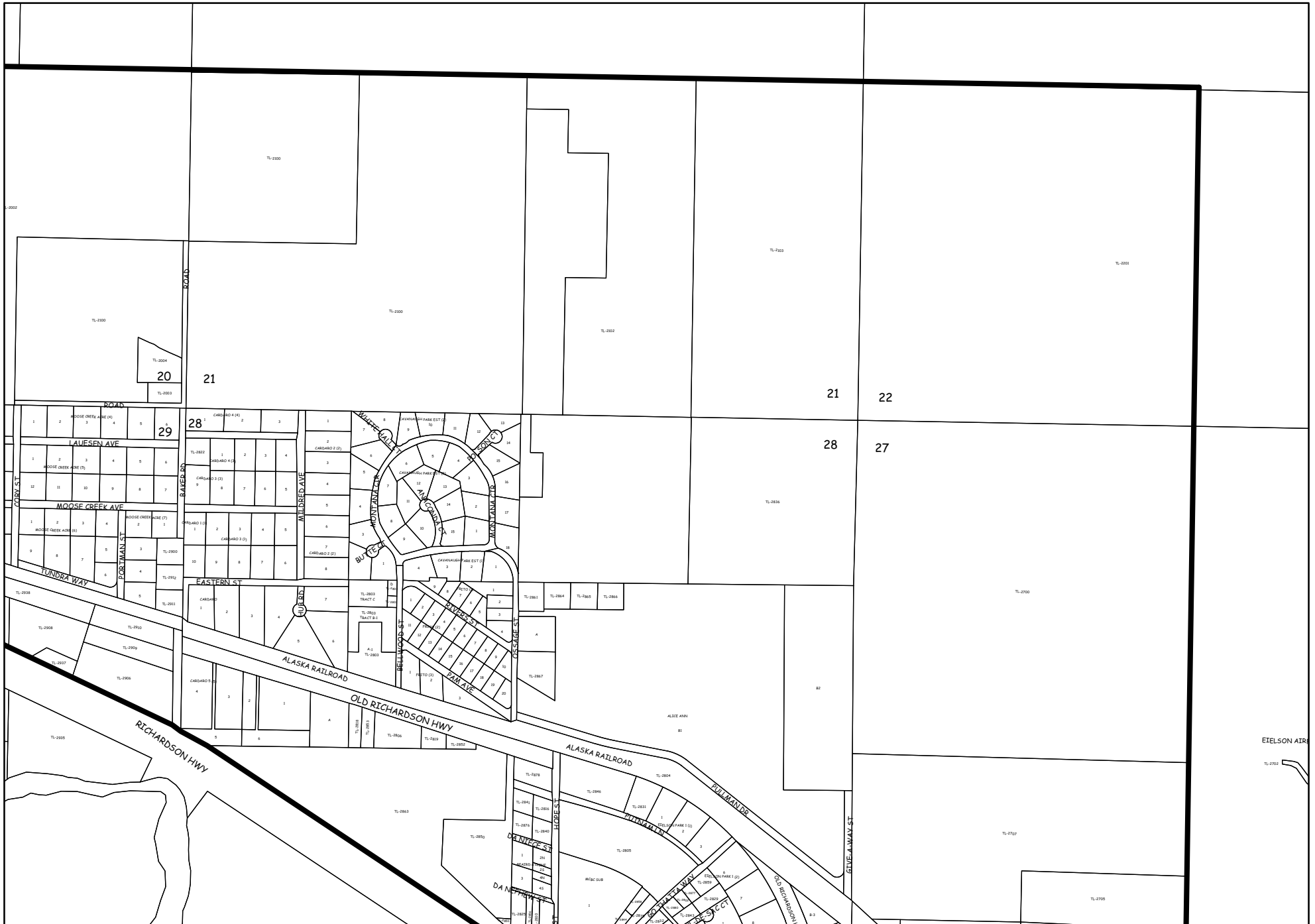



MOOSE CREEK SERVICE AREA SOUTH-EAST PORTION

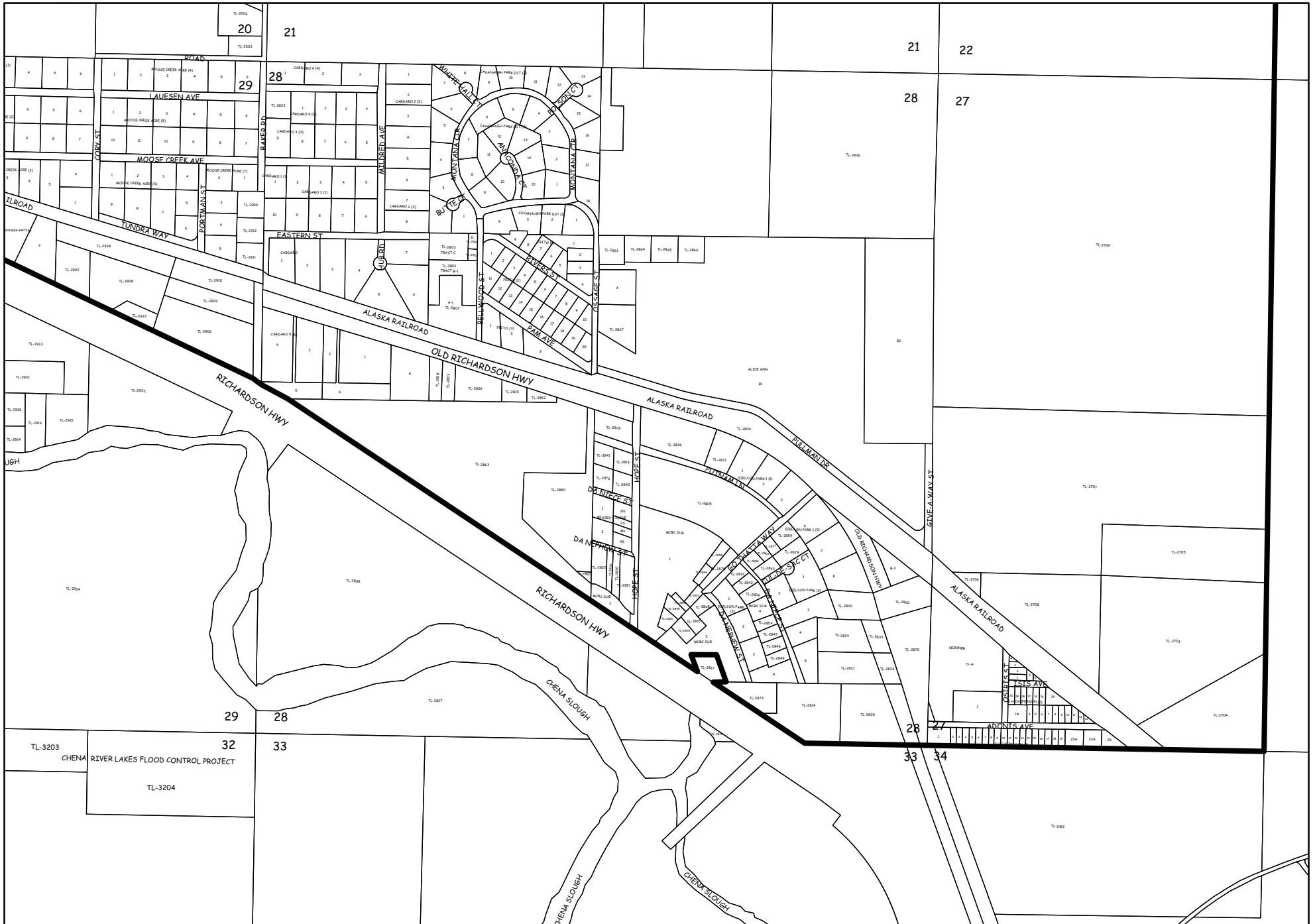



MOOSE MEADOWS SERVICE AREA

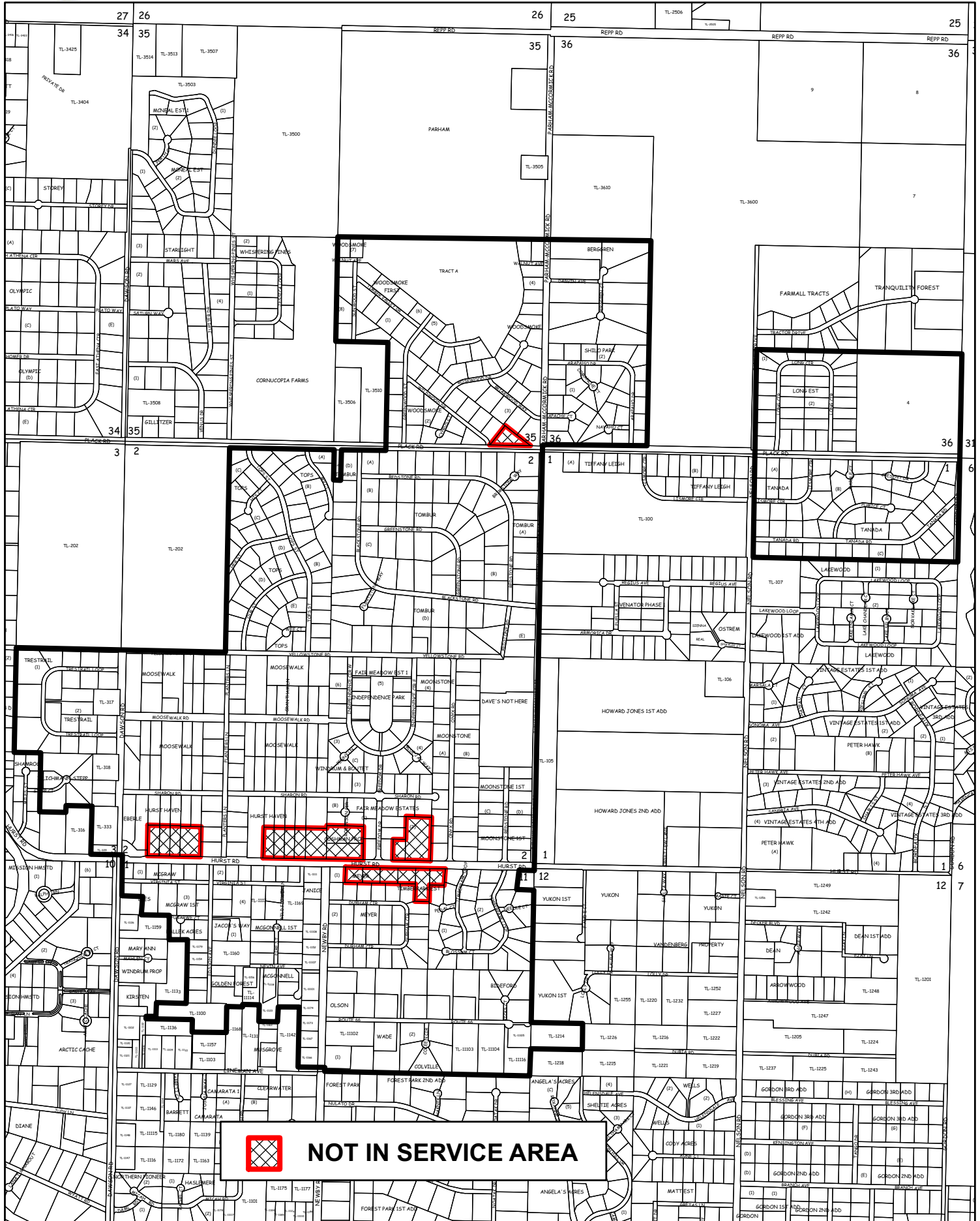



MOOSE MEADOWS SERVICE AREA SOUTH-WEST PORTION

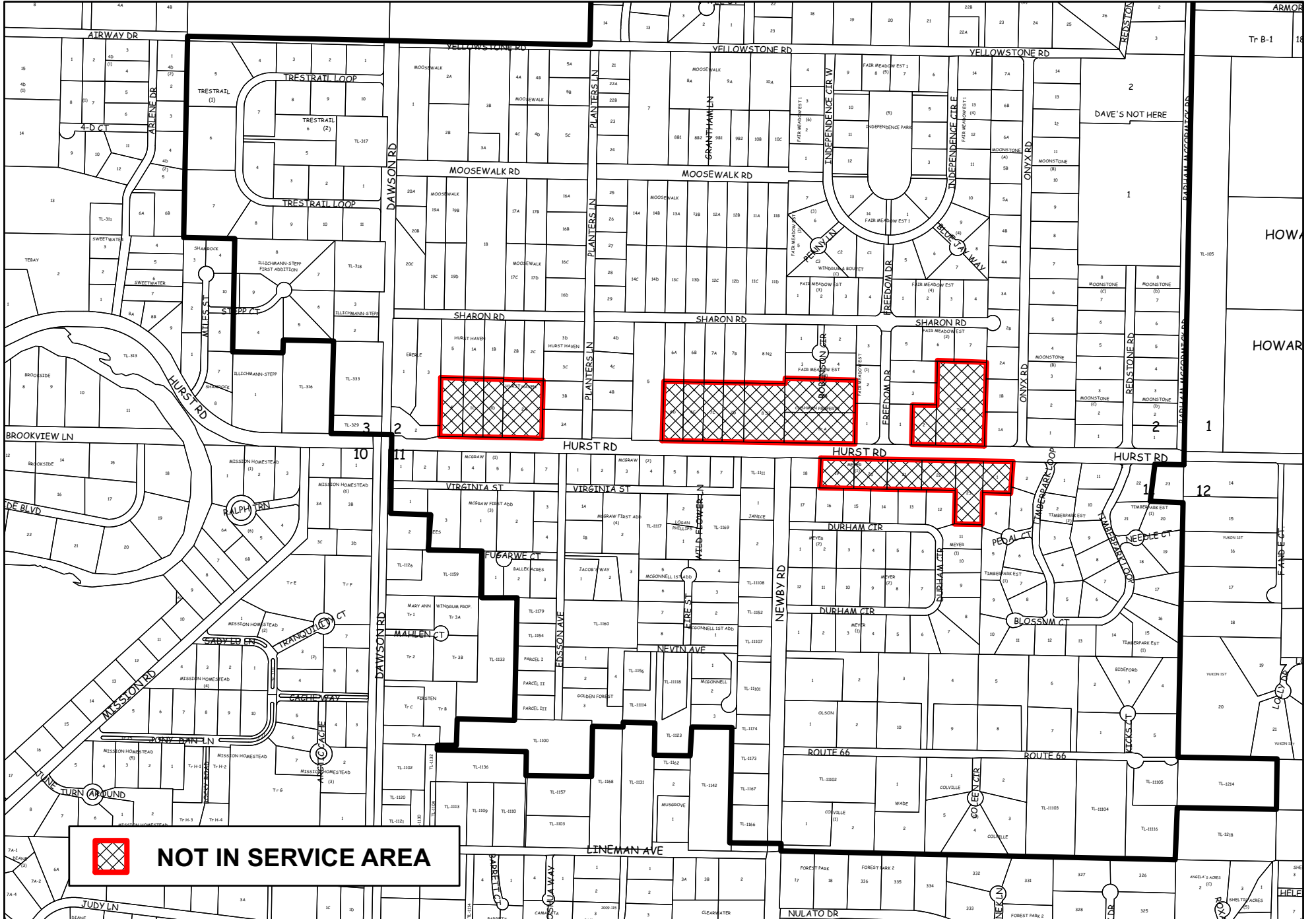



MOOSE MEADOWS SERVICE AREA NORTH-WEST PORTION

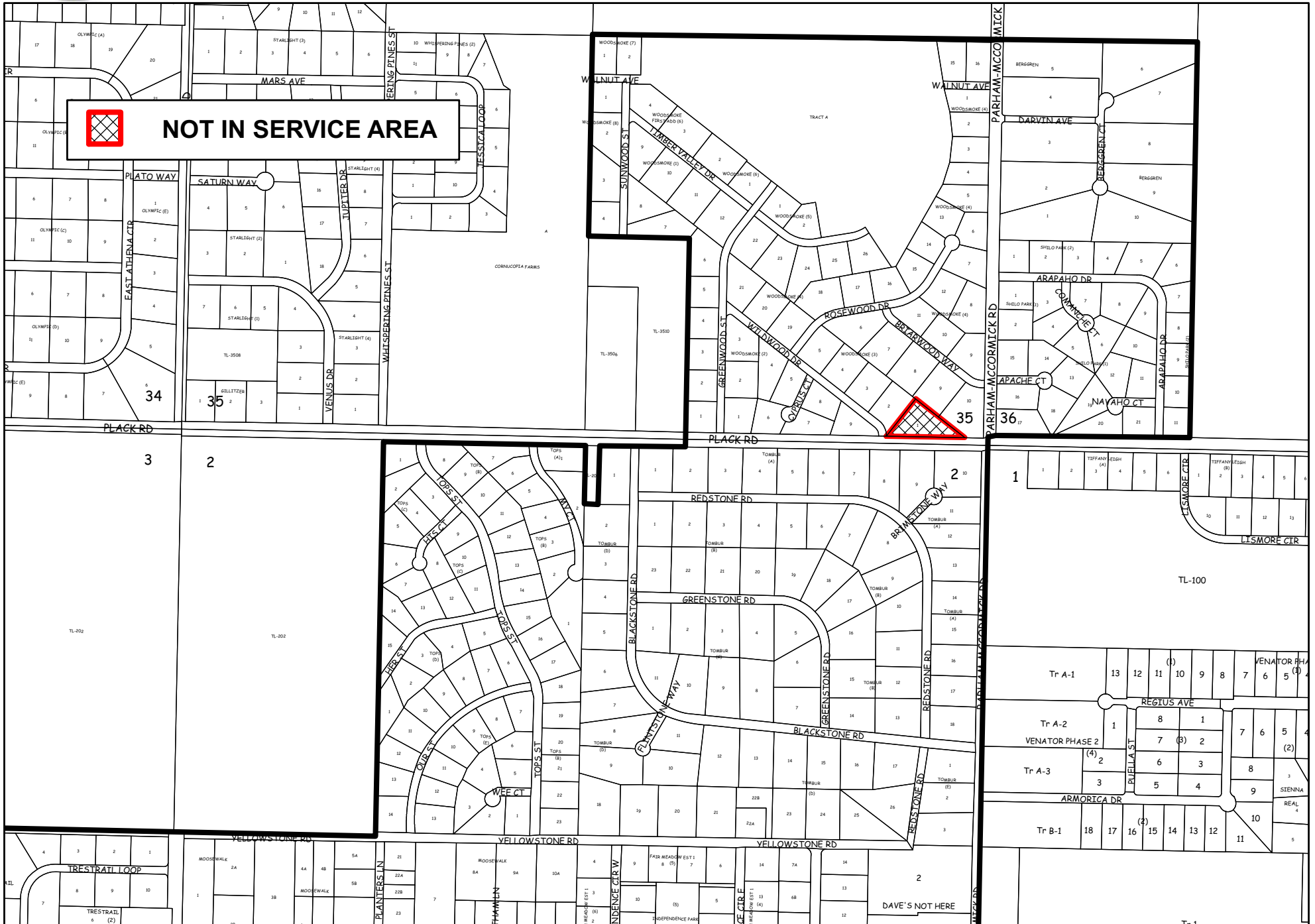



MOOSE MEADOWS SERVICE AREA NORTH-EAST PORTION



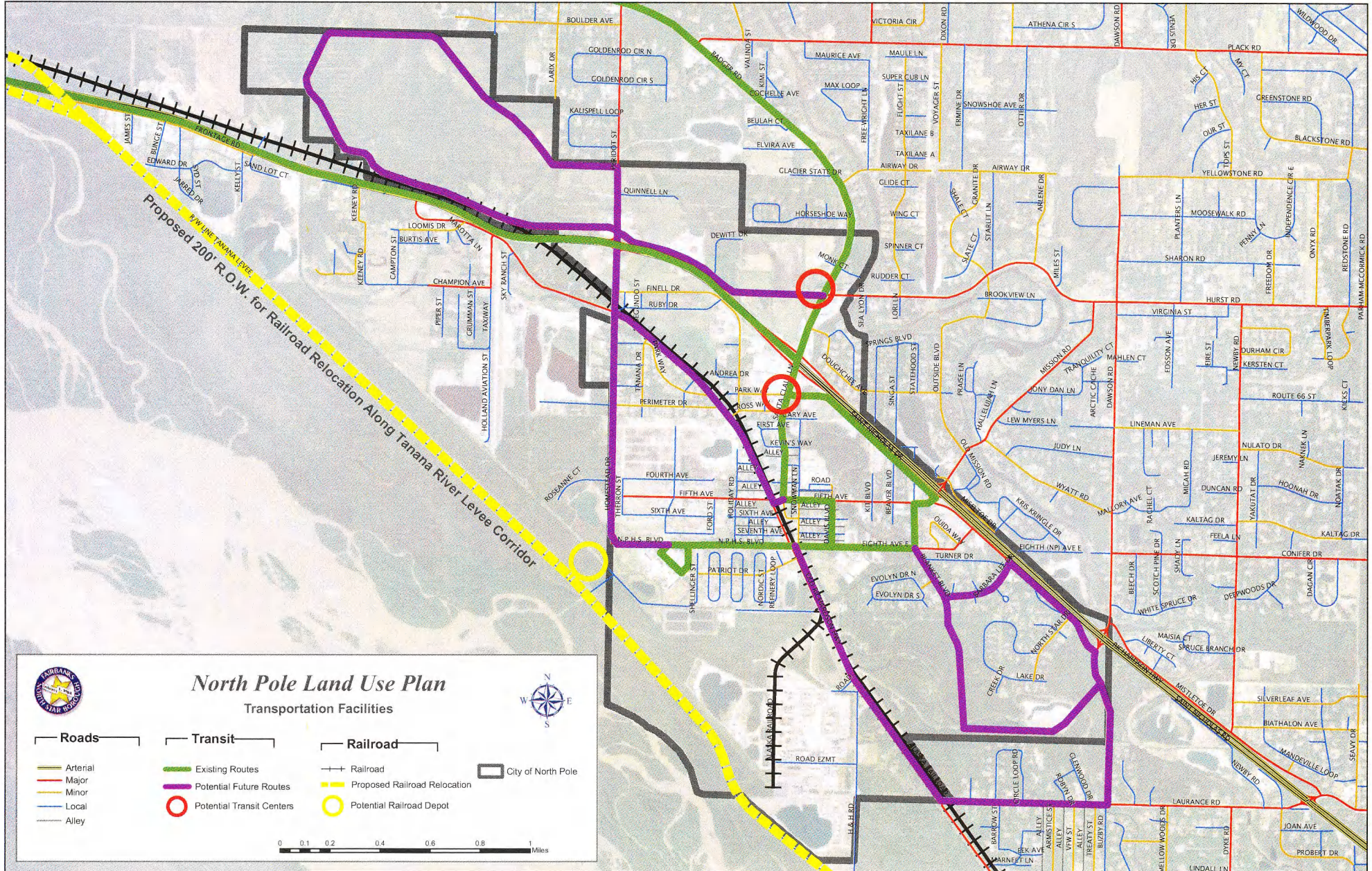

North Pole Land Use Plan

Transportation Facilities



- | | | | |
|--------------|---------------------------|------------------------------|--------------------|
| Roads | Transit | Railroad | |
| Arterial | Existing Routes | Railroad | City of North Pole |
| Major | Potential Future Routes | Proposed Railroad Relocation | |
| Minor | Potential Transit Centers | Potential Railroad Depot | |
| Local | | | |
| Alley | | | |
- 0 0.1 0.2 0.4 0.6 0.8 1 Miles



PINE STREAM SERVICE AREA

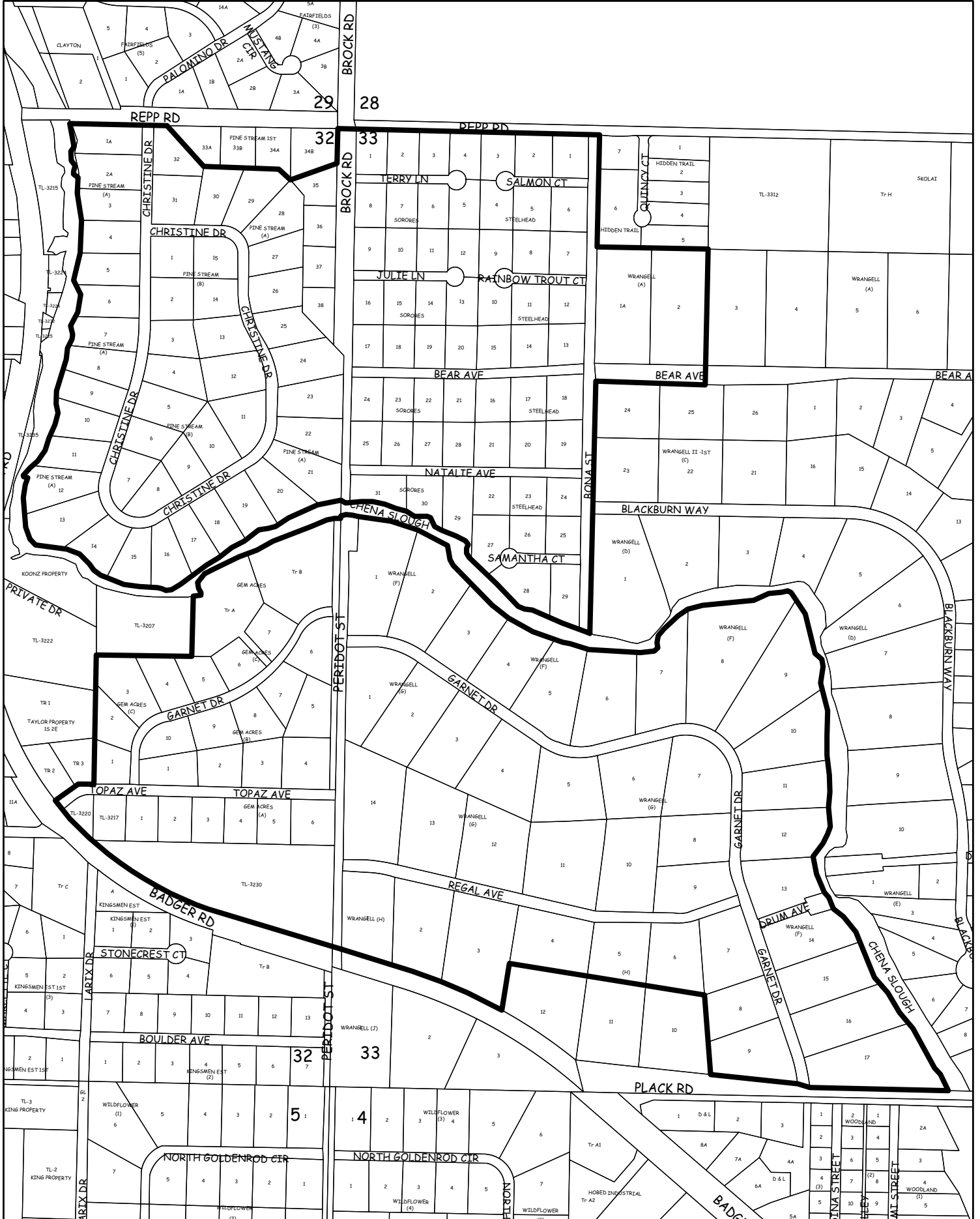



WOODLAND SERVICE AREA

