

Township No 8 North Range No 12 West of the Seward Meridian, Alaska

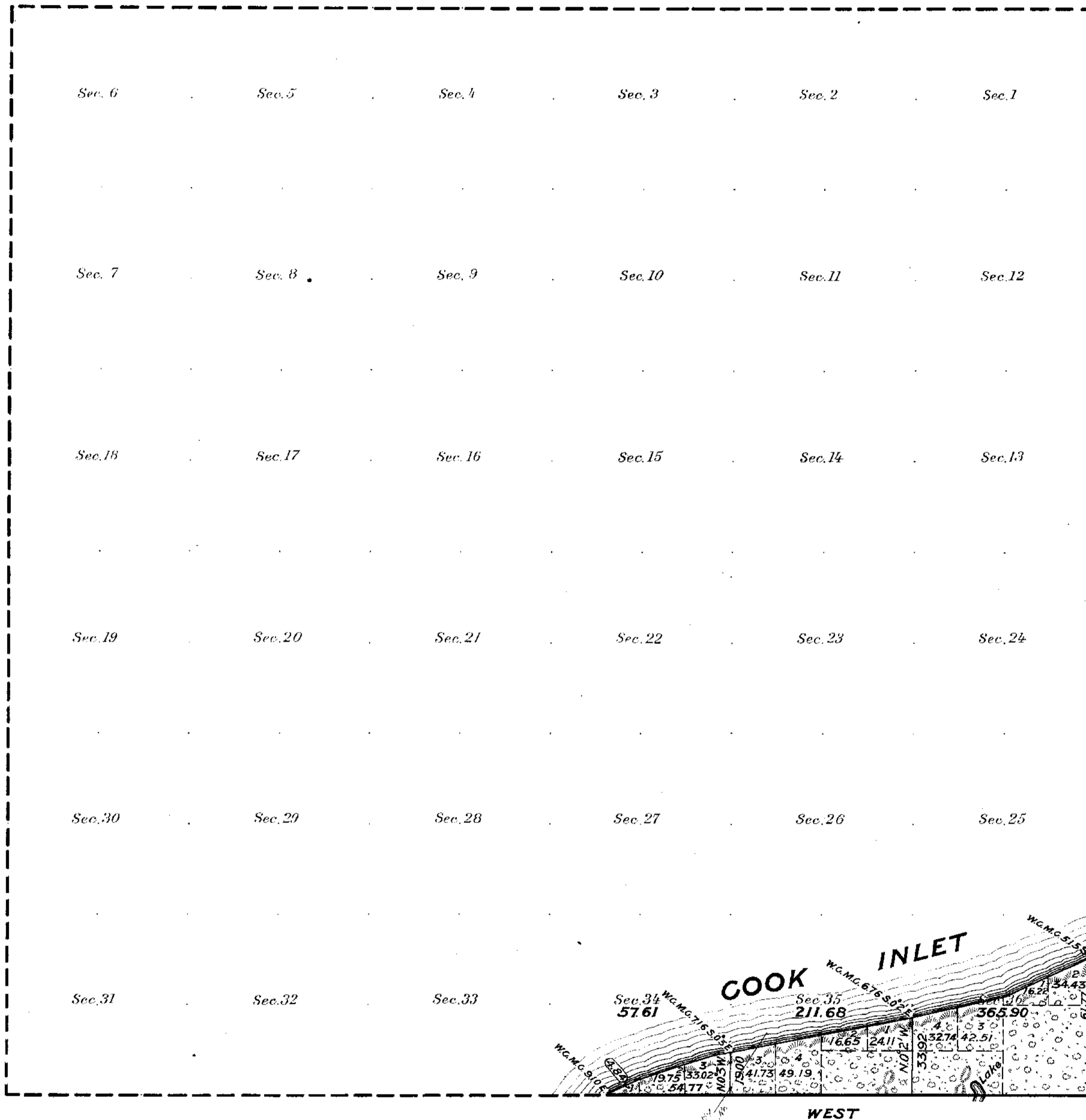

Areas in Acres	
Public Land	635.19
Indian Reservation	
Indian Allotments	
Mineral Claims	
Water Surface	
<b>Total Area</b>	<b>635.19</b>

Lat 60°43'50"N  
Long 151°17'43"W  
Scale 40 Chains to an inch  
Mean Magnetic Declination

Surveys Designated	By Whom Surveyed	Group		Amount of Surveys			When Surveyed	
		No.	Date	Mls.	chs.	lks.	Began	Completed
South Bdy	Fred Dahlquist	U.S.G.E. 28	June 29, 1922	2	54	77	July 31, 1922	Aug 9, 1922
East "	"	"	"	0	61	77	Aug 11 "	" 11 "
Subdivisions	"	"	"	0	52	92	" 8 "	" 9 "
Meanders	"	"	"	2	64	60	July 29 "	" 12 "

The above map of Township No. 8 North Range No. 12 West of the Seward Meridian Alaska is strictly conformable to the field notes of the survey thereof on file in this office, which have been examined and approved  
U. S. Surveyor General's Office.  
Juneau, Alaska. June 12, 1923

*Carl Smith*  
Surveyor General.