

SURVEYED TOWNSHIP 17 NORTH RANGE 1 WEST OF THE SEWARD MERIDIAN, ALASKA

STATUS OF PUBLIC DOMAIN
LAND AND MINERAL TITLES

MTP

FOR ORDERS EFFECTING DISPOSAL OR USE OF UN-IDENTIFIED LANDS WITHDRAWN FOR CLASSIFICATION MINERALS, WATER AND/OR OTHER PUBLIC PURPOSES REFER TO INDEX OF MISCELLANEOUS DOCUMENTS.

Entire Tp C1 prospectively valuable for O&G as of 4/22/1957

PL0 5184 Well CI affects Lds/interests not conveyed

A058730 SS ME entire Tp

AA55130 Exclusive Lic PL 97-468 1/14/1983:
Sec 7 lot 3, NEWSWA, N/SEW

AA57929 Iditarod National Historic Trail affects this Tp

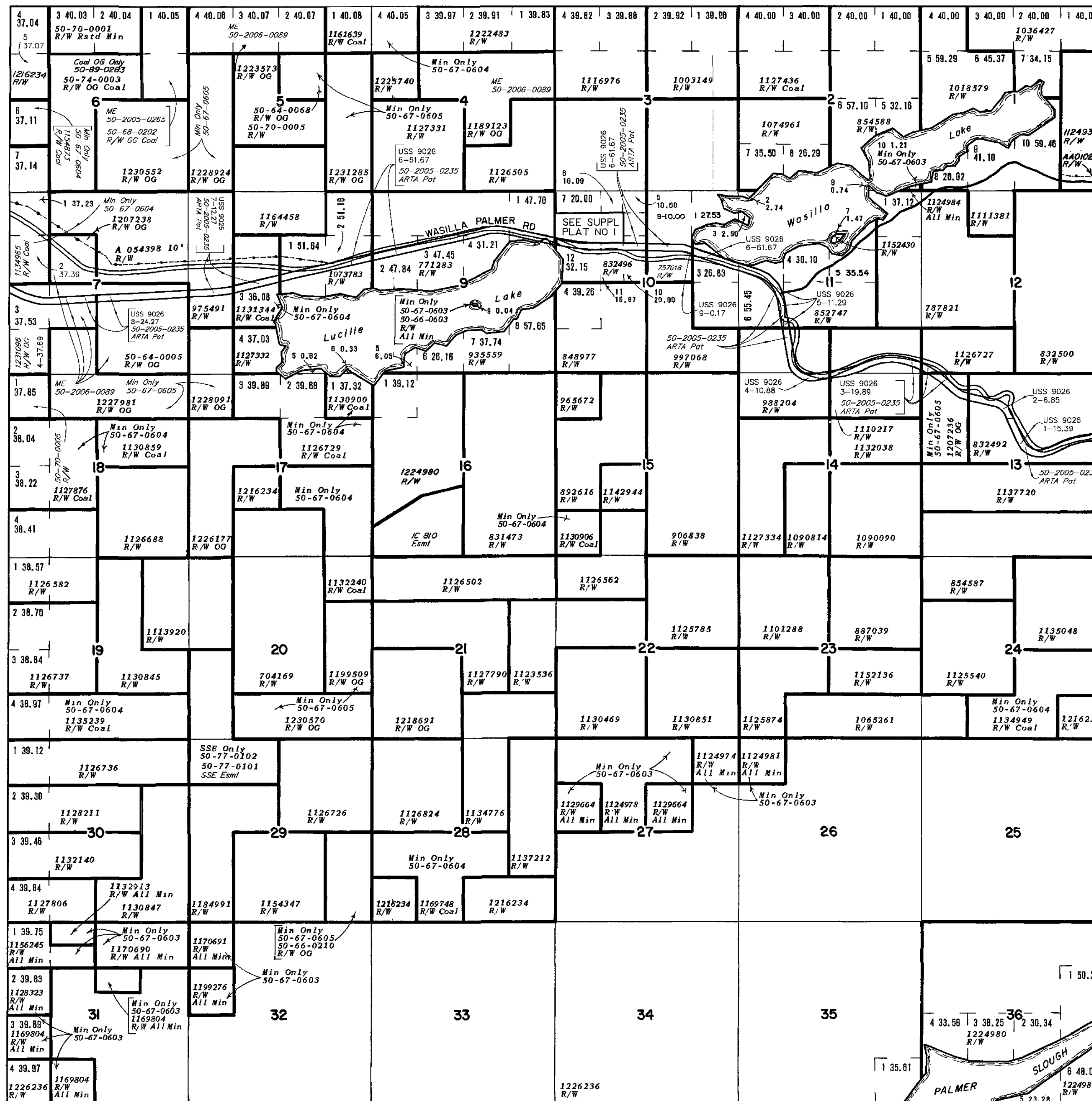

Lot 61°30'48.388"N
Long 149°21'25.992"W

16N 2W | 16N 1W

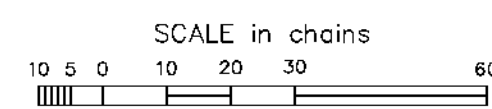

WARNING:
This plat is the Bureau's Record of Title, and should be used only as a graphic display of the township survey data. Records hereon do not reflect title changes which may have been affected by lateral movements of rivers or other bodies of water. Refer to the cadastral surveys for official survey information.

CURRENT TO		Sew Mer
9-25-2006		T 17 N
		R 1 W

PV